

### 10.Weather Strip

#### A: REPLACEMENT

##### 1. FLANGE

1) Remove the weather strip - body side flange while pulling the rubber. Be careful not to tear the rubber.

NOTE:

While removing, be careful not to damage the clips attached to the weather strip - body arch.

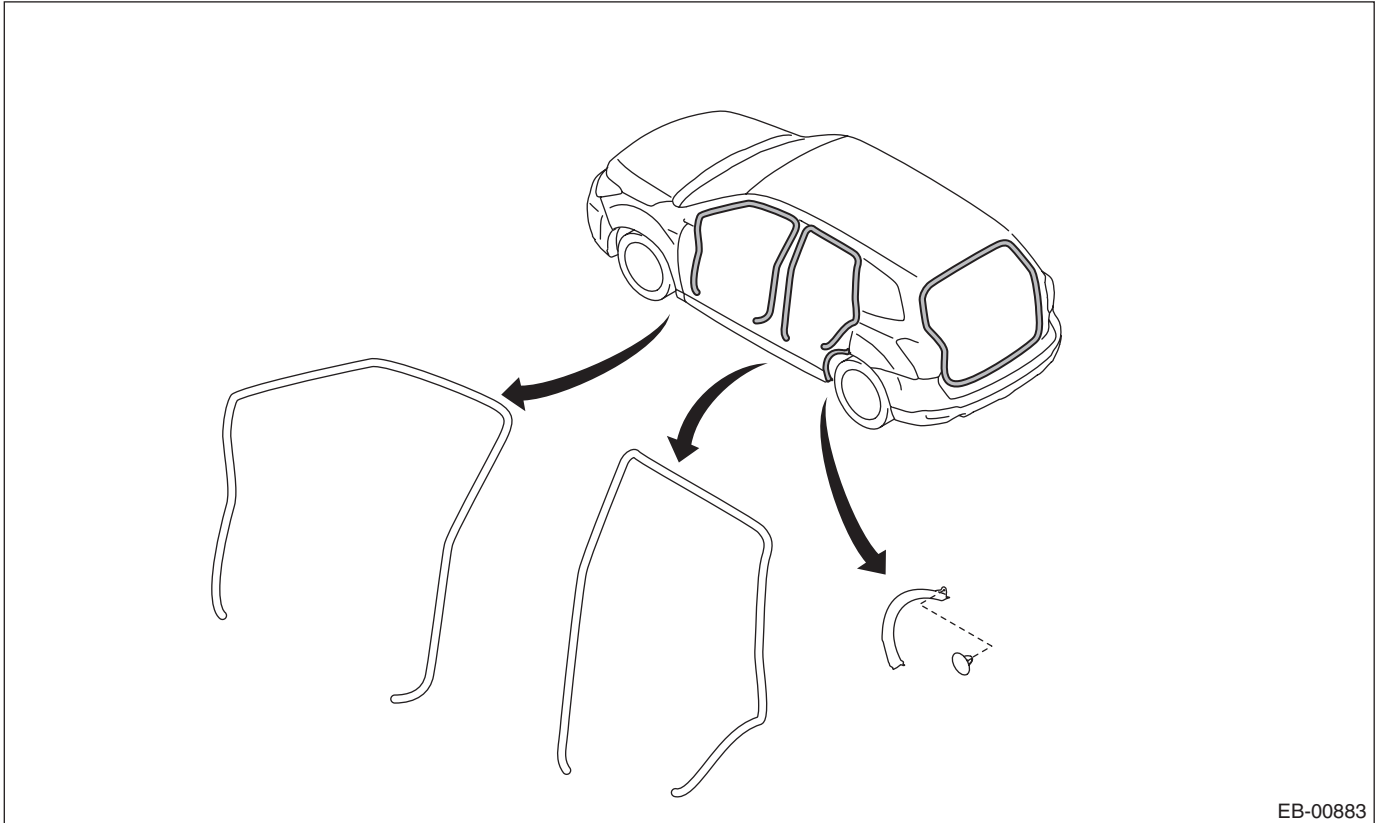

EB-00883

2) Replace the weather strip - rear gate while pulling the rubber. Be careful not to tear the rubber.

**NOTE:**

While removing the weather strip - rear gate, be careful not to allow adhesive to contact the trim panel - roof assembly and trim panel - trunk side.

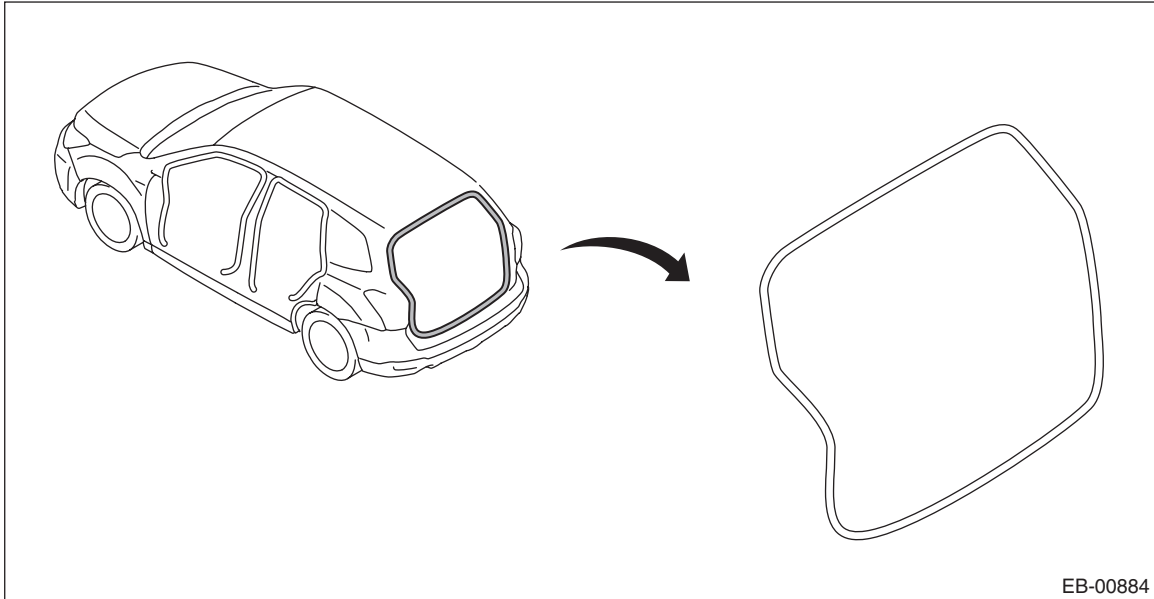

# Weather Strip

## EXTERIOR BODY PANELS

### 2. DOOR

1) Remove the weather strip after removing the clip. Be careful not to tear the rubber.

#### CAUTION:

If the weather strip clip is removed with excessive force, the weather strip may be damaged. Be sure to use clip remover to remove.

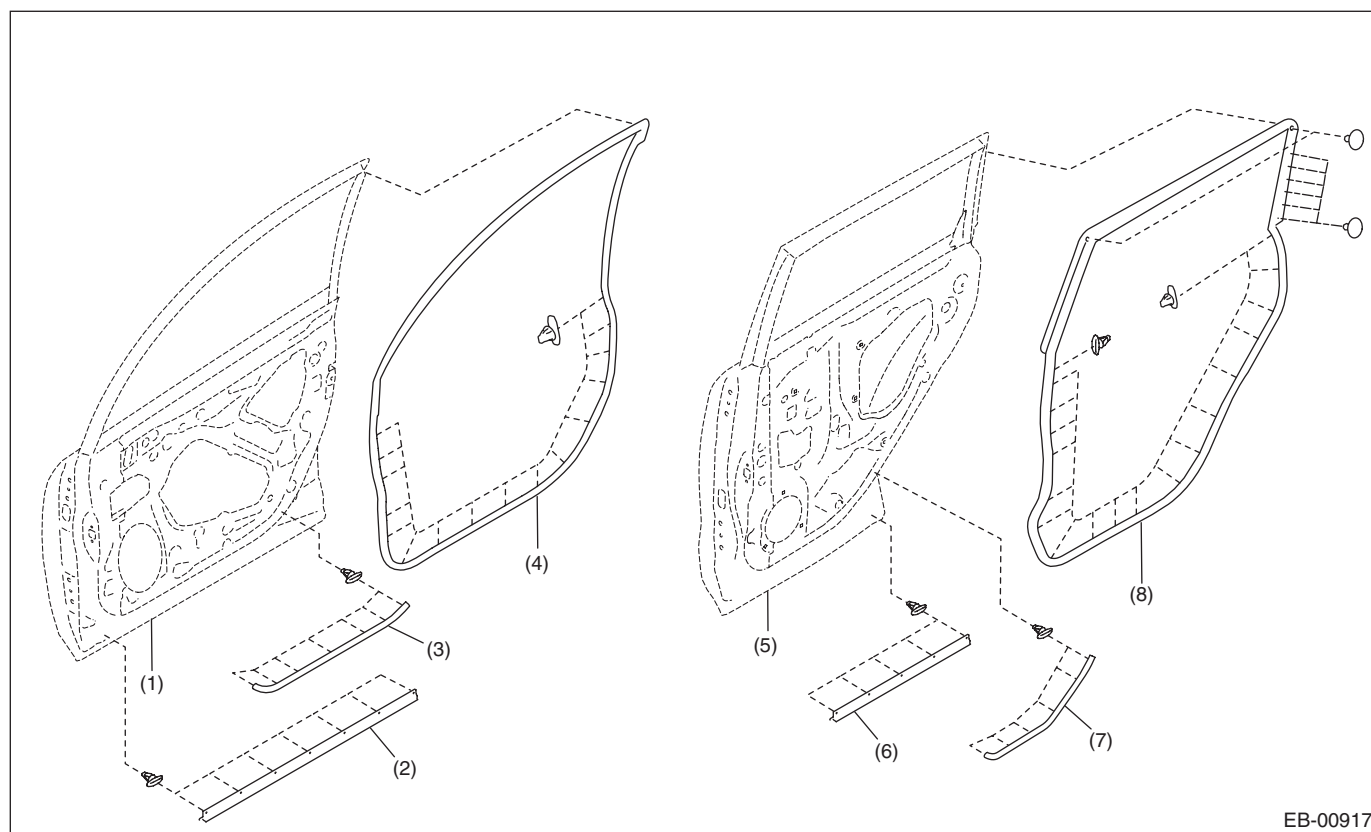
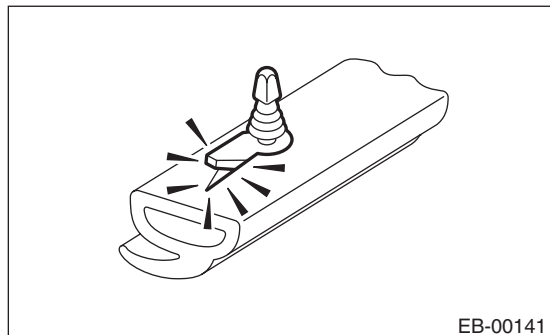

- |  |   |                                       |
|--|---|---------------------------------------|
| (1) Panel ASSY - front door                | (4) Weather strip - front door            | (7) Weather strip - rear door - lower |
| (2) Weather strip - front door - side sill | (5) Panel ASSY - rear door                | (8) Weather strip - rear door         |
| (3) Weather strip - front door - lower     | (6) Weather strip - rear door - side sill |                                       |

# POWER REAR GATE SYSTEM

# *PRG*

---

|   | Page |
|---|------|
| 1. General Description .....                    | 2    |
| 2. Relay and Fuse .....                         | 7    |
| 3. Power Rear Gate System .....                 | 8    |
| 4. Power Rear Gate Control Module .....         | 9    |
| 5. Power Rear Gate Drive Unit .....             | 10   |
| 6. Power Rear Gate Rod .....                    | 15   |
| 7. Power Rear Gate Auto Closer .....            | 17   |
| 8. Power Rear Gate Touch Sensor .....           | 21   |
| 9. Power Rear Gate Buzzer .....                 | 22   |
| 10. Power Rear Gate Inner Switch .....          | 23   |
| 11. Power Rear Gate Driver's Switch .....       | 24   |
| 12. Memory Height Switch .....                  | 25   |
| 13. Rear Gate Opener Button .....               | 27   |
| 14. Body Integrated Unit .....                  | 28   |
| 15. Turn Signal Light & Hazard Light Unit ..... | 29   |
| 16. Diagnostics with Phenomenon .....           | 30   |