

# General Description

EMISSION CONTROL (AUX. EMISSION CONTROL DEVICES)

## 1. General Description

### A: COMPONENT

#### 1. CANISTER, PURGE CONTROL SOLENOID VALVE, AND LEAK CHECK VALVE ASSEMBLY

For components of canister, purge control solenoid valve, and leak check valve assembly, refer to FU(H4DOTC). <Ref. to FU(H4DOTC)-3, COMPONENT, General Description.>

#### 2. EXHAUST GAS RECIRCULATION CONTROL CIRCUIT RANGE/PERFORMANCE

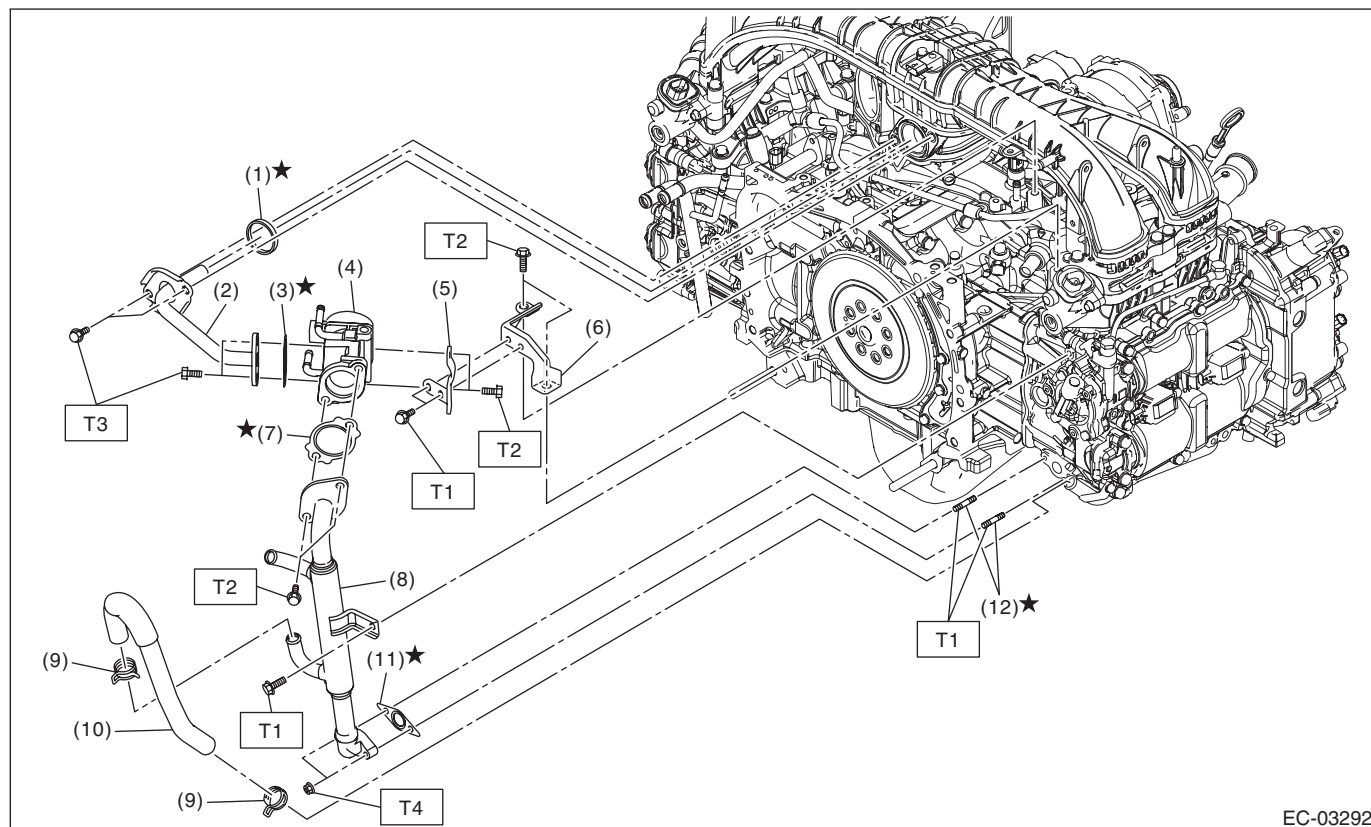

- |                                 |                 |
|---------------------------------|-----------------|
| (1) O-ring                      | (7) Gasket      |
| (2) EGR pipe                    | (8) EGR cooler  |
| (3) Gasket                      | (9) Clip        |
| (4) EGR control valve           | (10) Water hose |
| (5) EGR control valve bracket A | (11) Gasket     |
| (6) EGR control valve bracket B | (12) Stud bolt  |

#### **Tightening torque: N-m (kgf-m, ft-lb)**

**T1: 6.4 (0.7, 4.7)**

**T2: 19 (1.9, 14.0)**

**T3: <Ref. to EC(H4DOTC)-27, INSTALLATION, EGR Pipe.>**

**T4: <Ref. to EC(H4DOTC)-38, INSTALLATION, EGR Cooler.>**

# General Description

EMISSION CONTROL (AUX. EMISSION CONTROL DEVICES)

## 3. PCV SYSTEM 1

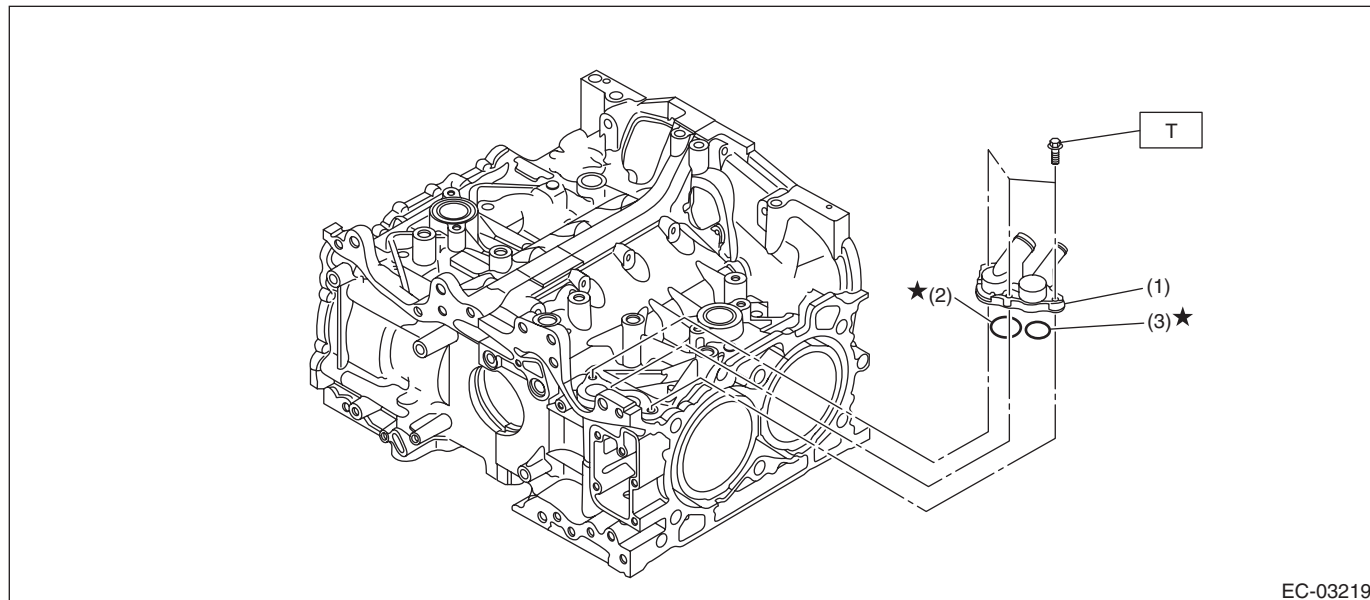

(1) PCV connector

(2) O-ring

(3) O-ring

**Tightening torque: N·m (kgf-m, ft-lb)**

**T: 6.4 (0.7, 4.7)**

# General Description

EMISSION CONTROL (AUX. EMISSION CONTROL DEVICES)

## 4. PCV SYSTEM 2

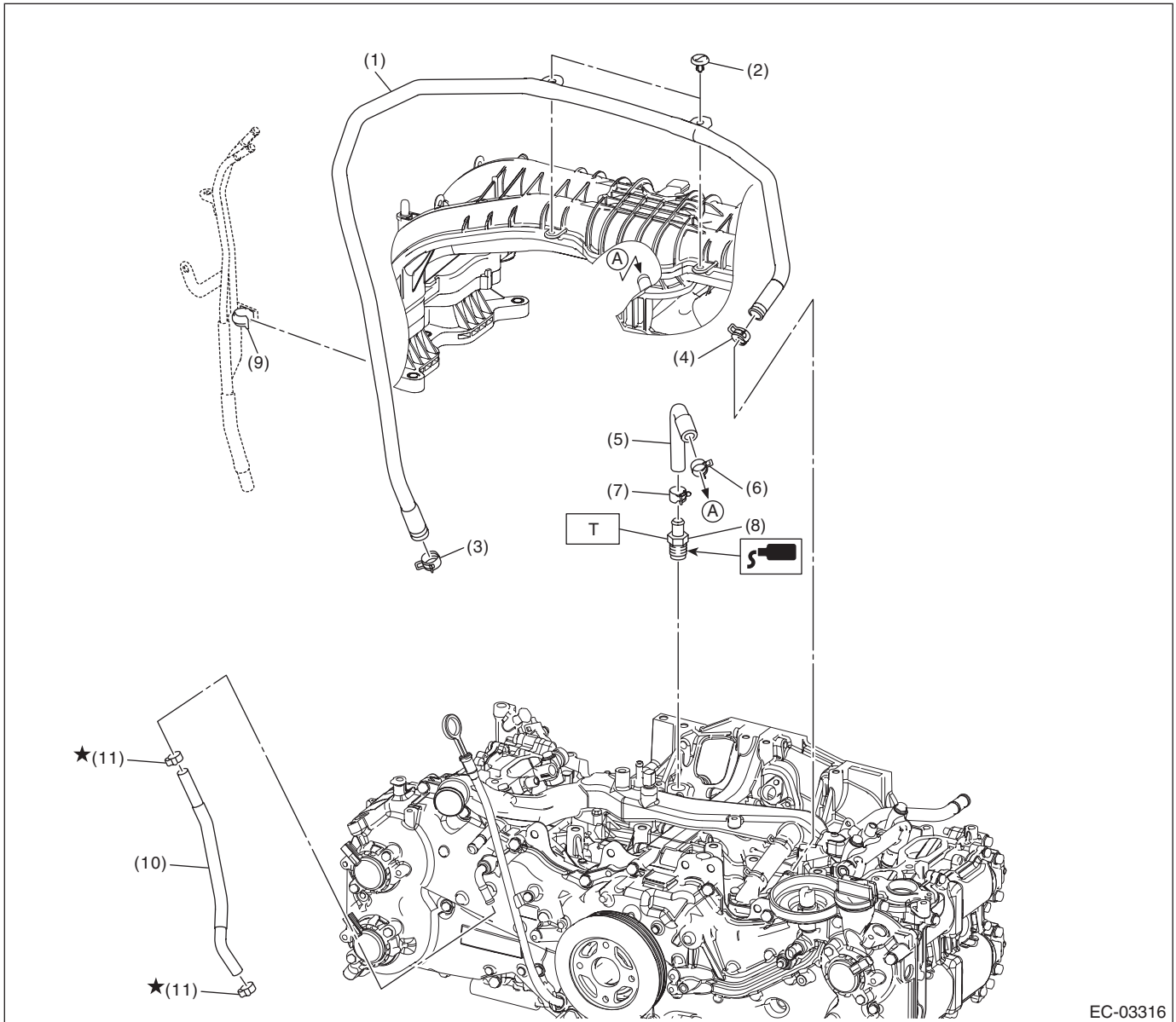

- (1) PCV pipe
- (2) Clip
- (3) Clip
- (4) Clip
- (5) PCV hose A

- (6) Clip
- (7) Clip
- (8) PCV valve
- (9) Clip
- (10) PCV hose B

- (11) Clamp

---

**Tightening torque: N·m (kgf-m, ft-lb)**  
**T: 23 (2.3, 17.0)**

---

## General Description

EMISSION CONTROL (AUX. EMISSION CONTROL DEVICES)

### B: CAUTION

- Prior to starting work, pay special attention to the following:
  1. Always wear work clothes, a safety cap, protective shoes. Additionally, wear a helmet, protective goggles, etc. if necessary.
  2. Protect the vehicle using a seat cover, fender cover, etc.
  3. Prepare the service tools, clean cloth, containers to catch grease and oil, etc.
- Vehicle components are extremely hot immediately after driving. Be wary of receiving burns from heated parts.
- When performing a repair, identify the cause of trouble and avoid unnecessary removal, disassembly and replacement.
- Before disconnecting connectors of sensors or units, be sure to disconnect the ground cable from battery.
- Always use the jack-up point when the shop jacks or rigid racks are used to support the vehicle.
- Remove contamination including dirt and corrosion before removal, installation, disassembly or assembly.
- Keep the removed parts in order and protect them from dust and dirt.
- All removed parts, if to be reused, should be reinstalled in the original positions with attention to the correct directions, etc.
- Bolts, nuts and washers should be replaced with new parts as required.
- Be sure to tighten the fasteners including bolts and nuts to the specified torque.

### C: PREPARATION TOOL

#### 1. SPECIAL TOOL

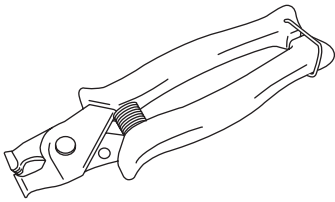
ILLUSTRATION	TOOL NUMBER	DESCRIPTION	REMARKS
 ST18353AA000	18353AA000	CLAMP PLIERS	<ul style="list-style-type: none"><li>• Used for removing and installing the PCV hose assembly.</li><li>• This tool is made by the French company CAILLAU. (code) 54.0.000.205</li></ul> To make it easier to obtain, it has been provided with a tool number.

#### 2. GENERAL TOOL

TOOL NAME	REMARKS
Circuit tester	Used for measuring resistance and voltage.
Mighty Vac	Used for inspection of the two-way valve.