

### 5. Air Intake Duct

#### A: REMOVAL

- 1) Remove the clip which secures air intake duct (rear), and remove the air intake duct (rear).

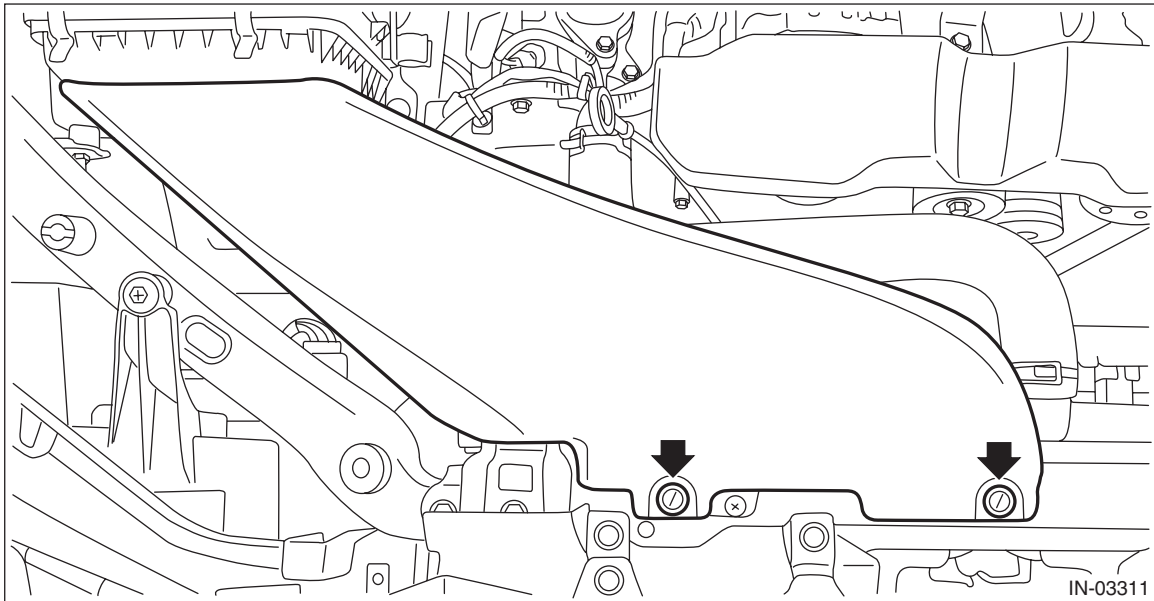

- 2) Remove the clip (A) and four claws and then remove the air intake duct (front).

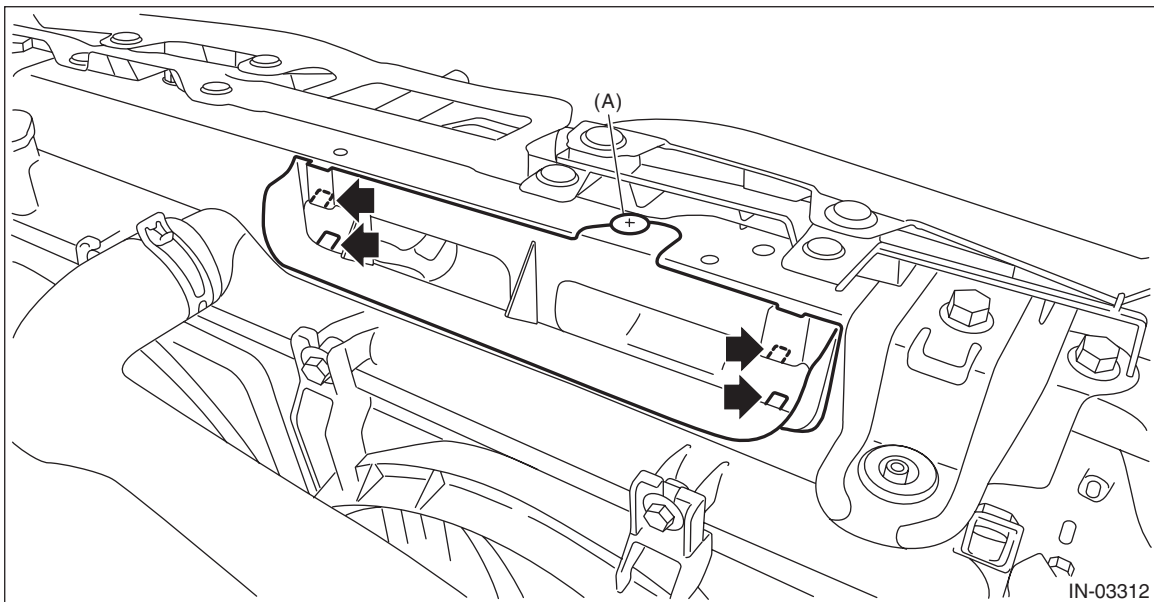

#### B: INSTALLATION

Install in the reverse order of removal.

#### C: INSPECTION

- 1) Check that the air intake duct has no deformation, cracks or other damages.
- 2) Inspect that no foreign objects are mixed in the air intake duct.