

Steering Wheel

POWER ASSISTED SYSTEM (POWER STEERING)

3. Steering Wheel

A: REMOVAL

- 1) Disconnect the negative terminal from the battery, and wait for 60 seconds or more.
- 2) Set the tire to the straight-ahead position.
- 3) Remove the driver's airbag module.

CAUTION:

Before performing service on the airbag module, always refer to “CAUTION” of “General Description” in “AIRBAG SYSTEM” section. <Ref. to AB-9, CAUTION, General Description.>

- (1) Using a hexagon wrench etc. wrapped by protective tape, insert the snap pins and release the locks (3 locations).

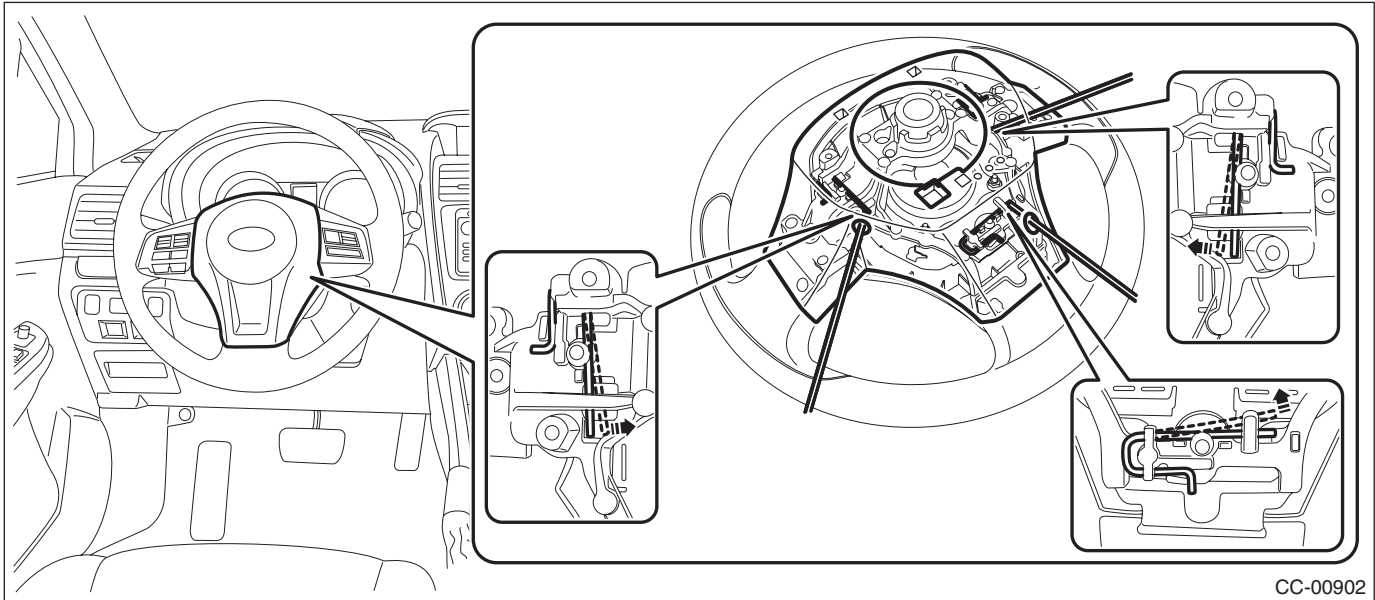

- (2) Disconnect the horn harness and airbag connector, and remove the airbag module. <Ref. to AB-21, DRIVER'S AIRBAG MODULE, KNEE AIRBAG MODULE, CURTAIN AIRBAG MODULE AND PRETENSIONER, PROCEDURE, Airbag Connector.>

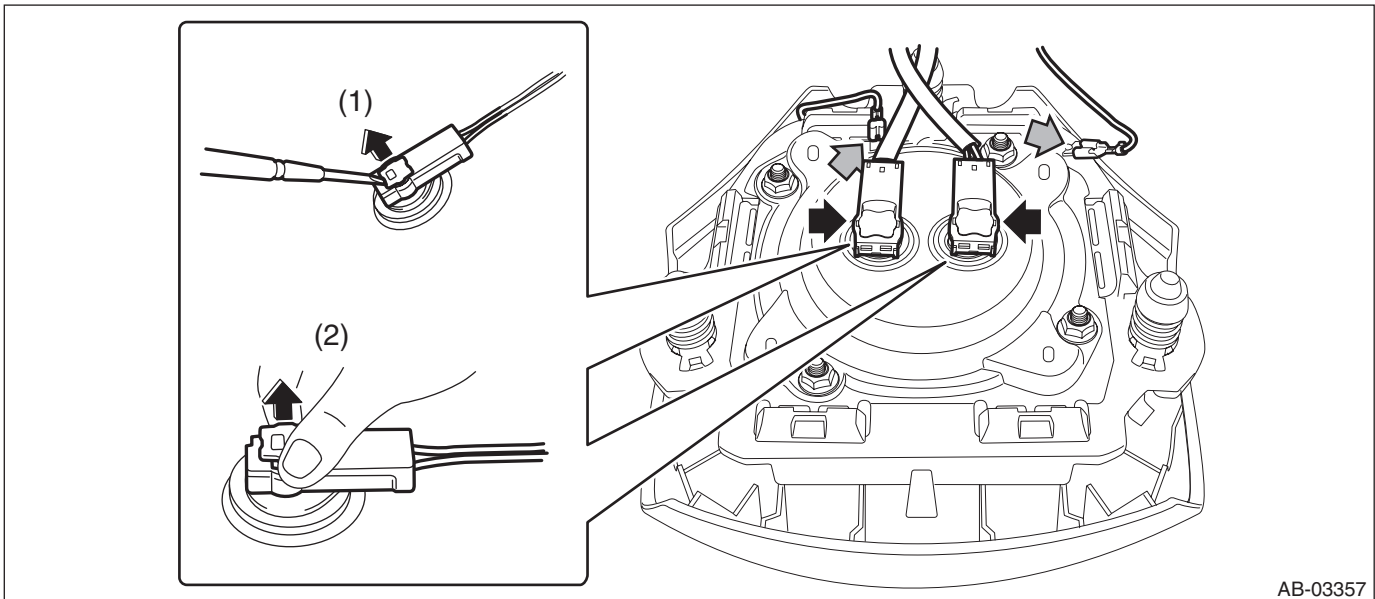

Steering Wheel

POWER ASSISTED SYSTEM (POWER STEERING)

4) Remove the steering wheel.

CAUTION:

- Always use the steering wheel puller for removal to avoid deforming the steering wheel.
- If the steering wheel has been removed, make sure that the steering roll connector is not turned from the original position.

Preparation tool:

Steering wheel puller

- (1) Disconnect the connector and remove the nut.
- (2) Put alignment marks and remove the steering wheel.

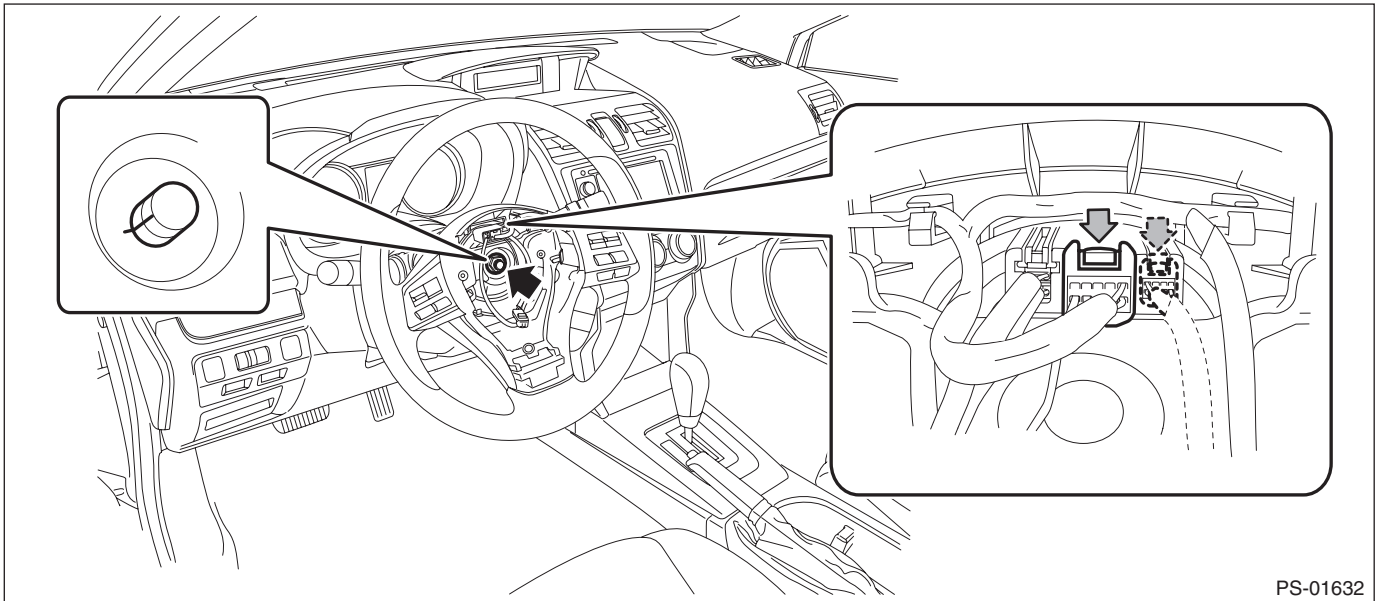

PS-01632

Steering Wheel

POWER ASSISTED SYSTEM (POWER STEERING)

B: INSTALLATION

CAUTION:

- Before handling the airbag module, refer to “CAUTION” of “General Description” in “AIRBAG SYSTEM”. <Ref. to AB-9, CAUTION, General Description.>
 - Be careful not to damage the curtain airbag module during removal.
 - If the steering wheel and steering angle sensor are removed, perform “VDC sensor midpoint setting mode” of the VDC. <Ref. to VDC-23, ADJUSTMENT, VDC Control Module and Hydraulic Control Unit (VDCCM&H/U).>
- 1) Align the center position of the roll connector. <Ref. to AB-103, ADJUSTMENT, Roll Connector.>
 - 2) Install each part in the reverse order of removal.

NOTE:

Align the alignment marks on the steering wheel and the column assembly - steering.

Tightening torque:

Steering wheel: 39 N·m (3.98 kgf-m, 28.8 ft-lb)

Clearance:

Between cover assembly - column and steering wheel: 4 — 6 mm (0.16 — 0.24 in)

C: DISASSEMBLY

- 1) Remove the screw, disconnect the connector and remove the paddle shift switch. (Model with paddle shift)

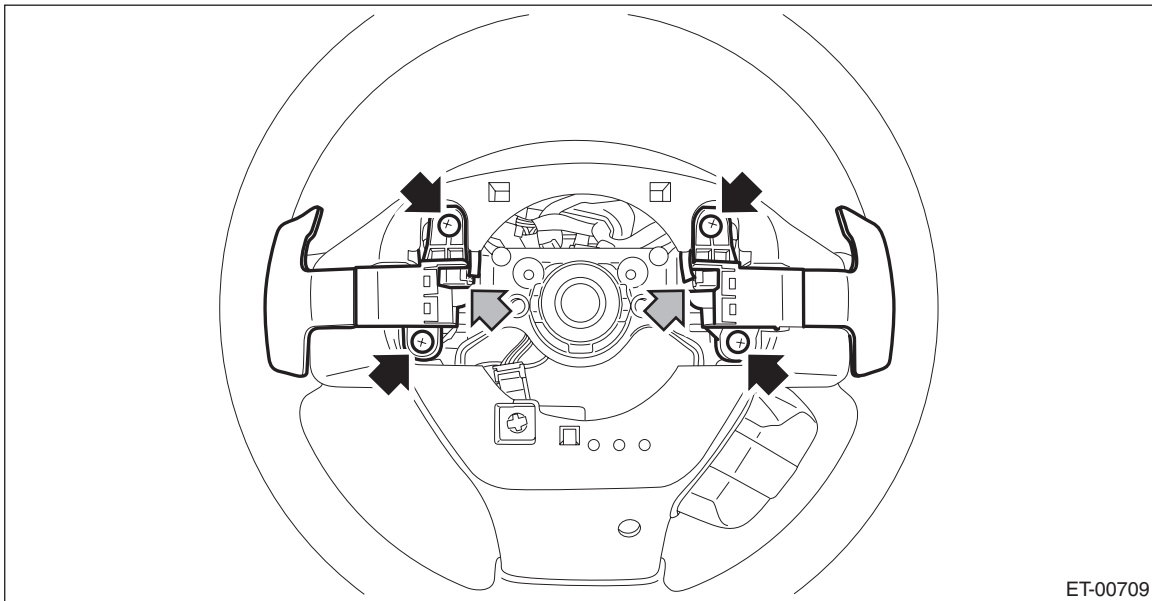

Steering Wheel

POWER ASSISTED SYSTEM (POWER STEERING)

2) Release the claws and clips, and remove the cover - steering wheel LWR.

NOTE:

For model with steering switch, remove the connector and screw.

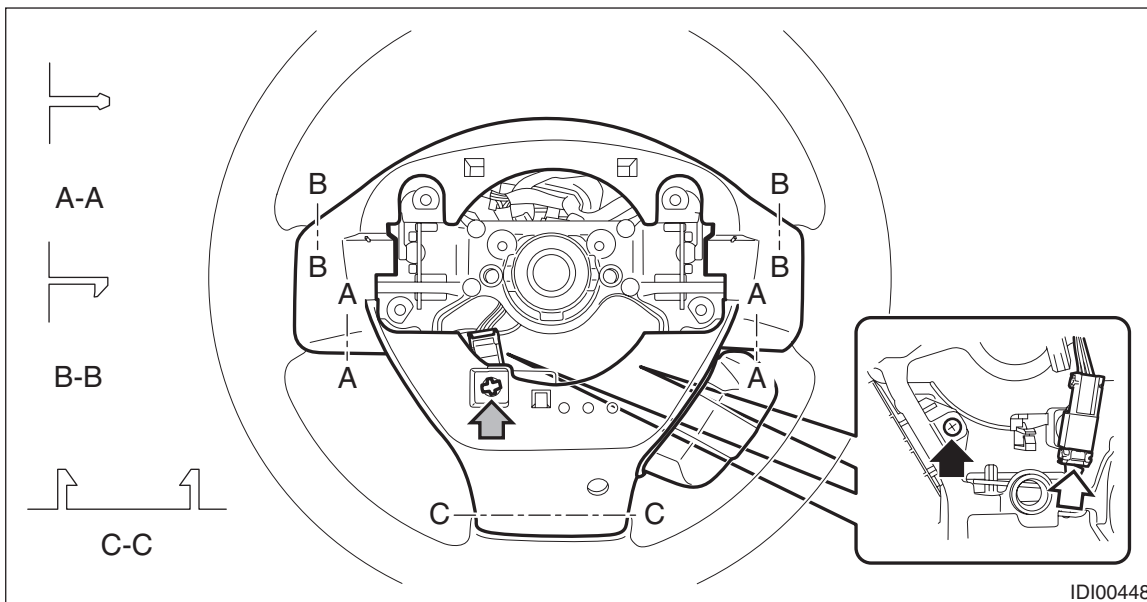

3) Remove the screws and then remove the satellite switch assembly.

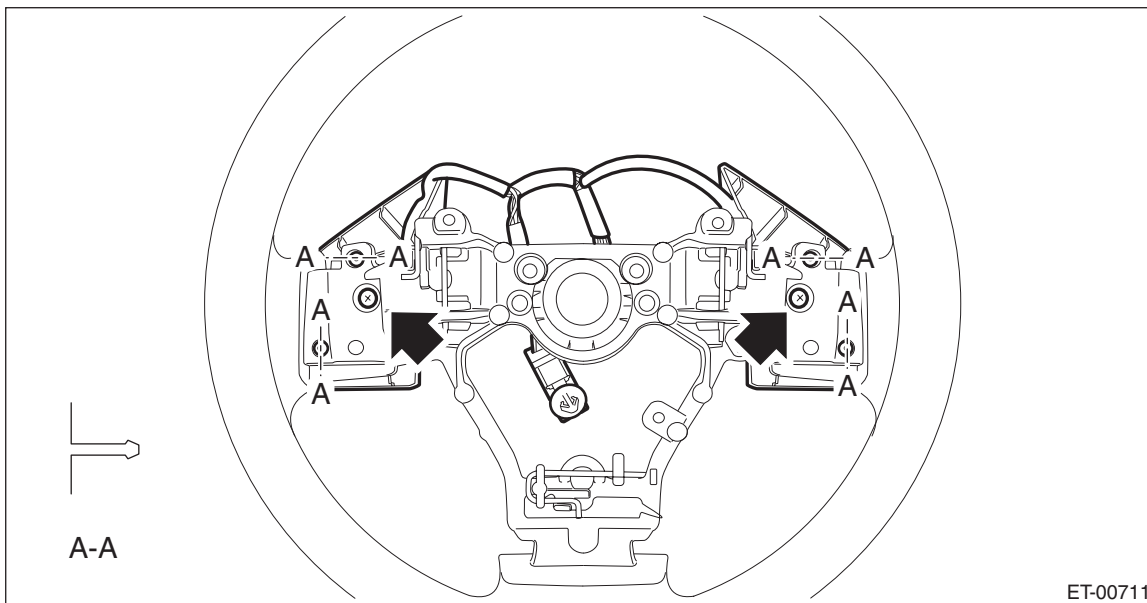

D: ASSEMBLY

Assemble each part in the reverse order of disassembly.

Steering Wheel

POWER ASSISTED SYSTEM (POWER STEERING)

E: INSPECTION

Check the resistance of paddle switch.

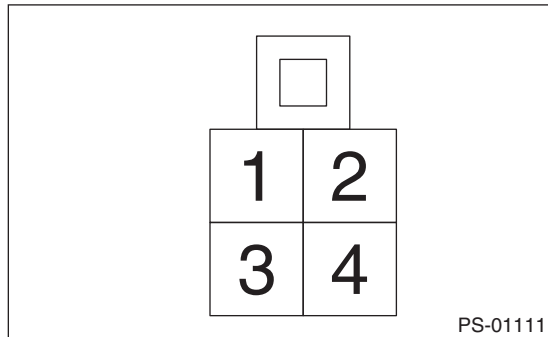

Step	Check	Yes	No
1 SHIFT-UP SWITCH CONTINUITY CHECK. 1) Operate the + side of paddle shift assembly and hold it. 2) Measure the resistance between terminals of the paddle shift assembly connector. Terminals No. 4 — No. 3:	Is the resistance less than 10 Ω ?	Go to step 2.	Replace the paddle shift assembly.
2 SHIFT-DOWN SWITCH CONTINUITY CHECK. 1) Operate the – side of paddle shift assembly and hold it. 2) Measure the resistance between terminals of the paddle shift assembly connector. Terminals No. 4 — No. 1:	Is the resistance less than 10 Ω ?	Go to step 3.	Replace the paddle shift assembly.
3 CHECK SHIFT SWITCH INSULATION. 1) Do not operate the paddle shift assembly. 2) Measure the resistance between terminals of the paddle shift assembly connector. Terminals No. 4 — No. 3: No. 4 — No. 1:	Is the resistance 1 M Ω or more?	Paddle shift assembly is normal.	Replace the paddle shift assembly.

Replace the paddle switch if the inspection result is not within the standard value.