

### 9. Front Washer Nozzle

#### A: REMOVAL

- 1) Open the hood COMPL - front.
- 2) Disconnect the ground cable from battery.
- 3) Remove the arm assembly - windshield wiper.
  - (1) Remove the cover - windshield wiper arm.
  - (2) Remove the nuts, and remove the arm assembly - windshield wiper.

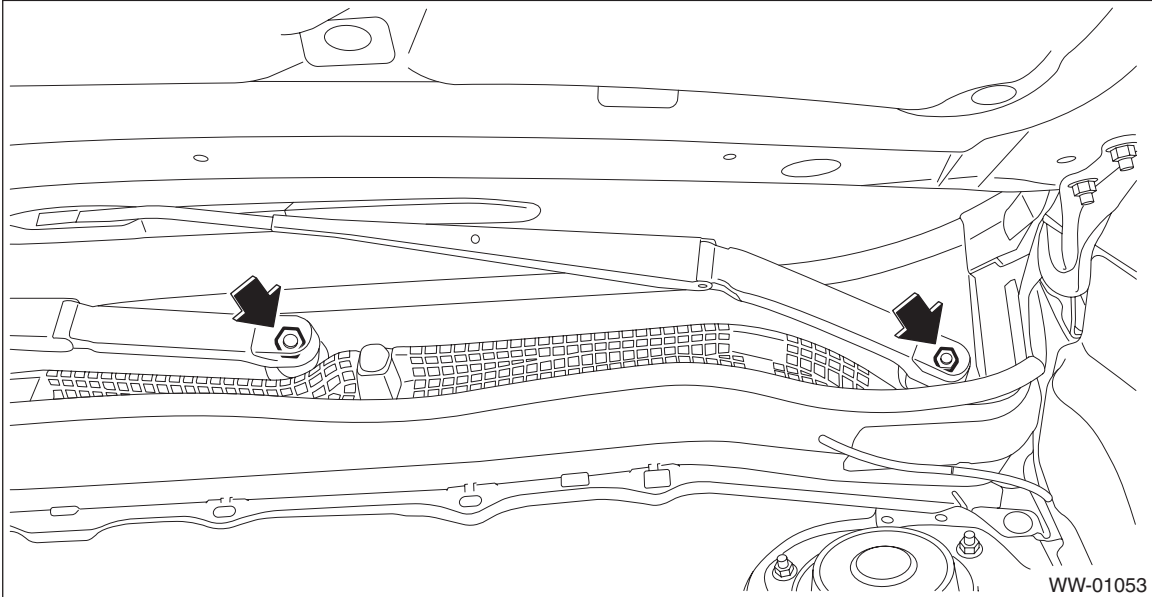

- 4) Remove the cowl panel - side.
  - (1) Remove the clips.
  - (2) Release the claws from (1) to (3) in sequence, and then remove the cowl panel - side.

#### CAUTION:

**Pulling with excessive force may damage the cowl panel - side. If it is difficult to remove, use a plastic remover or equivalent tool.**

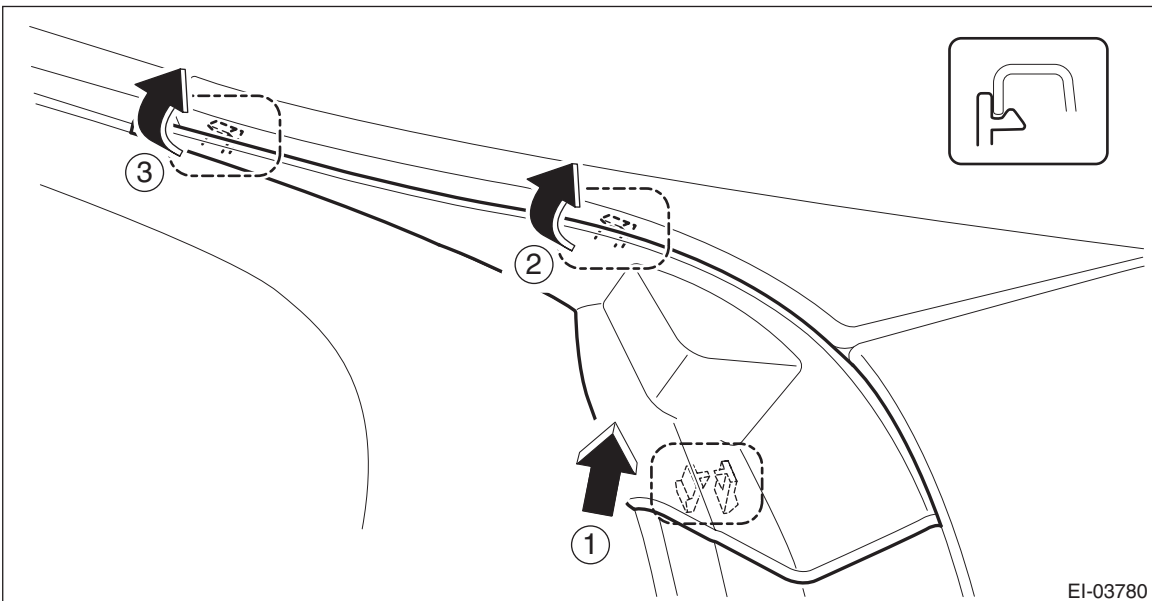

5) Remove the cowl panel assembly.

**CAUTION:**

**Before removing the cowl panel, use an air blower and nylon brush to sweep gravel from the lower area of the front side of the glass.**

- (1) Disconnect the hose - windshield washer.
- (2) Remove clips (A).
- (3) Check the direction of the clip (B), and push the claws from both sides to remove it.

**CAUTION:**

**When removing the clip (B), push the claw of the clip from both sides.**

**Be careful because the clips (B) can be damaged if you pull unnecessarily hard on them.**

- (4) Remove the cowl panel assembly by pulling it out towards the front of the vehicle.

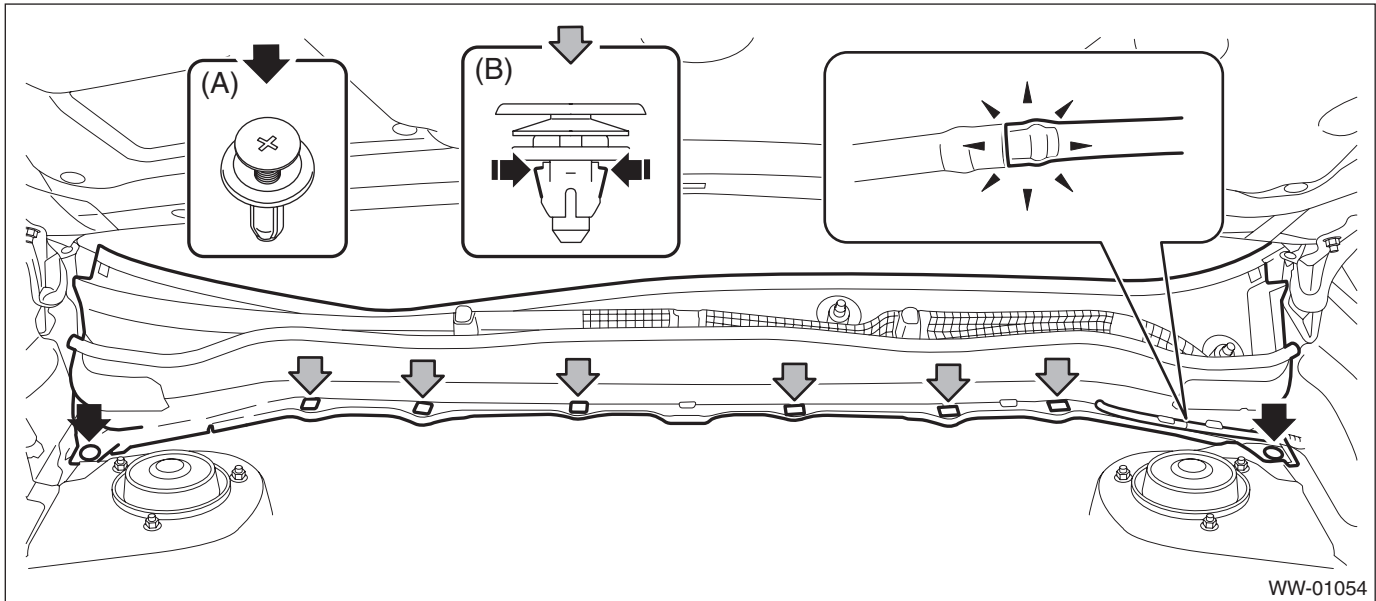

6) Disconnect the hose - windshield washer.

- Models without EyeSight

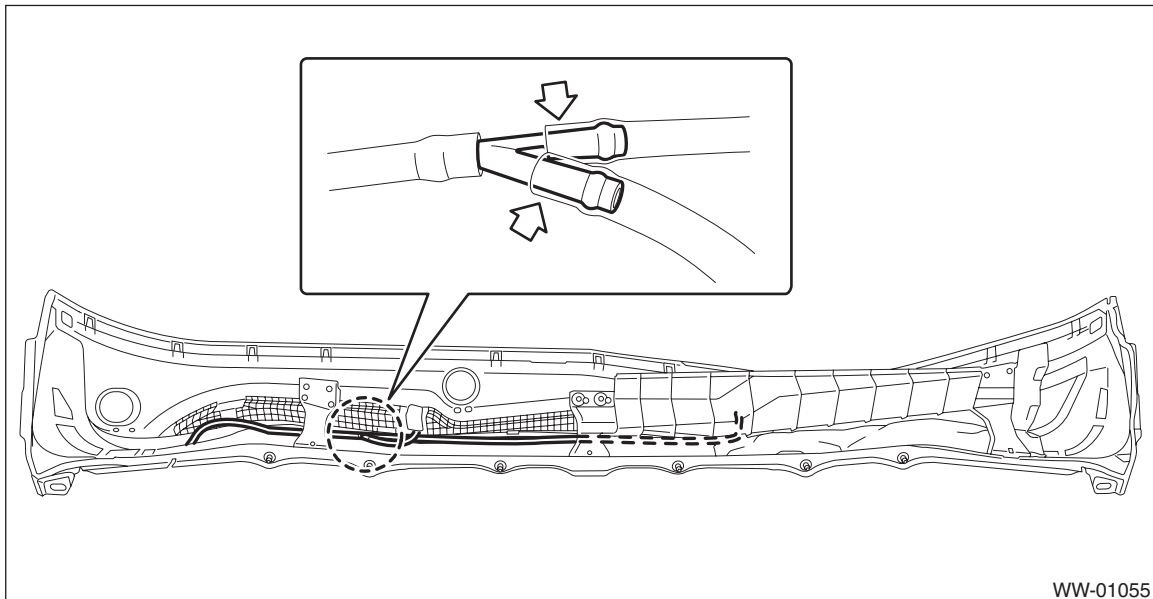

## Front Washer Nozzle

### WIPER AND WASHER SYSTEMS

- Models with EyeSight

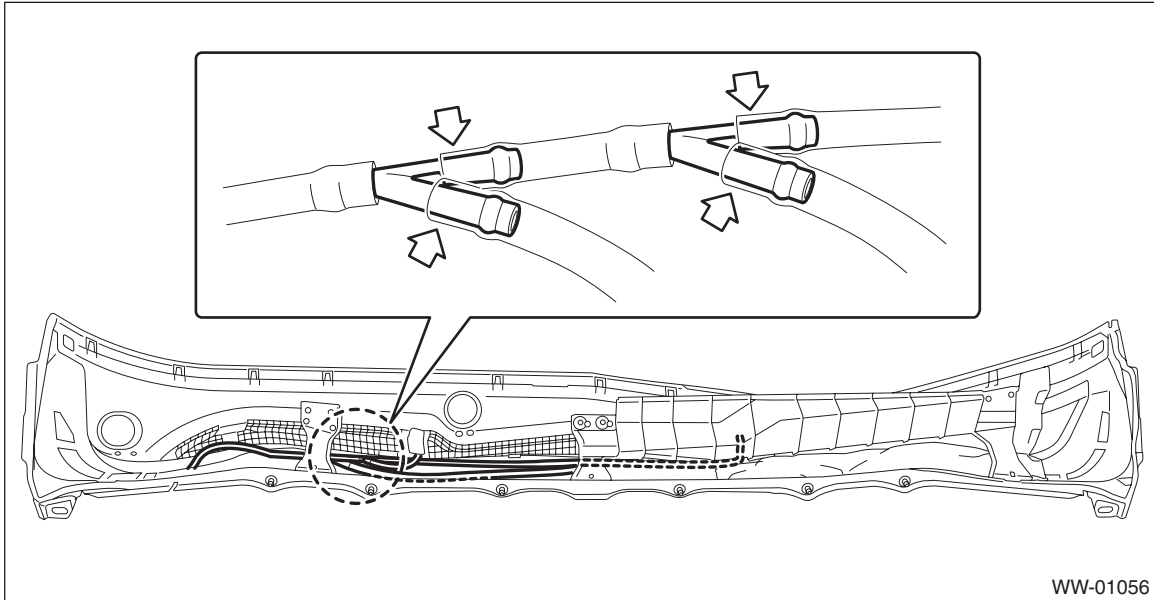

7) Remove the nozzle - windshield washer.

- (1) Push the claw using a flat tip screwdriver, etc.
- (2) When the nozzle - windshield washer lifts up, pull out the nozzle - windshield washer using a clip remover, etc.
- (3) Disconnect the hose - windshield washer, and remove the nozzle - windshield washer.

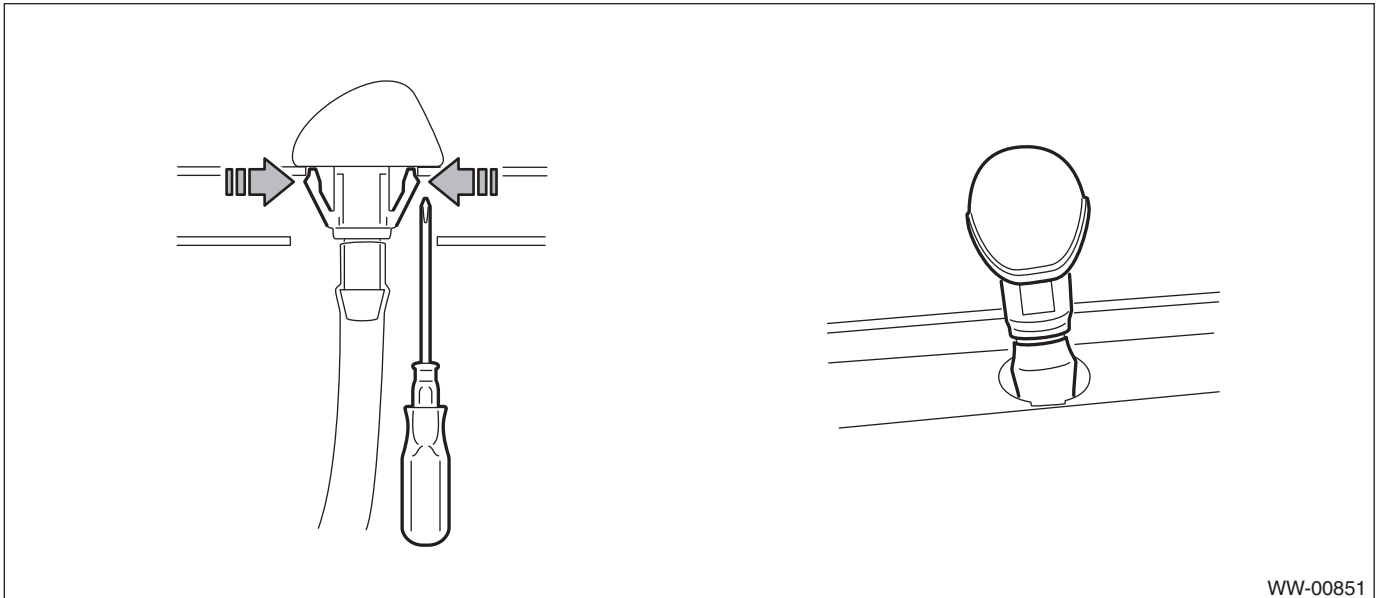

## B: INSTALLATION

1) Install each part in the reverse order of removal.

### CAUTION:

- If the cowl panel assembly cannot be installed properly, do not hit or set it forcibly. The claws of the cowl panel or the windshield glass may be damaged.
- Before installing the windshield glass and cowl panel, make sure there are no gravel in the installing area.

### Tightening torque:

Refer to “COMPONENT” of “General Description”. <Ref. to WW-3, FRONT WIPER, COMPONENT, General Description.>

2) Adjust the position of the nozzle - windshield washer. <Ref. to WW-37, ADJUSTMENT, Front Washer Nozzle.>

## C: INSPECTION

- Make sure the nozzle - windshield washer and the hose - windshield washer are not clogged.
- Make sure the hose - windshield washer is not bent.

## D: ADJUSTMENT

### 1. NOZZLE - WINDSHIELD WASHER

- 1) Turn the wiper switch to OFF position.
- 2) While the vehicle is at a standstill, insert the washer nozzle adjustment tool (a) into upper side (b) and lower side (c) of the nozzle - windshield washer to perform necessary adjustment.

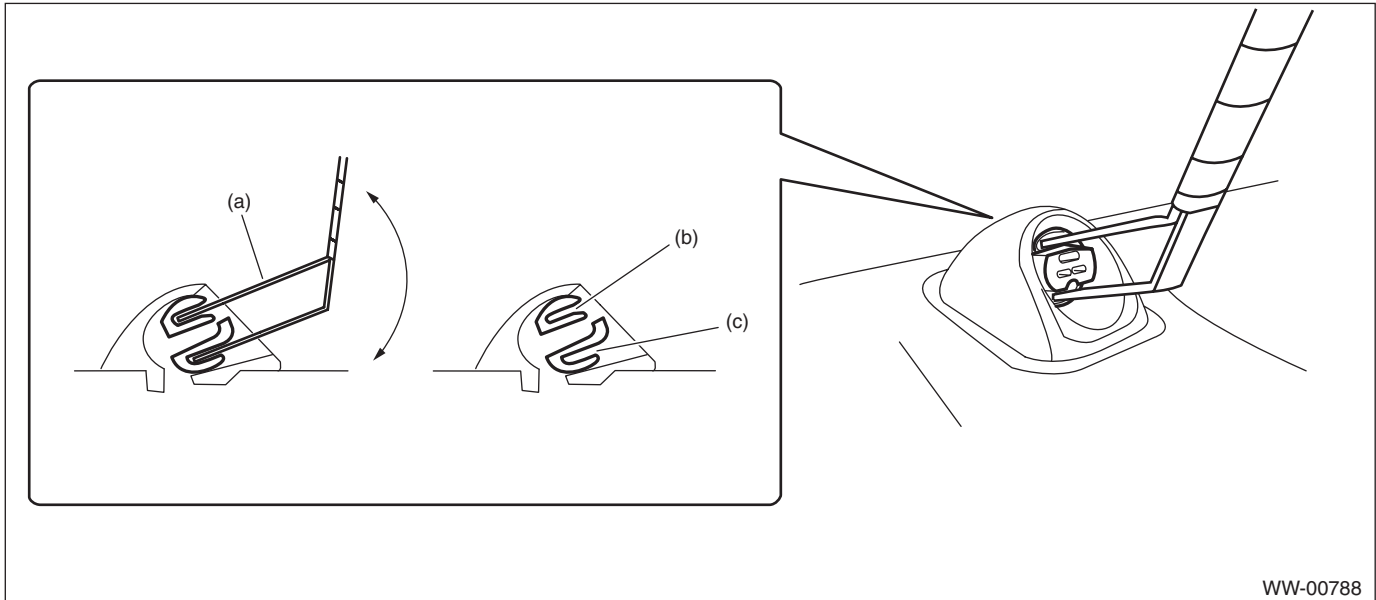

### CAUTION:

Washer nozzle is made of resin. If precision screwdriver (A) or equivalent is inserted into discharge port for adjustment, the discharge port can be deformed, and washer fluid cannot be sprayed.

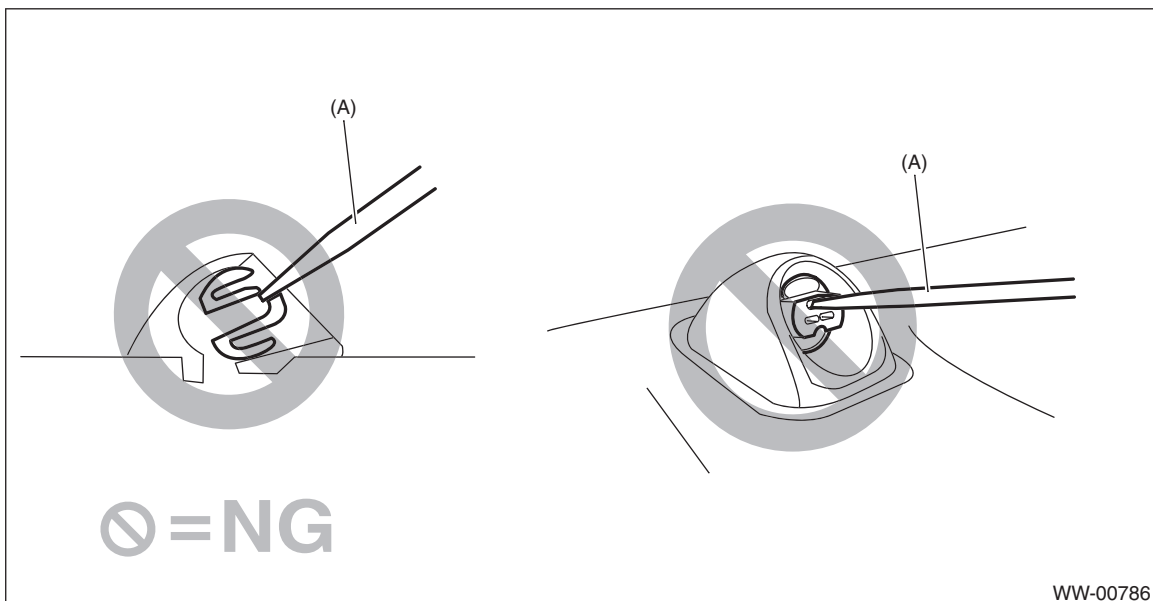

## Front Washer Nozzle

### WIPER AND WASHER SYSTEMS

3) Adjust the washer injection position as shown in the figure.

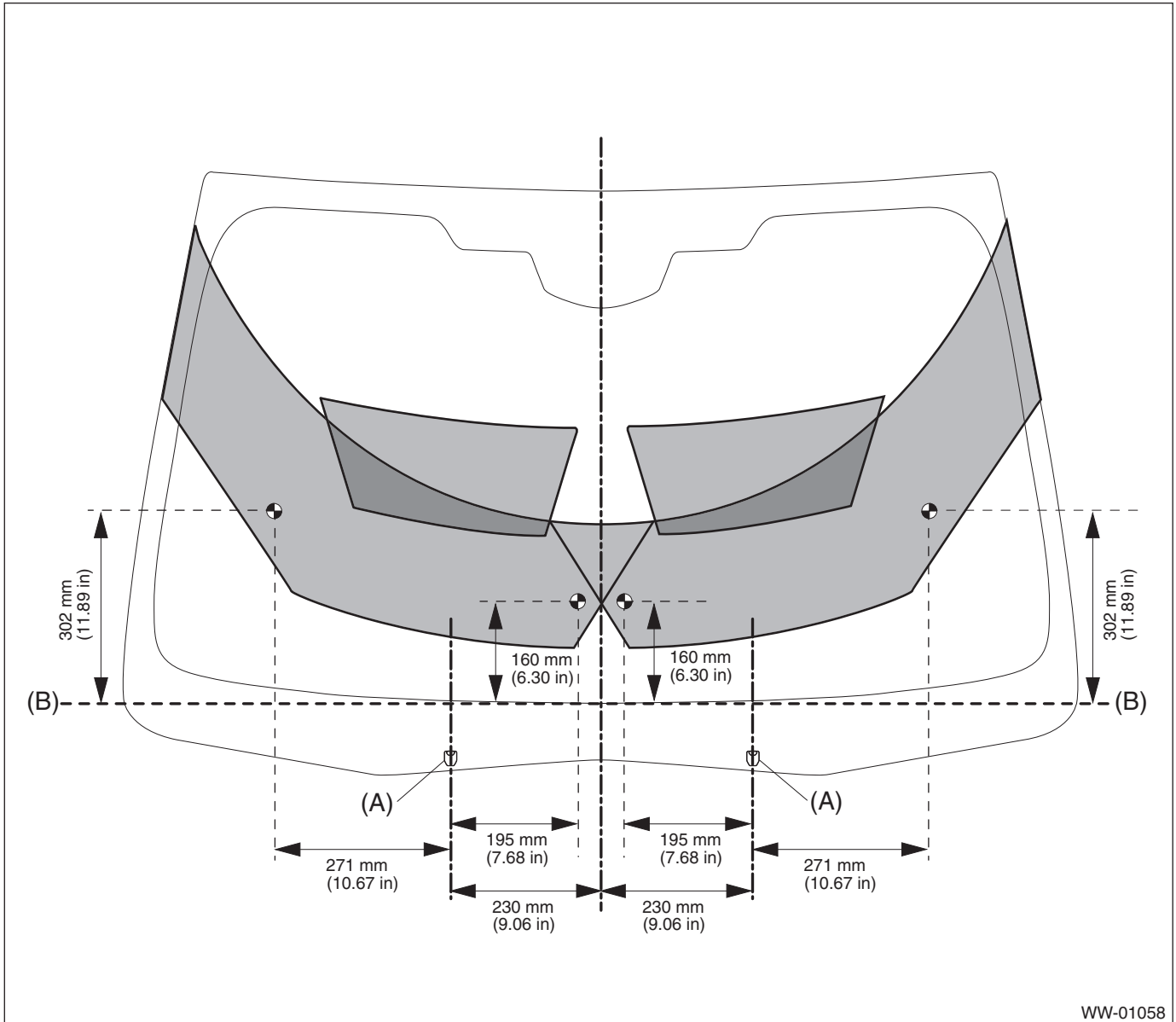

(A) Nozzle - windshield washer

(B) Ceramic line

## 2. NOZZLE - WINDSHIELD WASHER EyeSight (MODEL WITH EyeSight ONLY)

- 1) Turn the wiper switch to OFF position.
- 2) Adjust the washer injection position as shown in the figure.

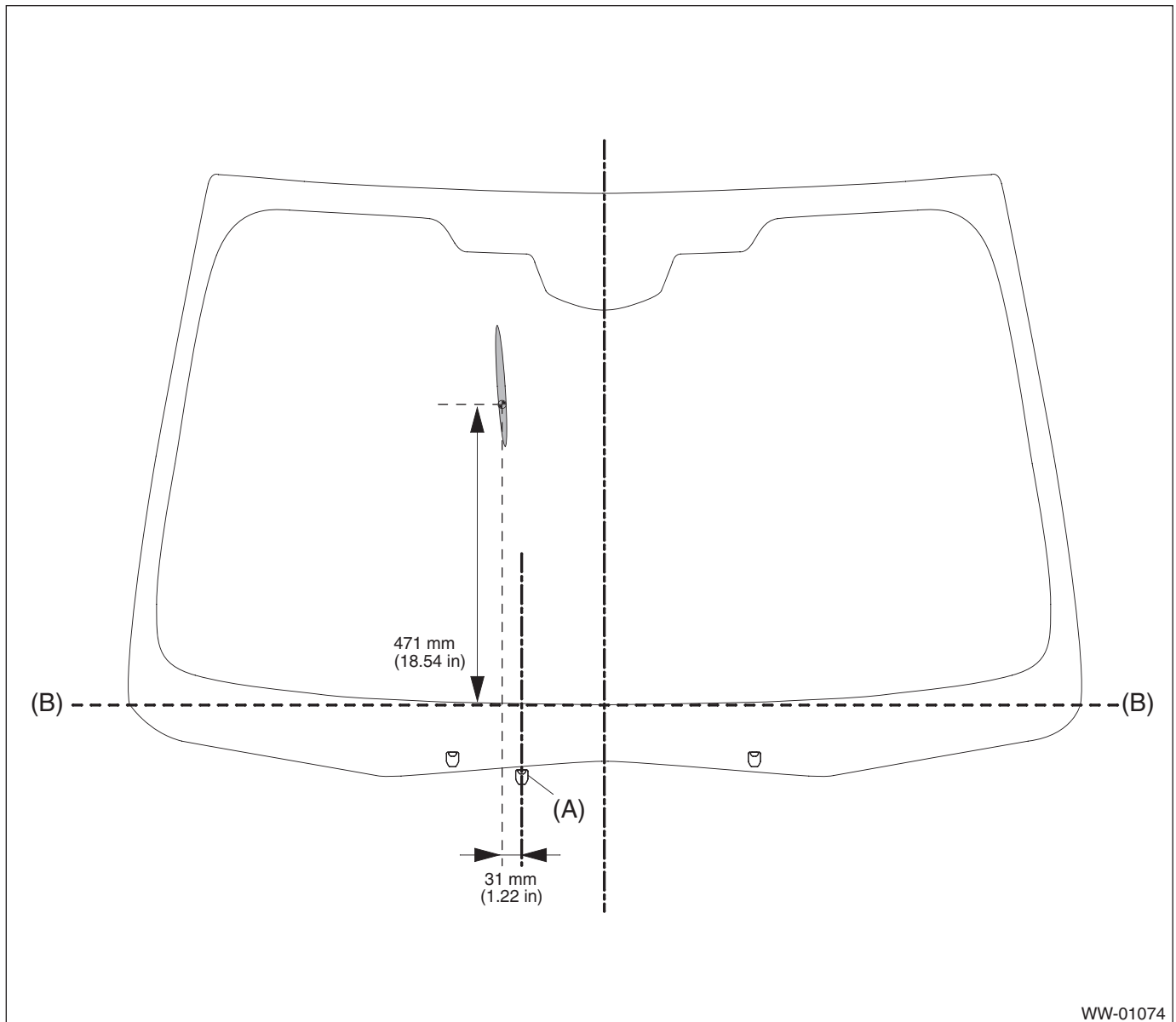

WW-01074

- (A) Nozzle - windshield washer Eye-Sight      (B) Ceramic line