

## 28. Immobilizer Antenna

### A: REMOVAL

#### 1. MODELS WITHOUT KEYLESS ACCESS

- 1) Disconnect the ground cable from battery.
- 2) Remove the cover assembly - column.
- (1) Remove the screws by turning the steering wheel to right and left.

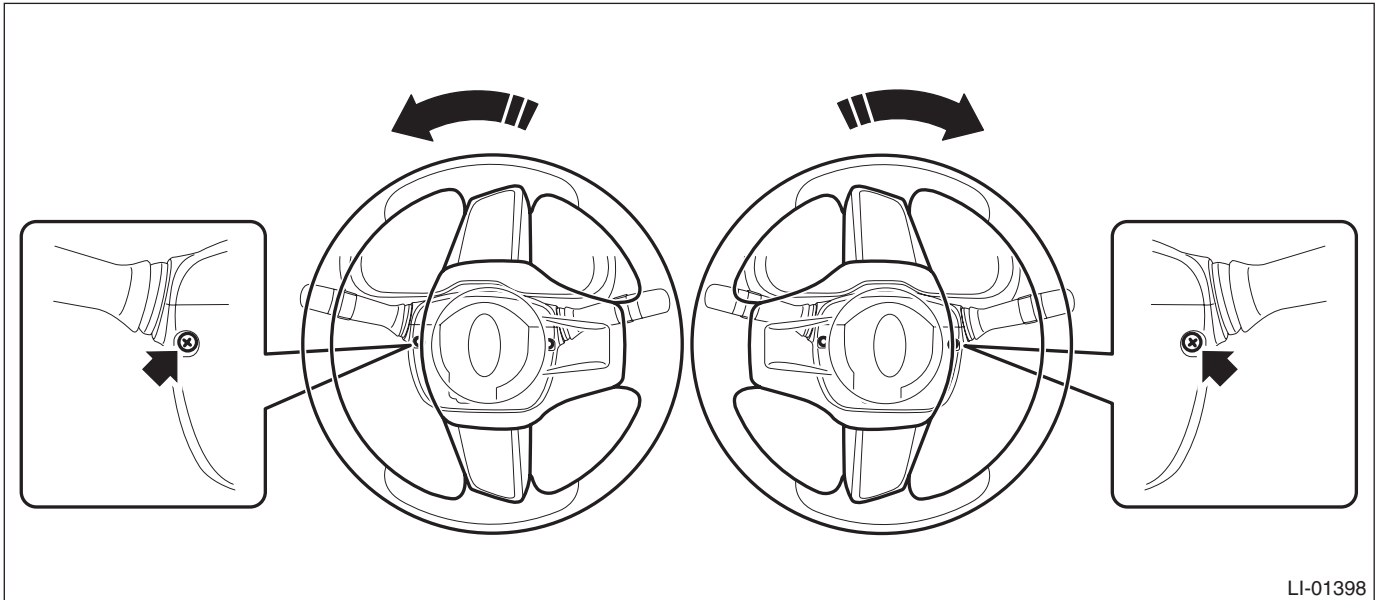

- (2) Release the claw, and remove the cover assembly - column UPR and the cover assembly - column LWR.

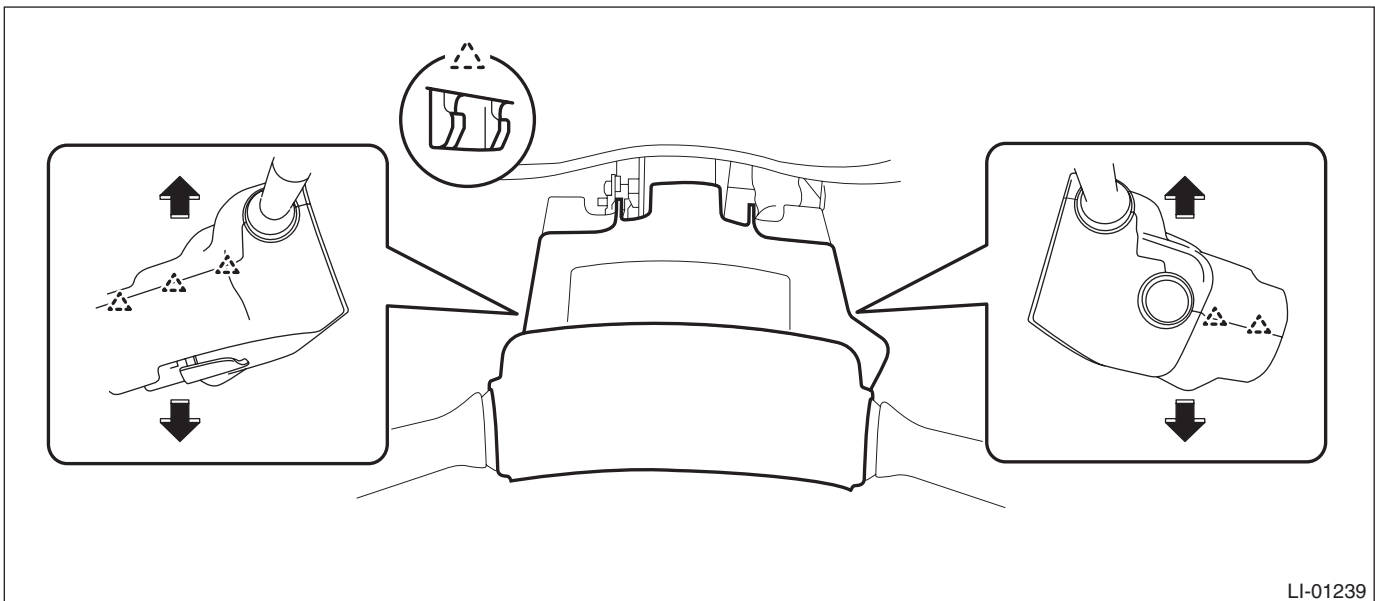

## Immobilizer Antenna

### SECURITY AND LOCKS

3) Disconnect the connector and remove the immobilizer antenna assembly.

#### CAUTION:

**Do not apply excessive force to remove the immobilizer antenna lock. Otherwise they may be broken because those parts are the products made of a plastic.**

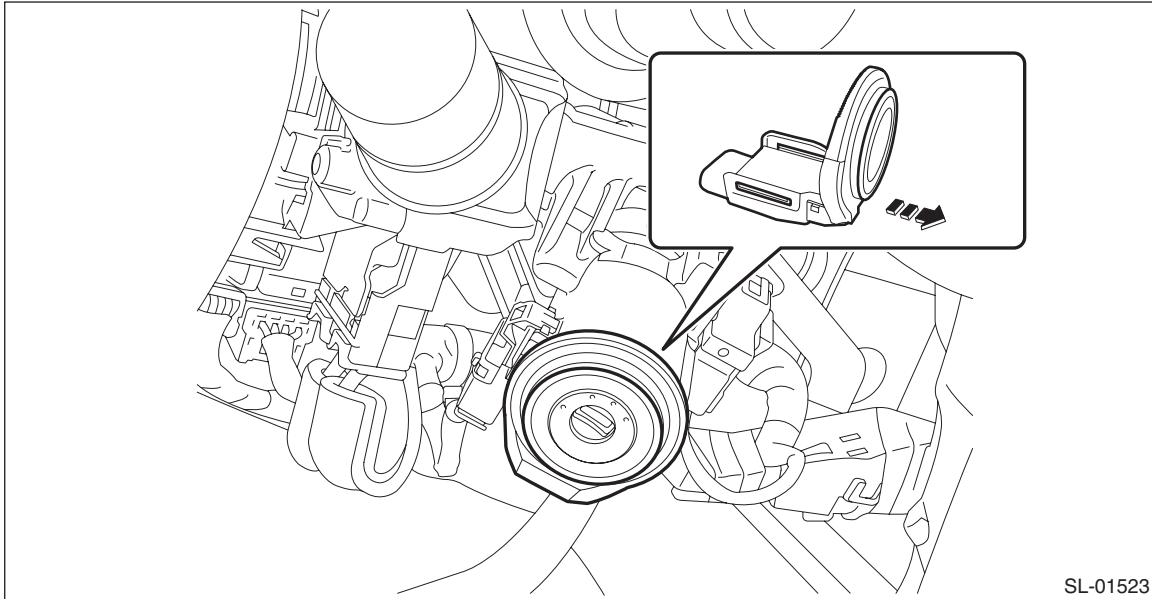

## 2. MODELS WITH KEYLESS ACCESS

#### NOTE:

Immobilizer antenna is integrated with the push button ignition switch.

1) Remove the cover assembly - instrument panel LWR driver. <Ref. to EI-59, REMOVAL, Instrument Panel Lower Cover.>

2) Remove the push button ignition switch.

(1) Disconnect the connector, and remove the aspirator hose.

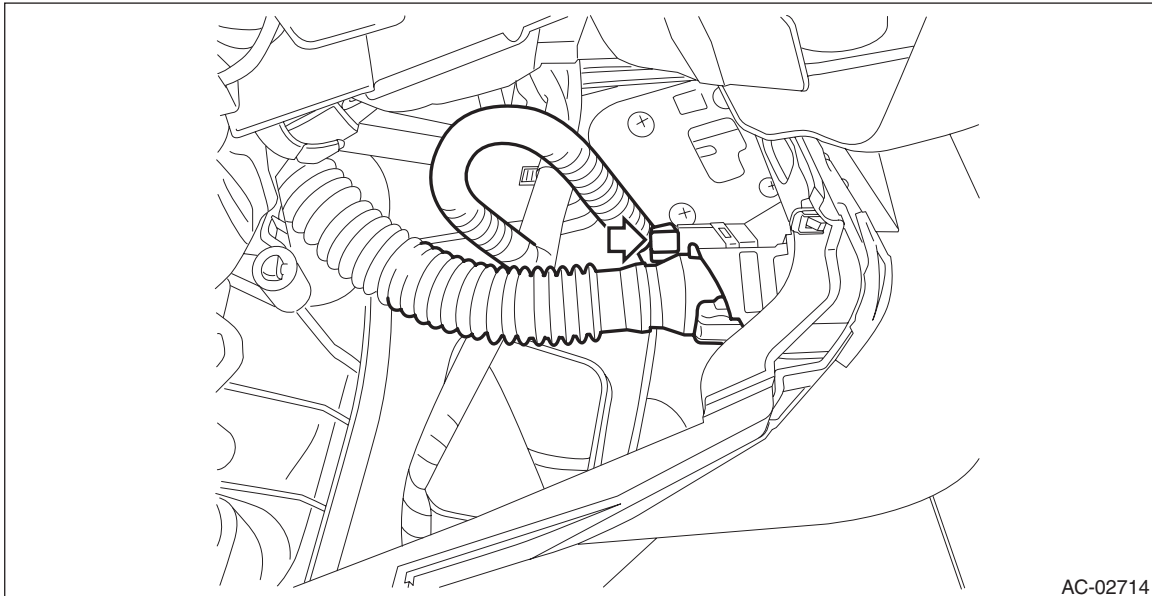

(2) Release the claws, and then remove the panel - switch.

- (3) Release the claws, and then remove the push button ignition switch from the panel - switch.

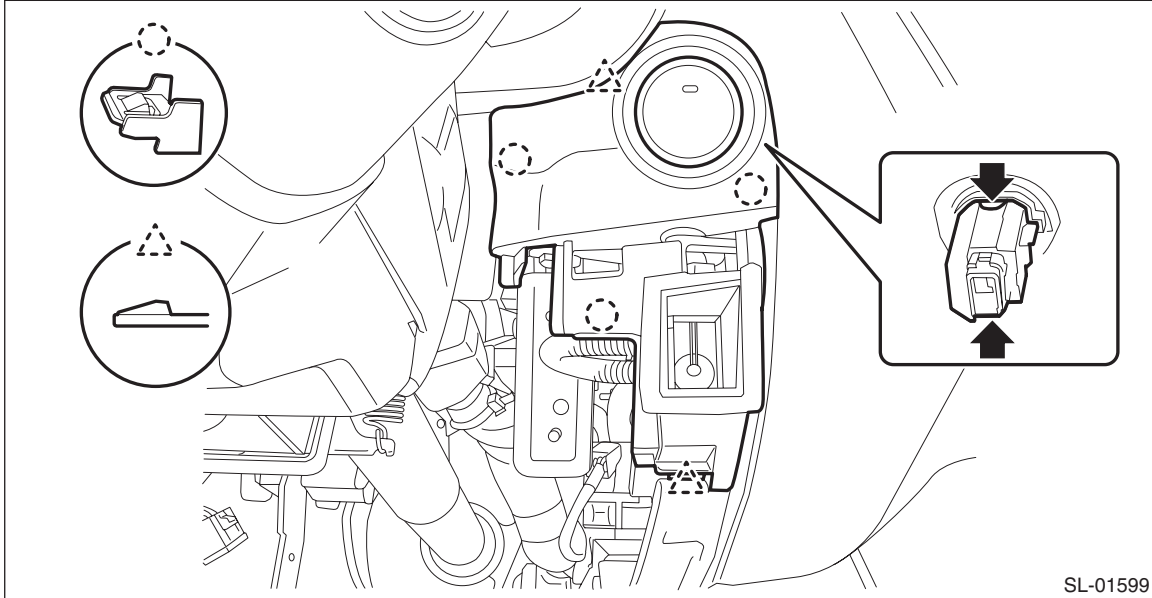

## B: INSTALLATION

Install each part in the reverse order of removal.

### NOTE:

For model with keyless access, refer to "INSTALLATION" of "Instrument Panel Lower Cover". <Ref. to EI-60, INSTALLATION, Instrument Panel Lower Cover.>