

5. Power Rear Gate Drive Unit

A: REMOVAL

1) Disconnect the ground cable from battery.

2) Remove the rod - power rear gate.

(1) Disconnect the upper part of the rod - power rear gate from the rear gate.

CAUTION:

Using a small flat tip screwdriver wrapped with protective tape, remove the part by gradually applying force. Forcibly removing the part may deform the stop ring.

1. Press the rod against the ball stud bolt.

2. With the rod pressed, remove the stop ring while sliding along the ball housing groove.

3. Disconnect the rod from ball stud bolt.

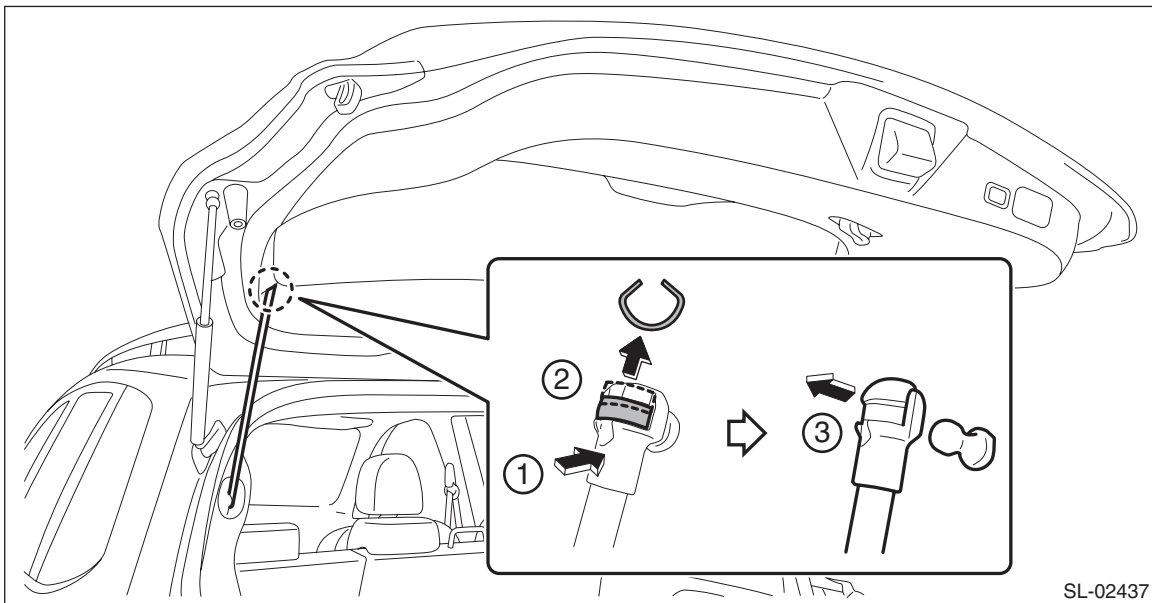

(2) Release the claws and then remove the cap - rear quarter pillar UPR.

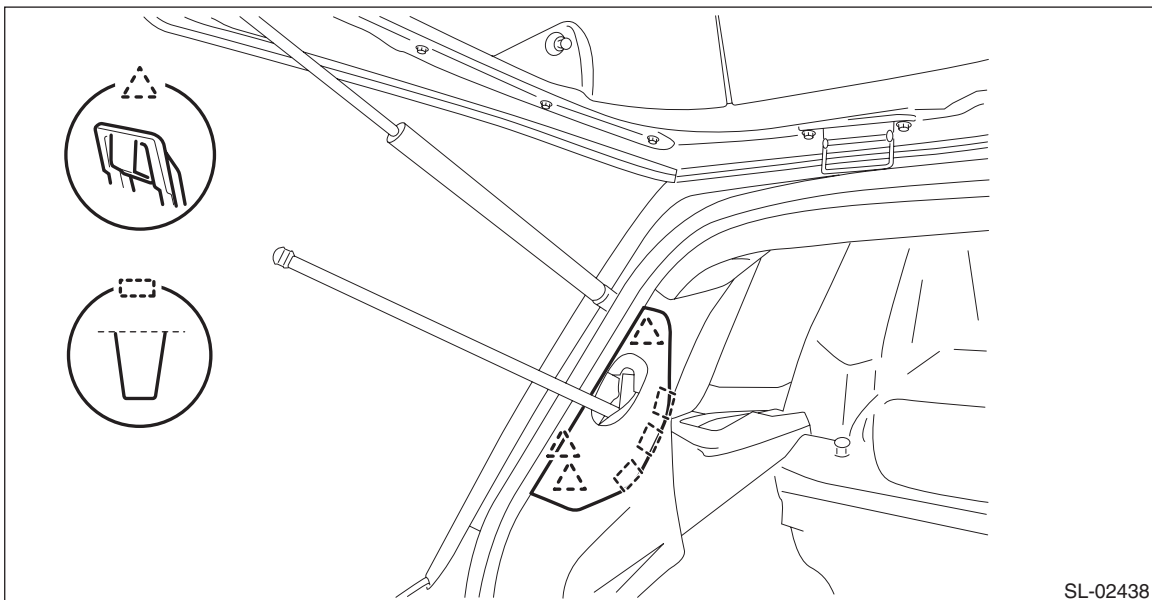

(3) Disconnect the lower part of the rod - power rear gate from the power rear gate drive unit (PRG D/U), and then remove the rod - power rear gate.

NOTE:

Perform the same procedures as for the upper part of rod - power rear gate.

- 3) Remove the trim panel - rear apron and the trim panel - rear quarter pillar UPR. <Ref. to EI-102, REMOV-AL, Rear Quarter Trim.>
- 4) Remove the power rear gate drive unit (PRG D/U).
 - (1) Release the claws, and disconnect the connector.
 - (2) Remove the bolts, release the claw, and then remove the power rear gate drive unit (PRG D/U).

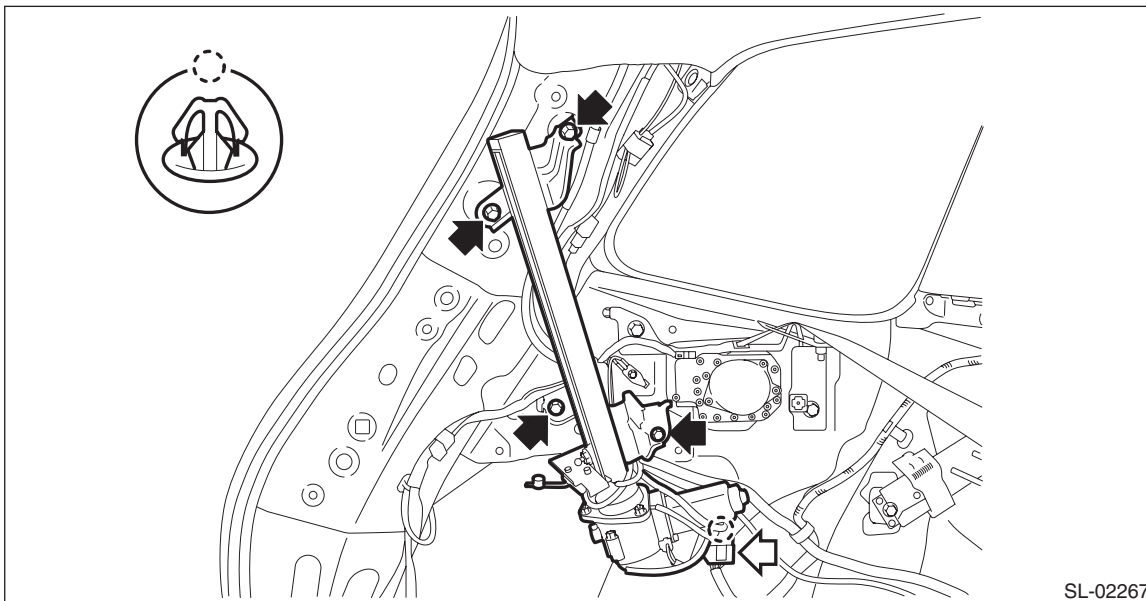

B: INSTALLATION

- 1) Install the stop ring to the rod - power rear gate.

CAUTION:

Align the stop ring to the ball housing groove, and attach the ring by gradually applying force, while paying attention not to deform it.

- 2) With the stop ring installed, check the clearance (a) of the stop ring.

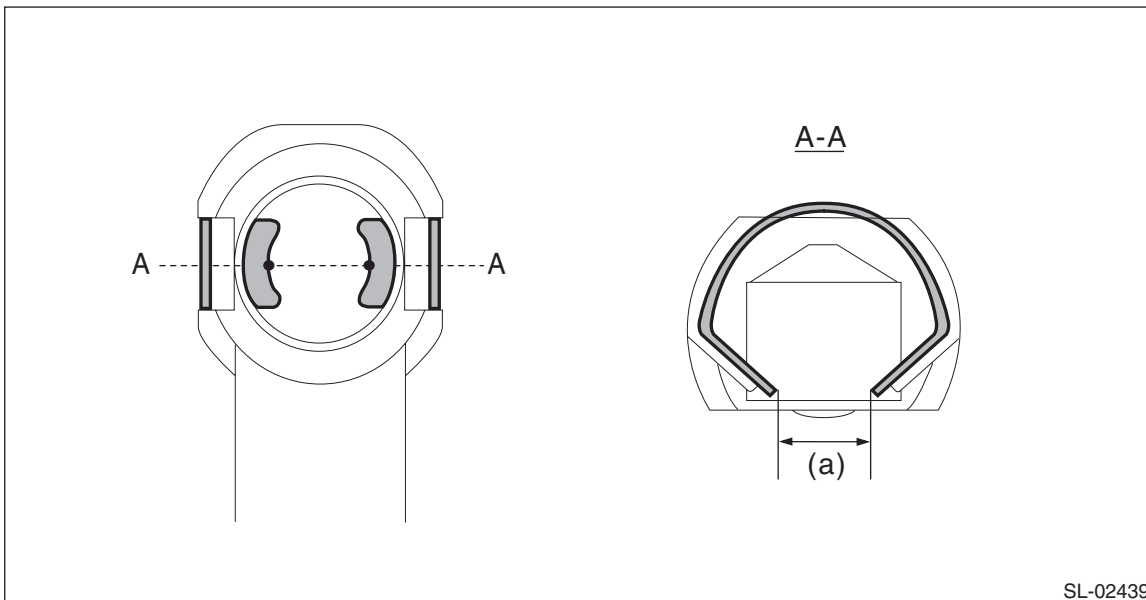

Specification:

6.4 — 7.2 mm (0.25 — 0.28 in)

Replace the stop ring if the inspection result is not within the standard value.

Power Rear Gate Drive Unit

POWER REAR GATE SYSTEM

3) Install each part in the reverse order of removal.

CAUTION:

- After installing the power rear gate drive unit (PRG D/U), check that the temporary stop lock mechanism is unlocked, and then move the ball stud bolt to the top position.
- When installing the rod, check that the stop ring and ball stud bolt are vertically placed, and then slowly press in the rod.

Tightening torque:

Power rear gate drive unit (PRG D/U): 10 N·m (1.02 kgf-m, 7.4 ft-lb)

C: INSPECTION

1. RAIL AND SLIDER

Pull the emergency lever to check that the temporary stop lock mechanism operates properly.

Move the ball stud bolt along the rail to check for play or stuck.

Replace the power rear gate drive unit (PRG D/U), if it is found defective.

2. ACTUATOR

Unit inspection

Preparation tool:

Circuit tester

1) Check motor operation

(1) Move the slider to the center of rail manually.

(2) Check the motor operation when battery voltage is applied between the terminals of motor.

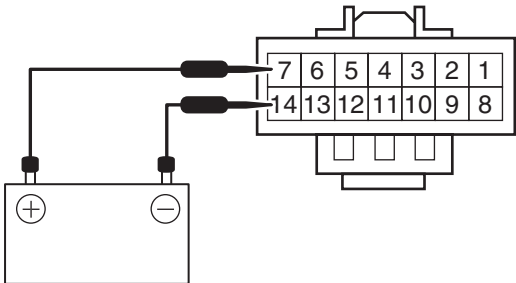
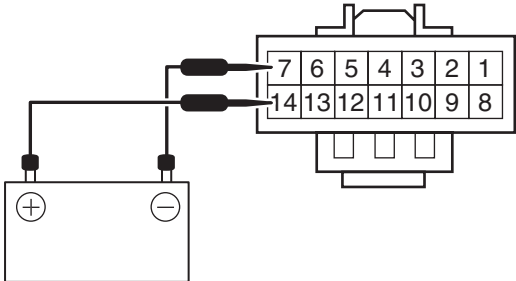
Terminal No.	Inspection conditions	Specification	Connection diagram
7 (+) — 14 (—)	Connect battery to the terminals	OPEN rotation	 <p>SL-02435</p>
14 (+) — 7 (—)		CLOSE rotation	 <p>SL-02436</p>

- 2) Check solenoid
- (1) Measure the resistance between solenoid position switch terminals.
 - (2) Check the solenoid operation when battery voltage is applied between the terminals of solenoid.

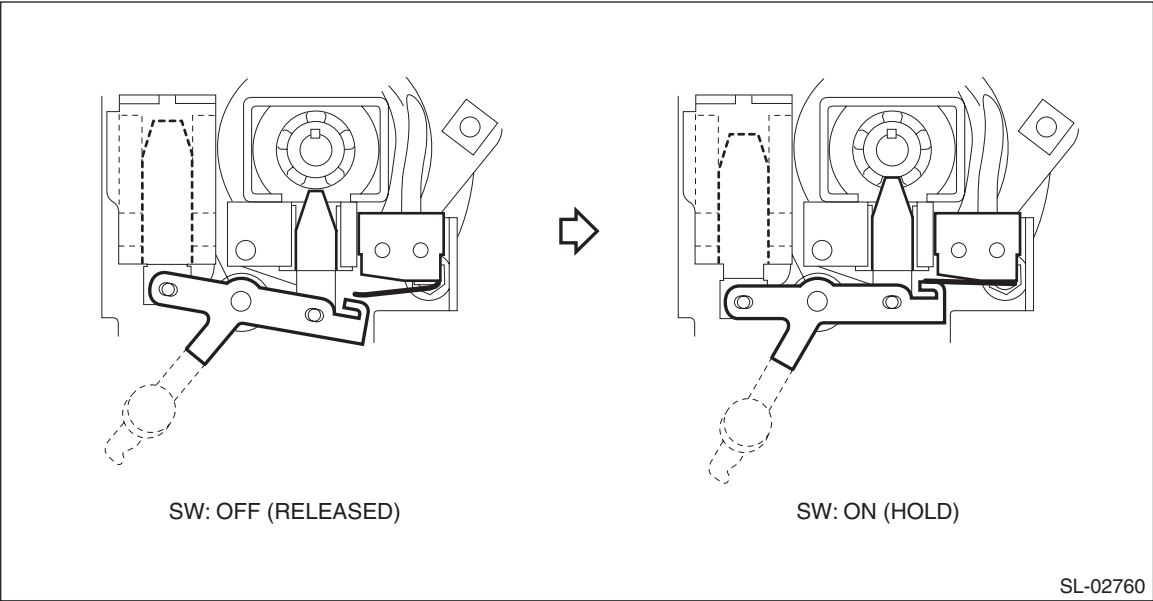

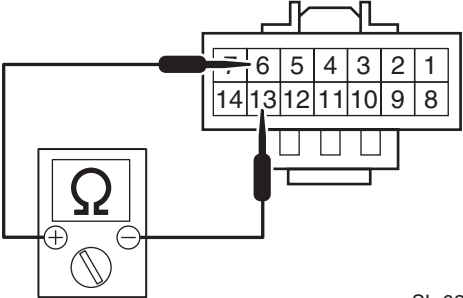
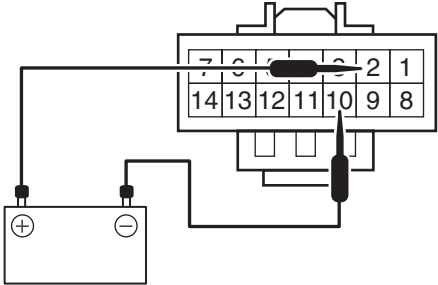
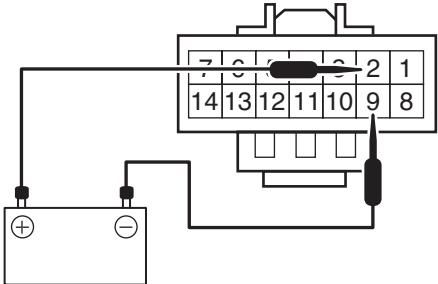
Terminal No.	Inspection conditions	Specification	Connection diagram
6 — 13	Switch OFF	1 MΩ or more	 <p>SL-02761</p>
	Switch ON	Less than 1 Ω	
2 (+) — 10 (-)	Connect battery to the terminals	Released	 <p>SL-02762</p>
2 (+) — 9 (-)		Hold	 <p>SL-02763</p>

Power Rear Gate Drive Unit

POWER REAR GATE SYSTEM

3) Check clutch
Check the clutch operation when battery voltage is applied between the terminals of clutch.

Terminal No.	Inspection conditions	Specification	Connection diagram
1 (+) — 8 (–)	Connect battery to the terminals	Check the operating sound when it is ON.	 SL-02764
8 (+) — 1 (–)			 SL-02765

4) Replace the power rear gate drive unit (PRG DU), if it is found defective.