

12. Combination Switch (Light)

A: REMOVAL

- 1) Position the front wheels straight ahead. (After moving a vehicle 5 m (16 ft) or more with front wheels positioned straight ahead, make sure that the vehicle moves straight ahead.)
- 2) Turn the ignition switch to OFF.
- 3) Disconnect the ground cable from battery and wait for at least 60 seconds before starting work.
- 4) Remove the driver's airbag module.

CAUTION:

Before handling the airbag module, refer to “CAUTION” of “General Description” in “AIRBAG SYSTEM”. <Ref. to AB-9, CAUTION, General Description.>

- (1) Using a hexagon wrench etc. wrapped by protective tape, insert the snap pins and release the locks (3 locations).

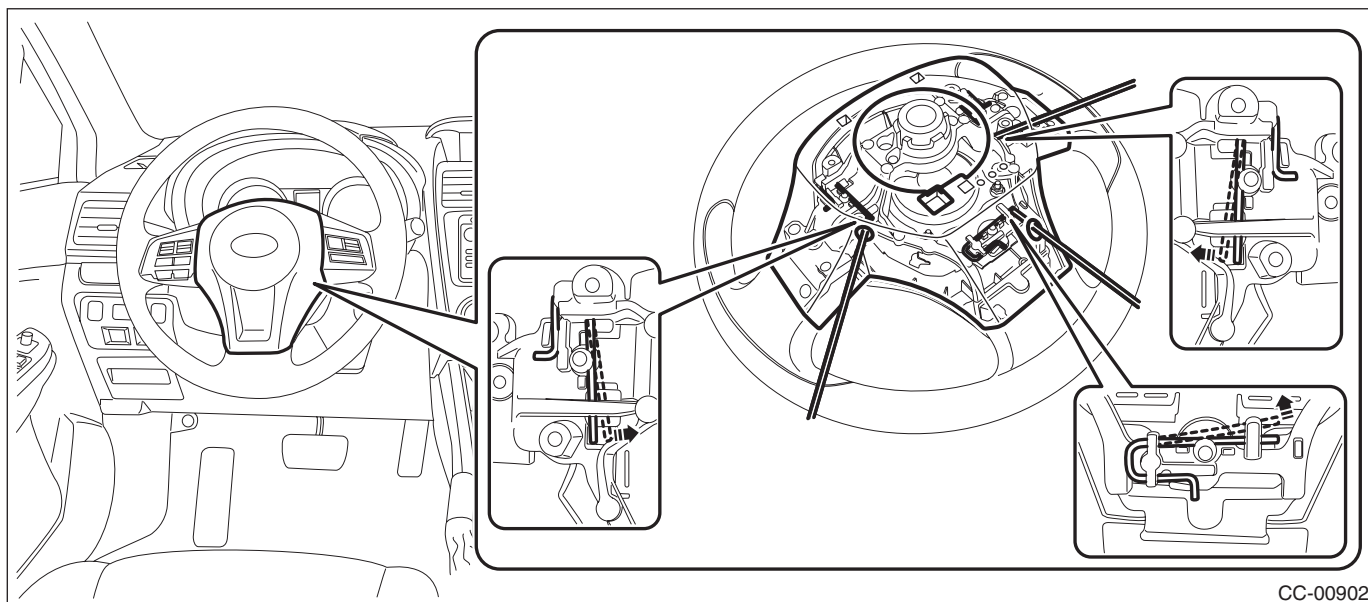

- (2) Disconnect the horn harness and airbag connector, and remove the driver's airbag module. <Ref. to AB-21, DRIVER'S AIRBAG MODULE, KNEE AIRBAG MODULE, CURTAIN AIRBAG MODULE AND PRETENSIONER, PROCEDURE, Airbag Connector.>

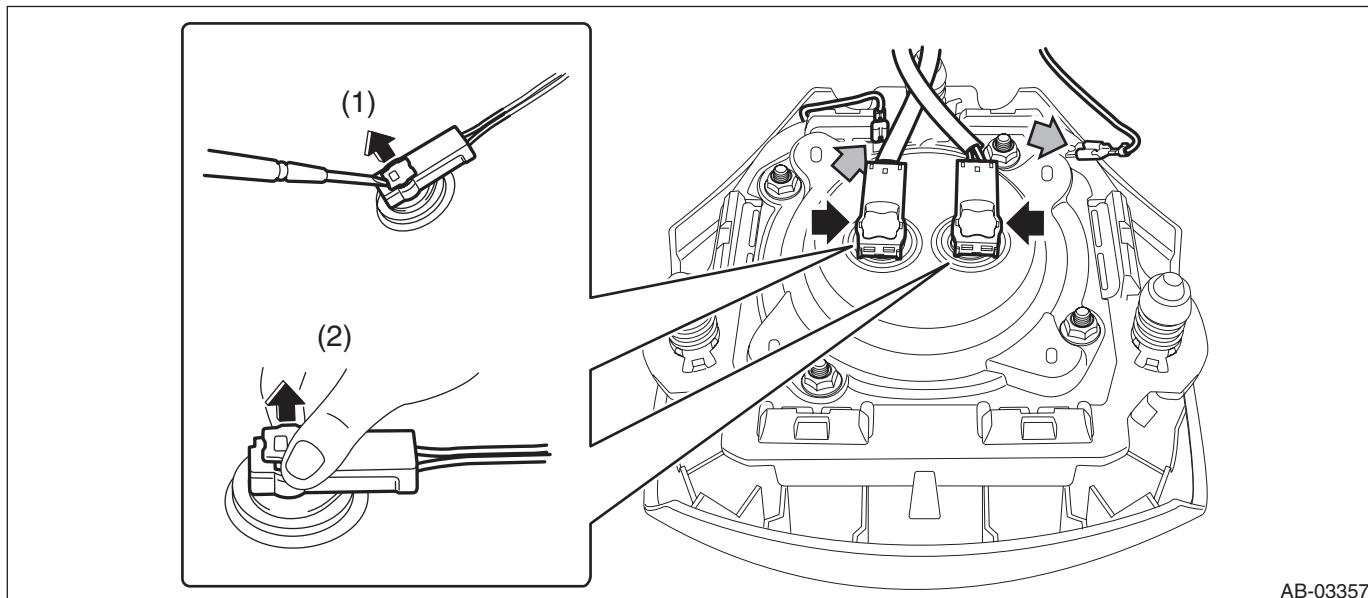

5) Remove the steering wheel.

CAUTION:

- Always use the steering wheel puller for removal to avoid deforming the steering wheel.
- If the steering wheel has been removed, make sure that the steering roll connector is not turned from the original position.

(1) Disconnect the connector and remove the nut.

(2) Put alignment marks and remove the steering wheel using a steering wheel puller.

Preparation tool:

Steering wheel puller

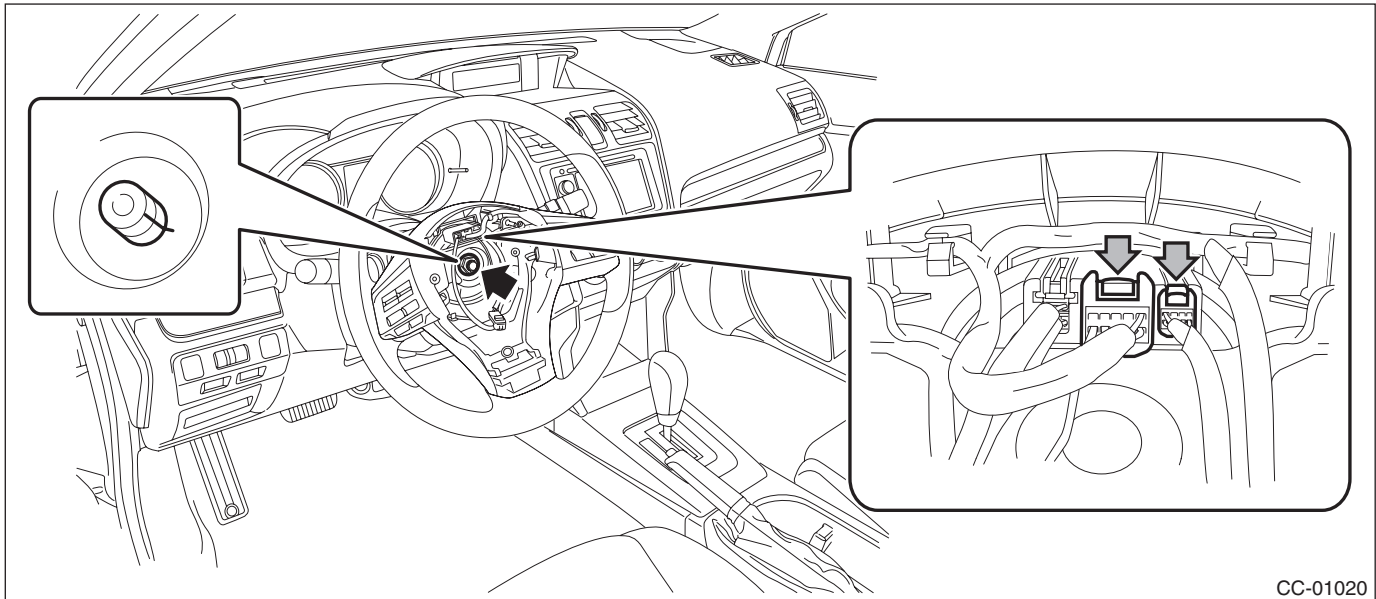

CC-01020

6) Remove the cover assembly - column.

(1) Release the screws and claws.

(2) Remove the cap - key cylinder (a). (Model with keyless access)

(3) Remove the cover assembly - column UPR and the cover assembly - column LWR.

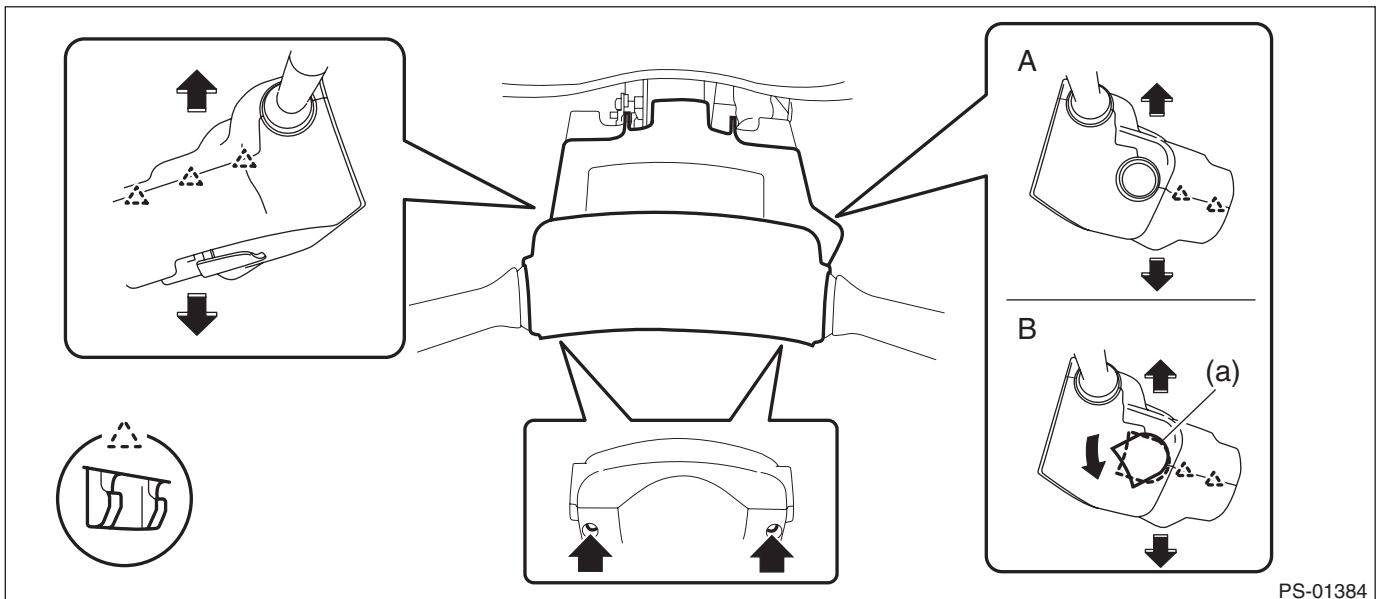

PS-01384

A Models without keyless access

B Models with keyless access

Combination Switch (Light)

LIGHTING SYSTEM

7) Remove the steering roll connector.

CAUTION:

Make sure that the steering roll connector is not turned from the original position.

- (1) Disconnect the connector under the steering roll connector.
- (2) Release the claws and remove the steering roll connector.

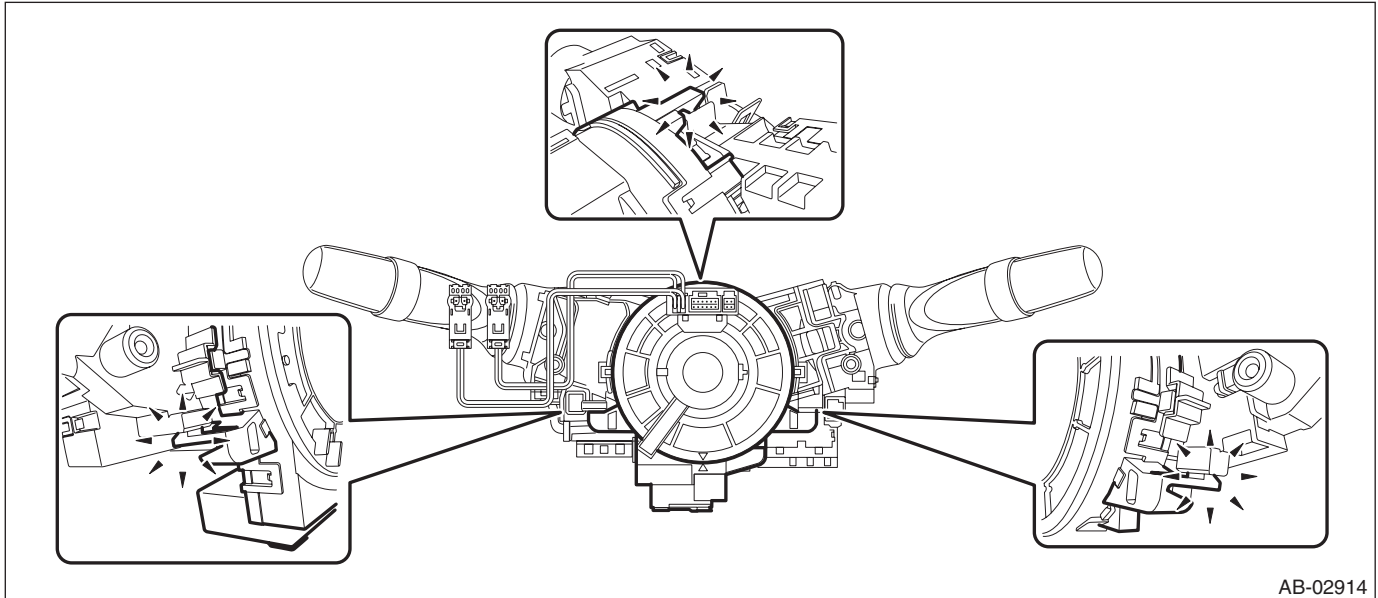

8) Remove the switch assembly - combination wiper select.

- (1) Disconnect the connector.
- (2) Release the claws, and pull out the switch assembly - combination wiper select.

CAUTION:

Do not press the claws with excessive force. They may be damaged.

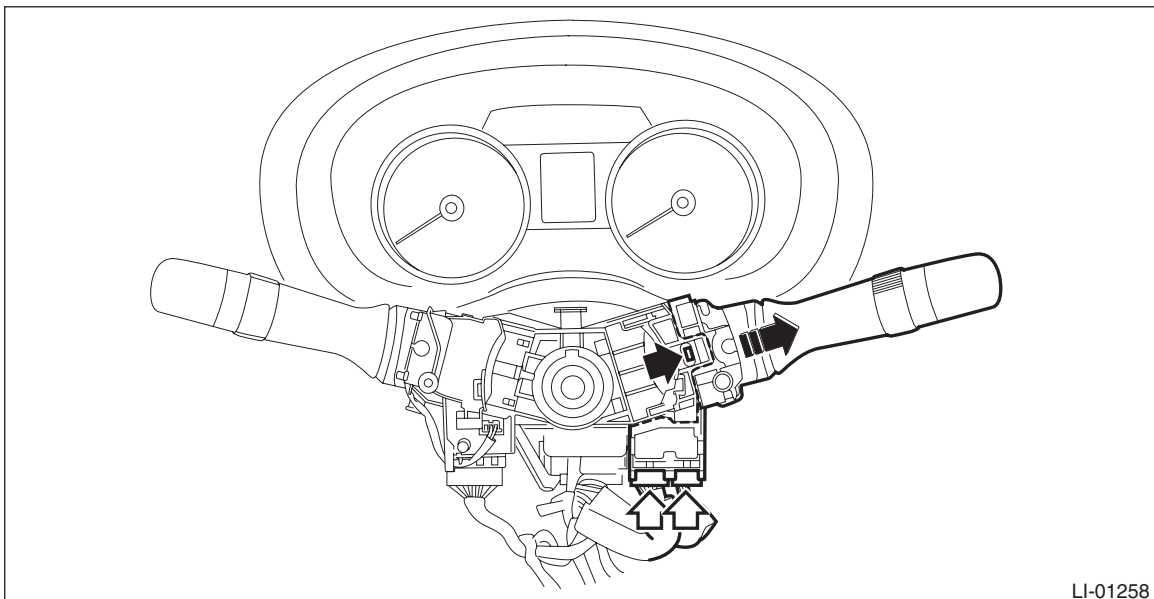

- 9) Remove the switch assembly - combination turn dimmer.
 - (1) Disconnect the connector, and loosen the clamp to release the claws.
 - (2) Pull out the switch assembly - combination turn dimmer from the column assembly - steering.

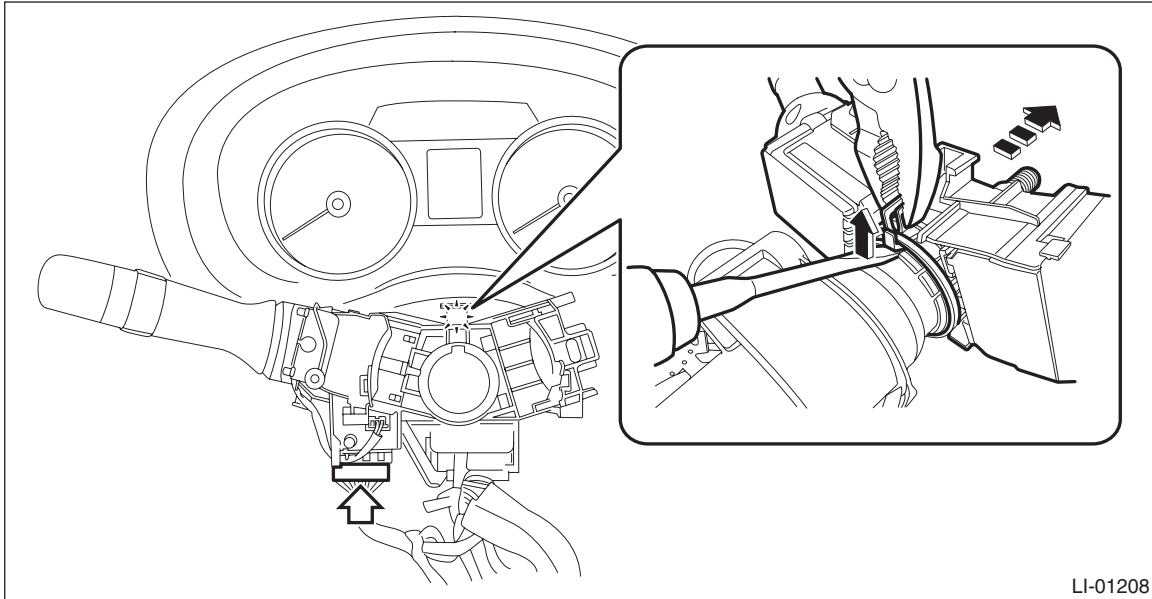

LI-01208

B: INSTALLATION

CAUTION:

- Before handling the airbag module, refer to “CAUTION” of “General Description” in “AIRBAG SYSTEM”. <Ref. to AB-9, CAUTION, General Description.>
- Do not allow harness and connectors to interfere or get tangled up with other parts.
- If the steering wheel and steering angle sensor (steering roll connector) are removed, adjust the steering angle sensor. <Ref. to VDC-23, ADJUSTMENT, VDC Control Module and Hydraulic Control Unit (VDCCM&H/U).>

- 1) Before installing steering wheel, be sure to adjust the direction of steering roll connector with steering wheel. <Ref. to AB-103, ADJUSTMENT, Roll Connector.>
- 2) Install each part in the reverse order of removal.

NOTE:

Align the alignment marks on the steering wheel and the column assembly - steering.

Tightening torque:

Steering wheel: 39 N·m (3.98 kgf-m, 28.8 ft-lb)

Clearance:

Between cover assembly - column and steering wheel: 4 — 6 mm (0.16 — 0.24 in)

Combination Switch (Light)

LIGHTING SYSTEM

C: INSPECTION

Unit inspection

Preparation tool:

Circuit tester

1) Check the resistance between switch terminals.

- Lighting switch

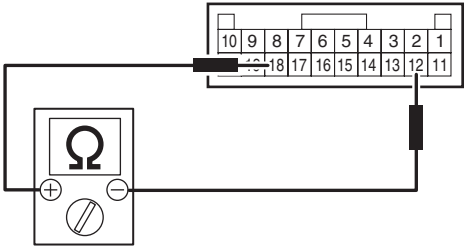
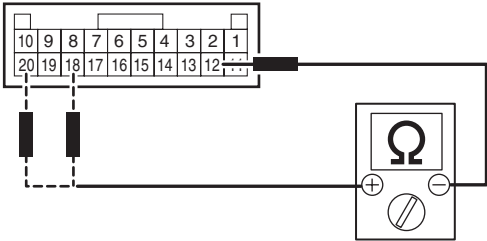
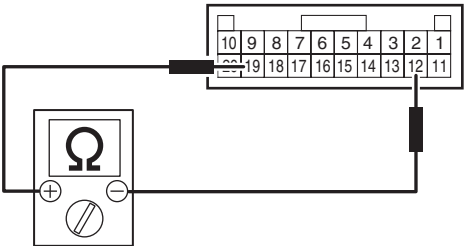
Terminal No.	Inspection conditions	Standard	Connection diagram
—	Switch OFF	1 MΩ or more	—
18 — 12	Switch 1 (TAIL)	Less than 1 Ω	 <p>LI-01244</p>
20, 18 — 12	Switch 2 (HEAD)	Less than 1 Ω	 <p>LI-01245</p>
19 — 12	Switch AUTO	Less than 1 Ω	 <p>LI-01246</p>

- Dimmer & passing switch

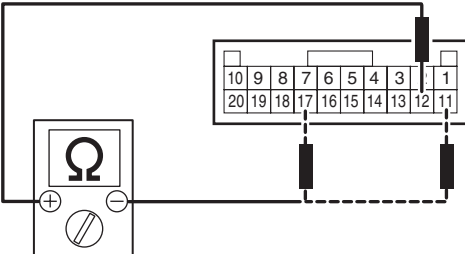
Terminal No.	Inspection conditions	Standard	Connection diagram
11, 17 — 12	Switch PASS	Less than 1 Ω	 <p>LI-01247</p>

Combination Switch (Light)

LIGHTING SYSTEM

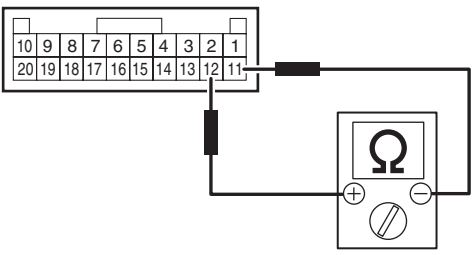
Terminal No.	Inspection conditions	Standard	Connection diagram
11 — 12	Switch UP	Less than 1 Ω	 <p>LI-01248</p>

• Turn signal switch

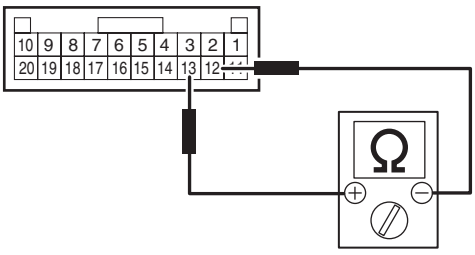
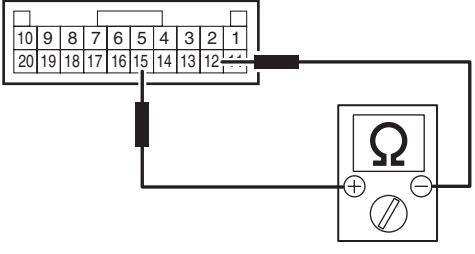
Terminal No.	Inspection conditions	Standard	Connection diagram
13 — 12	Switch TURN (RH)	Less than 1 Ω	 <p>LI-01249</p>
15 — 12	Switch TURN (LH)	Less than 1 Ω	 <p>LI-01250</p>

• Front fog light switch

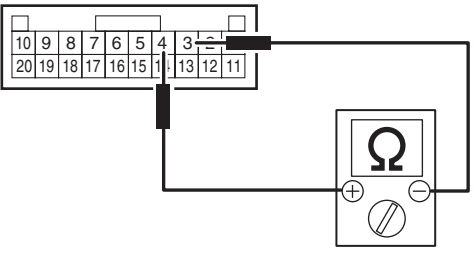
Terminal No.	Inspection conditions	Standard	Connection diagram
4 — 3	Switch OFF	1 M Ω or more	 <p>LI-01251</p>
	Switch ON	Less than 1 Ω	

2) Replace the switch assembly - combination turn dimmer if the inspection result is not within the standard value.