

Heater and Cooling Unit

HVAC SYSTEM (HEATER, VENTILATOR AND A/C)

17.Heater and Cooling Unit

A: REMOVAL

- 1) Disconnect the ground cable from battery.
- 2) Using the refrigerant recovery system, discharge refrigerant. <Ref. to AC-26, PROCEDURE, Refrigerant Recovery Procedure.>
- 3) Drain the coolant from the radiator.
 - Non-turbo model: <Ref. to CO(H4DO)-14, DRAINING OF ENGINE COOLANT, REPLACEMENT, Engine Coolant.>
 - Turbo model: <Ref. to CO(H4DOTC)-13, DRAINING OF ENGINE COOLANT, REPLACEMENT, Engine Coolant.>
- 4) Remove the air intake boot. (Non-turbo model) <Ref. to IN(H4DO)-11, REMOVAL, Air Intake Boot.>

CAUTION:

Move aside the air intake boot to perform the operation without disconnecting the PCV hose.

- 5) Remove the intercooler. (Turbo model) <Ref. to IN(H4DOTC)-35, REMOVAL, Intercooler.>
- 6) Remove the bolt, and remove the hose - pressure suction and the pipe - evaporator cooling from the expansion valve - cooling.
- 7) Loosen the heater hose clamps and remove the hoses.

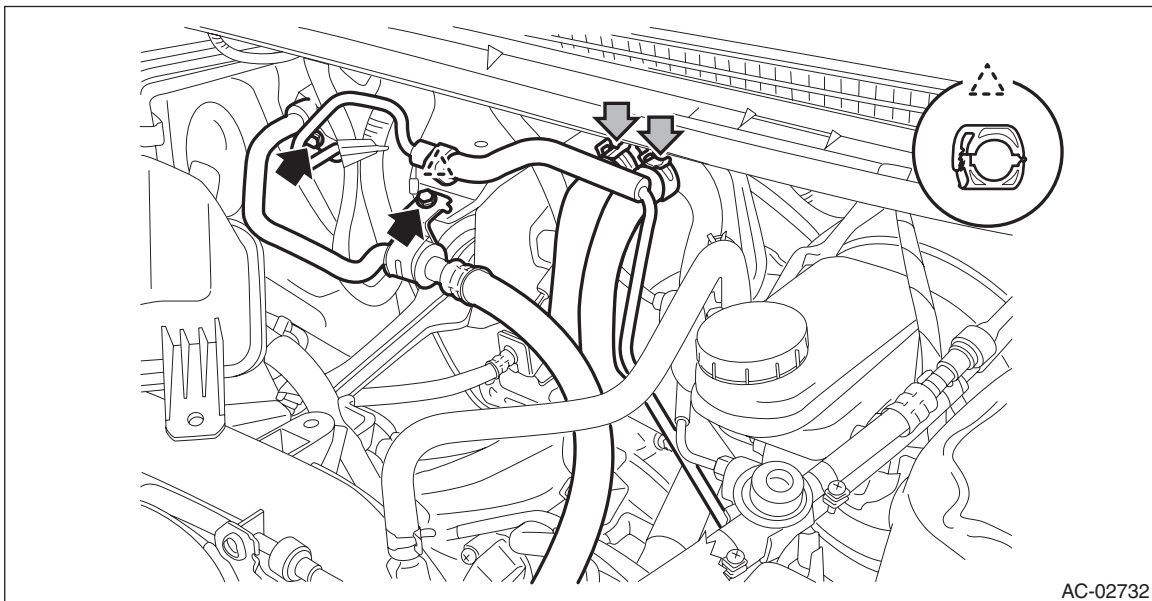

- 8) Remove the instrument panel assembly. <Ref. to EI-69, REMOVAL, Instrument Panel Assembly.>

Heater and Cooling Unit

HVAC SYSTEM (HEATER, VENTILATOR AND A/C)

- 9) Remove the engine control module (ECM). (Non-turbo model)
- (1) Release the lock and remove the relay holder.
 - (2) Remove the nuts (a).
 - (3) Loosen the bolt (b), and remove the engine control module (ECM).

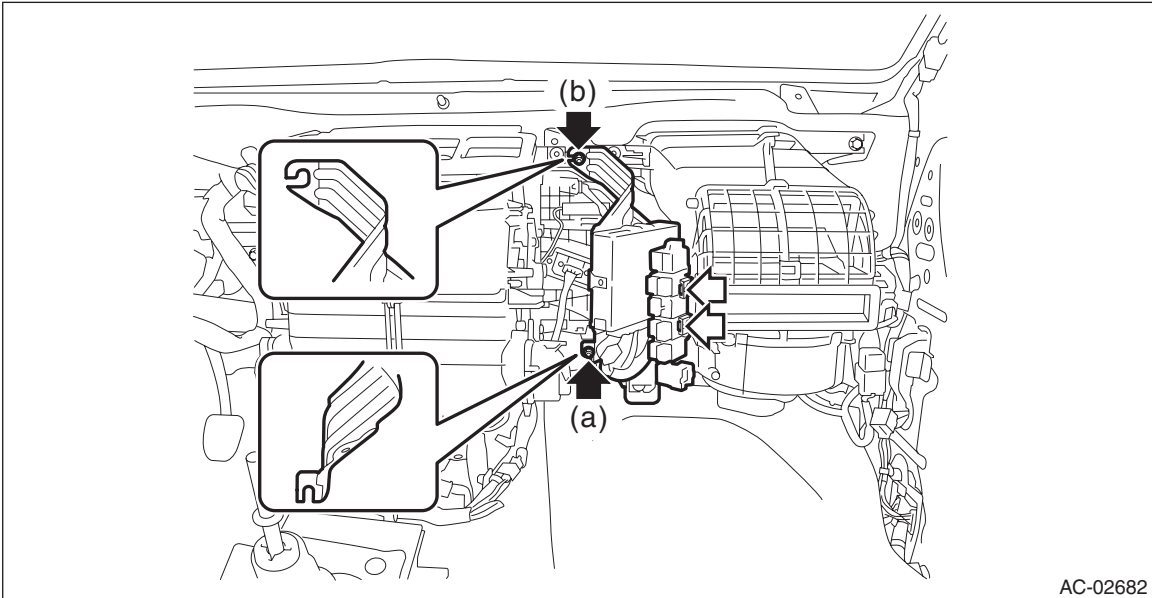

- 10) Remove the blower motor unit assembly.
- (1) Disconnect the blower motor relay and each connector.

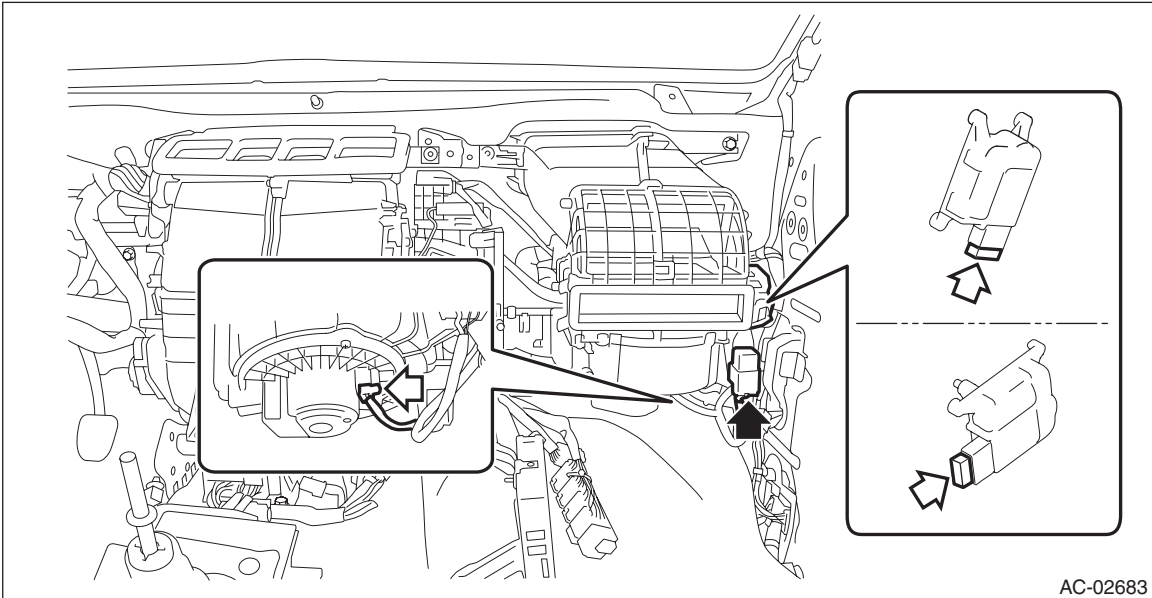

Heater and Cooling Unit

HVAC SYSTEM (HEATER, VENTILATOR AND A/C)

- (2) Remove the bolts and nuts to remove blower motor unit assembly.

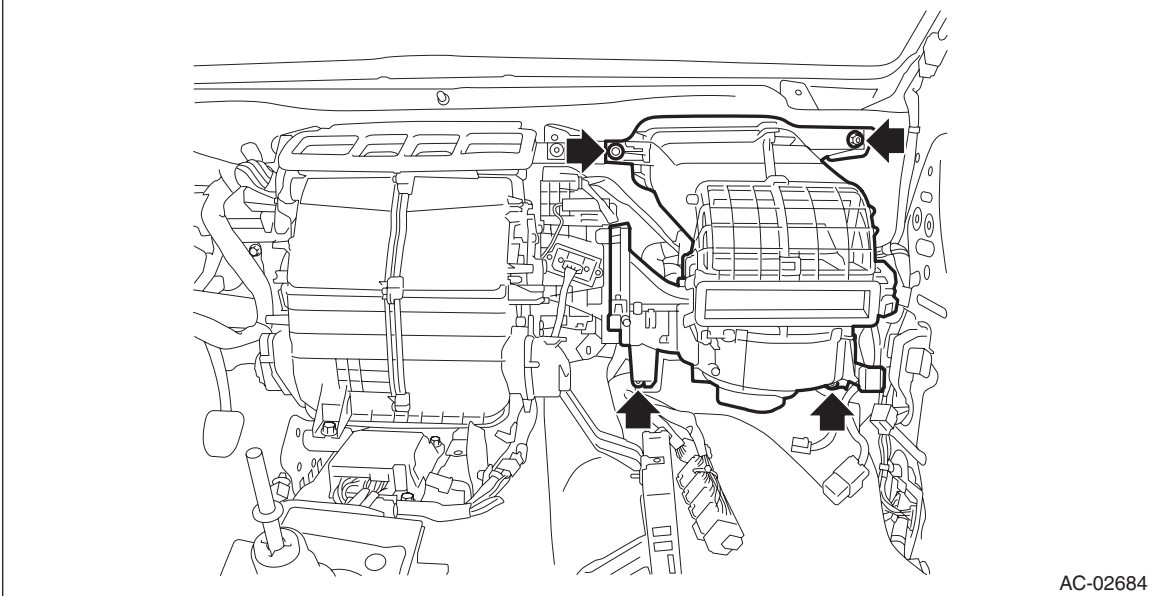

- 11) Remove the heater and cooling unit assembly.
(1) Disconnect each connector and the hose - drain.

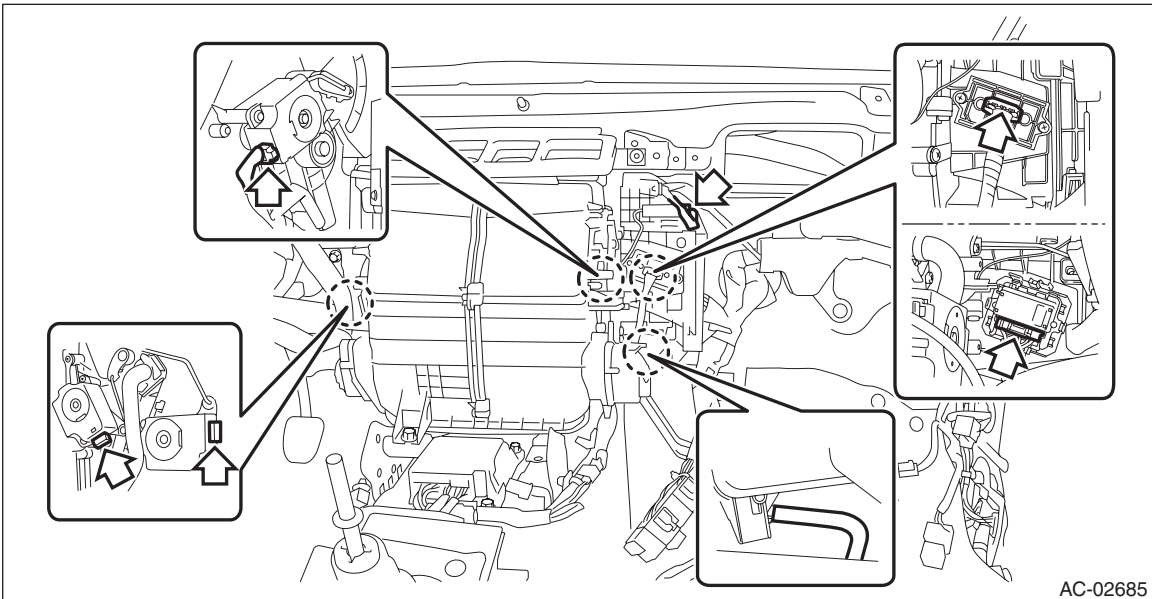

Heater and Cooling Unit

HVAC SYSTEM (HEATER, VENTILATOR AND A/C)

- (2) Remove the bolt and nuts, and remove the heater & cooling unit assembly.

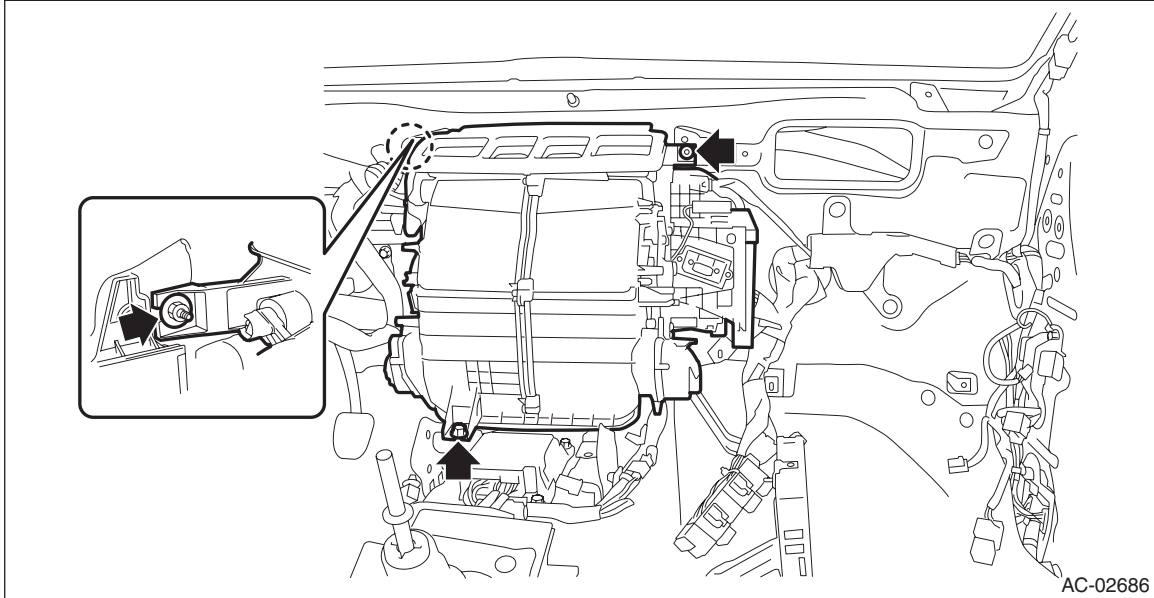

B: INSTALLATION

CAUTION:

Replace O-rings with new parts and install securely.

- 1) Install each part in the reverse order of removal.

Tightening torque:

Heater cooling unit: <Ref. to AC-6, HEATER AND COOLING UNIT, COMPONENT, General Description.>

Blower motor unit: <Ref. to AC-10, BLOWER MOTOR UNIT, COMPONENT, General Description.>

Engine control module (ECM): 7.5 N·m (0.76 kgf-m, 5.5 ft-lb)

- 2) Fill engine coolant.

- Non-turbo model: <Ref. to CO(H4DO)-15, FILLING OF ENGINE COOLANT, REPLACEMENT, Engine Coolant.>
- Turbo model: <Ref. to CO(H4DOTC)-14, FILLING OF ENGINE COOLANT, REPLACEMENT, Engine Coolant.>

- 3) Charge refrigerant. <Ref. to AC-27, PROCEDURE, Refrigerant Charging Procedure.>