

## Control Panel

HVAC SYSTEM (HEATER, VENTILATOR AND A/C)

### 14. Control Panel

#### A: REMOVAL

- 1) Disconnect the ground cable from battery.
- 2) Remove the panel center assembly.

#### CAUTION:

- Do not put your finger on the fin of the air vent grille. Doing so may damage the fin.
  - Pull the panel center assembly slowly. Pulling with excessive force may damage the connector.
- (1) On manual A/C models, disconnect the control cables from both sides of the heater and cooling unit assembly.

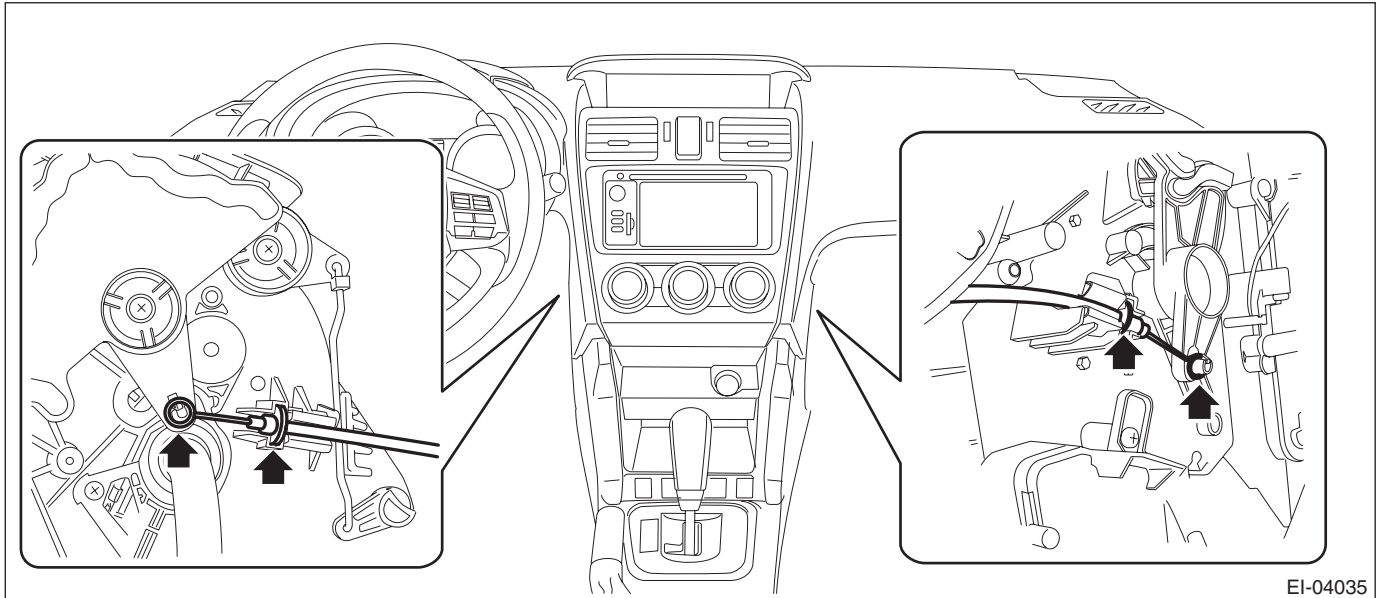

#### NOTE:

Remove the glove box pocket assembly on the passenger's side.

- (2) Insert a plastic remover to the three areas shown by the arrows, and slightly lift up the panel center assembly.
- (3) With the panel center assembly lifted up slightly, release the claw by using a clip remover wrapped with protective tape.
- (4) Release the rest of the claws, and pull out the panel center assembly.
- (5) Disconnect the connectors, and remove the panel center assembly.

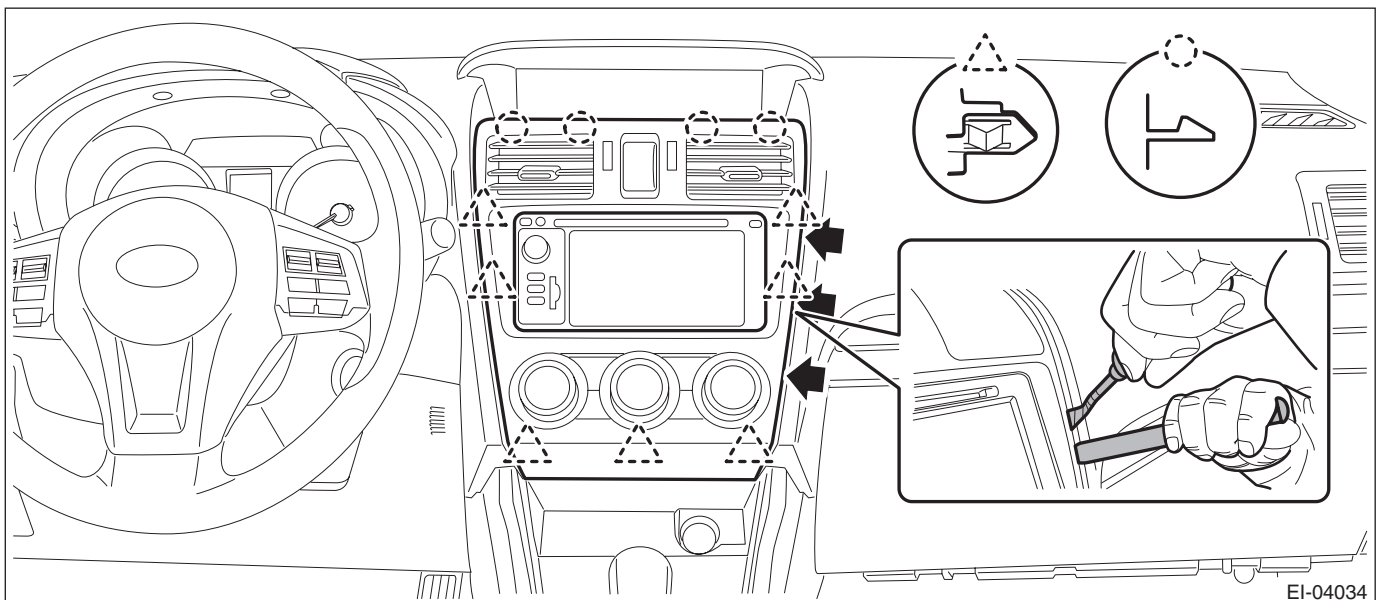

## Control Panel

HVAC SYSTEM (HEATER, VENTILATOR AND A/C)

- 3) Remove the heater control assembly.
- (1) Remove the screws.
  - (2) Release the claws, and then remove the heater control assembly from the panel center assembly.

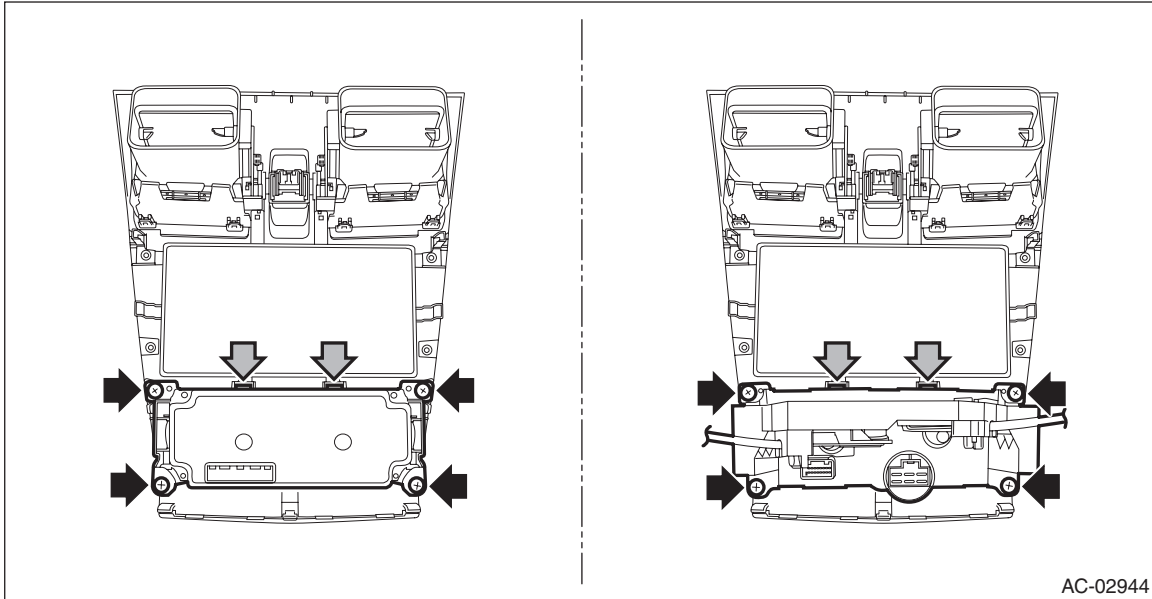

## B: INSTALLATION

### CAUTION:

**After installing the panel center assembly, check that the air vent grille of the panel center assembly is inserted correctly into the air vent duct.**

Install each part in the reverse order of removal.

# Control Panel

HVAC SYSTEM (HEATER, VENTILATOR AND A/C)

## C: INSPECTION

### 1. CHECK ILLUMINATION

#### UNIT INSPECTION

1) Check the illumination operation when battery voltage is applied between the terminals of control panel.

- Manual A/C model

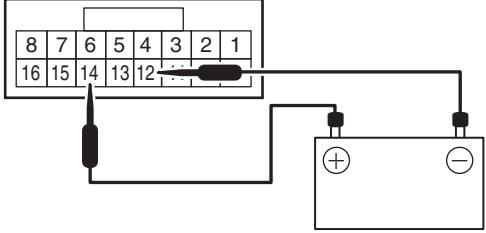
Terminal No.	Inspection conditions	Specification	Connection diagram
14 (+) — 12 (–)	Connect battery to the terminals	Light ON	 <p>AC-02733</p>

- Auto A/C model

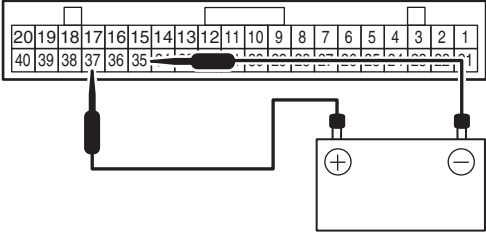
Terminal No.	Inspection conditions	Specification	Connection diagram
37 (+) — 35 (–)	Connect battery to the terminals	Light ON	 <p>AC-02734</p>

2) If it does not operate normally, replace the heater control assembly.

# Control Panel

HVAC SYSTEM (HEATER, VENTILATOR AND A/C)

## 2. BLOWER SWITCH (MANUAL A/C MODEL)

### UNIT INSPECTION

#### PREPARATION TOOL:

##### Circuit tester

1) Measure the resistance between the control panel terminals.

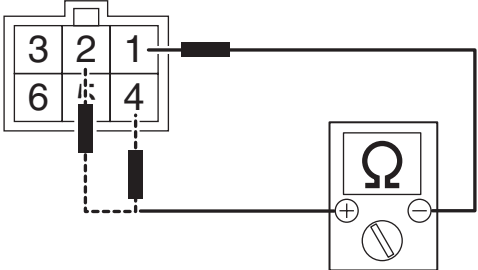
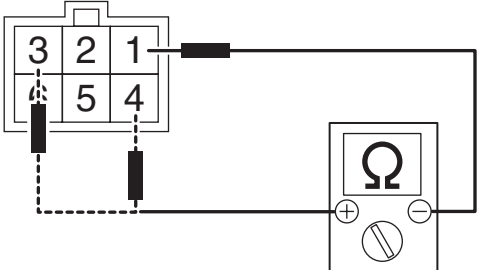
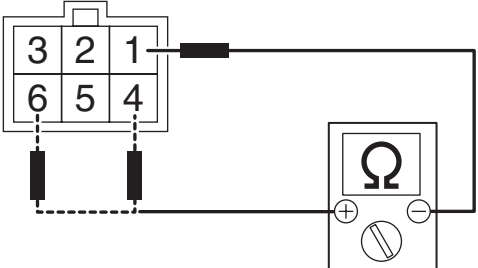
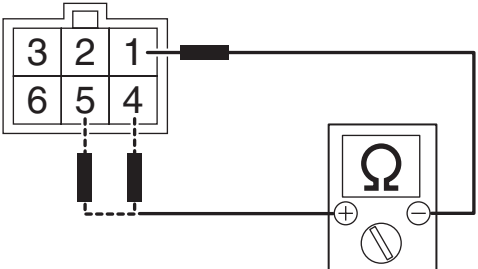
Terminal No.	Inspection conditions	Standard	Connection diagram
—	OFF	—	—
1 — 2, 4	1 (LO)	Less than 1 $\Omega$	 <p>AC-02798</p>
1 — 3, 4	2 (M1)	Less than 1 $\Omega$	 <p>AC-02799</p>
1 — 4, 6	3 (M2)	Less than 1 $\Omega$	 <p>AC-02800</p>
1 — 4, 5	4 (HI)	Less than 1 $\Omega$	 <p>AC-02801</p>

2) Replace the heater control assembly if the inspection result is not within the standard.