

26.Roof Trim

A: REMOVAL

CAUTION:

- Airbag system satellite safing sensor is located in the lower of the rear seat cushion center. Before removing the rear seat, refer to “CAUTION” of “General Description” in “AIRBAG SYSTEM” section. <Ref. to AB-9, CAUTION, General Description.>

- The airbag system is fitted with a backup power supply. After disconnecting the battery ground cable, the airbag may operate if you do not wait for 60 seconds before starting the service of airbag system.

- 1) Disconnect the ground cable from battery and wait for at least 60 seconds before starting work.
- 2) Adjust the front seat position.
 - (1) Remove the headrest.
 - (2) Move the seat to the front-most position and tilt the backrest rearward.
- 3) Release the clips and claws, then detach the left and right grille speaker side.

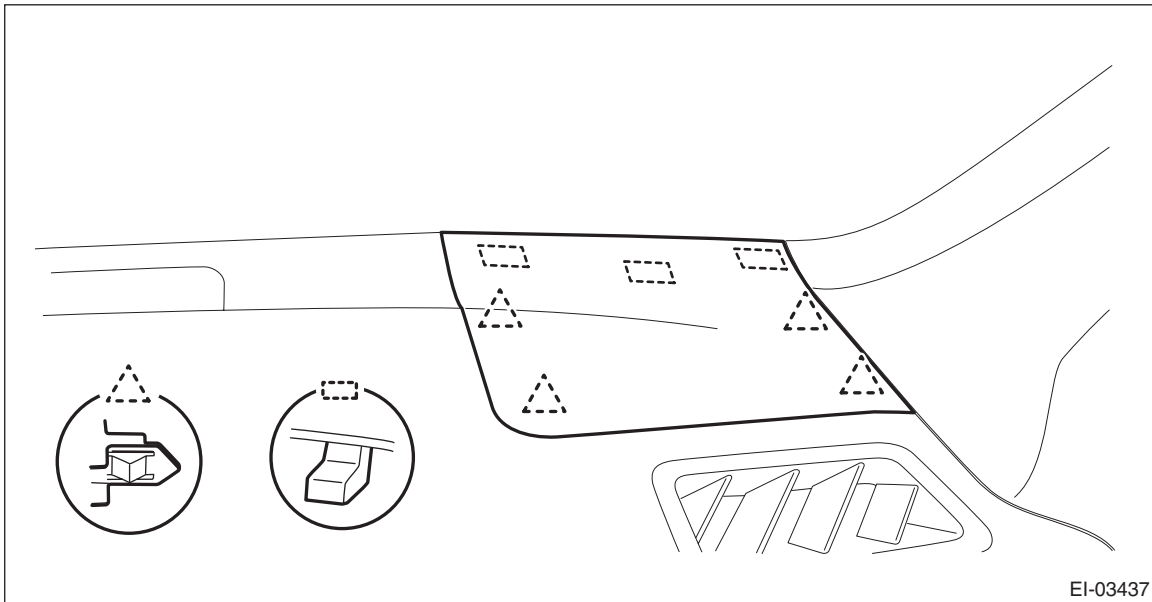

NOTE:

Remove the grille speaker side by using a plastic remover.

- 4) Remove the trim panel - front pillar UPR on the left and right sides.

CAUTION:

Be careful not to damage the trim panel surface and curtain airbag module.

- (1) Pull the trim panel - front pillar UPR towards the center of the vehicle to release the clips.
- (2) Pull out the end portion of the trim panel - front pillar UPR.
- (3) Pull out the trim panel - front pillar UPR towards the center of the vehicle.

Roof Trim

EXTERIOR/INTERIOR TRIM

- (4) Rotate the trim panel - front pillar UPR, release the tether clips, and remove the trim panel - front pillar UPR.

CAUTION:

Do not use tools when releasing the tether clip. If the tether clip is damaged, replace it with a new tether clip.

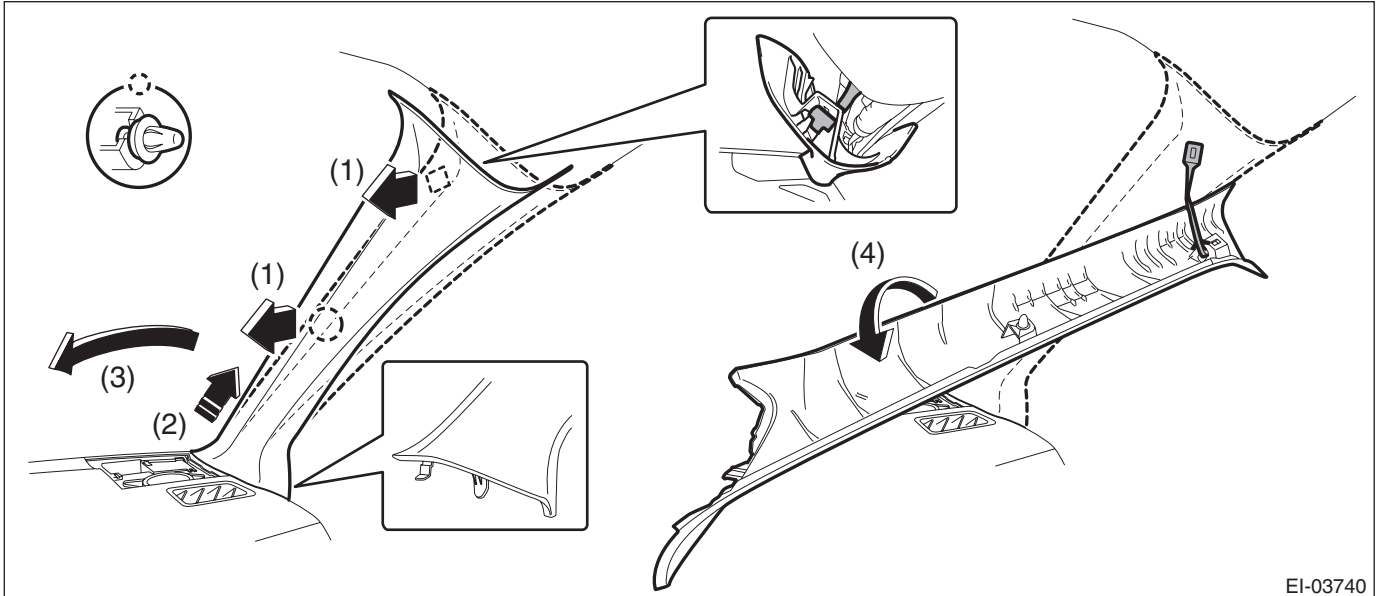

- 5) Release the claws, and then remove the cover side sill - front INN on LH and RH sides.

CAUTION:

Do not pull with excessive force. Doing so may damage the claws of the cover side sill - front INN.

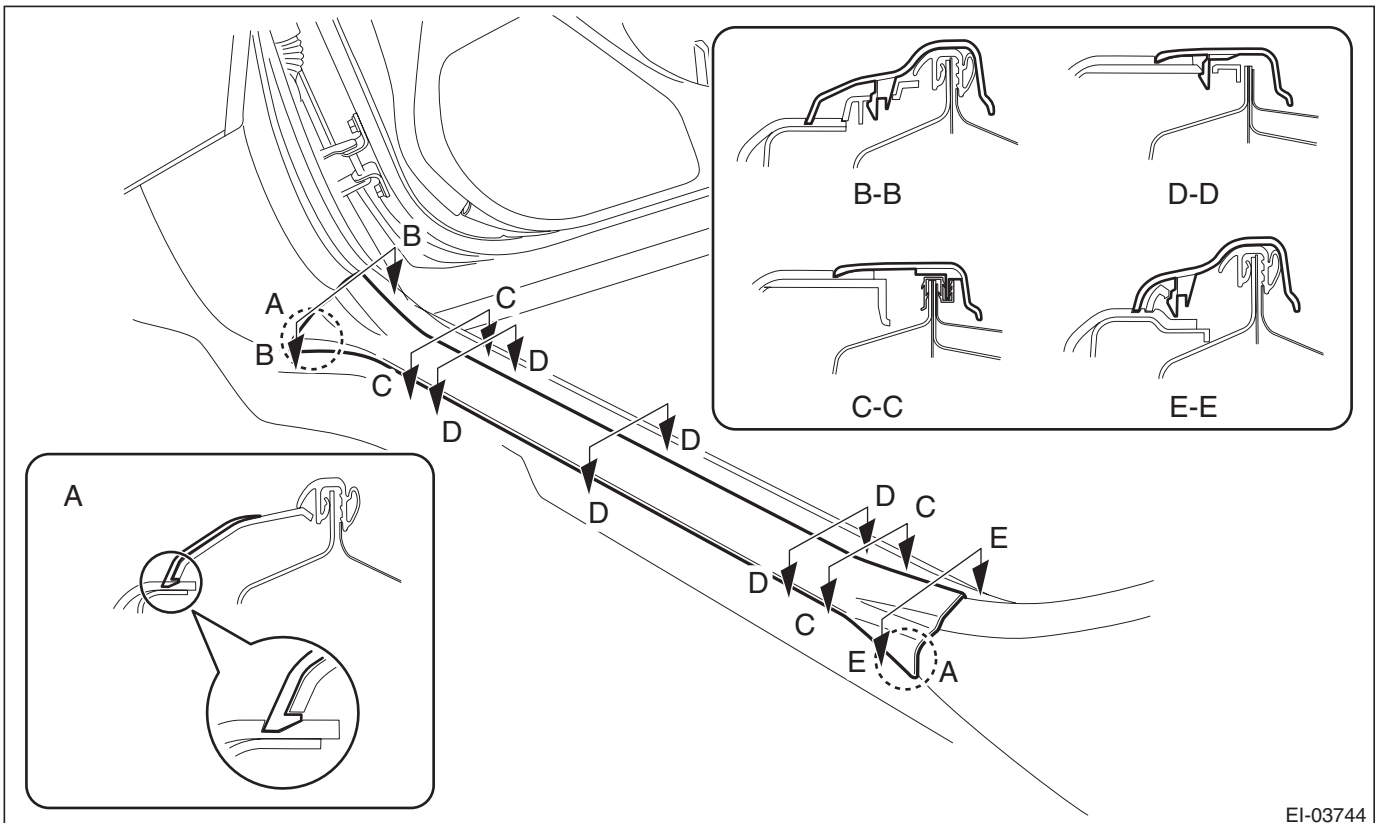

6) Remove the rear seat cushion assembly.

(1) Push the corners of the rear seat cushion from above.

(2) While pushing the corners of the rear seat cushion from above, pull the knob of the hook - seat cushion rear towards yourself.

(3) While pulling the knob towards yourself, disconnect the hooks by lifting up the rear seat cushion.

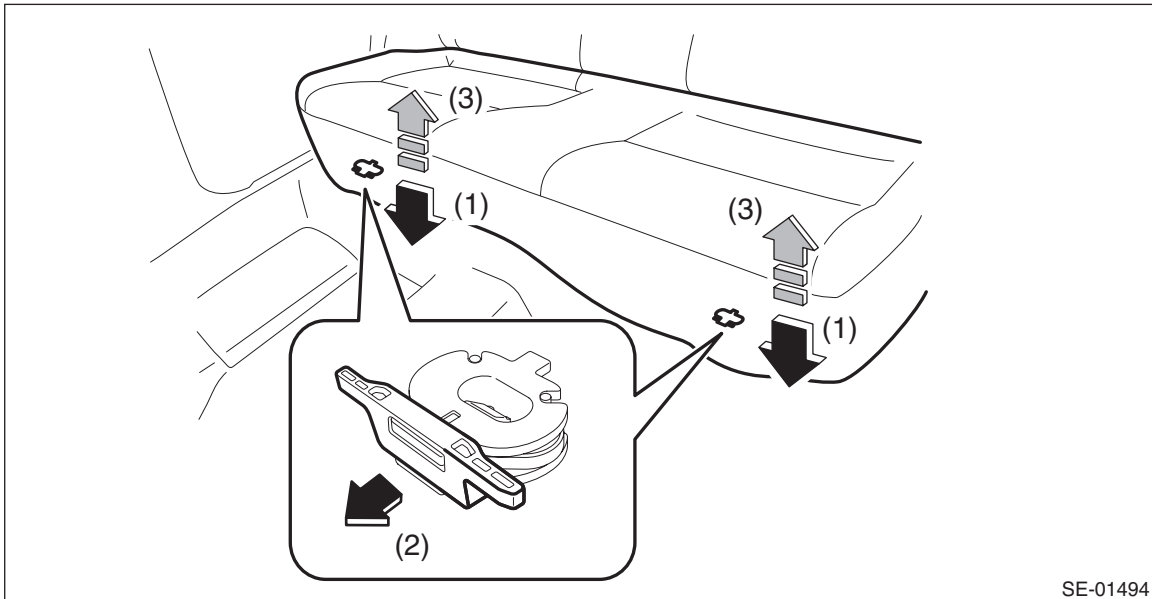

(4) Remove the hook (A) by pushing it back while lifting the front side of the rear seat cushion, and remove the rear seat cushion.

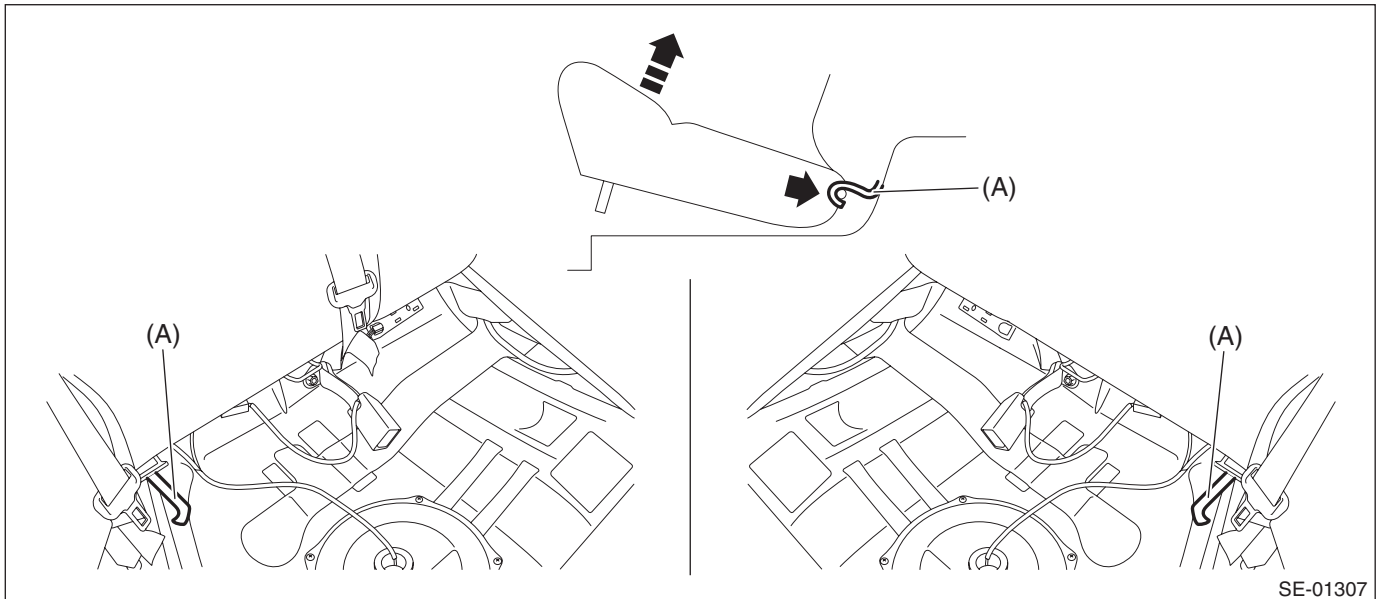

Roof Trim

EXTERIOR/INTERIOR TRIM

7) Release the clips and claws, and remove the cover side sill - rear INN on LH and RH sides.

CAUTION:

Do not pull with excessive force. Doing so may damage the claws of the cover side sill - rear INN.

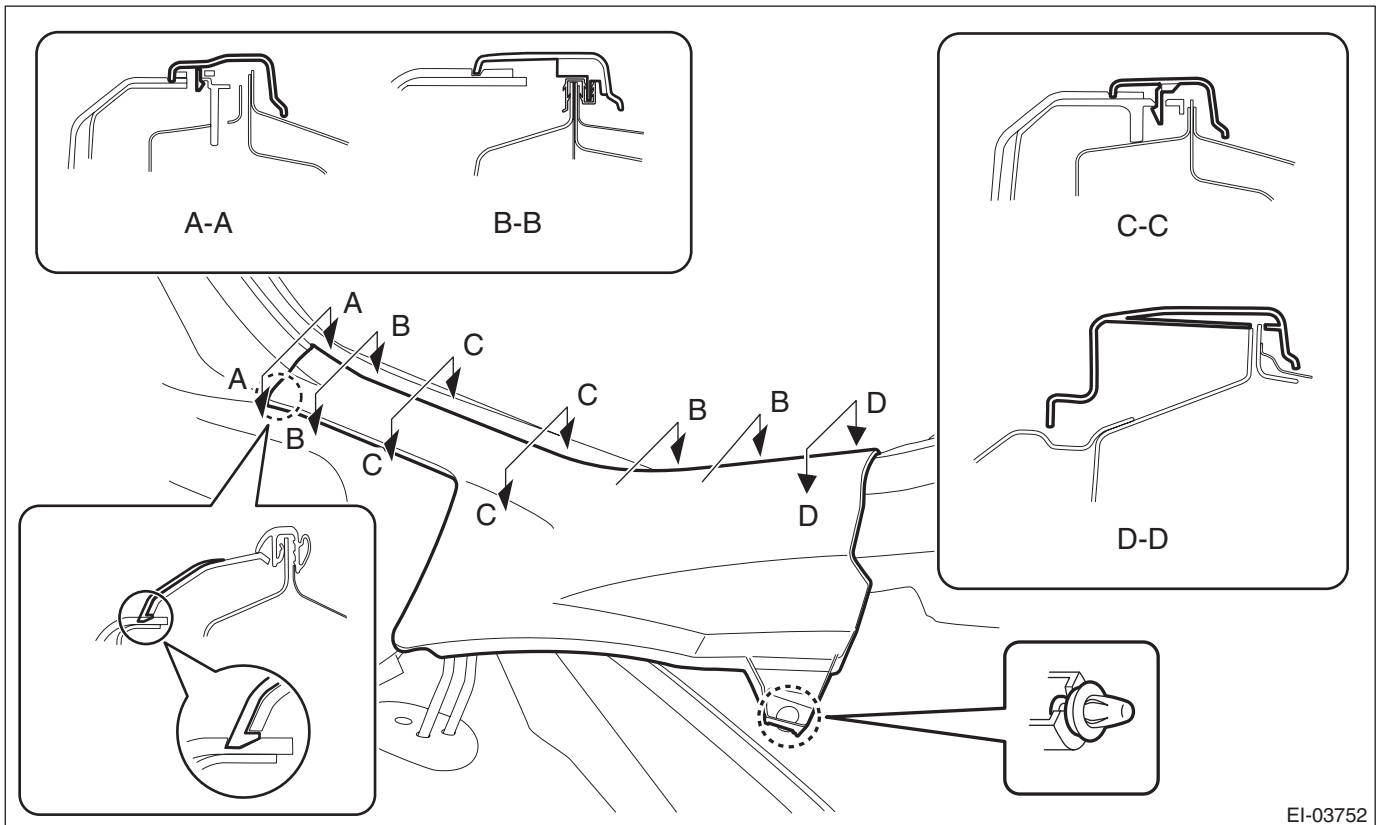

EI-03752

8) Remove the trim panel - center pillar LWR on the left and right sides.

(1) Release the clip by pulling the trim panel - center pillar LWR toward you.

(2) Expand the claws of the trim panel - center pillar LWR outward, and remove it from the trim panel - center pillar UPR.

CAUTION:

Do not expand the trim panel - center pillar LWR excessively. Doing so may damage the trim.

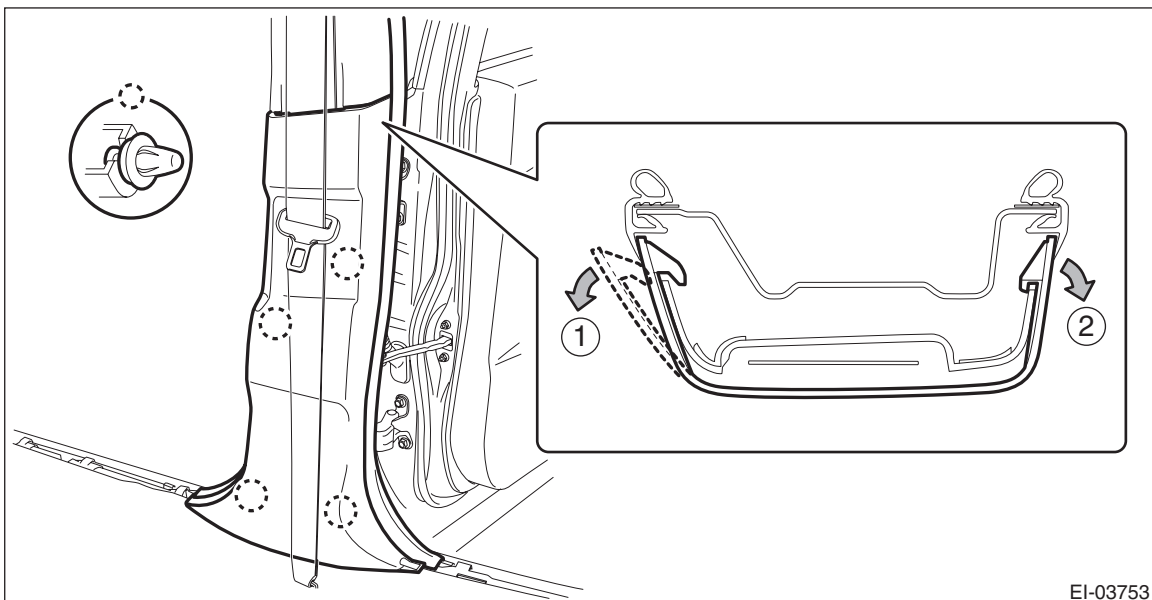

EI-03753

NOTE:

First release the claw located to the front of the vehicle.

9) Remove the trim panel - center pillar UPR on the left and right sides.

(1) Remove the cover through (a), and remove the seat belt anchor bolt.

(2) Remove the bolt on the lower side of the trim panel - center pillar UPR.

(3) Remove the clip by pulling the upper part of the trim toward you, and while lowering the entire trim, remove the trim panel - center pillar UPR.

CAUTION:

Do not reuse the upper clips of the trim panel - center pillar UPR. Once the clip is removed, its holding force is reduced. Be sure to replace it with a new clip.

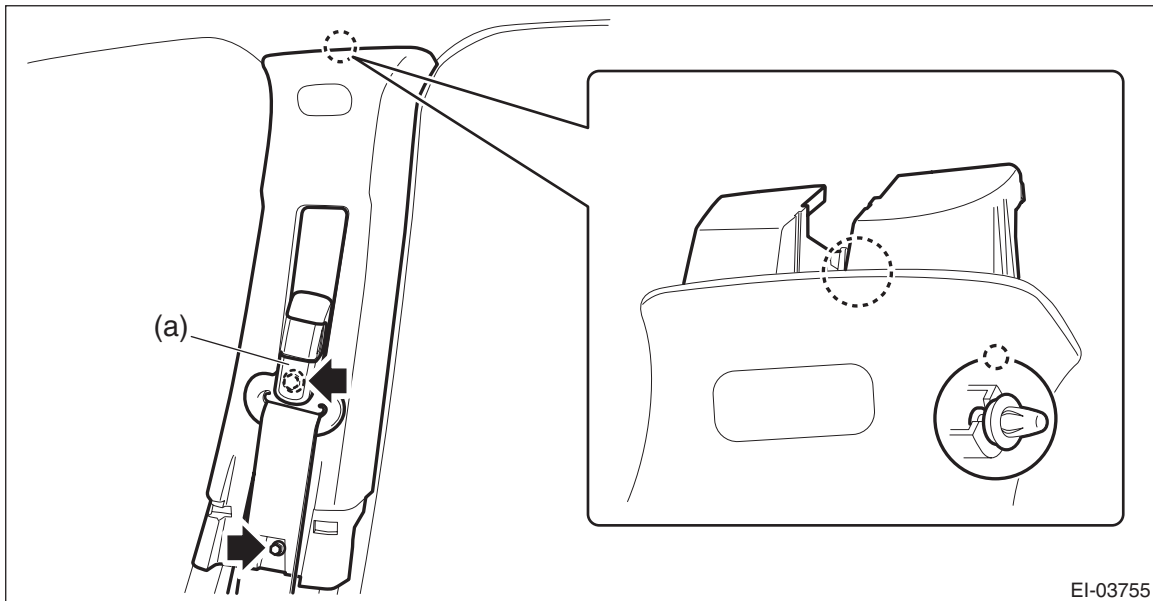

EI-03755

10) Remove the mat - rear floor, spacer - rear floor, and cover - trunk.

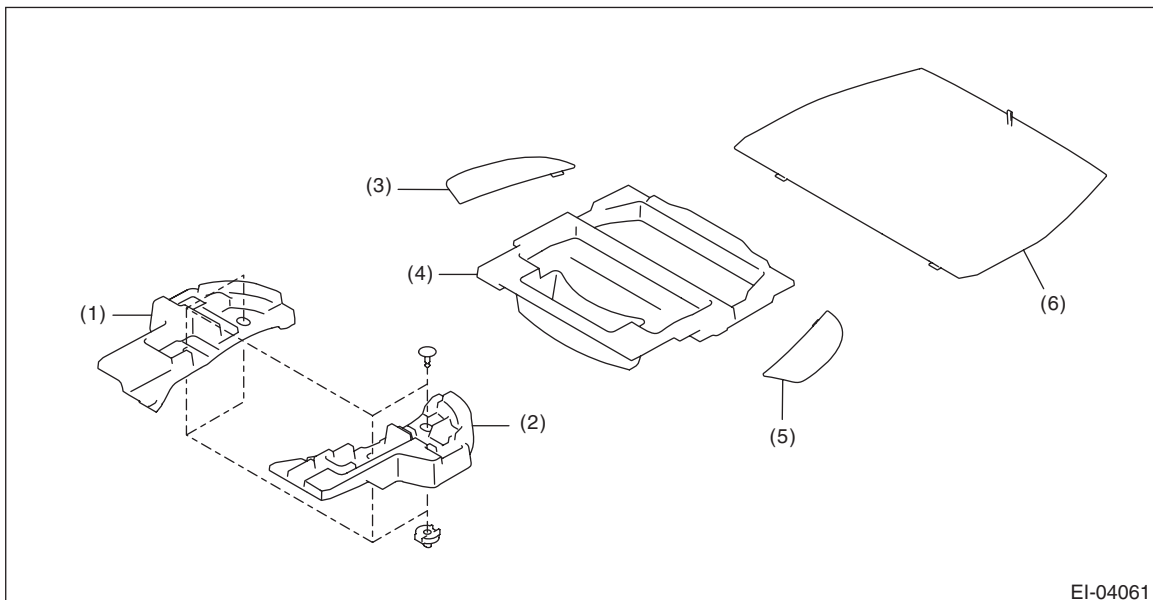

EI-04061

(1) Spacer - rear floor side RH

(3) Mat - rear floor RH

(5) Mat - rear floor LH

(2) Spacer - rear floor side LH

(4) Cover - trunk

(6) Mat - rear floor CTR

Roof Trim

EXTERIOR/INTERIOR TRIM

11) Remove the clips, and remove the trim panel - rear skirt.

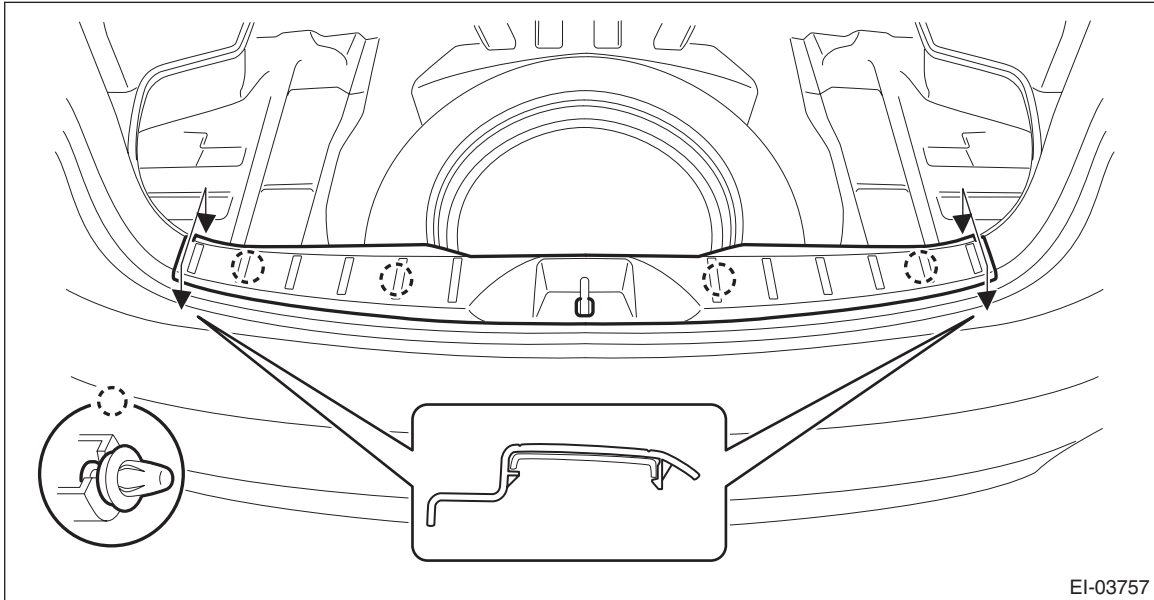

12) Remove the trim panel - rear apron.

- (1) Open the cover, remove the bolts, and remove the hook - luggage. (2 places)
- (2) Remove the screws, and release the clips.
- (3) Disconnect the connectors and remove the trim panel - rear apron.

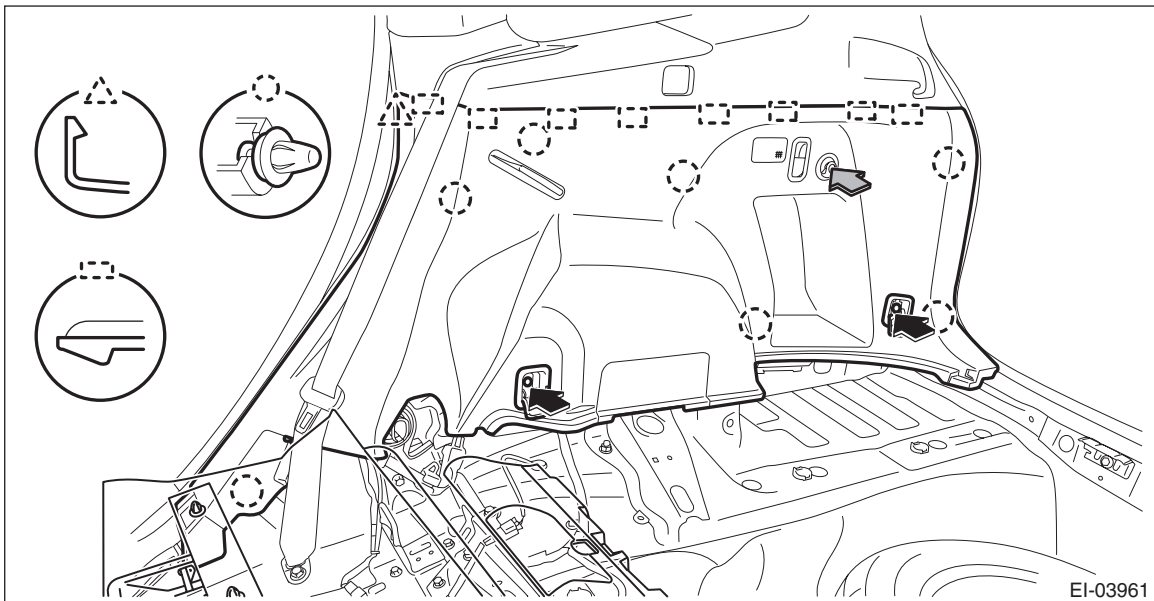

13) Remove the trim panel - rear quarter pillar UPR.

- (1) Disconnect the rod - power rear gate before removing the trim panel - rear quarter pillar UPR LH.
(Only for models with power rear gate)

CAUTION:

For the disconnection procedure of the rod - power rear gate, refer to “REMOVAL”, “Power Rear Gate Rod” in the “POWER REAR GATE” section and observe the precautions for removal. <Ref. to PRG-15, REMOVAL, Power Rear Gate Rod.>

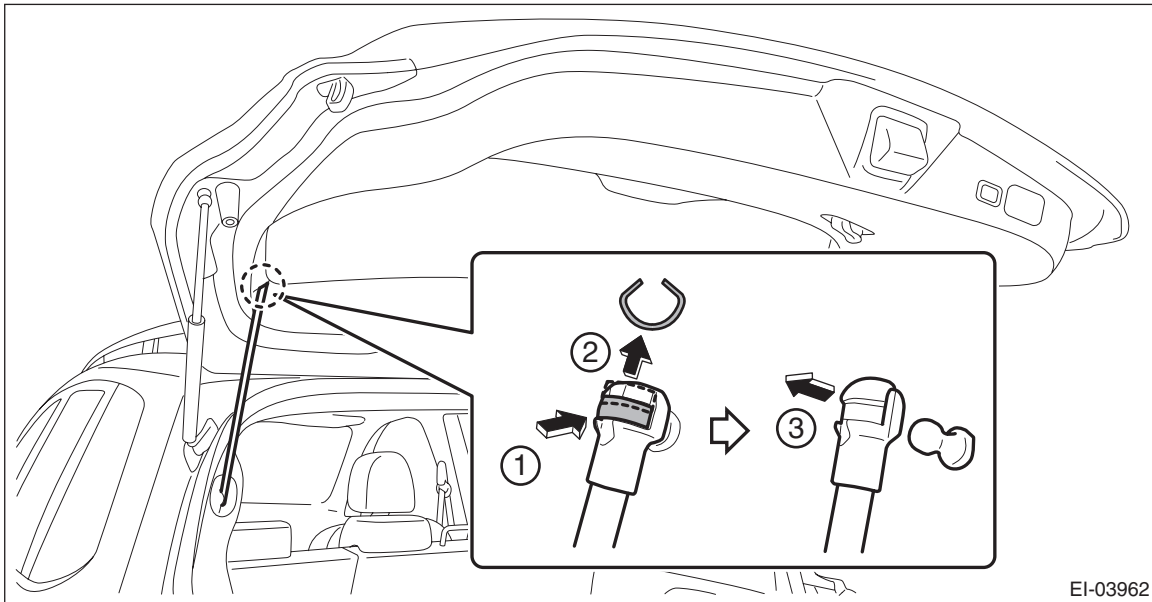

EI-03962

- (2) Remove the lower anchor bolts of rear seat belts.

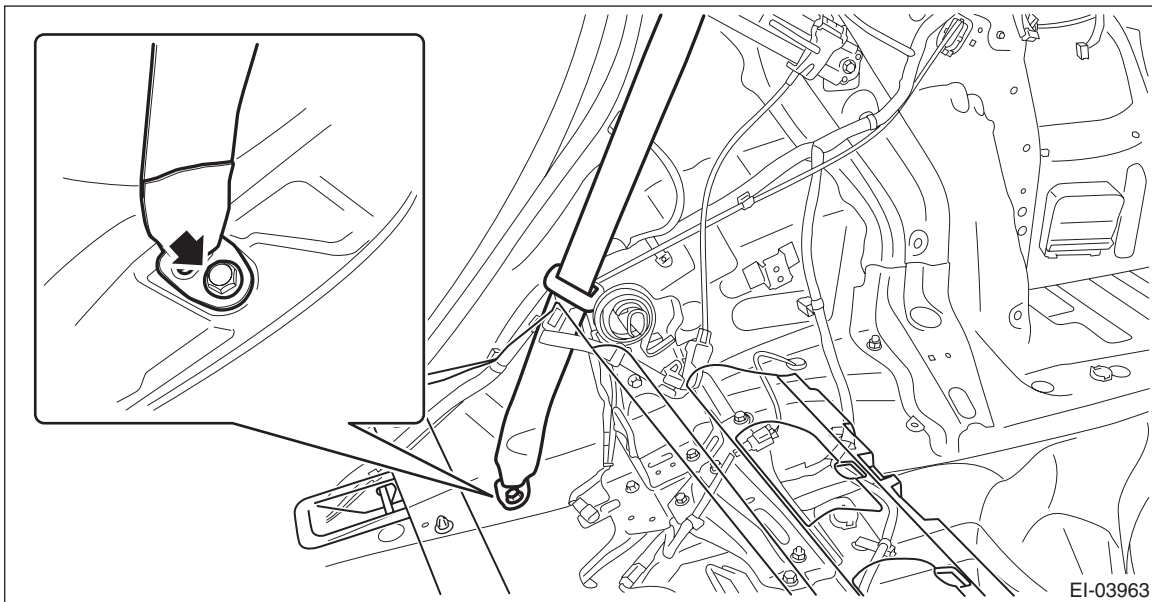

EI-03963

Roof Trim

EXTERIOR/INTERIOR TRIM

- (3) Remove the screws and clips, and remove the trim panel - rear quarter pillar UPR.

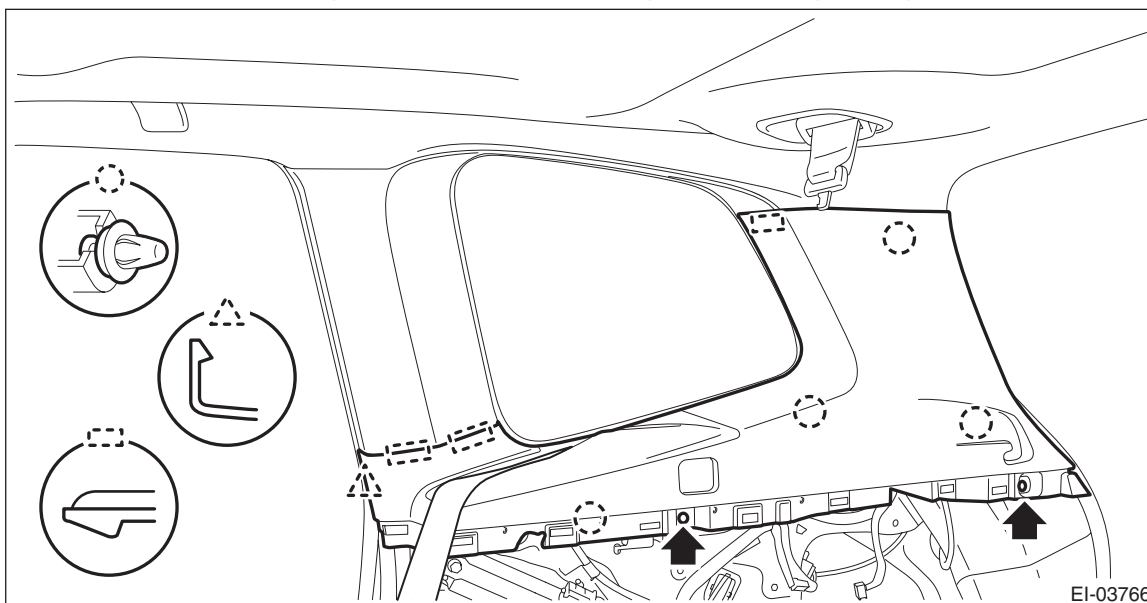

- 14) Release the clips, and remove the trim panel - rear pillar UPR.

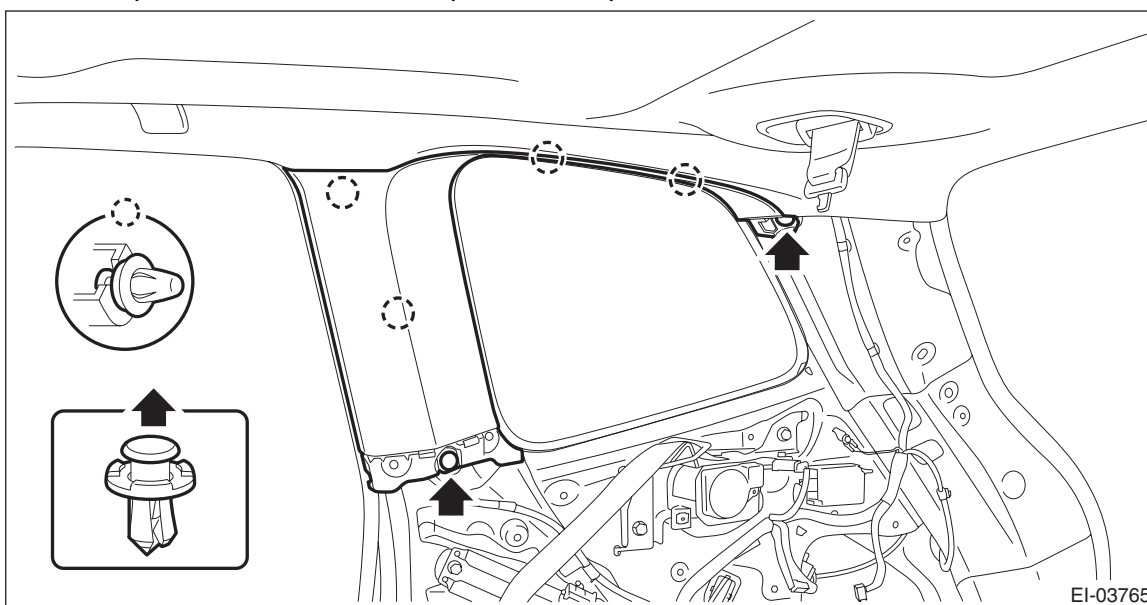

15) Remove the overhead console assembly.

- (1) Push and open the rear end of the overhead console lid, and remove the screws.
- (2) Remove the clips and pull out the overhead console to disconnect the connectors.

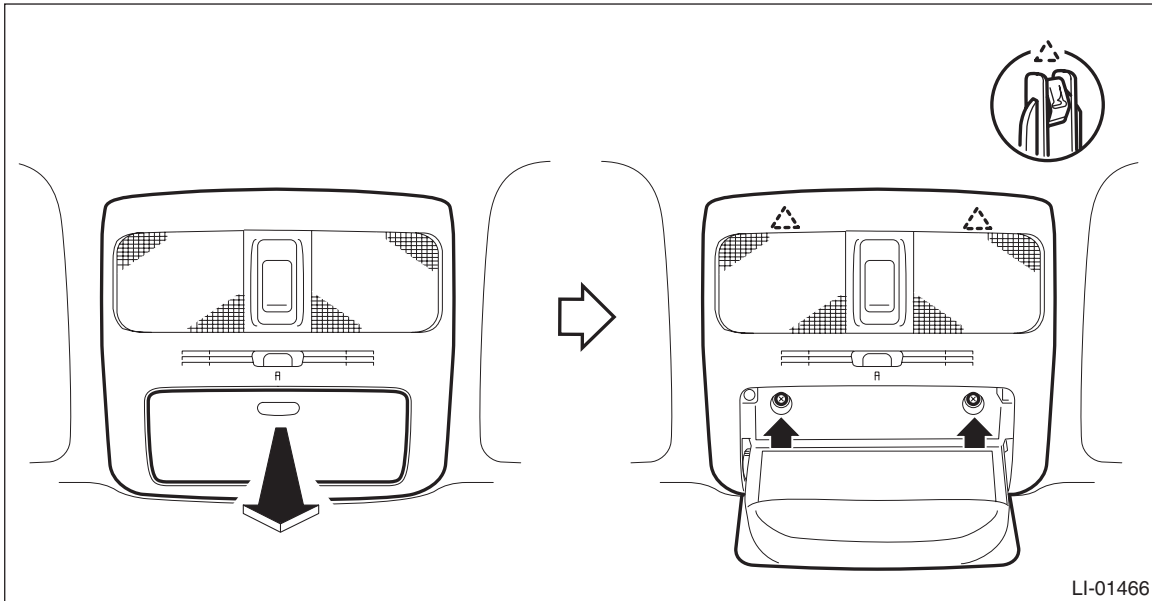

16) Remove the stereo camera cover. (Models with EyeSight) <Ref. to ES-11, REMOVAL, Stereo Camera.>

17) Remove the left and right sun visor assembly.

- (1) Remove the screws and remove the sun visor assembly.
- (2) Press both sides of the hook - sun visor using a flat tip screwdriver.
- (3) Remove the hook - sun visor by pulling it toward you.

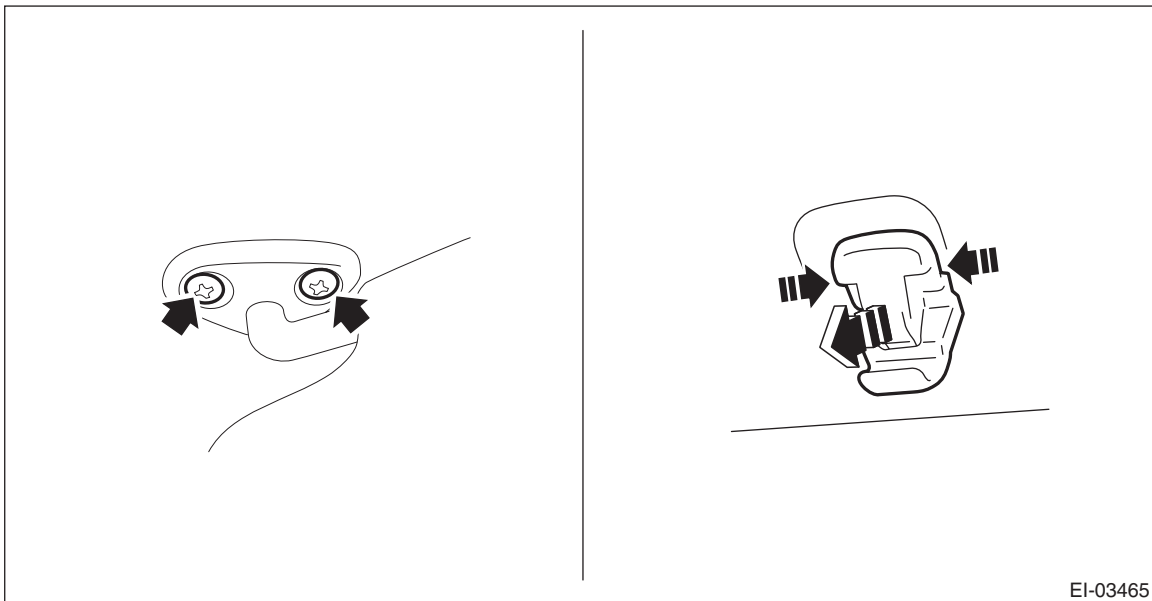

Roof Trim

EXTERIOR/INTERIOR TRIM

18) Remove the light assembly - room.

(1) Remove the lens and detach the screws.

(2) Disconnect the connector and remove the light assembly - room.

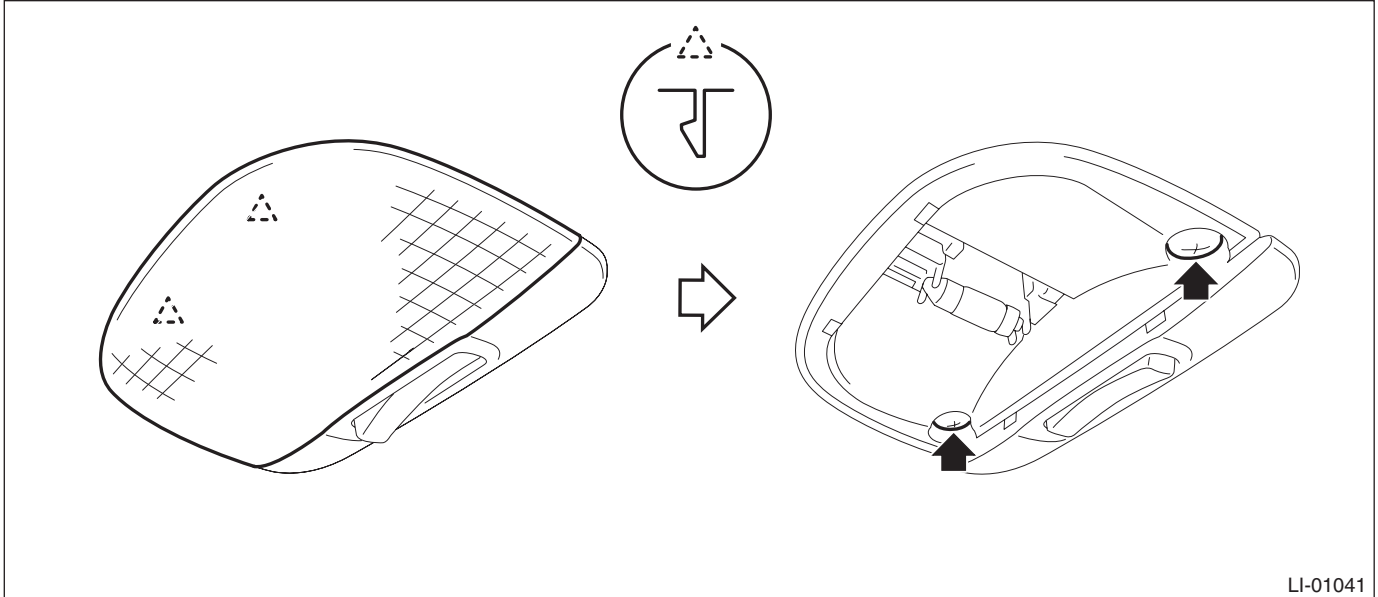

19) Remove all assist rails.

(1) Remove the cap (a) by pulling the both sides of the cap (a) using a flat tip screwdriver wrapped with a protection tape.

(2) Pull the assist grip toward you (to the vehicle center) and remove the metal clip from the bracket.

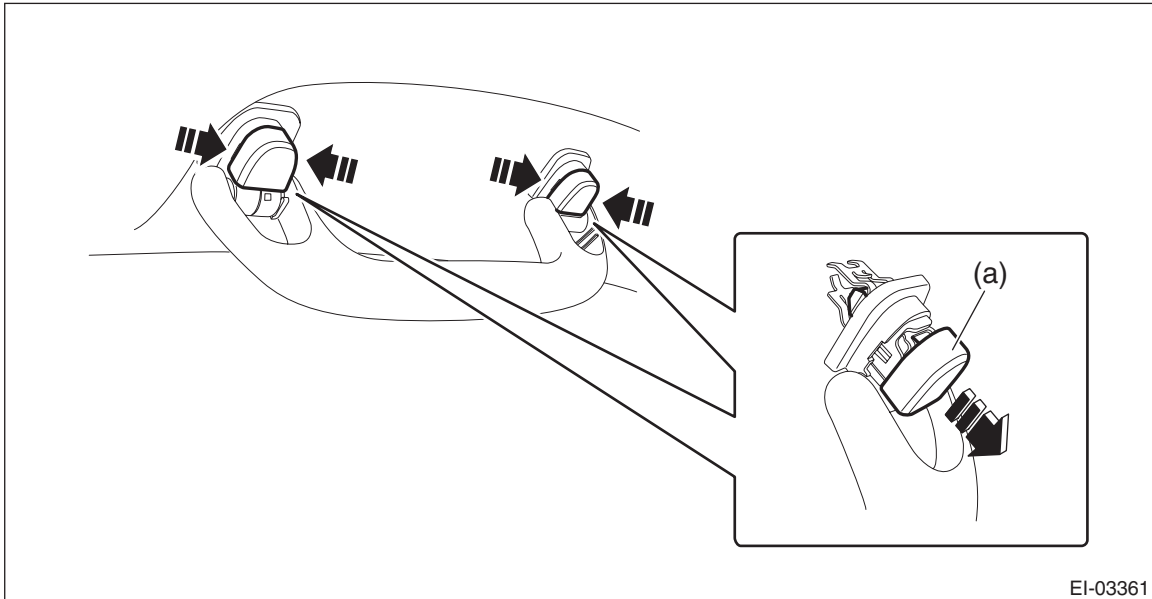

20) Remove the trim panel - roof assembly.

(1) Remove the harness clamp of the cord assembly - antenna feeder and the cord - roof, and disconnect the connectors.

(2) Remove the clips and remove the Velcro tape behind the room light.

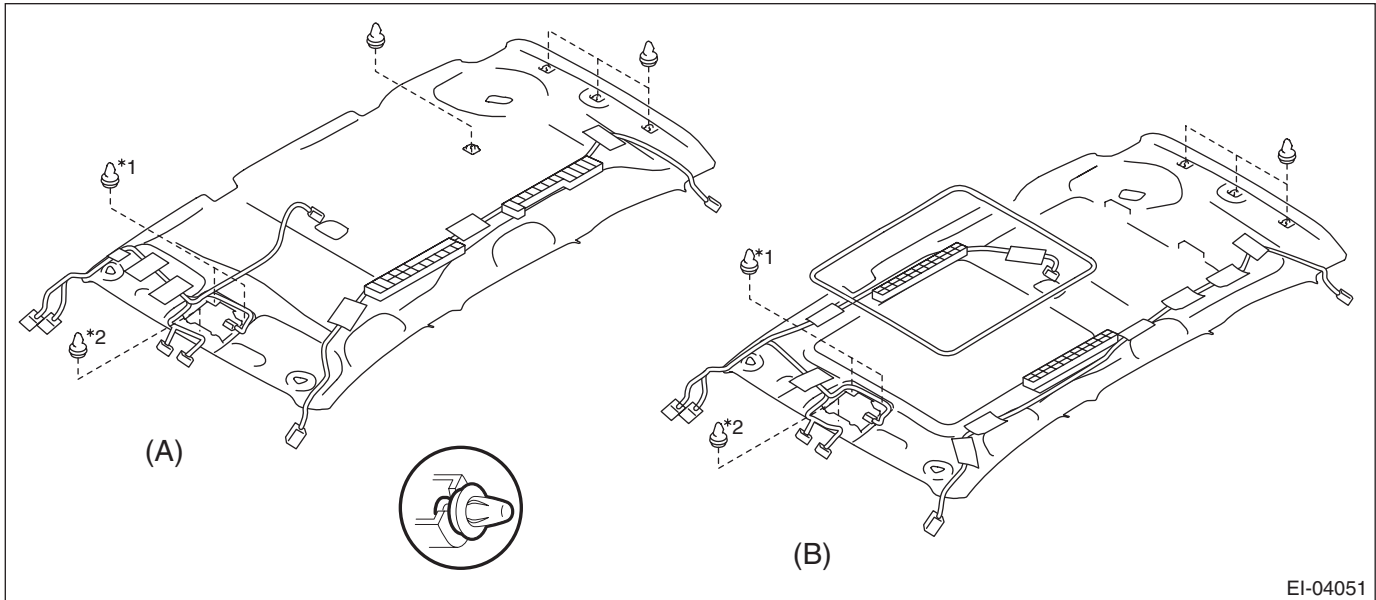

(A) Normal roof type (4 door model)

(B) Sunroof type

*1 Models with EyeSight

*2 Models without EyeSight

(3) Remove the weather strip - body side flange from the front/rear and left/right doors, and remove the trim panel - roof assembly.

(4) Take out the trim panel - roof assembly from the rear gate opening to outside.

Roof Trim

EXTERIOR/INTERIOR TRIM

B: INSTALLATION

1) Apply the feeder cord and roof cord along the mark-off line of the roof trim.

CAUTION:

Route each cord carefully. The cord may interfere, thus preventing normal deployment of the curtain airbag when necessary.

Tape:

Item number: 86359SC000/TAPE

NOTE:

Use the tape (service parts) by cutting into 80 mm × 50 mm (3.2 in × 2.0 in).

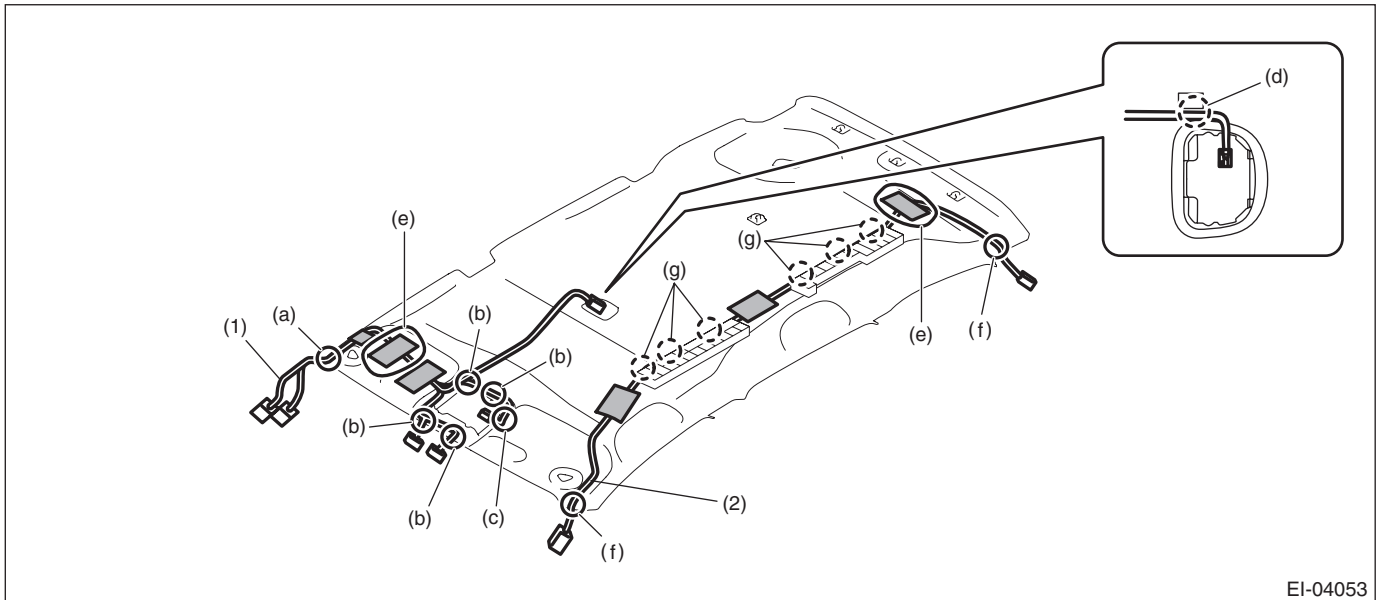

EI-04053

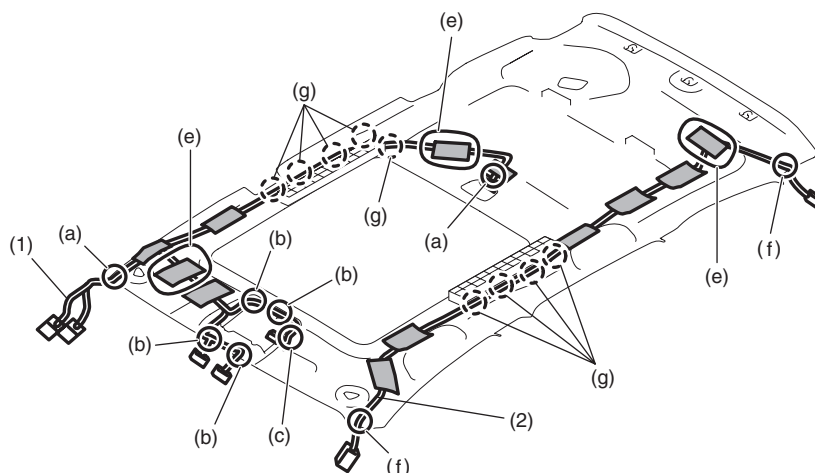

EI-04054

(1) Roof cord

(2) Feeder cord

(a) Align the marking (white tape) of the cord with the clamp to secure.

(d) Bind the cord between the patch and the trim.

(g) Secure the cord to the roof pad clamp.

(b) Secure the cord to the clamp of the patch.

(e) Fix with the tape by adjusting the excess portion of cord at the (e) position.

(c) Affix the polyurethane section of the cord to the clamp of the patch.

(f) Align the marking (red tape) of the cord with the clamp to secure.

2) Install each part in the reverse order of removal.

CAUTION:

- For installation of the stereo camera cover, refer to “INSTALLATION”, “Stereo Camera Cover” in the “EyeSight” section and observe the precautions for installation. <Ref. to ES-15, INSTALLATION, Stereo Camera.>
- For installation of the rod - power rear gate, refer to “INSTALLATION”, “Power Rear Gate Rod” in the “POWER REAR GATE” section and observe the precautions for installation. <Ref. to PRG-16, INSTALLATION, Power Rear Gate Rod.>
- Check that there is no damage to the tether clip on the upper part of the trim panel - front pillar UPR. If the tether clip is damaged, always replace it with a new tether clip.
- Do not reuse the tether clip removed from the upper part of the trim panel - front pillar UPR. Always replace with a new part.
- Do not reuse the upper clips of the trim panel - center pillar UPR. Once the clip is removed, its holding force is reduced. Be sure to replace it with a new clip.
- Before installing the trim panel - front pillar UPR, check the condition of protective non-woven fabric (white) of the curtain airbag. If it is damaged (airbag module cloth is exposed), replace the curtain airbag module assembly with a new part.

NOTE:

For installation of the trim panel - front pillar UPR, refer to “Upper Inner Trim”. <Ref. to EI-101, INSTALLATION, Upper Inner Trim.>

Tightening torque:

Rear seat belt lower anchor: 30 N·m (3.06 kgf·m, 22.1 ft·lb)

Trim panel - rear apron: 7.5 N·m (0.76 kgf·m, 5.5 ft·lb)