

10. Steering Satellite Switch

A: REMOVAL

- 1) Position the front wheels straight ahead. (After moving a vehicle 5 m (16 ft) or more with front wheels positioned straight ahead, make sure that the vehicle moves straight ahead.)
- 2) Turn the ignition switch to OFF.
- 3) Disconnect the ground cable from battery and wait for at least 60 seconds before starting work.
- 4) Remove the driver's airbag module.

CAUTION:

Before handling the airbag module, refer to “CAUTION” of “General Description” in “AIRBAG SYSTEM”. <Ref. to AB-9, CAUTION, General Description.>

- (1) Using a hexagon wrench etc. wrapped by protective tape, insert the snap pins and release the locks (3 locations).

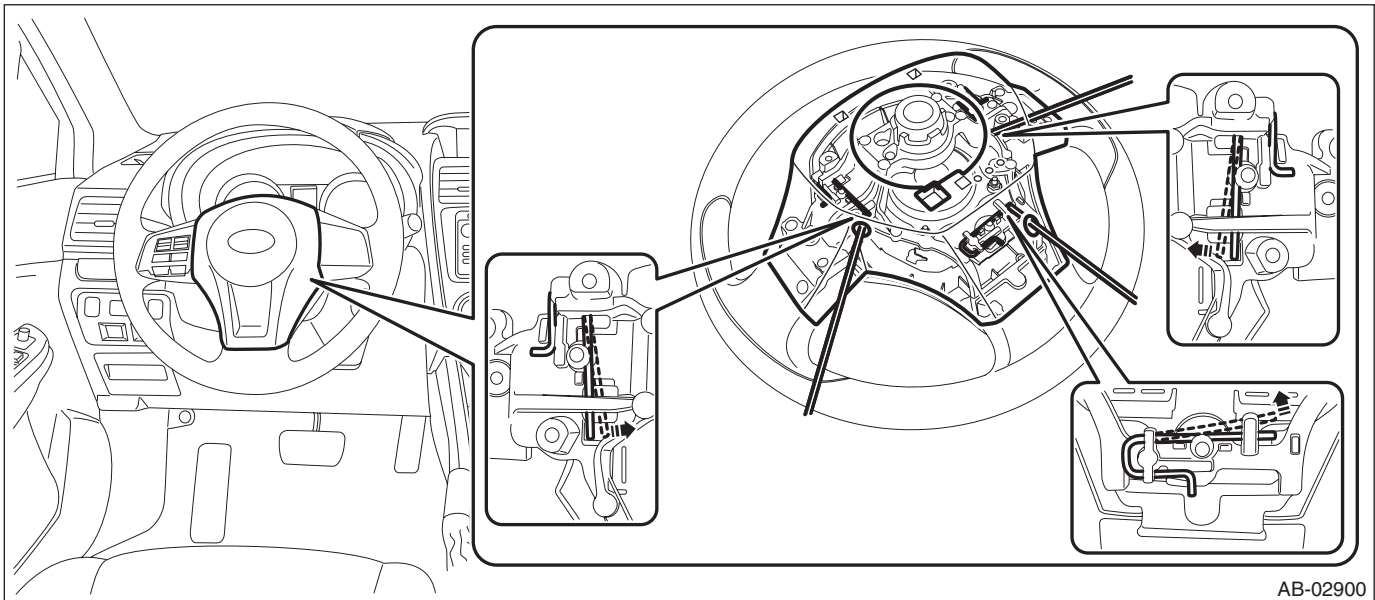

- (2) Disconnect the horn harness and airbag connector, and remove the driver's airbag module. <Ref. to AB-21, DRIVER'S AIRBAG MODULE, KNEE AIRBAG MODULE, CURTAIN AIRBAG MODULE AND PRETENSIONER, PROCEDURE, Airbag Connector.>

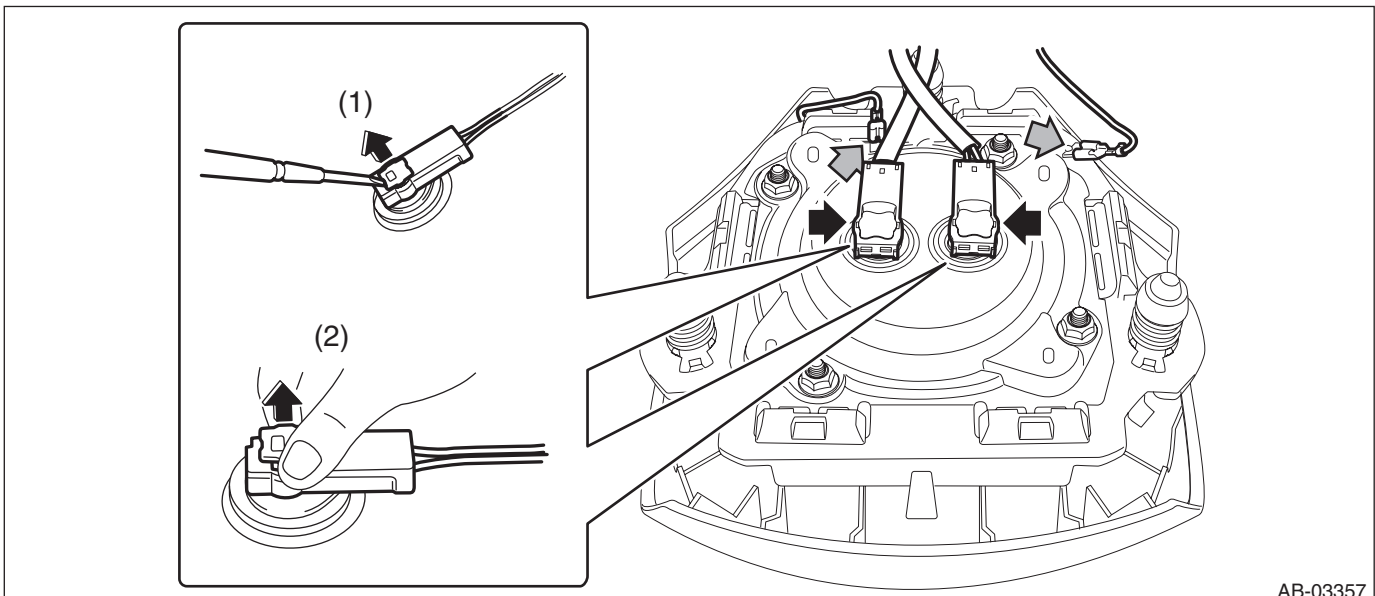

Steering Satellite Switch

ENTERTAINMENT

5) Remove the steering wheel.

CAUTION:

- Always use the steering wheel puller for removal to avoid deforming the steering wheel.
- If the steering wheel has been removed, make sure that the roll connector is not turned from the original position.

- (1) Disconnect the connector and remove the nut.
- (2) Put alignment marks and remove the steering wheel.

Preparation tool:

Steering wheel puller

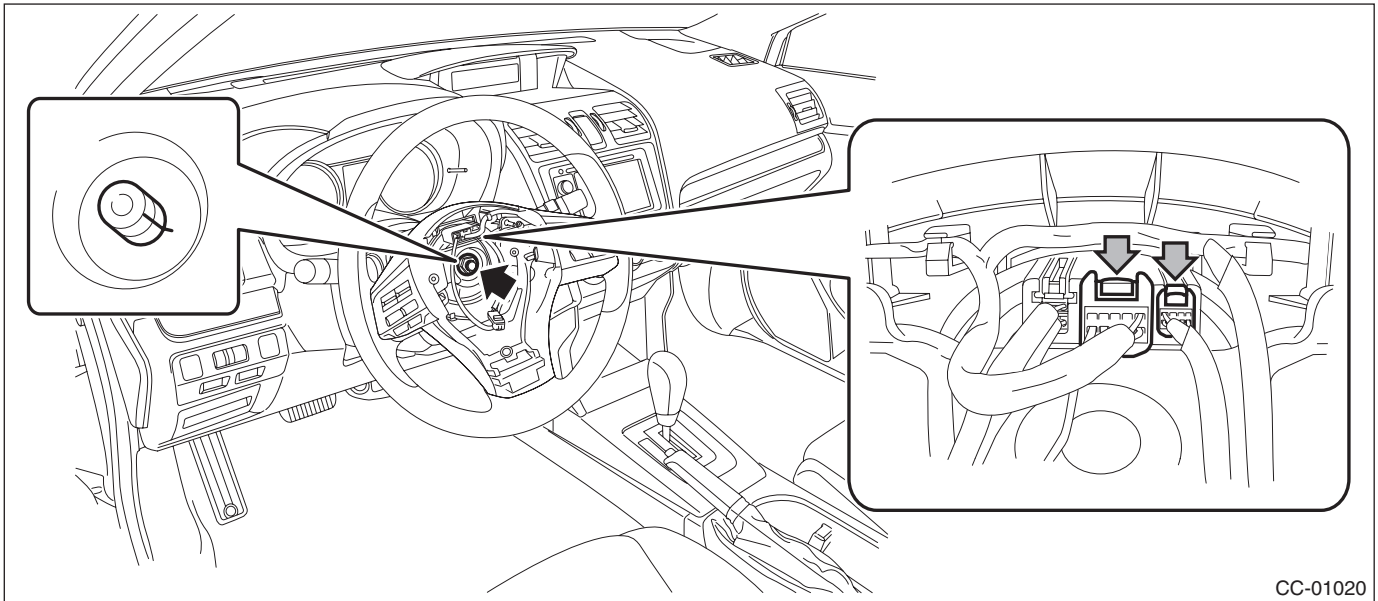

6) Remove the satellite switch assembly.

- (1) Remove the screw, disconnect the connector and remove the paddle shift switch. (Model with paddle shift)

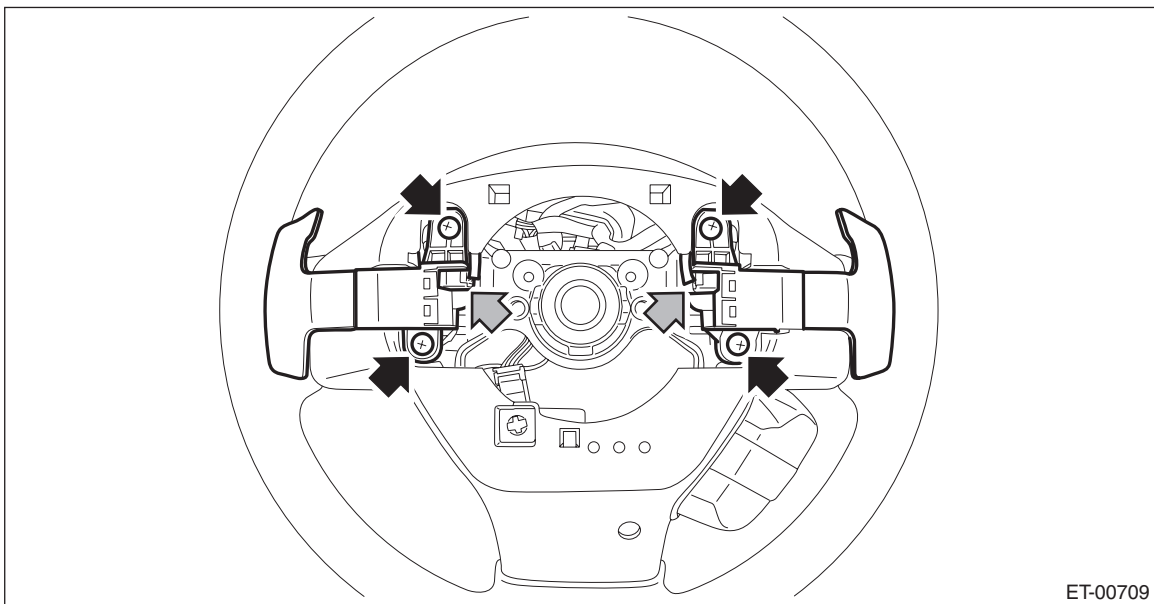

(2) Release the claws and clips, detach the cover - steering wheel LWR.

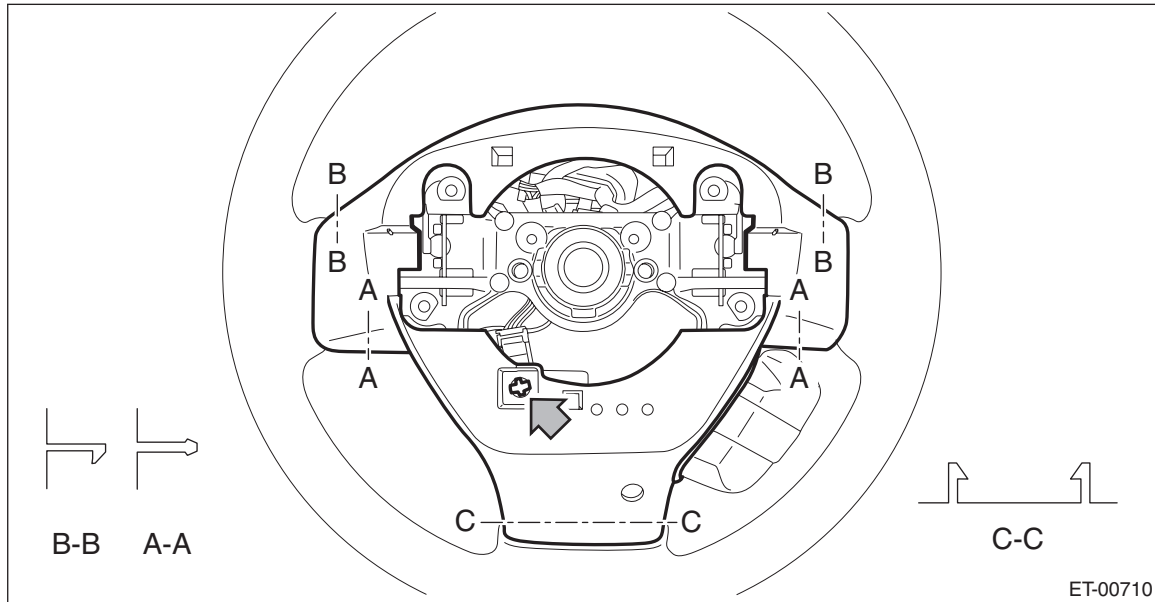

NOTE:

For model with steering switch, remove the connector and screw.

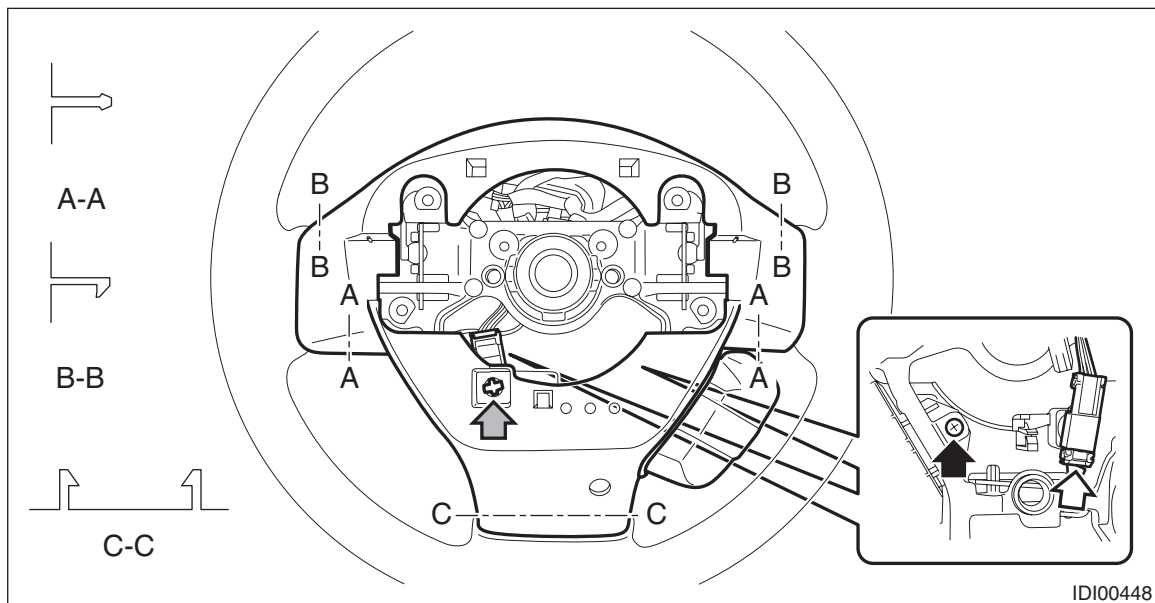

Steering Satellite Switch

ENTERTAINMENT

- (3) Remove the screws and then remove the satellite switch assembly.

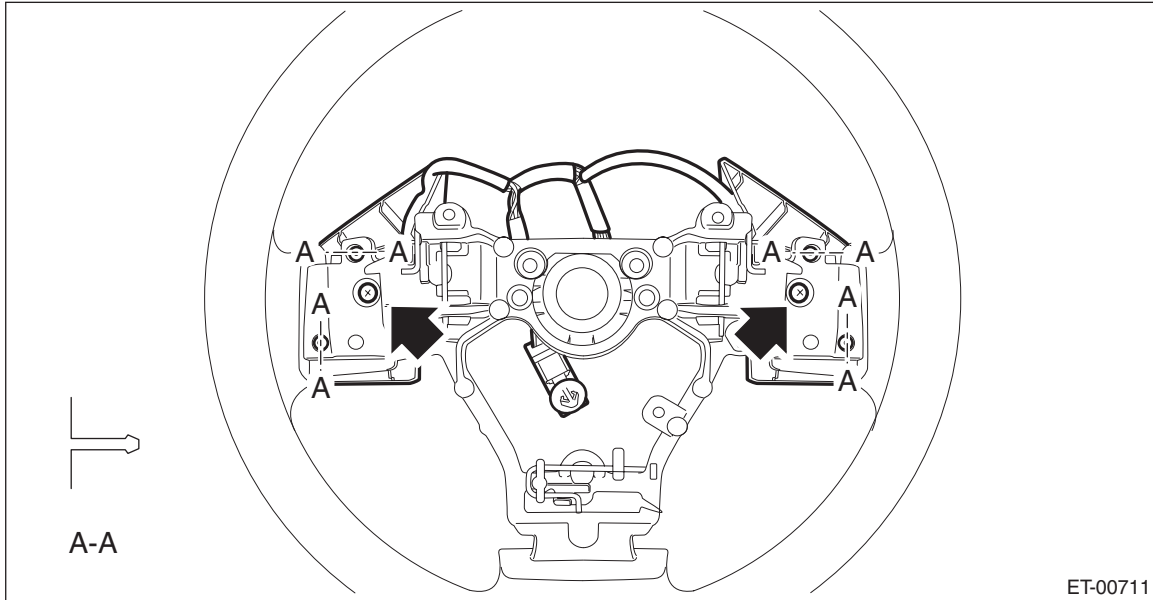

B: INSTALLATION

CAUTION:

- Before handling the airbag module, refer to “CAUTION” of “General Description” in “AIRBAG SYSTEM”. <Ref. to AB-9, CAUTION, General Description.>
 - Do not allow harness and connectors to interfere or get tangled up with other parts.
 - If the steering wheel and steering angle sensor are removed, adjust the steering angle sensor. <Ref. to VDC-23, ADJUSTMENT, VDC Control Module and Hydraulic Control Unit (VDCCM&H/U).>
- 1) Before installing steering wheel, be sure to adjust the direction of steering roll connector with steering wheel. <Ref. to AB-103, ADJUSTMENT, Roll Connector.>
- 2) Install each part in the reverse order of removal.

NOTE:

Align the alignment marks on the steering wheel and the column assembly - steering.

Tightening torque:

Steering wheel: 39 N·m (4.0 kgf-m, 28.8 ft-lb)

Clearance:

Between cover assembly - column and steering wheel: 4 — 6 mm (0.16 — 0.24 in)

C: INSPECTION

1) Check the resistance between switch terminals.

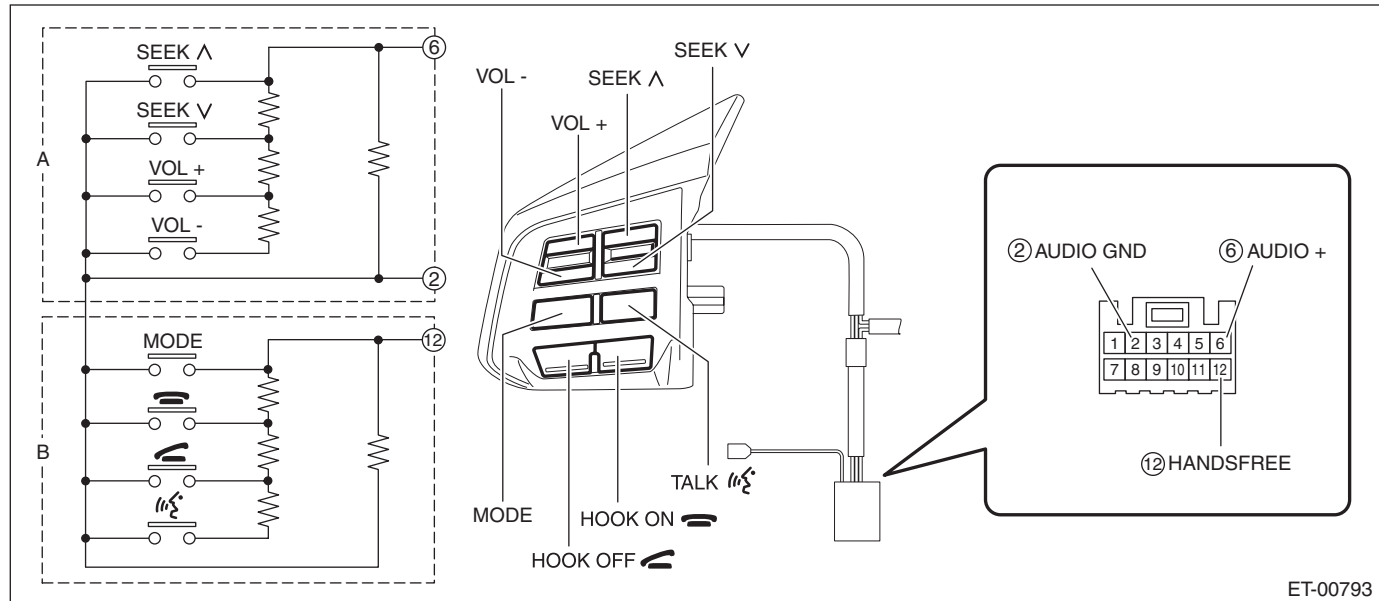

Terminal No.	Inspection conditions		Standard
6 — 2	SEEK (Δ) SEEK (∇) VOL (+) VOL (-)	A circuit is all OFF.	Approx. 100 kΩ
6 — 2	Preset CH UP/SEEK (Δ)	ON	Less than 1 Ω
6 — 2	Preset CH DOWN/SEEK (∇)	ON	Approx. 330 Ω
6 — 2	VOL (+)	ON	Approx. 1000 Ω
6 — 2	VOL (-)	ON	Approx. 3110 Ω
12 — 2	MODE HOOK ON HOOK OFF TALK	B circuit is all OFF.	Approx. 100 kΩ
12 — 2	MODE	ON	Less than 1 Ω
12 — 2	HOOK ON	ON	Approx. 330 Ω
12 — 2	HOOK OFF	ON	Approx. 1000 Ω
12 — 2	TALK	ON	Approx. 3110 Ω

2) If the result of the inspection is not within the standard value, replace the satellite switch assembly.