

13. Curtain Airbag Sensor

A: REMOVAL

CAUTION:

- Airbag system satellite safing sensor is located in the lower of the rear seat cushion center. Before removing the rear seat, refer to “CAUTION” of “General Description” in “AIRBAG SYSTEM” section. <Ref. to AB-9, CAUTION, General Description.>
- The airbag system is fitted with a backup power supply. After disconnecting the battery ground cable, the airbag may operate if you do not wait for 60 seconds before starting the service of airbag system.

- 1) Disconnect the ground cable from battery and wait for at least 60 seconds before starting work.
- 2) Remove the rear seat cushion assembly.
 - (1) Push the corners of the rear seat cushion from above.
 - (2) While pushing the corners of the rear seat cushion from above, pull the knob of the hook - seat cushion rear towards yourself.
 - (3) While pulling the knob towards yourself, disconnect the hooks by lifting up the rear seat cushion.

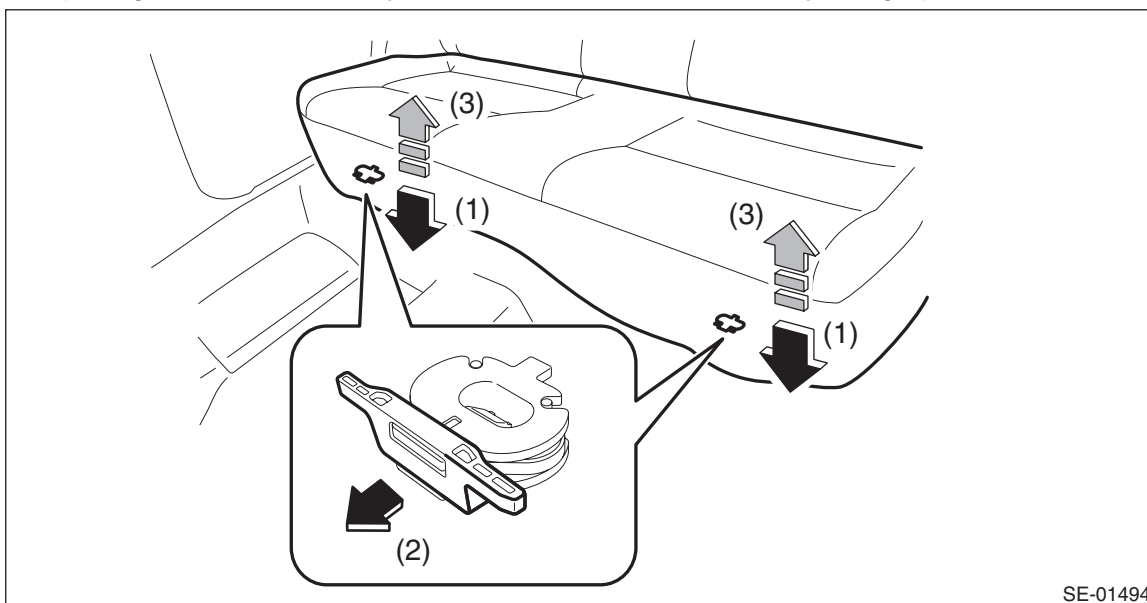

- (4) Remove the hook (A) by pushing it back while lifting the front side of the rear seat cushion, and remove the rear seat cushion.

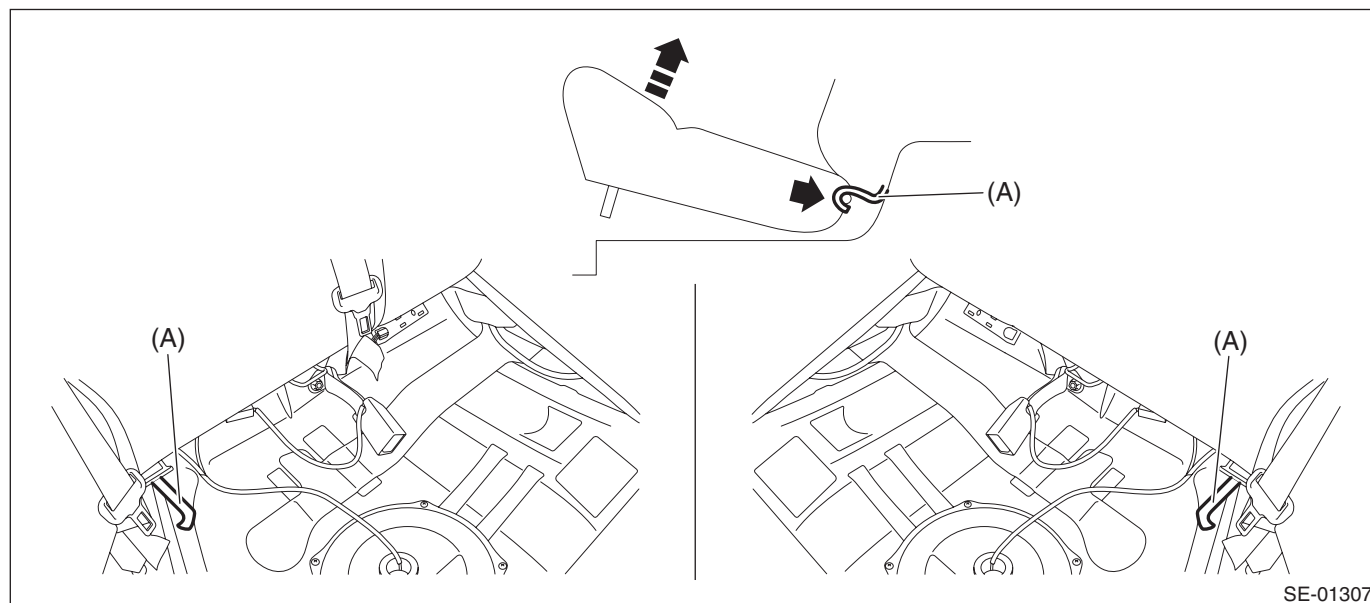

3) Release the clips and claws, and remove the side sill covers - rear INN on the left and right sides. (On the side where the curtain airbag sensor is removed)

CAUTION:

Do not pull with excessive force. Doing so may damage the claws of the side sill cover - rear INN.

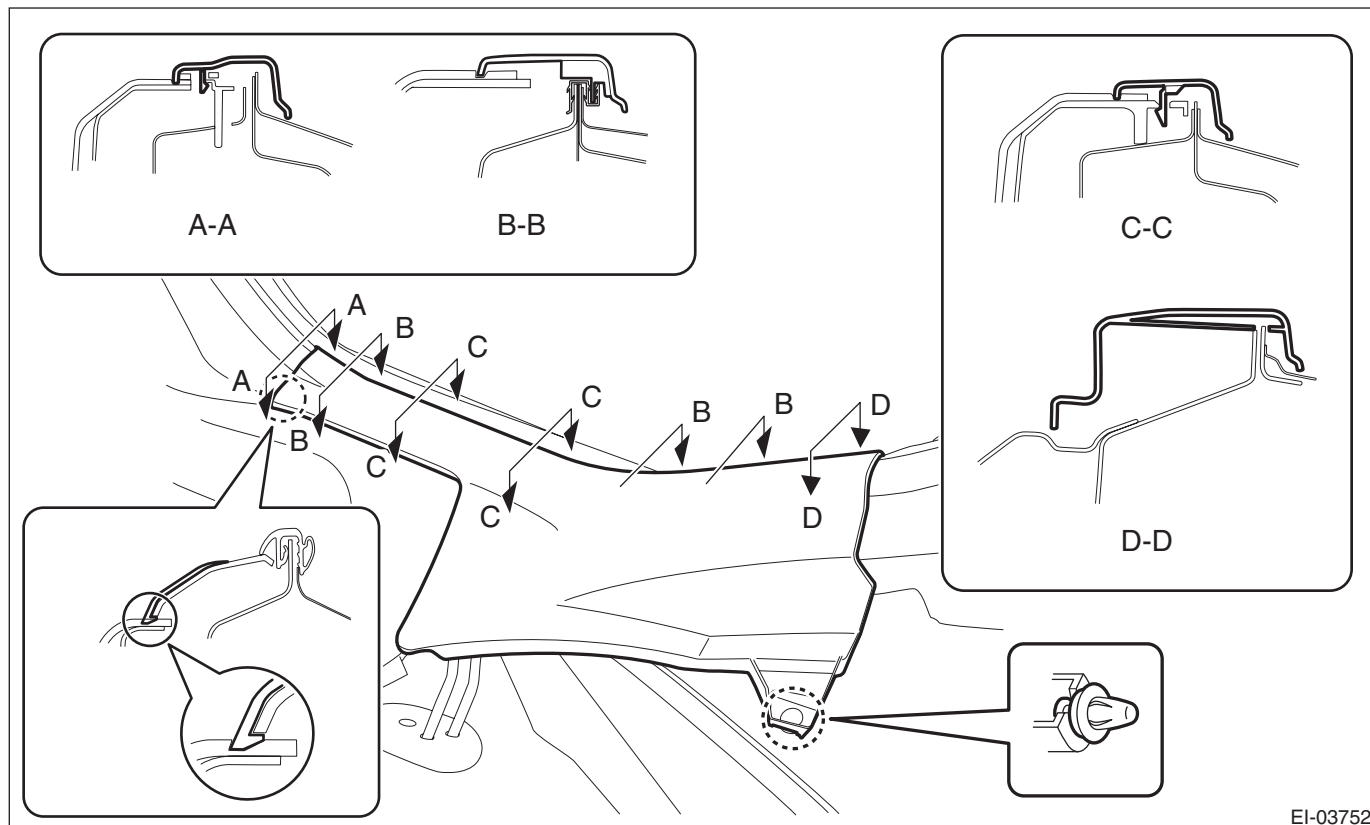

EI-03752

4) Remove the mat - rear floor, spacer - rear floor, and cover - trunk.

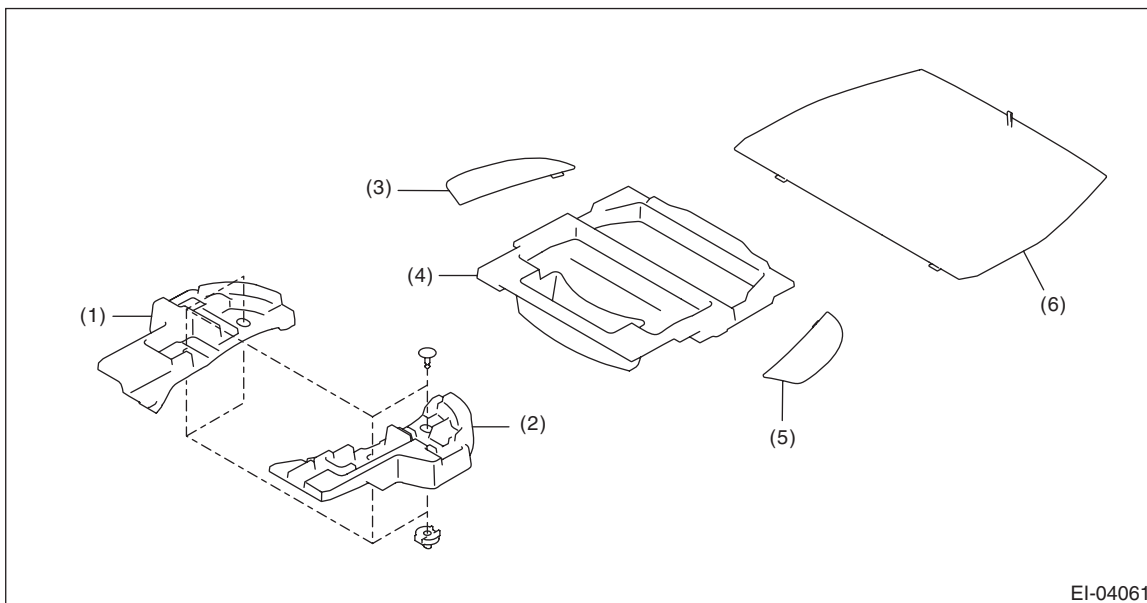

EI-04061

- (1) Spacer - rear floor side RH
- (2) Spacer - rear floor side LH

- (3) Mat - rear floor RH
- (4) Cover - trunk

- (5) Mat - rear floor LH
- (6) Mat - rear floor CTR

Curtain Airbag Sensor

AIRBAG SYSTEM

5) Remove the clips, and remove the trim panel - rear skirt.

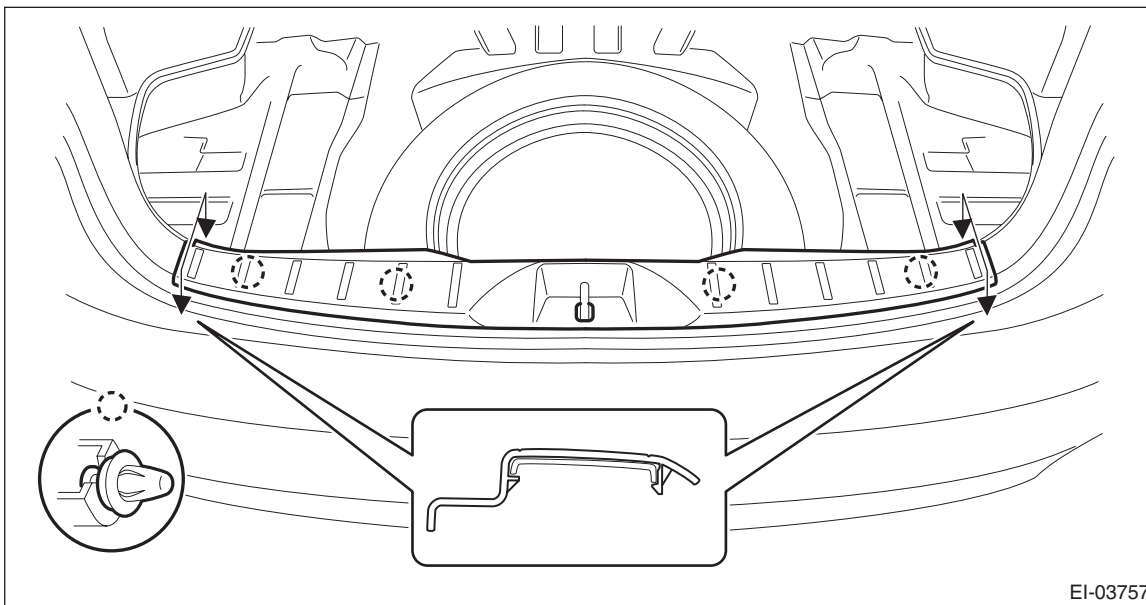

6) Remove the trim panel - rear apron. (On the side where the curtain airbag sensor is removed)

- (1) Open the cover, remove the bolts, and remove the hook - luggage. (2 places)
- (2) Remove the screws, and release the clips.
- (3) Disconnect the connectors and remove the trim panel - rear apron.

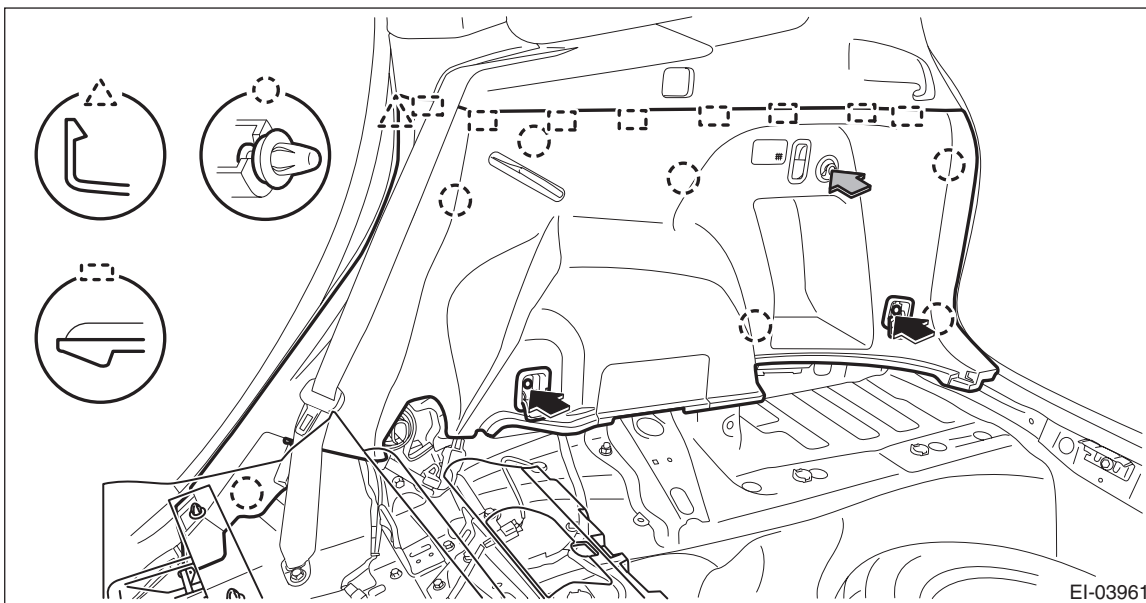

7) Remove the nuts and then remove the curtain airbag sensor. <Ref. to AB-25, SIDE AIRBAG SENSOR AND CURTAIN AIRBAG SENSOR, PROCEDURE, Airbag Connector.>

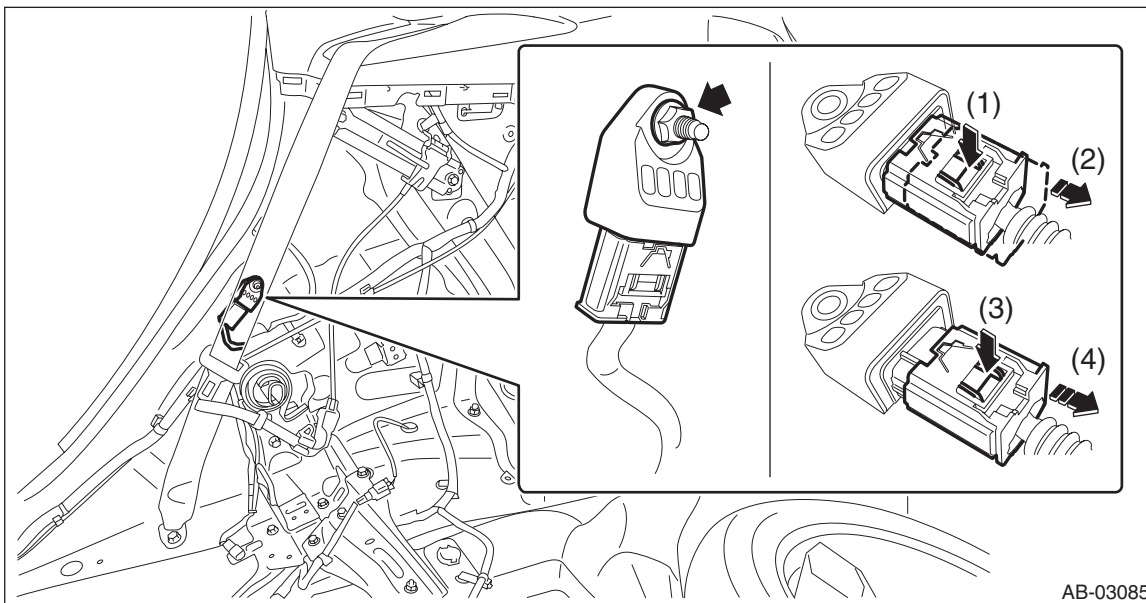

AB-03085

B: INSTALLATION

CAUTION:

- Do not reuse the bolt and nut.

Always replace with the specified new bolts and nuts.

- When installing the sensor, insert the set pin on the backside of the sensor into the hole on the body side securely.

1) Before installation, inspect the following items and replace any faulty part with a new one.

- Curtain airbag sensor or connector is damaged.
- Curtain airbag module has been activated.

2) Install each part in the reverse order of removal.

Tightening torque:

Curtain airbag sensor: 7.5 N·m (0.76 kgf-m, 5.5 ft-lb)

Rear seat backrest assembly: <Ref. to SE-6, REAR SEAT, COMPONENT, General Description.>