

## 6. Engine Oil Pressure

### A: INSPECTION

- 1) Remove the collector cover.
- 2) Disconnect the ground cable from the battery.

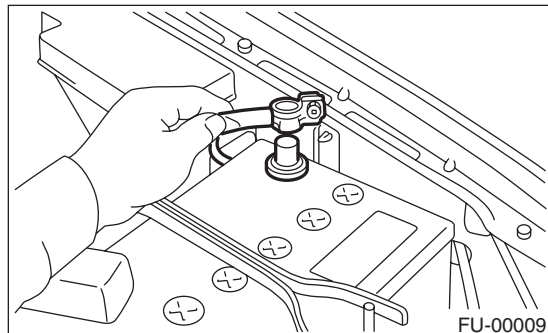

- 3) Remove the oil pressure switch. <Ref. to LU(H4SO)-21, REMOVAL, Oil Pressure Switch.>
- 4) Connect the oil pressure gauge hose to cylinder block.
- 5) Connect the ground cable to the battery.

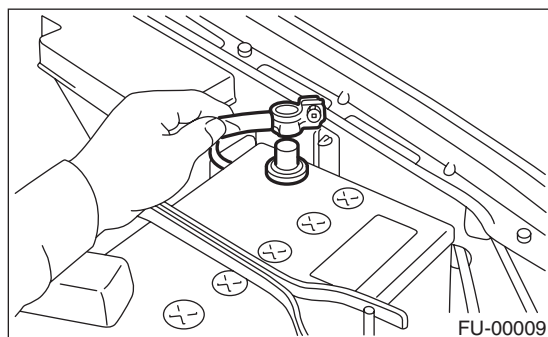

- 6) Start the engine, and measure the oil pressure.

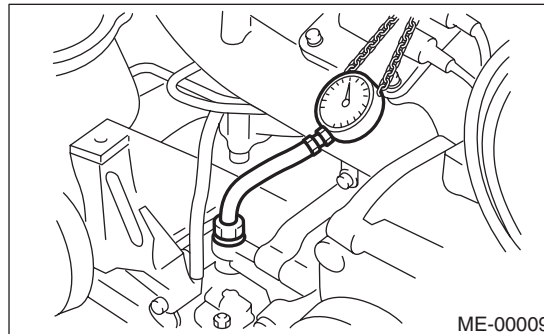

#### Oil pressure:

##### Standard

**98 kPa (1.0 kgf/cm<sup>2</sup>, 14 psi) or more  
(at 600 rpm)**

**294 kPa (3.0 kgf/cm<sup>2</sup>, 43 psi) or more  
(at 5,000 rpm)**

- If the oil pressure is out of specification, check the oil pump, oil filter and lubrication line. <Ref. to LU(H4SO)-26, INSPECTION, Engine Lubrication System Trouble in General.>
- If the oil pressure warning light is ON and oil pressure is within specification, check the oil pressure switch. <Ref. to LU(H4SO)-26, INSPECTION, Engine Lubrication System Trouble in General.>

#### NOTE:

Standard value is based on an engine oil temperature of 80°C (176°F).

- 7) After measuring the oil pressure, install the oil pressure switch. <Ref. to LU(H4SO)-21, INSTALLATION, Oil Pressure Switch.>

#### Tightening torque:

**25 N·m (2.5 kgf-m, 18.4 ft-lb)**