

### 5. Intake Duct

#### A: REMOVAL

1) Disconnect the ground cable from the battery.

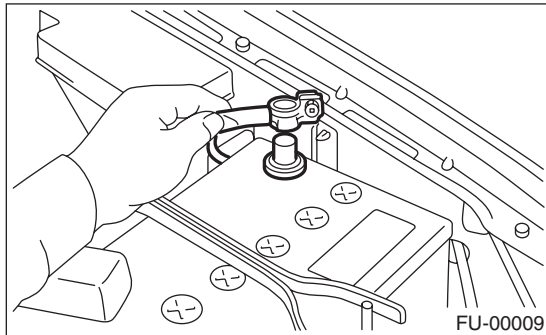

2) Remove the collector cover.

3) Remove the intake manifold.

<Ref. to FU(H4DOTC)-14, REMOVAL, Intake Manifold.>

4) Remove the sensor, engine harness and fuel pipe attached to the intake manifold. <Ref. to FU(H4DOTC)-20, DISASSEMBLY, Intake Manifold.>

5) Remove the intake duct from intake manifold.

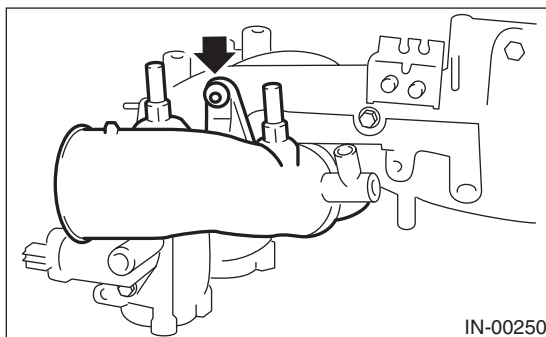

#### B: INSTALLATION

Install in the reverse order of removal.

**Tightening torque:**

**19 N·m (1.9 kgf-m, 14.0 ft-lb)**

