

Air Cleaner Case

INTAKE (INDUCTION)

3. Air Cleaner Case

A: REMOVAL

- 1) Disconnect the ground cable from the battery.

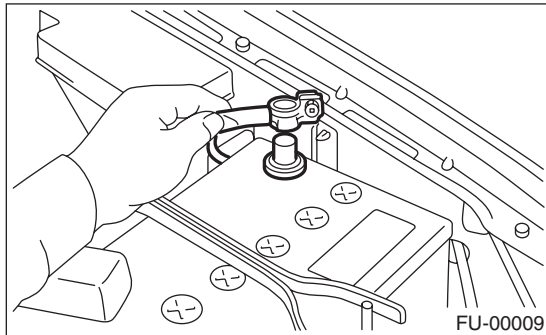

- 2) Disconnect the connector from mass air flow and intake air temperature sensor.

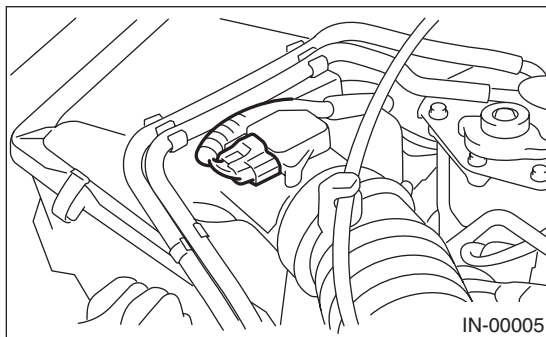

- 3) Loosen the clamps (A) which connect the air intake boot and the intake duct.
4) Remove the clip (B) from air cleaner upper cover.

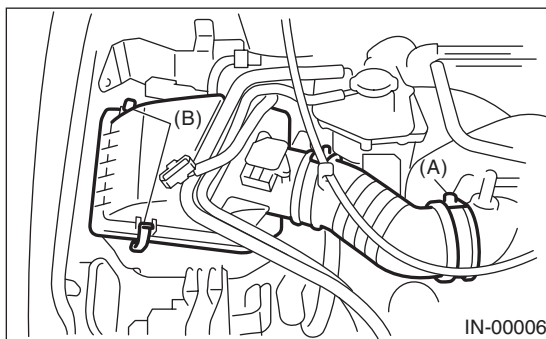

- 5) Remove the air cleaner upper cover.
6) Remove the air cleaner element.
7) Remove the air cleaner lower case.

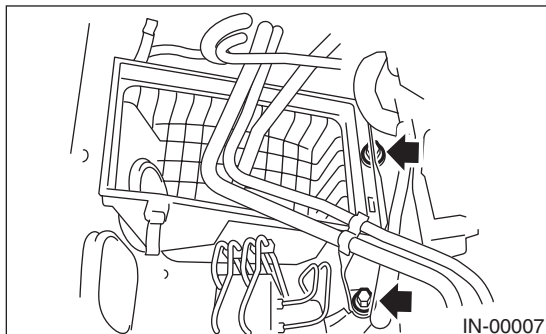

B: INSTALLATION

Install in the reverse order of removal.

Tightening torque:

33 N·m (3.4 kgf-m, 24.3 ft-lb)

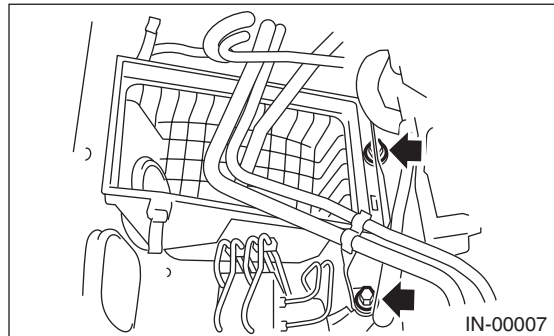

NOTE:

Before installing the air cleaner upper cover, align the protrusion with the hole of air cleaner lower case, and then secure the upper cover and lower case.

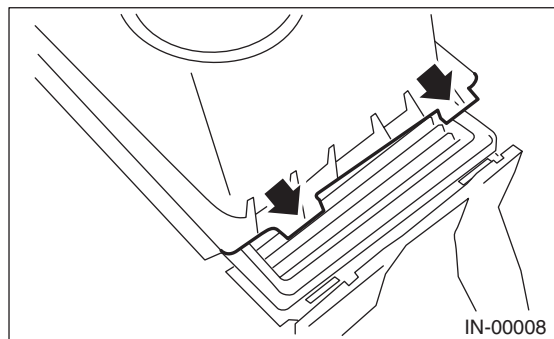

C: INSPECTION

Check for cracks or loose connection.