

Engine Coolant Temperature Sensor

FUEL INJECTION (FUEL SYSTEMS)

4. Engine Coolant Temperature Sensor

A: REMOVAL

1) Disconnect the ground cable from the battery.

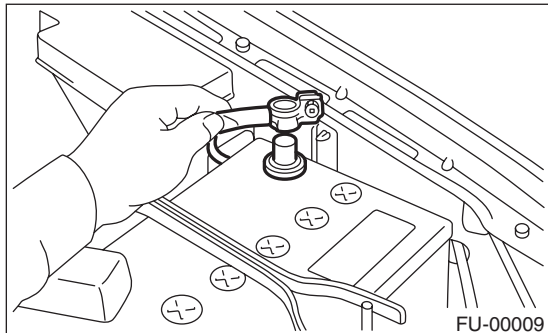

2) Remove the collector cover.

3) Remove the generator. <Ref. to SC(H4SO)-14, REMOVAL, Generator.>

4) Drain the engine coolant. <Ref. to CO(H4SO)-17, DRAINING OF ENGINE COOLANT, REPLACEMENT, Engine Coolant.>

5) Disconnect the connectors from the engine coolant temperature sensor.

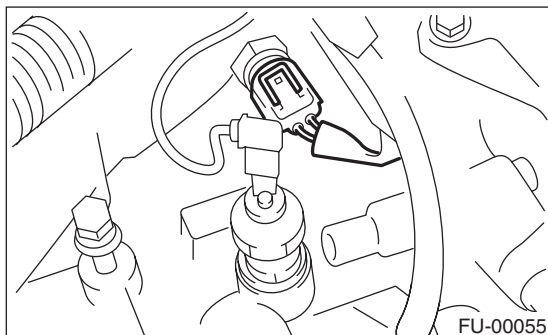

6) Remove the engine coolant temperature sensor.

B: INSTALLATION

Install in the reverse order of removal.

NOTE:

Use a new gasket.

Tightening torque:

18 N·m (1.8 kgf-m, 13.3 ft-lb)