

## Fuel Sub Level Sensor

FUEL INJECTION (FUEL SYSTEMS)

### 28. Fuel Sub Level Sensor

#### A: REMOVAL

##### WARNING:

Place "NO FIRE" signs near the working area.

##### CAUTION:

Be careful not to spill fuel.

1) Disconnect the ground cable from the battery.

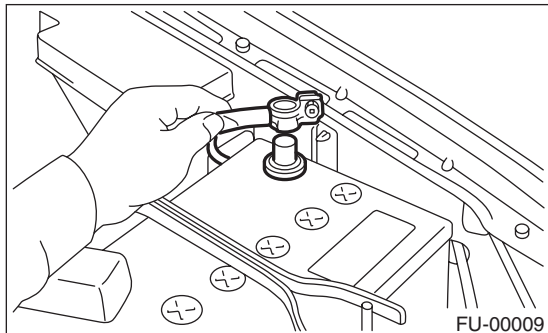

2) Remove the luggage floor mat. <Ref. to EI-48, REMOVAL, Luggage Floor Mat.>

3) Remove the service hole cover.

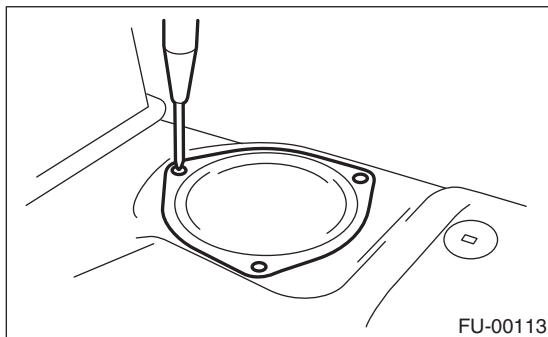

4) Disconnect the connector from the fuel sub level sensor.

5) Disconnect the fuel jet pump hose.

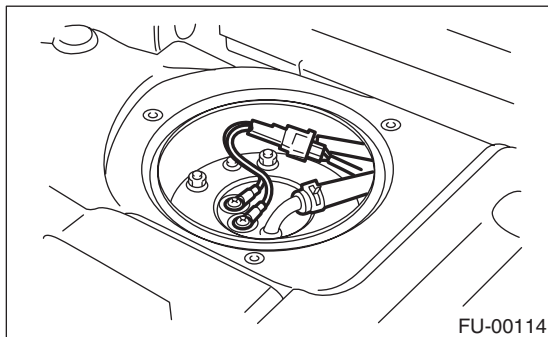

6) Remove the bolts which install fuel sub level sensor on fuel tank.

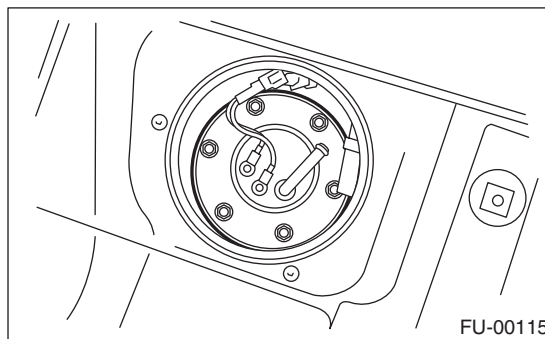

7) Remove the fuel sub level sensor.

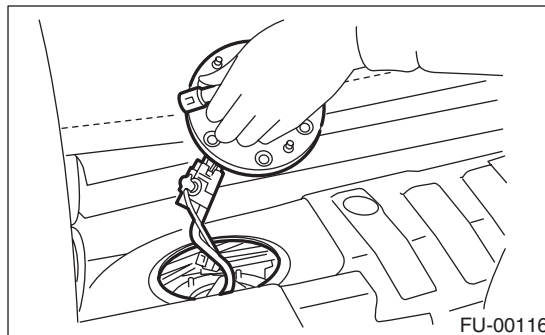

#### B: INSTALLATION

Install in the reverse order of removal while being careful of the following.

- Make sure the sealing portion is free from fuel or foreign matter before installation.
- Tighten the nuts to the specified torque in the order as shown in the figure.

##### NOTE:

Use a new gasket.

##### Tightening torque:

**4.4 N·m (0.45 kgf-m, 3.3 ft-lb)**

