

26. Fuel Pump

A: REMOVAL

WARNING:

Place “NO FIRE” signs near the working area.

CAUTION:

Be careful not to spill fuel.

NOTE:

Fuel pump assembly consists of fuel pump, fuel filter and fuel level sensor.

1) Release the fuel pressure. <Ref. to FU(H4DOTC)-51, RELEASING OF FUEL PRESSURE, PROCEDURE, Fuel.>

2) Disconnect the ground cable from the battery.

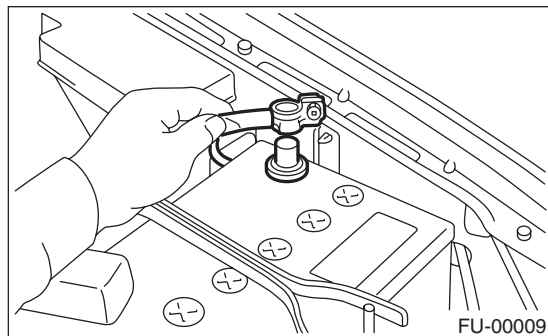

3) Open the fuel filler flap lid, and remove the fuel filler cap.

4) Remove the luggage floor mat. <Ref. to EI-48, REMOVAL, Luggage Floor Mat.>

5) Remove the service hole cover.

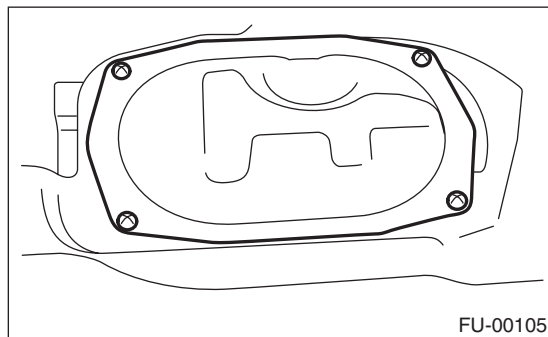

6) Disconnect the connector from fuel pump.

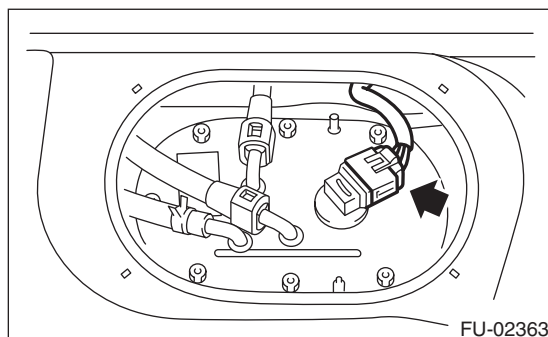

7) Disconnect the quick connector and then disconnect the fuel delivery hose and fuel return tube. <Ref. to FU(H4DOTC)-66, REMOVAL, Fuel Delivery, Return and Evaporation Lines.>

8) Move the clips, and disconnect the jet pump hose (A).

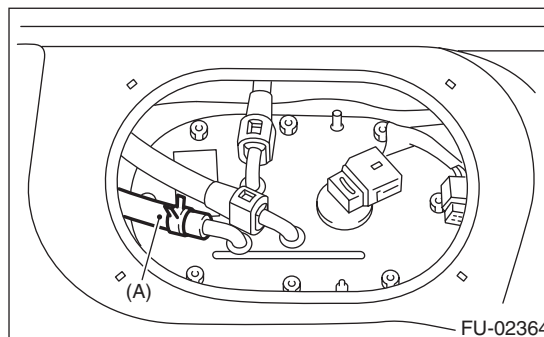

9) Remove the nuts which install fuel pump assembly onto fuel tank.

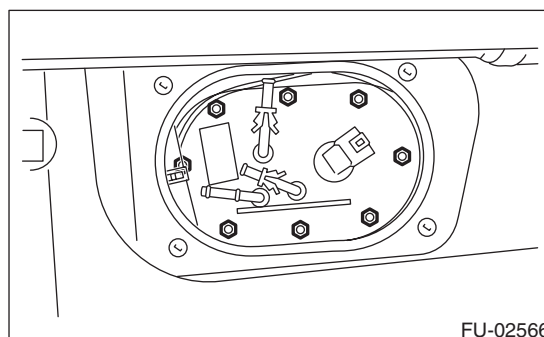

10) Remove the fuel pump assembly from the fuel tank.

B: INSTALLATION

Install in the reverse order of removal while being careful of the following.

- Make sure the sealing portion is free from fuel or foreign matter before installation.
- Tighten the nuts in alphabetical sequence shown in the figure to the specified torque.

NOTE:

Use a new gasket and retainer.

Tightening torque:

4.4 N·m (0.45 kgf·m, 3.3 ft·lb)

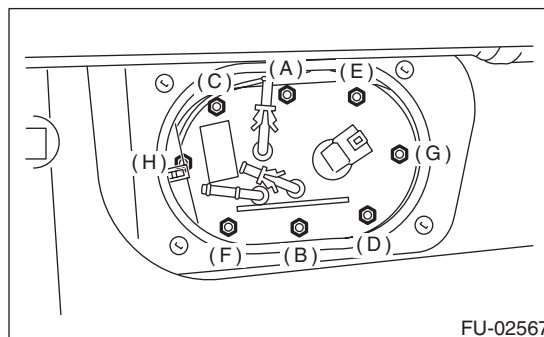

Fuel Pump

FUEL INJECTION (FUEL SYSTEMS)

C: INSPECTION

Connect the lead harness to the connector terminal of fuel pump, and apply the battery power supply to check whether the pump operates.

CAUTION:

- Wipe off fuel completely.
- Keep the battery as far apart from fuel pump as possible.
- Be sure to perform the ON/OFF operation on the battery side.
- Do not run the fuel pump for a long time under non-load condition.

