

23. Fuel

A: PROCEDURE

1. RELEASING OF FUEL PRESSURE

WARNING:

Place “NO FIRE” signs near the working area.

CAUTION:

Be careful not to spill fuel.

- 1) Remove the glove box. <Ref. to EI-35, REMOVAL, Glove Box.>
- 2) Remove the side sill cover on the passenger's side.
- 3) Disconnect the connector from fuel pump relay.

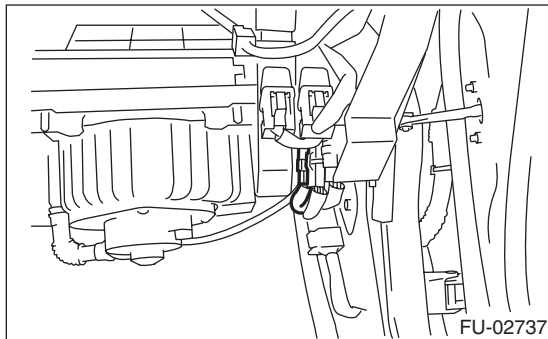

- 4) Start the engine and run it until it stalls.
- 5) After the engine stalls, crank it for five more seconds.
- 6) Turn the ignition switch to OFF.

2. DRAINING FUEL

WARNING:

Place “NO FIRE” signs near the working area.

CAUTION:

Be careful not to spill fuel.

- 1) Release the fuel pressure. <Ref. to FU(H4DOTC)-51, RELEASING OF FUEL PRESSURE, PROCEDURE, Fuel.>
- 2) Disconnect the ground cable from the battery.

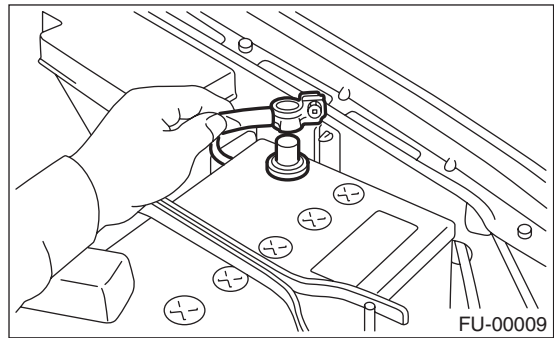

- 3) Remove the fuel pump. <Ref. to FU(H4DOTC)-59, REMOVAL, Fuel Pump.>
- 4) Drain fuel using a pump etc. from installation area of fuel pump.

CAUTION:

Use pumps, etc. which are resistant to gasoline.

- 5) Install the fuel pump. <Ref. to FU(H4DOTC)-59, INSTALLATION, Fuel Pump.>