

# Fuel Pump Control Unit

FUEL INJECTION (FUEL SYSTEMS)

## 22. Fuel Pump Control Unit

### A: REMOVAL

- 1) Disconnect the ground cable from the battery.

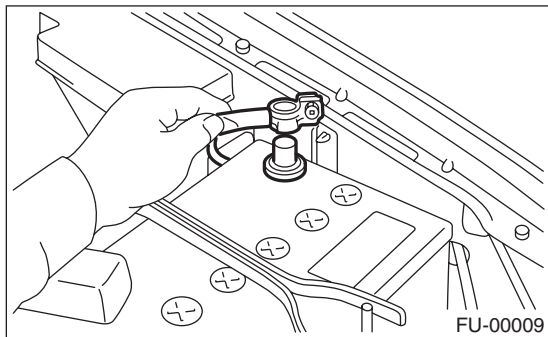

- 2) Remove the rear quarter trim. <Ref. to EI-43, REMOVAL, Rear Quarter Trim.>
- 3) Disconnect the connector from fuel pump control unit.
- 4) Remove the fuel pump control unit.

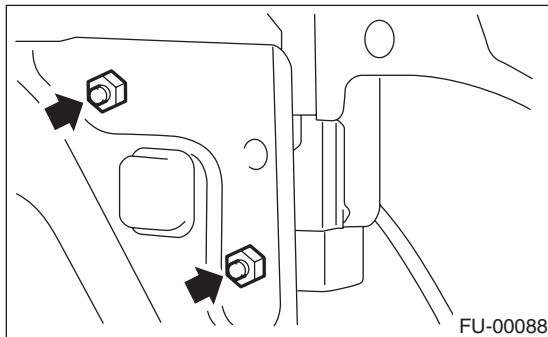

### B: INSTALLATION

Install in the reverse order of removal.

**Tightening torque:**

**5 N·m (0.5 kgf-m, 3.7 ft-lb)**

