

Rear Oxygen Sensor

FUEL INJECTION (FUEL SYSTEMS)

17.Rear Oxygen Sensor

A: REMOVAL

- 1) Set the vehicle on a lift.
- 2) Disconnect the ground cable from the battery.

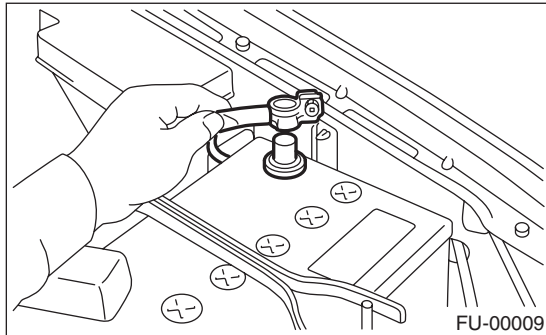

- 3) Lift up the vehicle.
- 4) Disconnect the connector from the rear oxygen sensor.

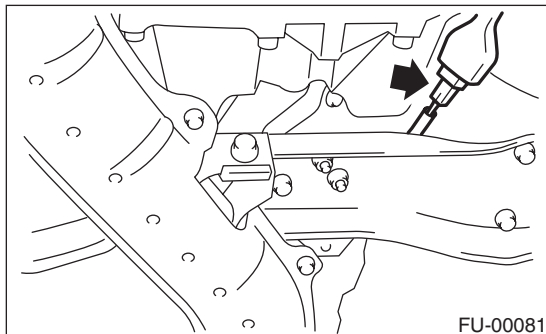

- 5) Remove the clip by pulling out from the upper side of crossmember.

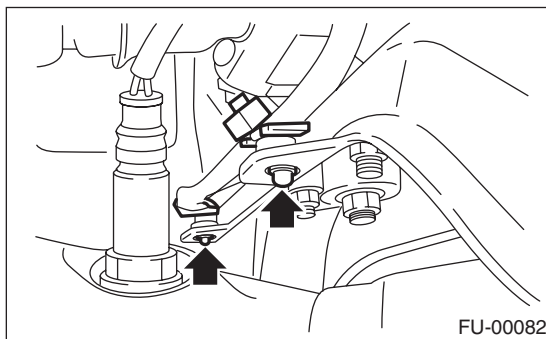

- 6) Apply spray-type lubricant to the threaded portion of rear oxygen sensor, and leave it for one minute or more.

- 7) Remove the rear oxygen sensor.

CAUTION:

When removing the rear oxygen (A/F) sensor, wait until exhaust pipe cools, otherwise it will damage the exhaust pipe.

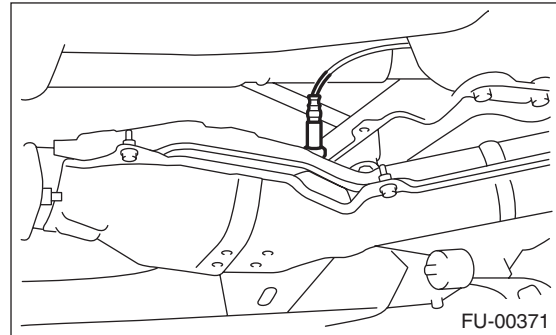

B: INSTALLATION

1) Before installing rear oxygen sensor, apply the anti-seize compound only to the threaded portion of rear oxygen sensor. This facilitates the next removal.

CAUTION:

Never apply anti-seize compound to the protector of rear oxygen sensor.

Anti-seize compound:

NEVER-SEEZ NSN, JET LUBE SS-30 or the equivalent

2) Install the rear oxygen sensor.

Tightening torque:

21 N·m (2.1 kgf-m, 15.5 ft-lb)

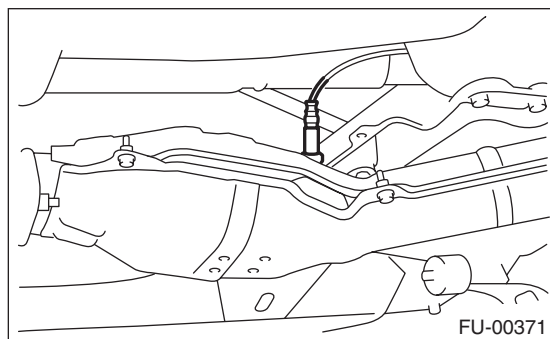

• AT model

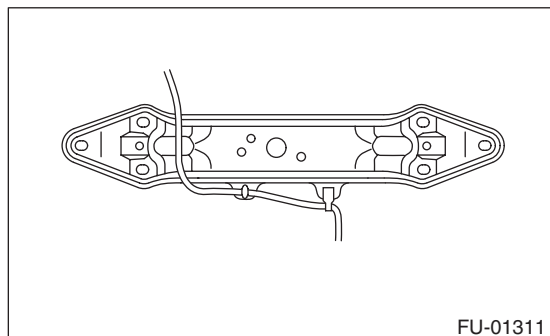

• MT model

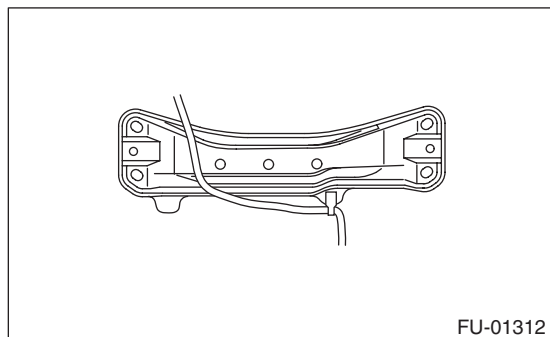

3) Connect the rear oxygen sensor connector.

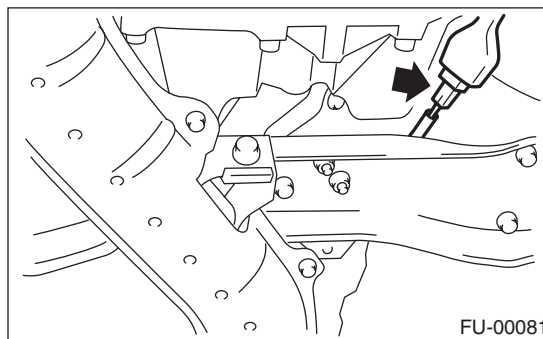

4) Connect the clip to the crossmember.

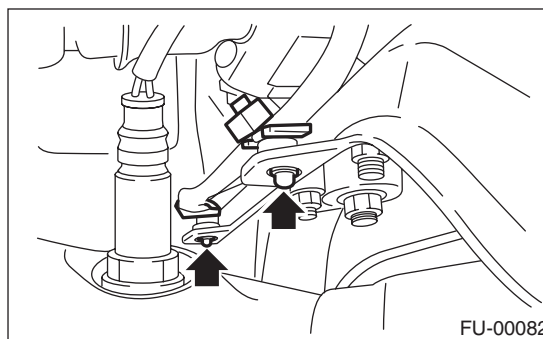

5) Lower the vehicle.

6) Connect the ground cable to the battery.

