

Purge Control Solenoid Valve

EMISSION CONTROL (AUX. EMISSION CONTROL DEVICES)

5. Purge Control Solenoid Valve

A: REMOVAL

1) Disconnect the ground cable from the battery.

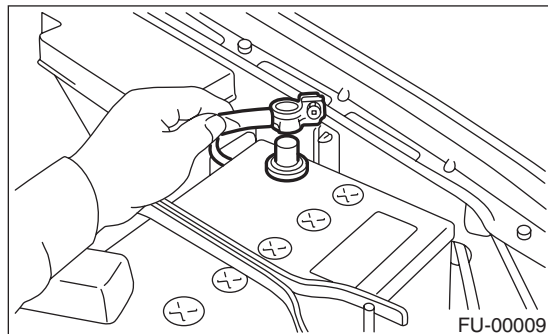

2) Disconnect the connector and hoses from purge control solenoid valve.

3) Loosen the bolt and remove the purge control solenoid valve from the intake manifold.

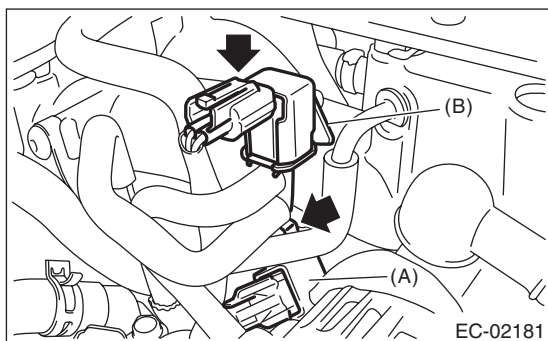

- (A) Purge control solenoid valve 1
- (B) Purge control solenoid valve 2

B: INSTALLATION

Install in the reverse order of removal.

Tightening torque:

19 N·m (1.9 kgf-m, 14.0 ft-lb)

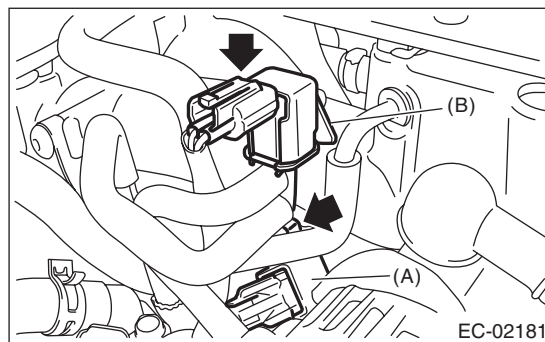

- (A) Purge control solenoid valve 1
- (B) Purge control solenoid valve 2

NOTE:

Connect the evaporation hose as shown in the figure.

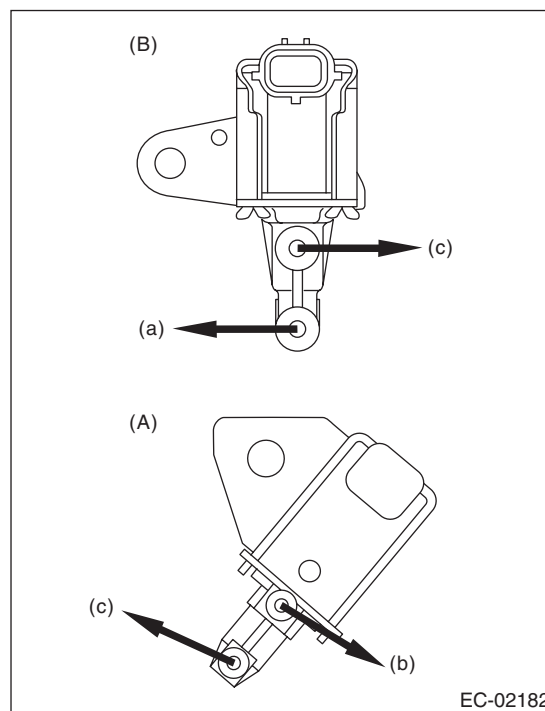

- (A) Purge control solenoid valve 1
- (B) Purge control solenoid valve 2
- (a) To intake duct
- (b) To intake manifold
- (c) To splitter and then to fuel pipe

C: INSPECTION

Make sure the hoses are not cracked or loose.