

PCV Hose Assembly

EMISSION CONTROL (AUX. EMISSION CONTROL DEVICES)

17.PCV Hose Assembly

A: REMOVAL

CAUTION:

Do not remove if the PCV hose, diagnostics connector and PCV valve are not damaged.

1) Remove the intake manifold.

<Ref. to FU(H4DOTC)-14, REMOVAL, Intake Manifold.>

2) Fit the depression in the ST with the protrusion on the clamp to unlock.

3) Remove the PCV hose assembly.

ST 18353AA000 CLAMP PLIERS

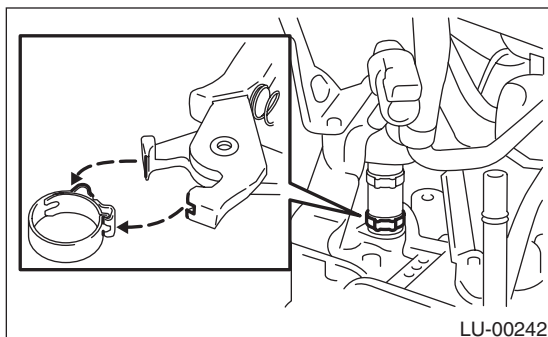

LU-00242

B: INSTALLATION

1) Install the PCV hose assembly, then lock by fitting the ST on the clamp protrusion.

NOTE:

Use a new clamp.

ST 18353AA000 CLAMP PLIERS

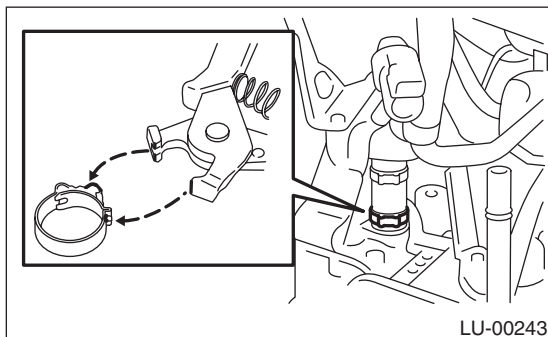

LU-00243

2) Install the intake manifold.

<Ref. to FU(H4DOTC)-17, INSTALLATION, Intake Manifold.>