

Drain Valve

EMISSION CONTROL (AUX. EMISSION CONTROL DEVICES)

16.Drain Valve

A: REMOVAL

- 1) Set the vehicle on a lift.
- 2) Disconnect the ground cable from the battery.

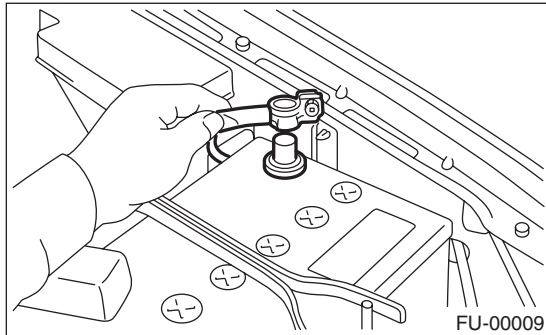

- 3) Lift up the vehicle.
- 4) Remove the canister. <Ref. to EC(H4DOTC)-7, REMOVAL, Canister.>
- 5) Disengage the clip, then remove the drain valve from the canister.

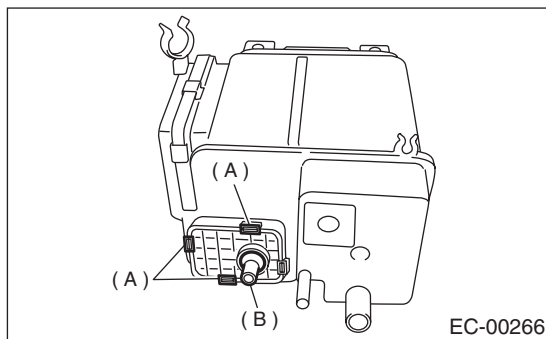

- (A) Clip
(B) Drain valve

B: INSTALLATION

Install in the reverse order of removal.

NOTE:

Use a new clip.

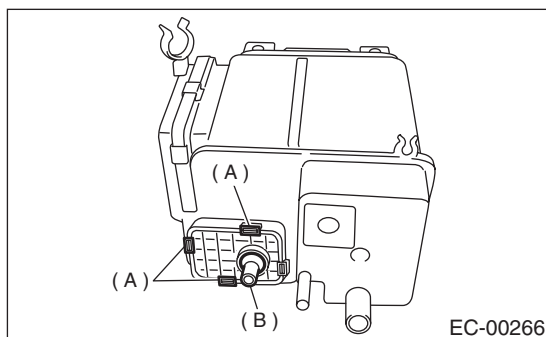

- (A) Clip
(B) Drain valve