

6. Engine Oil Pressure

A: INSPECTION

1) Disconnect the ground cable from battery.

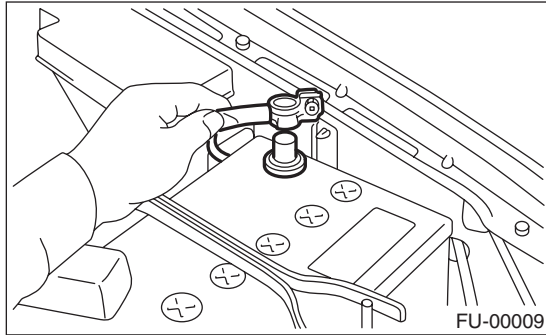

2) Remove the oil pressure switch. <Ref. to LU(H4SO)-21, REMOVAL, Oil Pressure Switch.>

3) Connect the oil pressure gauge to cylinder block.

4) Connect the ground cable to the battery.

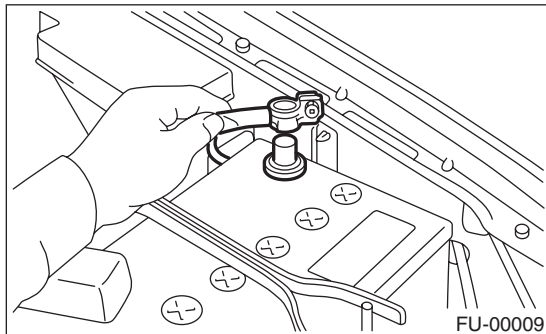

5) Start the engine, and measure the oil pressure.

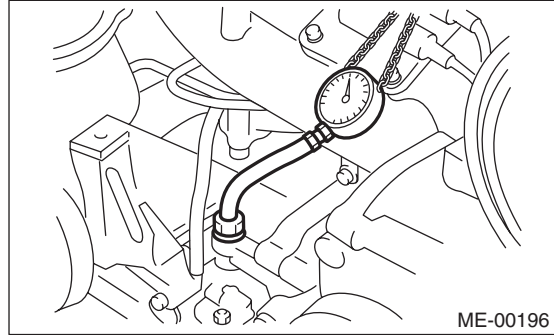

Oil pressure:

Standard

98 kPa (1.0 kg/cm², 14 psi) or more at 600 rpm

294 kPa (3.0 kg/cm², 43 psi) or more at 5,000 rpm

- If the oil pressure is out of specification, check the oil pump, oil filter and lubrication line. <Ref. to LU(H4SO)-26, INSPECTION, Engine Lubrication System Trouble in General.>

- If the oil pressure warning light is ON and oil pressure is within specification, check the oil pressure switch. <Ref. to LU(H4SO)-26, INSPECTION, Engine Lubrication System Trouble in General.>

NOTE:

Standard value is based on an engine oil temperature of 80°C (176°F).

6) After measuring the oil pressure, install the oil pressure switch. <Ref. to LU(H4SO)-21, INSTALLATION, Oil Pressure Switch.>

Tightening torque:

25 N·m (2.5 kgf-m, 18.4 ft-lb)