

# Oil Switching Solenoid Valve

## MECHANICAL

## 22.Oil Switching Solenoid Valve

### A: REMOVAL

#### 1. RH SIDE

- 1) Disconnect the ground cable from the battery.

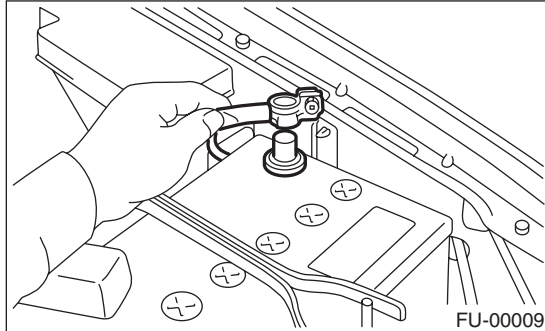

- 2) Remove the air intake chamber.  
<Ref. to IN(H4SO)-6, REMOVAL, Air Intake Chamber.>
- 3) Remove the engine harness connector from the bracket.

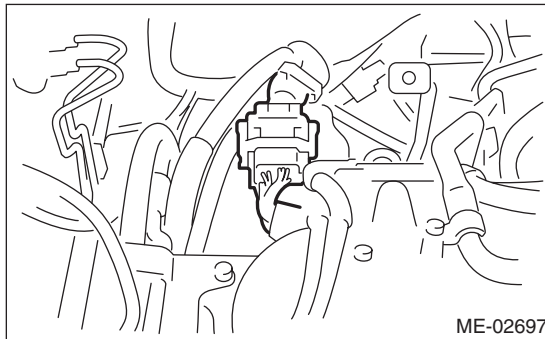

- 4) Disconnect the connector from the oil switching solenoid valve.
- 5) Remove the oil switching solenoid valve.
- 6) Remove the variable valve lift diagnosis oil pressure switch.  
<Ref. to FU(H4SO)-35, REMOVAL, Variable Valve Lift Diagnosis Oil Pressure Switch.>
- 7) Remove the oil temperature sensor.  
<Ref. to FU(H4SO)-36, REMOVAL, Oil Temperature Sensor.>

- 8) Remove the oil switching solenoid valve holder from the cylinder head.

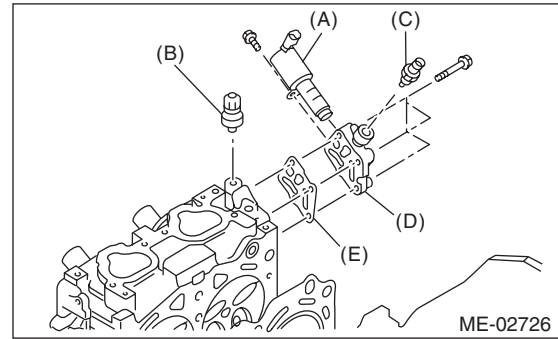

- (A) Oil switching solenoid valve
- (B) Variable valve lift diagnosis oil pressure switch
- (C) Oil temperature sensor
- (D) Oil switching solenoid valve holder
- (E) Gasket

#### 2. LH SIDE

- 1) Disconnect the ground cable from the battery.

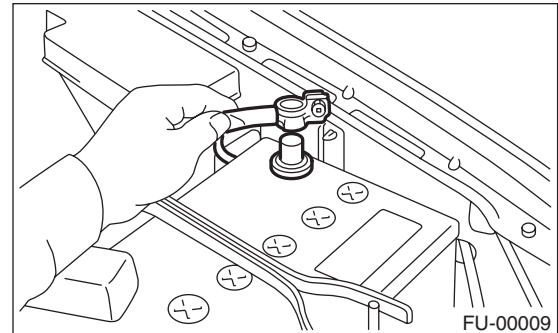

- 2) Remove the V-belts.  
<Ref. to ME(H4SO)-41, REMOVAL, V-belt.>
- 3) Remove the crank pulley.  
<Ref. to ME(H4SO)-43, REMOVAL, Crank Pulley.>
- 4) Remove the timing belt cover.  
<Ref. to ME(H4SO)-44, REMOVAL, Timing Belt Cover.>
- 5) Remove the timing belt.  
<Ref. to ME(H4SO)-45, REMOVAL, Timing Belt.>
- 6) Remove the cam sprocket.  
<Ref. to ME(H4SO)-50, REMOVAL, Cam Sprocket.>
- 7) Remove the timing belt cover No. 2 (LH).
- 8) Disconnect the connector from the oil switching solenoid valve.
- 9) Remove the oil switching solenoid valve.
- 10) Remove the variable valve lift diagnosis oil pressure switch.  
<Ref. to FU(H4SO)-35, REMOVAL, Variable Valve Lift Diagnosis Oil Pressure Switch.>

11) Remove the oil switching solenoid valve holder from the cylinder head.

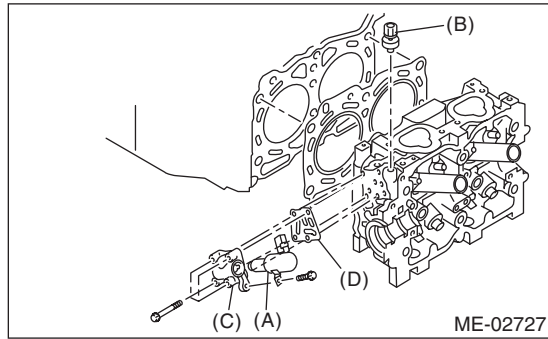

- (A) Oil switching solenoid valve
- (B) Variable valve lift diagnosis oil pressure switch
- (C) Oil switching solenoid valve holder
- (D) Gasket

## B: INSTALLATION

### 1. RH SIDE

Install in the reverse order of removal.

#### NOTE:

- Use a new gasket.
- Apply liquid gasket to the variable valve lift diagnosis oil pressure switch threads.
- Install the oil switching solenoid valve to the holder, then install it to the cylinder head.

#### Liquid gasket:

**THREE BOND 1324 (Part No. 004403042) or equivalent**

#### Tightening torque:

**T1**

**8 N·m (0.8 kgf-m, 5.9 ft-lb)**

**T2**

**10 N·m (1.0 kgf-m, 7.4 ft-lb)**

**T3**

**17 N·m (1.7 kgf-m, 12.5 ft-lb)**

**T4**

**18 N·m (1.8 kgf-m, 13.3 ft-lb)**

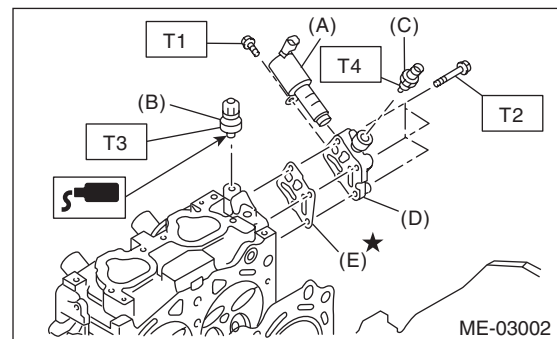

- (A) Oil switching solenoid valve
- (B) Variable valve lift diagnosis oil pressure switch
- (C) Oil temperature sensor
- (D) Oil switching solenoid valve holder
- (E) Gasket

# Oil Switching Solenoid Valve

## MECHANICAL

### 2. LH SIDE

Install in the reverse order of removal.

#### NOTE:

- Use a new gasket.
- Apply liquid gasket to the variable valve lift diagnosis oil pressure switch threads.
- Install the oil switching solenoid valve to the holder, then install it to the cylinder head.

#### **Liquid gasket:**

**THREE BOND 1324 (Part No. 004403042) or equivalent**

#### **Tightening torque:**

**T1**

**8 N·m (0.8 kgf-m, 5.9 ft-lb)**

**T2**

**10 N·m (1.0 kgf-m, 7.4 ft-lb)**

**T3**

**17 N·m (1.7 kgf-m, 12.5 ft-lb)**

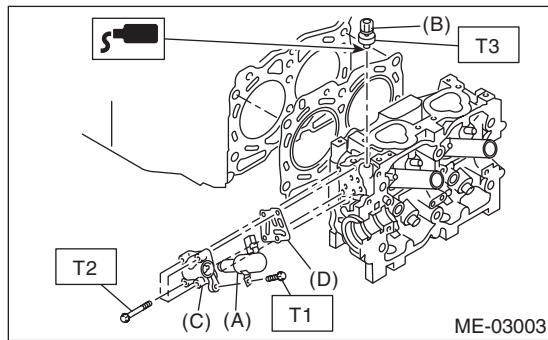

- (A) Oil switching solenoid valve
- (B) Variable valve lift diagnosis oil pressure switch
- (C) Oil switching solenoid valve holder
- (D) Gasket