

4. Engine Coolant Temperature Sensor

A: REMOVAL

- 1) Disconnect the ground cable from the battery.

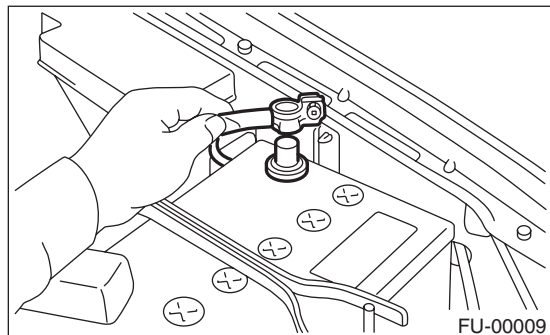

- 2) Remove the generator. <Ref. to SC(H4SO)-14, REMOVAL, Generator.>

- 3) Disconnect the connectors from the engine coolant temperature sensor.

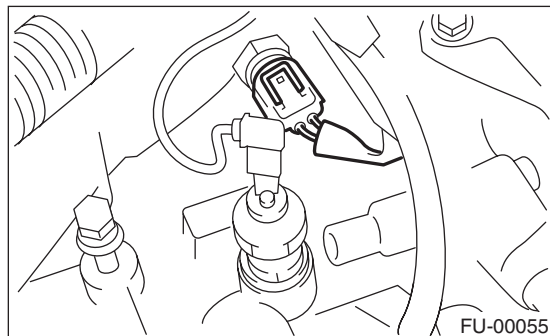

- 4) Remove the engine coolant temperature sensor.

B: INSTALLATION

Install in the reverse order of removal.

NOTE:

Use a new gasket.

Tightening torque:

18 N·m (1.8 kgf-m, 13.3 ft-lb)