

## 21. Fuel

### A: PROCEDURE

#### 1. RELEASING OF FUEL PRESSURE

**WARNING:**

Place “NO FIRE” signs near the working area.

**CAUTION:**

Be careful not to spill fuel.

- 1) Disconnect the connector from fuel pump relay.

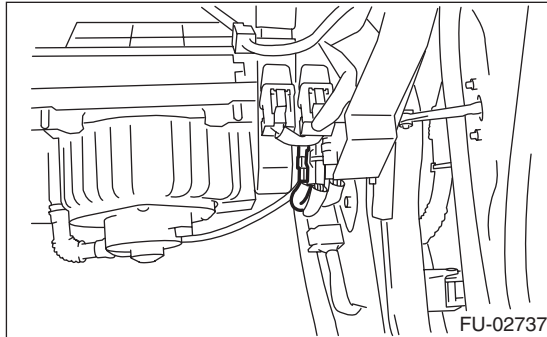

- 2) Start the engine and run it until it stalls.
- 3) After the engine stalls, crank it for five seconds.
- 4) Turn the ignition switch to OFF.

#### 2. DRAINING FUEL

**WARNING:**

Place “NO FIRE” signs near the working area.

**CAUTION:**

Be careful not to spill fuel.

- 1) Release the fuel pressure. <Ref. to FU(H4SO)-45, RELEASING OF FUEL PRESSURE, PROCEDURE, Fuel.>
- 2) Disconnect the ground cable from the battery.

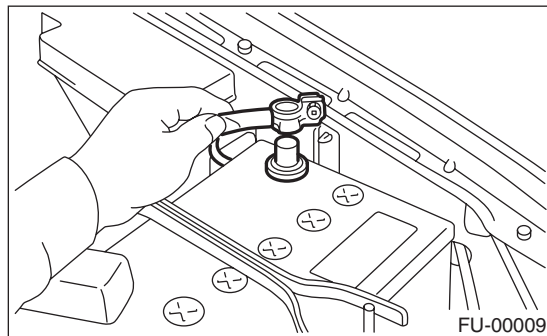

- 3) Remove the fuel pump. <Ref. to FU(H4SO)-53, REMOVAL, Fuel Pump.>
- 4) Drain fuel from the fuel pump attachment section using pump, etc.

**CAUTION:**

Be sure to use an anti-gasoline pump.

- 5) Install the fuel pump. <Ref. to FU(H4SO)-53, INSTALLATION, Fuel Pump.>