

## 13. Variable Valve Lift Diagnosis Oil Pressure Switch

### A: REMOVAL

- 1) Disconnect the ground cable from the battery.

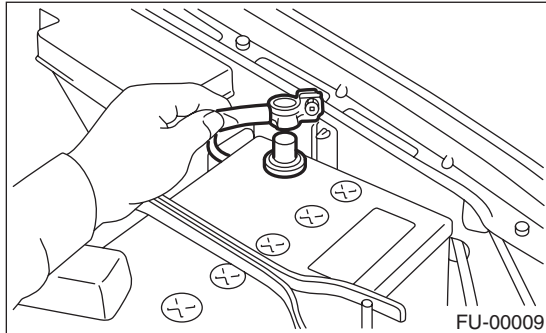

- 2) Remove the air intake chamber. <Ref. to IN(H4SO)-6, REMOVAL, Air Intake Chamber.>
- 3) Remove the engine harness connector from the bracket.
- 4) Disconnect the connector from the variable valve lift diagnosis oil pressure switch.
- 5) Remove the variable valve lift diagnosis oil pressure switch.

- LH side

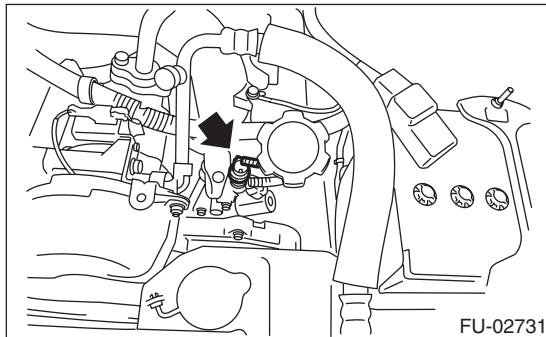

- RH side

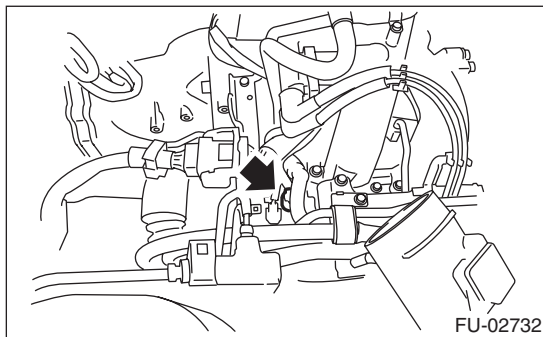

### B: INSTALLATION

Install in the reverse order of removal.

#### NOTE:

Apply liquid gasket to the variable valve lift diagnosis oil pressure switch threads.

#### Liquid gasket:

**THREE BOND 1324 (Part No. 004403042) or equivalent**

#### Tightening torque:

**17 N·m (1.7 kgf-m, 12.5 ft-lb)**