

11.EGR Valve

A: REMOVAL

1) Disconnect the ground cable from the battery.

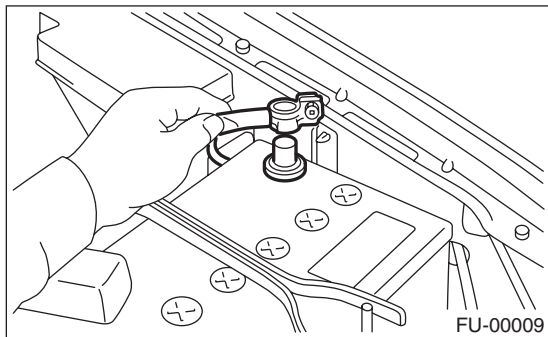

2) Disconnect the connector from EGR valve.

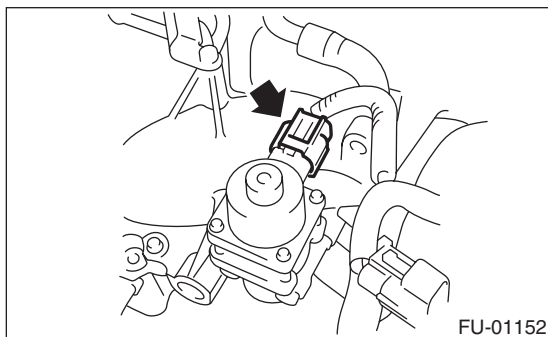

3) Remove the EGR valve from intake manifold.

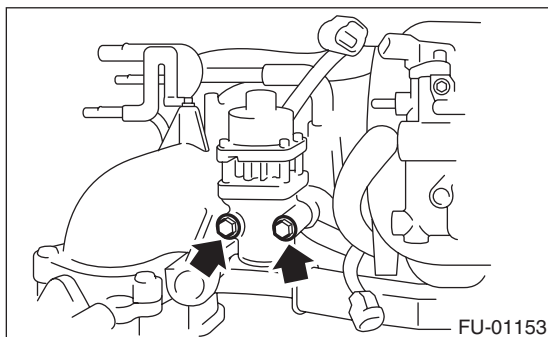

B: INSTALLATION

Install in the reverse order of removal.

NOTE:

Use a new gasket.

Tightening torque:

19 N·m (1.9 kgf-m, 14.0 ft-lb)