

11. Coolant Filler Tank

A: REMOVAL

NOTE:

The coolant filler tank is mounted on the turbo model.

CAUTION:

The radiator is pressurized. Wait until engine cools down before working on the radiator.

- 1) Remove the collector cover.
- 2) Drain approximately 3.0 ℓ (3.2 US qt, 2.6 Imp qt) of engine coolant. <Ref. to CO(H4SO)-17, DRAINING OF ENGINE COOLANT, REPLACEMENT, Engine Coolant.>
- 3) Remove the air cleaner upper cover and air intake boot. <Ref. to IN(H4SO)-5, REMOVAL, Air Cleaner Case.>
- 4) Remove the air cleaner element.
- 5) Disconnect the engine coolant hoses from coolant filler tank.

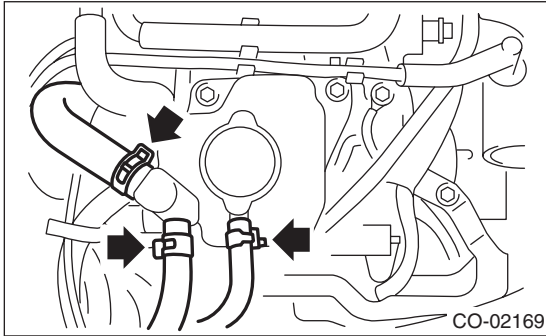

- 6) Remove the bolts and nuts which install coolant filler tank.
- 7) Disconnect the engine coolant hose which connects the under side of coolant filler tank.

- 8) Remove the coolant filler tank.

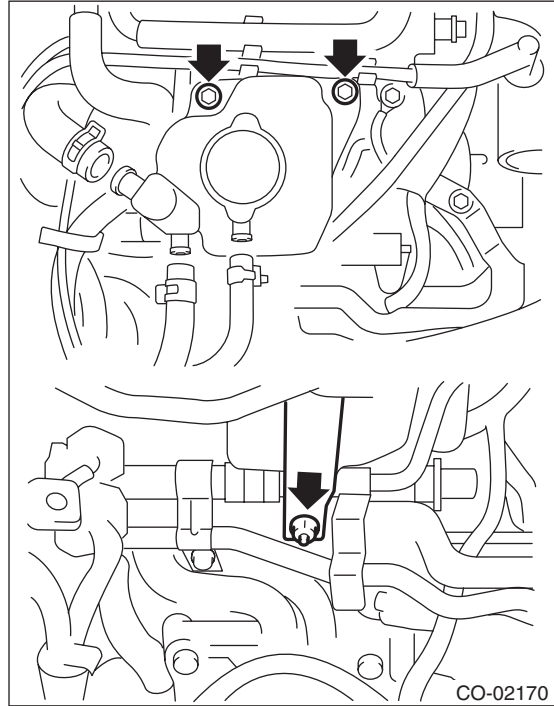

B: INSTALLATION

- 1) Install in the reverse order of removal.

Tightening torque:

T1: 16 N·m (1.6 kgf-m, 11.8 ft-lb)

T2: 13 N·m (1.3 kgf-m, 9.6 ft-lb)

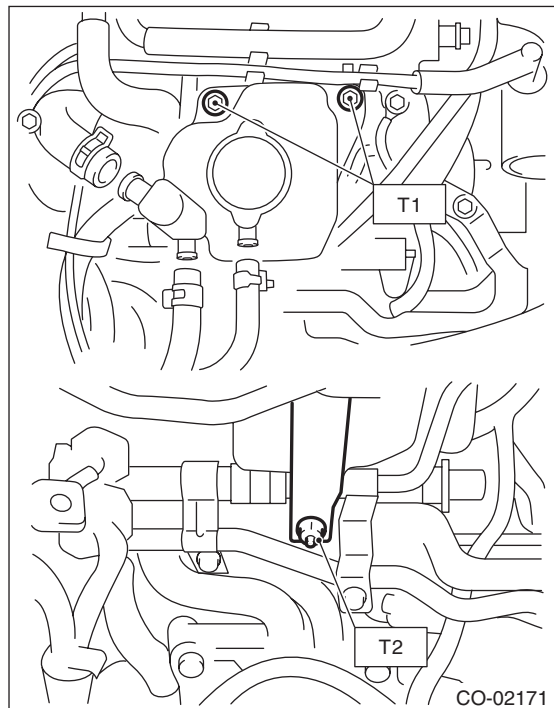

- 2) Fill engine coolant. <Ref. to CO(H4SO)-17, FILLING OF ENGINE COOLANT, REPLACEMENT, Engine Coolant.>