

12.VDC OFF Switch

A: REMOVAL

1) Disconnect the ground cable from the battery.

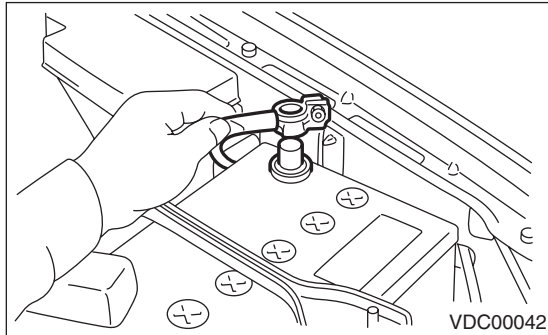

2) Remove the instrument panel lower cover. <Ref. to EI-38, REMOVAL, Instrument Panel Assembly.>

3) Disconnect the VDC OFF switch connector, push outside, and press the VDC OFF switch.

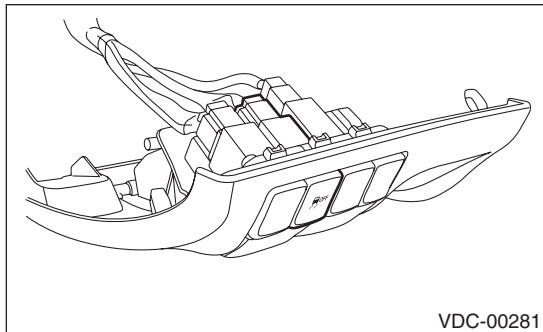

B: INSTALLATION

Install in the reverse order of removal.

C: INSPECTION

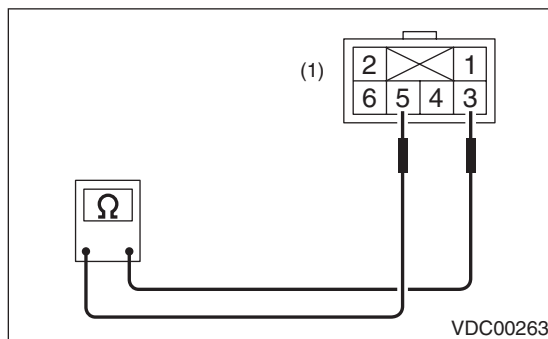

(1) VDC OFF switch side

Inspect the resistance between VDC OFF switch terminals.

Switch position	Tester connection	Standard
OFF	3 — 5	1 M Ω or more
ON	3 — 5	Less than 1 Ω

If NG, replace the VDC OFF switch.