

2. Parking Brake Lever

A: REMOVAL

- 1) Lift up the vehicle.
- 2) Remove the rear wheels.
- 3) Remove the rear seat cushion.
- 4) Remove the console box.
- 5) Loosen the parking cable self-locking nut and console bracket.
- 6) Disconnect the parking brake switch connector.
- 7) Remove the parking brake lever.

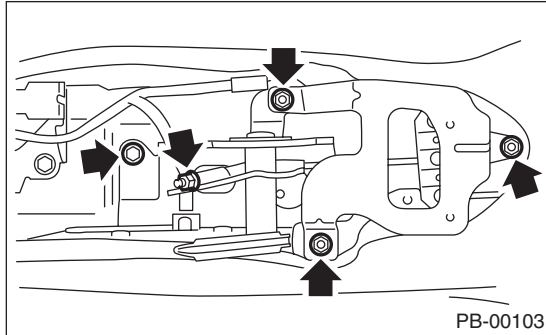

- 8) Straighten the tab on the parking brake lever and remove the cable.

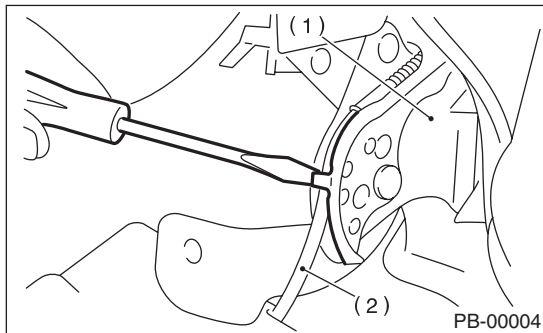

- (1) Parking brake lever
- (2) Cable

B: INSTALLATION

- 1) Install in the reverse order of removal.

Tightening torque:

Parking brake lever

18 N·m (1.8 kgf-m, 13.0 ft-lb)

- 2) Be sure to adjust the lever stroke. <Ref. to PB-4, ADJUSTMENT, Parking Brake Lever.>

C: INSPECTION

While pulling the parking brake lever upward, count the notches.

Lever stroke:

7 to 8 notches when pulled with a force of 196 N (20 kgf, 44 lb)

If it is not within the specified value, adjust the parking brake. <Ref. to PB-8, ADJUSTMENT, Parking Brake Assembly (Rear Disc Brake).>

D: ADJUSTMENT

- 1) Remove the console cover. <Ref. to EI-37, REMOVAL, Console Box.>
- 2) Forcefully pull the parking brake lever 3 to 5 times.
- 3) Rotate to adjust the selflocking nut so that the lever stroke of the parking brake lever is 7 to 8 notches when applying the parking brake with force of 196 N (20 kgf, 44 lb).

Lever stroke:

7 to 8 notches when pulled with a force of 196 N (20 kgf, 44 lb)

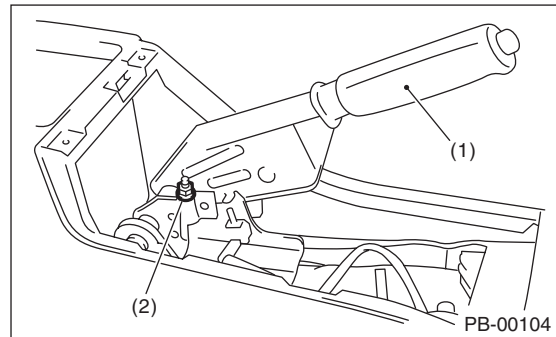

- (1) Parking brake lever
- (2) Self-locking nut

- 4) Install the console cover. <Ref. to EI-37, INSTALLATION, Console Box.>