

11.Compressor

A: INSPECTION

1. MAGNETIC CLUTCH CLEARANCE

Check the clearance of entire circumference around the drive plate and pulley.

Standard:

0.3 — 0.6 mm (0.0118 — 0.0236 in)

2. MAGNETIC CLUTCH OPERATION

- 1) Disconnect the compressor connector.
 - 2) Connect the battery positive (+) terminal to the terminal of the compressor connector.
 - 3) Confirm the magnet clutch engagement.
- If NG, replace the compressor.

B: REMOVAL

- 1) Perform the compressor oil return operation. <Ref. to AC-26, PROCEDURE, Compressor Oil.>
- 2) Turn the A/C switch to OFF and stop the engine.
- 3) Using the refrigerant recovery system, discharge refrigerant. <Ref. to AC-21, PROCEDURE, Refrigerant Recovery Procedure.>
- 4) Disconnect the ground cable from the battery.
- 5) Remove the V-belts. <Ref. to ME(H4SO)-41, REMOVAL, V-belt.> <Ref. to ME(H4DOTC)-39, REMOVAL, V-belt.>
- 6) Remove the generator. <Ref. to SC(H4SO)-14, REMOVAL, Generator.>
- 7) Remove the low-pressure hose and high-pressure hose from the compressor.
- 8) Disconnect the compressor harness from body harness.

- 9) Remove the bolts and then remove the compressor bracket.

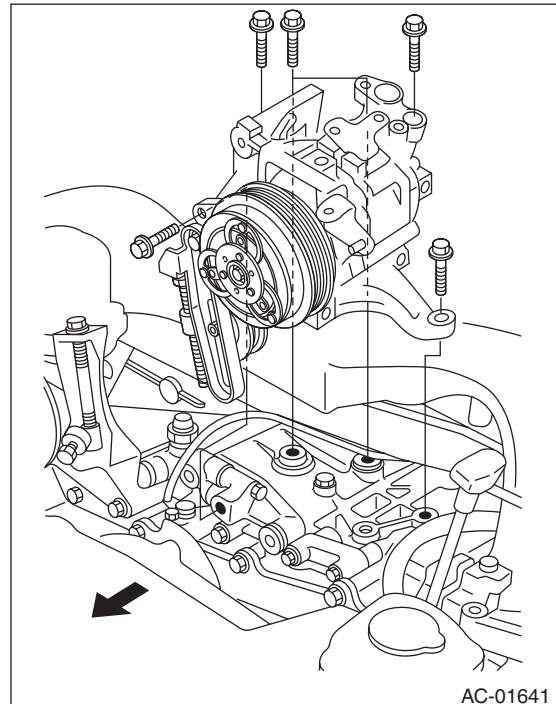

- 10) Remove the bolts, then remove the bracket from the compressor.

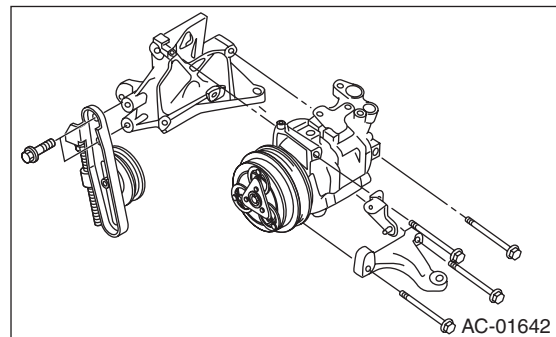

C: INSTALLATION

- 1) Install in the reverse order of removal.
- 2) Replace the O-rings on low-/high-pressure hoses with new parts, then apply compressor oil.
- 3) After replacing the compressor, adjust amount of compressor oil. <Ref. to AC-26, PROCEDURE, Compressor Oil.>
- 4) Charge refrigerant. <Ref. to AC-22, PROCEDURE, Refrigerant Charging Procedure.>

Tightening torque:

Refer to “COMPONENT” of “General Description”. <Ref. to AC-13, AIR CONDITIONING UNIT, COMPONENT, General Description.> <Ref. to AC-14, COMPRESSOR, COMPONENT, General Description.>