

POWER SUPPLY ROUTING
Schematic

PFP:00011

EKS00322

To ESM

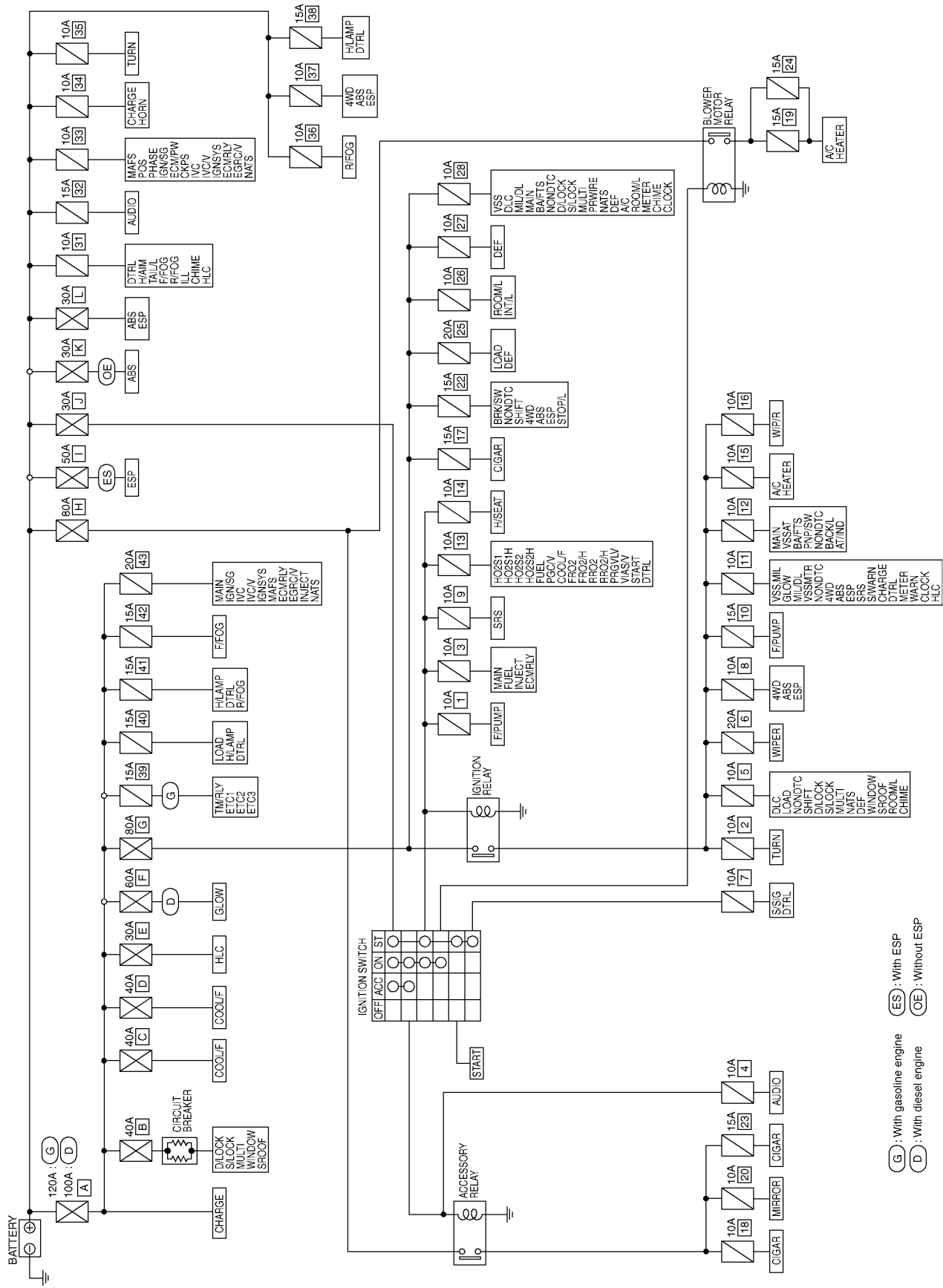

(G) : With gasoline engine
(D) : With diesel engine
(ES) : With ESP
(OE) : Without ESP

POWER SUPPLY ROUTING

Wiring Diagram — POWER —
BATTERY POWER SUPPLY — IGNITION SW. IN ANY POSITION

EKS00323

PG-POWER-01

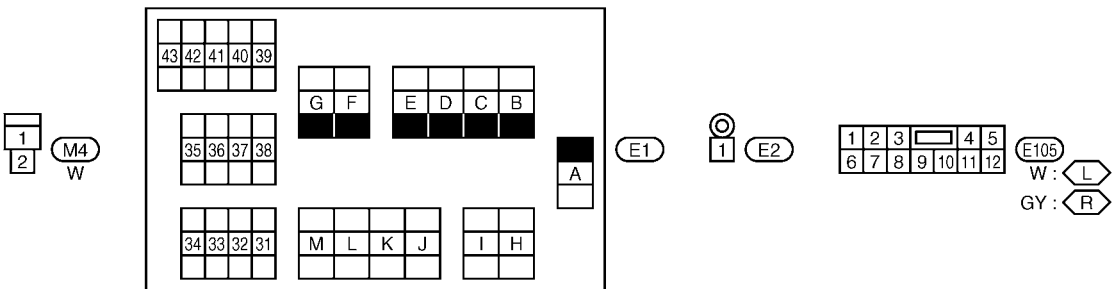
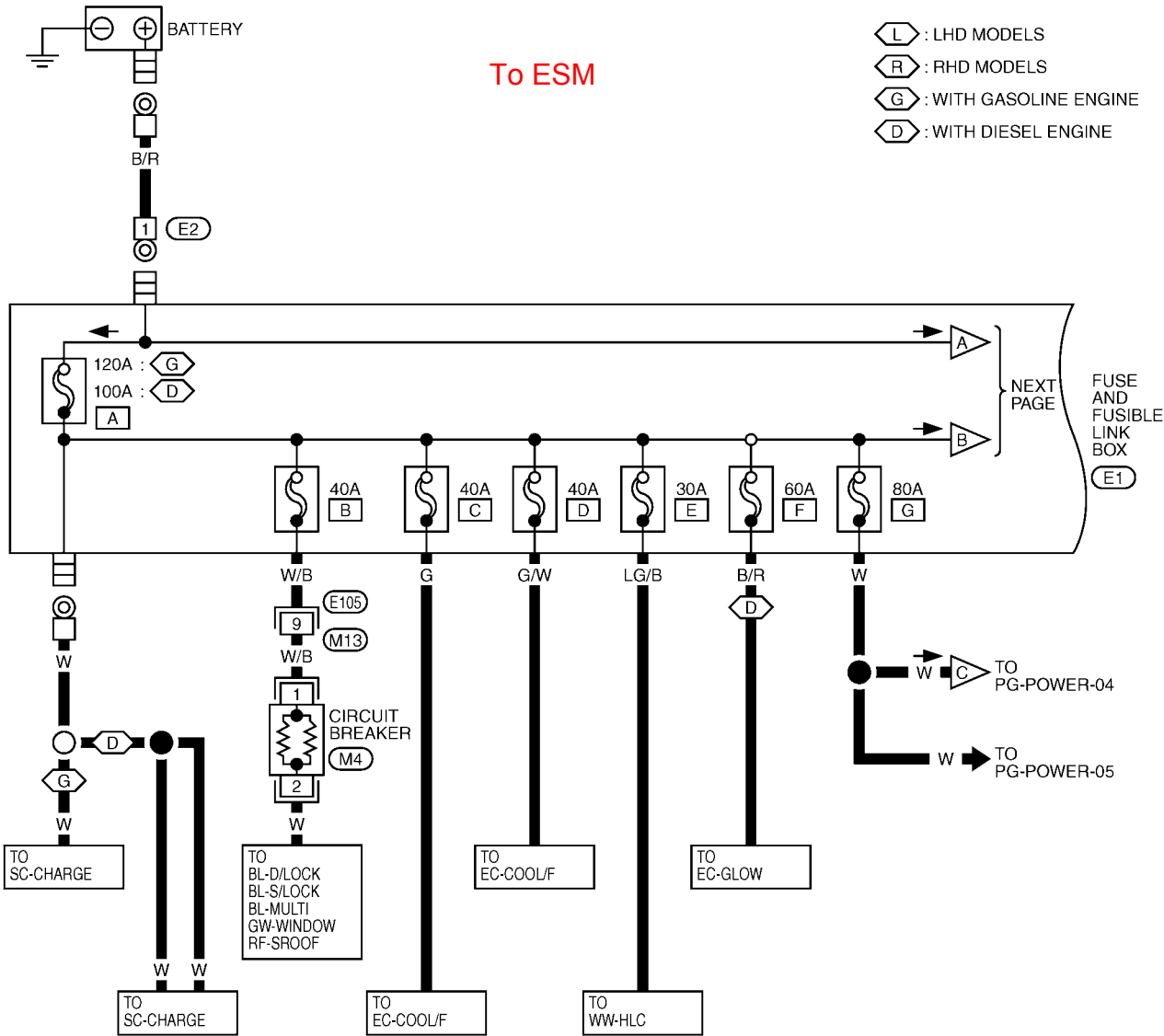

G : WITH GASOLINE ENGINE
D : WITH DIESEL ENGINE

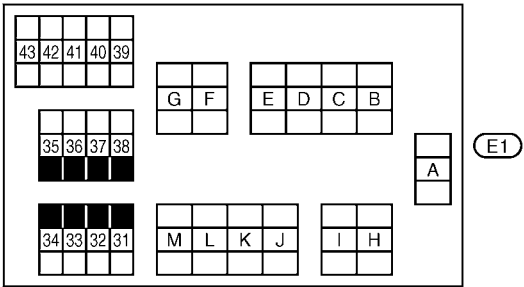
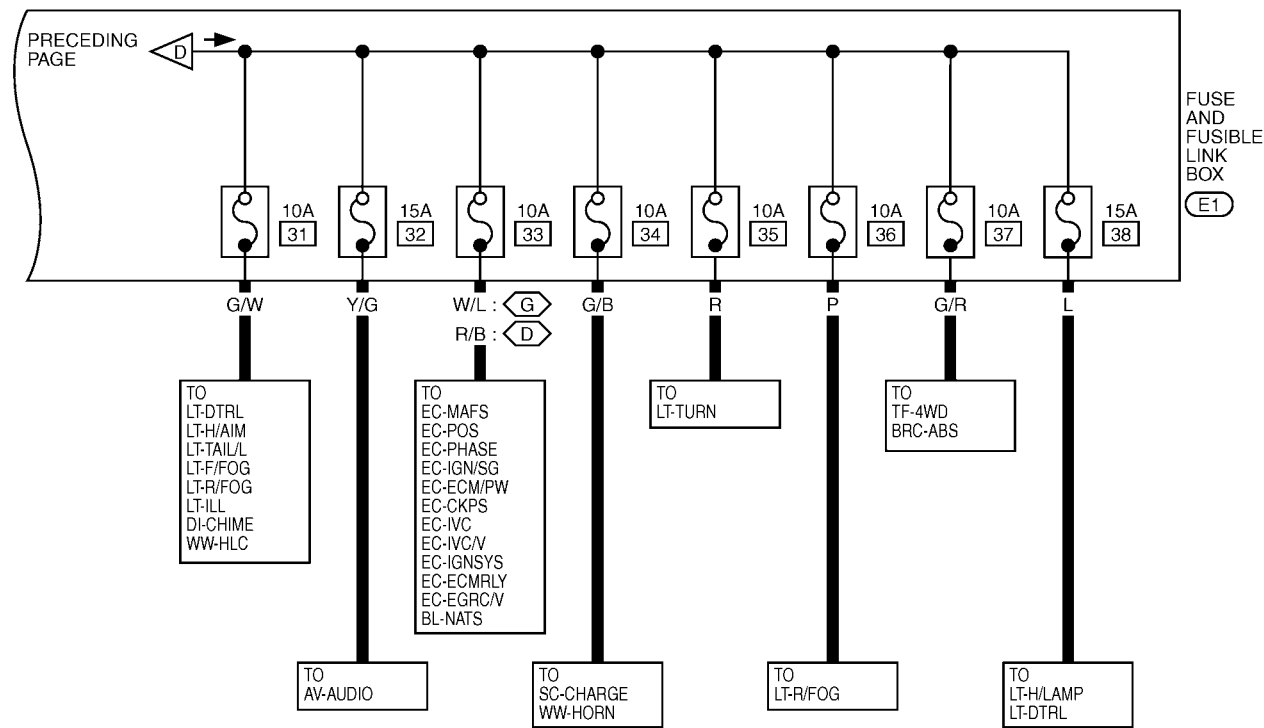

GROUND

GROUND

PFP:00011

Ground Distribution MAIN HARNESS/LHD MODELS

To ESM

EKS0032H

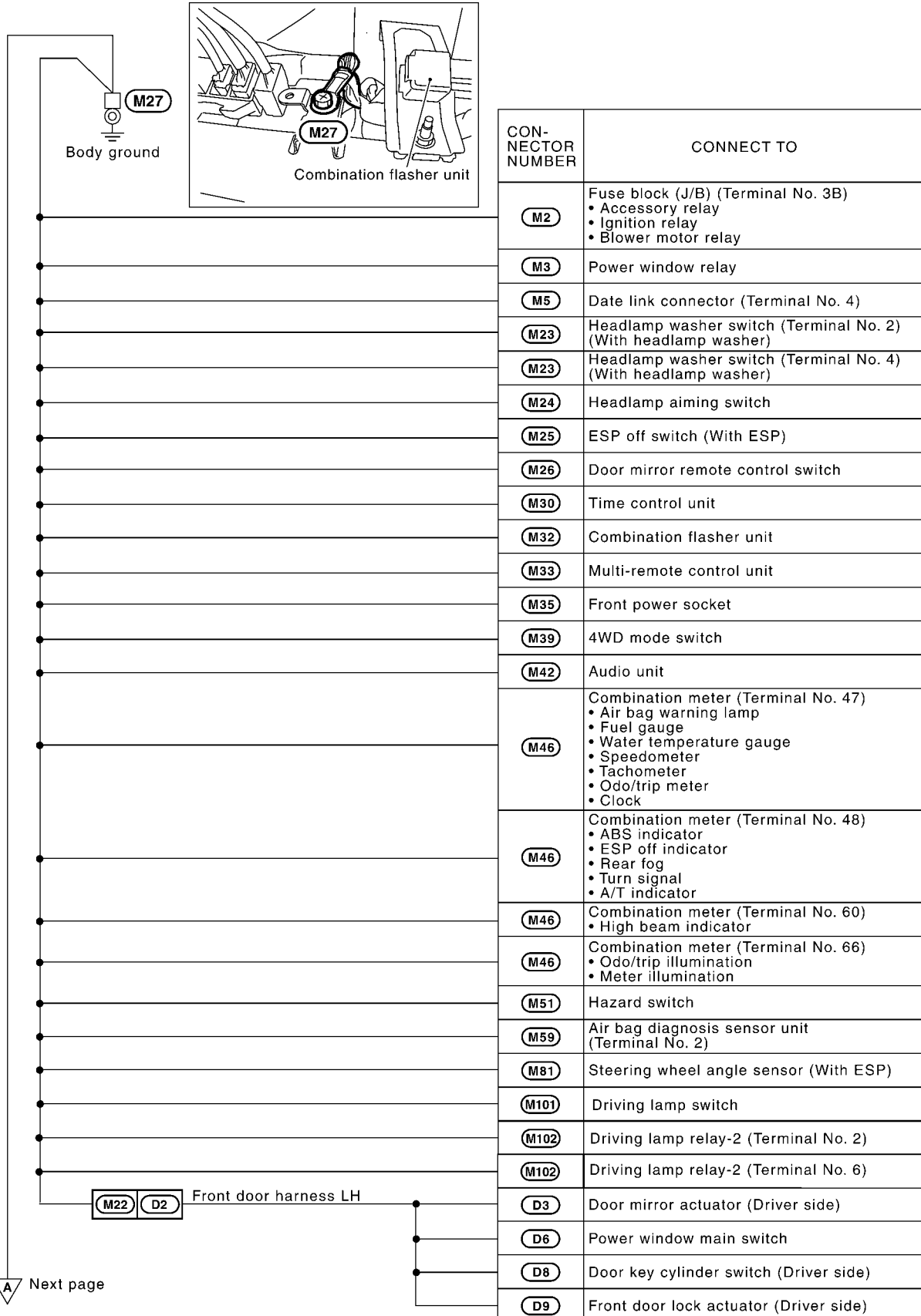

Next page

CKIA0304E

GROUND

MAIN HARNESS/RHD MODELS

To ESM

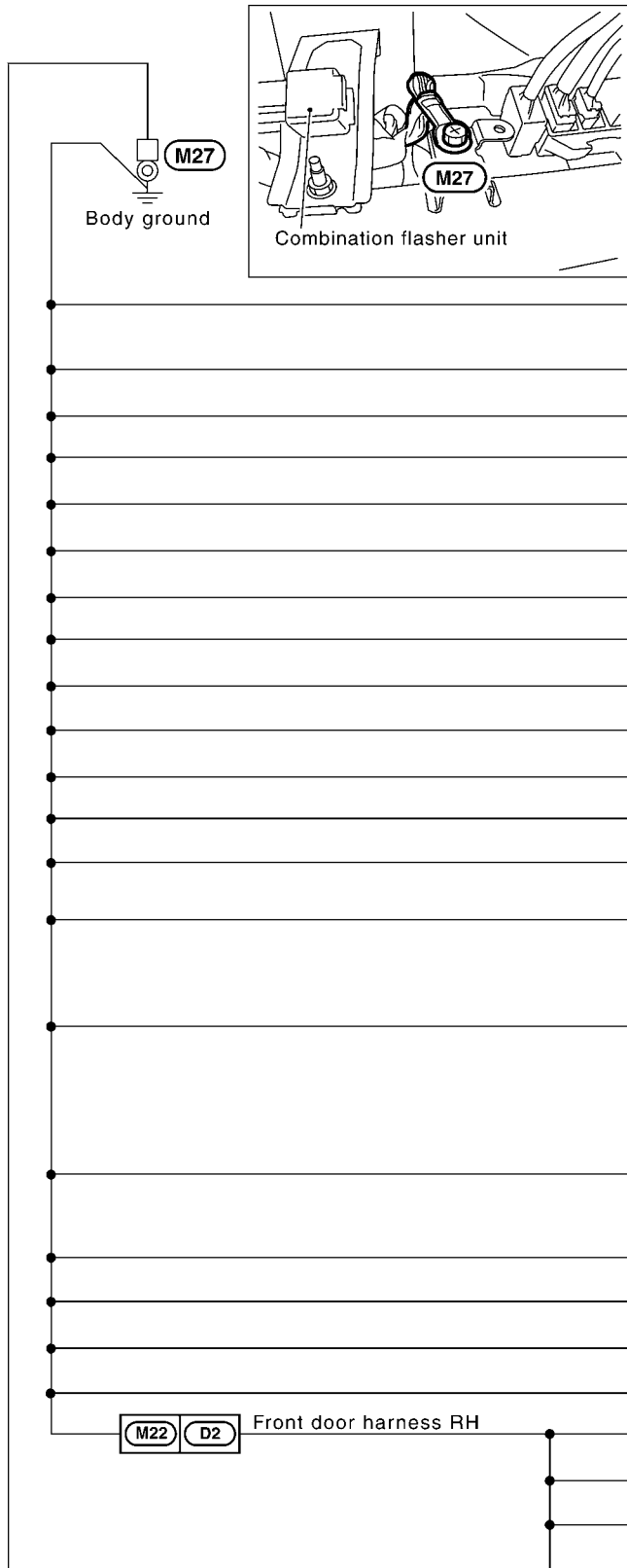

CON- NECTOR NUMBER	CONNECT TO
M2	Fuse block (J/B) (Terminal No. 3B) • Accessory relay • Ignition relay • Blower motor relay
M3	Power window relay
M5	Data link connector (Terminal No. 4)
M23	Headlamp washer switch (Terminal No. 2) (With headlamp washer)
M23	Headlamp washer switch (Terminal No. 4) (With headlamp washer)
M24	Headlamp aiming switch
M25	ESP off switch (With ESP)
M26	Door mirror remote control switch
M30	Time control unit
M32	Combination flasher unit
M35	Front power socket
M39	4WD mode switch
M46	Combination meter (Terminal No. 49) • High beam indicator
M46	Combination meter (Terminal No. 56) • Odo/trip illumination • Meter illumination
M46	Combination meter (Terminal No. 60) • Air bag warning lamp • Fuel gauge • Water temperature gauge • Speedometer • Tachometer • Odo/trip meter • Clock
M46	Combination meter (Terminal No. 61) • ABS indicator • ESP off indicator • Rear fog • Turn signal • A/T indicator
M51	Hazard switch
M59	Air bag diagnosis sensor unit (Terminal No. 2)
M81	Steering wheel angle sensor (With ESP)
M101	Driving lamp switch
D3	Door mirror actuator (Driver side)
D6	Power window main switch
D8	Door key cylinder switch (Driver side)
D9	Front door lock actuator (Driver side)

A Next page

CKIA0305E

GROUND

ENGINE ROOM HARNESS/RHD MODELS

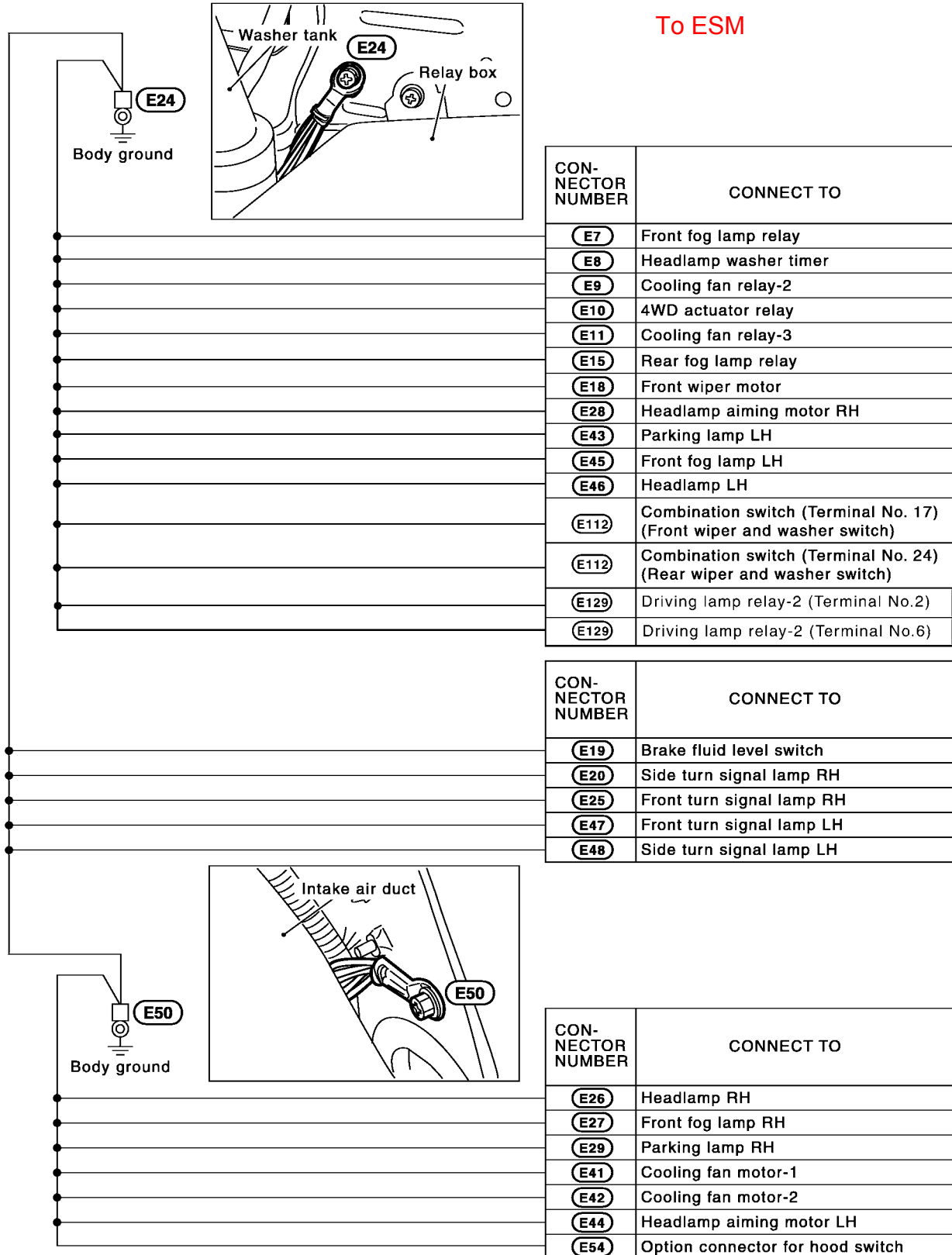

CKIA0300E

GROUND

ROOM LAMP HARNESS

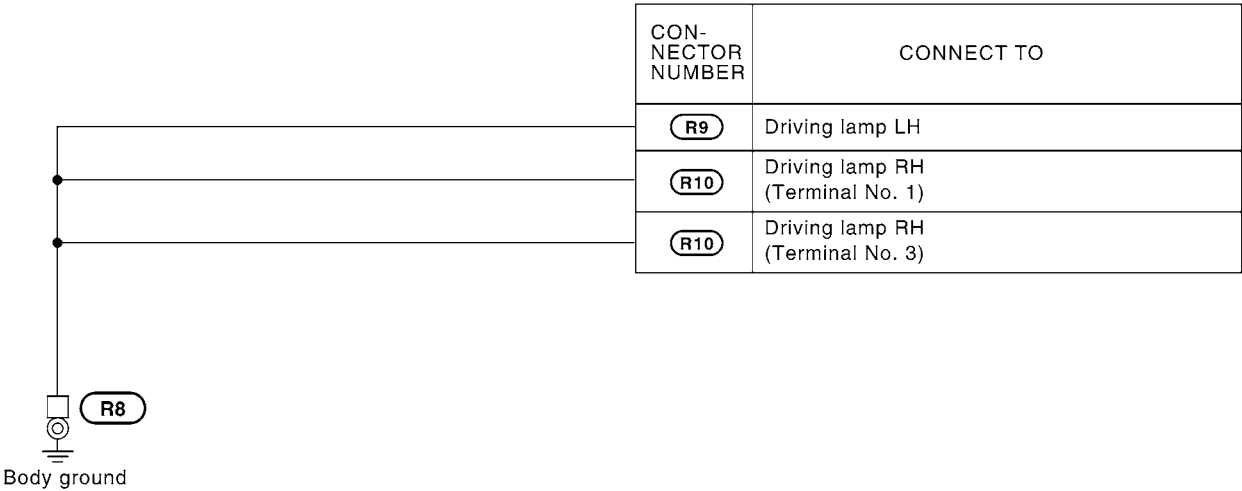

CKIA0301E

MAIN HARNESS/LHD MODELS

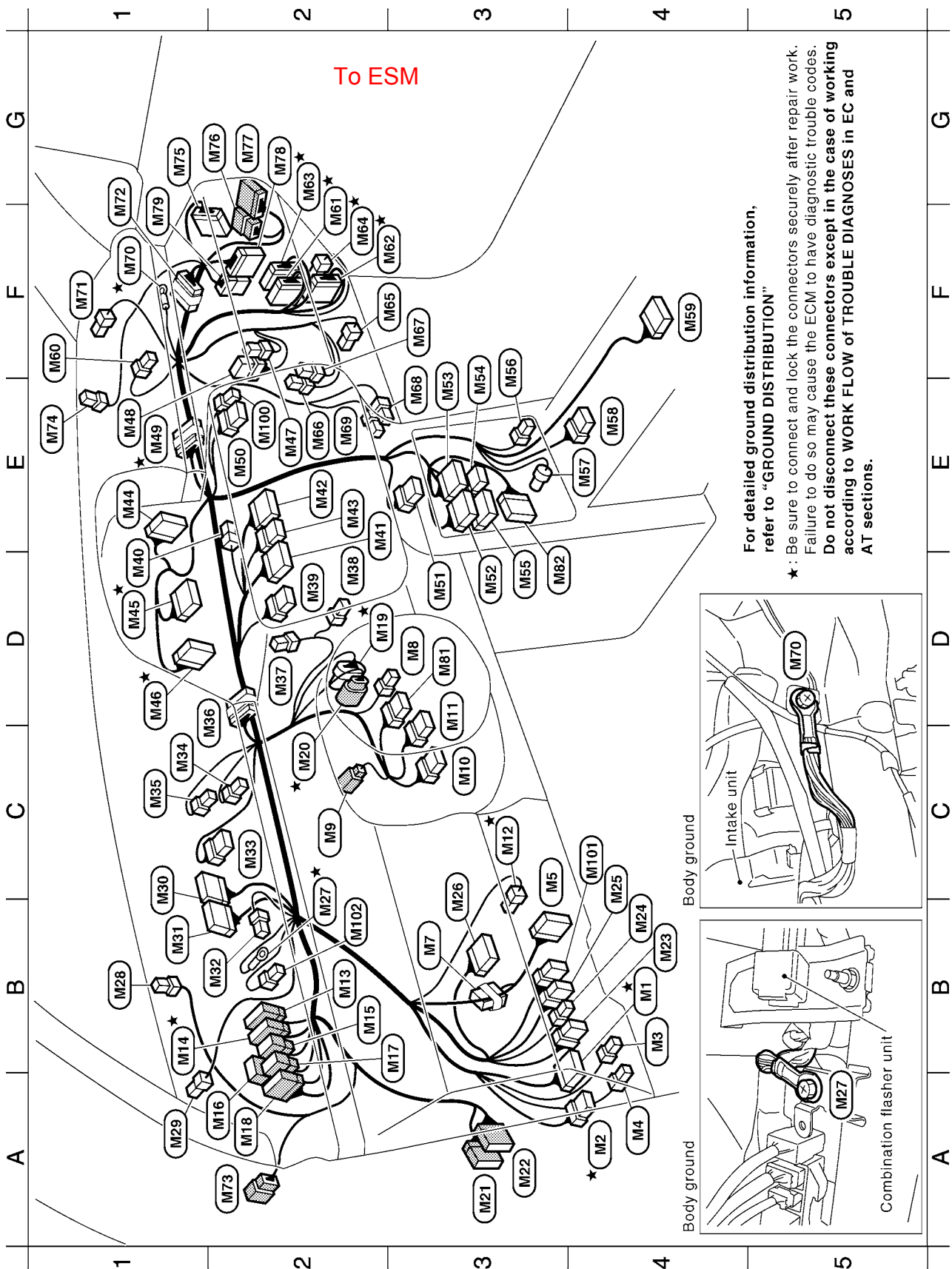

B4	★	M1	W/16	: Fuse block (J/B)	D1	★	M46	W/24	: Combination meter
A4	★	M2	W/10	: Fuse block (J/B)	E2		M47	W/3	: Intake door motor (With auto A/C)
B4		M3	L/4	: Power window relay	E1		M48	B/6	: Intake door motor (With manual A/C)
A4		M4	W/2	: Circuit breaker (PTC)	E1	★	M49	OR/20	: Joint connector-2
C3		M5	W/16	: Date link connector	E2		M50	W/6	: Rear window defogger switch
B3		M7	W/6	: Option connector for theft warning system	D3		M51	W/8	: Hazard switch
D3		M8	L/4	: Cigarette lighter relay	D3		M52	GY/20	: A/C auto amp. (With auto A/C)
C2		M9	BR/2	: Key switch	E3		M53	GY/16	: A/C auto amp. (With auto A/C)
C3		M10	Y/6	: Combination switch (Spiral cable)	E3		M54	W/6	: Fan switch (With manual A/C)
D3		M11	GY/8	: Combination switch (Spiral cable)	D3		M55	W/12	: Heater control panel (With manual A/C)
C3	★	M12	B/2	: Stop lamp switch	F3		M56	L/4	: Cigarette lighter socket
B2		M13	W/12	: To E105	E4		M57	GY/4	: G sensor
B1	★	M14	BR/16	: To E106	E4		M58	W/8	: A/T device
B2		M15	GY/8	: To E107	F4		M59	Y/20	: Air bag diagnosis sensor unit
A2		M16	W/6	: To B3	F1		M60	Y/2	: Front passenger air bag module
B3		M17	W/8	: To B1	F2	★	M61	BR/24	: To F41 (With gasoline engine)
A2		M18	BR/20	: To B2	F2	★	M62	W/16	: To F42 (With gasoline engine)
D2	★	M19	GY/6	: Accelerator pedal position sensor (With gasoline engine)	G2	★	M63	BR/24	: To F30 (With diesel engine)
C2	★	M20	GY/8	: Accelerator work unit (With diesel engine)	F2	★	M64	W/4	: To F29 (With diesel engine)
A3		M21	W/16	: To D1	F2		M65	W/2	: Blower motor
A3		M22	BR/12	: To D2	E2		M66	BR/4	: Fan resistor (With manual A/C)
B4		M23	GY/8	: Headlamp washer switch	F3		M67	W/4	: Fan control amp. (With auto A/C)
B4		M24	W/4	: Headlamp aiming switch	E3		M68	W/4	: Intake sensor (Gasoline engine with auto A/C)
C4		M25	GY/6	: ESP off switch (With ESP)	E2		M69	W/2	: Intake sensor (Diesel engine with auto A/C)
C3	★	M26	W/10	: Door mirror remote control switch	F1	★	M70	—	: Body ground
B2		M27	—	: Body ground	F1		M71	BR/2	: Tweeter RH
B1		M28	BR/2	: Security indicator lamp	F1		M72	L/20	: Joint connector-3
A1		M29	BR/2	: Tweeter LH	A2		M73	W/8	: To R1
C1		M30	GY/16	: Time control unit	E1		M74	B/2	: Sunload sensor (With auto A/C)
B1		M31	GY/20	: Time control unit	G1		M75	BR/20	: To E116
B2		M32	B/3	: Combination flasher unit	G2		M76	BR/8	: To D12
C2		M33	BR/8	: Multi-remote control unit	G2		M77	W/12	: To D11
C1		M34	W/2	: In-vehicle sensor (With auto A/C)	G2		M78	W/12	: To B105
C1		M35	B/2	: Front power socket	F1		M79	W/8	: To B106
D1		M36	OR/20	: Joint connector-1	D3		M81	W/8	: Steering wheel angle sensor (With ESP)
D2		M37	W/3	: Mode door motor (With auto A/C)	D3		M82	W/16	: CD autochanger
D2		M38	W/3	: Air mix door motor (With auto A/C)	E2		M100	W/4	: Seat belt warning lamp (Passenger side)
D2		M39	GY/6	: 4WD mode switch	C4		M101	W/6	: Driving lamp switch
D1		M40	W/2	: Antenna amp.	B2		M102	BR/6	: Driving lamp relay-2
E2		M41	W/12	: Audio unit	★: Be sure to connect and lock the connectors securely after repair work. Failure to do so may cause the ECM to have diagnostic trouble codes. Do not disconnect these connectors except in the case of working according to WORK FLOW of TROUBLE DIAGNOSES in EC and AT sections.				
E2		M42	W/16	: Audio unit					
E2		M43	W/8	: Audio unit					
E1		M44	BR/24	: Combination meter					
D1	★	M45	W/20	: Combination meter					

MAIN HARNESS/RHD MODELS

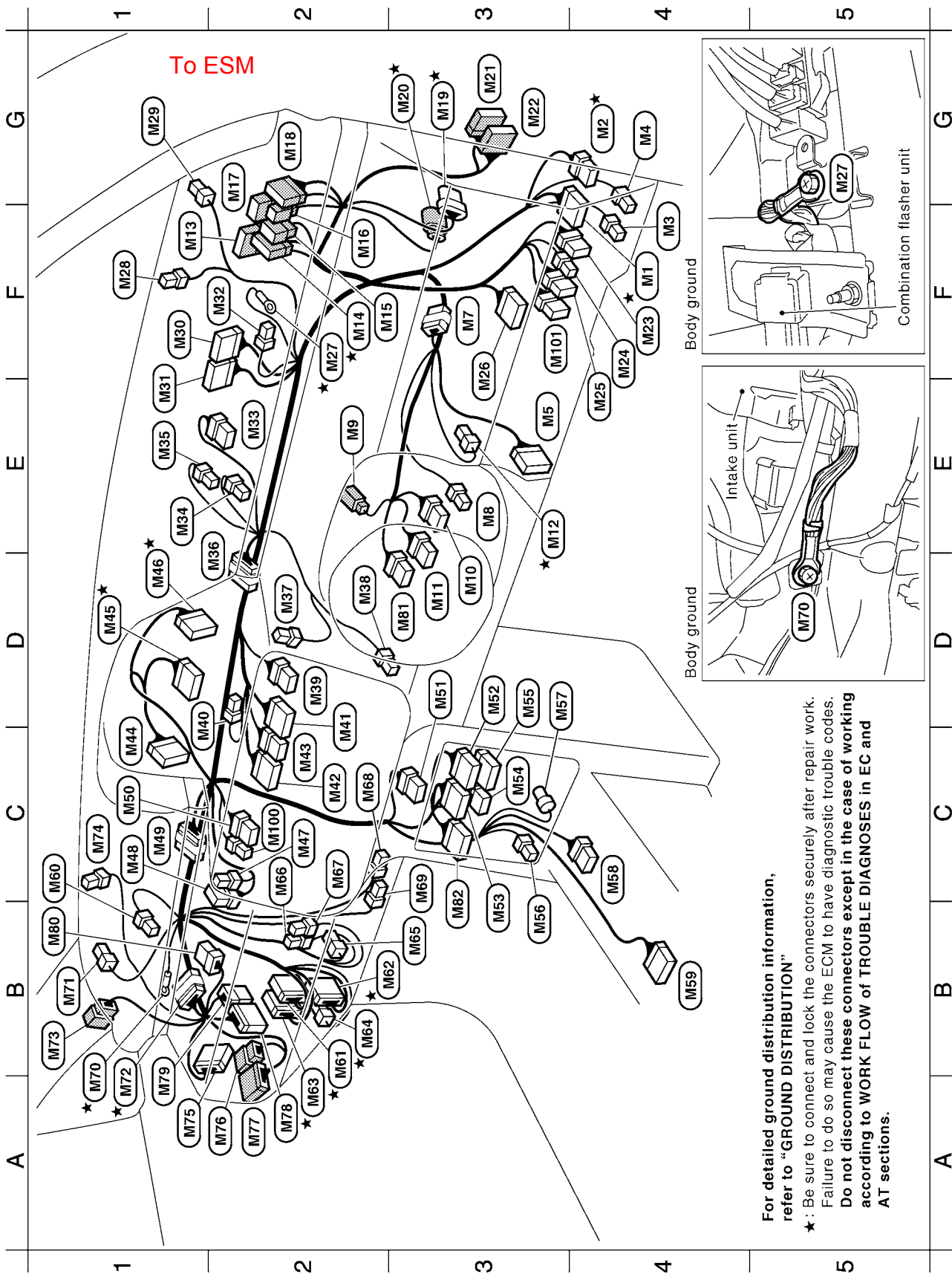

TKIA0057E

F4	★	(M1)	W/16	: Fuse block (J/B)	D1	★	(M46)	BR/24	: Combination meter
G4	★	(M2)	W/10	: Fuse block (J/B)	C2		(M47)	W/3	: Intake door motor (With auto A/C)
F4		(M3)	L/4	: Power window relay	C1		(M48)	B/6	: Intake door motor (With manual A/C)
G4		(M4)	W/2	: Circuit breaker (PTC)	C1		(M49)	OR/20	: Joint connector-2
E3		(M5)	W/16	: Date link connector	C1		(M50)	W/6	: Rear window defogger switch
F3		(M7)	W/6	: Option connector for theft warning system	D3		(M51)	W/8	: Hazard switch
E3		(M8)	L/4	: Cigarette lighter relay	D3		(M52)	GY/20	: A/C auto amp. (With auto A/C)
E2		(M9)	BR/2	: Key switch	B3		(M53)	GY/16	: A/C auto amp. (With auto A/C)
D3		(M10)	Y/6	: Combination switch (Spiral cable)	C3		(M54)	W/6	: Fan switch (With manual A/C)
D3		(M11)	GY/8	: Combination switch (Spiral cable)	D3		(M55)	W/12	: Heater control panel (With manual A/C)
E3	★	(M12)	B/2	: Stop lamp switch	B3		(M56)	L/4	: Cigarette lighter socket
F1		(M13)	W/12	: To (E105)	D3		(M57)	GY/4	: G sensor
F2	★	(M14)	BR/16	: To (E106)	C4		(M58)	W/8	: A/T device
F2		(M15)	GY/6	: To (E107)	B4		(M59)	Y/20	: Air bag diagnosis sensor unit
F2		(M16)	W/6	: To (B3)	C1		(M60)	Y/2	: Front passenger air bag module
G2		(M17)	W/8	: To (B1)	B2	★	(M61)	BR/24	: To (F41) (With gasoline engine)
G2		(M18)	BR/20	: To (B2)	B2	★	(M62)	W/16	: To (F42) (With gasoline engine)
G3	★	(M19)	GY/6	: Accelerator pedal position sensor (With gasoline engine)	A2	★	(M63)	BR/24	: To (F30) (With diesel engine)
G3	★	(M20)	GY/8	: Accelerator work unit (With diesel engine)	B2	★	(M64)	W/4	: To (F29) (With diesel engine)
G3		(M21)	W/16	: To (D1)	B3		(M65)	W/2	: Blower motor
G3		(M22)	BR/12	: To (D2)	C2		(M66)	BR/4	: Fan resistor (With manual A/C)
F4		(M23)	GY/8	: Headlamp washer switch	C2		(M67)	W/4	: Fan control amp. (With auto A/C)
F4		(M24)	W/4	: Headlamp aiming switch	C2		(M68)	W/4	: Intake sensor (Gasoline engine with auto A/C)
F4		(M25)	GY/6	: ESP off switch (With ESP)	C3		(M69)	W/2	: Intake sensor (Diesel engine with auto A/C)
F3		(M26)	W/10	: Door mirror remote control switch	B1	★	(M70)	—	: Body ground
F2	★	(M27)	—	: Body ground	B1		(M71)	BR/2	: Tweeter RH
F1		(M28)	BR/2	: Security indicator lamp	A1	★	(M72)	L/20	: Joint connector-3
G1		(M29)	BR/2	: Tweeter LH	B1		(M73)	W/8	: To (R1)
F1		(M30)	GY/16	: Time control unit	C1		(M74)	B/2	: Sunload sensor (With auto A/C)
E1		(M31)	GY/20	: Time control unit	A1		(M75)	BR/20	: To (E116)
F2		(M32)	B/3	: Combination flasher unit	A2		(M76)	BR/8	: To (D12)
E2		(M33)	BR/8	: Multi-remote control unit	A2		(M77)	W/12	: To (D11)
E1		(M34)	W/2	: In-vehicle sensor (With auto A/C)	A2		(M78)	W/12	: To (B105)
E1		(M35)	B/2	: Front power socket	A1		(M79)	W/8	: To (B106)
D2		(M36)	OR/20	: Joint connector-1	B1		(M80)	BR/8	: Dongle unit
D2		(M37)	W/3	: Mode door motor (With auto A/C)	D3		(M81)	W/8	: Steering wheel angle sensor (With ESP)
D2		(M38)	W/3	: Air mix door motor (With auto A/C)	B3		(M82)	W/16	: CD autochanger
D2		(M39)	GY/6	: 4WD mode switch	C2		(M100)	W/4	: Seat belt warning lamp (Passenger side)
D1		(M40)	W/2	: Antenna amp.	F3		(M101)	W/6	: Driving lamp switch
D2		(M41)	W/12	: Audio unit	★: Be sure to connect and lock the connectors securely after repair work. Failure to do so may cause the ECM to have diagnostic trouble codes. Do not disconnect these connectors except in the case of working according to WORK FLOW of TROUBLE DIAGNOSES in EC and AT sections.				
C2		(M42)	W/16	: Audio unit					
C2		(M43)	W/8	: Audio unit					
C1		(M44)	W/24	: Combination meter					
D1	★	(M45)	BR/20	: Combination meter					

HARNESS

ENGINE ROOM HARNESS/LHD MODELS
Gasoline Engine Models

To ESM

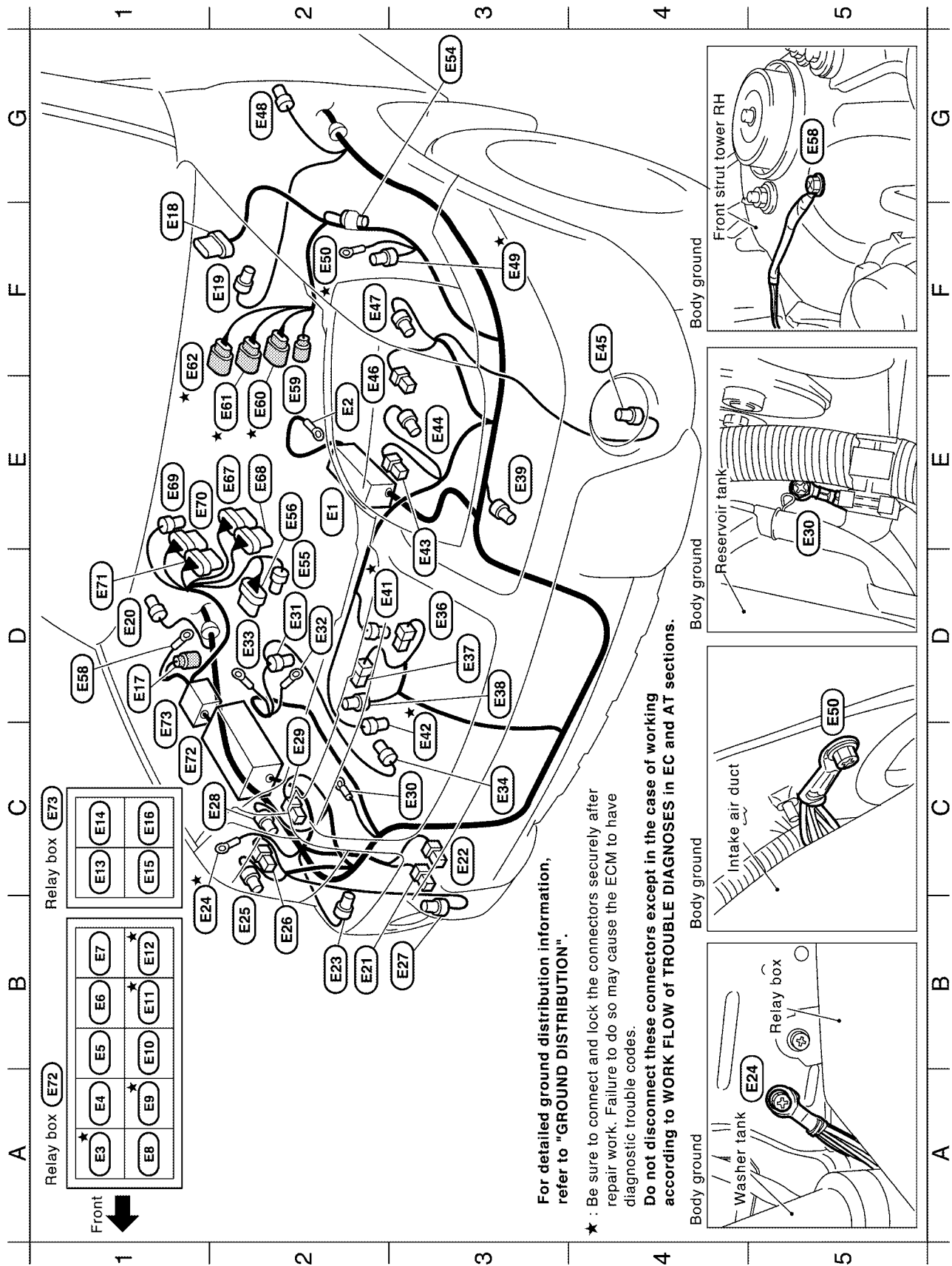

E2	E1	—	Fuse and Fusible link box
E2	E2	—	Battery (+)
A1	E3	BR/6	Cooling fan relay-1
A1	E4	W/3	Horn relay
B1	E5	L/4	Air conditioner relay (With auto A/C)
B1	E6	L/4	Park/Neutral position relay (With A/T)
B1	E7	L/4	Front fog lamp relay
A1	E8	BR/6	Headlamp washer timer
A1	E9	BR/6	Cooling fan relay-2
B1	E10	B/5	4WD actuator relay
B1	E11	BR/6	Cooling fan relay-3
B1	E12	L/4	Throttle control motor relay
C1	E13	L/4	Daytime light relay LH (With daytime light system)
C1	E14	L/4	Driving lamp relay-1
C1	E15	L/4	Rear fog lamp relay
C1	E16	L/4	Daytime light relay RH (With daytime light system)
D1	E17	GY/2	Front wheel sensor RH
F1	E18	GY/6	Front wiper motor
F2	E19	GY/2	Brake fluid level switch
D1	E20	BR/2	Side turn signal lamp RH
B2	E21	W/2	Front washer motor
C3	E22	G/2	Rear washer motor
B2	E23	GY/2	Headlamp washer motor
B1	E24	—	Body ground
B2	E25	GY/2	Front turn signal lamp RH
B2	E26	B/3	Headlamp RH
B3	E27	GY/2	Front fog lamp RH
C2	E28	B/3	Headlamp aiming motor RH
C2	E29	B/2	Parking lamp RH
C3	E30	—	Body ground
D2	E31	GY/2	Alternator
D2	E32	—	Alternator
D2	E33	—	Alternator
C3	E34	B/1	Compressor (With auto A/C)
D3	E36	B/1	Horn high
D3	E37	B/1	Horn low
D3	E38	B/2	Ambient sensor (With auto A/C)
E3	E39	B/3	Refrigerant pressure sensor (With auto A/C)
D2	E41	GY/4	Cooling fan motor-1
C3	E42	GY/4	Cooling fan motor-2

D3	E43	B/2	Parking lamp LH
E3	E44	B/3	Headlamp aiming motor LH
F4	E45	GY/2	Front fog lamp LH
E2	E46	B/3	Headlamp LH
F2	E47	GY/2	Front turn signal lamp LH
G2	E48	BR/2	Side turn signal lamp LH
F3	E49	GY/2	Dropping resistor (With A/T)
F2	E50	—	Body ground
G3	E54	GY/2	Option connector for hood switch
D2	E55	B/2	ESP relay box (With ESP)
E2	E56	B/8	ESP relay box (With ESP)
D1	E58	—	Body ground
E2	E59	BR/2	Front wheel sensor LH
E2	E60	GY/9	To F36
E2	E61	DGY/8	To F38
F1	E62	GY/8	To F37
E2	E67	DGY/8	ESP actuator (With ESP)
E2	E68	SB/8	ESP actuator (With ESP)
E1	E69	B/2	ABS actuator (Without ESP)
E1	E70	B/8	ABS actuator (Without ESP)
D1	E71	GY/8	ABS actuator (Without ESP)
A1, C1	E72	—	Relay box
C1	E73	—	Relay box

★: Be sure to connect and lock the connectors securely after repair work.
 Failure to do so may cause the ECM to have diagnostic trouble codes.
Do not disconnect these connectors except in the case of working according to WORK FLOW of TROUBLE DIAGNOSES in EC and AT sections.

Diesel Engine Models

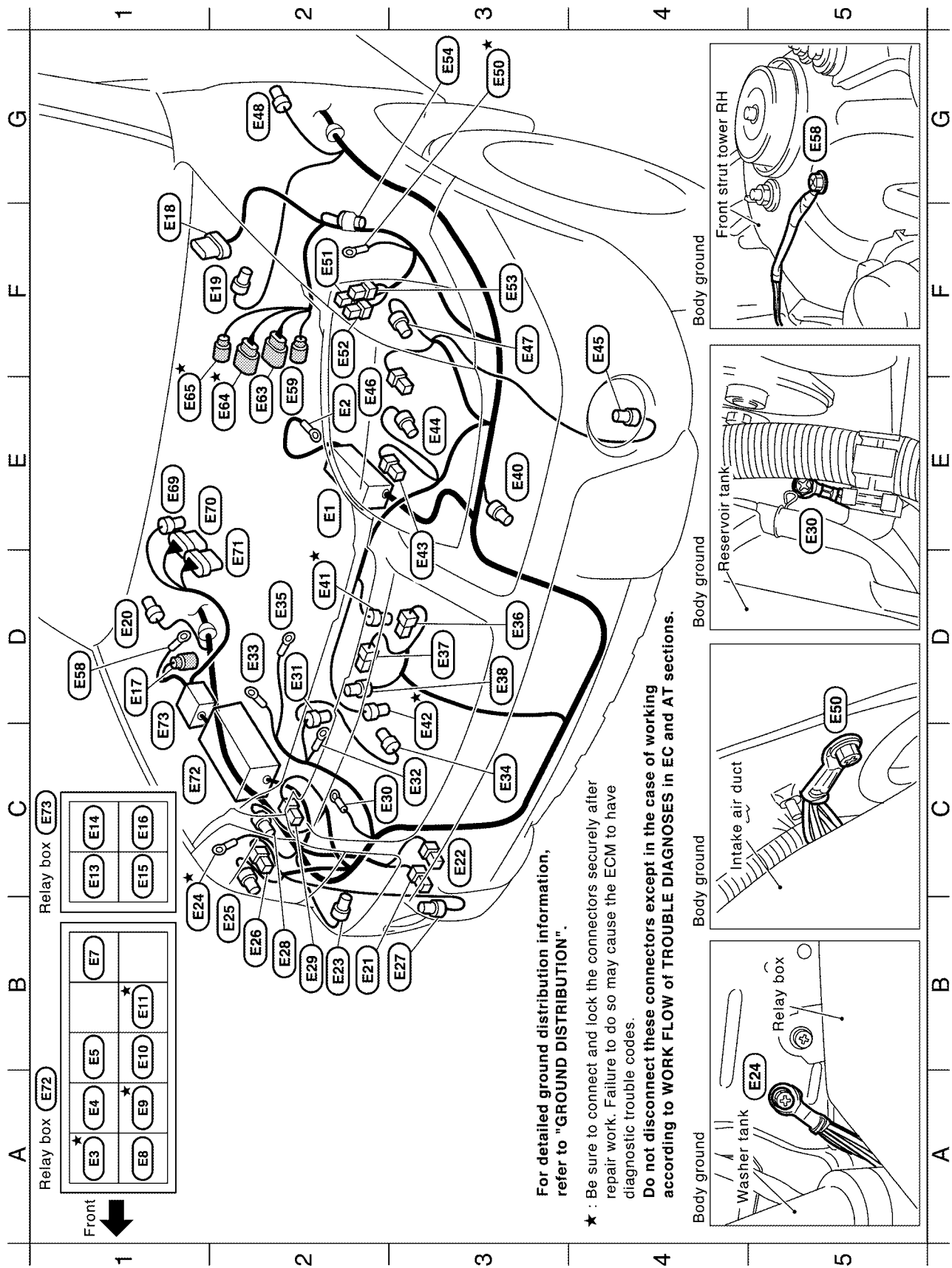

E2	E1	—	Fuse and Fusible link box	E3	E44	B/3	Headlamp aiming motor LH
E2	E2	—	Battery (+)	F4	E45	GY/2	Front fog lamp LH
A1	E3	BR/6	Cooling fan relay-1	E2	E46	B/3	Headlamp LH
A1	E4	W/3	Horn relay	F3	E47	GY/2	Front turn signal lamp LH
B1	E5	L/4	Air conditioner relay (With auto A/C)	G2	E48	BR/2	Side turn signal lamp LH
B1	E7	L/4	Front fog lamp relay	G3	E50	—	Body ground
A1	E8	BR/6	Headlamp washer timer	F2	E51	W/1	Glow relay
A1	E9	BR/6	Cooling fan relay-2	F2	E52	W/1	Glow relay
B1	E10	B/5	4WD actuator relay	F3	E53	G/2	Glow relay
B1	E11	BR/6	Cooling fan relay-3	G3	E54	GY/2	Option connector for hood switch
C1	E13	L/4	Daytime light relay LH (With daytime light system)	D1	E58	—	Body ground
C1	E14	L/4	Driving lamp relay-1	E2	E59	BR/2	Front wheel sensor LH
C1	E15	L/4	Rear fog lamp relay	E2	E63	GY/8	To F4
C1	E16	L/4	Daytime light relay RH (With daytime light system)	E2	E64	B/6	To F5
D1	E17	GY/2	Front wheel sensor RH	E1	E65	B/2	To F6
F1	E18	GY/6	Front wiper motor	E1	E69	B/2	ABS actuator
F2	E19	GY/2	Brake fluid level switch	E1	E70	B/8	ABS actuator
D1	E20	BR/2	Side turn signal lamp RH	D2	E71	GY/8	ABS actuator
B2	E21	W/2	Front washer motor	A1, C1	E72	—	Relay box
C3	E22	G/2	Rear washer motor	C1	E73	—	Relay box
B2	E23	GY/2	Headlamp washer motor				
B1	E24	—	Body ground				
B2	E25	GY/2	Front turn signal lamp RH				
B2	E26	B/3	Headlamp RH				
B3	E27	GY/2	Front fog lamp RH				
B2	E28	B/3	Headlamp aiming motor RH				
B2	E29	B/2	Parking lamp RH				
C2	E30	—	Body ground				
D2	E31	GY/2	Alternator				
C3	E32	—	Alternator				
D2	E33	—	Alternator				
C3	E34	B/1	Compressor (With auto A/C)				
D2	E35	—	Glow plug				
D3	E36	B/1	Horn high				
D3	E37	B/1	Horn low				
D3	E38	B/2	Ambient sensor (With auto A/C)				
E3	E40	B/2	Dual-pressure switch (With auto A/C)				
D2	E41	GY/4	Cooling fan motor-1				
C3	E42	GY/4	Cooling fan motor-2				
D3	E43	B/2	Parking lamp LH				

★: Be sure to connect and lock the connectors securely after repair work.
Failure to do so may cause the ECM to have diagnostic trouble codes.
Do not disconnect these connectors except in the case of working according to WORK FLOW of TROUBLE DIAGNOSES in EC and AT sections.

Passenger Compartment

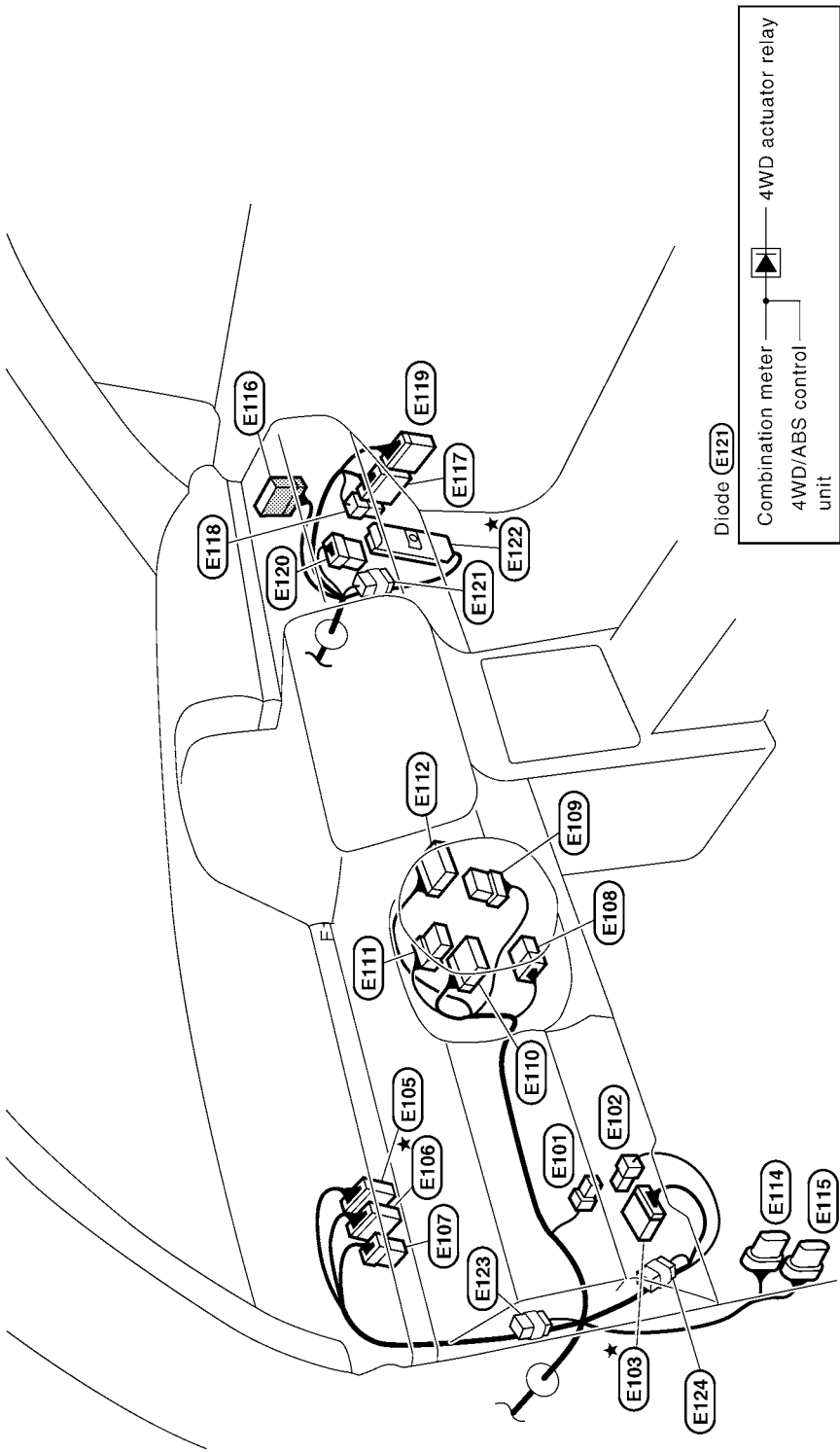

- (E101) B/2 : Fuse block (J/B)
(E102) W/4 : Fuse block (J/B)
(E103) W/12 : Fuse block (J/B)
(E105) W/12 : To (M13)
(E106) BR/16 : To (M14)
(E107) GY/8 : To (M15)
(E108) W/6 : Ignition switch
(E109) W/8 : NATS IMMU
(E110) BR/12 : Combination switch (Lighting switch)
(E111) W/8 : Combination switch (Fog lamp switch)
(E112) GY/12 : Combination switch (Wiper and washer switch)
(E114) GY/6 : Daytime light control unit

- (E115) GY/8 : Daytime light control unit
(E116) BR/20 : To (M75)
(E117) W/16 : To (B101) (With ESP)
(E118) B/2 : To (B102) (With ESP)
(E119) W/20 : To (B103) (With ESP)
(E120) W/8 : To (B104) (Without ESP)
(E121) W/2 : Diode
(E122) SMJ : 4WD control unit (With ESP)
(E123) SMJ : 4WD/ABS control unit (Without ESP)
(E124) W/2 : Diode
(E124) W/2 : Diode

- (E123) , (E124)
Headlamp LH
Combination switch (Lighting switch)
Combination switch (Lighting switch)
Headlamp LH

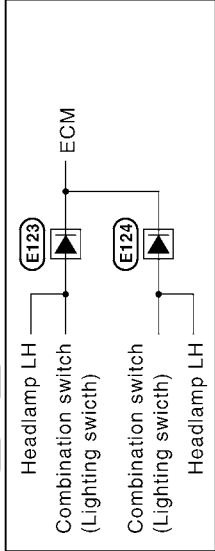
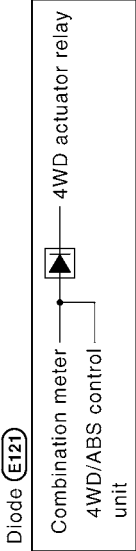

★ : Be sure to connect and lock the connectors securely after repair work.
Failure to do so may cause the ECM to have diagnostic trouble codes.
Do not disconnect these connectors except in the case of working according to WORK FLOW of TROUBLE DIAGNOSES in EC and AT sections.

HARNESS

ENGINE ROOM HARNESS/RHD MODELS
Gasoline Engine Models

To ESM

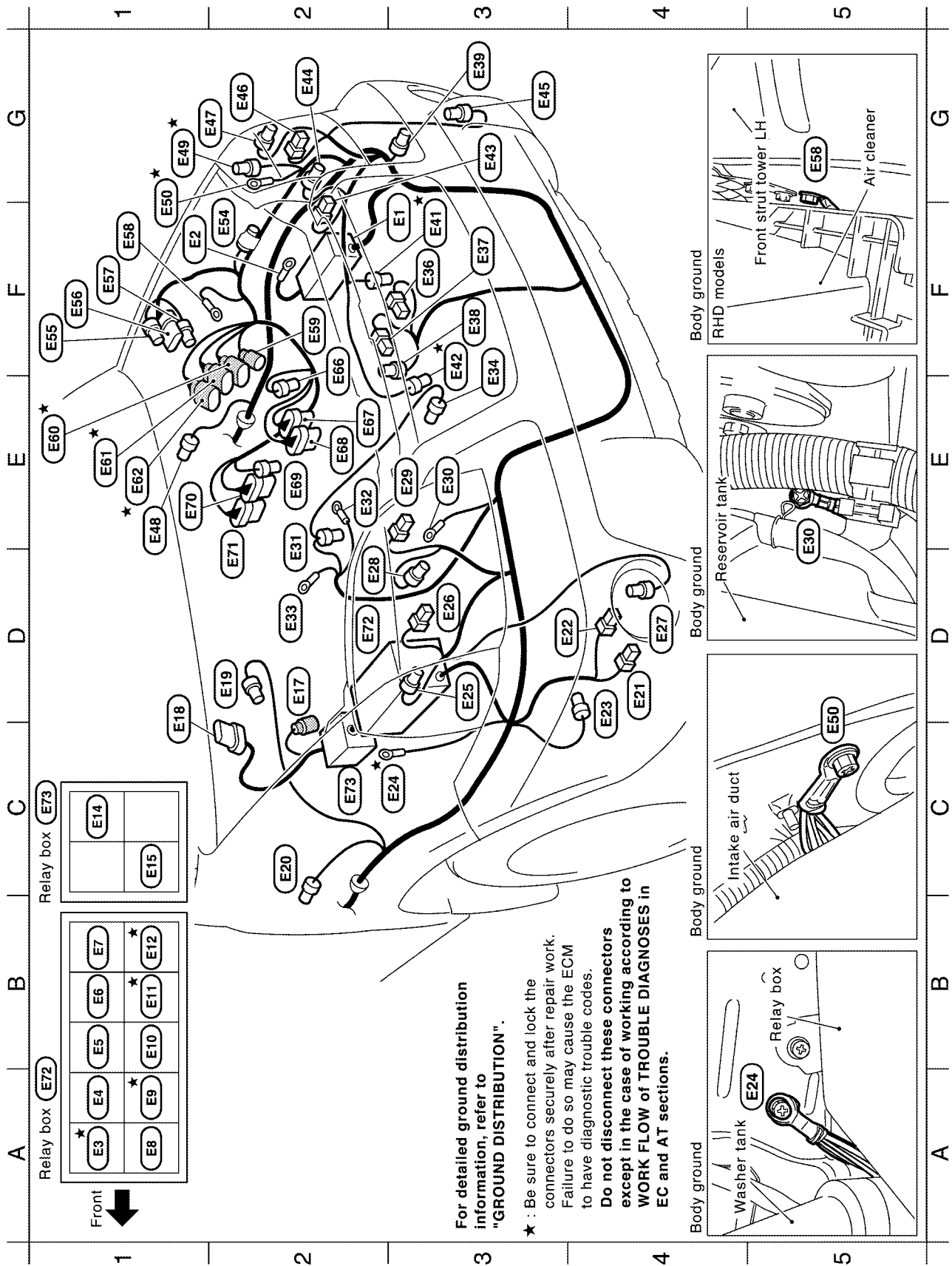

F3	(E1)	—	: Fuse and Fusible link box
F1	(E2)	—	: Battery (+)
A1	(E3)	BR/6	: Cooling fan relay-1
A1	(E4)	W/3	: Horn relay
B1	(E5)	L/4	: Air conditioner relay (With auto A/C)
B1	(E6)	L/4	: Park/Neutral position relay (With A/T)
B1	(E7)	L/4	: Front fog lamp relay
A1	(E8)	BR/6	: Headlamp washer timer
A1	(E9)	BR/6	: Cooling fan relay-2
B1	(E10)	B/5	: 4WD actuator relay
B1	(E11)	BR/6	: Cooling fan relay-3
B1	(E12)	L/4	: Throttle control motor relay
C1	(E14)	L/4	: Driving lamp relay-1
C1	(E15)	L/4	: Rear fog lamp relay
D2	(E17)	GY/2	: Front wheel sensor RH
D1	(E18)	GY/6	: Front wiper motor
D2	(E19)	GY/2	: Brake fluid level switch
C2	(E20)	BR/2	: Side turn signal lamp RH
D4	(E21)	W/2	: Front washer motor
D4	(E22)	G/2	: Rear washer motor
D4	(E23)	GY/2	: Headlamp washer motor
C3	(E24)	—	: Body ground
D3	(E25)	GY/2	: Front turn signal lamp RH
D3	(E26)	B/3	: Headlamp RH
D4	(E27)	GY/2	: Front fog lamp RH
D2	(E28)	B/3	: Headlamp aiming motor RH
E3	(E29)	B/2	: Parking lamp RH
E3	(E30)	—	: Body ground
E2	(E31)	GY/2	: Alternator
E2	(E32)	—	: Alternator
D2	(E33)	—	: Alternator
F3	(E34)	B/1	: Compressor (With auto A/C)
F3	(E36)	B/1	: Horn high
F3	(E37)	B/1	: Horn low
F3	(E38)	B/2	: Ambient sensor
G3	(E39)	B/3	: Refrigerant pressure sensor (With auto A/C)
F3	(E41)	GY/4	: Cooling fan motor-1
F3	(E42)	GY/4	: Cooling fan motor-2
G3	(E43)	B/2	: Parking lamp LH

G2	(E44)	B/3	: Headlamp aiming motor LH
G3	(E45)	GY/2	: Front fog lamp LH
G2	(E46)	B/3	: Headlamp LH
G2	(E47)	GY/2	: Front turn signal lamp LH
E1	(E48)	BR/2	: Side turn signal lamp LH
G1	(E49)	GY/2	: Dropping resistor (With A/T)
G1	(E50)	—	: Body ground
F2	(E54)	GY/2	: Option connector for hood switch
F1	(E55)	B/2	: ESP relay box (With ESP)
F1	(E56)	B/8	: ESP relay box (With ESP)
F1	(E57)	GY/2	: ESP relay box (With ESP)
F1	(E58)	—	: Body ground
F2	(E59)	BR/2	: Front wheel sensor LH
E1	(E60)	GY/9	: To (F36)
E1	(E61)	DGY/8	: To (F38)
E1	(E62)	GY/8	: To (F37)
F2	(E66)	B/2	: ESP actuator (With ESP)
E2	(E67)	DGY/8	: ESP actuator (With ESP)
E2	(E68)	SB/8	: ESP actuator (With ESP)
E2	(E69)	GY/2	: ABS actuator (Without ESP)
E1	(E70)	B/8	: ABS actuator (Without ESP)
D2	(E71)	GY/8	: ABS actuator (Without ESP)
A1, D2	(E72)	—	: Relay box
C1, C2	(E73)	—	: Relay box

★: Be sure to connect and lock the connectors securely after repair work.
Failure to do so may cause the ECM to have diagnostic trouble codes.
Do not disconnect these connectors except in the case of working according to WORK FLOW of TROUBLE DIAGNOSES in EC and AT sections.

HARNESS

Diesel Engine Models

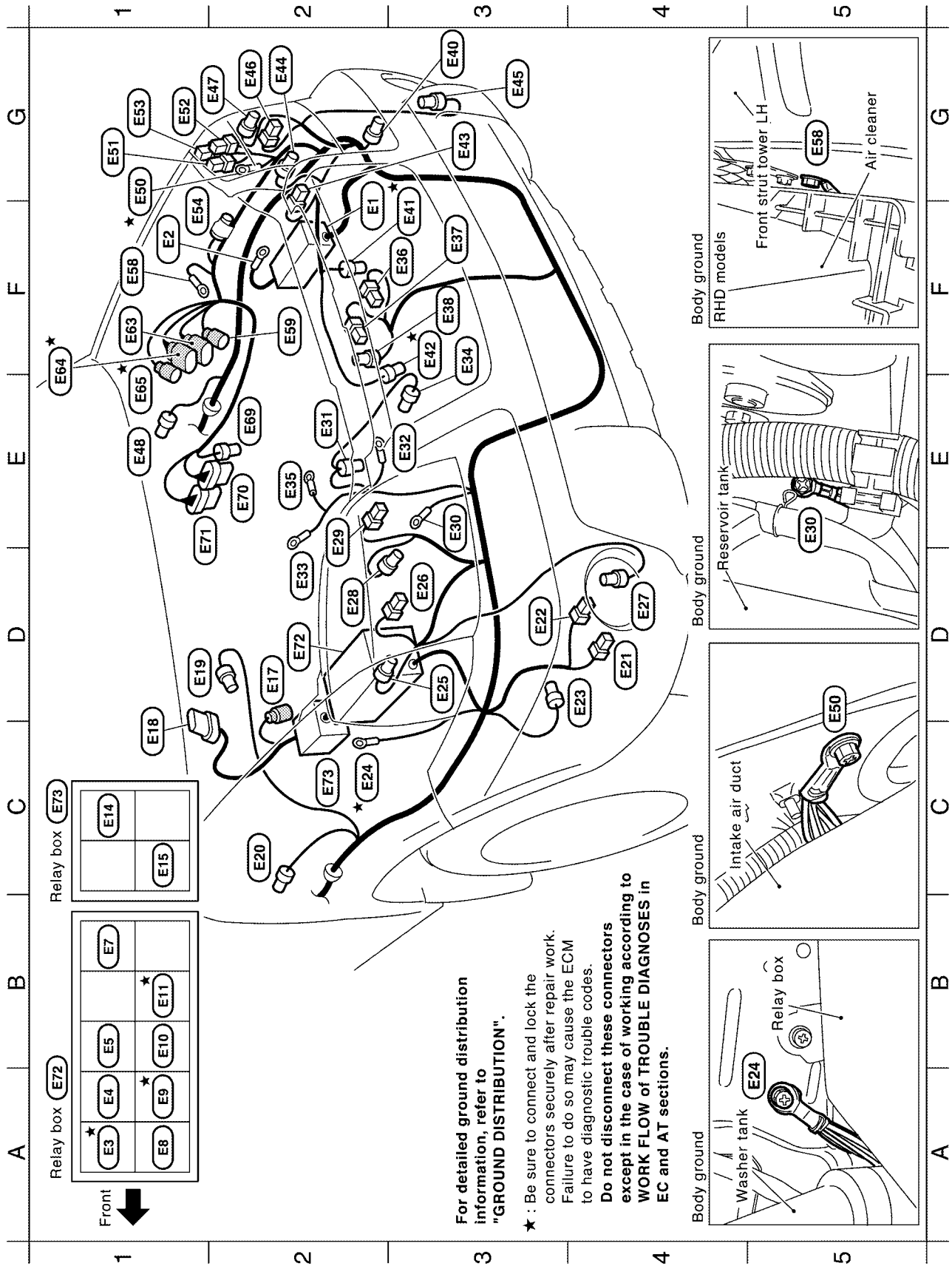

For detailed ground distribution information, refer to "GROUND DISTRIBUTION".

★ : Be sure to connect and lock the connectors securely after repair work. Failure to do so may cause the ECM to have diagnostic trouble codes.

Do not disconnect these connectors except in the case of working according to WORK FLOW of TROUBLE DIAGNOSES in EC and AT sections.

F2	(E1)	—	: Fuse and Fusible link box
F1	(E2)	—	: Battery (+)
A1	(E3)	BR/6	: Cooling fan relay-1
A1	(E4)	W/3	: Horn relay
B1	(E5)	L/4	: Air conditioner relay (With auto A/C)
B1	(E7)	L/4	: Front fog lamp relay
A1	(E8)	BR/6	: Headlamp washer timer
A1	(E9)	BR/6	: Cooling fan relay-2
B1	(E10)	B/5	: 4WD actuator relay
B1	(E11)	BR/6	: Cooling fan relay-3
C1	(E14)	L/4	: Driving lamp relay-1
C1	(E15)	L/4	: Rear fog lamp relay
D2	(E17)	GY/2	: Front wheel sensor RH
C1	(E18)	GY/6	: Front wiper motor
D1	(E19)	GY/2	: Brake fluid level switch
C2	(E20)	BR/2	: Side turn signal lamp RH
D4	(E21)	W/2	: Front washer motor
D3	(E22)	G/2	: Rear washer motor
D4	(E23)	GY/2	: Headlamp washer motor
C2	(E24)	—	: Body ground
D3	(E25)	GY/2	: Front turn signal lamp RH
D3	(E26)	B/3	: Headlamp RH
D4	(E27)	GY/2	: Front fog lamp RH
D2	(E28)	B/3	: Headlamp aiming motor RH
E2	(E29)	B/2	: Parking lamp RH
E3	(E30)	—	: Body ground
E2	(E31)	GY/2	: Alternator
E3	(E32)	—	: Alternator
D2	(E33)	—	: Alternator
F3	(E34)	B/1	: Compressor (With auto A/C)
E2	(E35)	—	: Glow plug
F3	(E36)	B/1	: Horn high
F3	(E37)	B/1	: Horn low
F3	(E38)	B/2	: Ambient sensor
G3	(E40)	B/2	: Dual-pressure switch (With auto A/C)
F3	(E41)	GY/4	: Cooling fan moter-1
F3	(E42)	GY/4	: Cooling fan moter-2
G3	(E43)	B/2	: Parking lamp LH

G2	(E44)	B/3	: Headlamp aiming motor LH
G3	(E45)	GY/2	: Front fog lamp LH
G2	(E46)	B/3	: Headlamp LH
G2	(E47)	GY/2	: Front turn signal lamp LH
E1	(E48)	BR/2	: Side turn signal lamp LH
G1	(E50)	—	: Body ground
G1	(E51)	W/1	: Glow relay
G1	(E52)	W/1	: Glow relay
G1	(E53)	G/2	: Glow relay
F1	(E54)	GY/2	: Option connector for hood switch
F1	(E58)	—	: Body ground
F2	(E59)	BR/2	: Front wheel sensor LH
F1	(E63)	GY/8	: To (F4)
F1	(E64)	B/6	: To (F5)
E1	(E65)	B/2	: To (F6)
E2	(E69)	GY/2	: ABS actuator
E2	(E70)	B/8	: ABS actuator
E1	(E71)	GY/8	: ABS actuator
A1, D2	(E72)	—	: Relay box
C1, C2	(E73)	—	: Relay box

★: Be sure to connect and lock the connectors securely after repair work.
Failure to do so may cause the ECM to have diagnostic trouble codes.
Do not disconnect these connectors except in the case of working according to WORK FLOW of TROUBLE DIAGNOSES in EC and AT sections.

Passenger Compartment

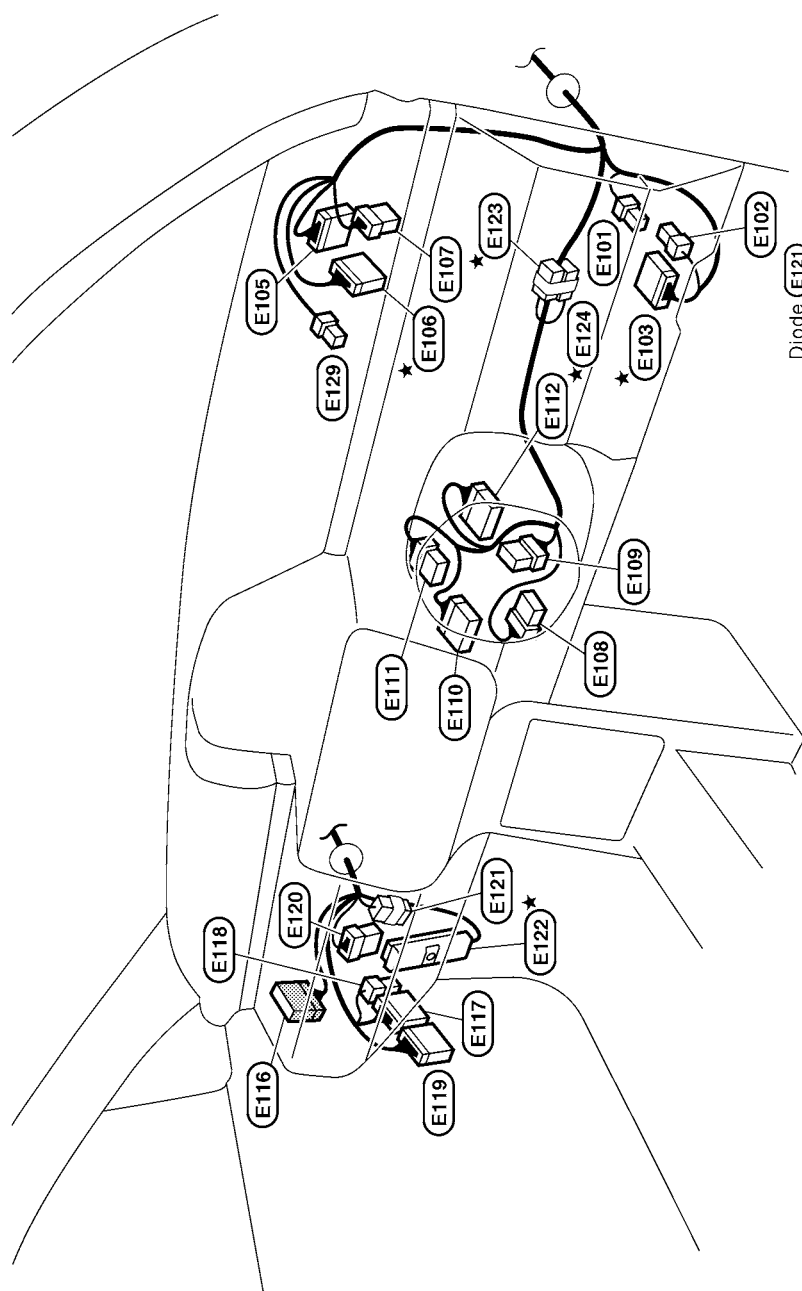

- E101 : Fuse block (J/B)
- E102 : Fuse block (J/B)
- E103 : Fuse block (J/B)
- E105 : To M13
- E106 : To M14
- E107 : To M15
- E108 : Ignition switch
- E109 : NATS IMMU
- E110 : Combination switch (Lighting switch)
- E111 : Combination switch (Fog lamp switch)
- E112 : Combination switch (Wiper and washer switch)
- E116 : To M75

- E117 : W/16 : To B101 (With ESP)
- E118 : B/2 : To B102 (With ESP)
- E119 : W/20 : To B103 (With ESP)
- E120 : W/8 : To B104 (Without ESP)
- E121 : W/2 : Diode
- E122 : SMJ : 4WD control unit (With ESP)
- E123 : SMJ : 4WD/ABS control unit (Without ESP)
- E124 : W/2 : Diode
- E129 : BR/6 : Driving lamp relay-2

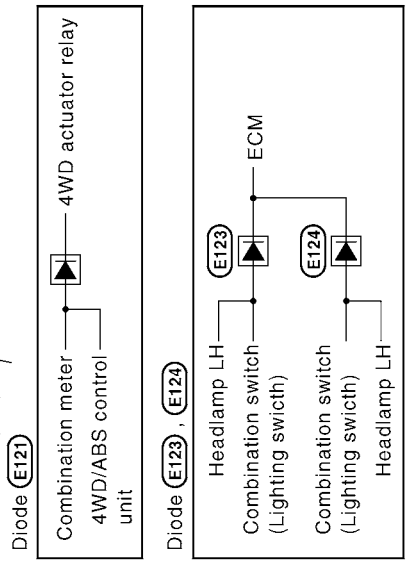

★ : Be sure to connect and lock the connectors securely after repair work.
Failure to do so may cause the ECM to have diagnostic trouble codes.
Do not disconnect these connectors except in the case of working according to WORK FLOW of TROUBLE DIAGNOSES in EC and AT sections.

HARNESS

BODY NO.2 HARNESS/LHD MODELS

To ESM

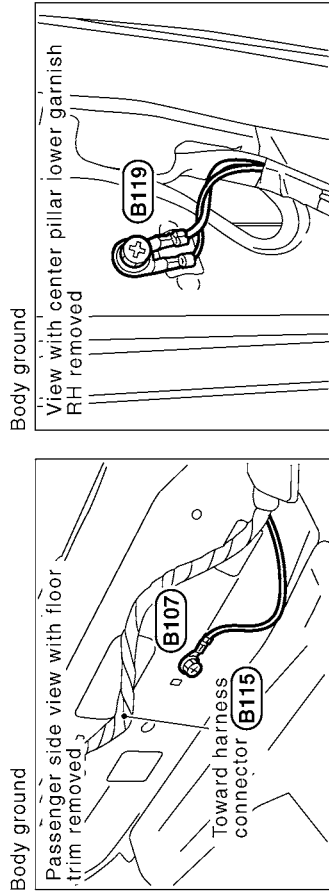

B101	W/16 : To E117 (With ESP)
B102	B/2 : To E118
B103	W/20 : To E119 (With ESP)
B104	W/8 : To E120 (With ESP)
B105	W/12 : To M78 (Without ESP)
B106	W/8 : To M79
B107	— : Body ground (With ESP)
B109	Y/2 : Front RH side air bag module (With side air bag)
B110	GY/3 : Heated seat RH (With heater seat)
B111	SMJ : ESP/TCS/ABS control unit
B112	B/6 : Yaw rate and G sensor
B113	W/3 : Seat belt buckle switch (Passenger side)
B114	B/1 : Parking brake switch
B115	Y/12 : Air bag diagnosis sensor unit
B116	Y/2 : RH side air bag (Satellite) sensor (With side air bag)
B117	Y/2 : Front RH seat belt pre-tensioner
B118	W/3 : Front door switch (Passenger side)
B119	— : Body ground
B120	W/8 : To D21
B121	W/1 : Rear door switch RH
B125	GY/4 : Sub fuel level sensor unit
B126	BR/2 : Rear wheel sensor LH
B128	W/6 : To B22
B129	B/2 : To B151
B130	GY/2 : Rear wheel sensor RH
B131	W/6 : Heated seat switch LH
B132	BR/6 : Heated seat switch RH

Transmission sub-harness

B151	B/2 : To B129
B152	GY/2 : 4WD solenoid valve

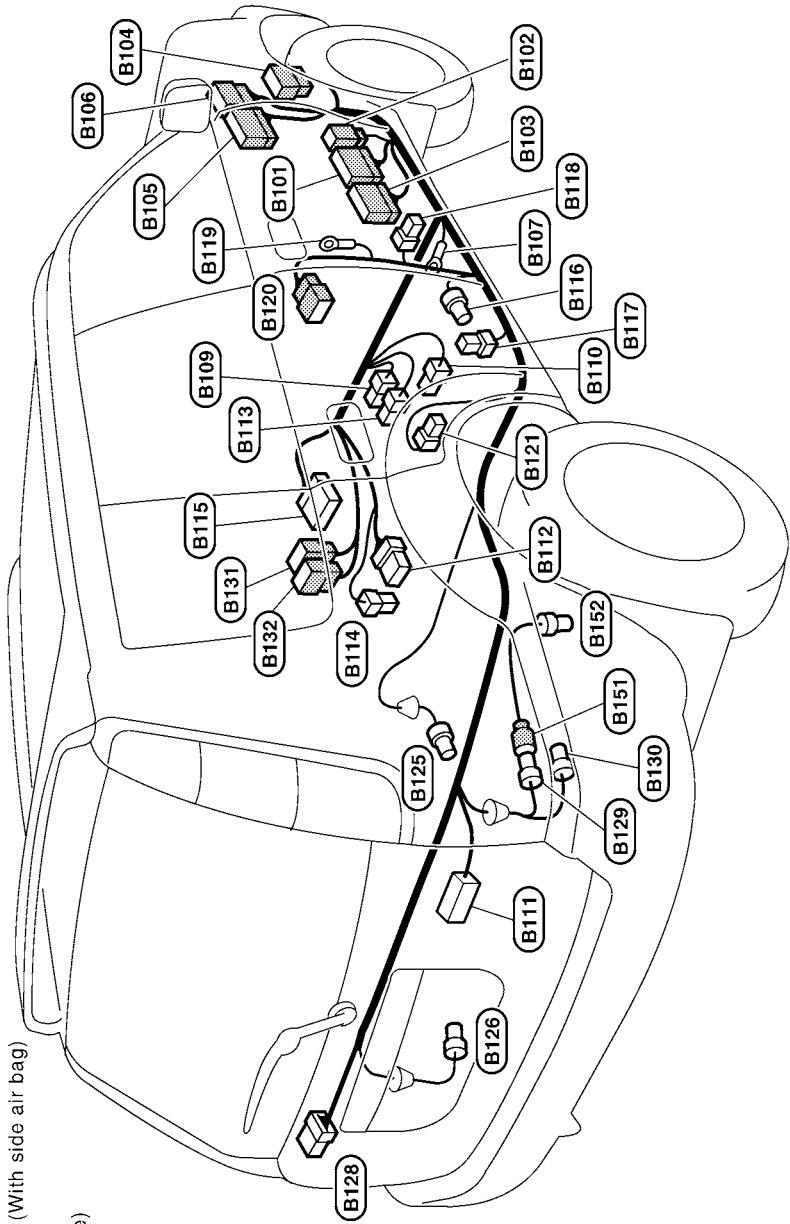

For detailed ground distribution information, refer to "GROUND DISTRIBUTION".

HARNESS

ROOM LAMP HARNESS

To ESM

- R6 W/1 : Sunroof motor assembly
- R7 W/2 : Luggage room lamp
- R8 — : Body ground
- R9 GY/2 : Driving lamp LH
- R10 W/3 : Driving lamp RH

- R1 W/8 : To (M73)
- R2 W/2 : Spot lamp
- R3 GY/6 : Sunroof switch
- R4 W/2 : Interior room lamp
- R5 W/6 : Sunroof motor assembly

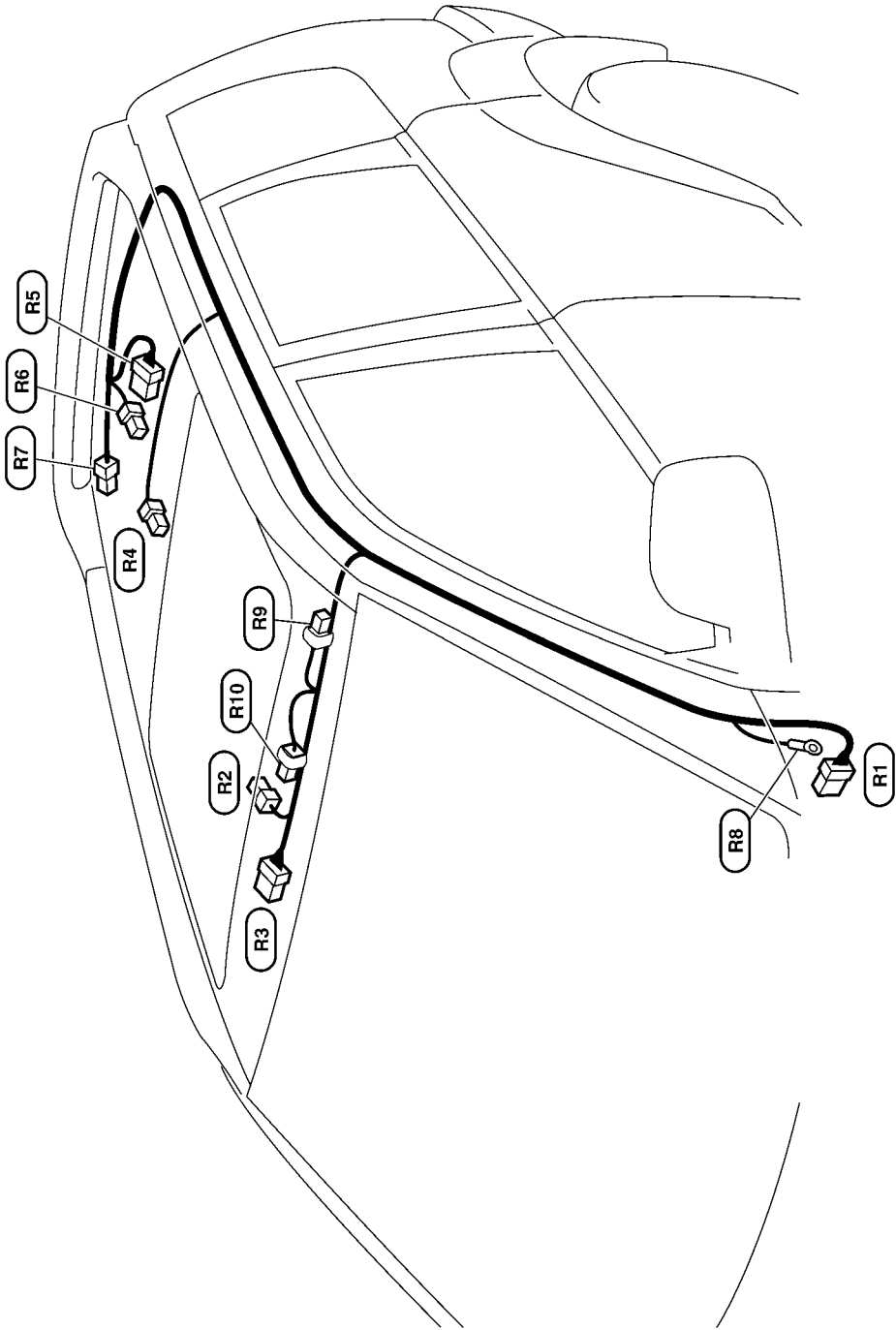

ELECTRICAL UNITS LOCATION

ELECTRICAL UNITS LOCATION

PFP:25230

Electrical Units Location ENGINE COMPARTMENT

To ESM

EKS0032K

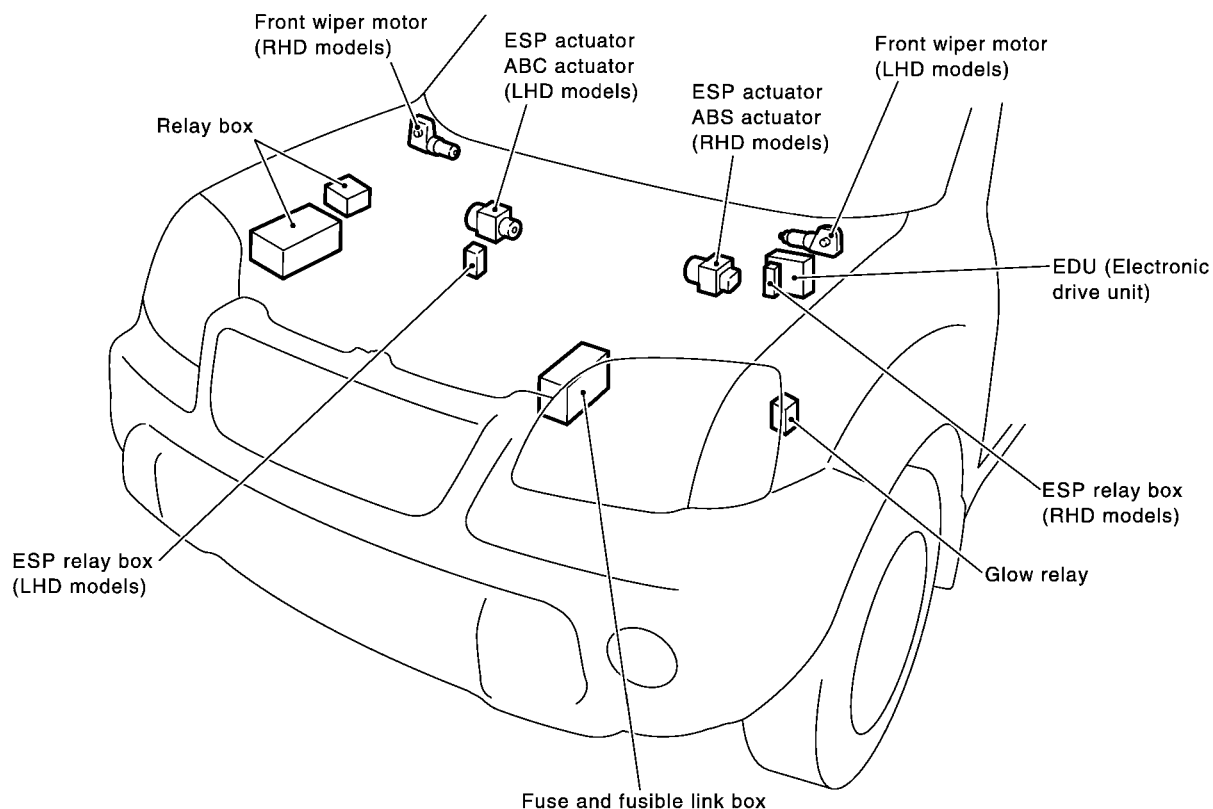

Relay box

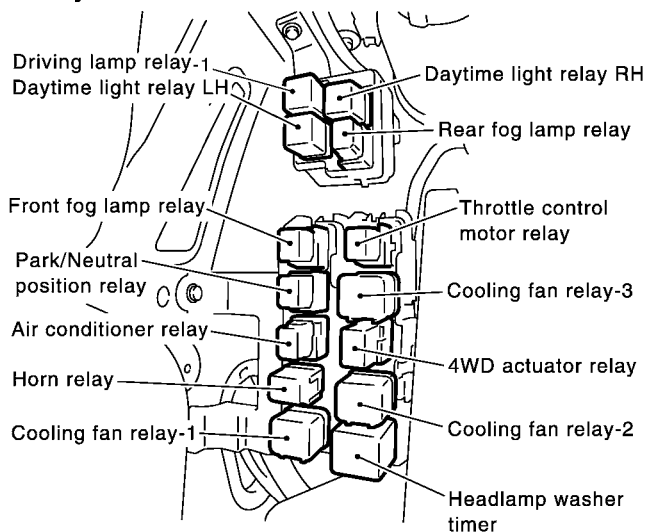

Fuse and fusible link box

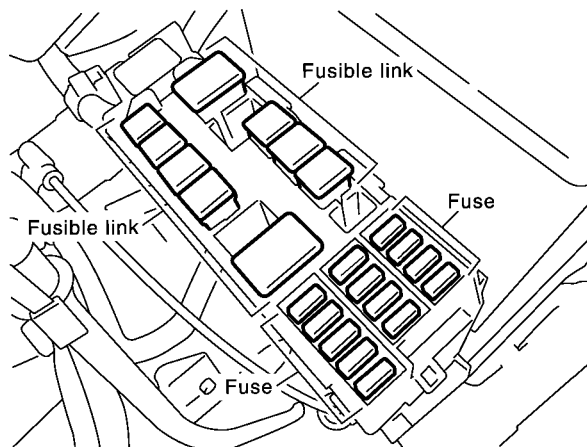

ELECTRICAL UNITS LOCATION

PASSENGER COMPARTMENT/LHD MODELS

To ESM

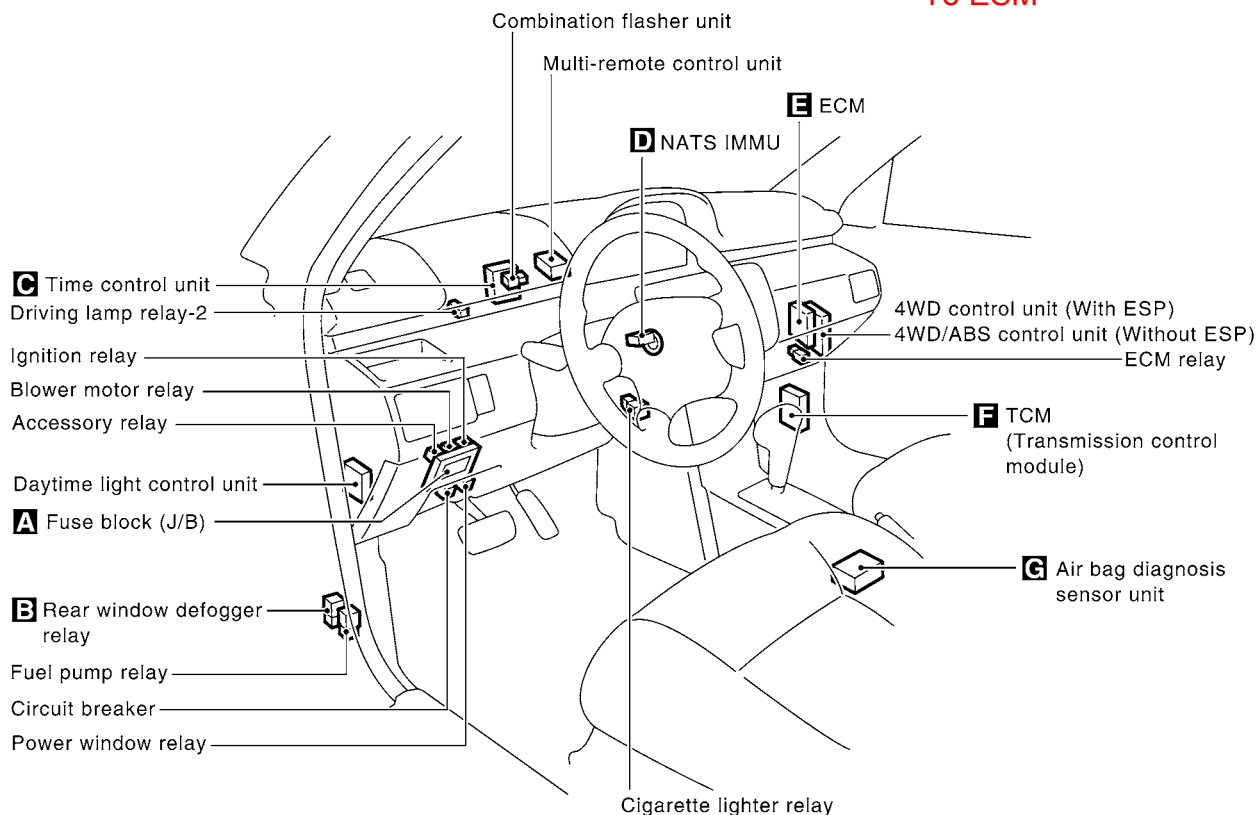

A Instrument panel LH

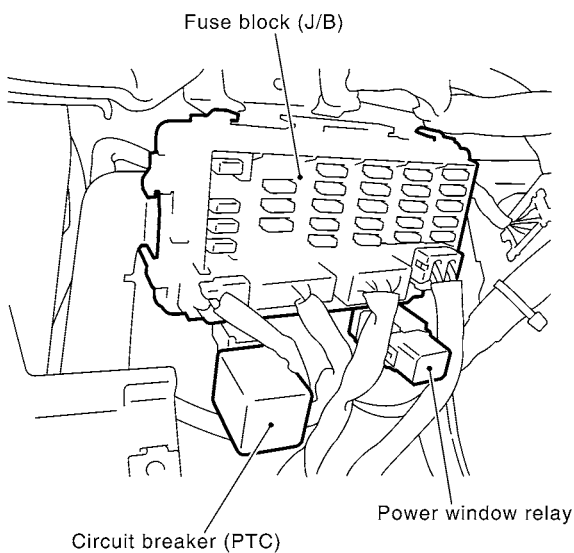

Back of the fuse block (J/B)

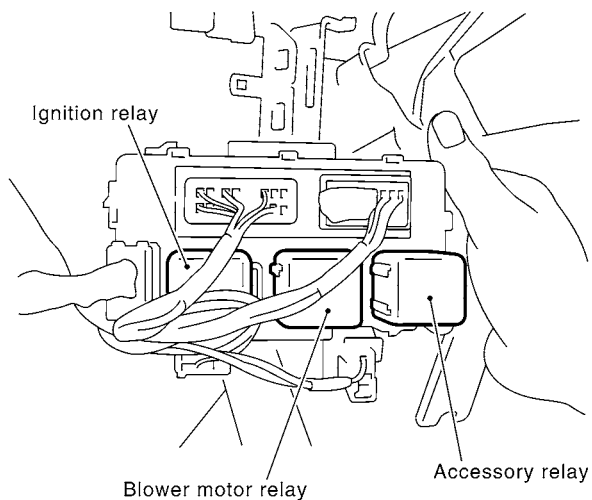

ELECTRICAL UNITS LOCATION

PASSENGER COMPARTMENT/RHD MODELS

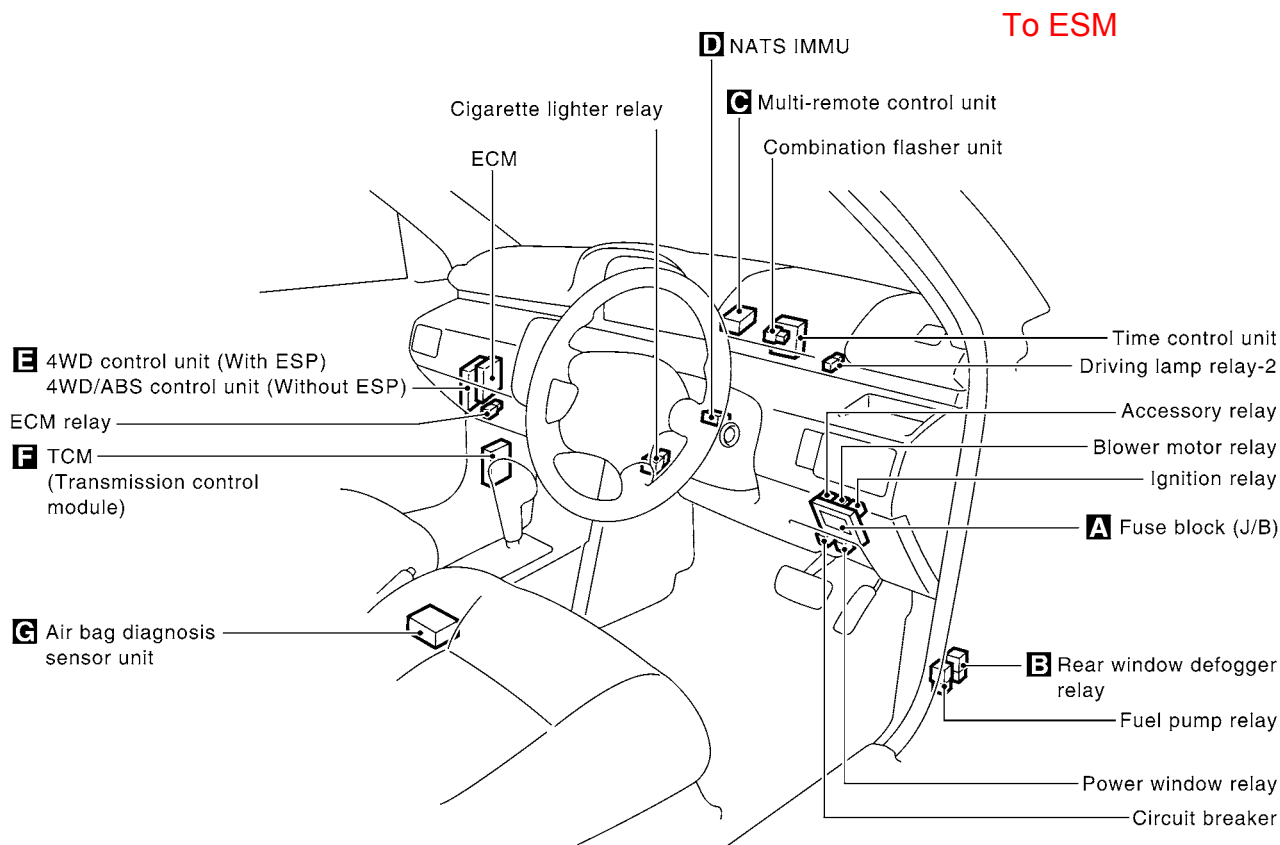

A Instrument panel RH

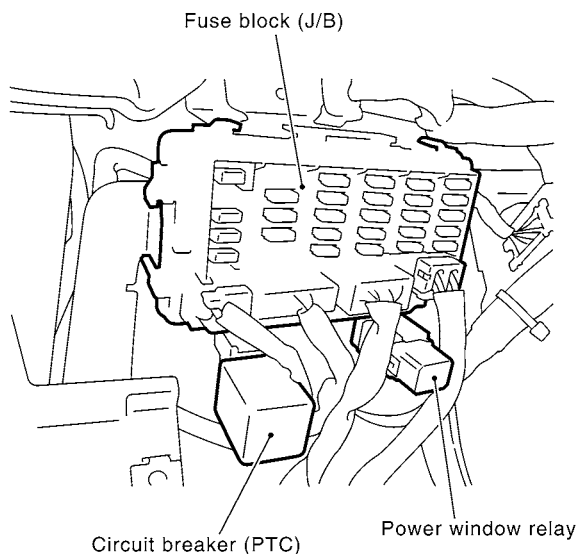

Back of the fuse block (J/B)

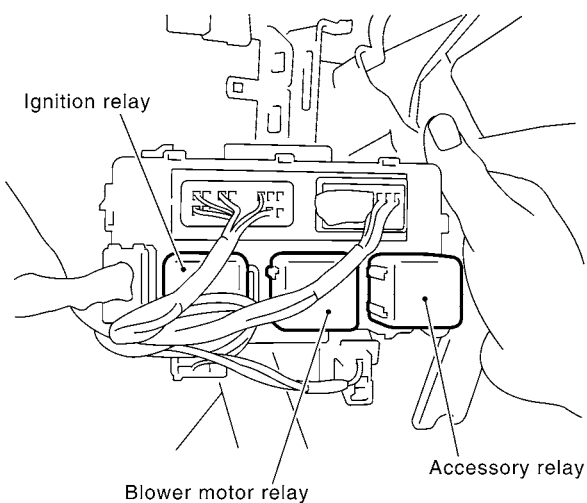

FUSE AND FUSIBLE LINK BOX

FUSE AND FUSIBLE LINK BOX
Terminal Arrangement

PFP:24381

To ESM

EKS0032G

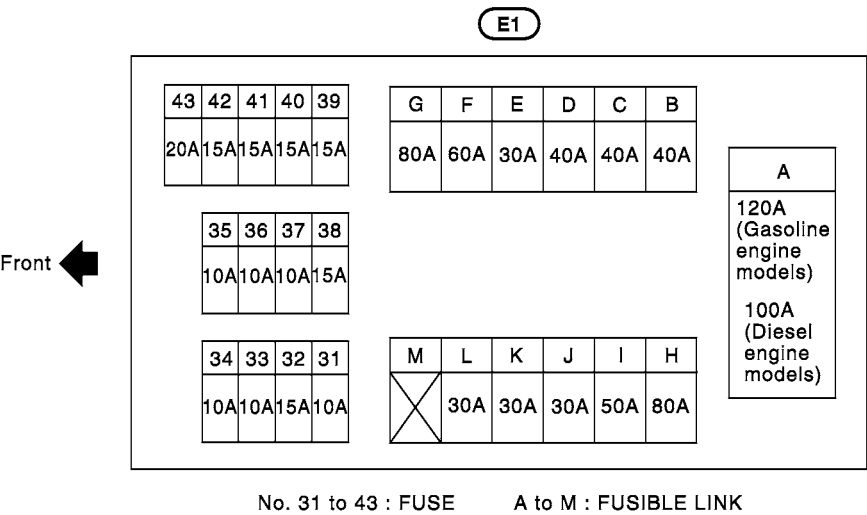

CKIA0303E