

SECTION

WW

WIPER, WASHER & HORN

A

B

C

CONTENTS

E

PRECAUTIONS	3	Terminal and Reference Values for Combination Switch	17	F
Precautions for Supplemental Restraint System (SRS) "AIR BAG" and "SEAT BELT PRE-TENSIONER"	3	Removal and Installation of Rear Wiper Arms, Adjustment of Wiper Arms Stop Location	17	G
FRONT WIPER AND WASHER SYSTEM	4	REMOVAL	17	
System Description	4	INSTALLATION	17	
WIPER OPERATION	4	Removal and Installation of Rear Wiper Motor	18	H
WASHER OPERATION	5	REMOVAL	18	
Wiring Diagram — WIPER —	6	INSTALLATION	18	
LHD MODELS	6	Rear Washer Nozzle Adjustment	19	I
RHD MODELS	7	Removal and Installation of Rear Washer Nozzle..	19	
Terminal and Reference Values for Combination Switch	8	REMOVAL	19	
Removal and Installation of Front Wiper Arms, Adjustment for Wiper Arms Stop Location	9	INSTALLATION	19	J
REMOVAL	9	Inspection for Rear Washer Nozzle	19	
INSTALLATION	9	CHECK VALVE	19	
Removal and Installation of Front Wiper Drive Assembly	10	Removal and Installation of Wiper and Washer Switch	20	WW
REMOVAL	10	Removal and Installation of Washer Tank	20	
INSTALLATION	11	Removal and Installation of Washer Pump	20	
Front Washer Nozzle Adjustment	12	Washer Tube Layout	20	
Washer Tube Layout	12	HEADLAMP WASHER	21	L
Removal and Installation of Front Washer Nozzle..	13	System Description	21	
REMOVAL	13	Wiring Diagram —HLC—	22	
INSTALLATION	13	LHD MODELS	22	M
Inspection for Front Washer Nozzle	13	RHD MODELS	24	
CHECK VALVE	13	Removal and Installation of Headlamp Washer Noz- zle	26	
Removal and Installation of Wiper and Washer Switch	13	REMOVAL	26	
REMOVAL	13	INSTALLATION	26	
INSTALLATION	13	Inspection for Headlamp Washer Nozzle	26	
Removal and Installation of Washer Tank	14	CHECK VALVE	26	
REMOVAL	14	Removal and Installation of Washer Tank	26	
INSTALLATION	14	Removal and Installation of Headlamp Washer Pump	26	
Removal and Installation of Washer Pump	14	Washer Tube Layout	27	
REMOVAL	14	HORN	28	
INSTALLATION	14	Wiring Diagram — HORN —	28	
REAR WIPER AND WASHER SYSTEM	15	Removal and Installation	29	
Wiring Diagram — WIP/R —	15	REMOVAL	29	
		INSTALLATION	29	

CIGARETTE LIGHTER	30	REMOVAL	33
Wiring Diagram — CIGAR —	30	INSTALLATION	33
Removal and Installation	31	Removal and Installation of Front Power Socket	
REMOVAL	31	(Center Console)	33
INSTALLATION	31	REMOVAL	33
POWER SOCKET	32	INSTALLATION	33
Wiring Diagram —POWER SOCKET—	32	Removal and Installation of Rear Power Socket	33
Removal and Installation of Front Power Socket		REMOVAL	33
(Driver Box)	33	INSTALLATION	33

PRECAUTIONS

PRECAUTIONS

PFP:00011

Precautions for Supplemental Restraint System (SRS) “AIR BAG” and “SEAT BELT PRE-TENSIONER”

BKS000LR

The Supplemental Restraint System such as “AIR BAG” and “SEAT BELT PRE-TENSIONER”, used along with a front seat belt, helps to reduce the risk or severity of injury to the driver and front passenger for certain types of collision. Information necessary to service the system safely is included in the SRS and SB section of this Service Manual.

WARNING:

- To avoid rendering the SRS inoperative, which could increase the risk of personal injury or death in the event of a collision which would result in air bag inflation, all maintenance must be performed by an authorized NISSAN/INFINITI dealer.
- Improper maintenance, including incorrect removal and installation of the SRS, can lead to personal injury caused by unintentional activation of the system. For removal of Spiral Cable and Air Bag Module, see the SRS section.
- Do not use electrical test equipment on any circuit related to the SRS unless instructed to in this Service Manual. SRS wiring harnesses can be identified by yellow and/or orange harnesses or harness connectors.

A
B
C
D
E
F
G
H
I
J
L
M

WW

FRONT WIPER AND WASHER SYSTEM

PFP:28810

System Description WIPER OPERATION

BKS000LT

The wiper switch is controlled by a lever built into the combination switch.
There are three wiper switch positions:

- LO speed
- HI speed
- INT (Intermittent)

With the ignition switch in the ON or START position, power is supplied

- through 20A fuse [No. 6, located in fuse block (J/B)]
- to front wiper motor terminal 2, and
- to front wiper and washer switch terminal 15.

Ground is supplied

- to front wiper and washer switch terminal 17
- through grounds E24 and E50.

Low and High Speed Wiper Operation

When the wiper switch is placed in the LO position, ground is supplied

- to front wiper motor terminal 3 (LHD models)
- to front wiper motor terminal 1 (RHD models)
- through front wiper and washer switch terminal 14,
- through front wiper and washer switch terminal 17
- through grounds E24 and E50.

With power and ground supplied, the wiper motor operates at low speed.

When the wiper switch is placed in the HI position, ground is supplied

- to front wiper motor terminal 5 (LHD models)
- to front wiper motor terminal 4 (RHD models)
- through front wiper and washer switch terminal 16
- through front wiper and washer switch terminal 17
- through grounds E24 and E50.

With power and ground supplied, the wiper motor operates at high speed.

Auto Stop Operation

With wiper switch turned OFF, wiper motor will continue to operate until wiper arms reach windshield base.

When wiper arms are not located at base of windshield with wiper switch OFF, ground is provided

- to front wiper motor terminal 3 (LHD models)
- to front wiper motor terminal 1 (RHD models)
- through front wiper and washer switch terminal 14, in order to continue wiper motor operation at low speed.

Ground is supplied

- to front wiper and washer switch terminal 13
- through front wiper motor terminal 4 (LHD models)
- through front wiper motor terminal 1 (LHD models)
- through front wiper motor terminal 5 (RHD models)
- through front wiper motor terminal 3 (RHD models)
- through grounds E24 and E50.

When wiper arms reach base of windshield, front wiper motor terminals 2 and 4 (LHD models) or 2 and 5 (RHD models) are connected instead of terminals 1 and 4 (LHD models) or 3 and 5 (RHD models). Wiper motor will then stop wiper arms at the STOP position.

FRONT WIPER AND WASHER SYSTEM

Intermittent Operation

The front wiper motor operates the wiper arms one time at low speed at a set interval of approximately 1 to 15 seconds. This feature is controlled by the wiper amplifier (INT SW) combined with front wiper and washer switch.

When the wiper switch is placed in the INT position, ground is supplied to wiper amplifier.

The desired interval time is input to wiper amplifier (INT VR) from wiper volume switch combined with front wiper and washer switch.

Then intermittent ground is supplied

- to front wiper motor terminal 3 (LHD models)
- to front wiper motor terminal 1 (RHD models)
- through front wiper and washer switch terminal 14
- through wiper amp.

The wiper motor operates at low speed at the desired interval.

WASHER OPERATION

With the ignition switch in the ON or START position, power is supplied

- through 20A fuse [No. 6, located in fuse block (J/B)]
- to front washer pump terminal 1.

Ground is supplied

- to front wiper and washer switch terminal 17
- through grounds E24 and E50.

When the washer switch is pulled to the ON position, ground is supplied

- to front washer pump terminal 2
- through front wiper and washer switch terminal 18
- through front wiper and washer switch terminal 17, and
- through grounds E24 and E50.

With power and ground supplied, the washer motor operates.

When the washer switch is pulled to the ON position for one second or more, the wiper motor operates at low speed for approximately 3 seconds to clean windshield. This feature is controlled by the wiper amplifier in the same manner as the intermittent operation.

A

B

C

D

E

F

G

H

I

J

WW

L

M

FRONT WIPER AND WASHER SYSTEM

Wiring Diagram — WIPER — LHD MODELS

BKS000LU

WW-WIPER-01

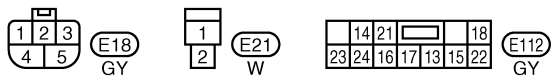
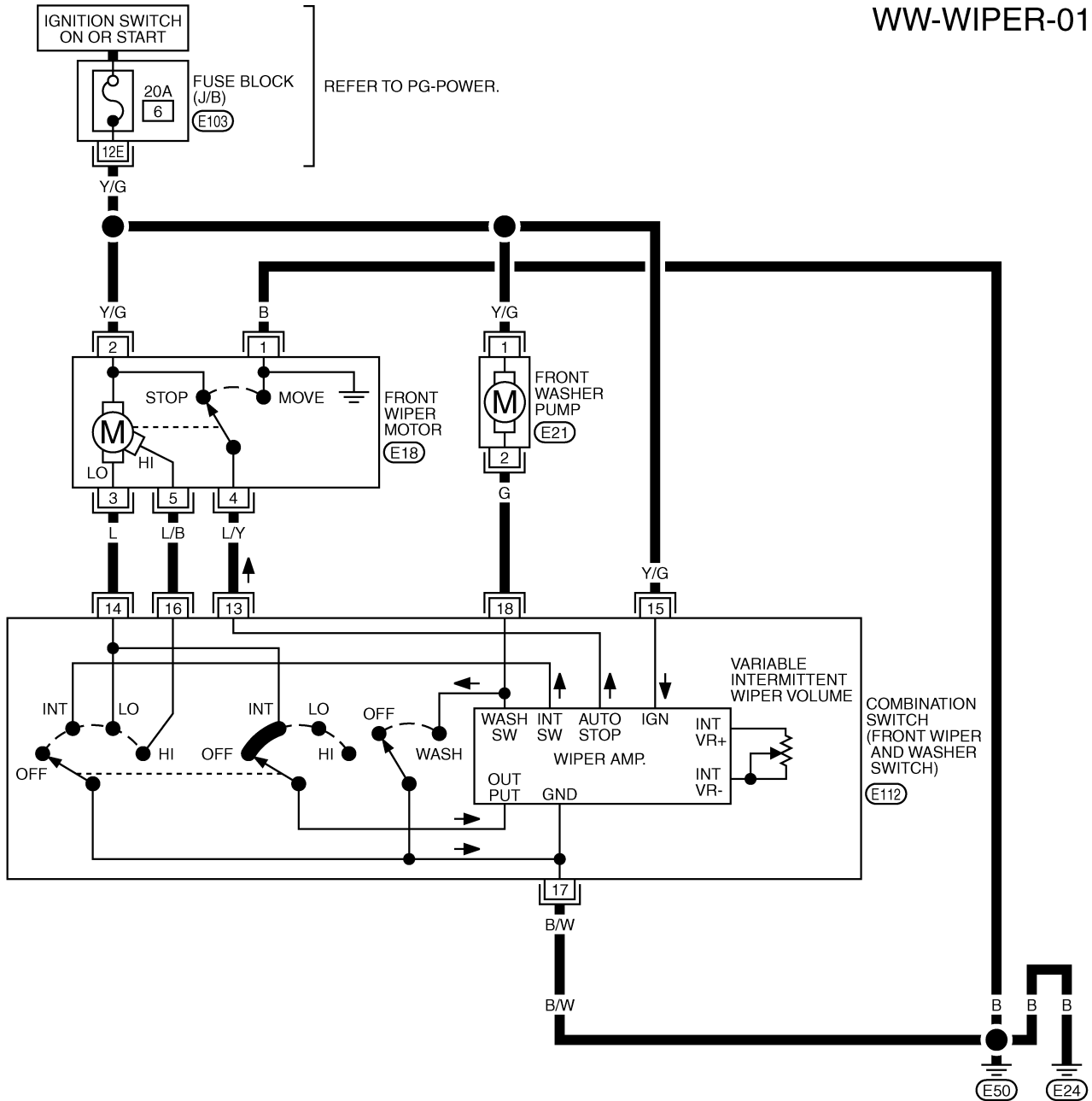

REFER TO THE FOLLOWING.
(E103) -FUSE BLOCK-JUNCTION BOX (J/B)

TKWB2767E

FRONT WIPER AND WASHER SYSTEM

RHD MODELS

WW-WIPER-02

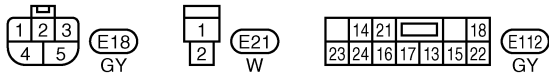
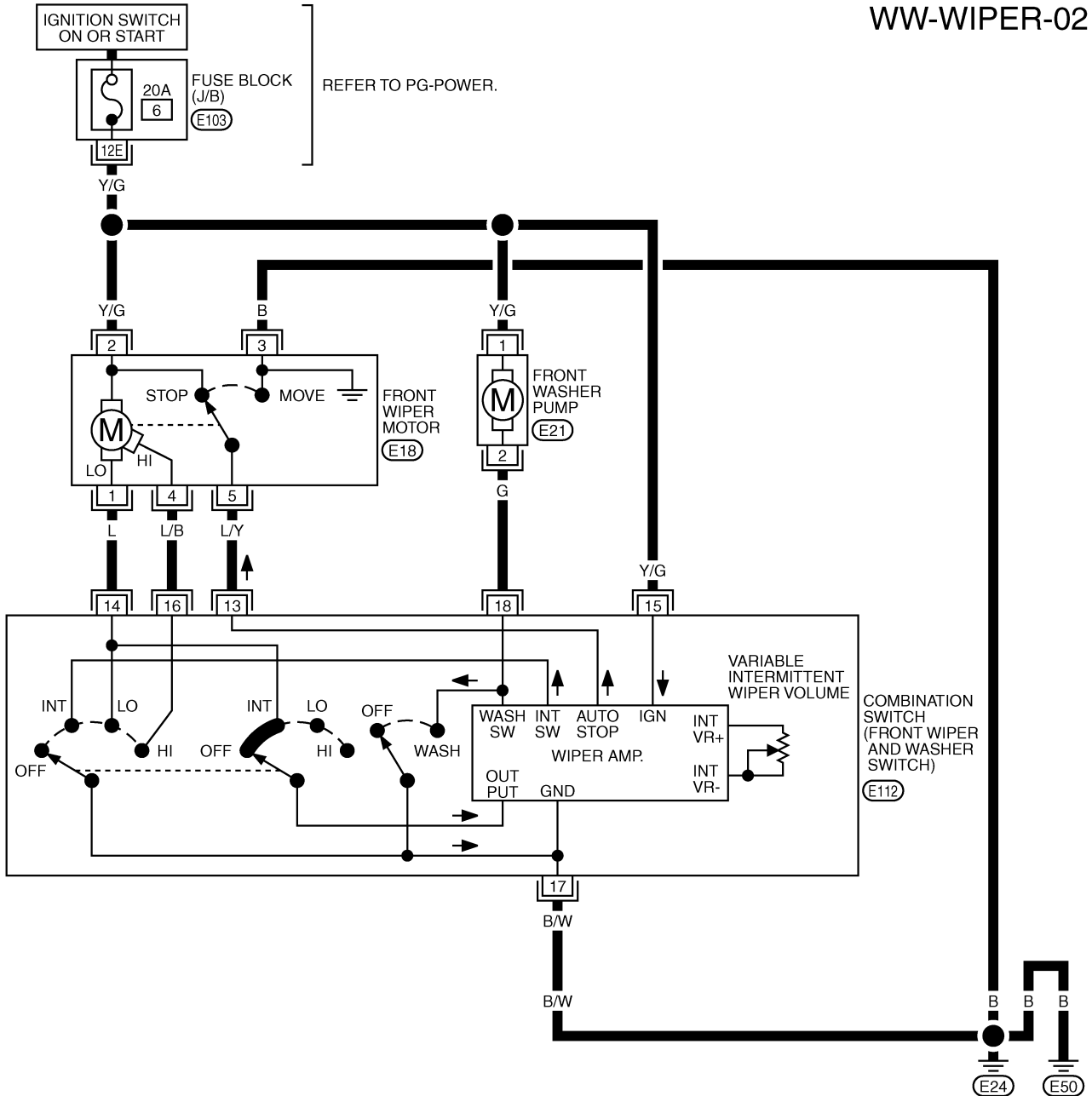

REFER TO THE FOLLOWING.
(E103) -FUSE BLOCK-JUNCTION BOX (J/B)

FRONT WIPER AND WASHER SYSTEM

Terminal and Reference Values for Combination Switch

BKS000LW

Terminal No.	Wire color	Signal name	Measuring condition		Reference value	
			Ignition switch	Condition or operation		
13	L/Y	Front wiper auto stop signal	ON	Wiper operating		Approx. 0 V
				Wiper stopped		Battery voltage
14	L	Front wiper motor operation signal (LO)	ON	Wiper switch	OFF	Battery voltage
					LO	Approx. 0 V
15	Y/G	Ignition switch (ON)	ON	—		Battery voltage
16	L/B	Front wiper motor operation signal (HI)	ON	Wiper switch	OFF	Battery voltage
					HI	Approx. 0 V
17	B/W	Ground	OFF	—		—
18	G	Front washer switch signal	ON	Wiper switch	WASH	Approx. 0 V
					OFF	Battery voltage

FRONT WIPER AND WASHER SYSTEM

Removal and Installation of Front Wiper Arms, Adjustment for Wiper Arms Stop Location

BKS000LX

REMOVAL

1. Turn wiper switch ON to operate wiper motor, and then turn wiper switch OFF (auto stop).
2. Open hood, remove nut covers, and remove wiper arm nuts.
3. Raise wiper arms, and remove front wiper arms from the vehicle.

INSTALLATION

1. Clean up the pivot area as shown in the figure. This will reduce possibility of wiper arm nuts looseness.
2. Prior to wiper arm installation, turn front wiper switch ON to operate wiper motor, and then turn front wiper switch OFF (auto stop).

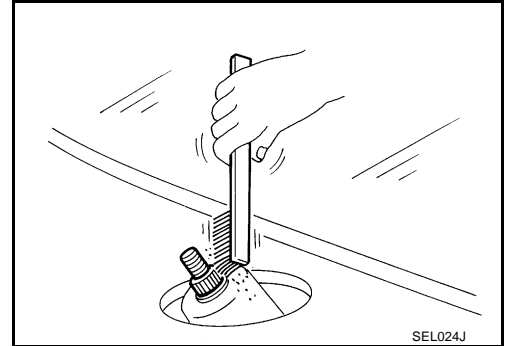

3. Lift the blade up and then set it down onto windshield glass surface to set the blade center to clearance "L1" & "L2" immediately.

Clearance "L1" : 49.2 - 64.2 mm (1.937 - 2.528 in)

Clearance "L2" : 39.3 - 54.3 mm (1.547 - 2.138 in)

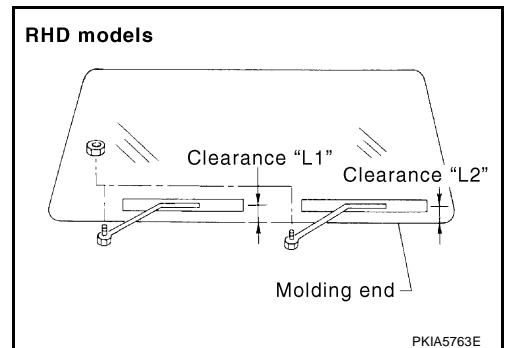
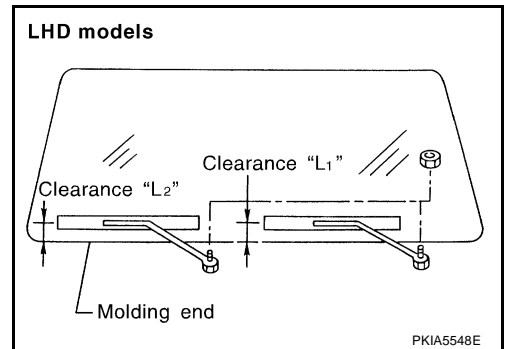

4. Tighten front wiper arm nuts to specified torque.

Front wiper arm nut  : 23.6 N·m (2.4 kg-m, 17 ft-lb)

5. Spray washer fluid. Turn front wiper switch ON to operate wiper motor, and then turn front wiper switch OFF (auto stop).
6. Make sure that wiper blades stop within clearance "L1" & "L2".
7. Install front wiper nut covers.

FRONT WIPER AND WASHER SYSTEM

Removal and Installation of Front Wiper Drive Assembly

BKS000LY

RHD models

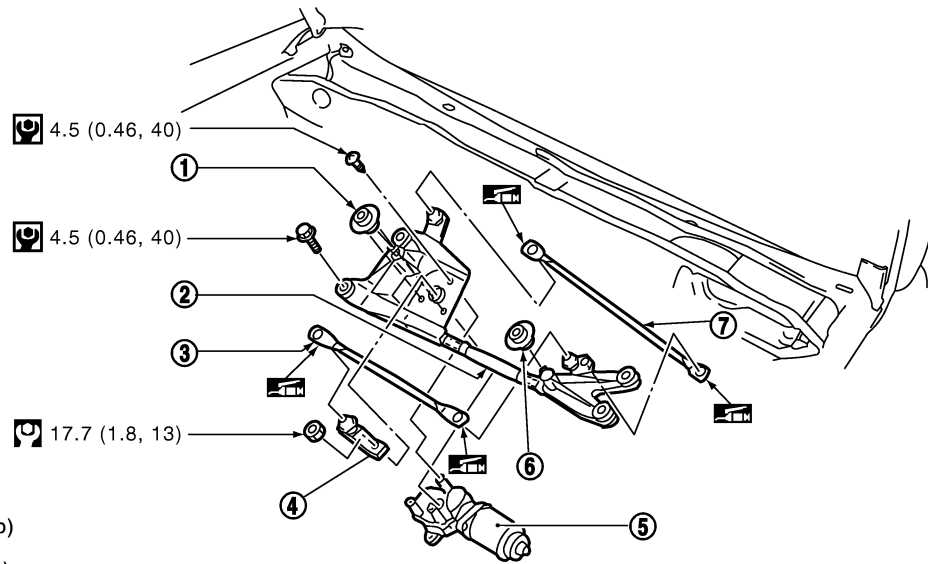

SKIB7866E

- | | | |
|---------------|----------------|---------------|
| 1. Rubber | 2. Wiper frame | 3. Wiper link |
| 4. Motor arm | 5. Wiper Motor | 6. Rubber |
| 7. Wiper link | . | . |

LHD models

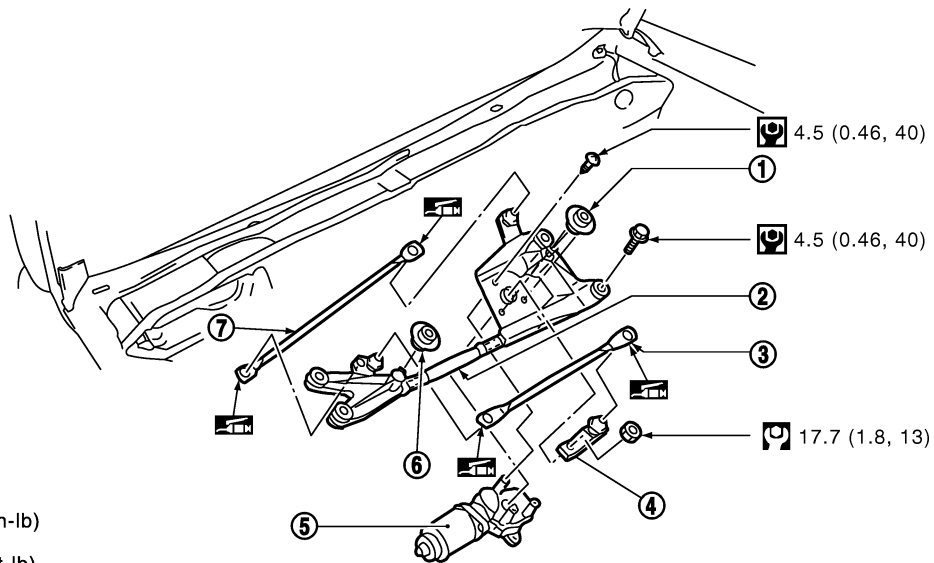

SKIB7867E

- | | | |
|---------------|----------------|---------------|
| 1. Rubber | 2. Wiper frame | 3. Wiper link |
| 4. Motor arm | 5. Wiper Motor | 6. Rubber |
| 7. Wiper link | . | . |

REMOVAL

1. Remove front wiper arms Refer to [WW-9, "REMOVAL"](#).
2. Remove cowl top cover. Refer to [EI-20, "COWL TOP"](#).

FRONT WIPER AND WASHER SYSTEM

3. Remove 4 screws and remove front wiper drive assembly from the vehicle.
4. Disconnect front wiper motor connector.
5. Remove wiper link from wiper frame.
6. Remove motor arm from wiper motor.

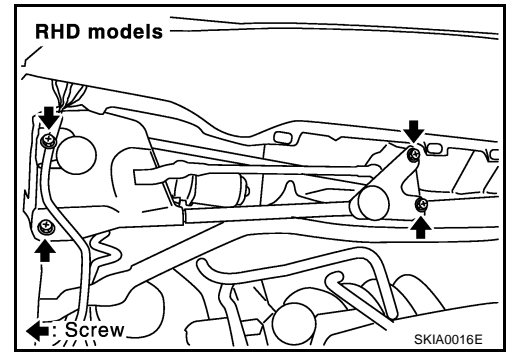

7. Remove front wiper motor from wiper frame.

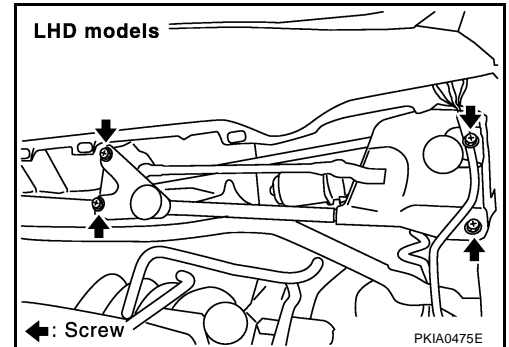

INSTALLATION

1. Connect front wiper motor connector. Turn front wiper switch ON to operate front wiper motor, then turn front wiper switch OFF (auto stop).
2. Disconnect wiper motor connector.
3. Install front wiper motor to wiper frame.
4. Install front wiper drive assembly to the vehicle.
5. Install wiper link to wiper motor arm.
6. Connect front wiper motor connector. Turn front wiper switch ON to operate front wiper motor, then turn wiper switch OFF (auto stop).
7. Rotate motor arm to the upper limit position.
8. Install front wiper drive assembly to the vehicle.
9. Turn front wiper switch ON to operate wiper motor, then turn front wiper switch OFF (auto stop).
10. Install cowl top cover. Refer to [EI-20, "COWL TOP"](#).
11. Install wiper arms. Refer to [WW-9, "INSTALLATION"](#).

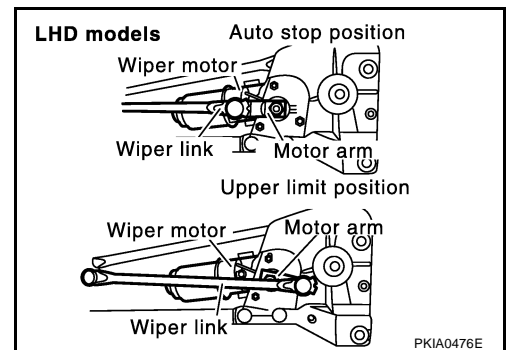
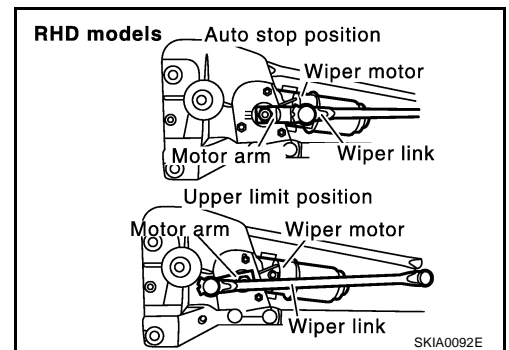

Motor arm mounting nut : 17.7 N·m (1.8 kg-m, 13 ft-lb)

Wiper motor mounting screw : 4.5 N·m (0.46 kg-m, 40 in-lb)

Front wiper drive assembly mounting bolt : 7.7 N·m (0.79 kg-m, 68 in-lb)

CAUTION:

- Never drop the wiper motor or cause it to contact other parts.
- Check the grease conditions of the motor arm and wiper link joint (at retainer). Apply grease if necessary.

FRONT WIPER AND WASHER SYSTEM

Front Washer Nozzle Adjustment

BKS000LZ

Adjust front washer nozzle with suitable tool as shown in the figure.

Adjustable range : $\pm 10^\circ$ (In any direction)

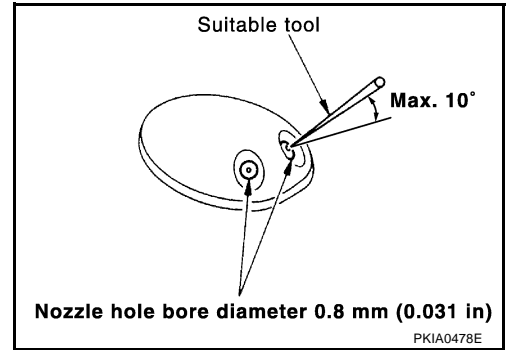

Unit: mm (in)

*1	395 (15.55)	*5	100 (3.94)
*2	395 (15.55)	*6	100 (3.94)
*3	395 (15.55)	*7	400 (15.88)
*4	395 (15.55)	*8	400 (15.88)

NOTE:

*: The diameters of these circles are less than 80 mm (3.15 in).

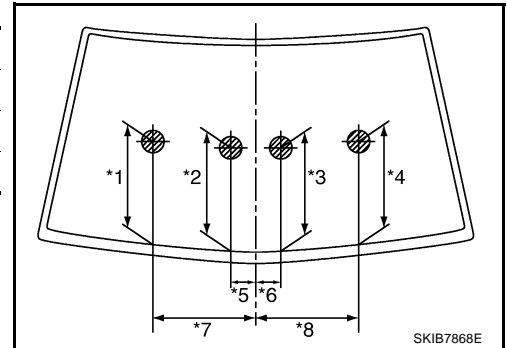

Washer Tube Layout

BKS000M0

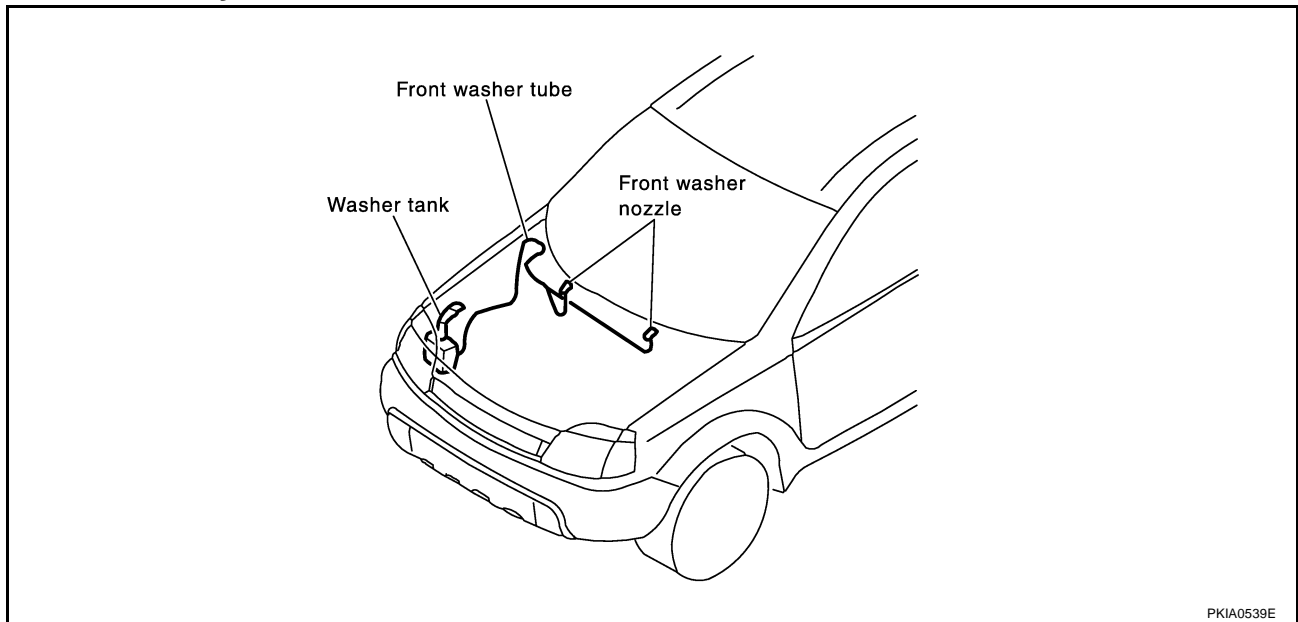

FRONT WIPER AND WASHER SYSTEM

Removal and Installation of Front Washer Nozzle

BKS000M1

REMOVAL

Push front washer nozzle pawl toward engine hood to pull out.

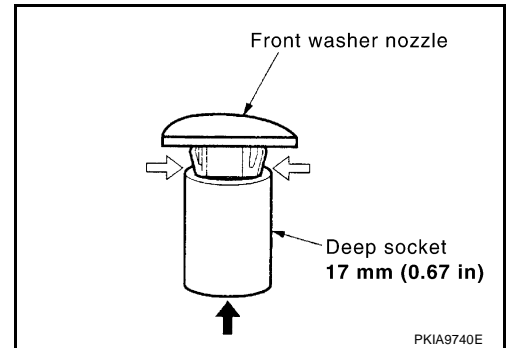

INSTALLATION

1. After connecting washer hose, press nozzle from cowl top cover surface.
2. Assemble nozzle and socket.
3. Adjust nozzle injection position.

Inspection for Front Washer Nozzle

CHECK VALVE

BKS000M2

Blow air in the injection direction, and check that air flows only one way. Make sure that the reverse direction (inhale) is not possible.

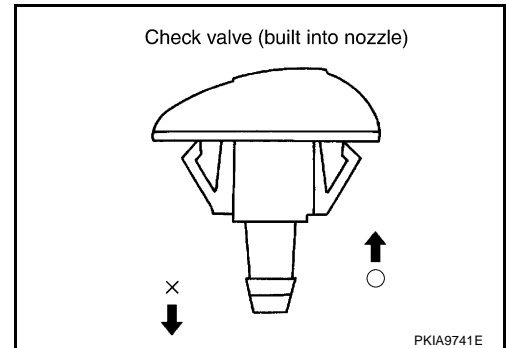

Removal and Installation of Wiper and Washer Switch

BKS000M3

REMOVAL

1. Remove steering column cover. Refer to [IP-10, "INSTRUMENT PANEL ASSEMBLY"](#).
2. Remove wiper and washer switch connector.
3. Remove two screws then remove wiper and washer switch from spiral cable.

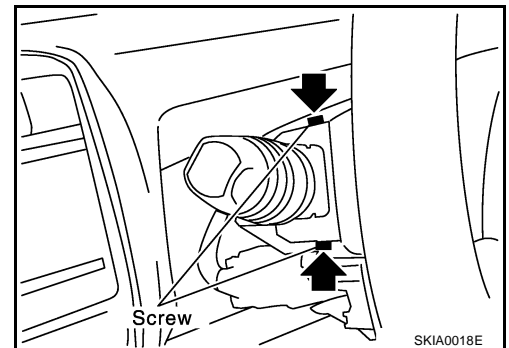

INSTALLATION

Installation is the reverse order of removal.

FRONT WIPER AND WASHER SYSTEM

Removal and Installation of Washer Tank

BKS000M4

REMOVAL

1. Remove washer tank inlet mounting screw and pull out washer tank inlet.
2. Remove fender protector. Refer to [EI-21, "FENDER PROTECTOR"](#).
3. Remove washer pump connector.
4. Remove washer tank mounting screw and pawl.

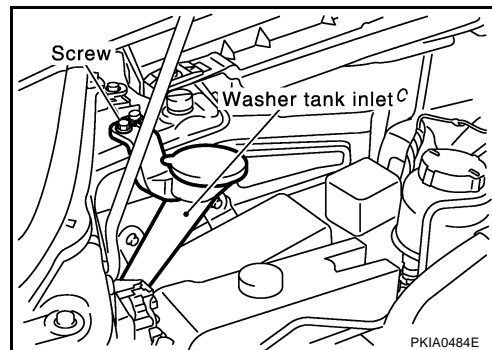

5. Remove washer hose, and remove washer tank from the vehicle.

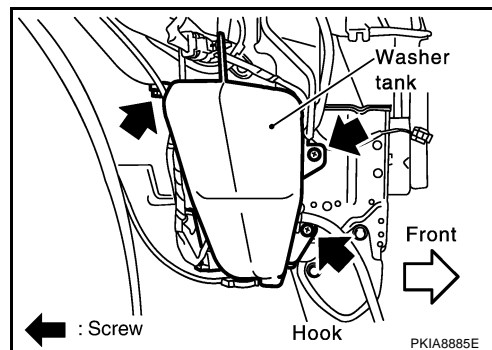

INSTALLATION

Installation is the reverse order of removal.

CAUTION:

After installation, add water up to the upper level of the washer tank inlet, and check for water leaks.

Washer tank mounting screw  : 4.5 N·m (0.46 kg-m, 40 in-lb)

Removal and Installation of Washer Pump

BKS000M5

REMOVAL

1. Remove fender protector. Refer to [EI-21, "FENDER PROTECTOR"](#).
2. Remove washer pump connector and hose.
3. Pull out washer pump in the direction of the arrow (←) in the figure, and remove washer pump from washer tank.

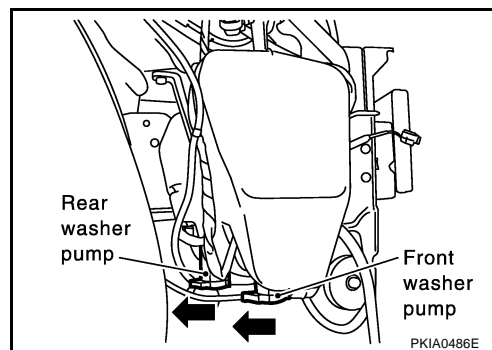

INSTALLATION

Installation is the reverse order of removal.

CAUTION:

When installing washer pump, there should be no packing twists, etc.

REAR WIPER AND WASHER SYSTEM

REAR WIPER AND WASHER SYSTEM

PFP:28710

Wiring Diagram — WIP/R —

BKS000M6

WW-WIP/R-01

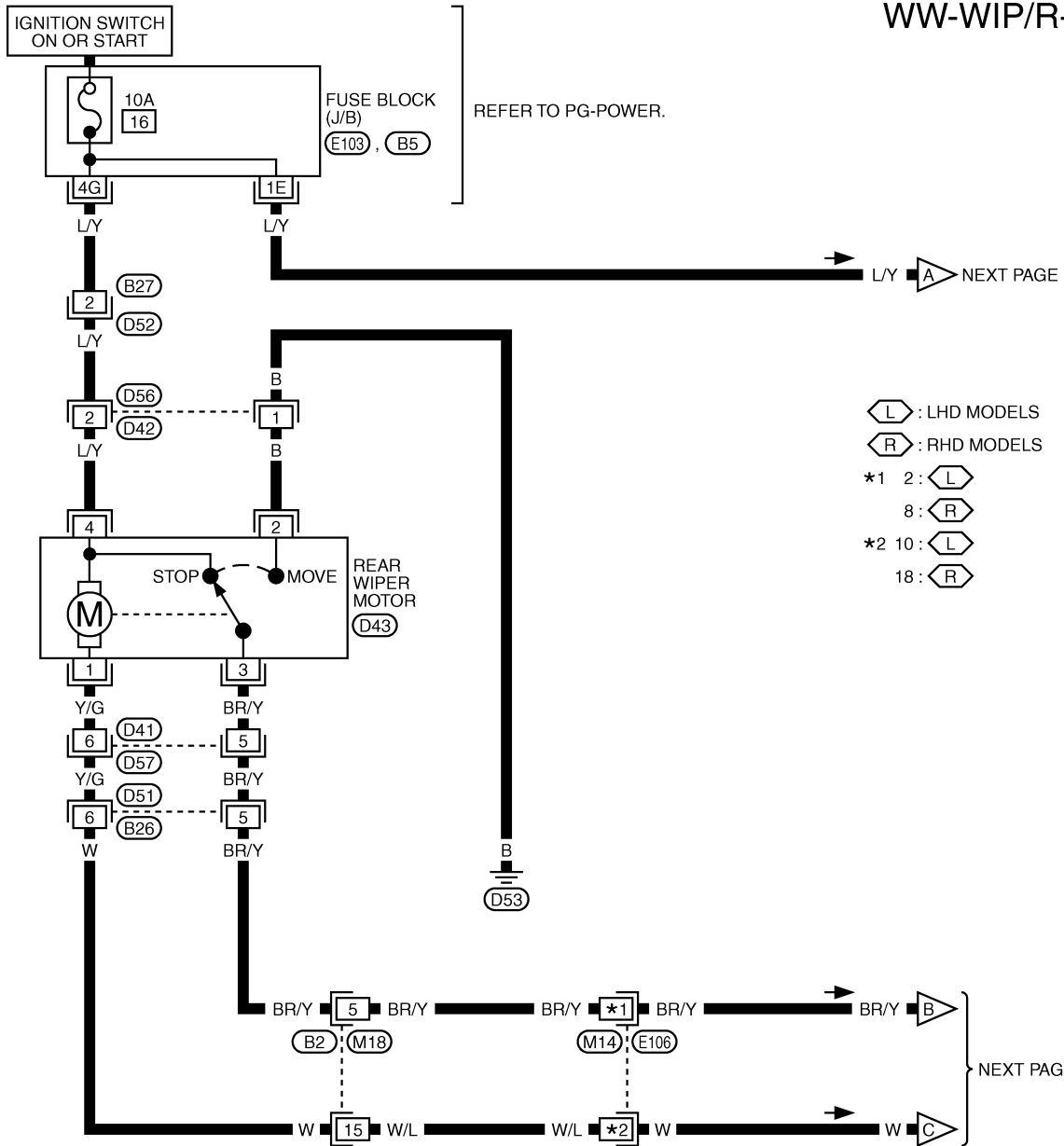

1	2	3	4	5	6	7
8	9	10	11	12	13	14
15	16					

E106 : L
BR

1	2	3	4	5	6	7	8	9
10	11	12	13	14	15	16	17	18
19	20							

E106 : R
W B2
BR

1	2	3	4
---	---	---	---

D43
W

1	2	3	4	5	6
---	---	---	---	---	---

D51, D57
W W

1	2	3
---	---	---

D52
W

1	2
---	---

D56
B

REFER TO THE FOLLOWING.
E103, B5 - FUSE BLOCK-
JUNCTION BOX (J/B)

REAR WIPER AND WASHER SYSTEM

WW-WIP/R-02

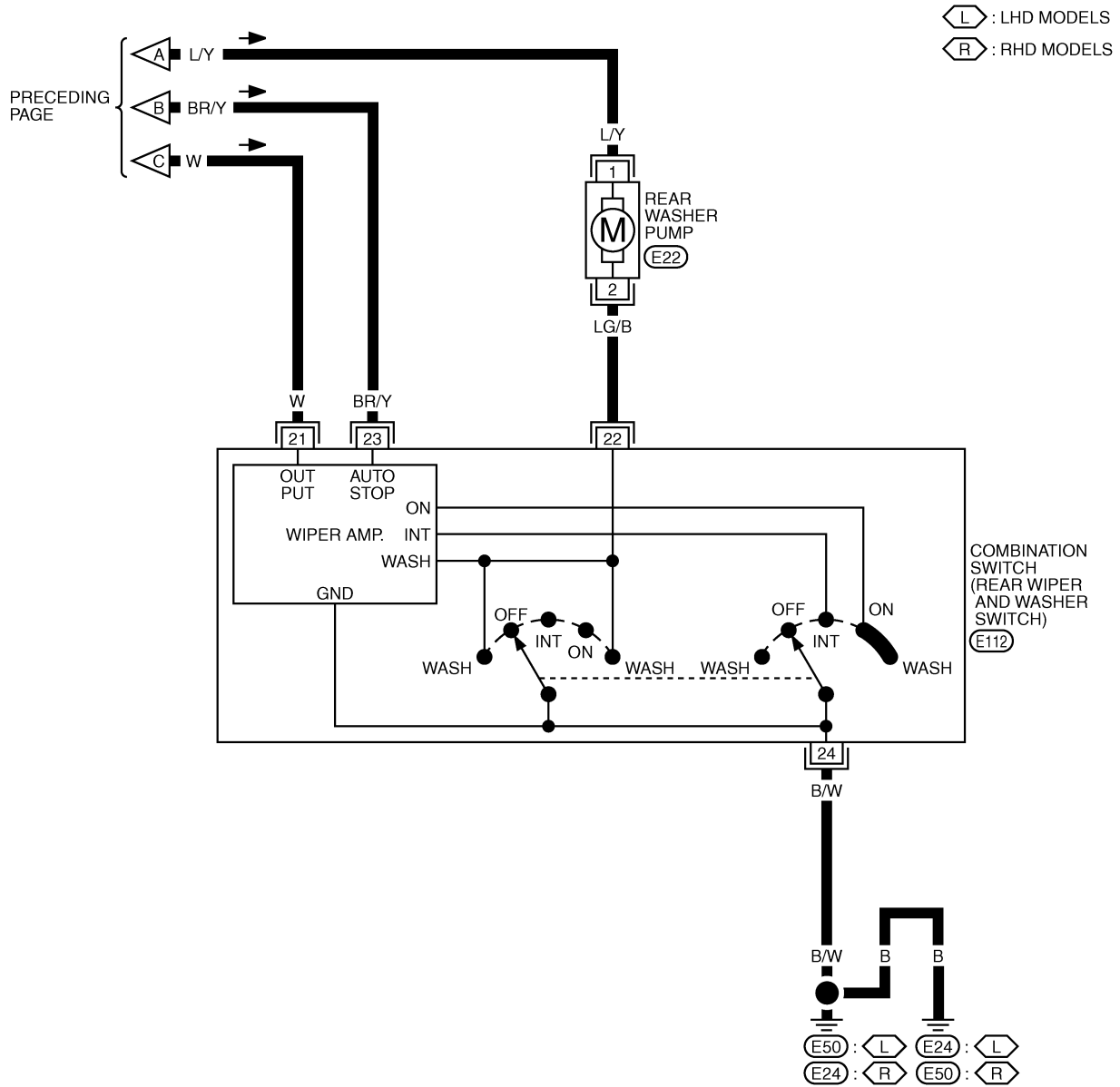

1	E22
2	G

14	21	18
23	24	16
17	13	15
22		

E112 GY

TKWB2769E

REAR WIPER AND WASHER SYSTEM

Terminal and Reference Values for Combination Switch

BKS000M7

Terminal No.	Wire color	Signal name	Measuring condition			Reference value
			Ignition switch	Condition or operation		
21	W	Rear wiper motor operation signal (ON)	ON	Wiper switch	OFF	Battery voltage
					ON	Approx. 0 V
22	LG/B	Rear washer switch signal	ON	Wiper switch	WASH	Approx. 0 V
					OFF	Battery voltage
23	BR/Y	Rear wiper auto stop signal	ON	Wiper operating		Approx. 0 V
				Wiper stopped		Battery Voltage
24	B/W	Ground	OFF	—		—

Removal and Installation of Rear Wiper Arms, Adjustment of Wiper Arms Stop Location

BKS000M8

REMOVAL

1. Turn rear wiper switch ON to operate rear wiper motor, and then turn rear wiper switch OFF (auto stop).
2. Remove nut cover, and remove rear wiper arm nut.
3. Raise rear wiper arm, and remove rear wiper arm from the vehicle.

INSTALLATION

1. Clean up the pivot area as shown in the figure. This will reduce possibility of rear wiper arm nut looseness.
2. Prior to rear wiper arm installation, turn rear wiper switch ON to operate rear wiper motor, and then turn rear wiper switch OFF (auto stop).

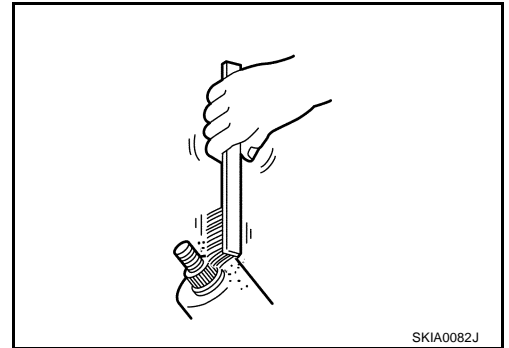

3. Lift the blade up and then set it down onto glass surface. Set the black center to clearance "L" immediately before tightening the nut.

Clearance "L" : 55.6 - 70.6 mm (2.189 - 2.780 in)

4. Tighten rear wiper arm nut to specified torque.

Rear wiper arm mounting nut : 15.2 N·m (1.6 kg-m, 11 ft-lb)

5. Spray washer fluid. Turn rear wiper switch ON to operate wiper motor, and then turn rear wiper switch OFF (auto stop).
6. Make sure that wiper blade stop within clearance "L".
7. Install nut cover.

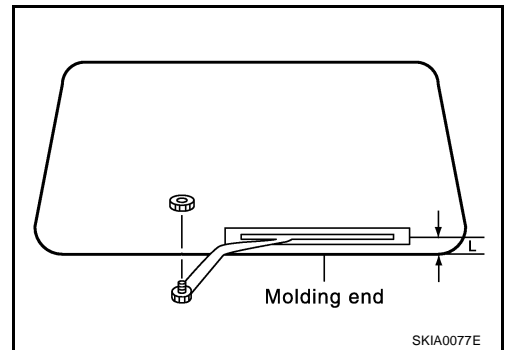

REAR WIPER AND WASHER SYSTEM

Removal and Installation of Rear Wiper Motor

BKS000M9

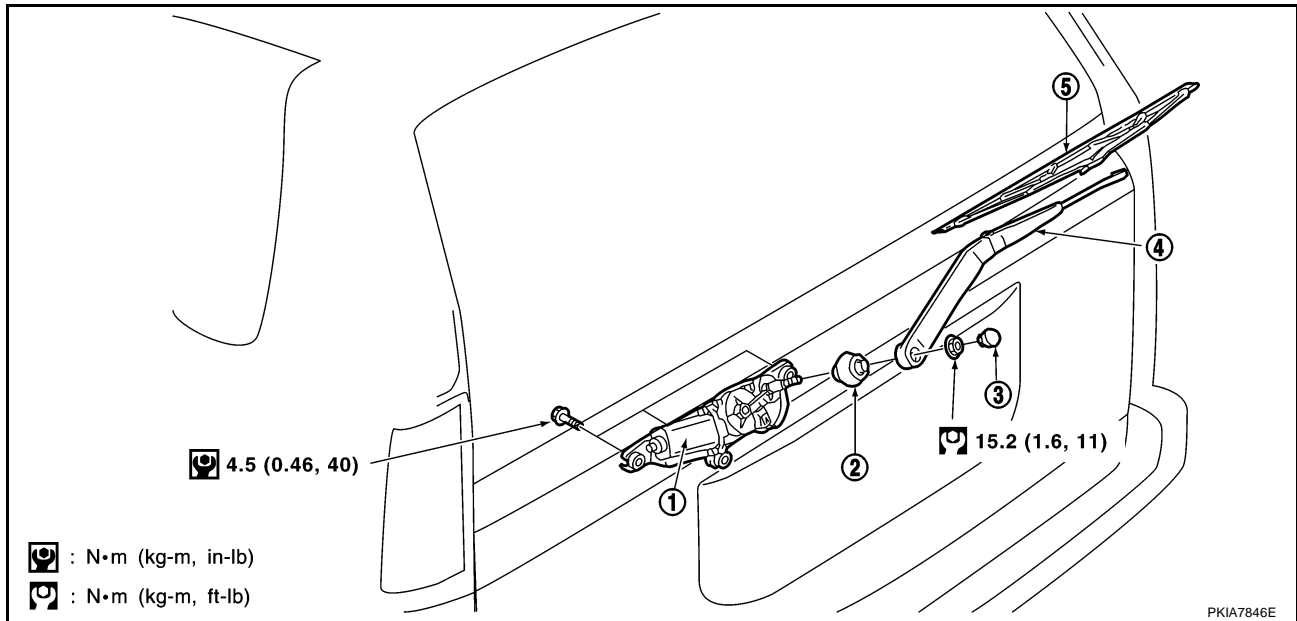

REMOVAL

1. Remove rear wiper arm. Refer to [WW-17, "REMOVAL"](#).
2. Remove back door finisher. Refer to [EI-34, "BACK DOOR TRIM"](#).
3. Disconnect rear wiper motor connector.
4. Remove rear wiper motor mounting bolts and remove rear wiper motor.
5. Remove rubber to the vehicle.

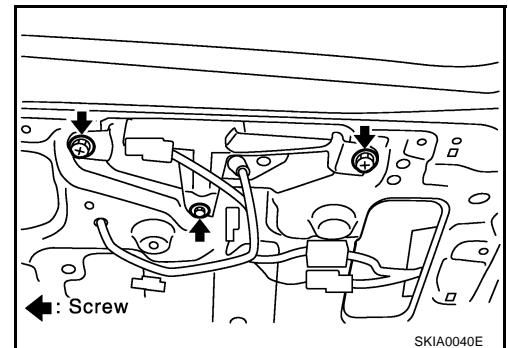

INSTALLATION

1. Install rubber to the vehicle.
2. Install rear wiper motor to the vehicle.
3. Connector rear wiper motor connector. Turn rear wiper switch ON to operate rear wiper motor, then turn rear wiper switch OFF (auto stop).
4. Install rear wiper arm to the vehicle. Refer to [WW-17, "INSTALLATION"](#).
5. Install back door finisher. Refer to [EI-34, "BACK DOOR TRIM"](#).

Rear wiper motor mounting bolt ⊙ : 4.5 N·m (0.46 kg-m, 40 in-lb)

CAUTION:

- Never drop the wiper motor or cause it to contact other parts.
- Check the grease conditions of the motor arm and wiper link joint (at retainer). Apply grease if necessary.

REAR WIPER AND WASHER SYSTEM

Rear Washer Nozzle Adjustment

BKS000MA

- Adjust rear washer nozzle with suitable tool as shown in the figure at left.

Adjustable range : $\pm 10^\circ$ (In any direction)

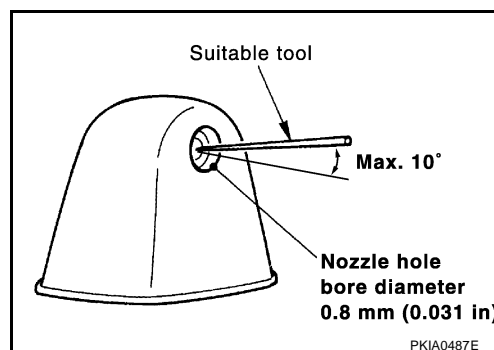

Unit: mm (in)

*H	90 (3.54)
*L	150 (5.91)

*: The diameter of this circle is less than 40 mm (1.57in).

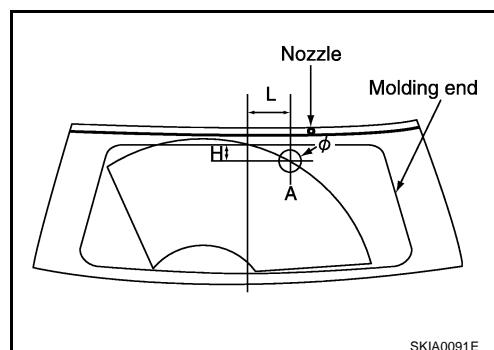

Removal and Installation of Rear Washer Nozzle

BKS000MB

- Remove washer hose from rear washer nozzle.
- Remove rear washer nozzle mounting screw and remove rear washer nozzle.

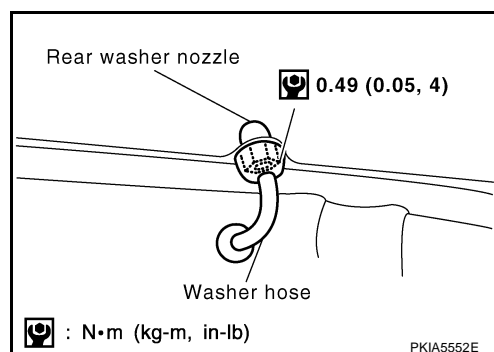

INSTALLATION

- After connecting washer hose, press nozzle from cowl top cover surface.
- Assemble nozzle and socket.
- Adjust nozzle injection position.

Inspection for Rear Washer Nozzle CHECK VALVE

BKS000MC

Blow air in the injection direction, and check that air flows only one way. Make sure that the reverse direction (inhale) is not possible.

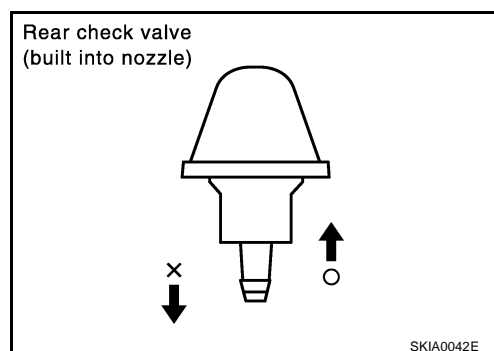

REAR WIPER AND WASHER SYSTEM

Removal and Installation of Wiper and Washer Switch

BKS000MD

Refer to [WW-13, "Removal and Installation of Wiper and Washer Switch"](#) .

Removal and Installation of Washer Tank

BKS000ME

Refer to [WW-14, "Removal and Installation of Washer Tank"](#) .

Removal and Installation of Washer Pump

BKS000MF

Refer to [WW-14, "Removal and Installation of Washer Pump"](#) .

Washer Tube Layout

BKS000MG

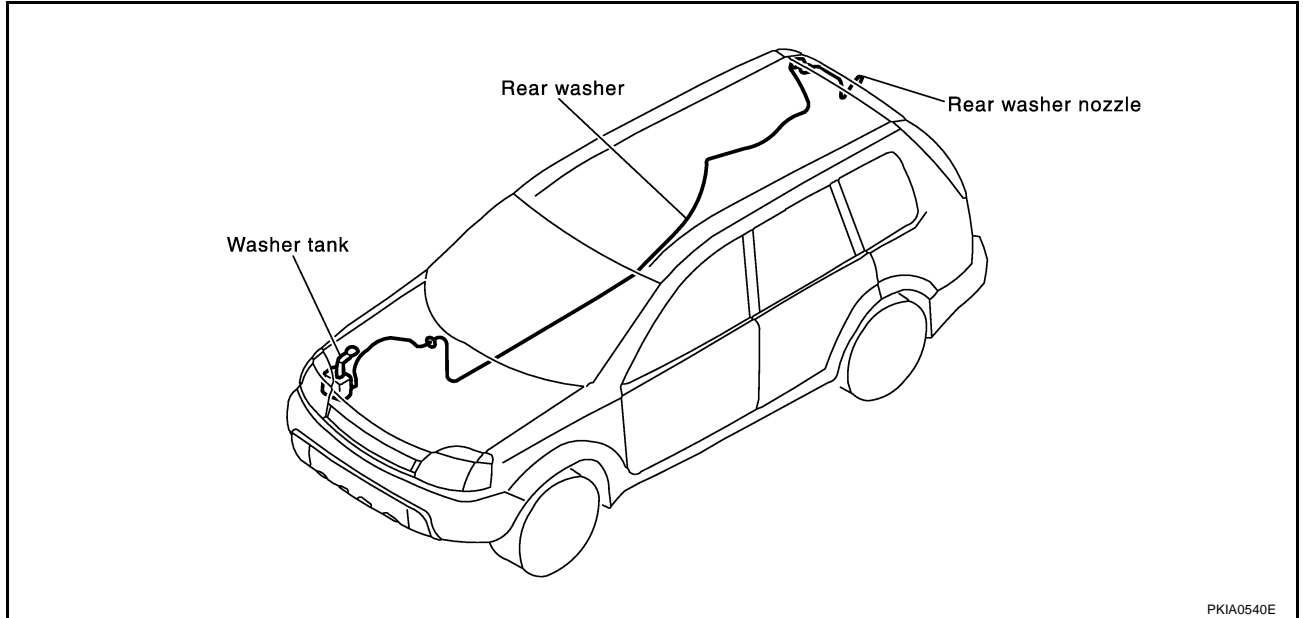

PKIA0540E

HEADLAMP WASHER

PFP:28620

System Description

BKS000MH

The headlamp washer is controlled by the headlamp washer timer. With power and ground supplied, the headlamp washer pump operates.

Power is supplied at all times

- through 30A fusible link (letter E, located in fuse and fusible link box)
- to headlamp washer pump terminal 1,
- through 10A fuse (No. 31, located in fuse and fusible link box)
- to lighting switch terminal 11.

With the ignition switch in the ON or START position, power is supplied (with xenon headlamp)

- through 10A fuse [No. 11, located in fuse block (J/B)]
- to headlamp washer timer terminal 4.

With the ignition switch in the ON or START position, power is supplied (without xenon headlamp)

- through 10A fuse [No. 13, located in fuse block (J/B)]
- to headlamp washer timer terminal 4.

Ground is supplied

- to headlamp washer timer terminal 5
- through grounds E24 and E50.

When headlamp washer switch is pushed during lighting switch is in 1ST or 2ND position, ground is supplied (with xenon headlamp)

- to headlamp washer pump terminal 2
- through headlamp washer timer terminal 2,
- to headlamp washer timer terminal 6
- through front wiper and washer switch terminal 18
- through front wiper and washer switch terminal 17
- through grounds M24 and M50.

When headlamp washer switch is pushed during lighting switch is in 1ST or 2ND position, ground is supplied (without xenon headlamp)

- to headlamp washer pump terminal 2
- through headlamp washer timer terminal 2,
- to headlamp washer timer terminal 6
- through headlamp washer switch terminal 2
- through headlamp washer switch terminal 1
- through grounds M27 and M70.

With power and ground supplied, the headlamp washer pump operates.

A

B

C

D

E

F

G

H

I

J

WW

L

M

HEADLAMP WASHER

Wiring Diagram —HLC— LHD MODELS

BKS000MI

WW-HLC-01

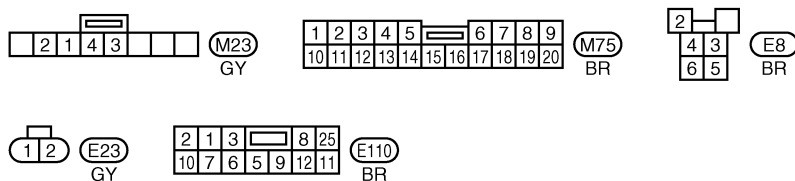
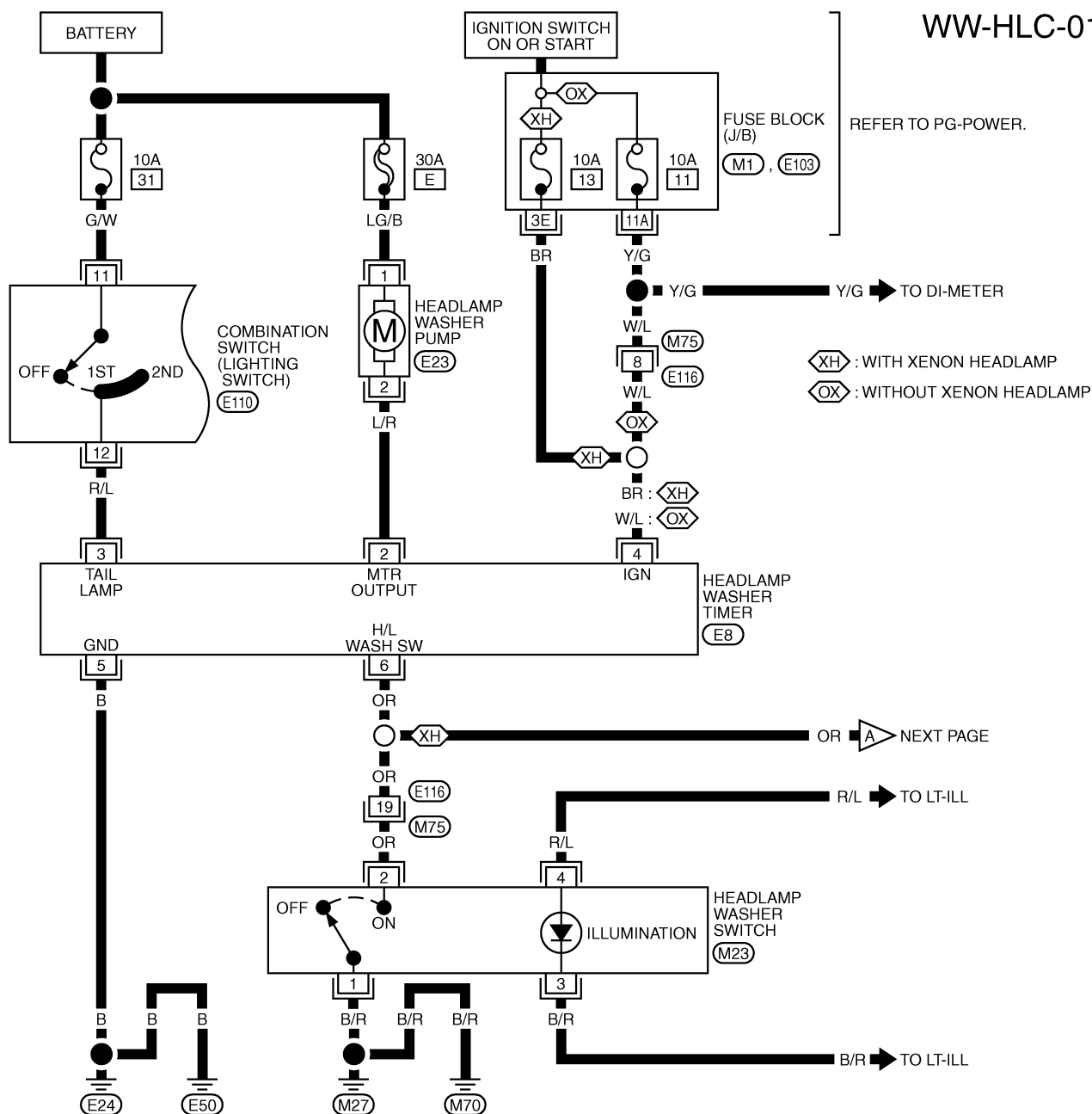

REFER TO THE FOLLOWING.
 (M1), (E103) - FUSE BLOCK-
 JUNCTION BOX (J/B)

HEADLAMP WASHER

WW-HLC-02

XH : WITH XENON HEADLAMP

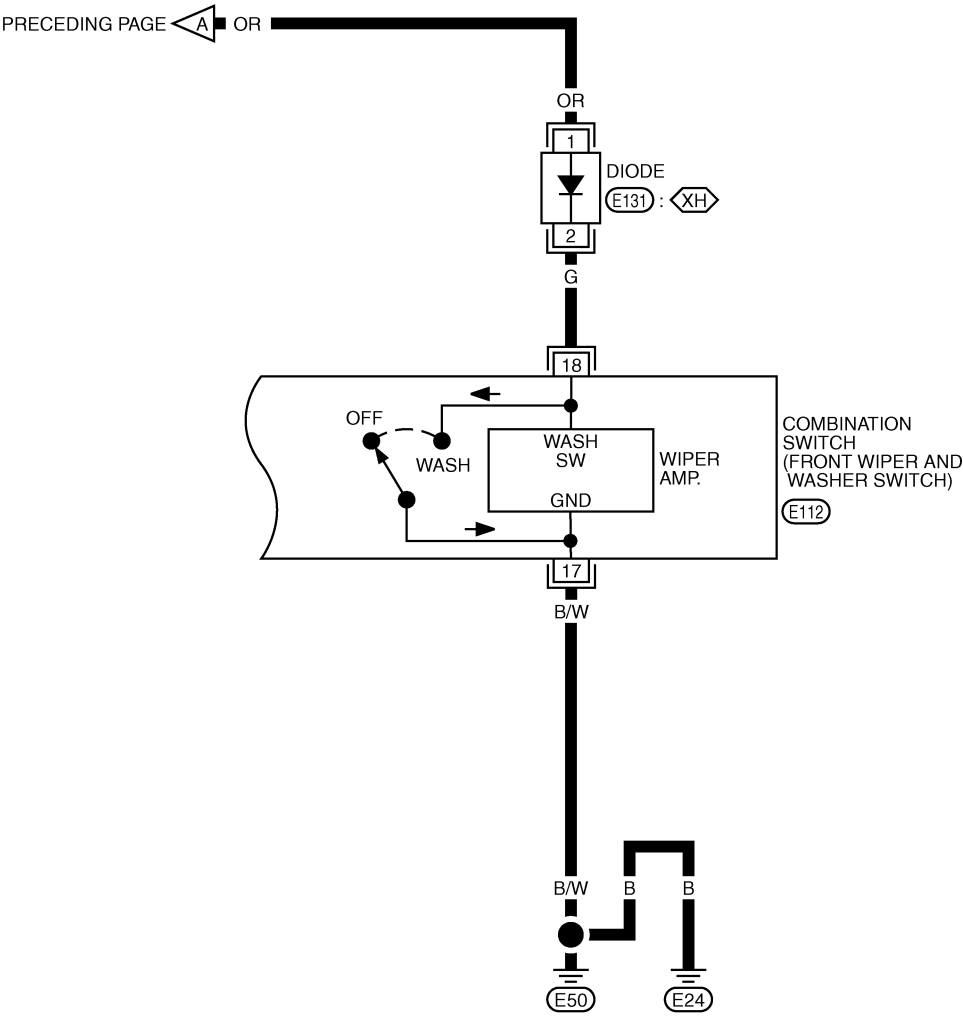

	14	21		18
23	24	16	17	13
15	22			

E112
GY

1 2 E131
W

WW

HEADLAMP WASHER

RHD MODELS

WW-HLC-03

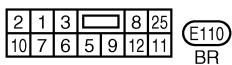
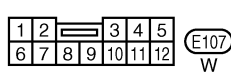
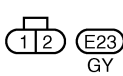
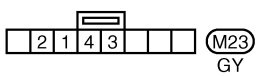
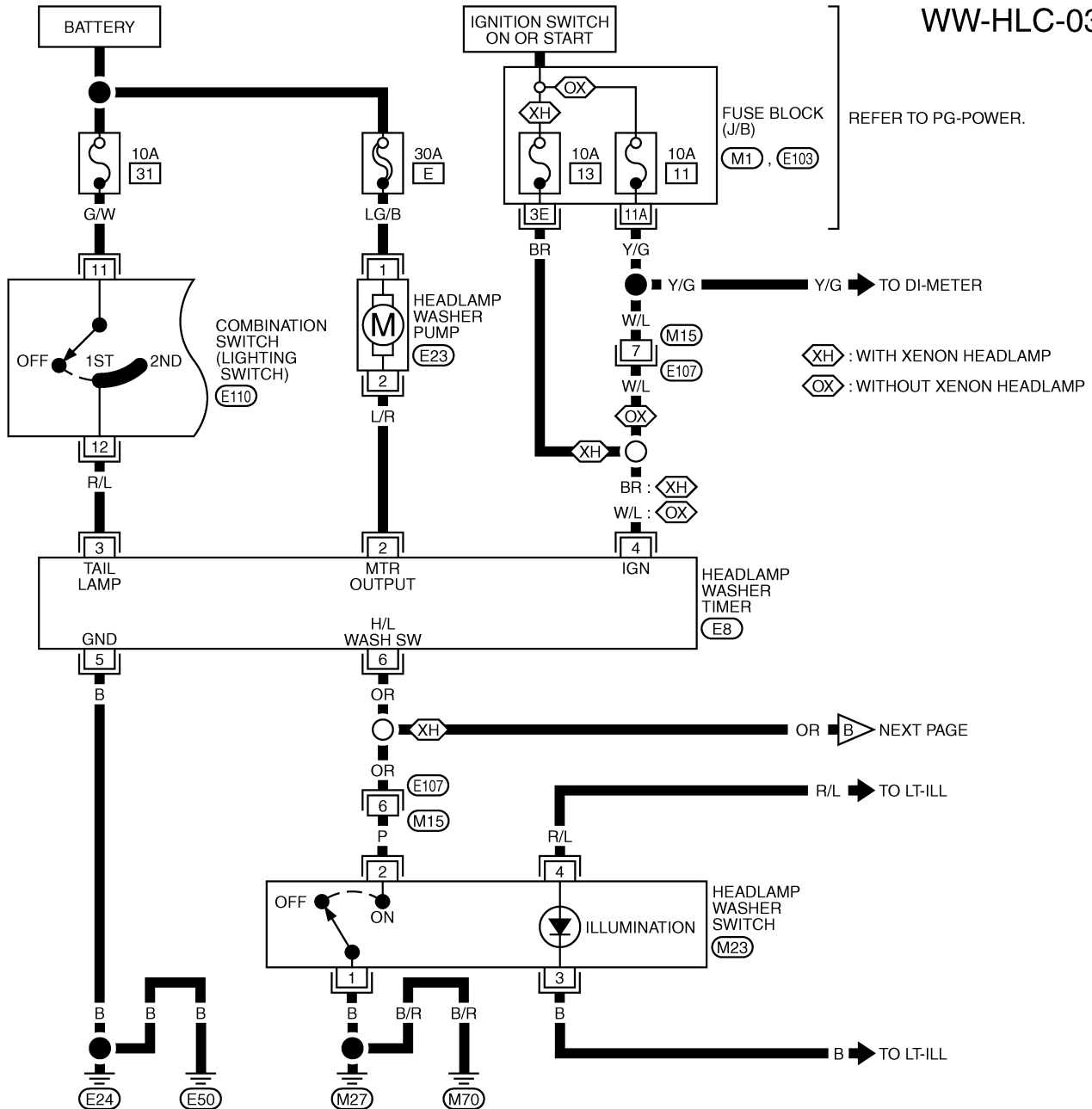

REFER TO THE FOLLOWING.
 (M1) (E103) - FUSE BLOCK-
 JUNCTION BOX (J/B)

HEADLAMP WASHER

WW-HLC-04

 : WITH XENON HEADLAMP

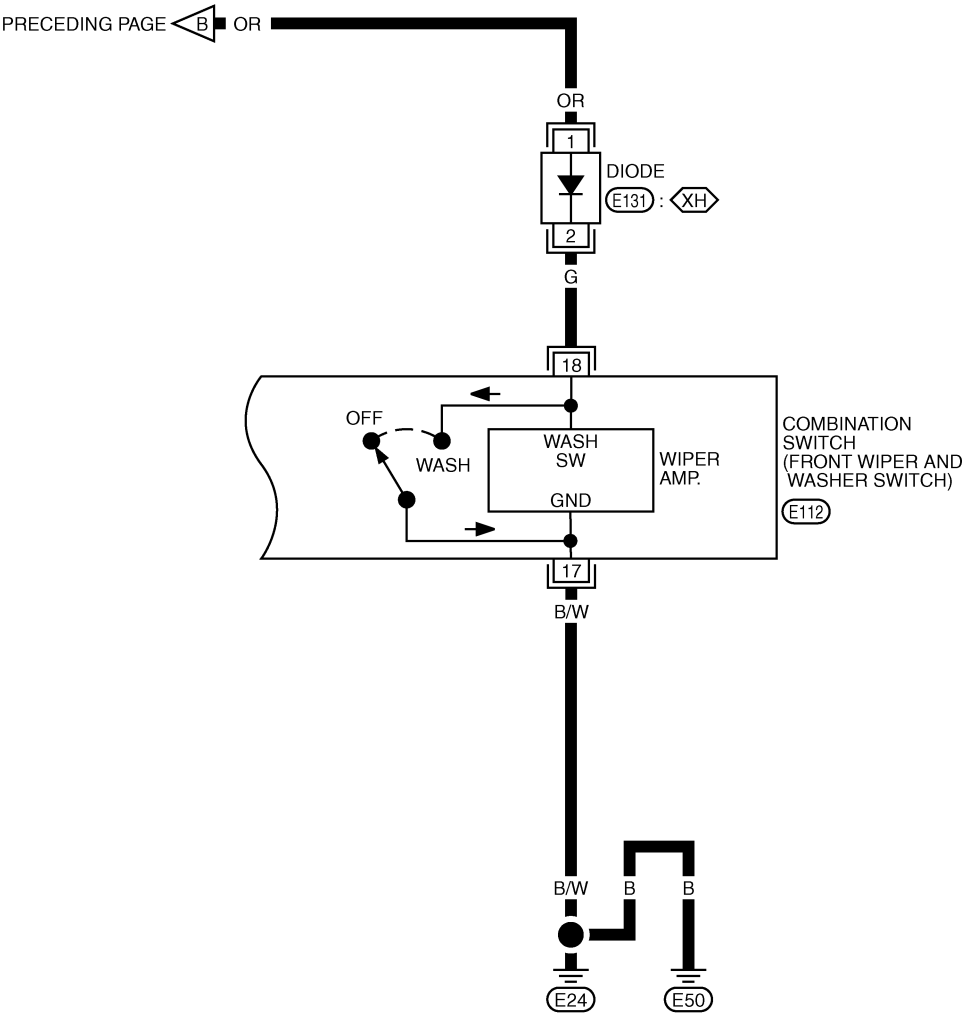

	14	21			18
23	24	16	17	13	15

E112
GY

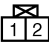
	1	2	E131
			W

HEADLAMP WASHER

Removal and Installation of Headlamp Washer Nozzle

BKS000MK

REMOVAL

1. Remove front bumper. Refer to [EI-14, "FRONT BUMPER"](#)
2. Remove hose clip and metal clip.
3. Remove headlamp washer nozzle from front bumper.

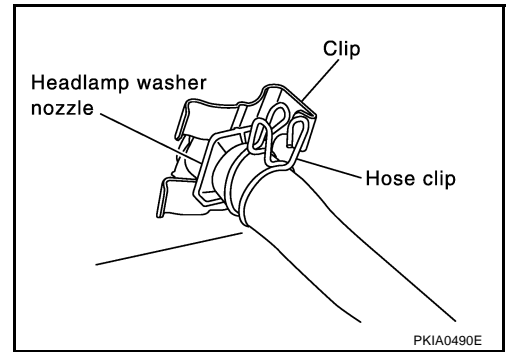

INSTALLATION

Installation is in the reverse order of removal.

Inspection for Headlamp Washer Nozzle

BKS000ML

CHECK VALVE

Blow air in the injection direction, and check that air flows only one way. Make sure that the reverse direction is not possible.

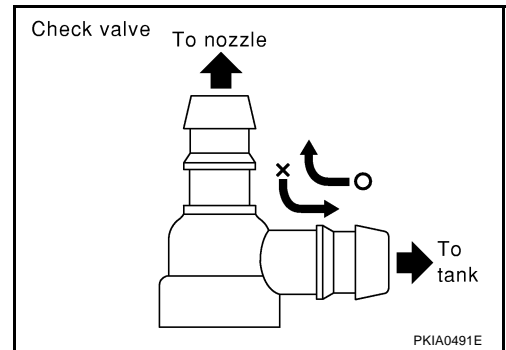

Removal and Installation of Washer Tank

BKS000MM

Refer to [WW-14, "Removal and Installation of Washer Tank"](#).

Removal and Installation of Headlamp Washer Pump

BKS000MN

1. Remove front bumper. Refer to [EI-14, "FRONT BUMPER"](#)
2. Remove washer pump connector and hose.
3. Pull out washer pump in the direction of the arrow in the figure, and remove the washer pump from the washer tank.

CAUTION:

When installing washer pump, there should be no packing twist, etc.

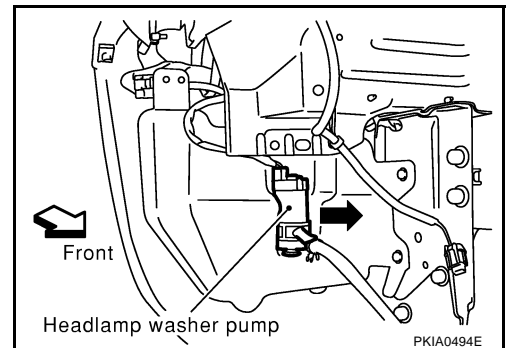

HEADLAMP WASHER

Washer Tube Layout

BKS000MO

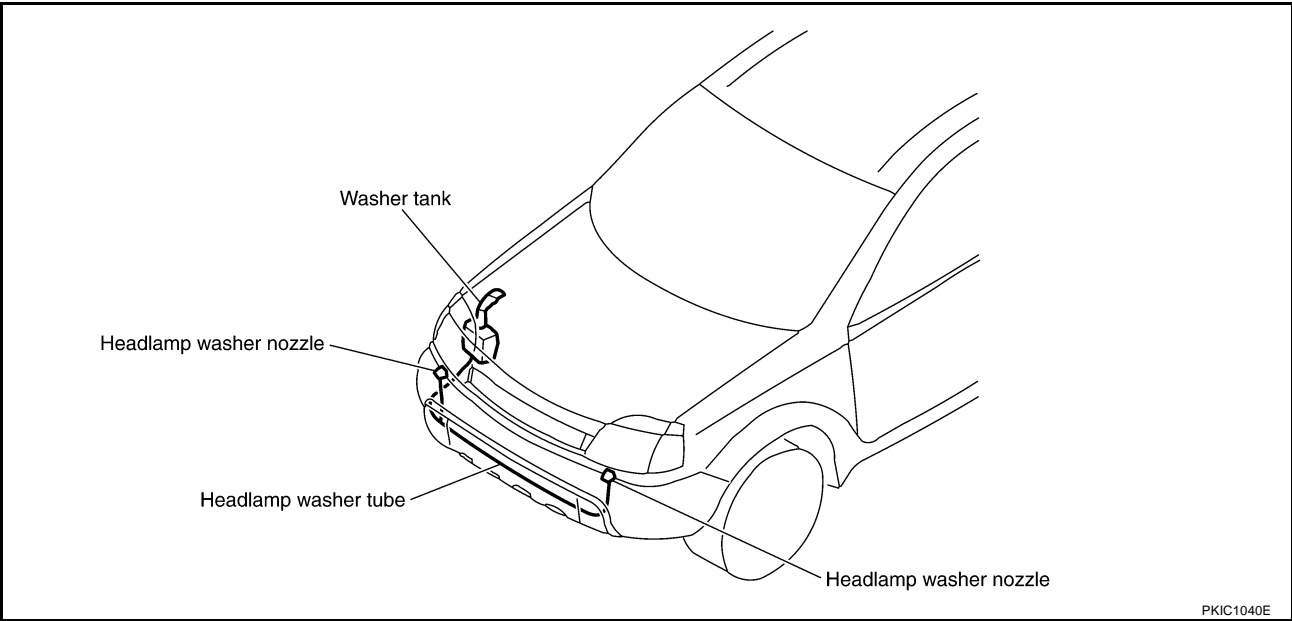

A

B

C

D

E

F

G

H

I

J

WW

L

M

HORN

HORN

PFP:25610

Wiring Diagram — HORN —

BKS000MP

WW-HORN-01

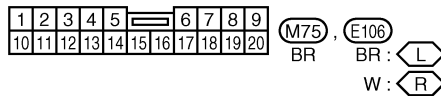
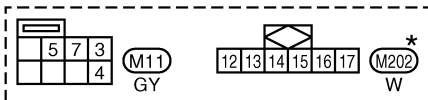
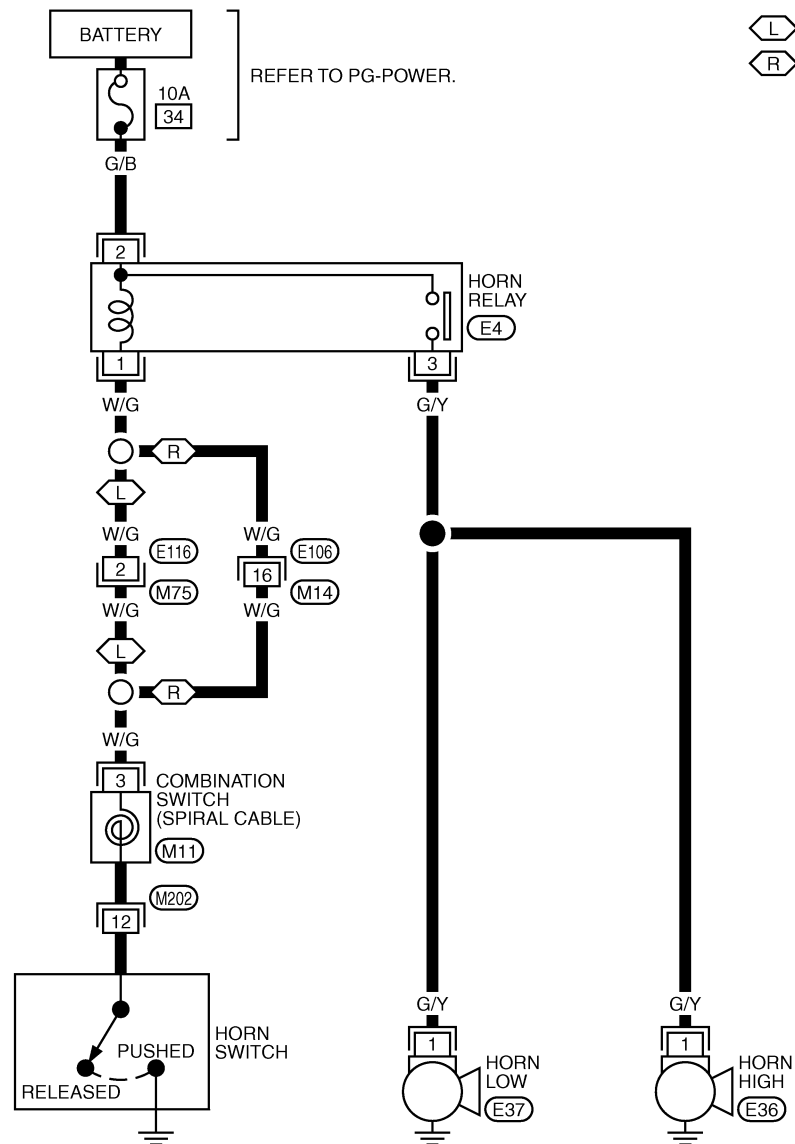

★: THIS CONNECTOR IS NOT SHOWN IN "HARNESS LAYOUT", PG SECTION.

HORN

Removal and Installation

REMOVAL

1. Remove the front grille. Refer to [EI-19, "FRONT GRILLE"](#)
2. Disconnect horn connector.
3. Remove horn.

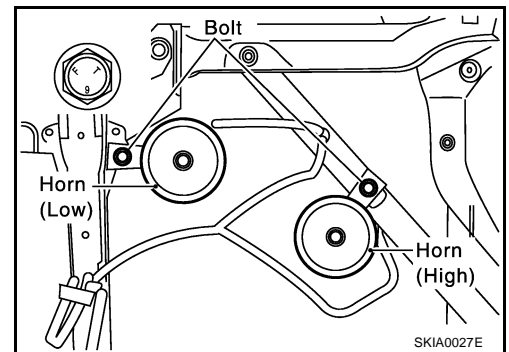

INSTALLATION

Installation is the reverse order of removal.

Horn mounting bolt  : 17 N-m (1.7 kg-m, 13 ft-lb)

A

B

C

D

E

F

G

H

I

J

WW

L

M

CIGARETTE LIGHTER

CIGARETTE LIGHTER

PFP:35330

Wiring Diagram — CIGAR —

BKS000MR

WW-CIGAR-01

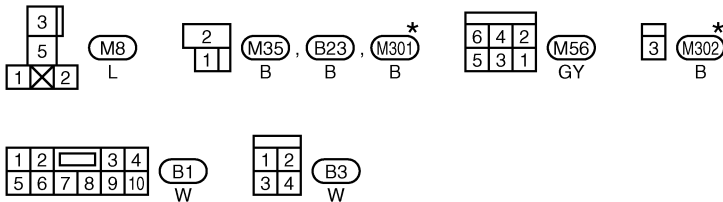
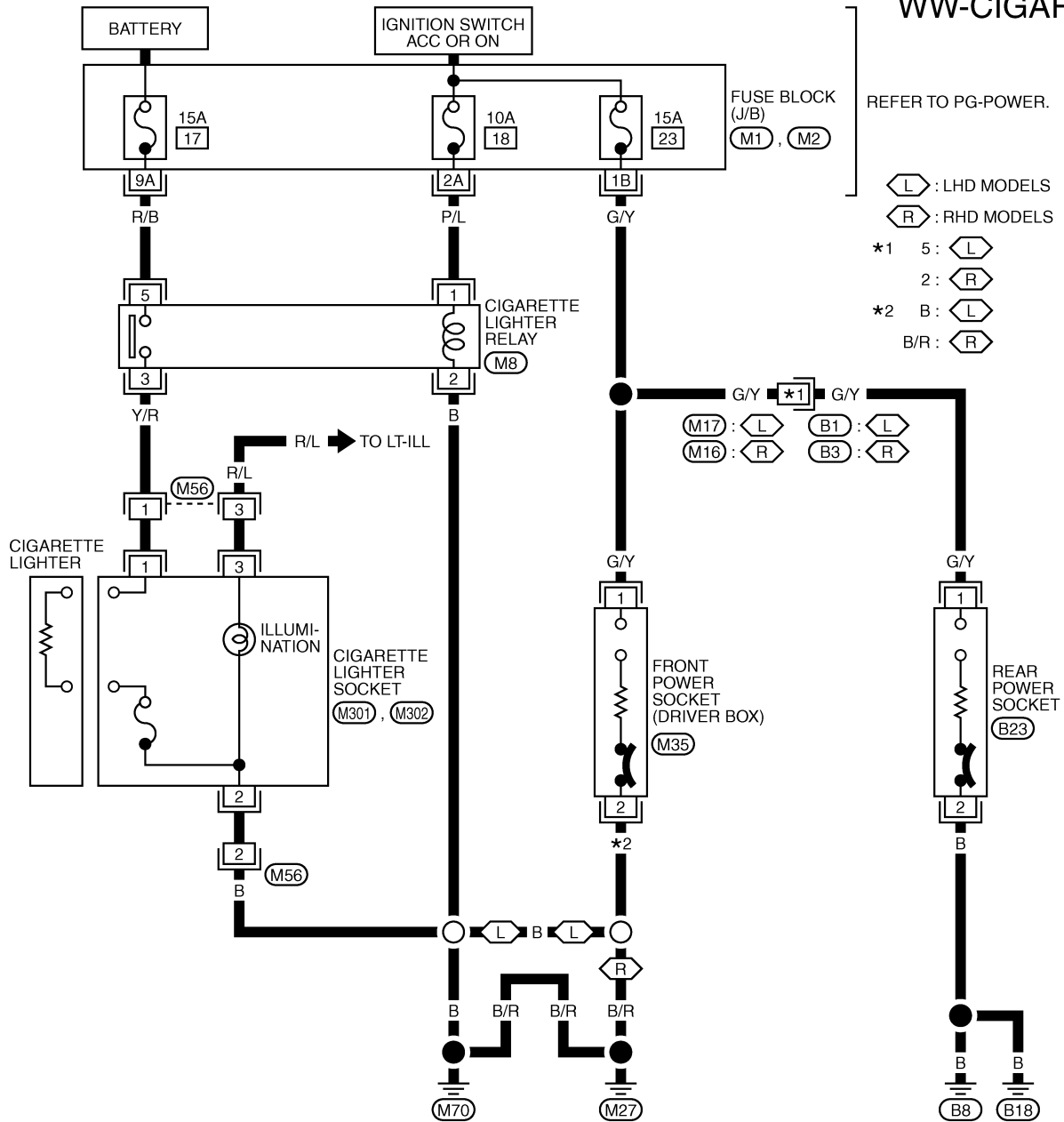

*: THIS CONNECTOR IS NOT SHOWN IN "HARNESS LAYOUT", PG SECTION.

REFER TO THE FOLLOWING.
M1, M2 - FUSE BLOCK - JUNCTION BOX (J/B)

CIGARETTE LIGHTER

Removal and Installation

REMOVAL

1. Remove instrument center lower panel, refer to [IP-10, "INSTRUMENT PANEL ASSEMBLY"](#) .
2. Disconnect cigarette lighter and illumination lamp connector.
3. Remove cigarette lighter socket from instrument center lower panel, while pressing the hook from hole.

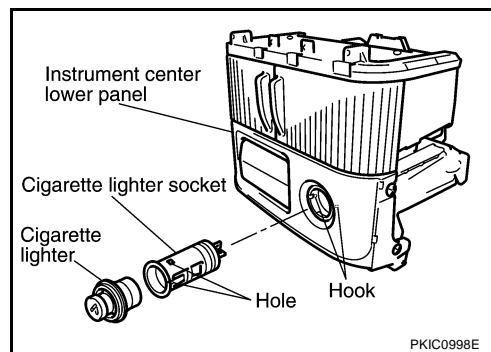

INSTALLATION

Installation is the reverse order of removal.

A
B
C
D
E
F
G
H
I
J
WW
L
M

POWER SOCKET

POWER SOCKET

PFP:253A2

Wiring Diagram —POWER SOCKET—

BKS000MT

WW-P/SCKT-01

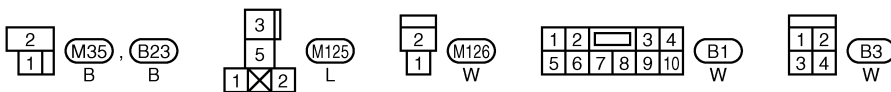
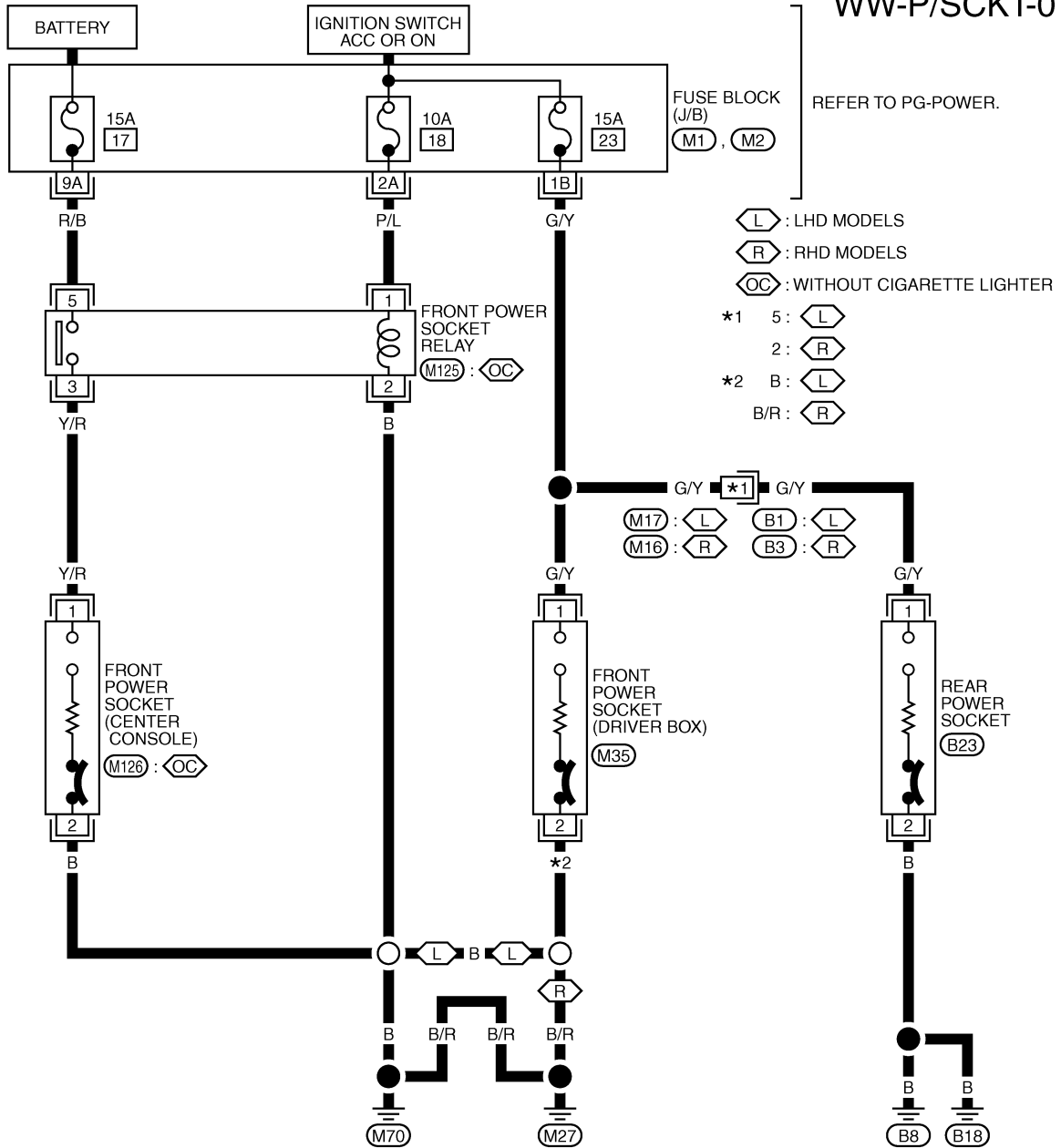

REFER TO THE FOLLOWING.
(M1), (M2) -FUSE BLOCK-
JUNCTION BOX (J/B)

POWER SOCKET

Removal and Installation of Front Power Socket (Driver Box)

BKS000MU

REMOVAL

1. Remove the driver's glove box. Refer to [IP-10, "INSTRUMENT PANEL ASSEMBLY"](#)
2. Disconnect power socket connector.
3. Remove inner socket from socket ring, while pressing the hook from hole.
4. Pull out socket ring from driver's glove box.

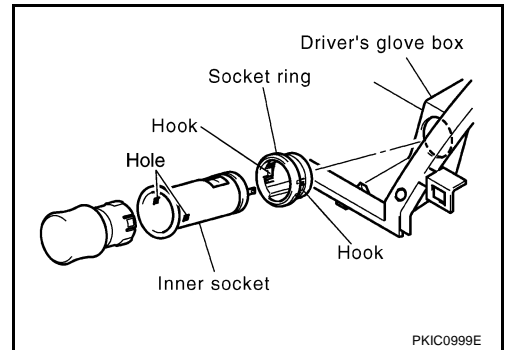

INSTALLATION

Installation is the reverse order of removal.

Removal and Installation of Front Power Socket (Center Console)

BKS000MV

REMOVAL

1. Remove the instrument center lower panel. Refer to [IP-10, "INSTRUMENT PANEL ASSEMBLY"](#).
2. Disconnect power socket connector.
3. Remove inner socket from socket ring, while pressing the hook from hole.
4. Remove socket ring from instrument center lower panel.

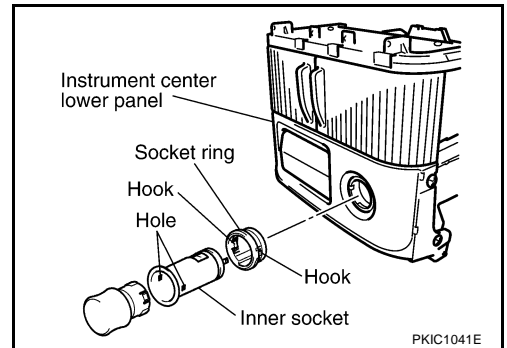

INSTALLATION

Installation is the reverse order of removal.

Removal and Installation of Rear Power Socket

BKS000MW

REMOVAL

1. Remove luggage side lower finisher, refer to [EI-36, "LUGGAGE SIDE LOWER FINISHER"](#)
2. Disconnect power socket connector.
3. Remove inner socket from socket ring, while pressing the hook from hole.
4. Remove socket ring from luggage side lower finisher, while pressing pawls.

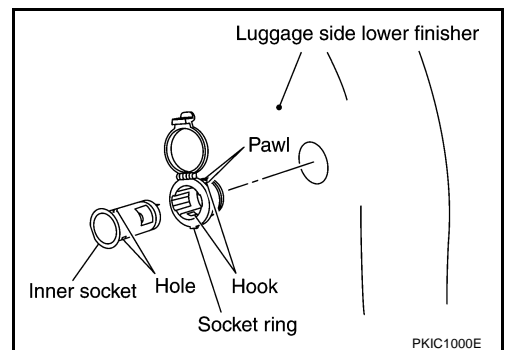

INSTALLATION

Installation is the reverse order of removal.

POWER SOCKET
