

A

EX

EX

C

SECTION

EXHAUST SYSTEM

CONTENTS

EXHAUST SYSTEM	2	SERVICE DATA AND SPECIFICATIONS (SDS)	5	F
Checking Exhaust System	2	Tightening Torque	5	
Removal and Installation	2	QR20DE AND QR25DE	5	
QR20DE AND QR25DE	2	YD22DDTI	5	G
YD22DDTI	3			
REMOVAL	3			
INSTALLATION	3			H
INSPECTION AFTER INSTALLATION	4			

EXHAUST SYSTEM

EXHAUST SYSTEM

PFP:20100

Checking Exhaust System

EBS00AZ6

Check exhaust pipes, muffler and mounting for improper attachment, leaks, cracks, damage or deterioration.

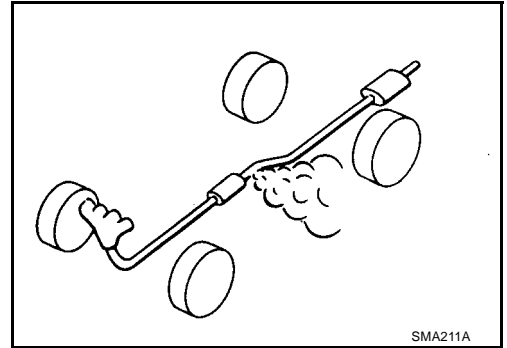

Removal and Installation

EBS003DN

CAUTION:

- Be sure to use genuine exhaust system parts or equivalents which are specially designed for heat resistance, corrosion resistance and shape.
- Perform the operation with the exhaust system fully cooled down because the system will be hot just after the engine stops.
- Be careful not to cut your hand on the insulator edge.

QR20DE AND QR25DE

SEC. 200

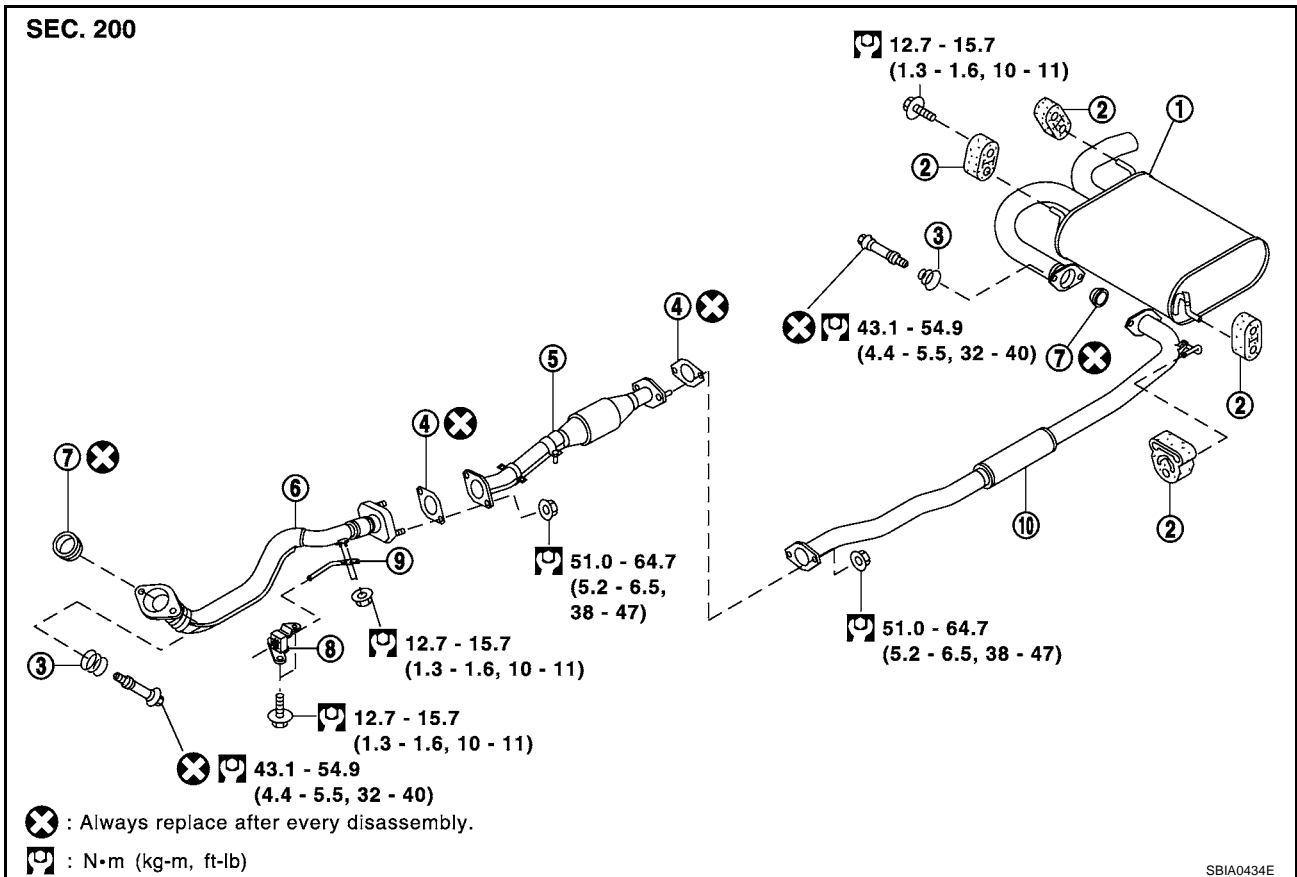

- | | | |
|-------------------------|----------------------------|-----------------------|
| 1. Main muffler | 2. Mounting rubber | 3. Spring |
| 4. Gasket | 5. Three way catalyst | 6. Exhaust front tube |
| 7. Seal bearing | 8. Mounting rubber bracket | 9. Mounting bracket |
| 10. Exhaust center tube | | |

EXHAUST SYSTEM

YD22DDTI

A

EX

C

D

E

F

G

H

I

J

K

L

M

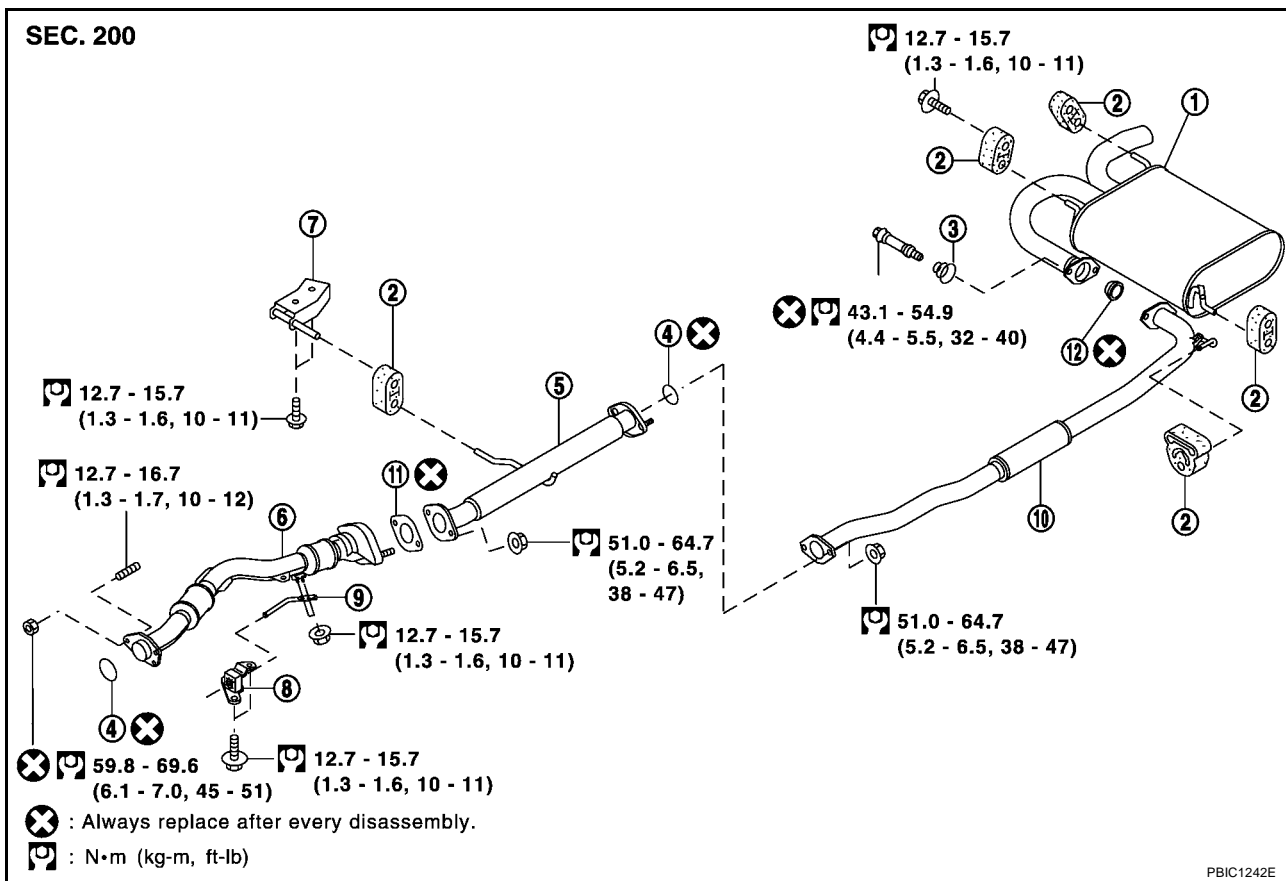

- | | | |
|----------------------------|----------------------------|-----------------------|
| 1. Main muffler | 2. Mounting rubber | 3. Spring |
| 4. Ring gasket | 5. Exhaust tube | 6. Exhaust front tube |
| 7. Exhaust bracket | 8. Mounting rubber bracket | 9. Mounting bracket |
| 10. Exhaust center muffler | 11. Gasket | 12. Seal bearing |

REMOVAL

Separate each connection as necessity.

INSTALLATION

- Install in the reverse order of removal paying attention to the following.
 - CAUTION:**
 - Always replace exhaust gaskets with new ones when reassembling.
 - If the insulator is badly deformed, repair or replace it. If deposits such as mud pile up on the insulator, remove them.
 - When installing the insulator avoid large gaps or interference between the insulator and each exhaust pipe.
 - Remove deposits from the sealing surface of each connection. Connect them securely to avoid gas leakage.
 - Temporarily tighten mounting nuts on the exhaust manifold side and mounting bolts on the vehicle side. Check each part for unusual interference, and then tighten them to the specified torque.
 - When installing each mounting rubber, avoid twisting or unusual extension in up/down and right/left directions.
- Install the seal bearings at front exhaust tube and main muffler as follows.
 - CAUTION:**
 - Do not mix the bolt and spring for seal bearing as the dimension is different for each seal bearing.

EXHAUST SYSTEM

Front Exhaust Side (QR20DE and QR25DE)

Insert the seal bearing in the direction shown in the figure.

CAUTION:

Tighten the mounting bolt without causing interference with the flange.

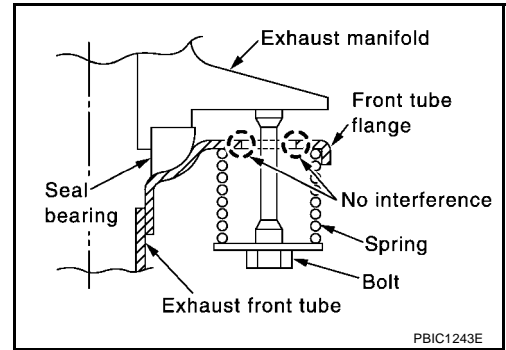

Main Muffler Side (QR20DE, QR25DE and YD22DDTi)

1. Insert the seal bearing in the direction shown in the figure.
2. Tighten the mounting bolt with the big end of the spring facing the flange.

CAUTION:

Tighten the mounting bolt without causing interference with the flange.

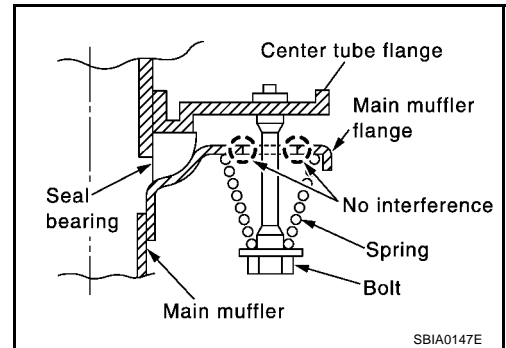

INSPECTION AFTER INSTALLATION

- With the engine running, check exhaust tube joints for gas leakage and unusual noises.
- Check to ensure that mounting brackets and mounting insulators are installed properly and free from undue stress. Improper installation could result in excessive noise and vibration.

SERVICE DATA AND SPECIFICATIONS (SDS)

SERVICE DATA AND SPECIFICATIONS (SDS)

PFP:00030

Tightening Torque QR20DE AND QR25DE

EBS00KP4

Unit: N·m (kg-m, ft-lb)

Exhaust system connections		
Exhaust manifold to exhaust front tube		43.1 - 54.9 (4.4 - 5.5, 32 - 40)
Exhaust front tube to three way catalyst		51.0 - 64.7 (5.2 - 6.5, 38 - 47)
Three way catalyst to exhaust center tube		51.0 - 64.7 (5.2 - 6.5, 38 - 47)
Exhaust center tube to main muffler		43.1 - 54.9 (4.4 - 5.5, 32 - 40)
Mounting bolts and nuts	M8	12.7 - 15.7 (1.3 - 1.6, 10 - 11)

YD22DDTI

Unit: N·m (kg-m, ft-lb)

Exhaust system connections		
Exhaust manifold to exhaust front tube		59.8 - 69.6 (6.1 - 7.0, 45 - 51)
Exhaust front tube to exhaust tube		51.0 - 64.7 (5.2 - 6.5, 38 - 47)
Exhaust tube to exhaust center tube		51.0 - 64.7 (5.2 - 6.5, 38 - 47)
Exhaust center tube to main muffler		43.1 - 54.9 (4.4 - 5.5, 32 - 40)
Mounting bolts and nuts	M8	12.7 - 15.7 (1.3 - 1.6, 10 - 11)

SERVICE DATA AND SPECIFICATIONS (SDS)
