

SECTION

ACC

ACC

ACCELERATOR CONTROL SYSTEM

CONTENTS

<b>ACCELERATOR CONTROL SYSTEM</b> .....	<b>2</b>	<b>SERVICE DATA AND SPECIFICATIONS (SDS)</b> .....	<b>4</b>
Removal and Installation .....	2	Tightening Torque .....	4
QR20DE AND QR25DE .....	2	QR20DE AND QR25DE .....	4
YD22DDTI .....	2	YD22DDTI .....	4
REMOVAL .....	2		
INSTALLATION .....	3		
INSPECTION AFTER INSTALLATION .....	3		

# ACCELERATOR CONTROL SYSTEM

## ACCELERATOR CONTROL SYSTEM

PFP:18005

### Removal and Installation QR20DE AND QR25DE

EBS00KP5

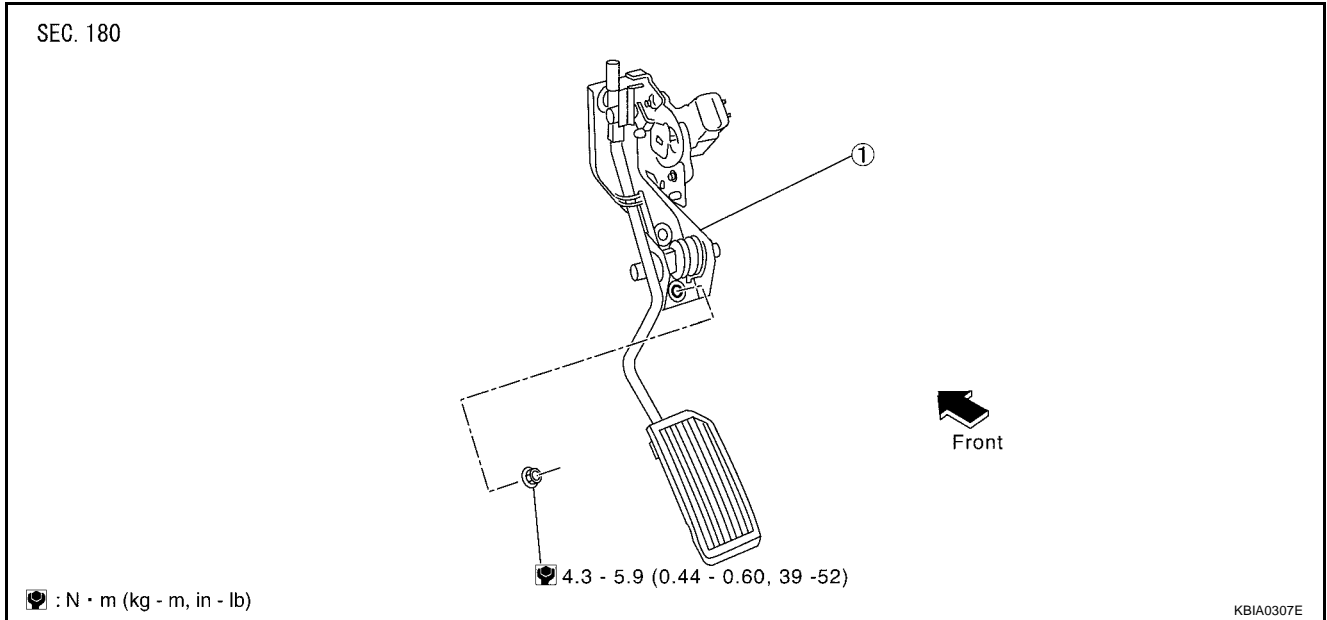

### YD22DDTI

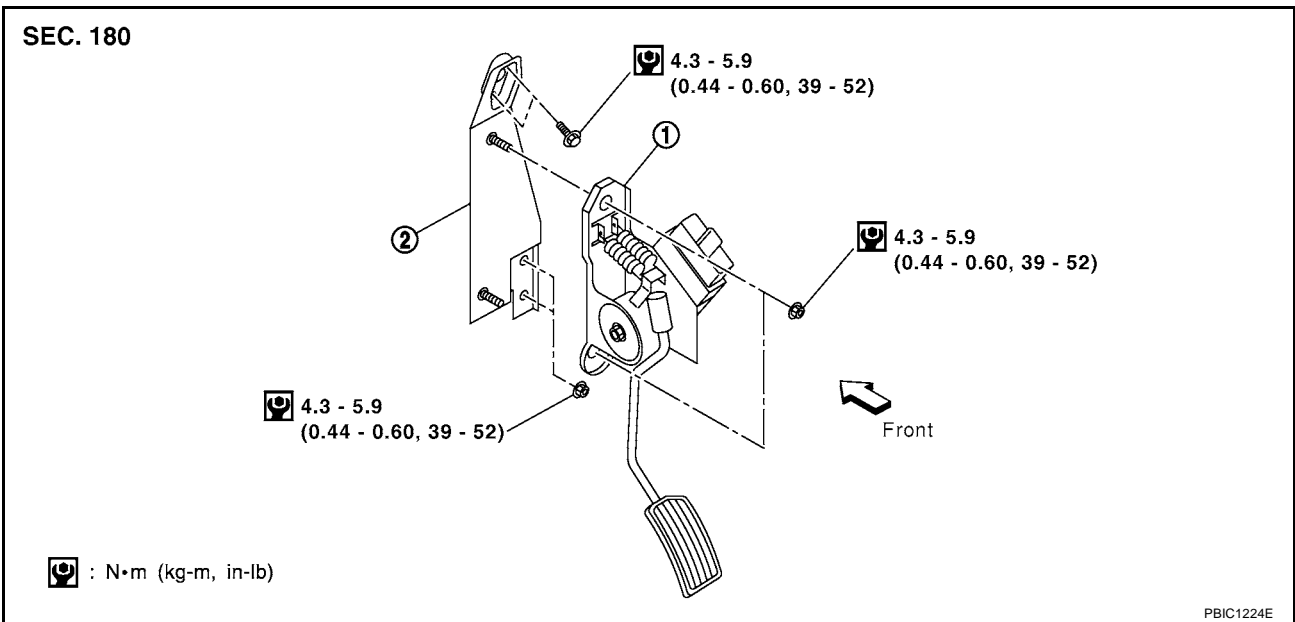

### REMOVAL

1. Disconnect accelerator pedal position sensor (QR) or accelerator work unit (YD22DDTi) harness connector.
2. Loosen nuts, and remove accelerator pedal assembly.
3. If necessary, loosen nuts and bolts, and remove accelerator pedal bracket (YD22DDTi).

#### CAUTION:

- Do not disassemble the accelerator pedal assembly. Do not remove the accelerator pedal position sensor (QR) or accelerator work unit (YD22DDTi) from the accelerator pedal assembly.
- Avoid impact from dropping etc. during handling.
- Be careful to keep the accelerator pedal assembly away from water.

# ACCELERATOR CONTROL SYSTEM

- Do not adjust the adjusting screw (painted white) of the accelerator work unit. (YD22DDTi)

## INSTALLATION

Install in the reverse order of removal.

## INSPECTION AFTER INSTALLATION

- Check that the accelerator pedal moves smoothly within the whole operation range.
- Check that the accelerator pedal securely returns to the original position.
- For the electrical inspection of the accelerator pedal position sensor, refer to [EC-893, "DTC P0121 APP SENSOR"](#) [QR20DE (WITH EURO-OBD)], [EC-1222, "DTC P0121 APP SENSOR"](#) [QR20DE (WITHOUT EURO-OBD)], [EC-355, "DTC P2122, P2123 APP SENSOR"](#) , [EC-361, "DTC P2127, P2128 APP SENSOR"](#) [QR25DE (WITH EURO-OBD)] or [EC-631, "DTC P2122, P2123 APP SENSOR"](#) , [EC-637, "DTC P2127, P2128 APP SENSOR"](#) [QR25DE (WITHOUT EURO-OBD)].
- For the electrical inspection of the accelerator work unit, refer to [EC-1460, "DTC P0120 ACCELERATOR PEDAL POSITION SENSOR"](#) or [EC-1531, "DTC P1510 ACCELERATOR PEDAL RELEASED POSITION SWITCH"](#) . (YD22DDTi)
- Check that the drum of the accelerator work unit can be fully opened. (YD22DDTi)

### CAUTION:

When the harness connector of the accelerator pedal position sensor (QR) or accelerator work unit (YD22DDTi) is disconnected, perform "Accelerator Pedal Released Position Learning". Refer to [EC-772, "Accelerator Pedal Released Position Learning"](#) [QR20DE (WITH EURO-OBD)], [EC-1136, "Accelerator Pedal Released Position Learning"](#) [QR20DE (WITHOUT EURO-OBD)], [EC-39, "Accelerator Pedal Released Position Learning"](#) [QR25DE (WITH EURO-OBD)], [EC-449, "Accelerator Pedal Released Position Learning"](#) [QR25DE (WITHOUT EURO-OBD)] or [EC-1404, "Accelerator Pedal Released Position Learning"](#) (YD22DDTi).

## SERVICE DATA AND SPECIFICATIONS (SDS)

### SERVICE DATA AND SPECIFICATIONS (SDS)

PFP:00030

#### Tightening Torque QR20DE AND QR25DE

EBS00KP6

Unit: N·m (Kg·m, in-lb)

Accelerator pedal assembly	4.3 - 5.9 (0.44 - 0.60, 39 - 52)
----------------------------	----------------------------------

#### YD22DDTI

Unit: N·m (Kg·m, in-lb)

Accelerator pedal assembly (work unit)	4.3 - 5.9 (0.44 - 0.60, 39 - 52)
Accelerator pedal bracket	4.3 - 5.9 (0.44 - 0.60, 39 - 52)