

SECTION

SE

SEAT

A

B

C

CONTENTS

PRECAUTIONS	2	SEATBACK FRAME	12	F
Precautions for Supplemental Restraint System (SRS) "AIR BAG" and "SEAT BELT PRE-TENSIONER"	2	Disassembly and Assembly of Seat Cushion	13	
Precautions	2	SEAT CUSHION TRIM PAD	13	G
CLIP AND FASTENER	3	SEAT CUSHION FRAME	14	
List of Table	3	REAR SEAT	15	H
HEATED SEAT	4	Component Parts Location	15	
Description	4	BENCH SEAT (3 DOOR AND 5 DOOR)	15	
Wiring Diagram — H/SEAT	5	SLIDE SEAT (3 DOOR AND 5 DOOR)	16	
FRONT SEAT	9	BENCH SEAT (C+C)	17	
Component Parts Location	9	Removal and Installation (3 Door and 5 Door)	17	SE
Removal and Installation	11	REMOVAL	17	
REMOVAL	11	INSTALLATION	18	J
INSTALLATION	11	REAR SEATBACK DISASSEMBLY AND ASSEMBLY	19	
Disassembly and Assembly of Seatback	11	Removal and Installation (C+C)	19	K
SEATBACK TRIM PAD	11	REMOVAL	19	
		INSTALLATION	19	
		REAR SEATBACK DISASSEMBLY AND ASSEMBLY	20	L

PRECAUTIONS

PRECAUTIONS

PFP:00001

Precautions for Supplemental Restraint System (SRS) “AIR BAG” and “SEAT BELT PRE-TENSIONER”

EIS004P3

The Supplemental Restraint System such as “AIR BAG” and “SEAT BELT PRE-TENSIONER”, used along with a front seat belt, helps to reduce the risk or severity of injury to the driver and front passenger for certain types of collision. Information necessary to service the system safely is included in the SRS and SB section of this Service Manual.

WARNING:

- To avoid rendering the SRS inoperative, which could increase the risk of personal injury or death in the event of a collision which would result in air bag inflation, all maintenance must be performed by an authorized NISSAN/INFINITI dealer.
- Improper maintenance, including incorrect removal and installation of the SRS, can lead to personal injury caused by unintentional activation of the system. For removal of Spiral Cable and Air Bag Module, see the SRS section.
- Do not use electrical test equipment on any circuit related to the SRS unless instructed to in this Service Manual. SRS wiring harnesses can be identified by yellow and/or orange harnesses or harness connectors.

Precautions

EIS004P4

- When removing or disassembling any part, be careful not to damage or deform it. Protect parts, which may get in the way with cloth.
- When removing parts with a screwdriver or other tool, protect parts by wrapping them with vinyl or tape.
- Keep removed parts protected with cloth.
- If a clip is deformed or damaged, replace it.
- If an unreusable part is removed, replace it with a new one.
- Tighten bolts and nuts firmly to the specified torque.
- After re-assembly has been completed, make sure each part functions correctly.
- Remove stains in the following way.

Water-soluble stains:

Dip a soft cloth in warm water, and then squeeze it tightly. After wiping the stain, wipe with a soft dry cloth.

Oil stain:

Dissolve a synthetic detergent in warm water (density of 2 to 3% or less), dip the cloth, then clean off the stain with the cloth. Next, dip the cloth in fresh water and squeeze it tightly. Then clean off the detergent completely. Then wipe the area with a soft dry cloth.



- Do not use any organic solvent, such as thinner or benzene.

CLIP AND FASTENER

PFP:76906

List of Table

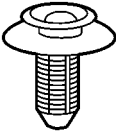
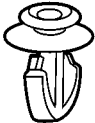
EIS0040N

Symbol No.	Shapes	Removal & Installation
C101 	  	Removal: Remove by bending up with flat-bladed screwdrivers or clip remover. 

MII0032E

A

B

C

D

E

F

G

H

SE

J

K

L

M

HEATED SEAT

HEATED SEAT

PFP:87335

Description

EIS004P5

- When handling seat, be extremely careful not to scratch heating unit.
- To replace heating unit, seat trim and pad should be separated.
- Do not use any organic solvent, such as thinner, benzene, alcohol, etc. to clean trims.

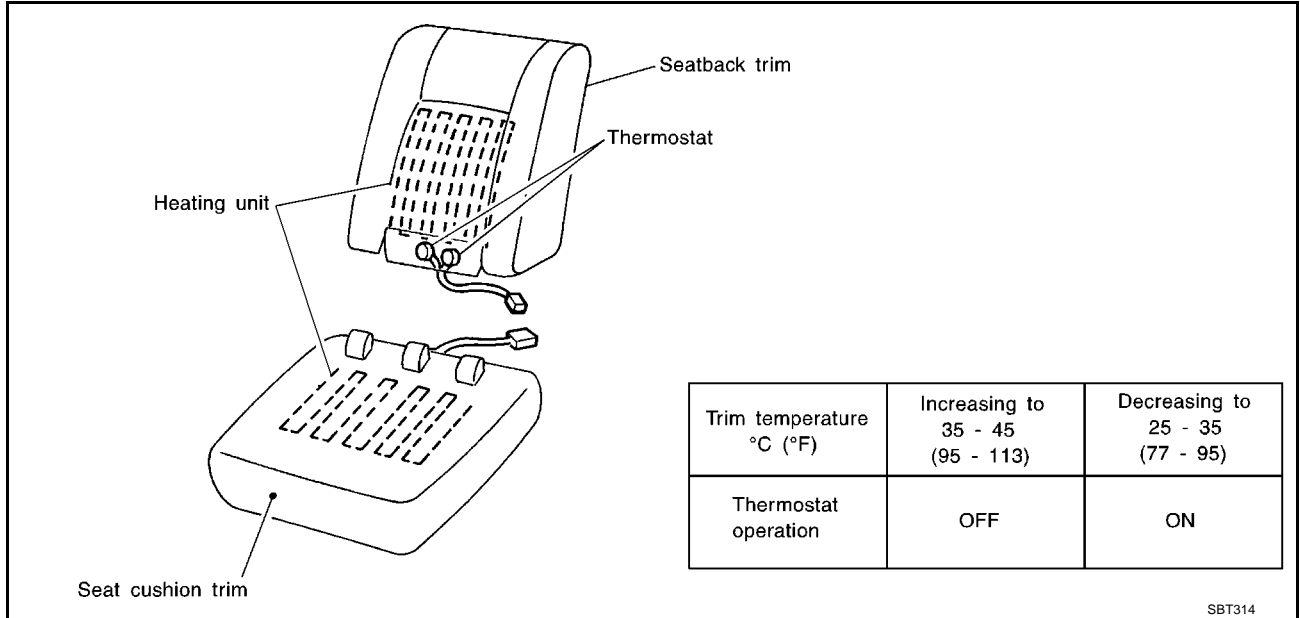

HEATED SEAT

Wiring Diagram — H/SEAT

EIS004P6

SE-H/SEAT-01

A
B
C
D
E
F
G
H
SE
J
K
L
M

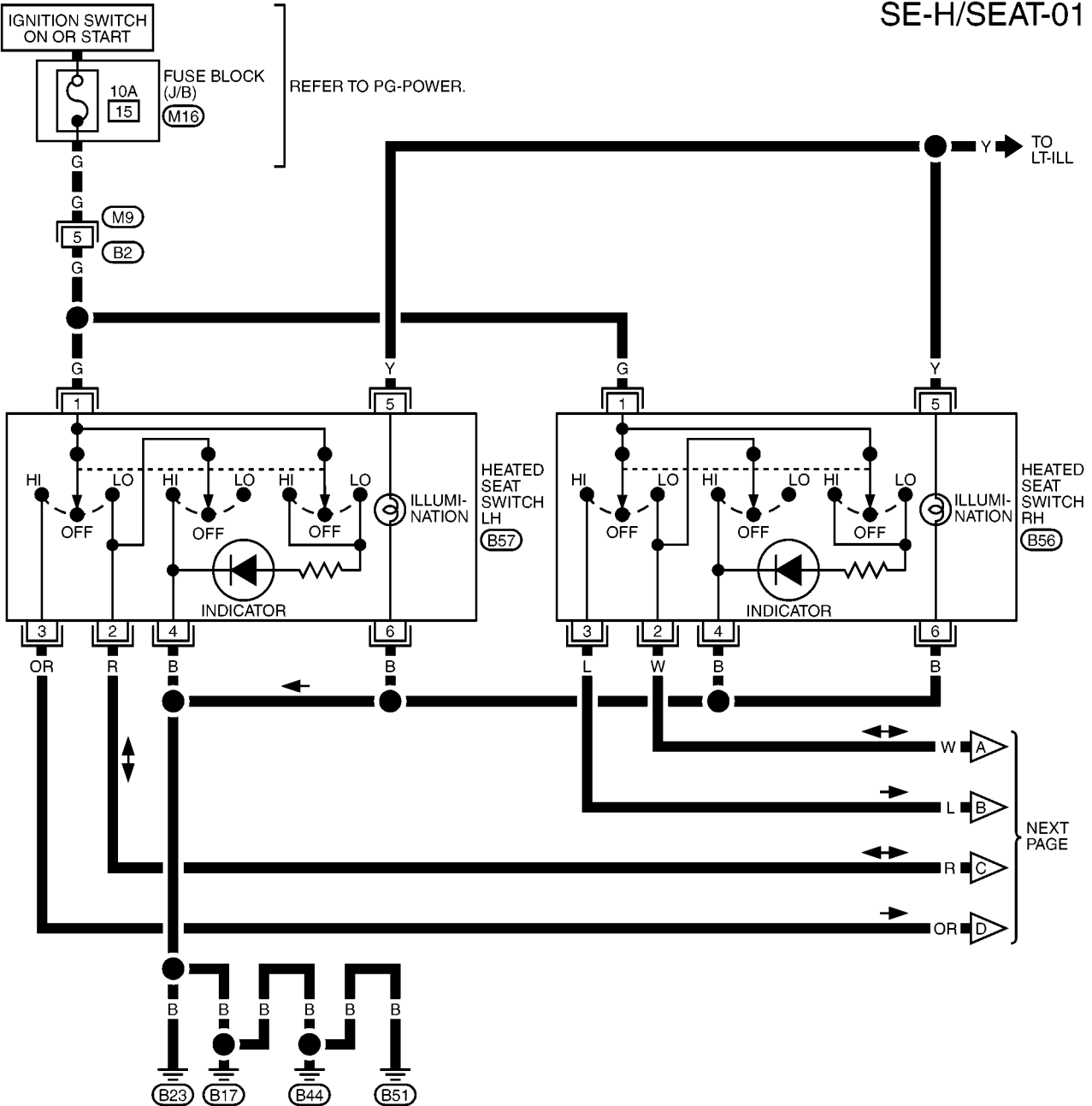

1	2	3	4	5	6	7	8	9	10	11	12
13	14	15	16	17	18	19	20	21	22	23	24

(M9)
W

1	2
3	4

(M88)
W

6	5
3	4

(B56), (B57)
BR W

REFER TO THE FOLLOWING.
(M16) - FUSE BLOCK-
JUNCTION BOX (J/B)

MIWA0294E

HEATED SEAT

SE-H/SEAT-02

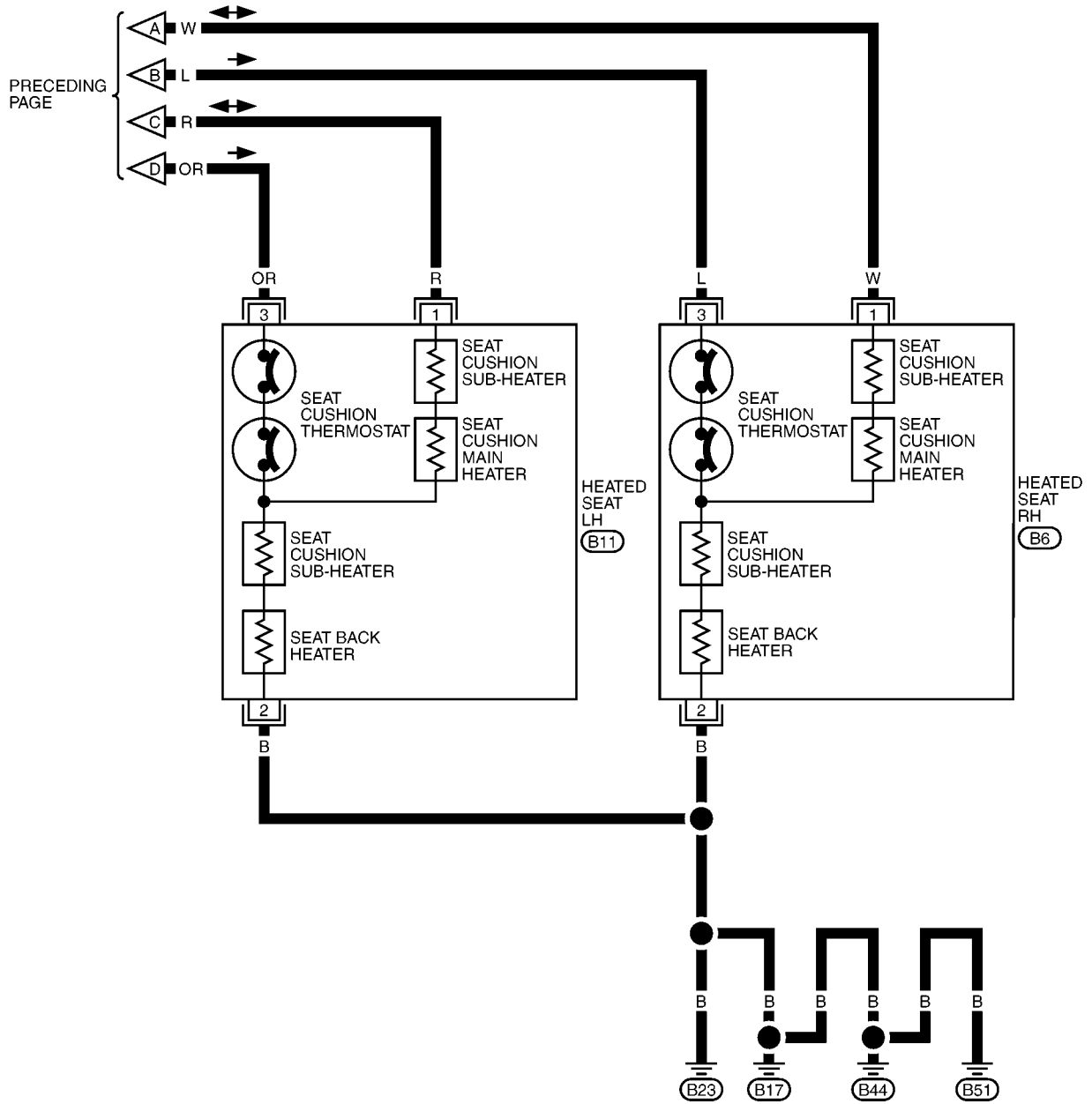

1	B6	B11
2	W	W
3		

MKWA0836E

HEATED SEAT

SE-H/SEAT-03

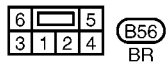
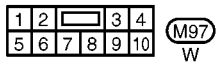
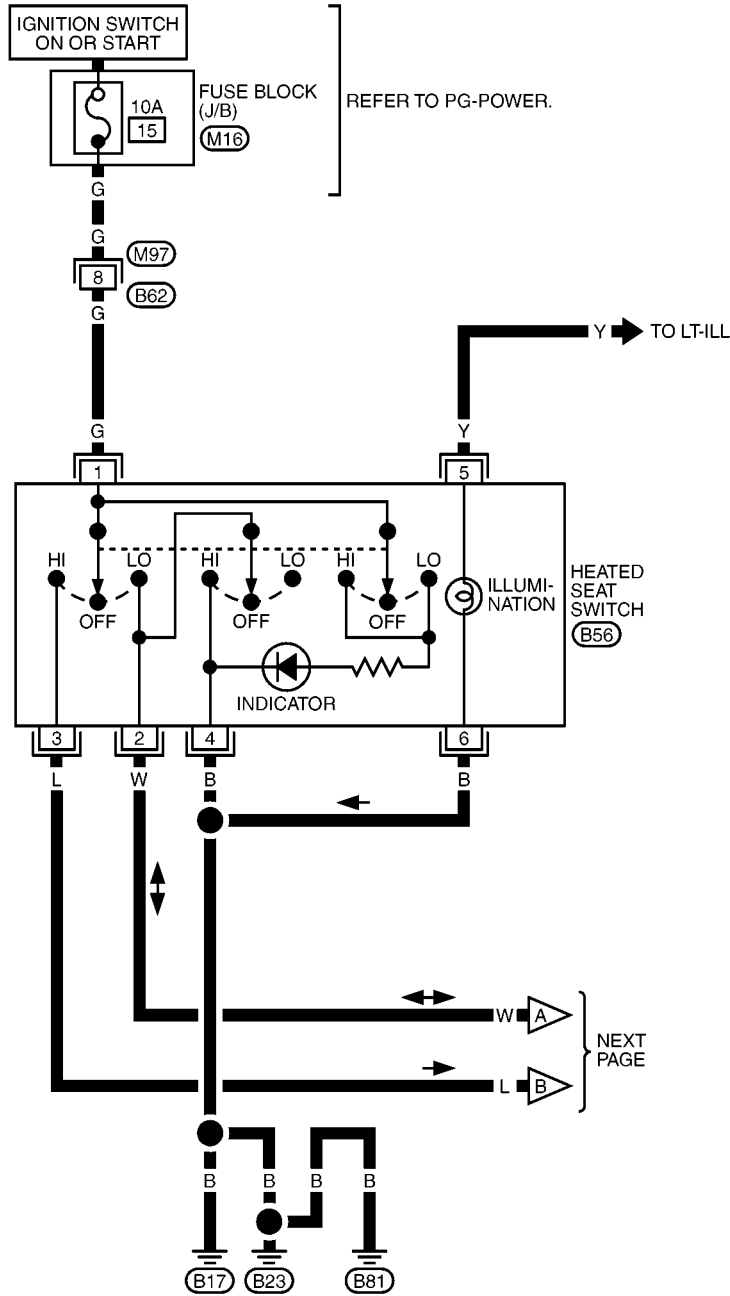

REFER TO THE FOLLOWING.

(M16) - FUSE BLOCK -
JUNCTION BOX (J/B)

MIWA0575E

HEATED SEAT

SE-H/SEAT-04

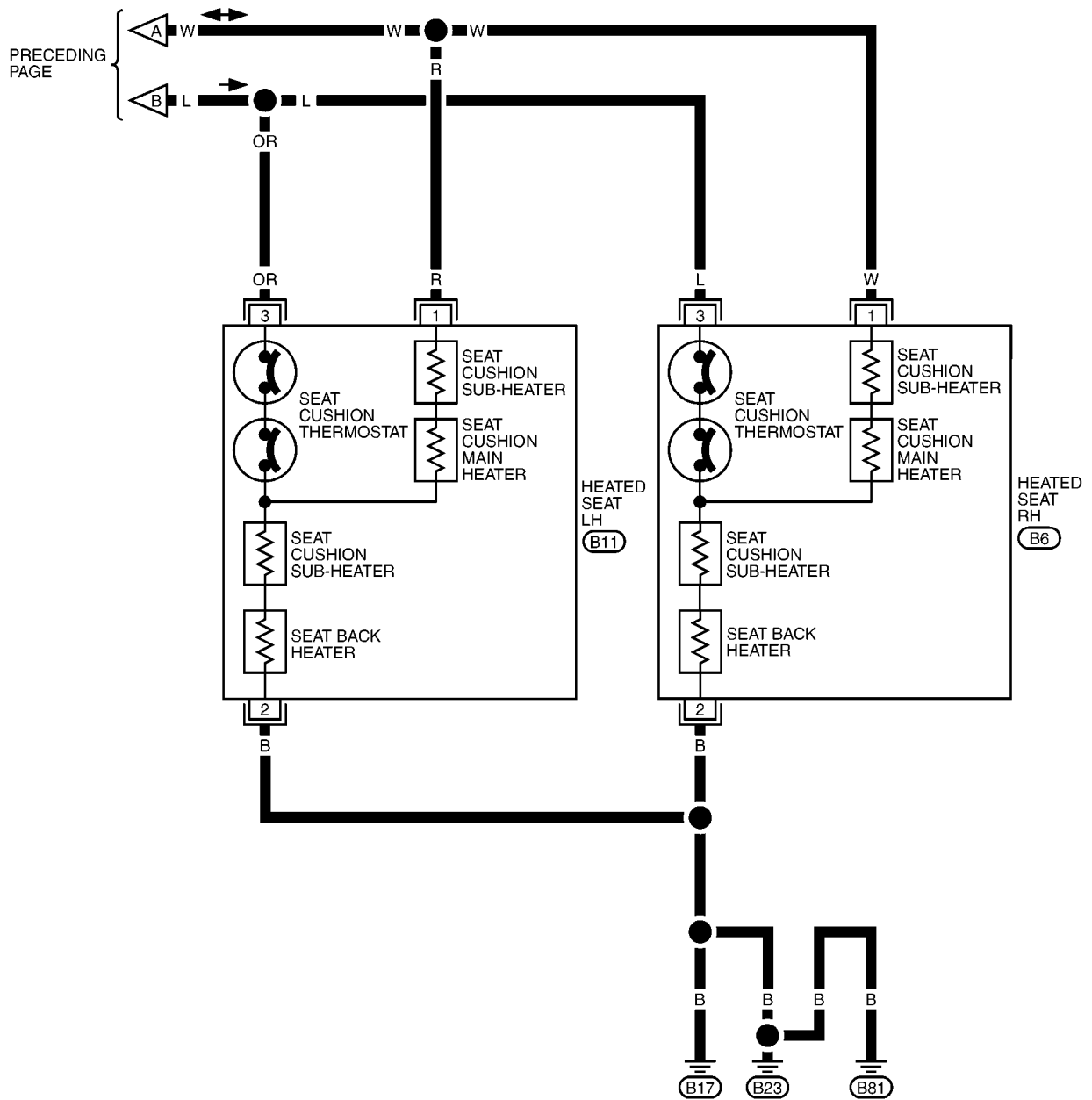

1	B6	B11
2	W	W
3		

MIWA0576E

FRONT SEAT

PFP:87000

Component Parts Location

EIS004OP

CAUTION:
When removing and installing seats, use shop cloths to protect the parts from damage.

A

B

C

D

E

F

G

H

SE

J

K

L

M

FRONT SEAT

Driver side

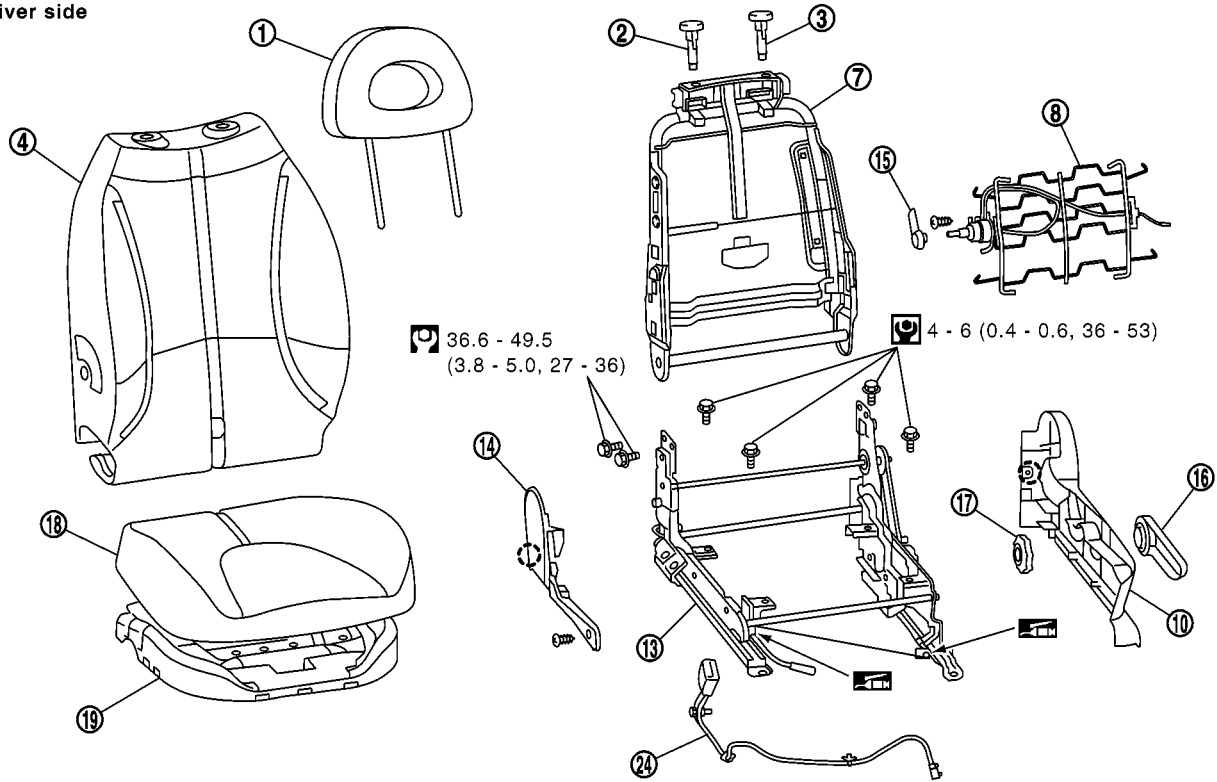

Passenger side

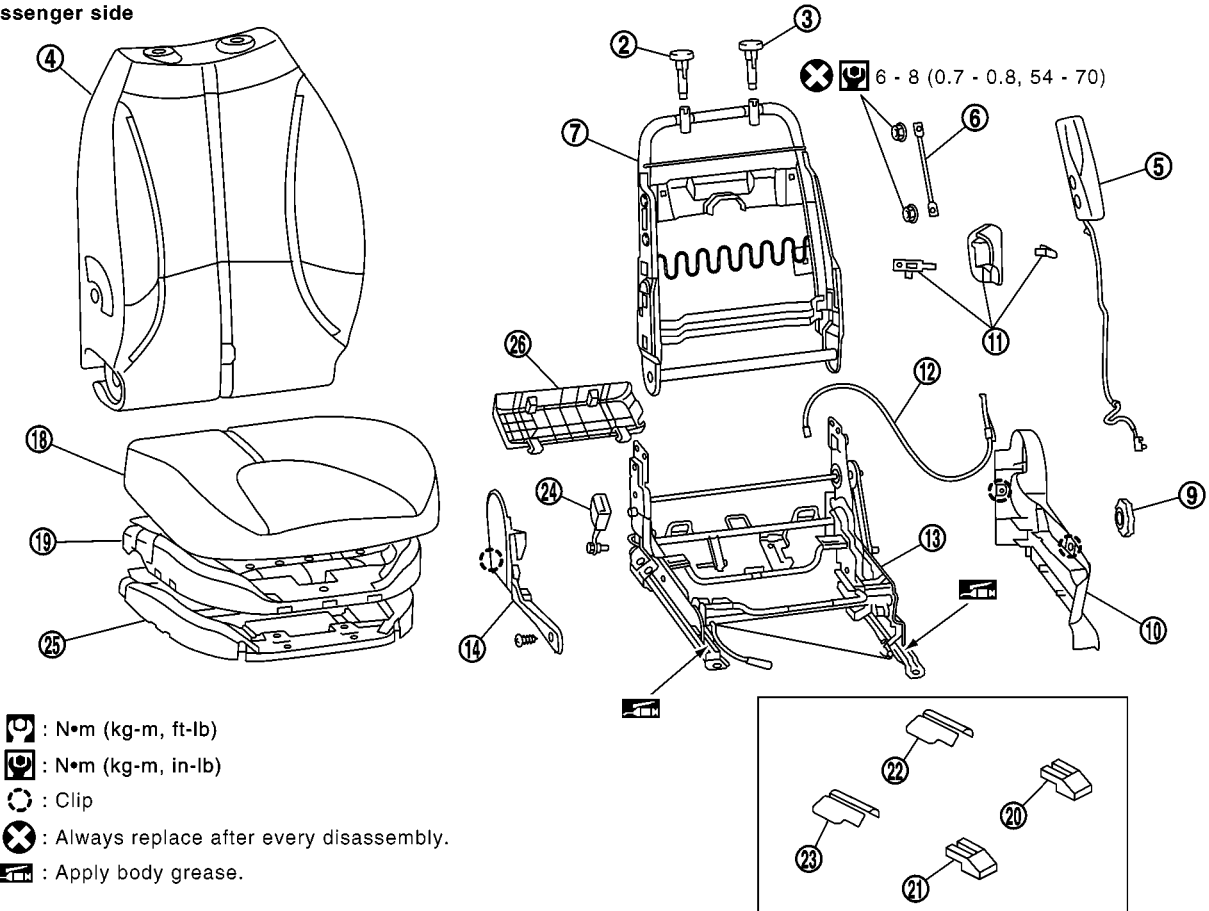

MIIB9203E

- | | | |
|------------------------|---------------------------|-----------------------------|
| 1. Headrest | 2. Headrest holder (free) | 3. Headrest holder (locked) |
| 4. Seatback trim & pad | 5. Side air bag module | 6. Fixed inner cross rod |
| 7. Seatback frame | 8. Lumbar assembly | 9. Reclining dial |

FRONT SEAT

- | | | |
|-------------------------------|-------------------------------|-------------------------------|
| 10. Seat slide outer finisher | 11. Tilt lever assembly | 12. Tilt cable |
| 13. Seat slide assembly | 14. Seat slide inner finisher | 15. Lumber support lever knob |
| 16. Seat lifter lever | 17. Seat lifter lever bracket | 18. Seat cushion trim & pad |
| 19. Seat cushion frame | 20. Front leg cover (inner) | 21. Front leg cover (outer) |
| 22. Rear leg cover (inner) | 23. Rear leg cover (outer) | 24. Belt buckle assembly |
| 25. Cushion pan undercover | 26. Underseat cover | |

Removal and Installation

REMOVAL

CAUTION:

For vehicles equipped with side air bags, disconnect the battery negative terminal, and wait at least 3 minutes before beginning work.

1. Remove side air bag module connector (vehicles with side air bags) and seatbelt buckle switch harness connector.
2. Remove front and rear leg covers.
3. Remove bolts (4), and remove seat from vehicle.

CAUTION:

When removing and installing, use shop cloths to protect parts from damage and interference.

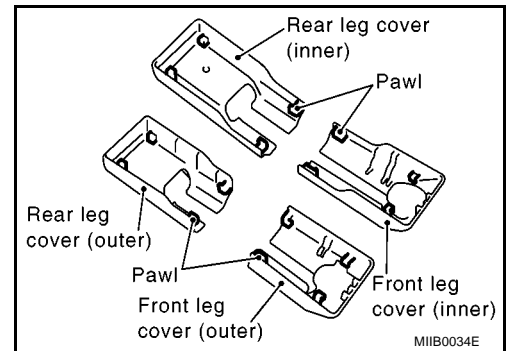

INSTALLATION

Install in the reverse order of removal.

CAUTION:

When removing and installing, use shop cloths to protect parts from damage and interference.

Disassembly and Assembly of Seatback

SEATBACK TRIM PAD

Disassembly (3 Door and 5 Door)

1. Unfasten seatback fastener. (Vehicles with side air bags)
2. Remove retainer.

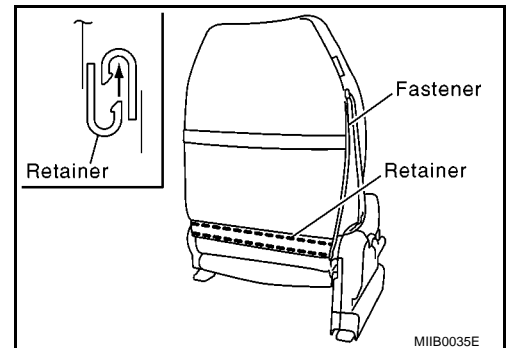

3. Turn over seatback trim, remove nuts (2), and remove fixed inner cross rod. (Vehicles with side air bags)

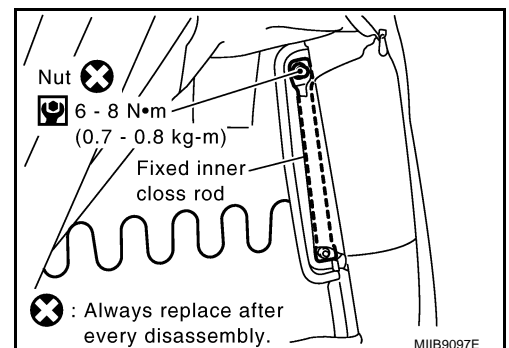

FRONT SEAT

4. Use pincers, etc., to push up hooks shown by the arrows in the figure, and remove headrest holder from seatback.
5. Remove seatback trim and pad from seatback frame.

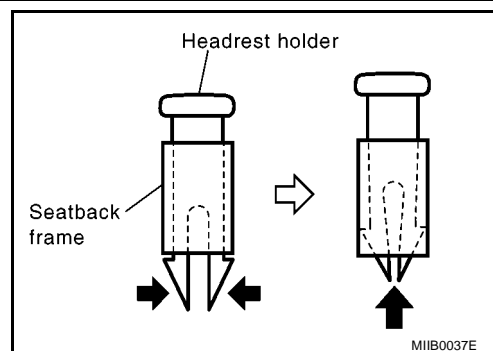

Disassembly (C+C)

1. Remove headrest.
2. Unfasten seatback fastener.
3. Separate both retainer parts, then release from seatback frame.
4. Turn over seatback trim, remove nuts (2), and remove fixed inner cross rod.
5. Remove headrest holders, tilt lever knob, tilt lever escutcheon, reclining dial.
6. Remove lumbar lever and seat lifter lever (driver seat).
7. Remove seat slide and outer finisher.
8. Pull air bag connector and heating connector out of seat slide frame.
9. Remove seatback trim and pad from seatback frame.

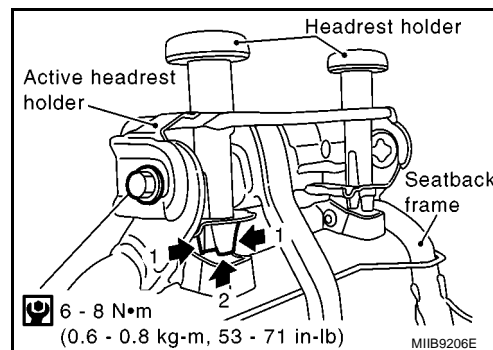

Assembly

Install in the reverse order of removal.

CAUTION:

Before installing headrest holder, check its orientation (front/rear and right/left).

SEATBACK FRAME

Disassembly (3 Door and 5 Door)

1. Remove seatback trim&pad.
2. Pull out side air bag connector from back of seat cushion.
3. Remove lumbar support lever knob, seat lifter lever, reclining dial, seat slide out finisher, slide inner cover, and seat slide inner finisher.
4. Remove seatback frame bolts and remove seatback frame from seat slide assembly.

FRONT SEAT

Disassembly (C+C)

CAUTION:

When removing or installing, use safety gloves to protect hands and seat cushion.

1. Remove seatback seat trim and pad. Refer to [SE-11, "SEATBACK TRIM PAD"](#).
2. Remove side air bag module. Refer to [SRS-42, "Removal and Installation"](#).
3. Remove seat slide inner finisher.
4. Remove fixing lockwasher from reclining shaft, then remove reclining shaft and pulley from seatback frame.
5. Remove fixing bolts from seatback frame, then remove seatback frame.
6. Remove active headrest protector, then remove fixing bolt and active headrest (if equipped).
7. Remove fixing bolts from lumbar unit, then remove lumbar unit assembly (driver seat).

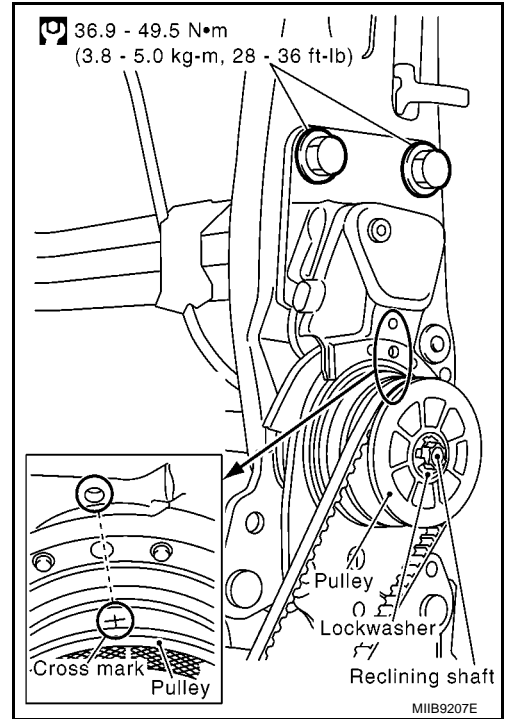

Assembly

Install in the reverse order of removal.

CAUTION:

After assembling seatback frame, make sure reclining device operates.

Disassembly and Assembly of Seat Cushion SEAT CUSHION TRIM PAD

EIS0040S

Disassembly

1. Remove seat lifter cover, seat lifter lever, reclining lever, seat slide out finisher, slide inner cover, and seat slide inner finisher.
2. Remove seatback frame bolts, and the remove seat cushion assembly from seatback frame
3. Remove retainer from the back of cushion.
4. Remove seat cushion trim&pad from seat cushion frame.

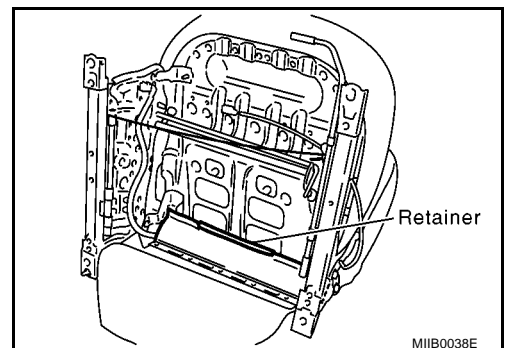

FRONT SEAT

Assembly

Install in the reverse order of removal.

CAUTION:

When assembling seat cushion assembly in seatback assembly, make sure the reclining device operates.

SEAT CUSHION FRAME

Disassembly

1. Remove short cushion trim&pad.
2. Remove bolts (4), and then remove seat cushion frame from seat slide assembly.

Assembly

Install in the reverse order of removal.

REAR SEAT

REAR SEAT

PFP:88300

Component Parts Location BENCH SEAT (3 DOOR AND 5 DOOR)

EIS0040T

A
B
C
D
E
F
G
H
SE
J
K
L
M

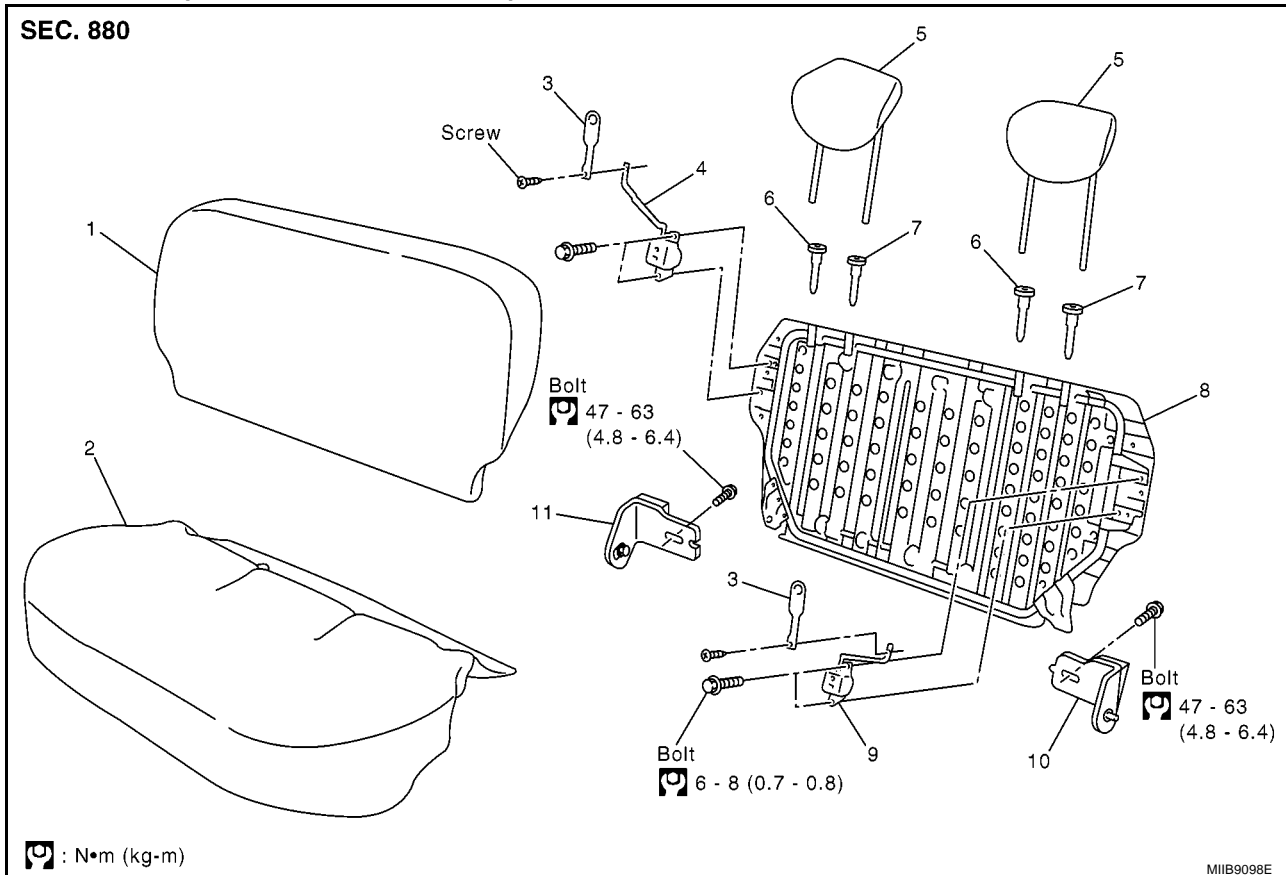



- | | | |
|---------------------------------|---------------------------------|---------------------------|
| 1. Rear seatback trim and pad | 2. Seat cushion trim and pad | 3. Seatback lock knob |
| 4. Rear seat lock (RH) | 5. Headrest | 6. Headrest holder (free) |
| 7. Headrest holder (locked) | 8. Seatback frame | 9. Rear seat lock (LH) |
| 10. Rear seat side bracket (LH) | 11. Rear seat side bracket (RH) | |

REAR SEAT

SLIDE SEAT (3 DOOR AND 5 DOOR)

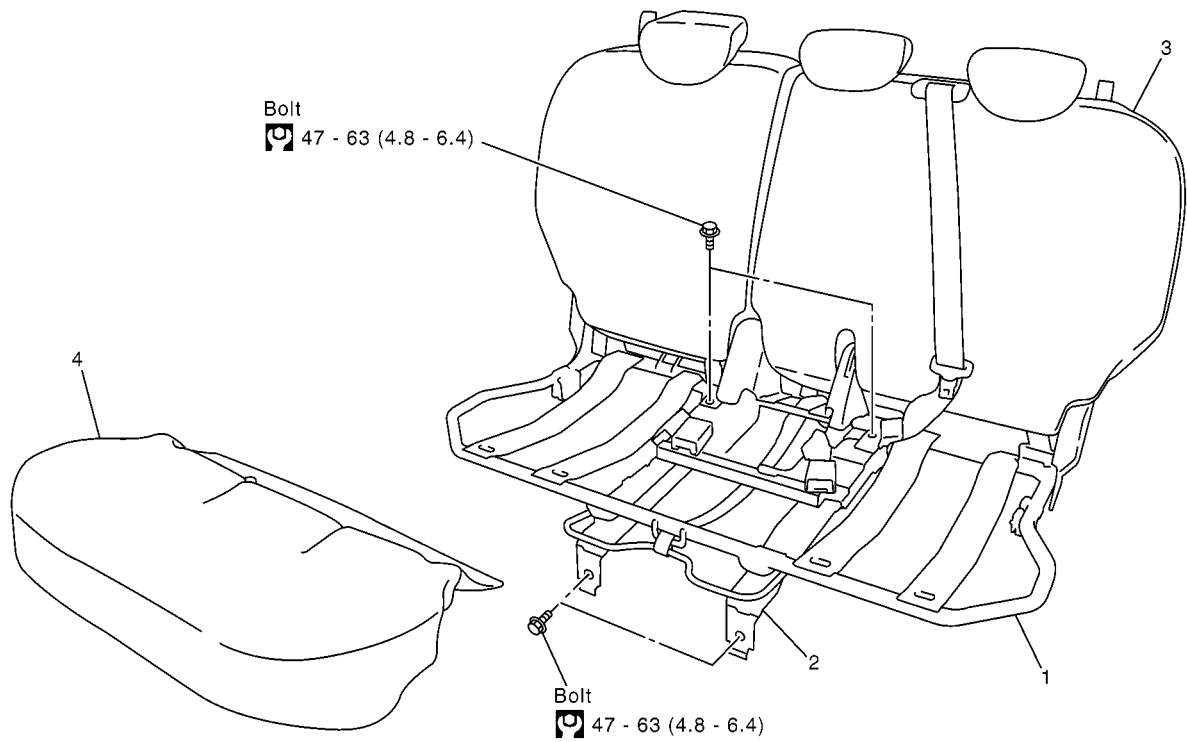
SEC. 880



 : N•m (kg-m, ft-lb)

M11B9069E

1. Seat slide assembly
2. Slide rail
3. Rear seatback trim and pad
4. Seat cushion trim and pad

REAR SEAT

BENCH SEAT (C+C)

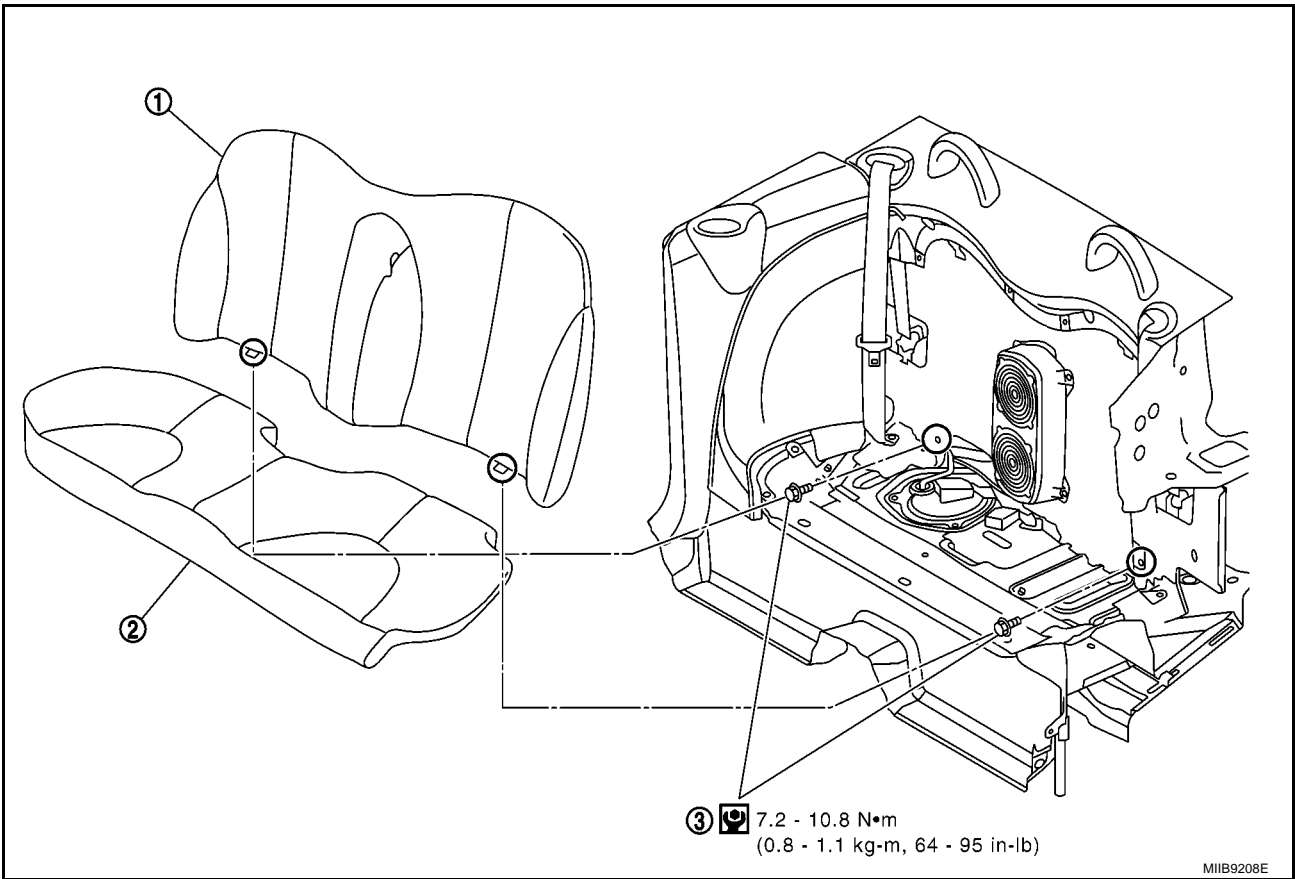

1. Rear seatback trim and pad

2. Seat cushion trim and pad

3. Bolt

Removal and Installation (3 Door and 5 Door)

REMOVAL

Seat Cushion

- Lift up seat cushion bottom, remove wire from plastic hooks (2 locations), and pull forward to remove.

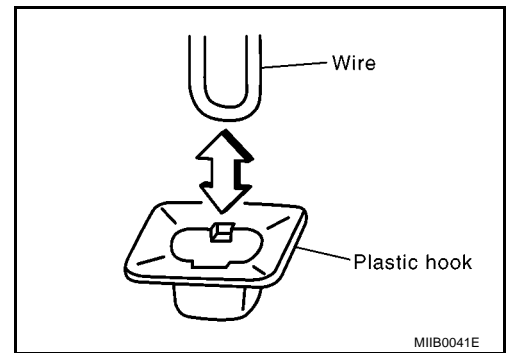

Seatback (Bench Seat)

- Turn over rear seatback carpet, remove rear seat side bracket bolts (2), and remove seatback from vehicle.

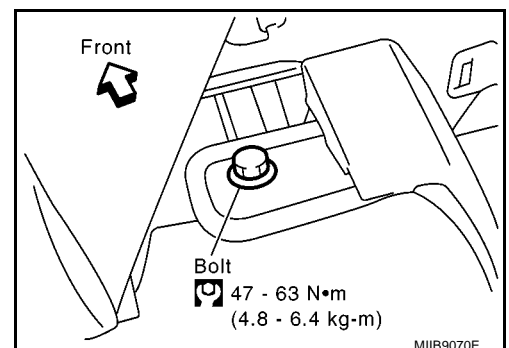

REAR SEAT

Rear Seat Side Bracket

1. Remove seat cushion and rear seatback.
2. Remove bolts (1 at LH/RH each), and remove rear seat side brackets (LH/RH) from vehicle.

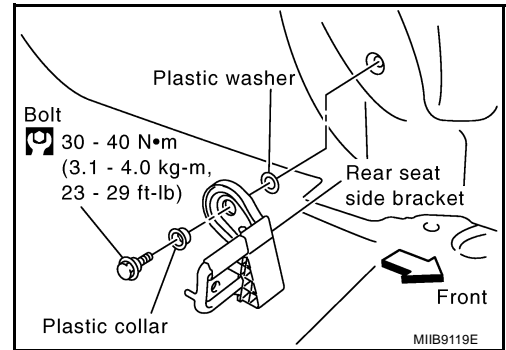

Rear Seat Center Bracket

1. Remove rear seat cushion and rear seatback.
2. Remove bolts (two), and then remove rear seat center bracket from vehicle.

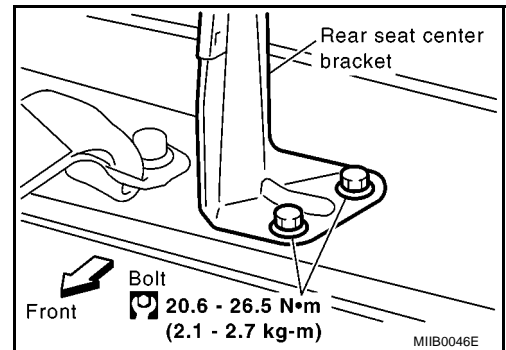

Child Car Seat Anchor That Complies With ISO FIX

1. Remove seat cushion.
2. Remove bolts (1 at LH/RH each), and then remove child car seat anchors that complies with ISO FIX (LH/RH) from vehicle.

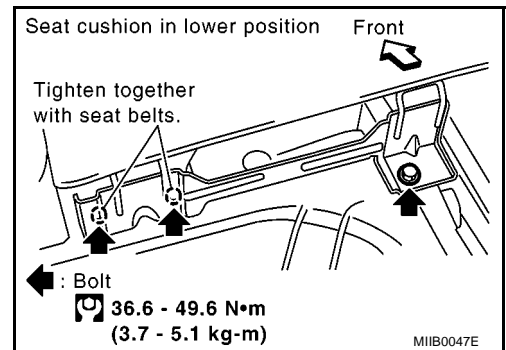

INSTALLATION

Install in the reverse order of removal.

REAR SEAT

REAR SEATBACK DISASSEMBLY AND ASSEMBLY

Disassembly

1. Use pincers, etc., to push up hooks shown by the arrows in the figure, and remove headrest holder from seatback.

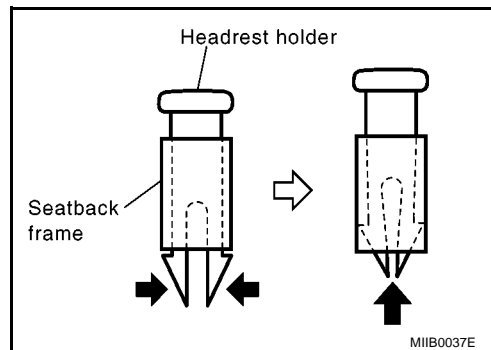

2. Remove retainer, and separate seatback trim&pad, and seatback frame.

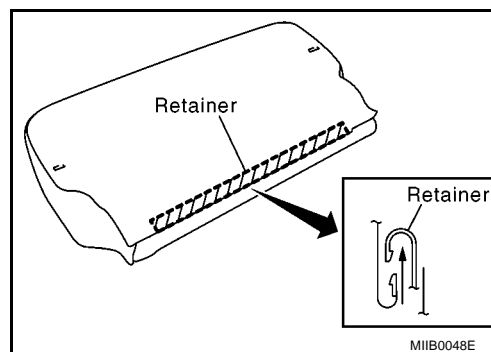

Assembly

Install in the reverse order of removal.

CAUTION:

Before installing headrest holder, check its orientation (front/rear and right/left).

Removal and Installation (C+C)

REMOVAL

Seatback

1. Remove seat cushion.
2. Remove fixing bolts (2), pull seatback lower end forward, then slide downward and rotate forward.

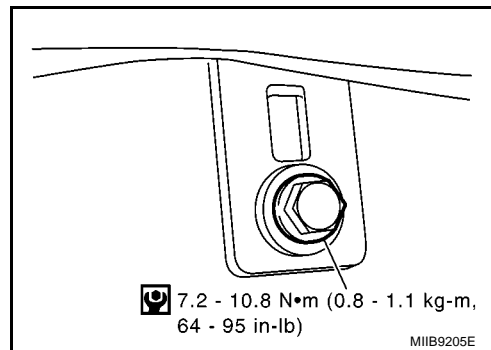

INSTALLATION

Install in the reverse order of removal.

REAR SEAT

REAR SEATBACK DISASSEMBLY AND ASSEMBLY

Disassembly

1. Use pliers to cut metal retainers from seatback trim and pad, and seatback frame.

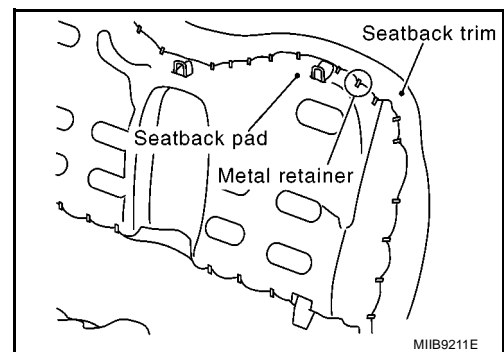

Assembly

Install in the reverse order of removal.