

A

SECTION

ACC

ACC

C

ACCELERATOR CONTROL SYSTEM

CONTENTS

ACCELERATOR CONTROL SYSTEM	2	SERVICE DATA AND SPECIFICATIONS (SDS)	3	F
Removal and Installation	2	Tightening Torque	3	
REMOVAL	2			G
INSTALLATION	2			
INSPECTION AFTER INSTALLATION	2			H

ACCELERATOR CONTROL SYSTEM

ACCELERATOR CONTROL SYSTEM

PFP:18005

Removal and Installation

EBS000JF

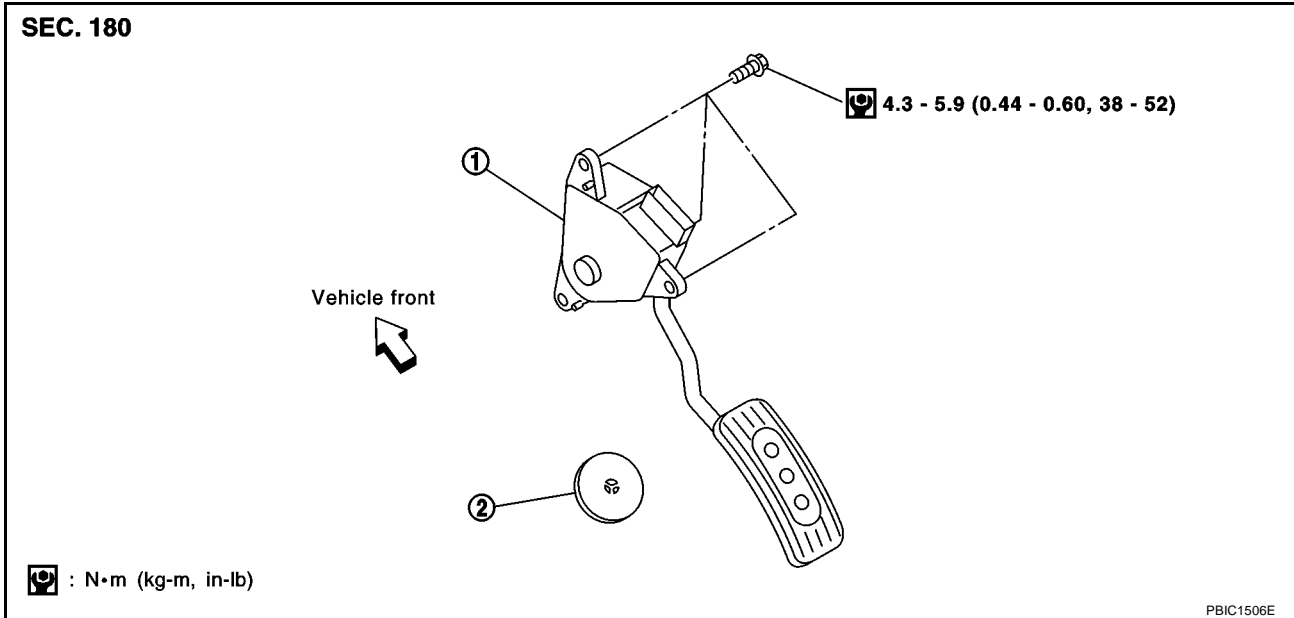

1. Accelerator pedal assembly

2. Accelerator pedal stopper
(Under floor carpet)

REMOVAL

1. Remove harness connector.
2. Remove mounting bolts, and remove accelerator assembly.

CAUTION:

- Do not disassemble accelerator pedal assembly and remove sensors.
 - Handle them carefully without subjecting them to impacts such as dropping.
 - Be careful not to get it wet.
3. Fold the floor carpet and remove accelerator pedal stopper.
 - Remove pedal stopper by turning it counterclockwise with fingers.

INSTALLATION

Install in the reverse order of removal. be careful of the following:

- Insert locating pin into vehicle side to position accelerator pedal assembly. Install mounting bolt to accelerator pedal assembly.
- Align the stud bolt on the floor with the thread hole to insert accelerator pedal stopper until it contacts the face.

INSPECTION AFTER INSTALLATION

- Check that the accelerator pedal moves smoothly within the whole operation range.
- Check that the accelerator pedal securely returns to the original position.
- For the electrical inspection of the accelerator pedal assembly, refer to [EC-405, "DTC P2138 APP SENSOR"](#) (CR WITH EURO-OBD), [EC-721, "DTC P2138 APP SENSOR"](#) (CR WITHOUT EURO-OBD) and [EC-1197, "DTC P2138 APP SENSOR"](#) (HR WITH EURO-OBD), [EC-1519, "DTC P2138 APP SENSOR"](#) (HR WITHOUT EURO-OBD) or "Interpretation", "DIESEL INJECTION" in EC section(K9K).
- When accelerator electrical connector is disconnected, perform [EC-49, "Accelerator Pedal Released Position Learning"](#) (CR WITH EURO-OBD), [EC-479, "Accelerator Pedal Released Position Learning"](#) (CR WITHOUT EURO-OBD) and [EC-858, "Accelerator Pedal Released Position Learning"](#) (HR WITH EURO-OBD), [EC-1283, "Accelerator Pedal Released Position Learning"](#) (HR WITHOUT EURO-OBD).

SERVICE DATA AND SPECIFICATIONS (SDS)

SERVICE DATA AND SPECIFICATIONS (SDS)		PFP:00030
Tightening Torque		EBS000JG
		Unit: N·m (kg-m, in-lb)
Accelerator pedal assembly	4.3 - 5.9 (0.44 - 0.60, 38 - 52)	

- ACC
- A
- C
- D
- E
- F
- G
- H
- I
- J
- K
- L
- M

SERVICE DATA AND SPECIFICATIONS (SDS)
