

SECTION EI

EXTERIOR & INTERIOR

CONTENTS

PRECAUTIONS	2	WINDSHIELD MOLDING	13
Precautions for Supplemental Restraint System (SRS) "AIR BAG" and "SEAT BELT PRE-TENSIONER"	2	Removal and Installation	13
Precautions	2	REMOVAL	13
CLIP AND FASTENER	3	INSTALLATION	14
Clip and Fastener	3	DOOR OUTSIDE MOLDING	15
FRONT BUMPER	4	Removal and Installation	15
Removal and Installation	4	REMOVAL	15
REMOVAL	5	INSTALLATION	15
INSTALLATION	5	DOOR FINISHER	16
REAR BUMPER	6	Removal and Installation	16
Removal and Installation	6	REMOVAL	16
REMOVAL	6	INSTALLATION	17
INSTALLATION	7	BACK DOOR TRIM	18
FRONT GRILLE	8	Removal and Installation	18
Removal and Installation	8	REMOVAL	18
REMOVAL	8	INSTALLATION	18
INSTALLATION	8	BODY SIDE TRIM	19
FRONT DEFLECTOR	9	Removal and Installation (5-Door)	19
Removal and Installation	9	REMOVAL	19
REMOVAL	9	INSTALLATION	20
INSTALLATION	9	Removal and Installation (3-Door)	20
COWL TOP	10	REMOVAL	20
Removal and Installation	10	INSTALLATION	21
REMOVAL	10	FLOOR TRIM	22
INSTALLATION	10	Removal and Installation	22
FENDER PROTECTOR	11	REMOVAL	22
Removal and Installation	11	INSTALLATION	23
ROOF SIDE MOLDING	12	HEADLINER	24
Removal and Installation	12	Removal and Installation	24
REMOVAL	12	REMOVAL	24
INSTALLATION	12	INSTALLATION	25
		LUGGAGE FLOOR TRIM	26
		Removal and Installation	26
		REMOVAL	26
		INSTALLATION	27

PRECAUTIONS

PRECAUTIONS

PFP:00001

Precautions for Supplemental Restraint System (SRS) “AIR BAG” and “SEAT BELT PRE-TENSIONER”

EIS004PB

The Supplemental Restraint System such as “AIR BAG” and “SEAT BELT PRE-TENSIONER”, used along with a front seat belt, helps to reduce the risk or severity of injury to the driver and front passenger for certain types of collision. Information necessary to service the system safely is included in the SRS and SB section of this Service Manual.

WARNING:

- To avoid rendering the SRS inoperative, which could increase the risk of personal injury or death in the event of a collision which would result in air bag inflation, all maintenance must be performed by an authorized NISSAN/INFINITI dealer.
- Improper maintenance, including incorrect removal and installation of the SRS, can lead to personal injury caused by unintentional activation of the system. For removal of Spiral Cable and Air Bag Module, see the SRS section.
- Do not use electrical test equipment on any circuit related to the SRS unless instructed to in this Service Manual. SRS wiring harnesses can be identified by yellow and/or orange harnesses or harness connectors.

Precautions

EIS004PC

- When removing or disassembling any part, be careful not to damage or deform it. Protect parts, which may get in the way with cloth.
- When removing parts with a screwdriver or other tool, protect parts by wrapping them with vinyl or tape.
- Keep removed parts protected with cloth.
- If a clip is deformed or damaged, replace it.
- If an un reusable part is removed, replace it with a new one.
- Tighten bolts and nuts firmly to the specified torque.
- After re-assembly has been completed, make sure each part functions correctly.
- Remove stains in the following way.

Water-soluble stains:

Dip a soft cloth in warm water, and then squeeze it tightly. After wiping the stain, wipe with a soft dry cloth.

Oil stain:

Dissolve a synthetic detergent in warm water (density of 2 to 3% or less), dip the cloth, then clean off the stain with the cloth. Next, dip the cloth in fresh water and squeeze it tightly. Then clean off the detergent completely. Then wipe the area with a soft dry cloth.

- Do not use any organic solvent, such as thinner or benzene.

CLIP AND FASTENER

PPF:76906

Clip and Fastener

EIS004PD

Symbol No.	Shapes	Removal & Installation
C101		Removal: Remove by bending up with flat-bladed screwdrivers or clip remover.
C103		Removal: Remove with a clip remover.
C203		Removal: Push center pin to catching position. (Do not remove center pin by hitting it.) Installation:
C205		Removal: Flat-bladed screwdriver Clip Finisher
C206		Removal:

FRONT BUMPER

FRONT BUMPER

PFP:F2022

Removal and Installation

EIS004NZ

- Bumper fascia is made of plastic. Do not use excessive force and be sure to protect it from exposure to oil.

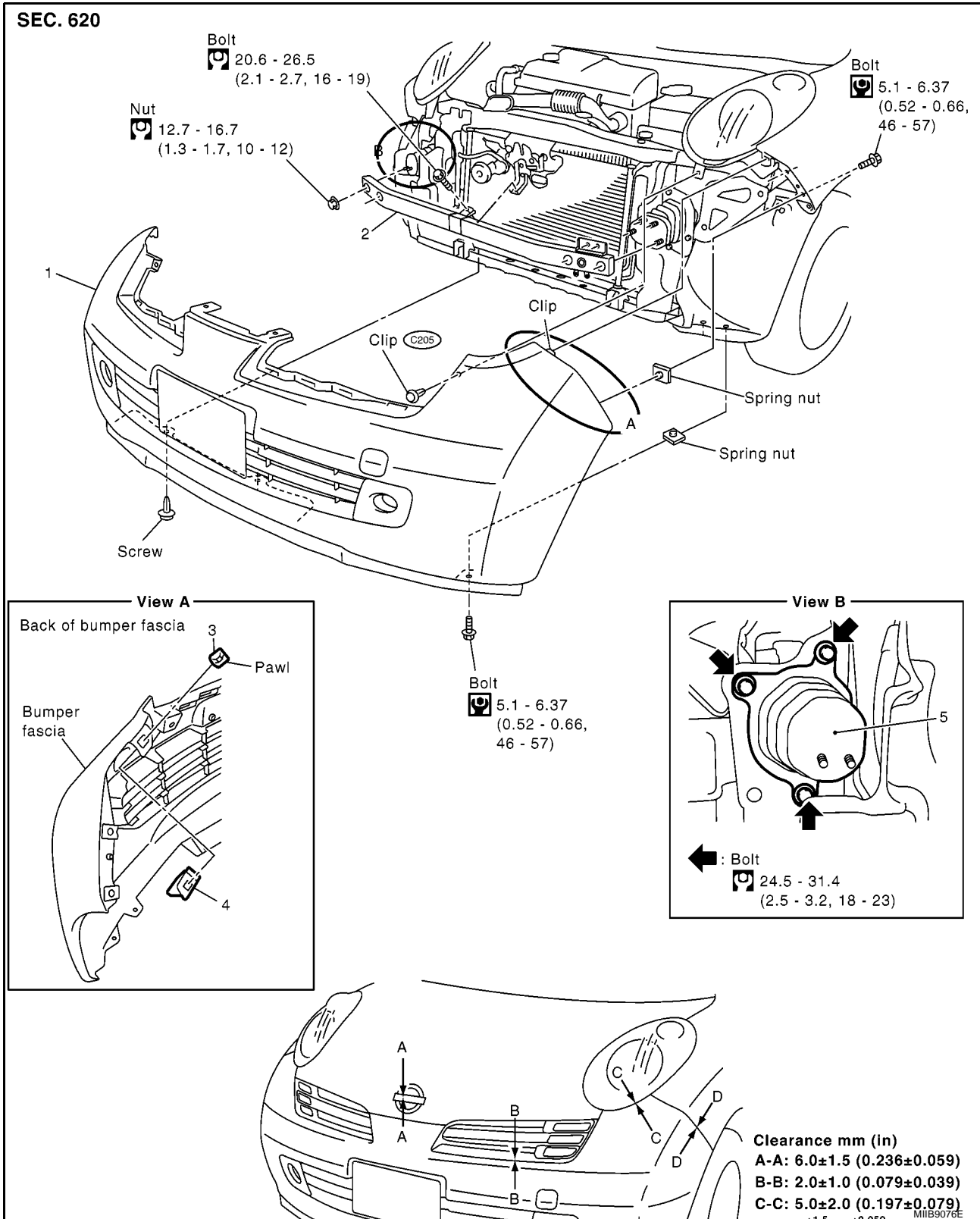

- Bumper fascia
- Bumper reinforcement
- Bumper side bracket (upper)
- Bumper side bracket (lower)
- Bumper stay

FRONT BUMPER

REMOVAL

- 1. Remove front grille. Refer to [EI-8, "FRONT GRILLE"](#) in EI section.
- 2. Remove bumper fascia installation clip.
- 3. Remove fender protectors (right, left). Refer to [EI-11, "FENDER PROTECTOR"](#) in EI section.
- 4. Remove the bolts holding bumper fascia to front fender.
- 5. Pull the bumper fascia horizontal from front fender mounting surface, disengage the clip, and remove.
- 6. Remove the bumper side brackets (upper and lower) from the bumper fascia.
- 7. Remove bolts and nuts and then remove bumper reinforcement.
- 8. Remove bolts and bumper stay.

INSTALLATION

Install in the reverse order of removal.

A

B

C

D

E

F

G

H

EI

J

K

L

M

REAR BUMPER

REAR BUMPER

PFP:H5022

Removal and Installation

EIS00400

Bumper fascia is made of plastic. Do not use excessive force and be sure to protect it from exposure to oil.

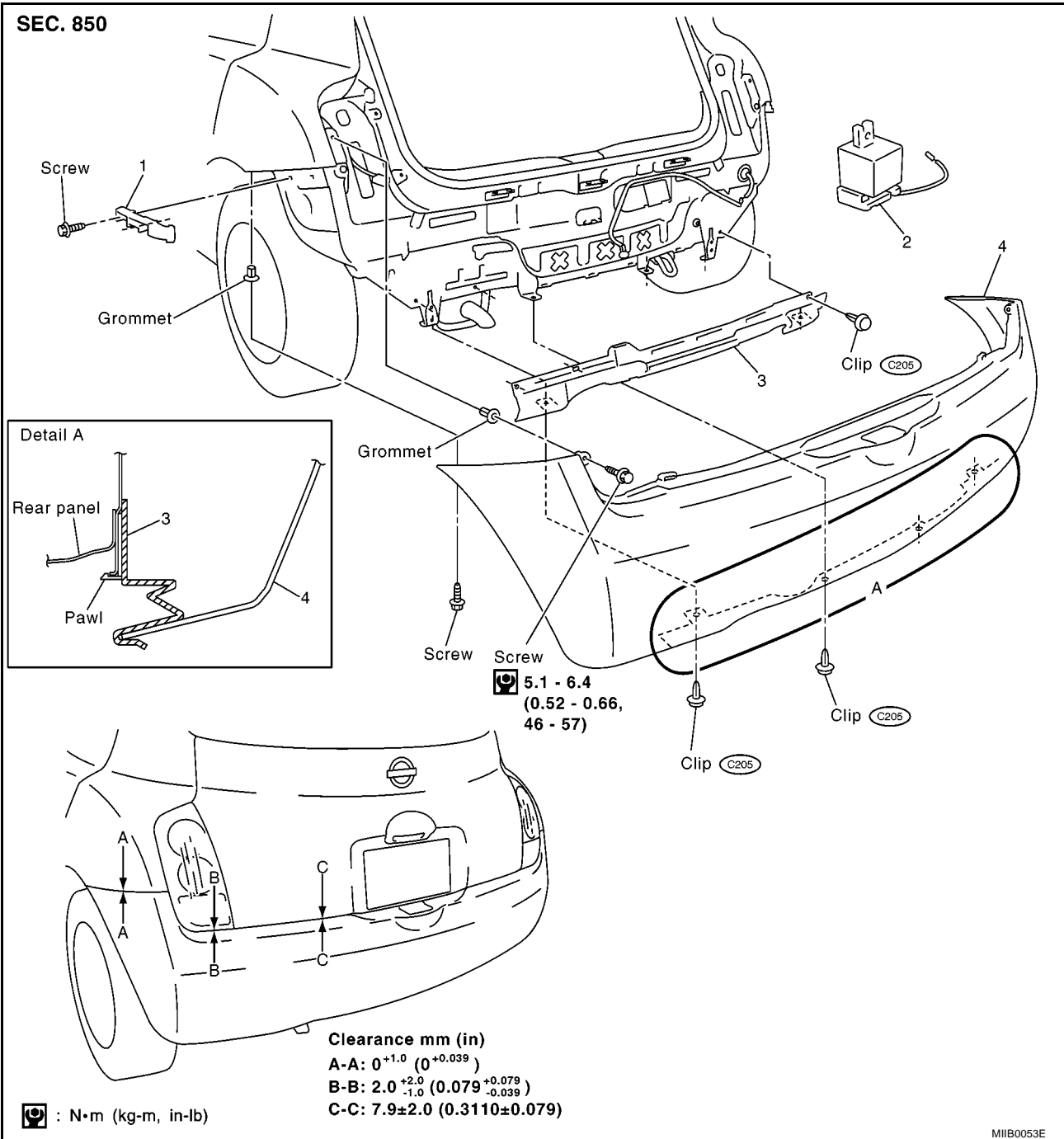

1. Bumper side bracket
2. Bumper energy shock absorber
3. Rear panel (lower)
4. Bumper fascia
5. Bumper stay

REMOVAL

1. Remove rear combination lamps (LH/RH). Refer to [LT-186, "Removal and Installation"](#).
2. Remove bumper fascia lower bottom installation clip
3. Remove bumper fascia screws.

REAR BUMPER

4. Remove bumper fascia side engaged hooks in the direction shown by the arrows in the figure.

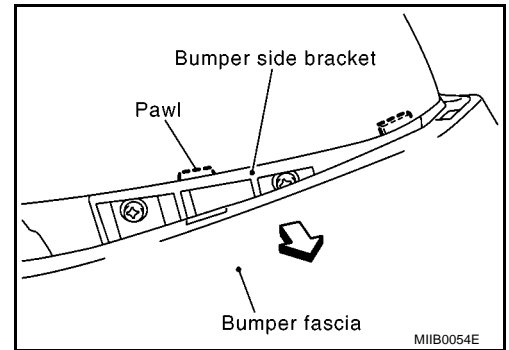

5. Remove license plate lamp, and then pull bumper fascia straight out toward back of vehicle to remove it. Refer to [LT-180, "LICENSE PLATE LAMP"](#).
6. Remove bumper energy shock absorber.
7. Remove the engaged rear panel (lower) mounting clips and hooks, and remove rear panel.

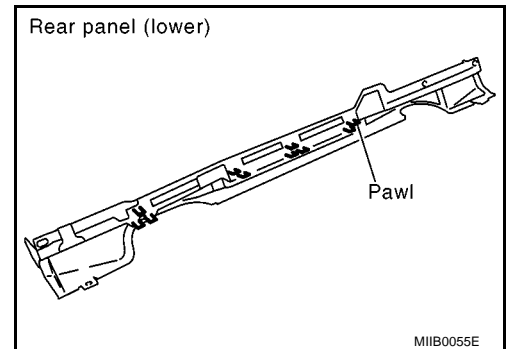

8. Remove bolts and bumper stay.

INSTALLATION

Note the following, and install in the reverse order of removal.

CAUTION:

Make sure the bumper fascia bottom edge is inserted in the rear panel (lower) insertion area.

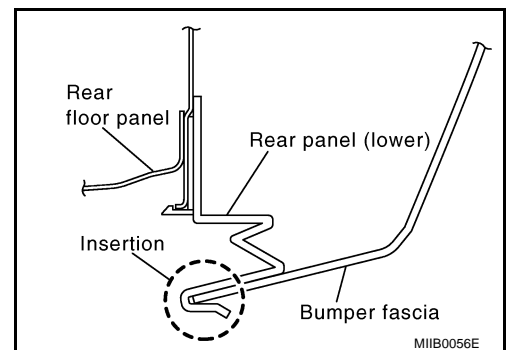

FRONT GRILLE

FRONT GRILLE

PFP:62310

Removal and Installation

EIS00401

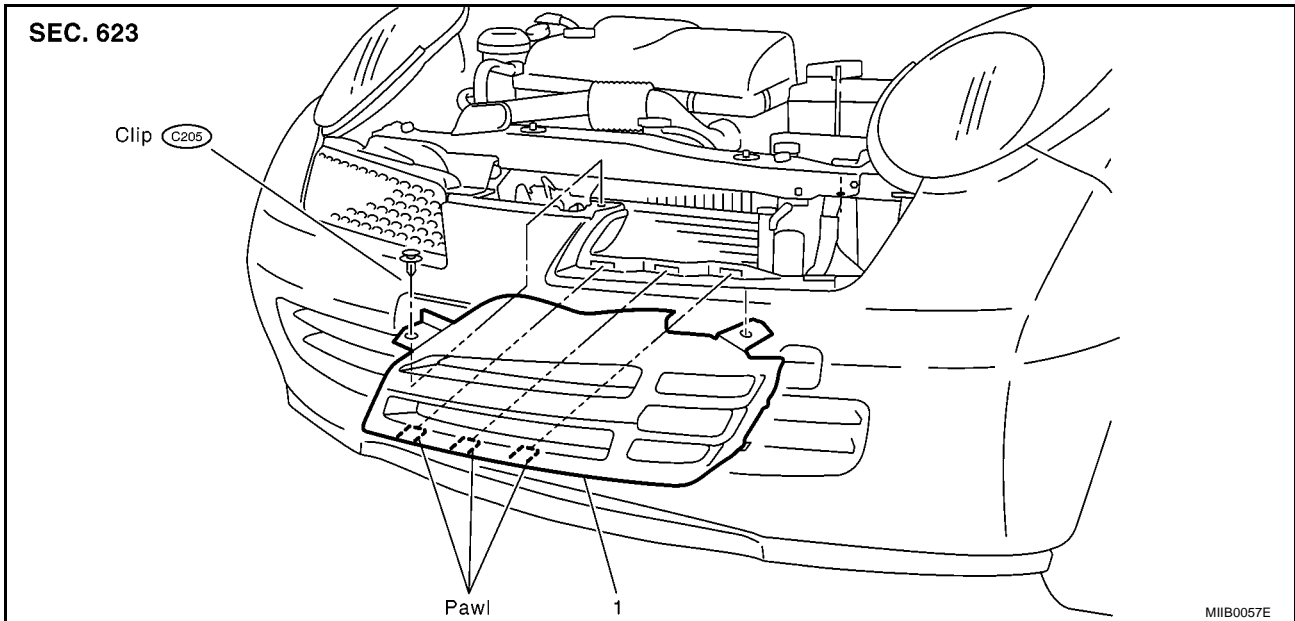

1. Front grille

REMOVAL

1. Remove mounting clips from top of front grille.
2. Insert your hand between the front grille and radiator core support (upper), and remove the front grille back hooks in order from the vehicle's center side to its outside.
3. After all hooks have been disengaged, pull front grille vehicle center side forward and remove the front turn signal lamp back insertion area and panel connector to remove the front grille vehicle center side.

INSTALLATION

Note the following, and install in the reverse order of removal.

CAUTION:

Before engaging the front grille back hooks, make sure the front turn signal lamp back insertion area is correctly inserted in the inside of the bumper fascia.

FRONT DEFLECTOR

FRONT DEFLECTOR Removal and Installation

PFP:96015

EIS00402

A
B
C
D
E
F
G
H
EI
J
K
L
M

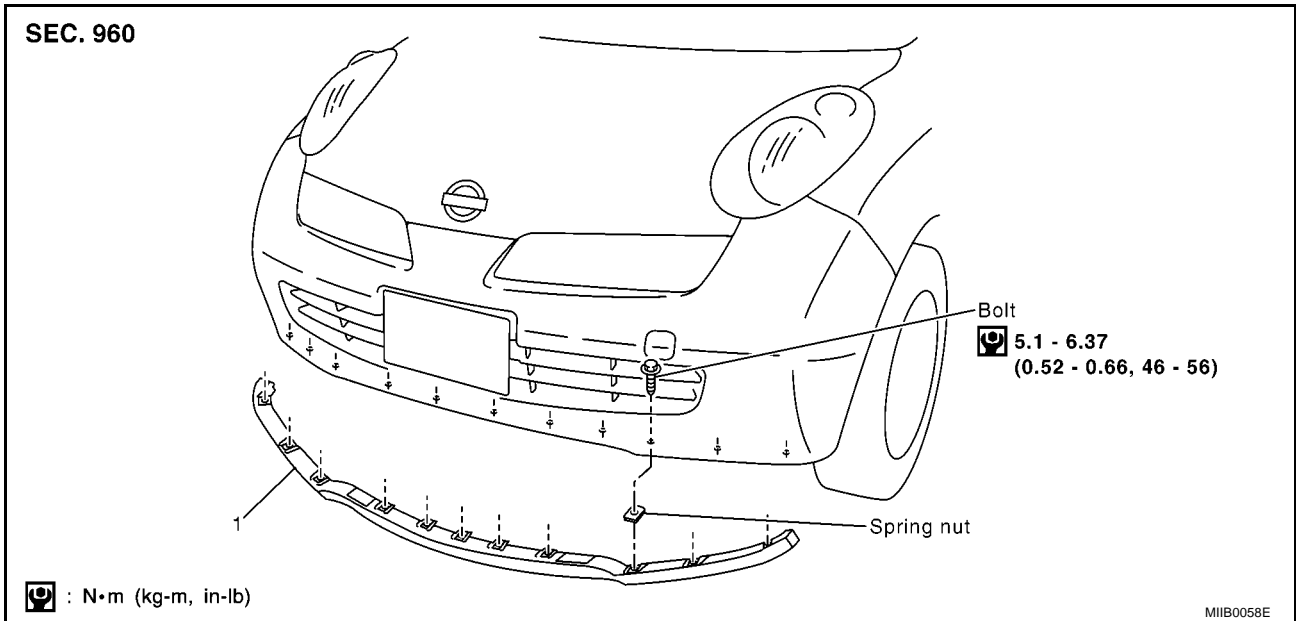

1. Front deflector

REMOVAL

1. Remove front bumper. Refer to [EI-4, "FRONT BUMPER"](#) in EI section.
2. Remove bolts from front bumper inner side, and then remove front deflector.

INSTALLATION

Install in the reverse order of removal.

COWL TOP

COWL TOP

PFP:66100

Removal and Installation

EIS00403

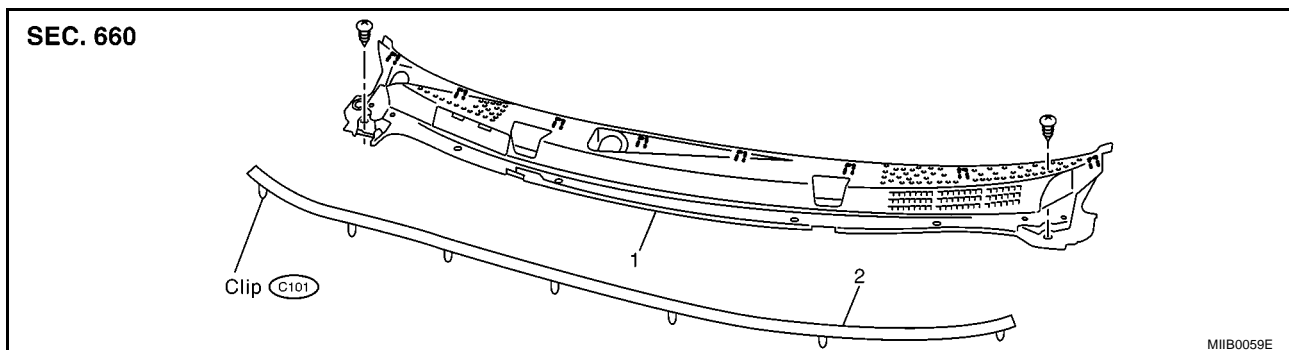

1. Cowl top cover

2. Cowl top seal rubber

REMOVAL

1. Remove front wiper arms (left and right). Refer to [WW-5, "FRONT WIPER AND WASHER SYSTEM"](#) , [WW-48, "FRONT WIPER AND WASHER SYSTEM \(WITH RAIN SENSOR\)"](#) in WW section.
2. Remove mounting screws, and the remove slat covers (LH/RH).
3. Remove cowl top seal rubber.
4. Pull cowl top over forward to remove it.

INSTALLATION

Install in the reverse order of removal.

FENDER PROTECTOR

FENDER PROTECTOR Removal and Installation

PFP:63840

EIS004O4

A
B
C
D
E
F
G
H
EI
J
K
L
M

SEC. 630

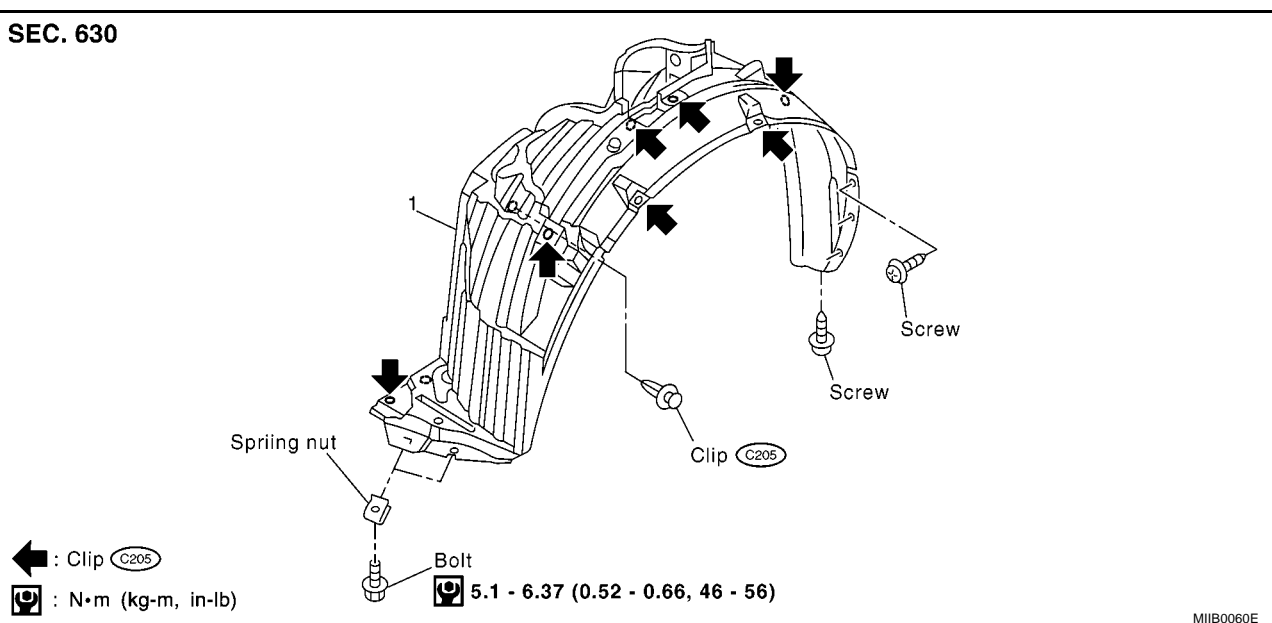

1. Fender protector

ROOF SIDE MOLDING

ROOF SIDE MOLDING

PFP:73854

Removal and Installation

EIS00405

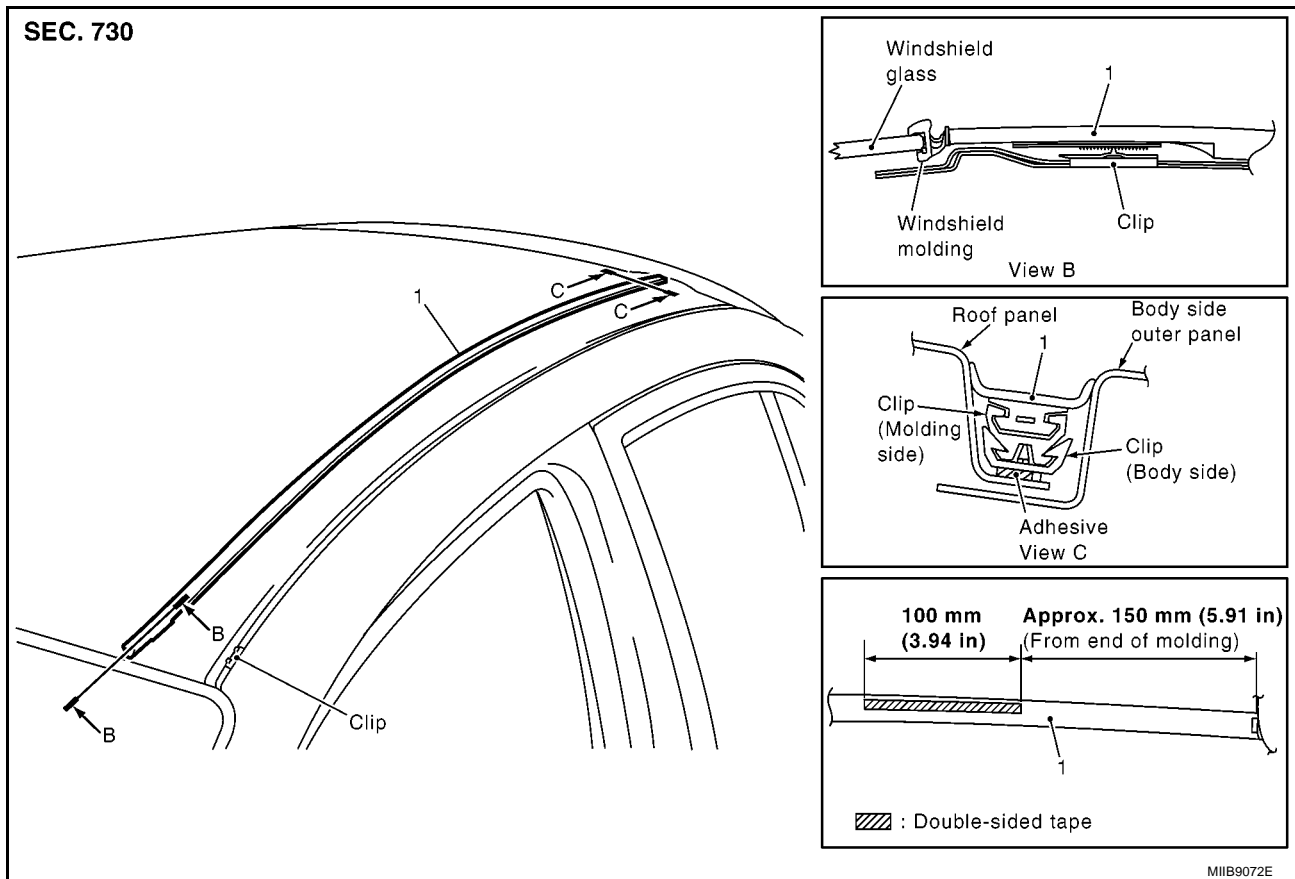

REMOVAL

1. Use a plastic knife, etc., and lift up the end of roof side molding (back end), remove clip, and peel off double-sided tape to remove it.
2. Remove the double-sided tape remaining on roof side molding back and vehicle body.

NOTE:

Double-sided tape can be easily removed using double-sided tape removal agent.

INSTALLATION

NOTE:

When only installing roof side molding, conduct the following procedure from Step 3.

1. Clean the roof side molding clip attachment surface (body side).
2. Bond roof side molding clip (body side) to vehicle body and let sit for 40 min.
3. Apply primer (Sumitomo3M N200 or comparable product) to roof side molding back double-sided tape application area.
4. Apply double-sided tape to roof side molding back (position in figure).
5. After butting roof side molding front end against window seal molding, push in molding from front to back end, and then affix to body using clips and double-sided tape.

WINDSHIELD MOLDING

WINDSHIELD MOLDING

PFP:72750

Removal and Installation

EIS00406

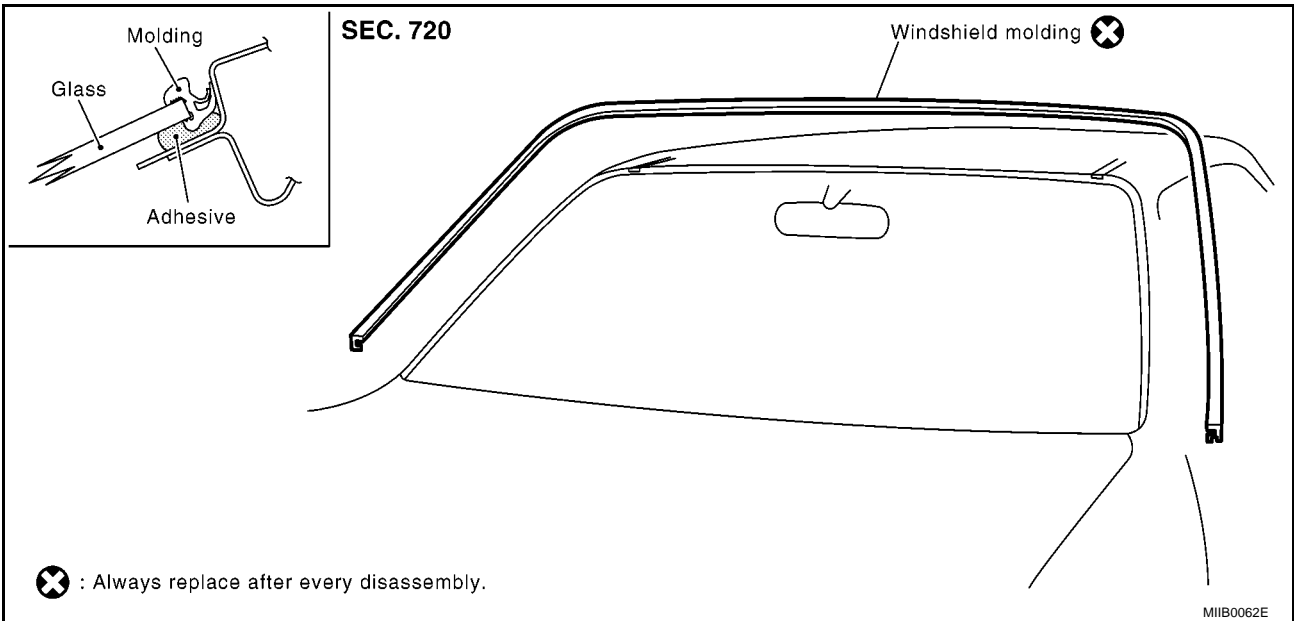

CAUTION:

Be careful when handling adhesive and primer.

REMOVAL

1. Remove cowl top cover. Refer to [EI-10, "COWL TOP"](#) in EI section.
2. Peel off double-sided tape and remove front fender covers (LH/RH) from front fenders (LH/RH).

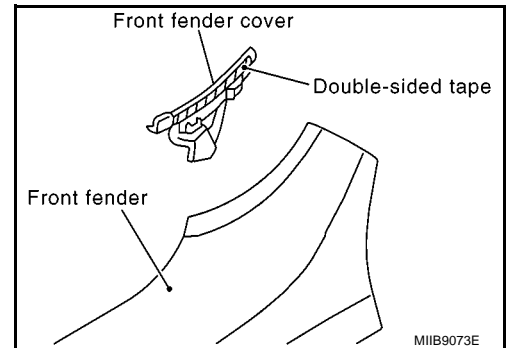

3. Apply protective tape along the contour of windshield molding and cut molding lip with cutter knife.
4. Tear off excess molding from end of molding to glass.
5. With pliers, draw out all the remaining molding left in flanged area of body to remove it completely from adhering surface on glass.

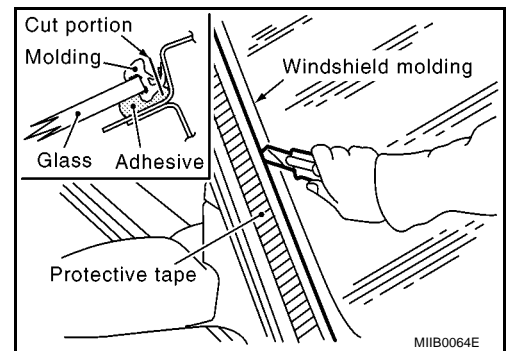

WINDSHIELD MOLDING

INSTALLATION

1. Apply primer between glass and panel then apply enough adhesive to allow molding adhesion.

NOTE:

- The essential function of primers is to strengthen adhesion between glass and painted surface.
 - There are 2 types of primer. Never confuse the application methods.
Primer M ... for painted surfaces
Primer G ... for glass
 - If primer M overflows onto a painted surface other than bonding area, quickly remove it with white gasoline.
2. Apply primer to entire perimeter of molding area shown in the figure.
 3. Align molding positioning mark (center of molding: white) with glass top edge center spacer positioning mark, push in so that molding's lower chin hooks onto glass, then continuing pushing toward the outside.

CAUTION:

After installing molding, make sure there are no non-standard conditions, such as a lip sticking out or wave in molding.

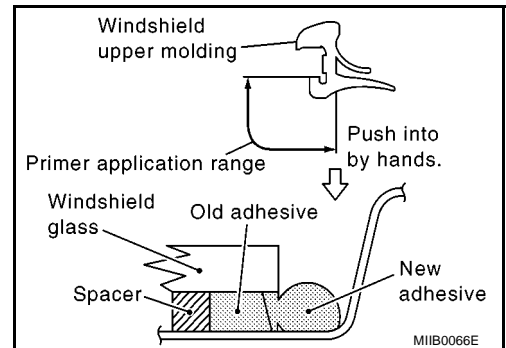
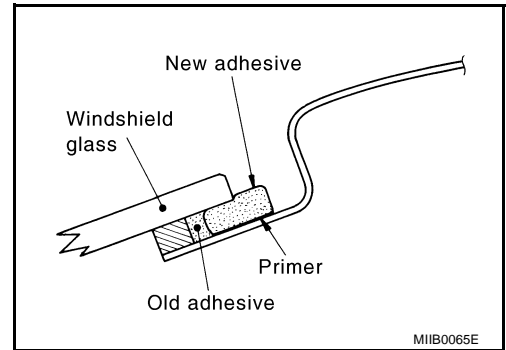

4. Remove protective tape.
5. Remove double-sided tape from front fender cover and apply primer (Sumitomo 3M K520) to double-sided tape application position shown in the figure. Then apply new double-sided tape and install front fender.

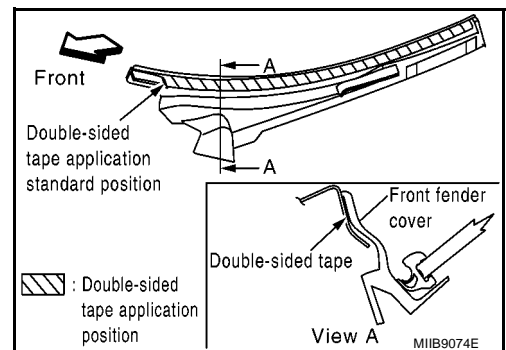

6. Install cowl top cover. Refer to [EI-10, "COWL TOP"](#) in EI section.

DOOR OUTSIDE MOLDING

DOOR OUTSIDE MOLDING

PPF:82820

Removal and Installation

EIS00407

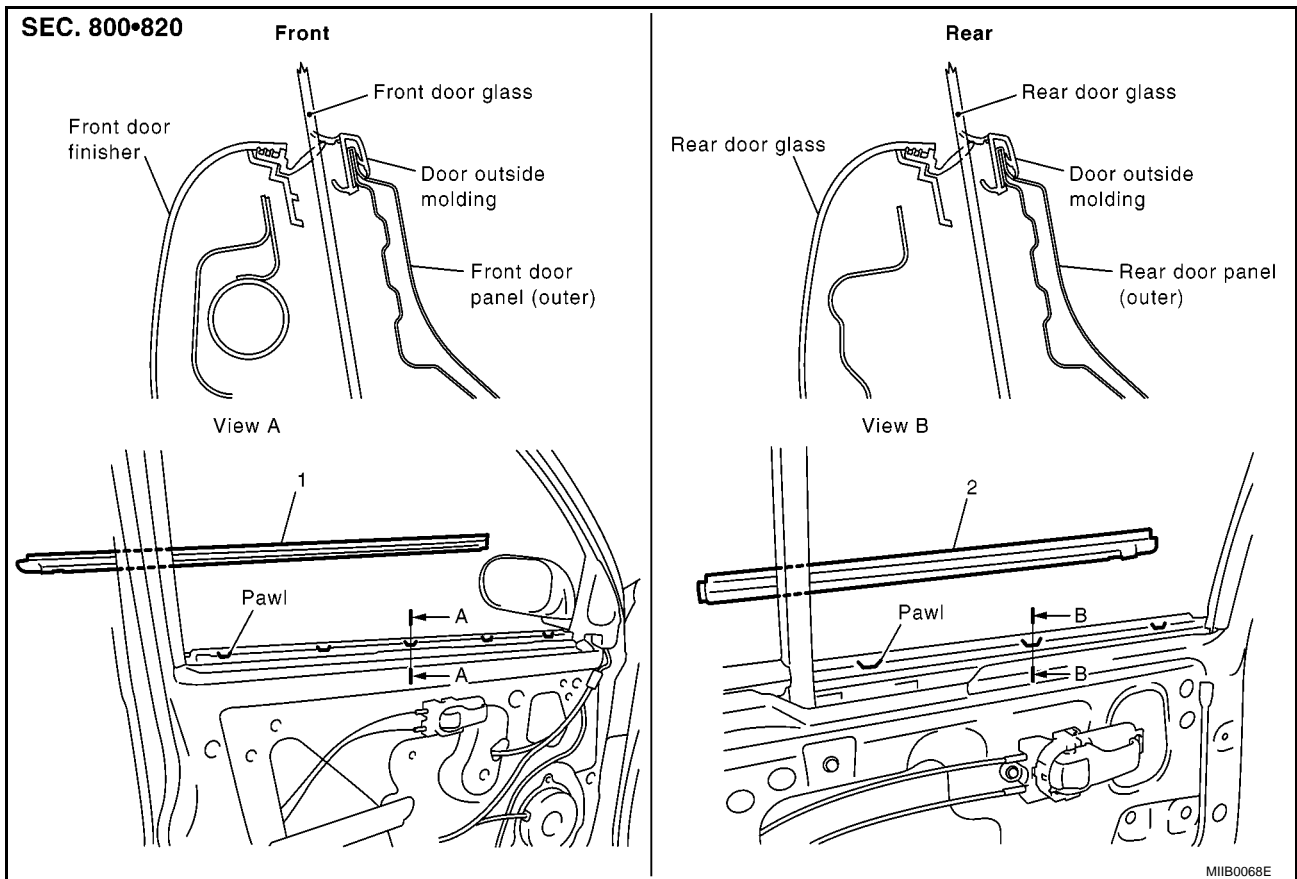

1. Front door outside molding

2. Rear door outside molding

REMOVAL

Front

1. Fully open door glass.
2. Hold molding back end straight up and release engagement with flange hooks in order of back to front.
3. After disengaging the flange hooks, with the molding back end held up, pull molding slanted backwards to remove it.

CAUTION:

After removal, visually inspect molding, and if it is deformed, replace it with new molding.

Rear

1. Fully open door glass.
2. Hold molding straight up and remove it.

CAUTION:

After removal, visually inspect molding, and if it is deformed, replace it with new molding.

INSTALLATION

Install in the reverse order of removal.

DOOR FINISHER

DOOR FINISHER

PFP:80900

Removal and Installation

EIS00408

SEC. 805•809•825•829

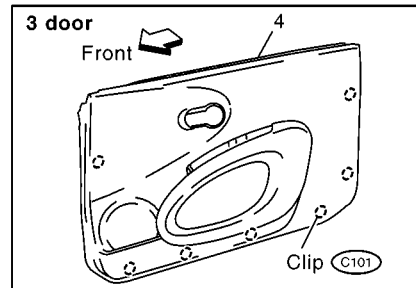
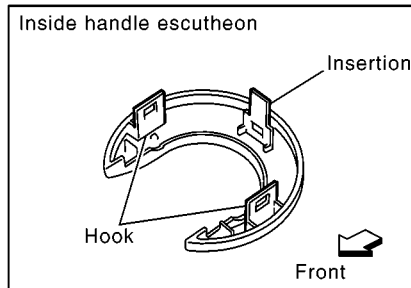
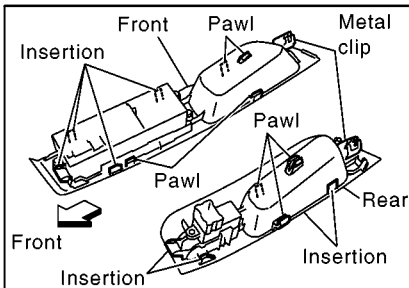
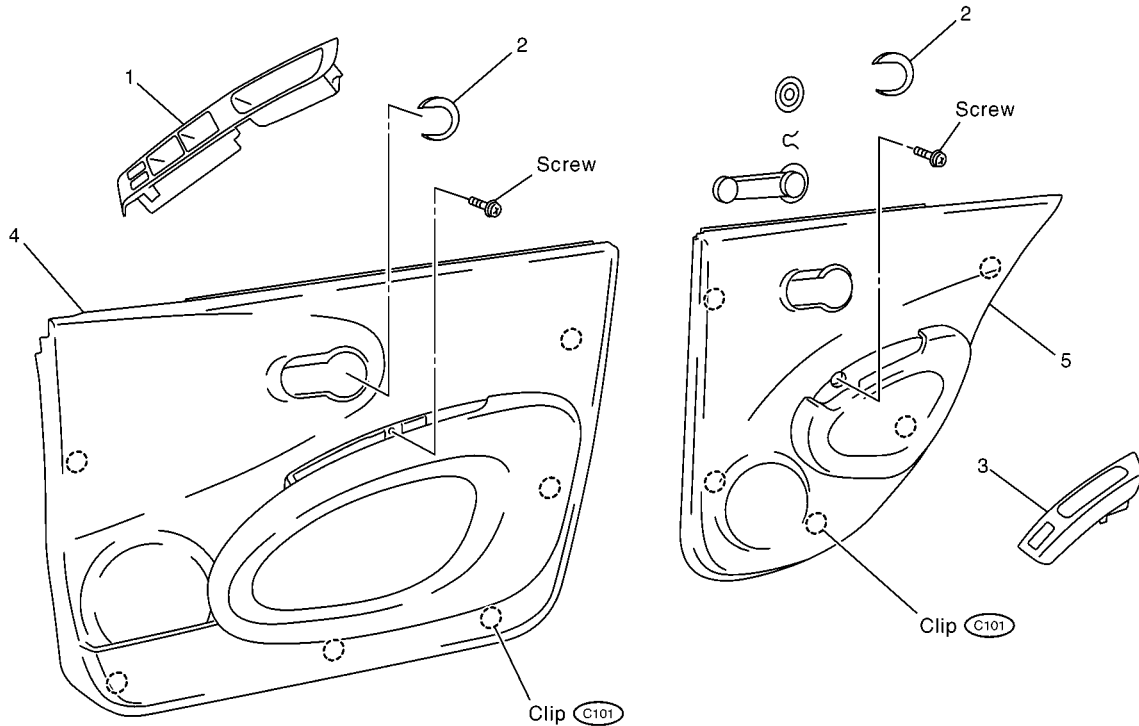

MIB0069E

1. Power window switch finisher (front door)
4. Front door finisher

2. Inside handle escutcheon
5. Rear door finisher

3. Power window switch finisher (rear door)

REMOVAL

1. Fully open door glass.
2. Pull up inside handle lever, and then spread inside handle escutcheon top and bottom to release top and bottom hooks.
3. Slide inside handle escutcheon backwards, disengage bottom, and remove from door finisher.

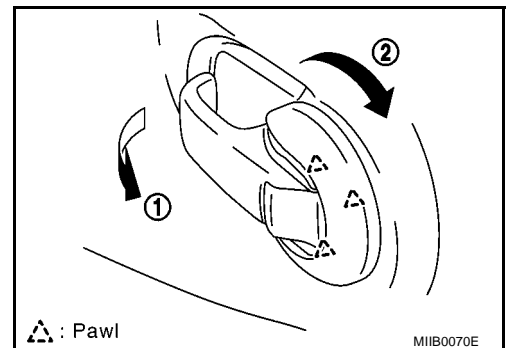

△ : Pawl

MIB0070E

DOOR FINISHER

4. Insert a screwdriver wrapped with tape into back of power window switch finisher, hold up the back end, and disengage metal clips.
5. Hold up front side, remove inserted area, and remove. Pull back rear side, remove inserted area, and remove.
6. Separate the power window switch finisher back harness connector and remove it.

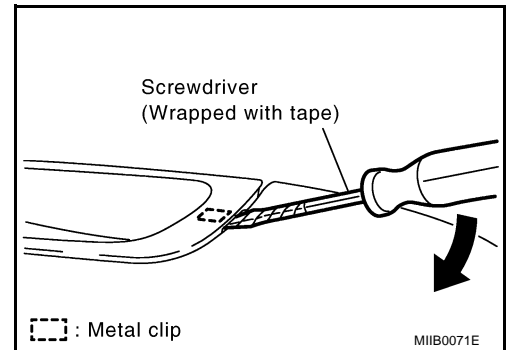

7. Remove door finisher screw.
8. Insert clip driver or clip clamp remover into door finisher back clip and remove clip.

NOTE:

Insert a clip driver or clip clamp remover into the part shown by the arrow (between the body side panel and the clips). Remove finisher.

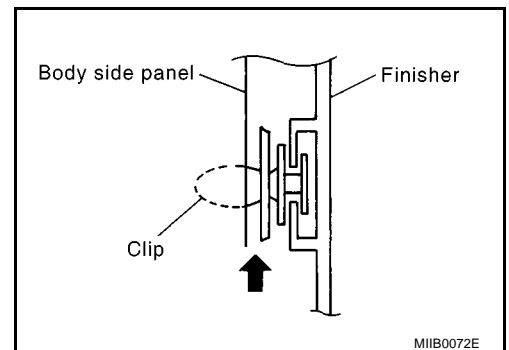

9. Pull door finisher upwards to remove it from door panel.

INSTALLATION

Note the following, and install in the reverse order of removal.

CAUTION:

When installing finisher, confirm clips are accurately aligned with the holes on body side panel, then press in.

BACK DOOR TRIM

BACK DOOR TRIM

PFP:90900

Removal and Installation

EIS00409

REMOVAL

1. Insert clip driver or clip clamp remover into back door finisher back mounting clip area and remove clip.

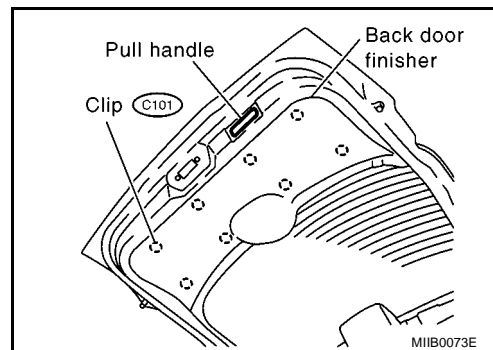

NOTE:

Insert a clip driver or clip clamp remover into the part shown by the arrow (between the clips and the body side panel). Remove clips.

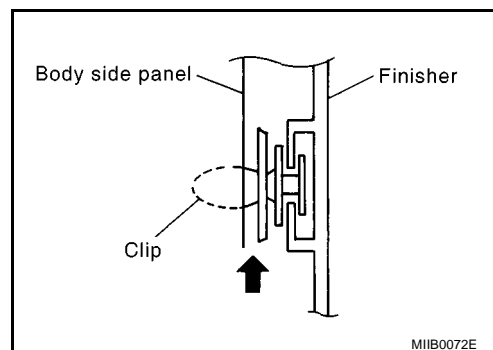

2. Pull back door finisher forward and remove it from back door.

INSTALLATION

Note the following, and install in the reverse order of removal.

CAUTION:

When installing, confirm clips are accurately aligned with the holes on body side panel, then press in.

BODY SIDE TRIM

PPF:76913

Removal and Installation (5-Door)

EIS0040A

SEC. 767

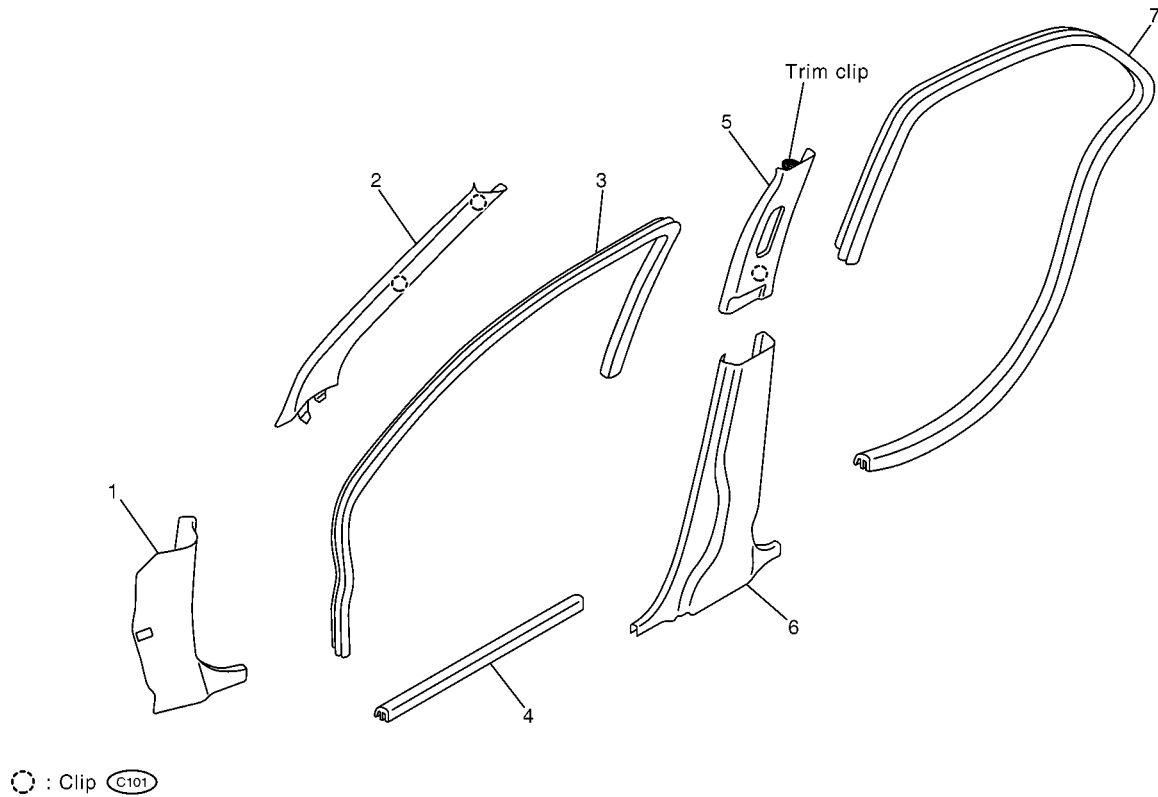

- | | | |
|---------------------------------|--------------------------------|---------------------------------|
| 1. Dashboard side finisher | 2. Front pillar garnish | 3. Front body side welt (upper) |
| 4. Front body side welt (lower) | 5. Center pillar upper garnish | 6. Center pillar lower garnish |
| 7. Rear body side welt | | |

REMOVAL

Dashboard Side Finisher

Pull dash side finisher slanted backwards to remove it.

Front Body Side Welt (Upper)

1. Remove the dashboard side finisher.
2. Remove front body side welt (upper) from vehicle.

Front Pillar Garnish

1. Remove front body side welt (upper).
2. Remove the mounting clips, pull the front pillar garnish from inside the passenger room, and remove it.

Center Pillar Lower Garnish

Spread the area engaged in the center pillar flange, remove front side first and then remove rear side in the same manner.

Center Pillar Upper Garnish

1. Remove front body side welt (upper)
2. Remove center pillar lower garnish.
3. Remove front seat belt shoulder anchor. Refer to [SB-3, "Removal and Installation of Front Seat Belt"](#) in SB section.

BODY SIDE TRIM

4. Pull center pillar upper garnish from inside passenger room, disengage clips as instructed in the figure, and remove garnish from vehicle.

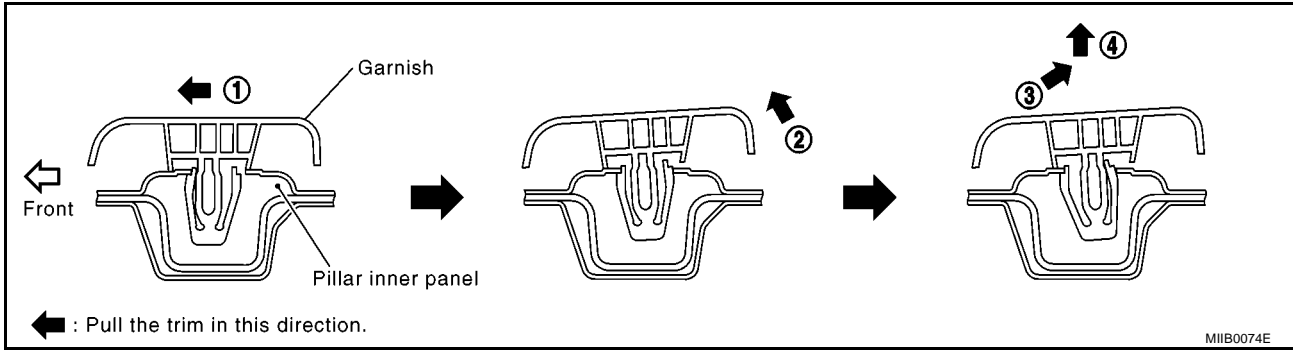

INSTALLATION

Install in the reverse order of removal.

Removal and Installation (3-Door)

EIS0040B

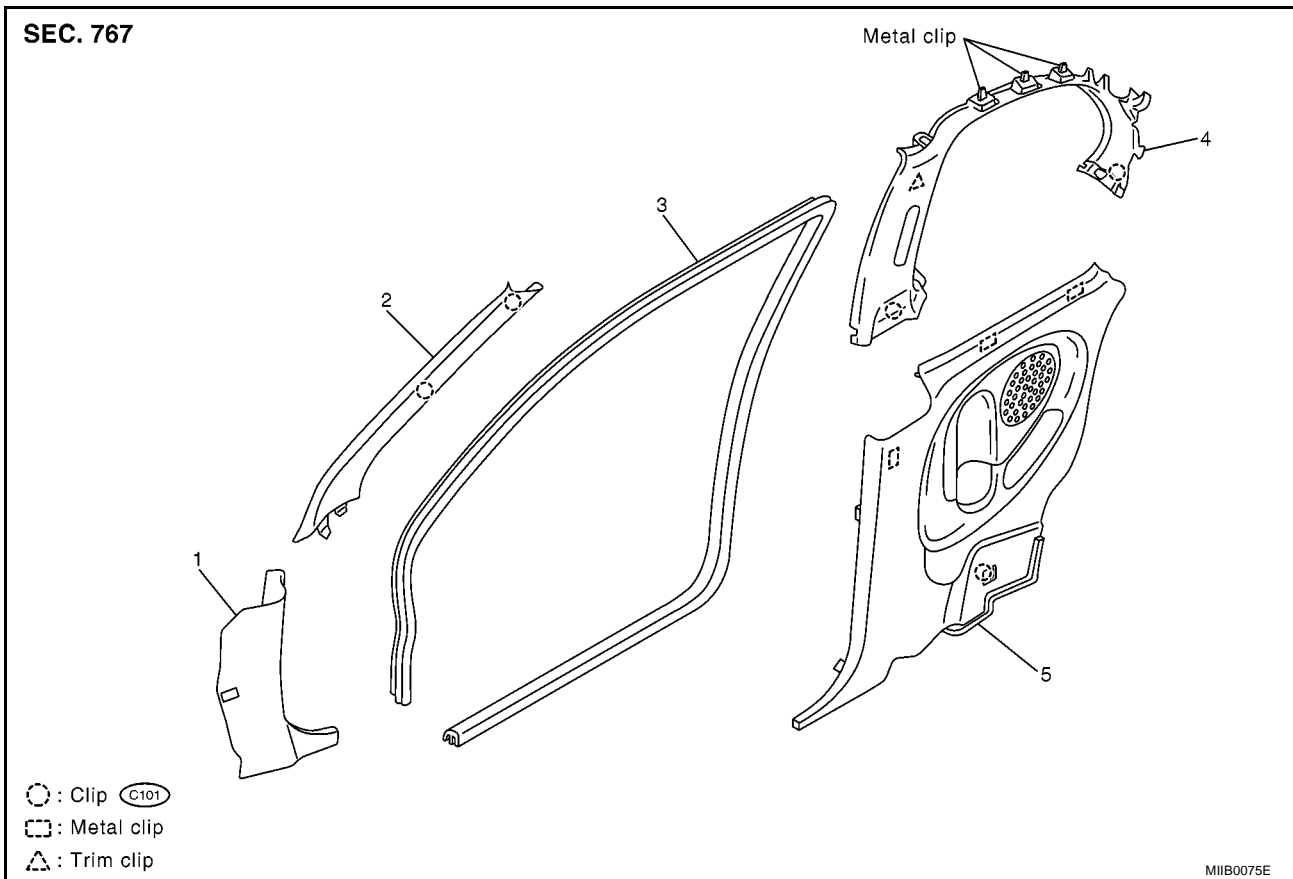

- | | | |
|------------------------------|-------------------------|-------------------|
| 1. Dashboard side finisher | 2. Front pillar garnish | 3. Body side welt |
| 4. Lock pillar upper garnish | 5. Rear side finisher | |

REMOVAL

Front Pillar Garnish

1. Remove body side welt.
2. Remove the mounting clips, pull the front pillar garnish from inside the passenger room, and remove it.

Dashboard Side Finisher

Pull dash side finisher slanted backwards to remove it.

Body Side Welt

1. Remove the dashboard side finisher.

BODY SIDE TRIM

2. Remove body side welt from vehicle.

Rear Side Finisher

1. Remove body side welt.
2. Remove rear seat cushion. Refer to [SE-11, "REAR SEAT"](#) in SE section.
3. Pull rear side finisher forward, remove mounting clips, disengage lock pillar upper garnish, and remove from vehicle.

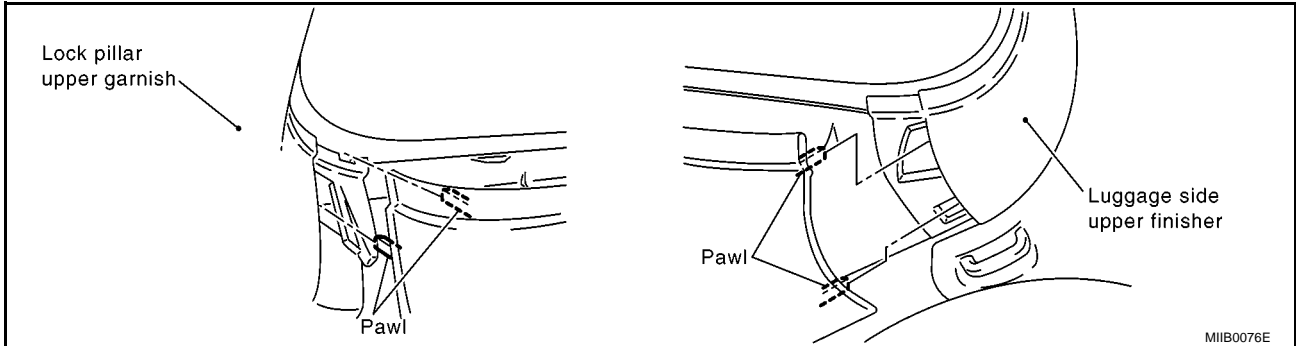

Lock Pillar Upper Garnish

1. Remove luggage side upper finisher. Refer to [EI-26, "LUGGAGE FLOOR TRIM"](#) in EI section.
2. Remove rear seat cushion. Refer to [SE-11, "REAR SEAT"](#) in SE section.
3. Remove rear side finisher.
4. Remove front seat belt shoulder anchor. Refer to [SB-3, "Removal and Installation of Front Seat Belt"](#) in SB section.
5. Disengage lock pillar upper garnish bottom clips.
6. Lower lock pillar upper garnish to bottom and disengage metal clips.
7. Pull lock pillar garnish toward passenger room, disengage clips following instructions in the figure, and remove it from vehicle.

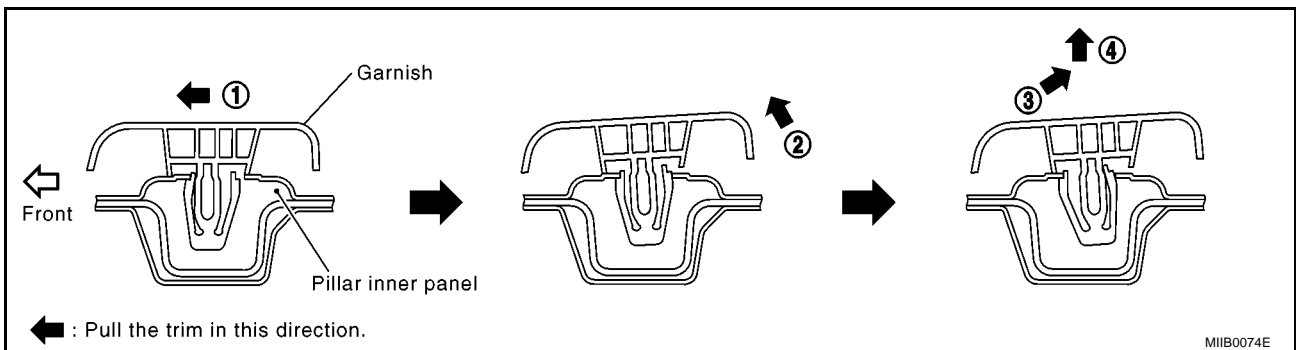

INSTALLATION

Install in the reverse order of removal.

FLOOR TRIM

FLOOR TRIM

PFP:74902

Removal and Installation

EIS0040C

SEC. 749

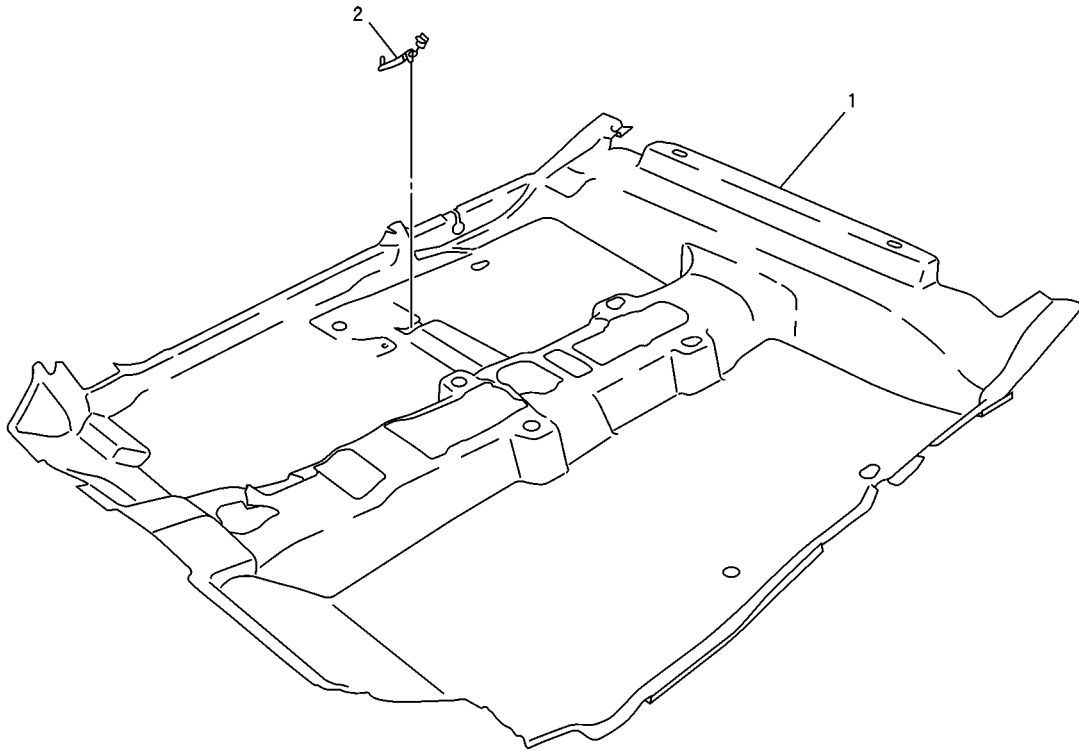

PIIA1414J

1. Floor carpet

2. Carpet hook

REMOVAL

1. Remove front seats (LH/RH) and rear seat cushion. Refer to [SE-7, "FRONT SEAT"](#) and [SE-11, "REAR SEAT"](#) in SE section.
2. Remove console box. Refer to [IP-9, "REMOVAL AND INSTALLATION OF CONSOLE BOX."](#) in IP section.
3. Remove air bag sensor unit harness connector and harness clips. Refer to [SRS-48, "DIAGNOSIS SENSOR UNIT"](#) in SRS section.
4. Remove instrument panel stay cover. Refer to [IP-5, "Removal and Installation"](#) in IP section.
5. For 5-door vehicles, remove center pillar lower garnish (LH/RH). Refer to [EI-19, "Removal and Installation \(5-Door\)"](#) in EI section.
6. For 3-door vehicles, remove rear side finishers (LH/RH) and luggage side lower finishers (LH/RH). Refer to [EI-20, "Removal and Installation \(3-Door\)"](#) and [EI-26, "LUGGAGE FLOOR TRIM"](#) in EI section.
7. Remove dash side finishers (LH/RH). Refer to [EI-19, "BODY SIDE TRIM"](#) in EI section.
8. Remove body side welts (LH/RH).
9. Remove carpet hook.
10. Remove instrument panel stay (LH).

FLOOR TRIM

11. Use a cutter knife, etc., to cut out sections 1 and 2 shown in the figure.
12. Rotate floor carpet until the cut out section 3 is visible, then cut out the section 3.
13. Remove floor carpet from vehicle.

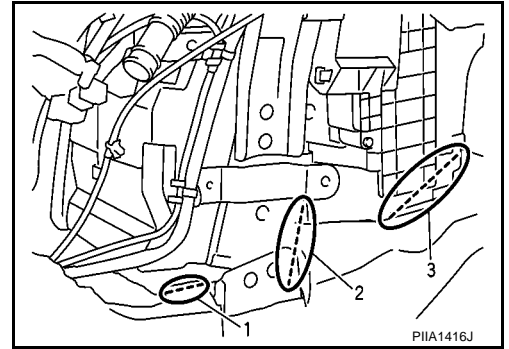

INSTALLATION

Install in the reverse order of removal.

A

B

C

D

E

F

G

H

EI

J

K

L

M

HEADLINER

HEADLINER

PFP:73910

Removal and Installation

SMA for VIN >SJN**AK12U1353780

EIS0040D

SEC. 251•738•963•964

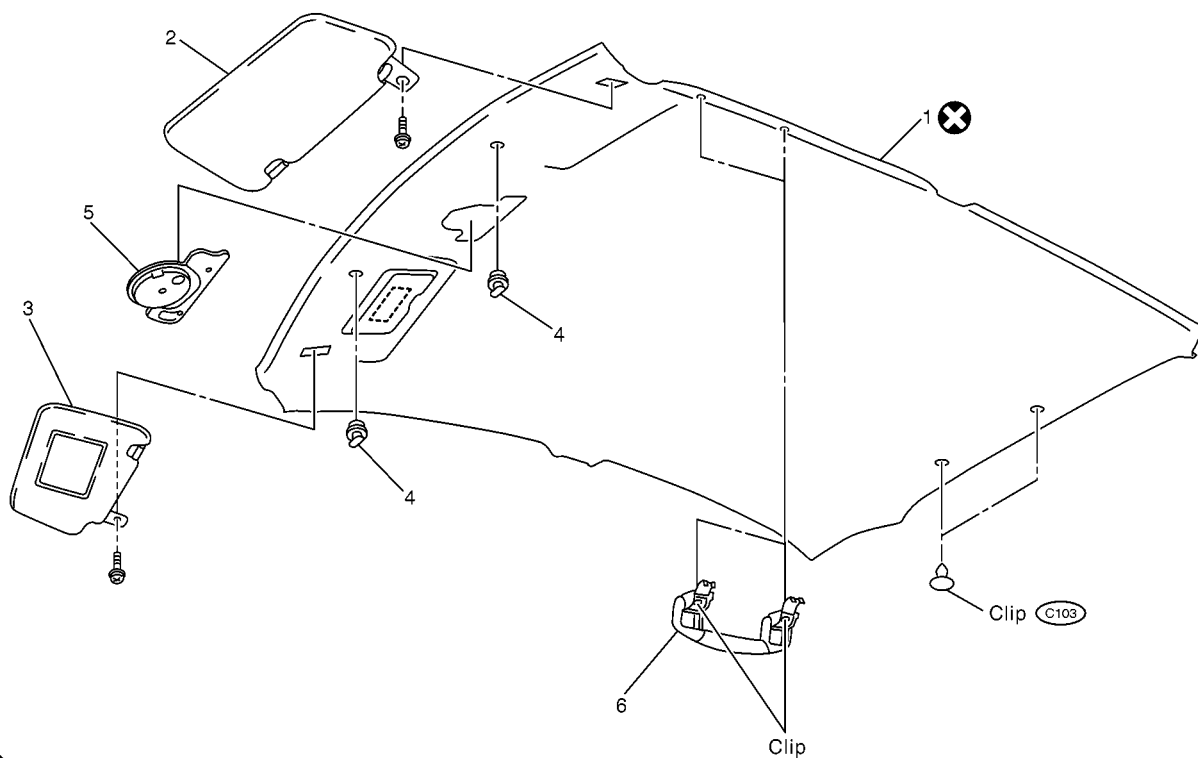

⊗ : Always replace after every disassembly.

MIIB0077E

- | | | |
|--------------------|---------------------------------------|---------------------------------|
| 1. Headliner | 2. Sunvisor (LH) | 3. Sunvisor (RH) |
| 4. Sunvisor holder | 5. Room lamp (with map lamp function) | 6. Assist grip (passenger seat) |

REMOVAL

1. Remove front pillar garnish. Refer to [EI-19, "BODY SIDE TRIM"](#) in EI section.
2. Remove back door weatherstrip.
3. Remove luggage side upper finishers (LH/RH). Refer to [EI-26, "LUGGAGE FLOOR TRIM"](#) in EI section.
4. Remove center pillar upper garnish (5-door vehicles) and lock pillar upper garnish (3-door vehicles). Refer to [EI-19, "BODY SIDE TRIM"](#) in EI section.
5. Remove assist grip.

NOTE:

When removing assist grip, insert a thin screwdriver, etc., into the clip and move the clip outside.

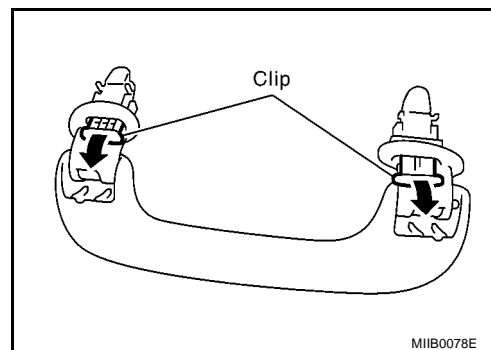

MIIB0078E

6. Remove sunvisors (LH/RH).
7. Remove room lamp (with map lamp function). Refer to [LT-229, "Removal and Installation"](#) in LT section.

HEADLINER

8. Remove sunvisor holder.

NOTE:

Insert a screwdriver into the cutout and rotate 90° to remove.

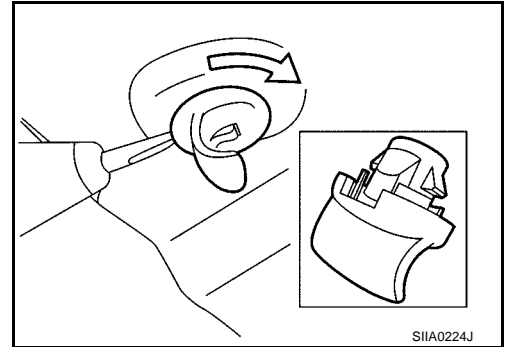

9. Remove vehicle rear clips.
10. Peel off headliner adhesive and remove headliner from back door opening.

CAUTION:

The roof panel could be deformed, so do not strongly pull the headliner.

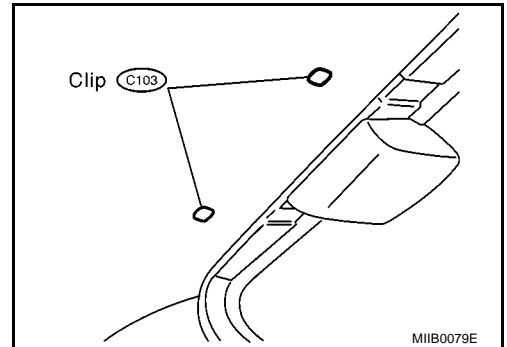

INSTALLATION

1. Remove any adhesive left on the vehicle side.
2. Apply adhesive to headliner.

Adhesive:

Yokohama Rubber Hammer Tight
YM-21

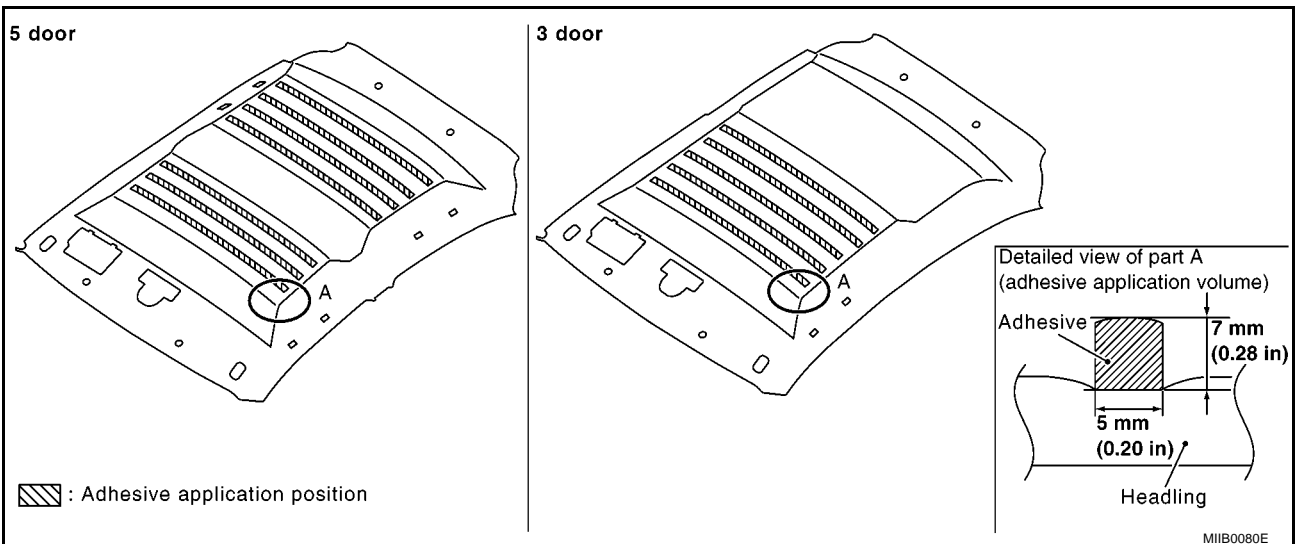

3. Move front seats (LH/RH) toward front of vehicle, and fix headrests (LH/RH) in top position.
4. Place the headliner front section on the headrest and fasten the headliner rear section with the clips.
5. After installing sunvisor holder, install in the reverse order of removal.

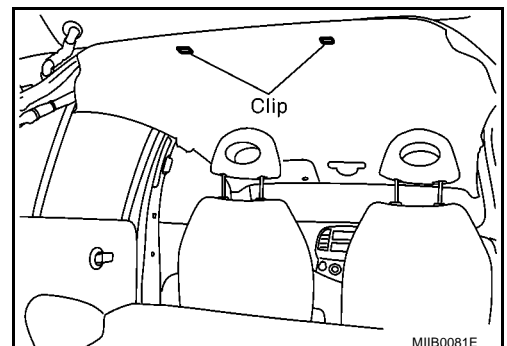

LUGGAGE FLOOR TRIM

LUGGAGE FLOOR TRIM

PFP:84999

Removal and Installation

EIS0040E

SEC. 849

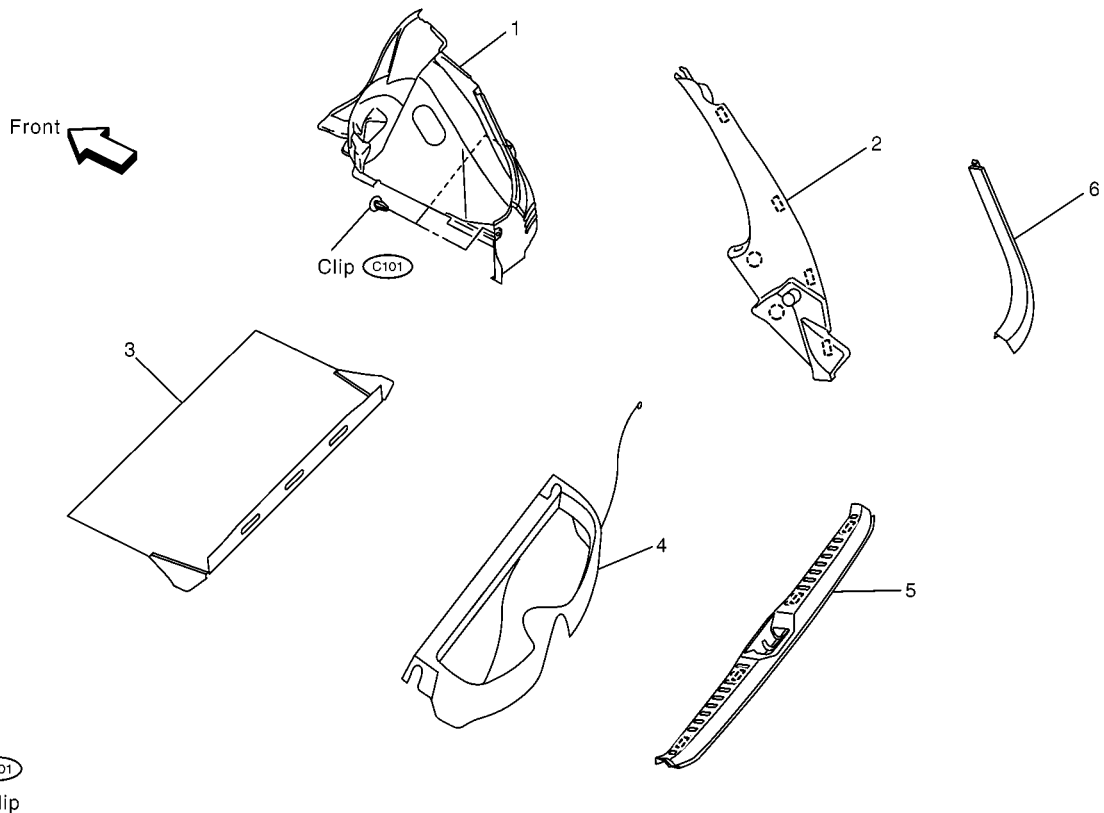

REMOVAL

Luggage Side Upper Finisher

1. Remove rear parcel shelf finisher.
2. Remove back door weather strip.
3. For 5-door vehicles, remove plastic clips and metal clips in order from luggage side upper finisher bottom.
4. For 3-door vehicles, remove the plastic clips and metal clips in order from luggage side upper finisher bottom, pull finisher straight forward, and disengage from lock pillar upper garnish.

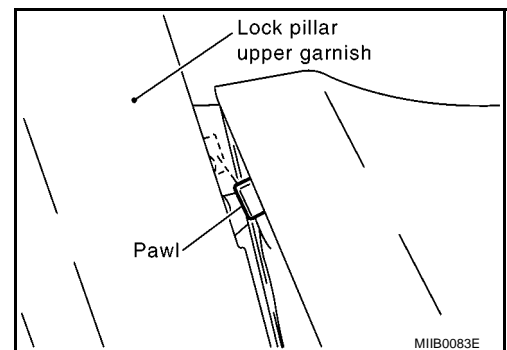

LUGGAGE FLOOR TRIM

5. Remove headliner insert, and remove luggage side upper finisher.

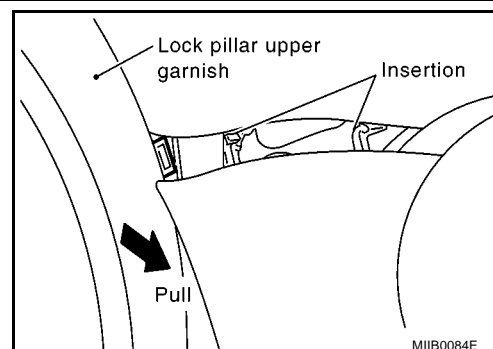

Luggage Side Lower Finisher (5-Door Vehicles)

1. Remove rear body side welt.
2. Remove luggage side upper finisher and luggage rear kickplate. Refer to [EI-19, "BODY SIDE TRIM"](#) and [EI-26, "LUGGAGE FLOOR TRIM"](#) in EI section.
3. Remove rear seat cushion and rear seatback. Refer to [SE-11, "REAR SEAT"](#) in SE section.
4. Remove mounting clips and then remove luggage side lower finisher.

Luggage Side Lower Finisher (3-Door Vehicles)

1. Remove body side welt.
2. Remove luggage side upper finisher and luggage rear kickplate. Refer to [EI-20, "Removal and Installation \(3-Door\)"](#) and [EI-26, "LUGGAGE FLOOR TRIM"](#) in EI section.
3. Remove rear seat cushion and rear seatback. Refer to [SE-11, "REAR SEAT"](#) in SE section.
4. Remove rear side finisher. Refer to [EI-20, "Removal and Installation \(3-Door\)"](#) in EI section.
5. Remove mounting clips and then remove luggage side lower finisher.

Luggage Rear Plate

1. Remove back door weather strip.
2. Hold up luggage rear plate, disengage metal clips, and remove plate.

Luggage Rear Kickplate

1. Remove rear parcel shelf finisher.
2. Remove back door weather strip.
3. Remove luggage rear plate.
4. Remove luggage side upper finisher.
5. Remove luggage rear kickplate.

INSTALLATION

Install in the reverse order of removal.

LUGGAGE FLOOR TRIM
