

SECTION

SE

SEAT

A

B

C

CONTENTS

E

PRECAUTIONS	2	SEATBACK TRIM PAD	8	F
Precautions for Supplemental Restraint System (SRS) “AIR BAG” and “SEAT BELT PRE-TENSIONER”	2	SEATBACK FRAME	9	
Precautions	2	Disassembly and Assembly of Seat Cushion	9	
CLIP AND FASTENER	3	SEAT CUSHION TRIM PAD	9	G
List of Table	3	SEAT CUSHION FRAME	9	
HEATED SEAT	4	REAR SEAT	11	
Description	4	Component Parts Location	11	H
Wiring Diagram — H/SEAT	5	BENCH SEAT	11	
FRONT SEAT	7	SPLIT SEAT	12	
Component Parts Location	7	SLIDE SEAT	13	
Removal and Installation	8	Removal and Installation	13	SE
REMOVAL	8	REMOVAL	13	
INSTALLATION	8	INSTALLATION	15	
Disassembly and Assembly of Seatback	8	REAR SEATBACK DISASSEMBLY AND ASSEMBLY	16	J

K

L

M

PRECAUTIONS

PRECAUTIONS

PFP:00001

Precautions for Supplemental Restraint System (SRS) “AIR BAG” and “SEAT BELT PRE-TENSIONER”

EIS004P3

The Supplemental Restraint System such as “AIR BAG” and “SEAT BELT PRE-TENSIONER”, used along with a front seat belt, helps to reduce the risk or severity of injury to the driver and front passenger for certain types of collision. Information necessary to service the system safely is included in the SRS and SB section of this Service Manual.

WARNING:

- To avoid rendering the SRS inoperative, which could increase the risk of personal injury or death in the event of a collision which would result in air bag inflation, all maintenance must be performed by an authorized NISSAN/INFINITI dealer.
- Improper maintenance, including incorrect removal and installation of the SRS, can lead to personal injury caused by unintentional activation of the system. For removal of Spiral Cable and Air Bag Module, see the SRS section.
- Do not use electrical test equipment on any circuit related to the SRS unless instructed to in this Service Manual. SRS wiring harnesses can be identified by yellow and/or orange harness connectors.

Precautions

EIS004P4

- When removing or disassembling any part, be careful not to damage or deform it. Protect parts, which may get in the way with cloth.
- When removing parts with a screwdriver or other tool, protect parts by wrapping them with vinyl or tape.
- Keep removed parts protected with cloth.
- If a clip is deformed or damaged, replace it.
- If an unreusable part is removed, replace it with a new one.
- Tighten bolts and nuts firmly to the specified torque.
- After re-assembly has been completed, make sure each part functions correctly.
- Remove stains in the following way.

Water-soluble stains:

Dip a soft cloth in warm water, and then squeeze it tightly. After wiping the stain, wipe with a soft dry cloth.

Oil stain:

Dissolve a synthetic detergent in warm water (density of 2 to 3% or less), dip the cloth, then clean off the stain with the cloth. Next, dip the cloth in fresh water and squeeze it tightly. Then clean off the detergent completely. Then wipe the area with a soft dry cloth.



- Do not use any organic solvent, such as thinner or benzene.

CLIP AND FASTENER

PFP:76906

List of Table

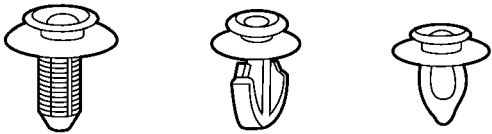
EIS0040N

Symbol No.	Shapes	Removal & Installation
C101 		Removal: Remove by bending up with flat-bladed screwdrivers or clip remover. 

MIB0032E

A

B

C

D

E

F

G

H

SE

J

K

L

M

HEATED SEAT

HEATED SEAT

PFP:87335

Description

EIS004P5

- When handling seat, be extremely careful not to scratch heating unit.
- To replace heating unit, seat trim and pad should be separated.
- Do not use any organic solvent, such as thinner, benzene, alcohol, etc. to clean trims.

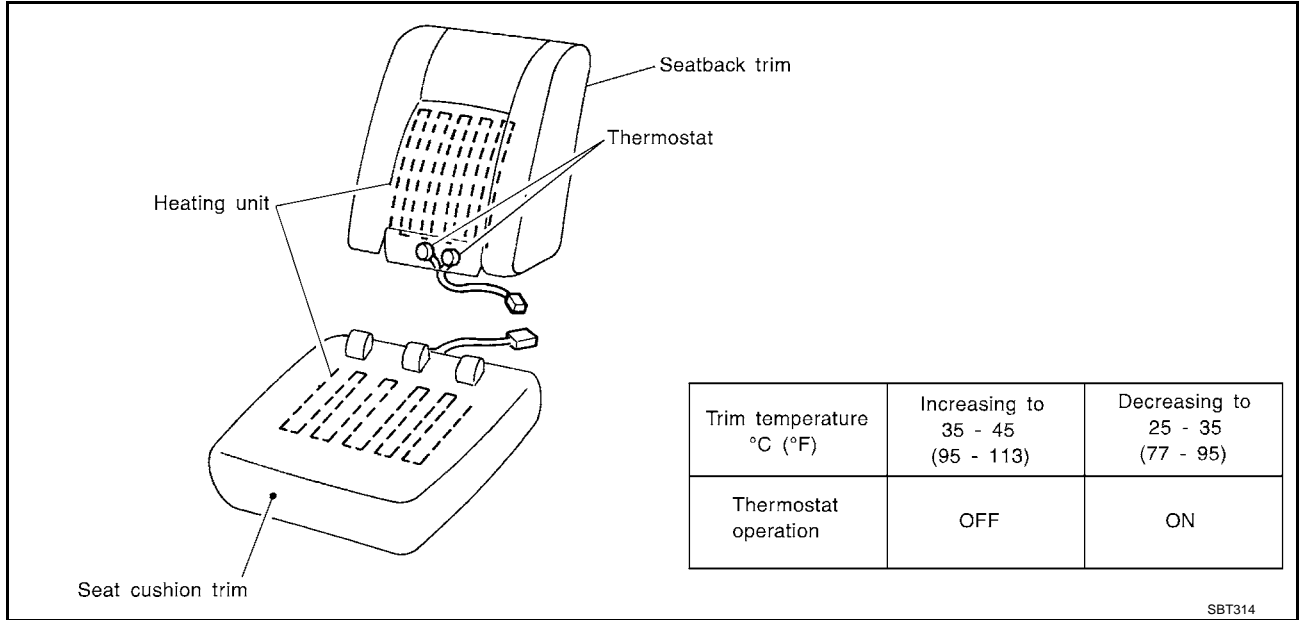

HEATED SEAT

Wiring Diagram — H/SEAT

EIS004P6

SE-H/SEAT-01

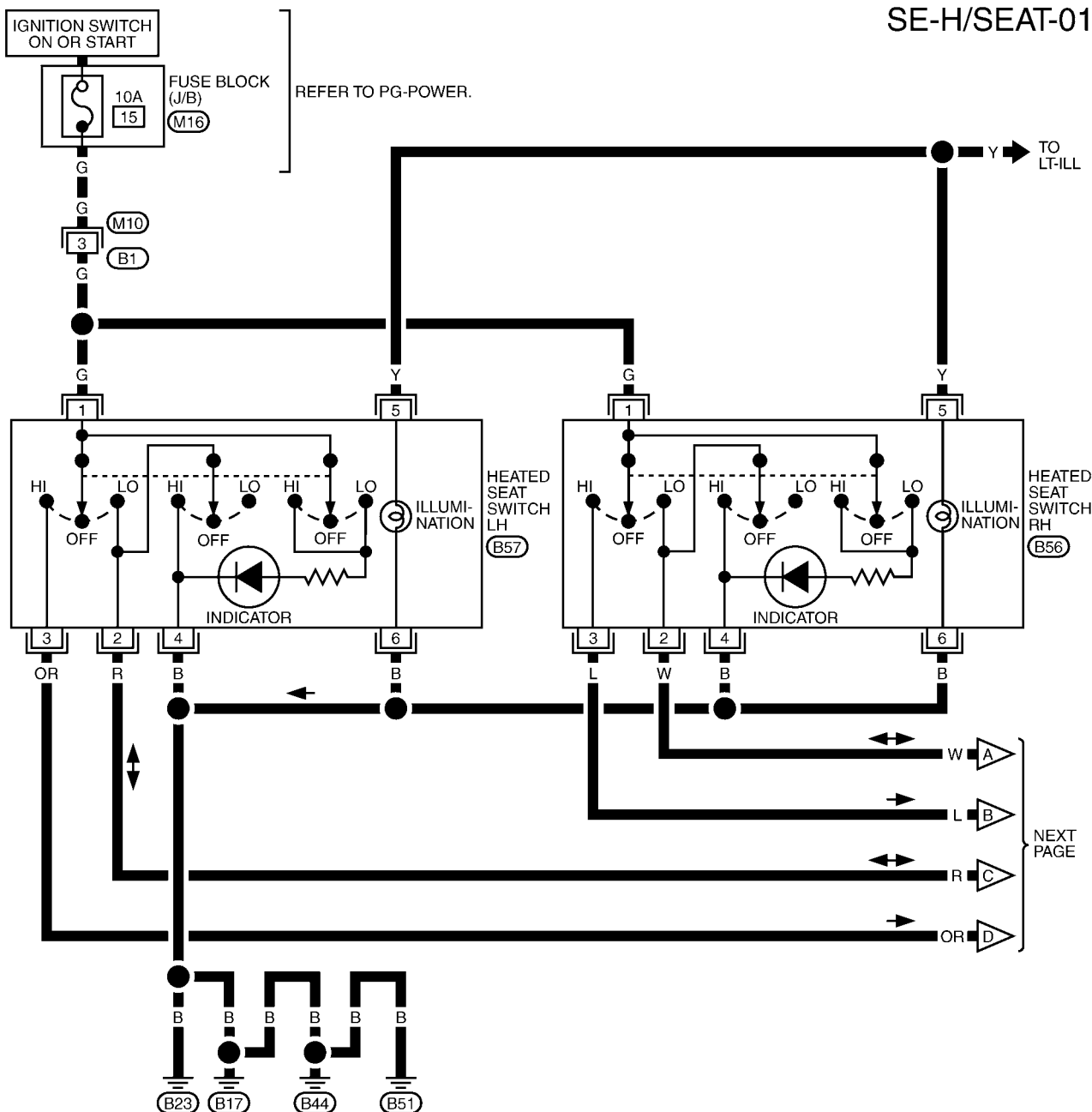

1	2		3	4	
5	6	7	8	9	10

M10

W

6		5
3	1	2

B56
BB

B57
W

REFER TO THE FOLLOWING.
(M16) -FUSE BLOCK-
JUNCTION BOX (J/B)

HEATED SEAT

SE-H/SEAT-02

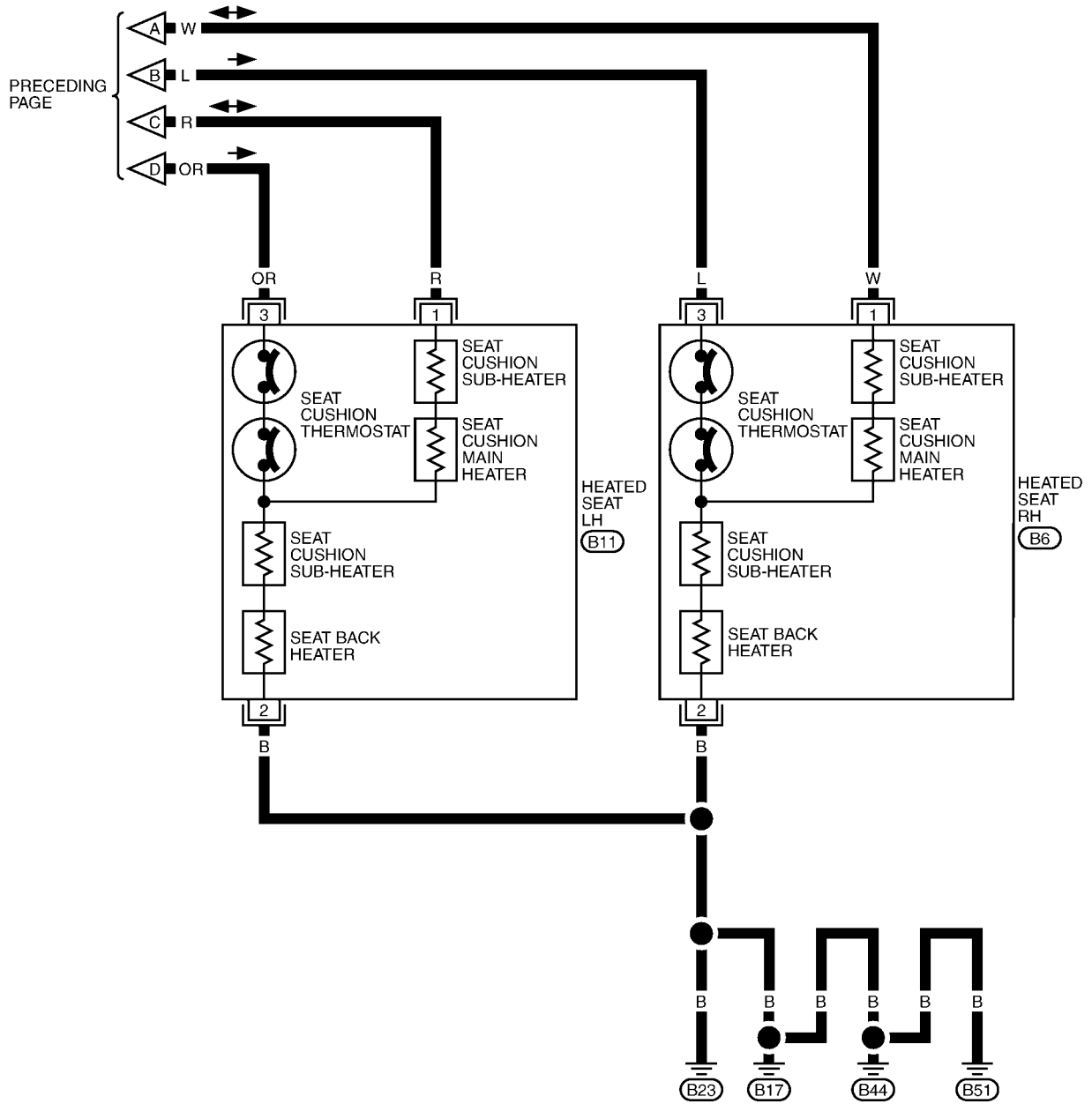

1	B6	B11
2	W	W
3		

MKWA0836E

FRONT SEAT

FRONT SEAT

PFP:87000

Component Parts Location

EIS0040P

CAUTION:

When removing and installing seats, use shop cloths to protect the parts from damage.

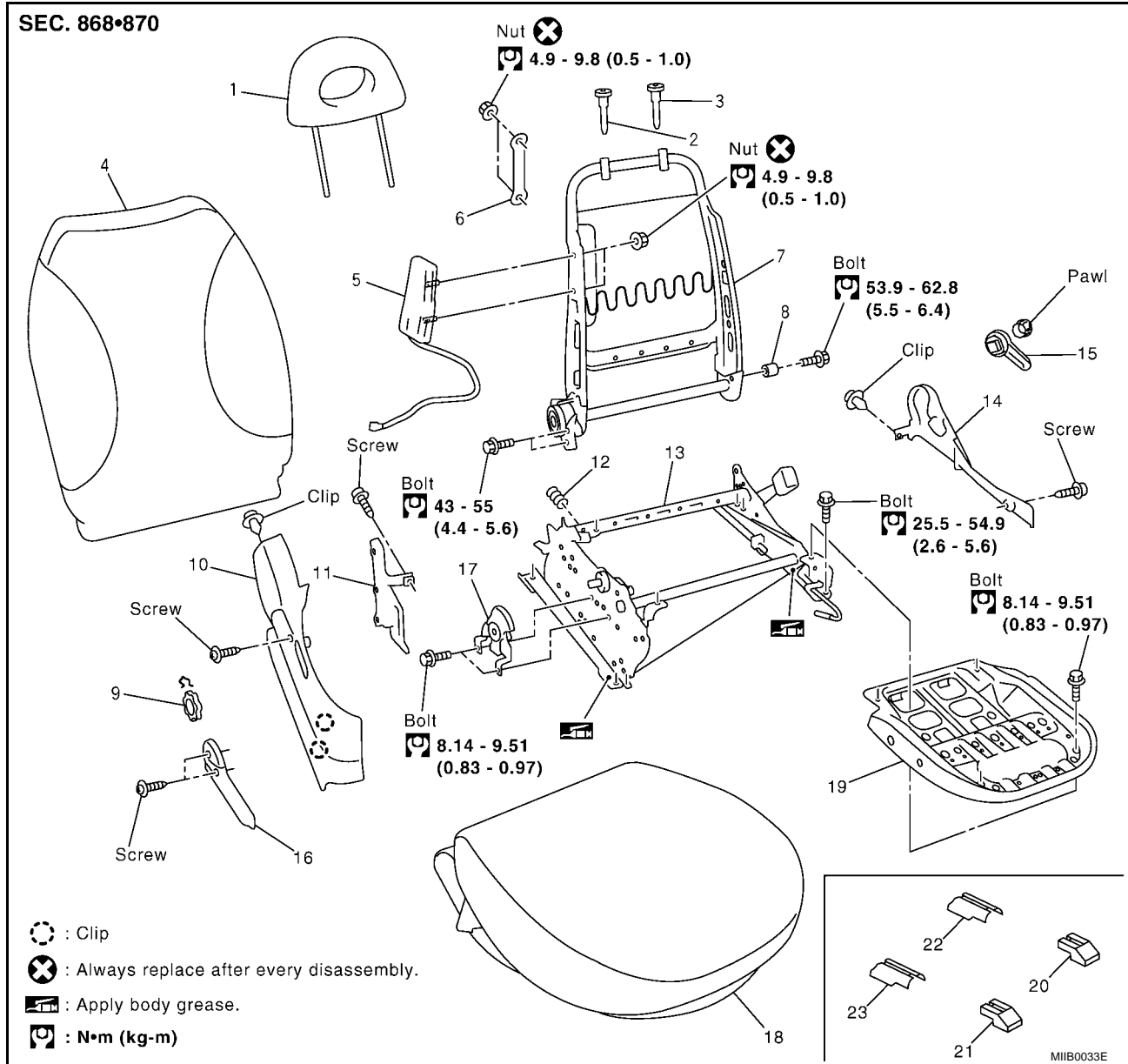

- | | | |
|-------------------------------|-------------------------------|-------------------------------|
| 1. Headrest | 2. Headrest holder (free) | 3. Headrest holder (locked) |
| 4. Seatback trim & pad | 5. Side air bag module | 6. Fixed inner cross rod |
| 7. Seatback frame | 8. Plastic collar | 9. Reclining dial |
| 10. Seat slide outer finisher | 11. Slide inner cover | 12. Spring |
| 13. Seat slide assembly | 14. Seat slide inner finisher | 15. Lumber support lever knob |
| 16. Seat lifter lever | 17. Seat lifter lever bracket | 18. Seat cushion trim & pad |
| 19. Seat cushion frame | 20. Front leg cover (inner) | 21. Front leg cover (outer) |
| 22. Rear leg cover (inner) | 23. Rear leg cover (outer) | |

FRONT SEAT

Removal and Installation

EIS0040Q

REMOVAL

CAUTION:

For vehicles equipped with side air bags, disconnect the battery negative terminal, and wait at least 3 minutes before beginning work.

1. Remove side air bag module connector (vehicles with side air bags) and seatbelt buckle switch harness connector.
2. Remove front and rear leg covers.
3. Remove bolts (4), and remove seat from vehicle.

CAUTION:

When removing and installing, use shop cloths to protect parts from damage and interference.

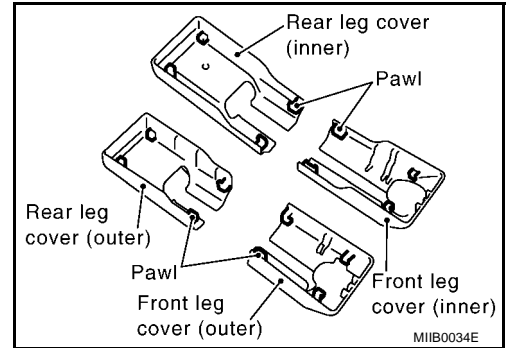

INSTALLATION

Install in the reverse order of removal.

CAUTION:

When removing and installing, use shop cloths to protect parts from damage and interference.

Disassembly and Assembly of Seatback SEATBACK TRIM PAD

EIS0040R

Disassembly

1. Unfasten seatback fastener. (Vehicles with side air bags)
2. Remove retainer.

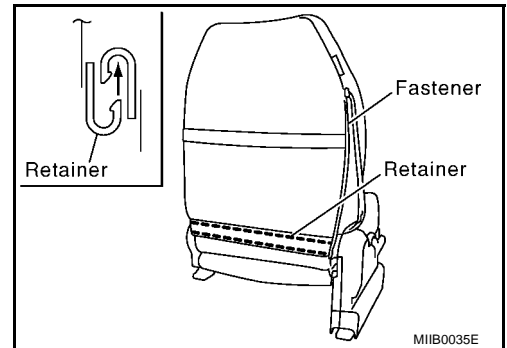

3. Turn over seatback trim, remove nuts (2), and remove fixed inner cross rod. (Vehicles with side air bags)

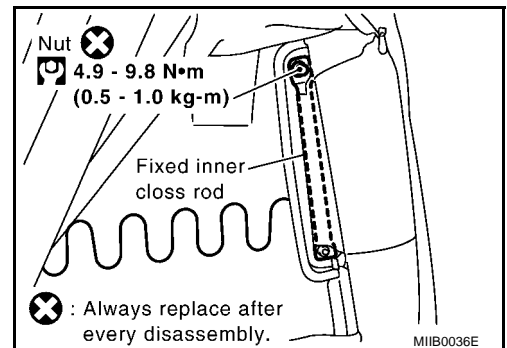

FRONT SEAT

4. Use pincers, etc., to push up hooks shown by the arrows in the figure, and remove headrest holder from seatback.
5. Remove seatback trim and pad from seatback frame.

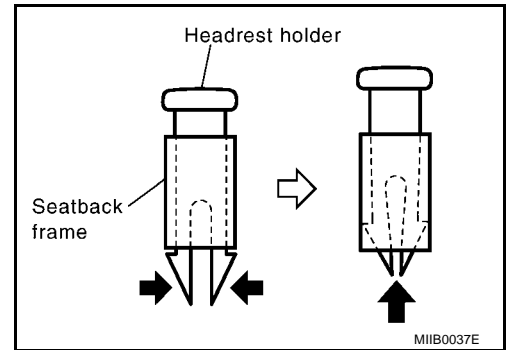

Assembly

Install in the reverse order of removal.

CAUTION:

Before installing headrest holder, check its orientation (front/rear and right/left).

SEATBACK FRAME

Disassembly

1. Remove seatback trim&pad.
2. Pull out side air bag connector from back of seat cushion.
3. Remove lumbar support lever knob, seat lifter lever, reclining dial, seat slide out finisher, slide inner cover, and seat slide inner finisher.
4. Remove seatback frame bolts and remove seatback frame from seat slide assembly.

Assembly

Install in the reverse order of removal.

CAUTION:

After assembling seatback frame, make sure reclining device operates.

Disassembly and Assembly of Seat Cushion

SEAT CUSHION TRIM PAD

Disassembly

1. Remove seat lifter cover, seat lifter lever, reclining lever, seat slide out finisher, slide inner cover, and seat slide inner finisher.
2. Remove seatback frame bolts, and the remove seat cushion assembly from seatback frame
3. Remove retainer from the back of cushion.
4. Remove seat cushion trim&pad from seat cushion frame.

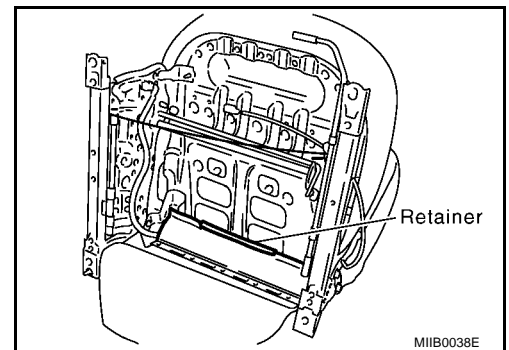

Assembly

Install in the reverse order of removal.

CAUTION:

When assembling seat cushion assembly in seatback assembly, make sure the reclining device operates.

SEAT CUSHION FRAME

Disassembly

1. Remove short cushion trim&pad.
2. Remove bolts (4), and then remove seat cushion frame from seat slide assembly.

FRONT SEAT

Assembly

Install in the reverse order of removal.

REAR SEAT

REAR SEAT

PFP:88300

Component Parts Location BENCH SEAT

EIS0040T

A
B
C
D
E
F
G
H
SE
J
K
L
M

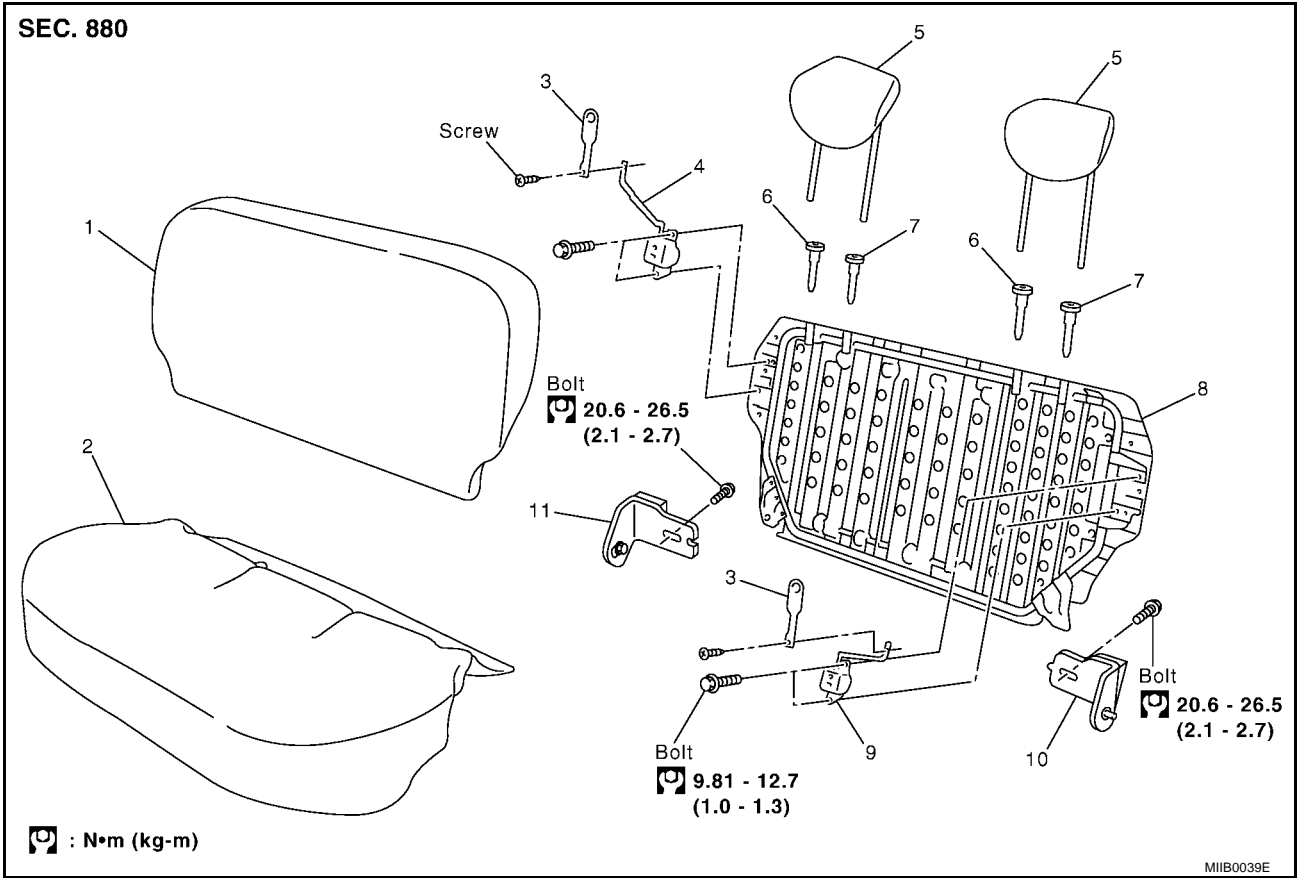

- | | | |
|---------------------------------|---------------------------------|---------------------------|
| 1. Rear seatback trim and pad | 2. Seat cushion trim and pad | 3. Seatback lock knob |
| 4. Rear seat lock (RH) | 5. Headrest | 6. Headrest holder (free) |
| 7. Headrest holder (locked) | 8. Seatback frame | 9. Rear seat lock (LH) |
| 10. Rear seat side bracket (LH) | 11. Rear seat side bracket (RH) | |

REAR SEAT

SPLIT SEAT

SEC. 880

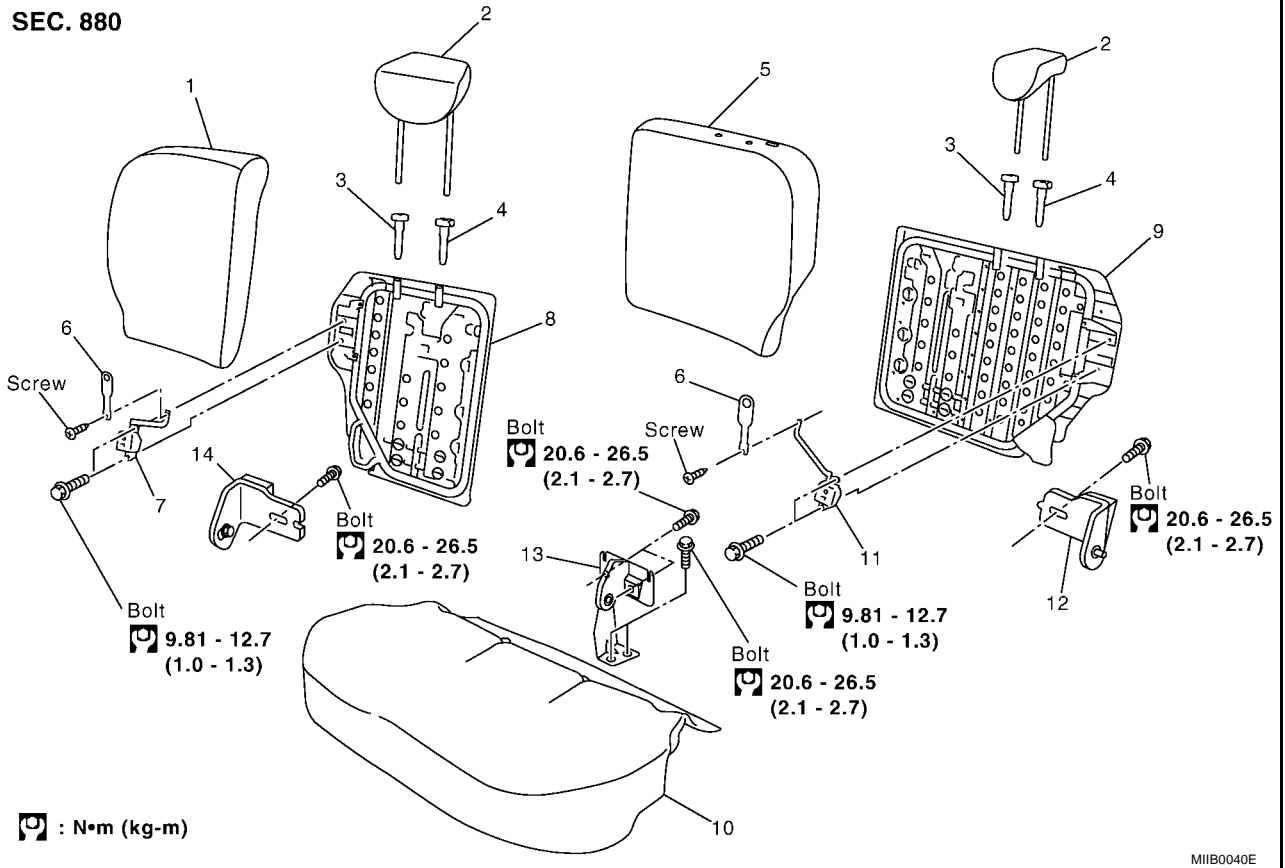

M11B0040E

- | | | |
|------------------------------------|------------------------------------|---------------------------------|
| 1. Rear seatback trim and pad (RH) | 2. Headrest | 3. Headrest holder (free) |
| 4. Headrest holder (locked) | 5. Rear seatback trim and pad (LH) | 6. Seatback lock knob |
| 7. Rear seat lock (RH) | 8. Rear seatback frame (RH) | 9. Rear seatback frame (LH) |
| 10. Rear seat cushion assembly | 11. Rear seat lock (LH) | 12. Rear seat side bracket (LH) |
| 13. Rear center bracket (RH) | 14. Rear seat side bracket (RH) | |

REAR SEAT

SLIDE SEAT

SEC. 880

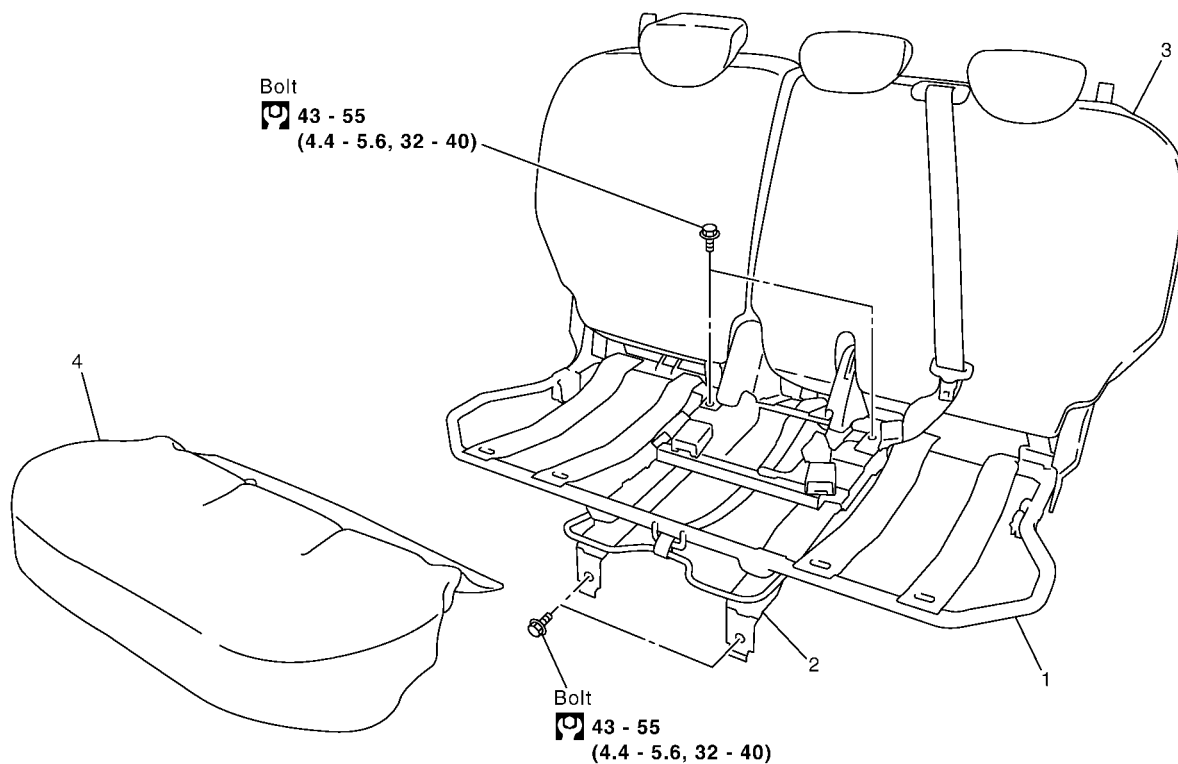

: N·m (kg-m, ft-lb)

MIIB0042E

1. Seat slide assembly
2. Slide rail
3. Rear seatback trim and pad
4. Seat cushion trim and pad

Removal and Installation

REMOVAL

Seat Cushion

- Lift up seat cushion bottom, remove wire from plastic hooks (2 locations), and pull forward to remove.

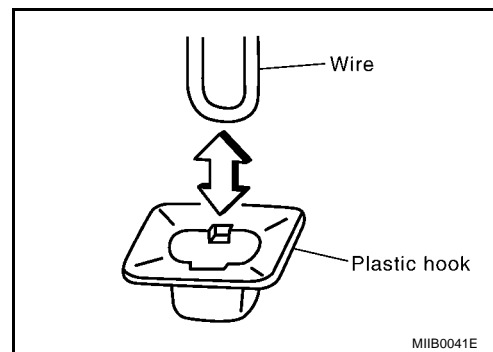

Seatback (Bench Seat)

- Turn over rear seatback carpet, remove rear seat side bracket bolts (2), and remove seatback from vehicle.

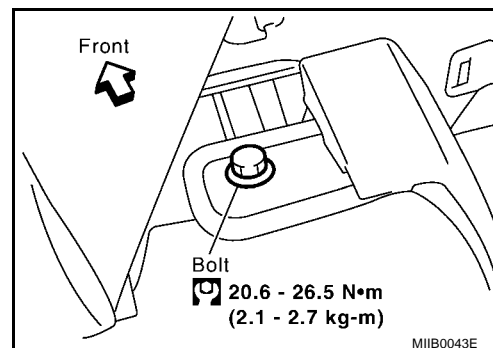

REAR SEAT

seatback (Split Seat)

1. Turn over rear seatback carpet, remove side bracket bolts (2), and remove seatback from vehicle.

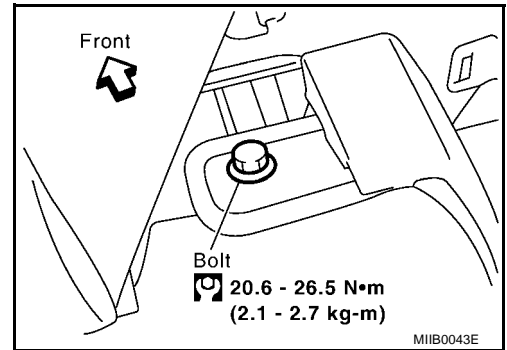

2. Turn over rear seatback carpet, remove center bracket seatback bolts (2), and remove.

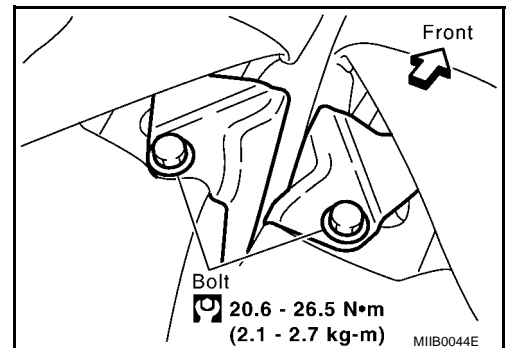

Rear Seat Side Bracket

1. Remove seat cushion and rear seatback.
2. Remove bolts (1 at LH/RH each), and remove rear seat side brackets (LH/RH) from vehicle.

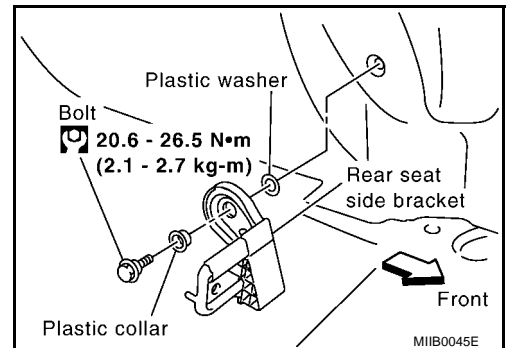

Rear Seat Center Bracket

1. Remove rear seat cushion and rear seatback.
2. Remove bolts (two), and then remove rear seat center bracket from vehicle.

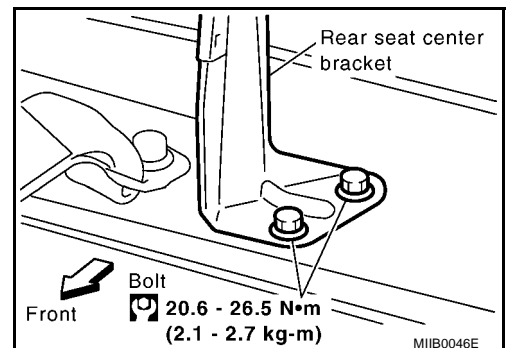

Child Car Seat Anchor That Complies With ISO FIX

1. Remove seat cushion.

REAR SEAT

2. Remove bolts (1 at LH/RH each), and then remove child car seat anchors that complies with ISO FIX (LH/RH) from vehicle.

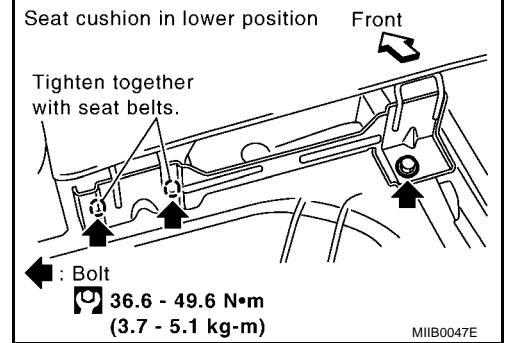

INSTALLATION

Install in the reverse order of removal.

A
B
C
D
E
F
G
H
SE
J
K
L
M

REAR SEAT

REAR SEATBACK DISASSEMBLY AND ASSEMBLY

Disassembly

1. Use pincers, etc., to push up hooks shown by the arrows in the figure, and remove headrest holder from seatback.

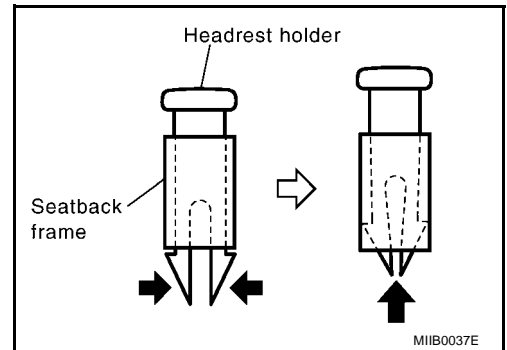

2. Remove retainer, and separate seatback trim&pad, and seatback frame.

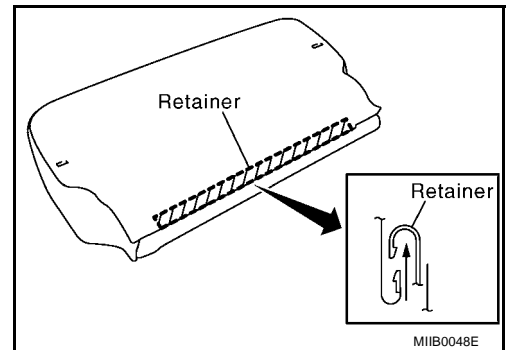

Assembly

Install in the reverse order of removal.

CAUTION:

Before installing headrest holder, check its orientation (front/rear and right/left).