

## ACC

## F

M

# ACCELERATOR CONTROL SYSTEM

## ACCELERATOR CONTROL SYSTEM

PFP:18005

### Removal and Installation

EBS000JF

SEC. 180

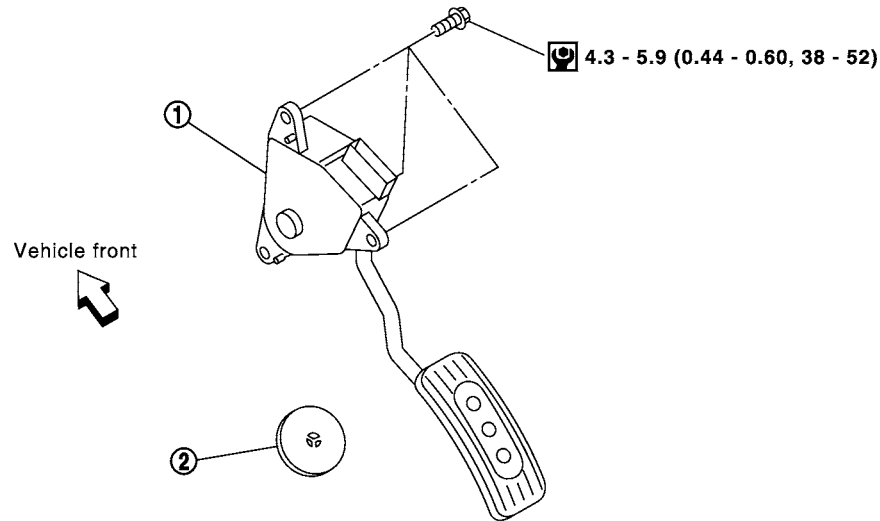

PBIC1506E

1. Accelerator pedal assembly
2. Accelerator pedal stopper (Underfloor carpet)

### REMOVAL

1. Remove harness connector.
2. Remove mounting bolts, and remove accelerator assembly.

#### CAUTION:

- Do not disassemble accelerator pedal assembly and remove sensors.
  - Handle them carefully without subjecting them to impacts such as dropping.
  - Be careful not to get it wet.
3. Fold the floor carpet and remove accelerator pedal stopper.
    - Remove pedal stopper by turning it counterclockwise with fingers.

### INSTALLATION

Install in the reverse order of removal. be careful of the following:

- Insert locating pin into vehicle side to position accelerator pedal assembly. Install mounting bolt to accelerator pedal assembly.
- Align the stud bolt on the floor with the thread hole to insert accelerator pedal stopper until it contacts the face.

### INSPECTION AFTER INSTALLATION

- Check that the accelerator pedal moves smoothly within the whole operation range.
- Check that the accelerator pedal securely returns to the original position.
- For the electrical inspection of the accelerator pedal assembly, refer to [EC-213, "DTC P0226 APP SENSOR"](#) (WITH EURO-OBD), [EC-548, "DTC P0226 APP SENSOR"](#) (WITHOUT EURO-OBD).
- When accelerator electrical connector is disconnected, perform [EC-34, "Accelerator Pedal Released Position Learning"](#) (WITH EURO-OBD), [EC-435, "Accelerator Pedal Released Position Learning"](#) (WITHOUT EURO-OBD).

SERVICE DATA AND SPECIFICATIONS (SDS)

SERVICE DATA AND SPECIFICATIONS (SDS)

PFP:00030

Tightening Torque

EBS000JG

Unit: N·m (kg-m, in-lb)

Accelerator pedal assembly	4.3 - 5.9 (0.44 - 0.60, 38 - 52)
----------------------------	----------------------------------

A

ACC

C

D

E

F

G

H

I

J

K

L

M

## SERVICE DATA AND SPECIFICATIONS (SDS)

---