GROUP 26

FRONT AXLE

CONTENTS

GENERAL INFORMATION	26-2
---------------------------	------

GENERAL INFORMATION

M2260000100325

The front axle consists of front hubs, knuckles, wheel bearings and driveshafts, and has the following features:

- The wheel bearing is a double-row angular contact ball bearing which incorporates the oil seals and is highly resistant to thrust loads.
- The driveshaft incorporates BJ-PTJ type constant velocity joints with high transmission efficiency for low vibration and noise.
- The dynamic damper has been mounted on the left driveshaft <2WD, 4WD> and on the right driveshaft <4WD except 2000-Turbo> to reduce differential gear noise.

- Due to the use of the inner shaft and bracket assembly, the right and left drive shafts are approximately the same in length. This reduces noise, vibration and torque steer.<2WD>
- Due to the use of the output shafts, the right and left drive shafts are approximately the same in length. This reduces noise, vibration and torque steer.<4WD>
- ABS rotor for detecting the wheel speed is press-fitted to the BJ.

NOTE:

- PTJ: Pillow Tripod Joint
- BJ: Birfield Joint

SPECIFICATIONS

Item			2WD	4WD
Wheel bearing	Type		Double-row angular contact ball bearing	
	Bearing (OD x ID) mm		80 x 40	80 x 40
Driveshaft	Joint type	Outer	BJ	BJ
		Inner	PTJ	PTJ
	Length (joint to joint) × diameter mm	LH	383.5 × 24	361 × 22 <2000-Non-Turbo, 2400>, 352.6 × 22.2 <2000-Turbo>
		RH	474.5 × 24	455 × 22 <2000-Non-Turbo, 2400>, 440.3 × 22.2 <2000-Turbo>

CONSTRUCTION DIAGRAM

<2WD>

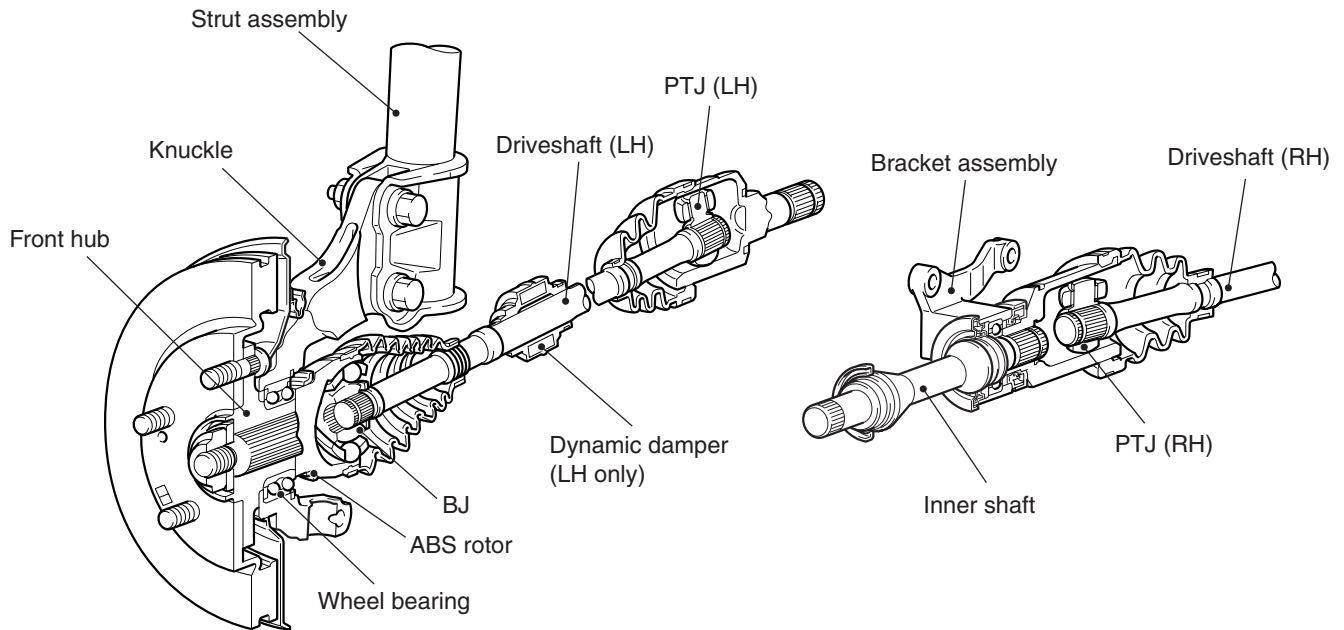

AC106952 AD

<4WD>

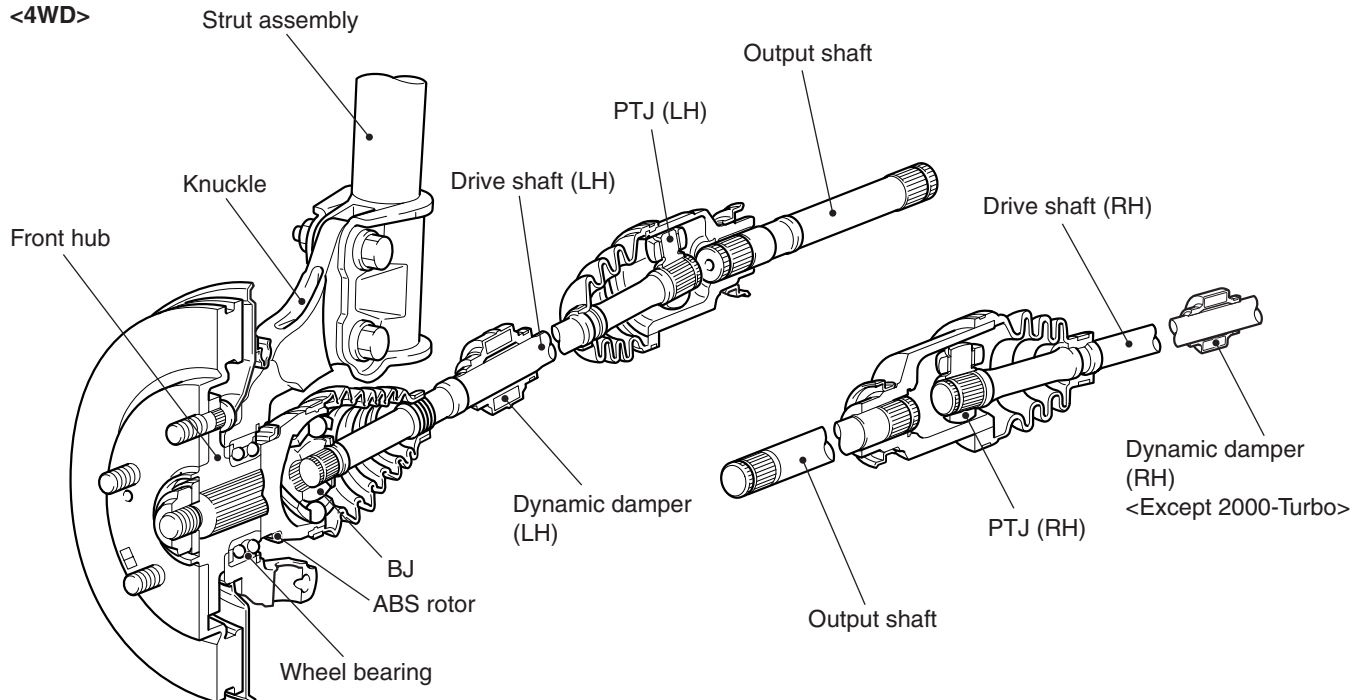

AC308113 AE

NOTES