GROUP 13C**FUEL SUPPLY****CONTENTS**

GENERAL INFORMATION	13C-2	FUEL TANK GAUGE UNIT REPLACEMENT <4WD>	13C-5
SEALANT.....	13C-2	FUEL TANK	13C-7
ON-VEHICLE SERVICE.....	13C-2	REMOVAL AND INSTALLATION <4G63> .	13C-7
FUEL PUMP OPERATION CHECK	13C-2	REMOVAL AND INSTALLATION <4G69> .	13C-11
FUEL GAUGE UNIT CHECK	13C-2	FUEL PUMP ASSEMBLY DISASSEMBLY AND REASSEMBLY <2WD>	13C-14
FUEL PUMP ASSEMBLY <2WD>, FUEL TANK PUMP AND GAUGE ASSEMBLY <4WD> REPLACEMENT	13C-2	FUEL TANK PUMP AND GAUGE ASSEMBLY DISASSEMBLY AND REASSEMBLY <4WD>	13C-15
FUEL TANK GAUGE UNIT REPLACEMENT <2WD>	13C-4	FUEL TANK GAUGE UNIT DISASSEMBLY AND REASSEMBLY	13C-16

GENERAL INFORMATION

- The fuel tank is located under the floor of the rear seats to provide increased protection and a more luggage space.
- A fuel tank safety valve assembly has been adopted to prevent fuel from leaking out in case of a collision.
- A fuel pump assembly <2WD>, fuel pump and gauge assembly <4WD> including fuel pump, fuel filter, reservoir and fuel gauge unit, has been adopted to lighten weight and improve serviceability.

SEALANT

Item	Specified sealant
Service hole cover and floor pan <2WD>	3M™ 8513 Grommets windshield sealer (Black)

ON-VEHICLE SERVICE

FUEL PUMP OPERATION CHECK

<4G63>: Refer to GROUP 13A - On-vehicle Service, Fuel Pump Operation Check [P.13A-328](#).
<4G69>: Refer to GROUP 13B - On-vehicle Service, Fuel Pump Operation Check [P.13B-428](#).

FUEL GAUGE UNIT CHECK

Refer to GROUP 54A – Combination Meter, On-vehicle Service, Fuel Gauge Unit Check [P.54A-69](#) <2WD>, [P.54A-70](#) <4WD>.

FUEL PUMP ASSEMBLY <2WD>, FUEL TANK PUMP AND GAUGE ASSEMBLY <4WD> REPLACEMENT

1. Remove the rear seat cushion assembly (Refer to GROUP 52A – Rear seat assembly [P.52A-36](#)).

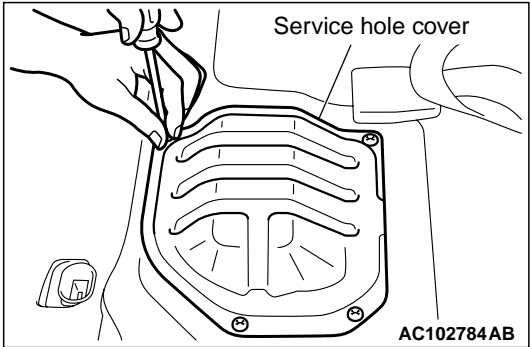

2. Remove the service hole cover mounting screws and remove the service hole cover.

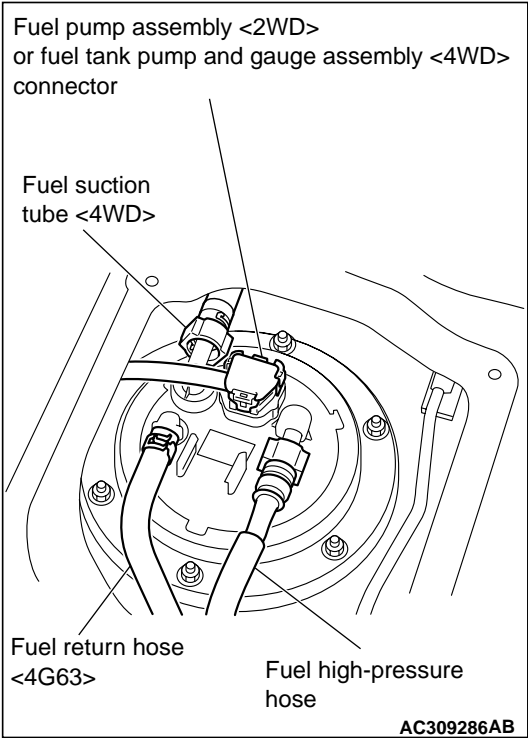

3. Disconnect the fuel pump assembly <2WD> or fuel tank pump and gauge assembly <4WD> connector, fuel return hose, fuel high-pressure hose and fuel suction tube <4WD>.

CAUTION

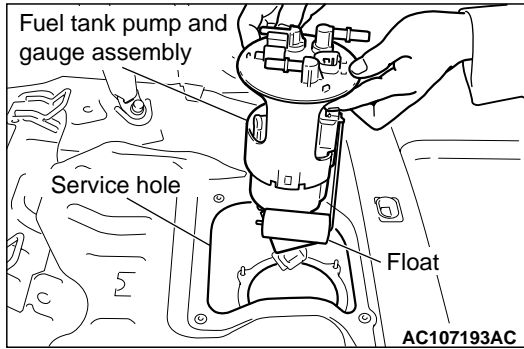

For 4WD: Pay attention not to damage the float when removing and installing fuel tank pump and gauge assembly through the service hole.

4. Remove the mounting nuts and fuel pump bracket plate, and remove the fuel pump assembly <2WD>, fuel tank pump and gauge assembly <4WD> from the service hole.
5. Install the fuel pump assembly <2WD>, fuel tank pump and gauge assembly <4WD> to the fuel tank through the service hole.

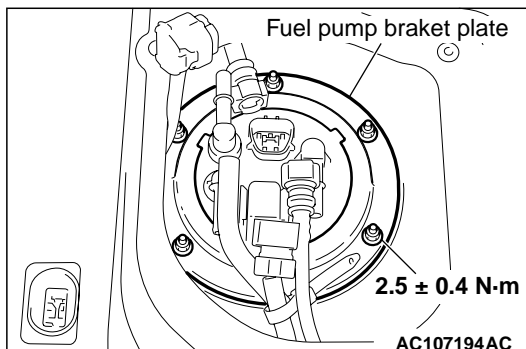

6. Install the fuel pump bracket plate to the fuel tank and tighten the mounting nuts to the specified torque.

Tightening torque: 2.5 ± 0.4 N·m

CAUTION

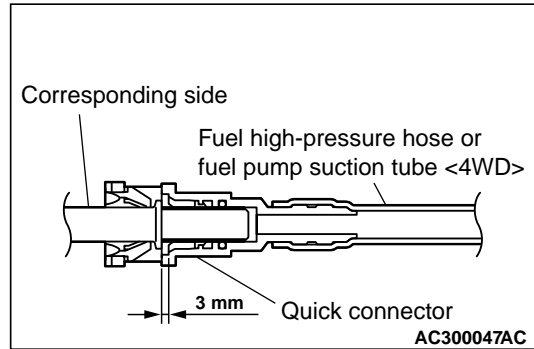

After connecting the fuel high-pressure hose or fuel pump suction tube <4WD>, slightly pull it to ensure that it is installed securely. Also confirm that there is a play approximately 3 mm.

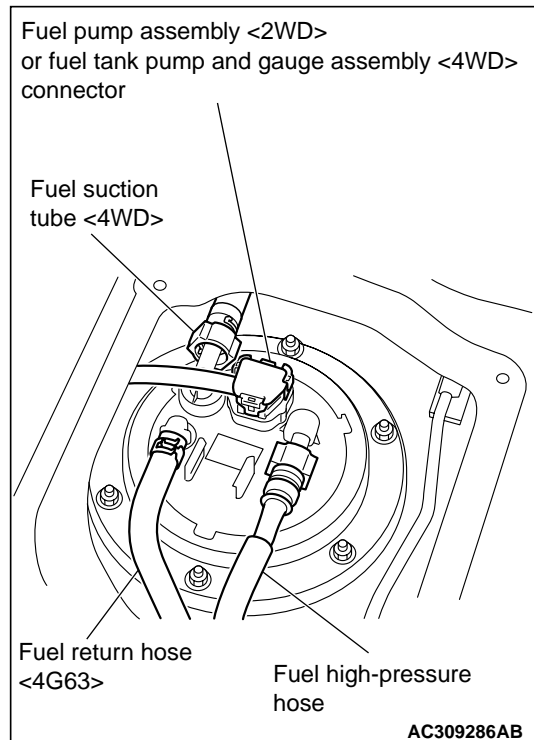

7. Connect the fuel pump assembly <2WD> or fuel tank pump and gauge assembly <4WD> connector, fuel return hose, fuel high-pressure hose and fuel suction tube <4WD>.

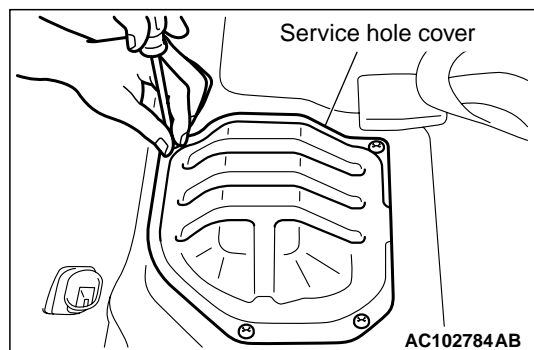

8. Tighten the service hole cover mounting screws and install the service hole cover.
9. Install the rear seat cushion assembly. (Refer to GROUP 52A – Rear seat assembly P.52A-36).

FUEL TANK GAUGE UNIT REPLACEMENT <2WD>

M1135001400398

1. Remove the rear seat cushion assembly (Refer to GROUP 52A – Rear Seat Assembly P.52A-36).

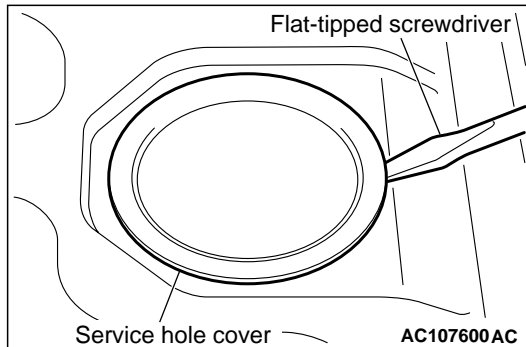

2. Pry off the service hole cover using a flat-tipped screwdriver, etc.

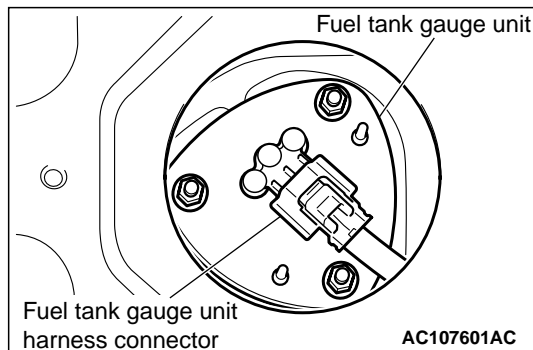

3. Disconnect the fuel tank gauge unit harness connector.

CAUTION

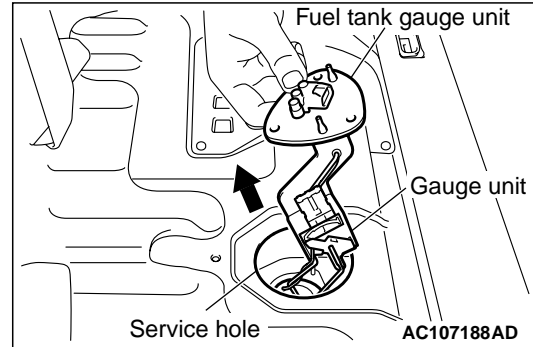

Pay attention not to damage the gauge unit and the float of the fuel tank gauge unit when withdrawing it from the service hole.

4. Remove the fuel tank gauge unit mounting nuts and remove the fuel tank gauge unit from service hole.

CAUTION

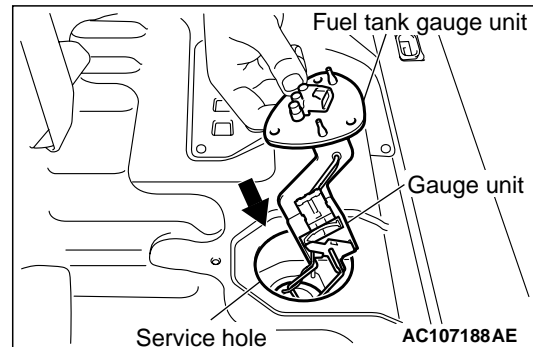

Pay attention not to damage the gauge unit and the float of the fuel tank gauge unit when inserting it from the service hole.

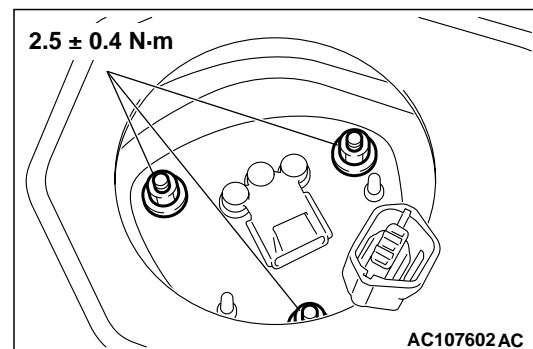

5. Install the fuel tank gauge unit to the fuel tank through the service hole, and tighten the mounting nuts to the specified torque.

Tightening torque: 2.5 ± 0.4 N·m

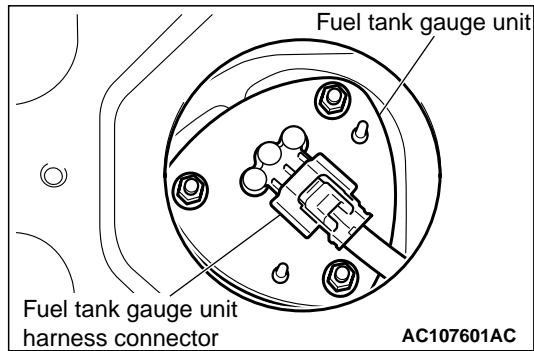

6. Connect the fuel tank gauge unit harness connector.

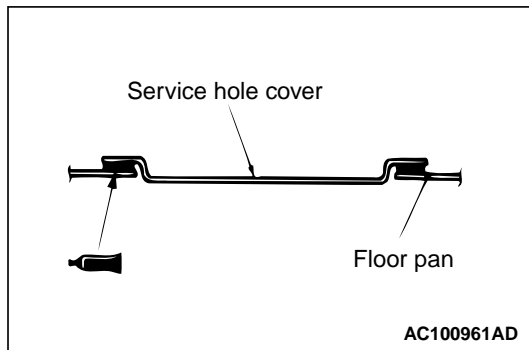

7. Apply the specified sealant to the contact surfaces of the service hole cover and the floor pan, and install the service hole cover.

Specified sealant: 3M™ 8513 Grommets Windshield Sealer (Black)

8. Install the rear seat cushion assembly (Refer to GROUP 52A – Rear Seat Assembly [P.52A-36](#)).

FUEL TANK GAUGE UNIT REPLACEMENT <4WD>

M1135001400406

1. Remove the rear seat cushion assembly (Refer to GROUP 52A – Rear Seat Assembly [P.52A-36](#)).

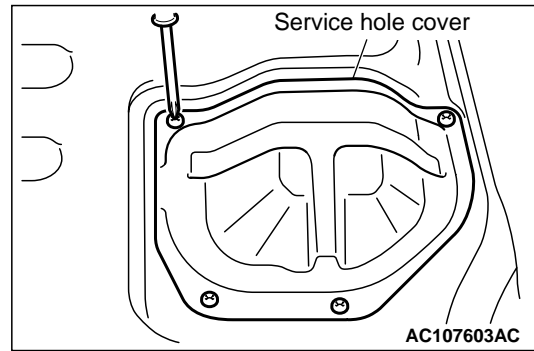

2. Remove the service hole cover mounting screws and remove the service hole cover.

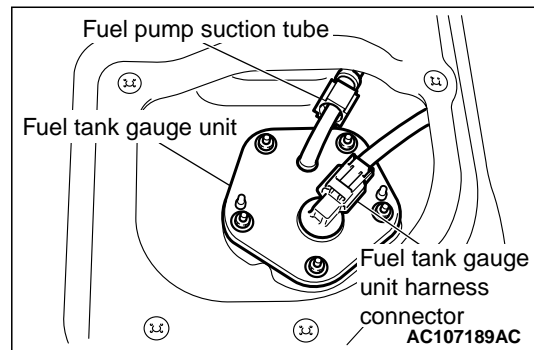

3. Disconnect the fuel tank gauge unit harness connector and fuel pump suction tube.

⚠ CAUTION

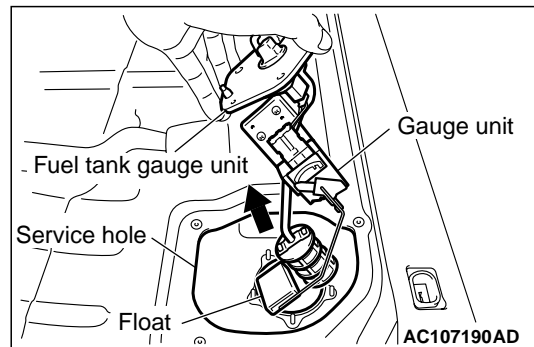

Pay attention not to damage the gauge unit and the float of the fuel tank gauge unit when withdrawing it from the service hole.

4. Remove the fuel tank gauge unit mounting nuts and remove the fuel tank gauge unit from service hole.

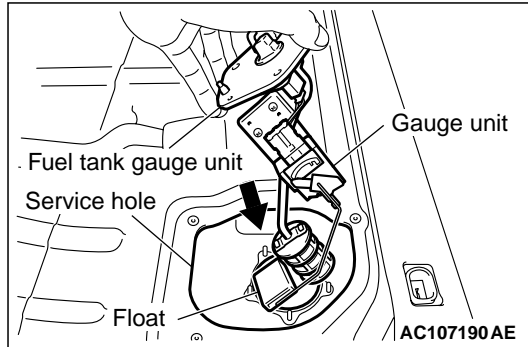
CAUTION

Pay attention not to damage the gauge unit and the float of the fuel tank gauge unit when inserting it from the service hole.

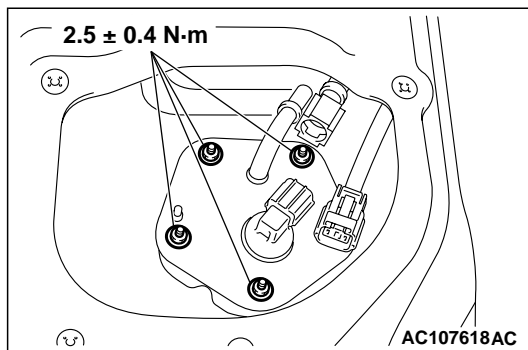

5. Install the fuel tank gauge unit to the fuel tank through the service hole, and tighten the mounting nuts to the specified torque.

Tightening torque: 2.5 ± 0.4 N·m

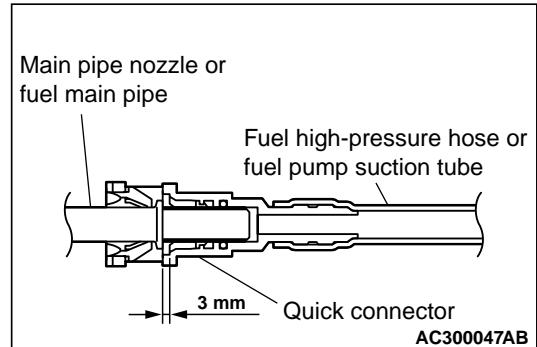
CAUTION

After connecting the fuel high-pressure hose or fuel pump suction tube, slightly pull it to ensure that it is installed securely. Also confirm that there is a play approximately 3 mm.

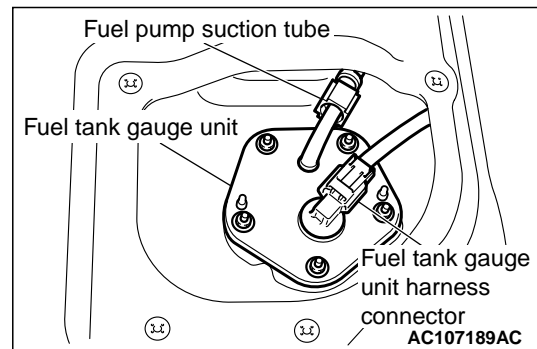

6. Connect the fuel tank pump gauge unit harness connector and fuel suction tube.

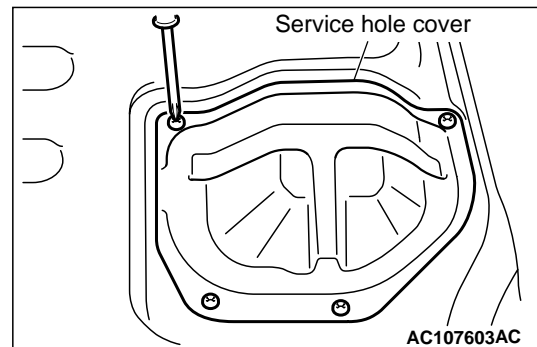

7. Tighten the service hole cover mounting screws and install the service hole cover.
8. Install the rear seat cushion assembly (Refer to GROUP 52A – Rear Seat Assembly [P.52A-36](#)).

FUEL TANK

REMOVAL AND INSTALLATION <4G63>

M1135001900520

Pre-removal Operation

- Draining Fuel
- Fuel Pump Connector Disconnection (How to Reduce Fuel Pressure) (Refer to GROUP 13A – On-vehicle Service [P.13A-328](#)).
- Centre Exhaust Pipe Removal (Refer to GROUP 15, Exhaust Pipe and Main Muffler [P.15-13](#)).
- Propeller Shaft Removal <4WD> (Refer to GROUP 25, Propeller Shaft [P.25-3](#)).

Post-installation Operation

- Propeller Shaft Installation <4WD> (Refer to GROUP 25, Propeller Shaft [P.25-3](#)).
- Centre Exhaust Pipe Installation (Refer to GROUP 15, Exhaust Pipe and Main Muffler [P.15-13](#)).
- Refilling Fuel
- Checking for Fuel Leaks

<2WD>

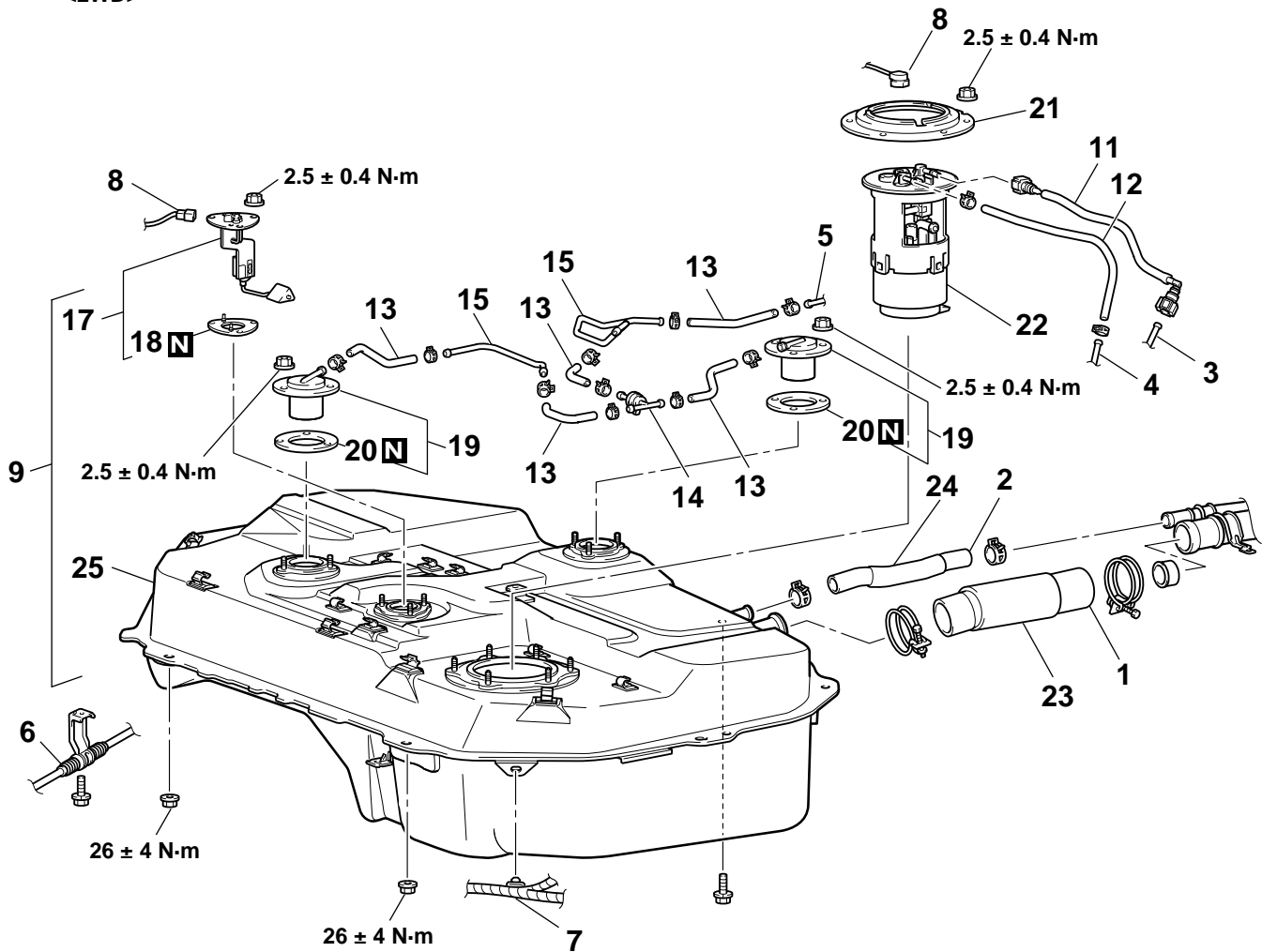

AC212356AB

<4WD>

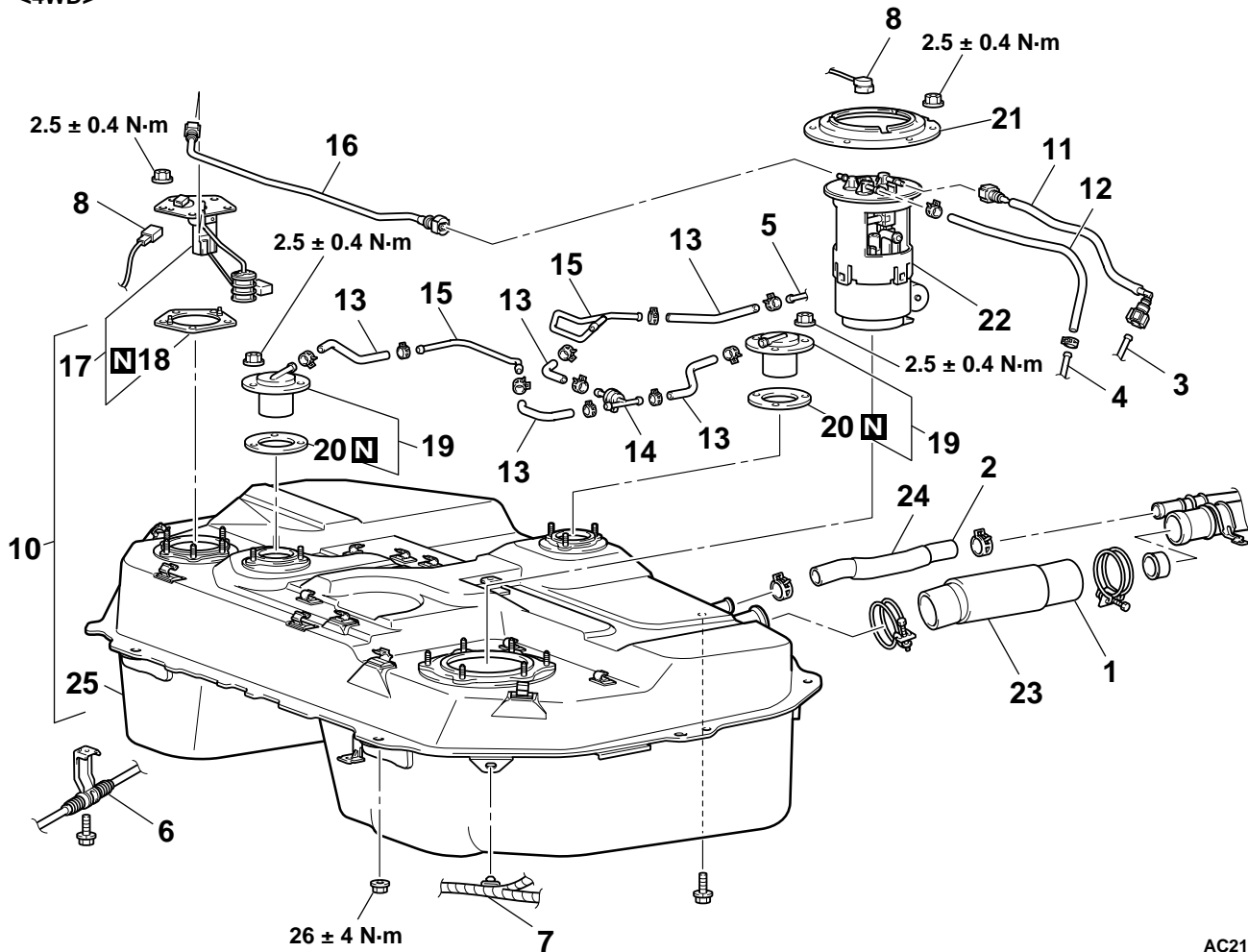

AC212516AB

Fuel tank assembly removal steps

1. Fuel filler hose connection <Fuel filler neck side>
2. Fuel filler neck breather hose connection <Fuel filler neck side>
3. Main pipe connection
4. Return pipe
5. Fuel vapour pipe
6. Parking brake cable clamp connection <RH side>
7. Wiring harness clamp connection
8. Fuel tank gauge unit assembly, fuel pump assembly <2WD>, fuel tank pump and gauge assembly <4WD> connector connection
- Rear differential support member installation nuts and bolts <4WD> (Refer to GROUP 27B – Rear Differential Carrier Assembly P.27B-16).
9. Fuel tank assembly <2WD>
10. Fuel tank assembly <4WD>

Fuel tank assembly removal steps (Continued)

- >>A<< 11. Fuel high-pressure hose
12. Fuel return hose
13. Fuel tank hose
14. Fuel tank vapour hose 2way valve
15. Fuel vapour pipe
- >>A<< 16. Fuel pump suction tube <4WD>
- <> 17. Fuel tank gauge unit
18. Gasket
19. Fuel tank safety valve
20. Gasket
21. Fuel pump bracket plate
- <> 22. Fuel pump assembly <2WD>, fuel tank pump and gauge assembly <4WD>
23. Fuel filler hose
24. Fuel filler neck breather hose
25. Fuel tank

<FUEL FILLER NECK>

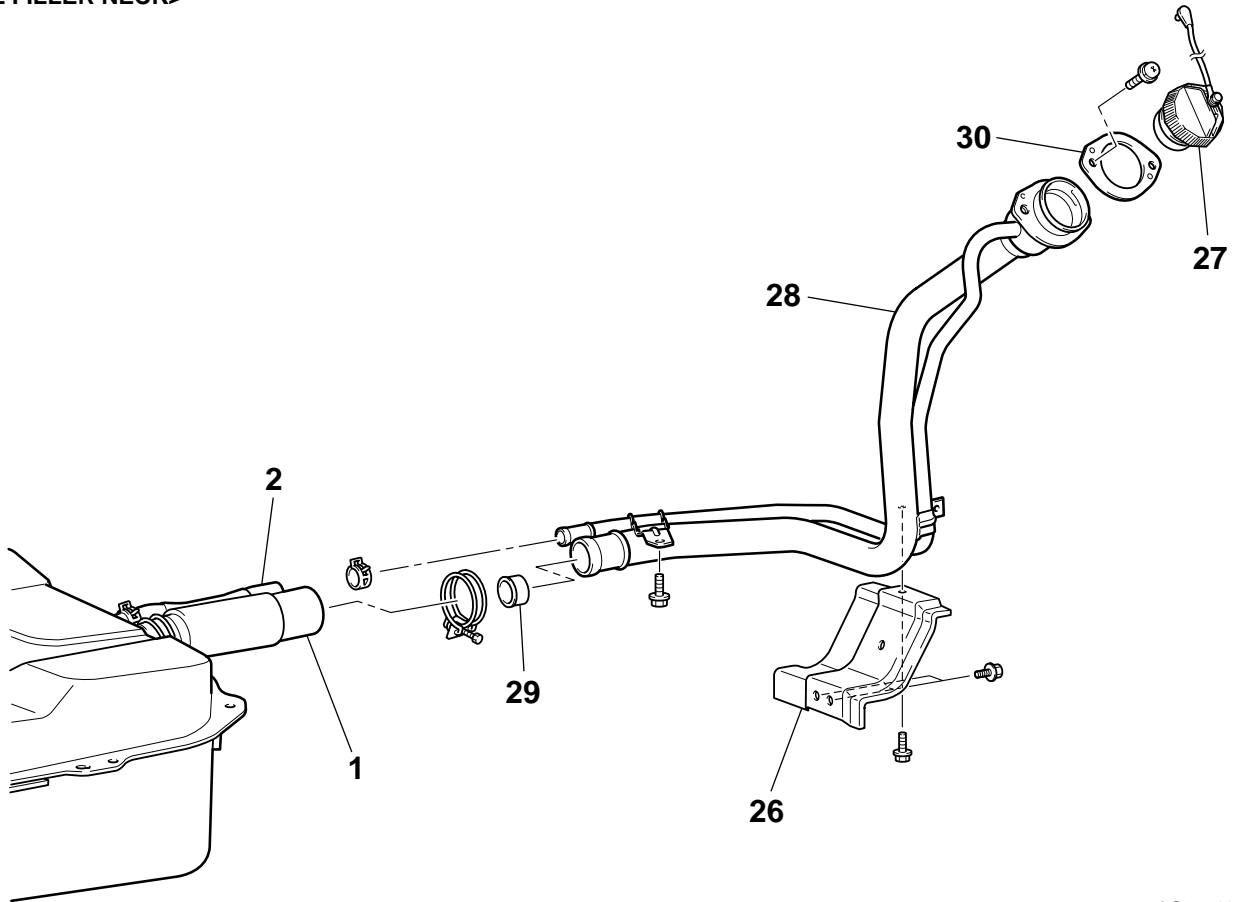

AC300410AB

Fuel filler neck removal steps

1. Fuel filler hose connection <Fuel filler neck side>
2. Fuel filler neck breather hose connection <Fuel filler neck side>
26. Fuel filler neck protector

Fuel filler neck removal steps

27. Fuel tank cap
28. Fuel filler neck
29. Fuel filler neck valve
30. Gasket

REMOVAL SERVICE POINTS

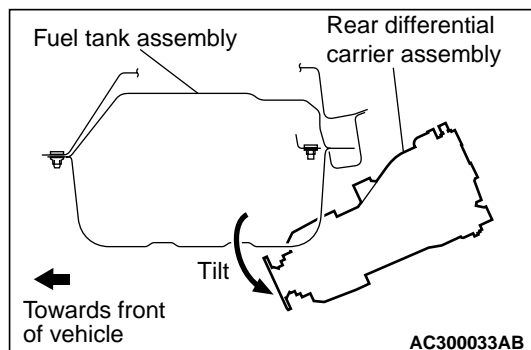
<<A>> REAR DIFFERENTIAL SUPPORT
MEMBER INSTALLATION NUTS AND BOLTS
<4WD>/FUEL TANK ASSEMBLY <4WD>
REMOVAL

1. Remove the rear differential support member installation nuts and bolts, and then tilt the rear differential carrier assembly (Refer to GROUP 27B – Rear Differential Carrier Assembly P.27B-16).

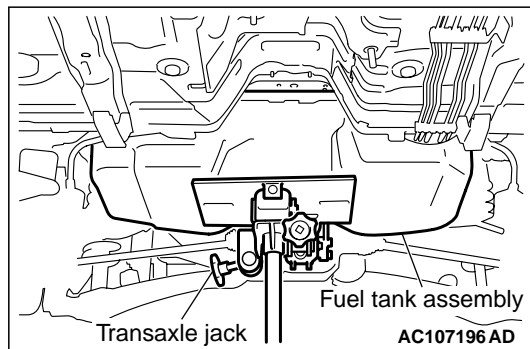

2. Raise and support the fuel tank assembly with a transmission jack, and remove the mounting nuts and bolts.

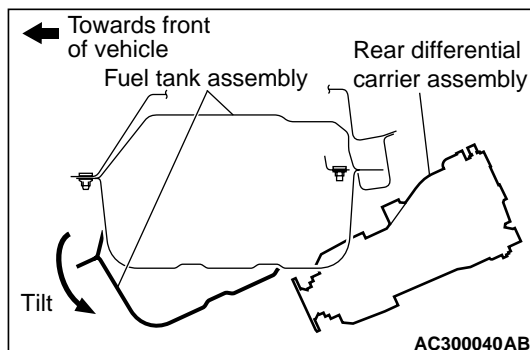

⚠ CAUTION

Support the fuel tank assembly securely so that it does not fall off from the transmission jack.

3. Tilt the fuel tank assembly to disconnect the connectors.

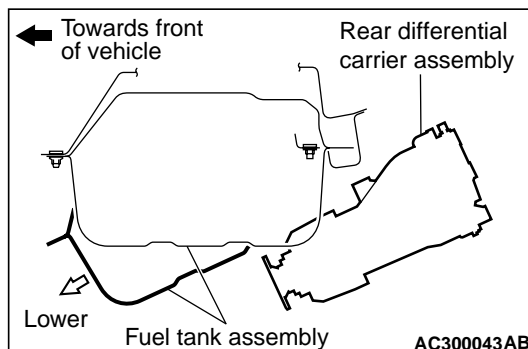

4. Remove the fuel tank assembly to the direction shown, being careful not to strike it against the rear differential carrier assembly.

<> FUEL TANK GAUGE UNIT/FUEL PUMP
ASSEMBLY <2WD>, FUEL TANK PUMP AND
GAUGE ASSEMBLY <4WD> REMOVAL

⚠ CAUTION

When withdrawing the fuel tank gauge unit, fuel tank pump and gauge assembly from the fuel tank, be careful not damage the module unit and the float.

INSTALLATION SERVICE POINS

>>A<< FUEL PUMP SUCTION TUBE <4WD>/FUEL
HIGH-PRESSURE HOSE INSTALLATION

⚠ CAUTION

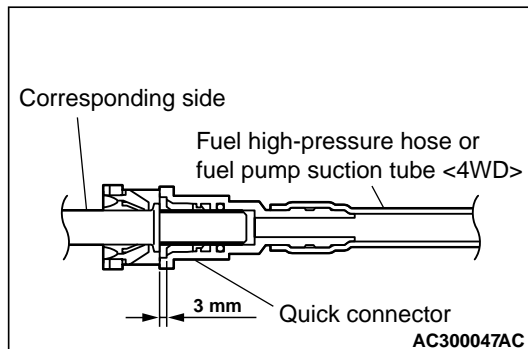

After connecting the fuel high-pressure hose or fuel pump suction tube <4WD>, slightly pull it to ensure that it is installed securely. Also confirm that there is a play approximately 3 mm.

REMOVAL AND INSTALLATION <4G69>

M1135001900542

Pre-removal Operation

- Draining Fuel
- Fuel Pump Connector Disconnection (How to Reduce Fuel Pressure) (Refer to GROUP 13B – On-vehicle Service [P.13B-428](#)).
- Centre Exhaust Pipe Removal (Refer to GROUP 15, Exhaust Pipe and Main Muffler [P.15-13](#)).
- Propeller Shaft Removal (Refer to GROUP 25, Propeller Shaft [P.25-3](#)).

Post-installation Operation

- Propeller Shaft Installation (Refer to GROUP 25, Propeller Shaft [P.25-3](#)).
- Centre Exhaust Pipe Installation (Refer to GROUP 15, Exhaust Pipe and Main Muffler [P.15-13](#)).
- Refilling Fuel
- Checking for Fuel Leaks

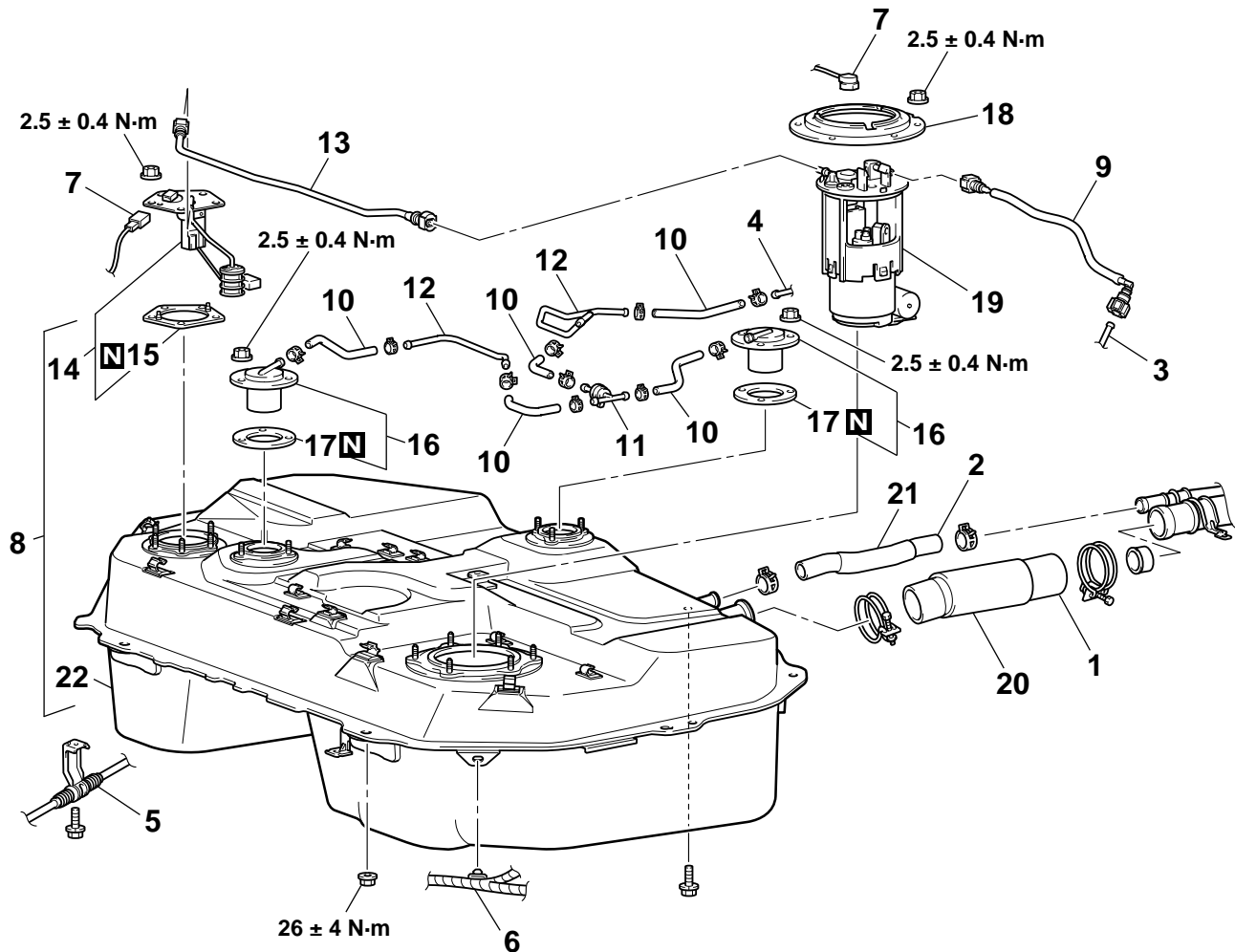

AC309122AB

Fuel tank assembly removal steps

1. Fuel filler hose connection <Fuel filler neck side> <<A>>
2. Fuel filler neck breather hose connection <Fuel filler neck side> <<A>>
3. Main pipe connection <<A>>
4. Fuel vapour pipe >>A<<
5. Parking brake cable clamp connection <RH side> >>A<<
6. Wiring harness clamp connection >>A<<
7. Fuel tank gauge unit assembly, fuel tank pump and gauge assembly connector connection <>

Fuel tank assembly removal steps (Continued)

- Rear differential support member installation nuts and bolts (Refer to GROUP 27B – Rear Differential Carrier Assembly [P.27B-16](#)).
- 8. Fuel tank assembly
- 9. Fuel high-pressure hose
- 10. Fuel tank hose
- 11. Fuel tank vapour hose 2way valve
- 12. Fuel vapour pipe
- 13. Fuel pump suction tube
- 14. Fuel tank gauge unit
- 15. Gasket
- 16. Fuel tank safety valve

**Fuel tank assembly removal
steps (Continued)**

<>

17. Gasket
18. Fuel pump bracket plate
19. Fuel tank pump and gauge assembly
20. Fuel filler hose
21. Fuel filler neck breather hose
22. Fuel tank

<FUEL FILLER NECK>

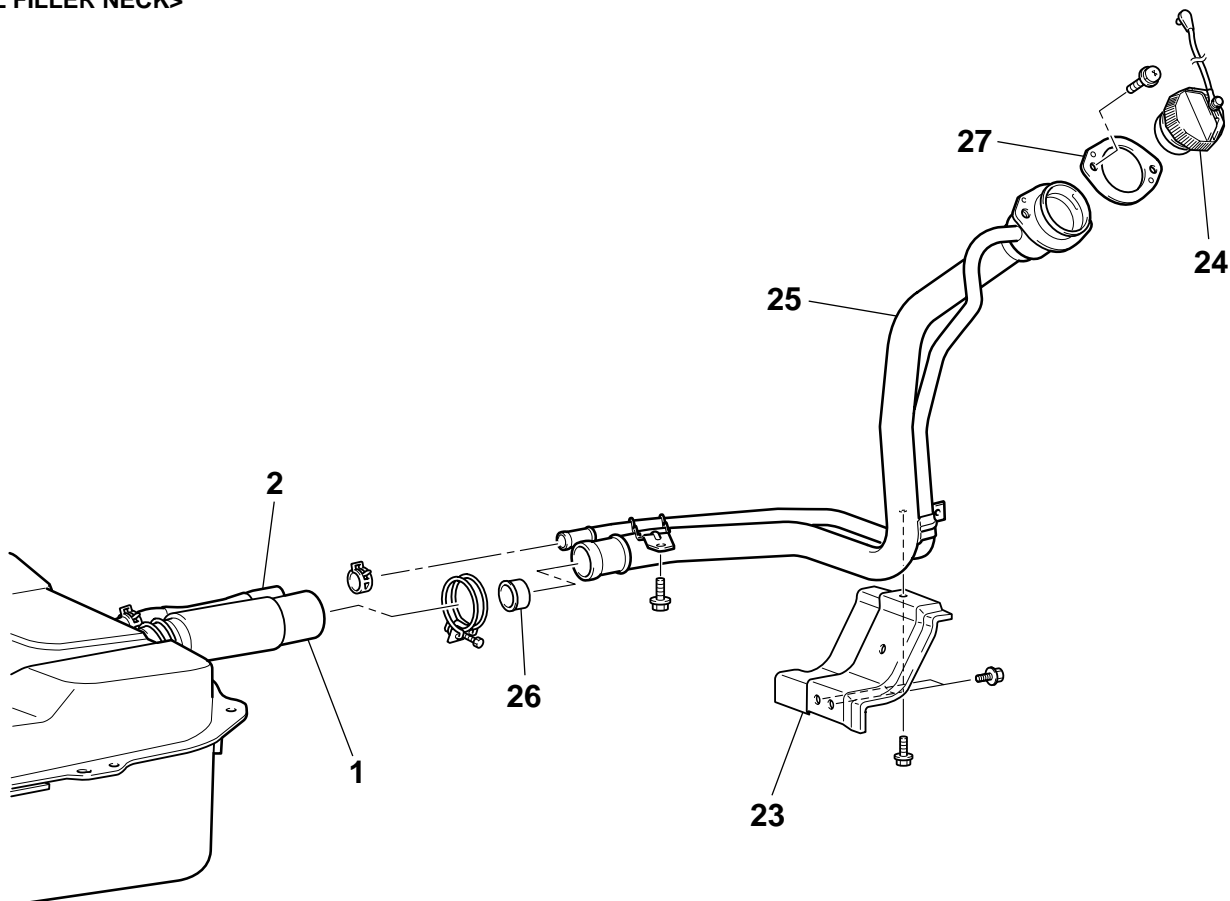

AC300410AC

Fuel filler neck removal steps

1. Fuel filler hose connection <Fuel filler neck side>
2. Fuel filler neck breather hose connection <Fuel filler neck side>
23. Fuel filler neck protector

Fuel filler neck removal steps

24. Fuel tank cap
25. Fuel filler neck
26. Fuel filler neck valve
27. Gasket

REMOVAL SERVICE POINTS

<<A>> REAR DIFFERENTIAL SUPPORT MEMBER INSTALLATION NUTS AND BOLTS/FUEL TANK ASSEMBLY REMOVAL

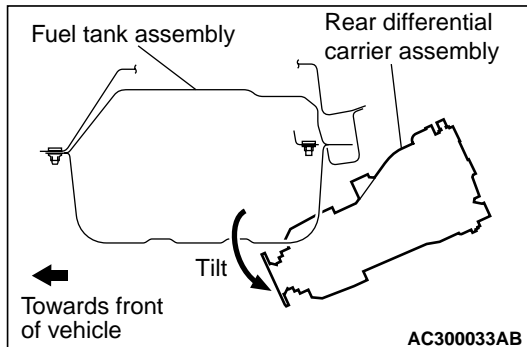

1. Remove the rear differential support member installation nuts and bolts, and then tilt the rear differential carrier assembly (Refer to GROUP 27B – Rear Differential Carrier Assembly P.27B-16).

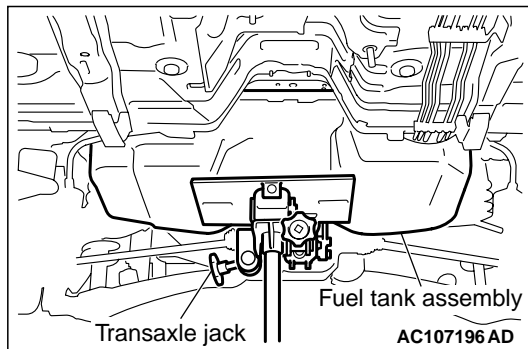

2. Raise and support the fuel tank assembly with a transmission jack, and remove the mounting nuts and bolts.

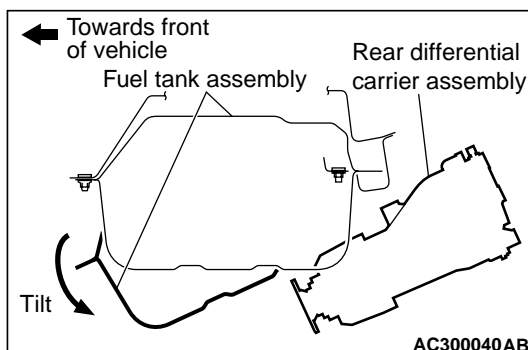

⚠ CAUTION

Support the fuel tank assembly securely so that it does not fall off from the transmission jack.

3. Tilt the fuel tank assembly to disconnect the connectors.

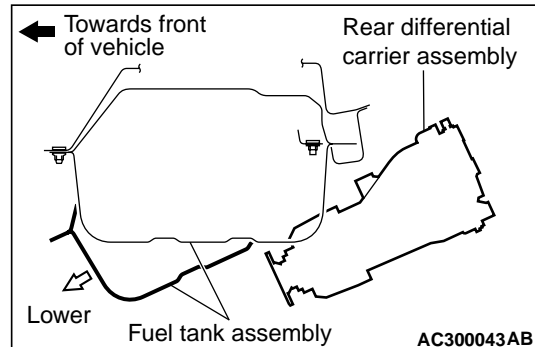

4. Remove the fuel tank assembly to the direction shown, being careful not to strike it against the rear differential carrier assembly.

<> FUEL TANK GAUGE UNIT/FUEL TANK PUMP AND GAUGE ASSEMBLY REMOVAL

⚠ CAUTION

When withdrawing the fuel tank gauge unit, fuel tank pump and gauge assembly from the fuel tank, be careful not damage the module unit and the float.

INSTALLATION SERVICE POINS

>>A<< FUEL PUMP SUCTION TUBE <4WD>/FUEL HIGH-PRESSURE HOSE INSTALLATION

⚠ CAUTION

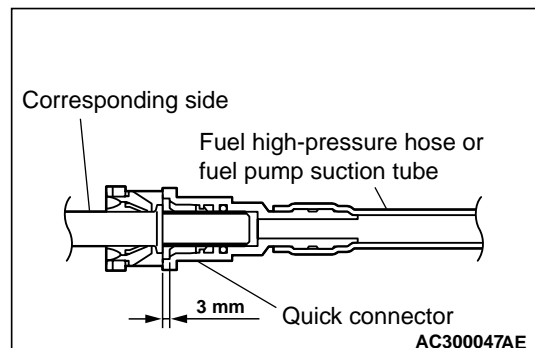

After connecting the fuel high-pressure hose or fuel pump suction tube, slightly pull it to ensure that it is installed securely. Also confirm that there is a play approximately 3 mm.

**FUEL PUMP ASSEMBLY DISASSEMBLY
AND REASSEMBLY <2WD>**

M1135004600380

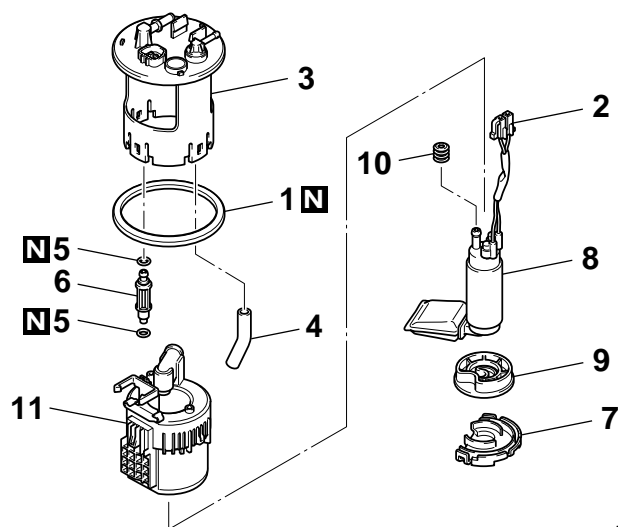
**Disassembly steps**

1. Gasket
2. Fuel tank pump connector connection
3. Fuel pump bracket
4. Fuel pump hose
5. O-ring
6. Fuel pump tube
7. Fuel pump bracket
8. Fuel tank pump
9. Fuel tank pump cushion

>>A<<

AC309295AB

Disassembly steps (Continued)

- >>A<< 10. Fuel tank grommet
11. Fuel tank filter assembly

REASSEMBLY SERVICE POINT**>>A<< FUEL TANK GROMMET/O-RING
INSTALLATION**

Apply gasoline on the grommet and the O-ring before mounting them to prevent damage or twisting.

FUEL TANK PUMP AND GAUGE ASSEMBLY DISASSEMBLY AND REASSEMBLY <4WD>

M1135004600391

<4G63>

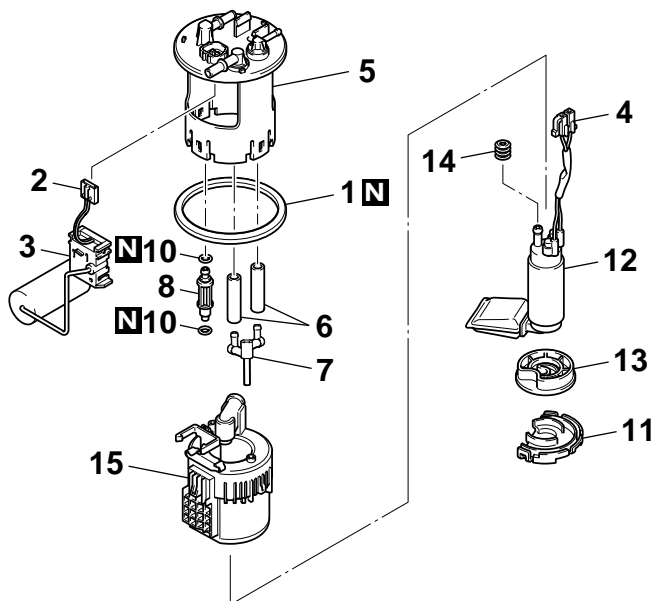

AC309123

Disassembly steps

1. Gasket
2. Fuel tank gauge unit connector connection
3. Fuel tank gauge unit
4. Fuel tank pump connector connection
5. Fuel pump bracket
6. Fuel pump hose
7. Fuel tank assist pump <4G63>
8. Fuel pump tube <4G63>
9. Fuel pump pressure regulator <4G69>
- >>A<< 10. O-ring

<4G69>

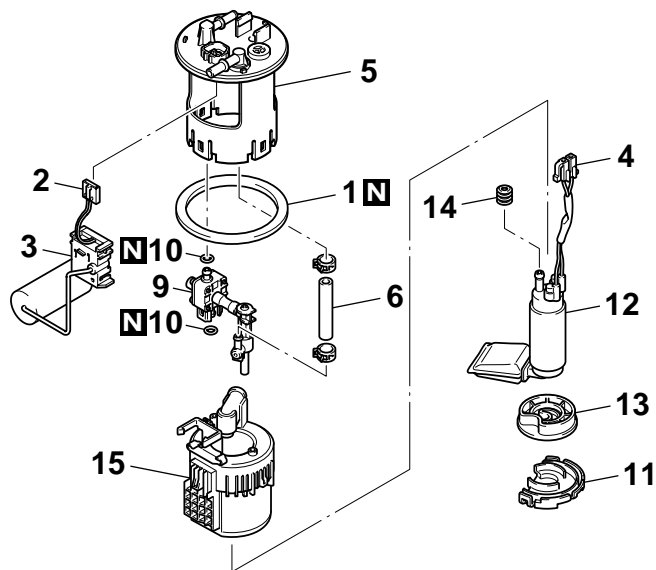

AC309123
AC309296AB

Disassembly steps (Continued)

11. Fuel pump bracket
12. Fuel tank pump
13. Fuel tank pump cushion
- >>A<< 14. Fuel tank grommet
15. Fuel tank filter assembly

REASSEMBLY SERVICE POINT

>>A<< FUEL TANK GROMMET/O-RING INSTALLATION

Apply gasoline on the grommet and the O-ring before mounting them to prevent damage or twisting.

FUEL TANK GAUGE UNIT DISASSEMBLY AND REASSEMBLY

M1135051100068

<2WD>

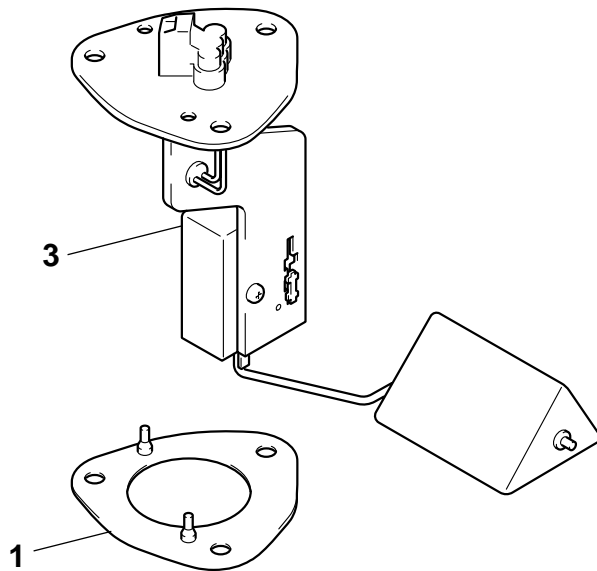
**Disassembly steps**

1. Gasket

<4WD>

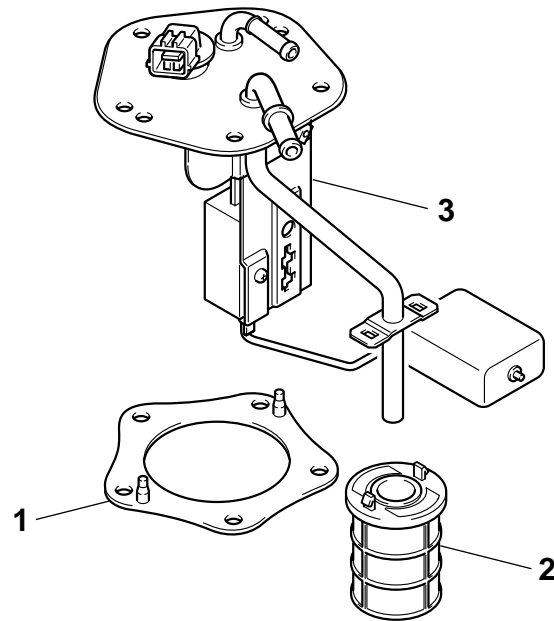

AC102461 AD

Disassembly steps (Continued)

2. Fuel in tank filter <4WD>
3. Fuel tank gauge unit