

# 1 BODY CONSTRUCTION

1

BODY COMPONENTS .....	1-2
BODY CONSTRUCTION CHARACTERISTICS .....	1-8
BODY MAIN CROSS-SECTIONAL VIEWS .....	1-8
MAINTENANCE, SERVICEABILITY .....	1-14
FRONT BODY .....	1-15
SIDE BODY .....	1-17
UNDER BODY .....	1-23
REAR BODY .....	1-26
ROOF .....	1-27
DOOR .....	1-28
CARRIER .....	1-29
SILENCER APPLICATION LOCATIONS .....	1-32

# BODY COMPONENTS

<Single cab>

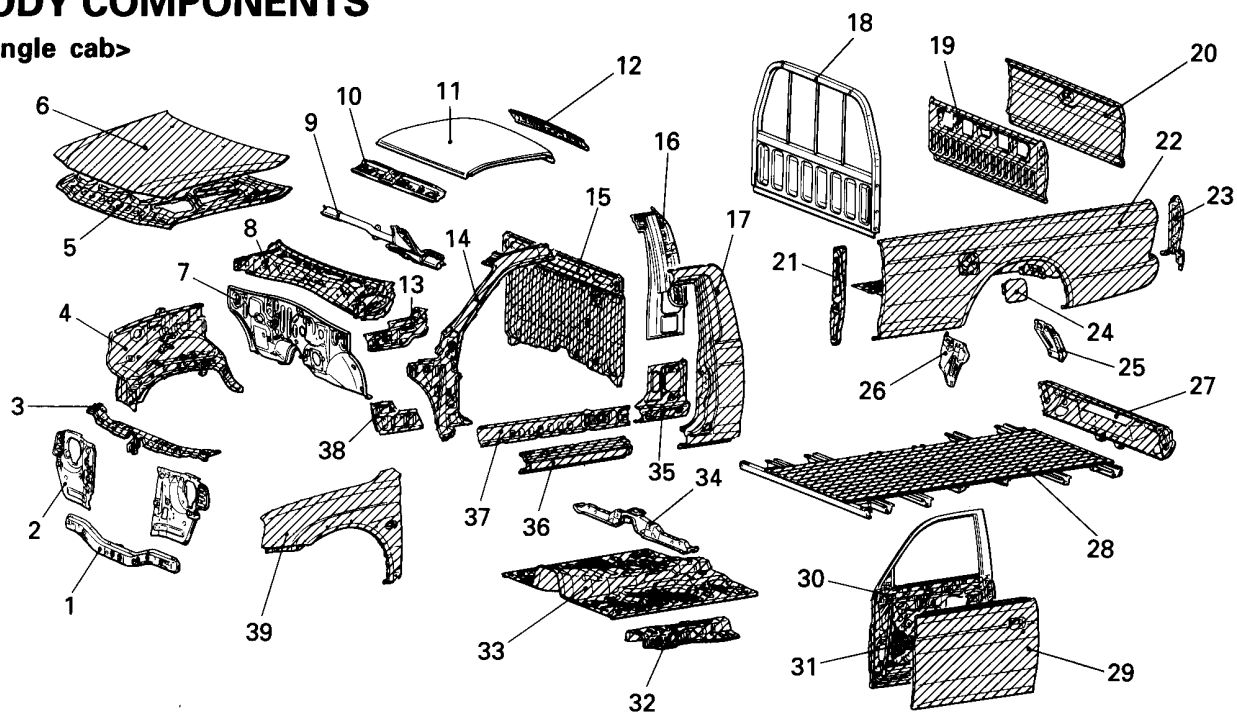

31V0138

(2WD)

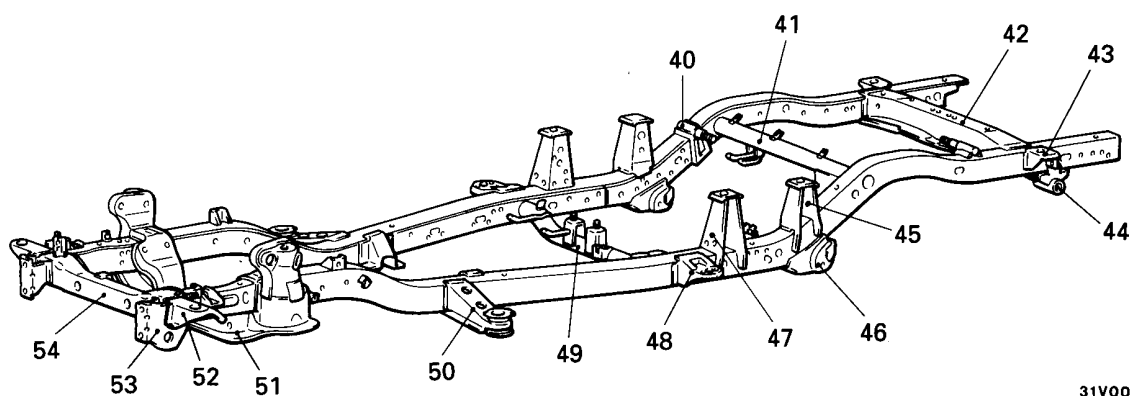

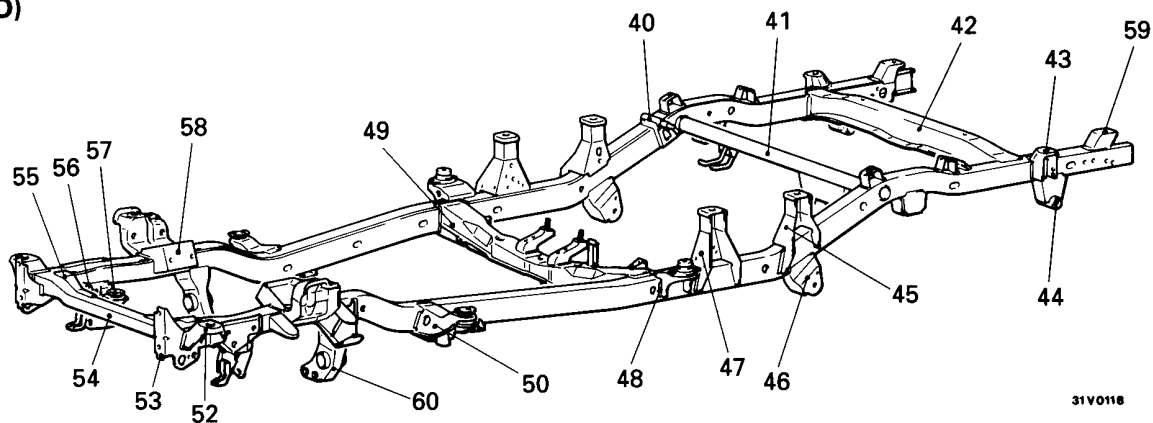

31V0002

(4WD)



31V0118

 : High-tensile steel panels.  
 : Anticorrosion steel panels.

- 
- |  |                                      |
|--|--------------------------------------|
| 1. Front end crossmember               | 31. Front side door beam             |
| 2. Headlamp support panel              | 32. Backbone reinforcement           |
| 3. Front end upper bar                 | 33. Front floor pan                  |
| 4. Fender shield                       | 34. Front floor crossmember          |
| 5. Hood panel, inner                   | 35. Rear pillar, inner, lower        |
| 6. Hood panel, outer                   | 36. Front floor side sill, outer     |
| 7. Dash panel                          | 37. Front floor side sill, inner     |
| 8. Cowl top panel                      | 38. Front side sill brace            |
| 9. Front deck crossmember              | 39. Front fender                     |
| 10. Front roof rail                    | 40. Absorber bracket                 |
| 11. Roof panel                         | 41. No. 4 crossmember                |
| 12. Rear roof rail                     | 42. No. 5 crossmember                |
| 13. Front upper frame extension, outer | 43. No. 3 rear body mounting bracket |
| 14. Front pillar, outer                | 44. Shackle bracket                  |
| 15. Rear panel                         | 45. No. 2 rear body mounting bracket |
| 16. Rear pillar, inner                 | 46. Front eye bracket                |
| 17. Rear pillar, outer                 | 47. No. 1 rear body mounting bracket |
| 18. Front gate                         | 48. No. 3 cab bracket                |
| 19. Rear gate inner panel              | 49. No. 3 crossmember                |
| 20. Rear gate outer panel              | 50. No. 2 cab bracket                |
| 21. Side gate panel, front             | 51. Engine mounting crossmember      |
| 22. Side panel, outer                  | 52. No. 1 cab bracket                |
| 23. Rear combination lamp housing      | 53. Bumper bracket                   |
| 24. Fuel filler door                   | 54. No. 1 crossmember                |
| 25. Rear skirt                         | 55. Crossmember reinforcement        |
| 26. Front skirt                        | 56. Stabilizer bracket               |
| 27. Rear end sill                      | 57. Gear box inner bracket           |
| 28. Rear body floor                    | 58. Engine mounting bracket          |
| 29. Front door outer panel             | 59. No. 4 rear body mounting bracket |
| 30. Front door inner panel             | 60. Lower arm support bracket        |

&lt;Club cab&gt;

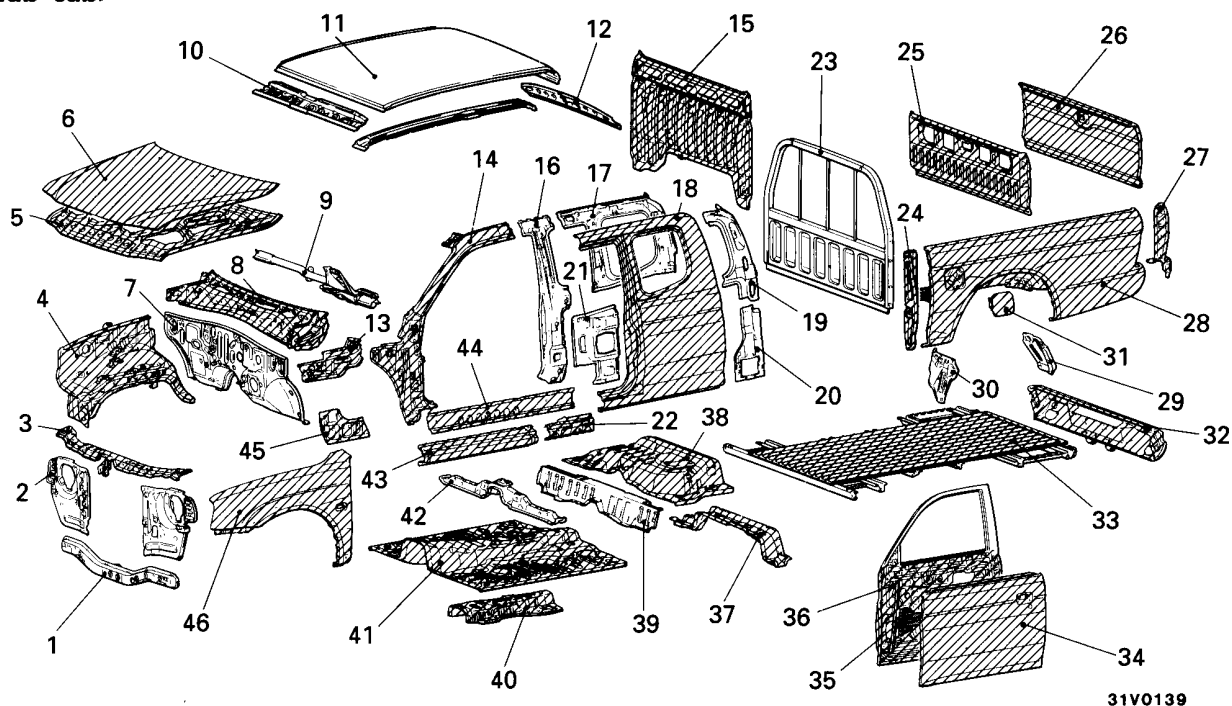

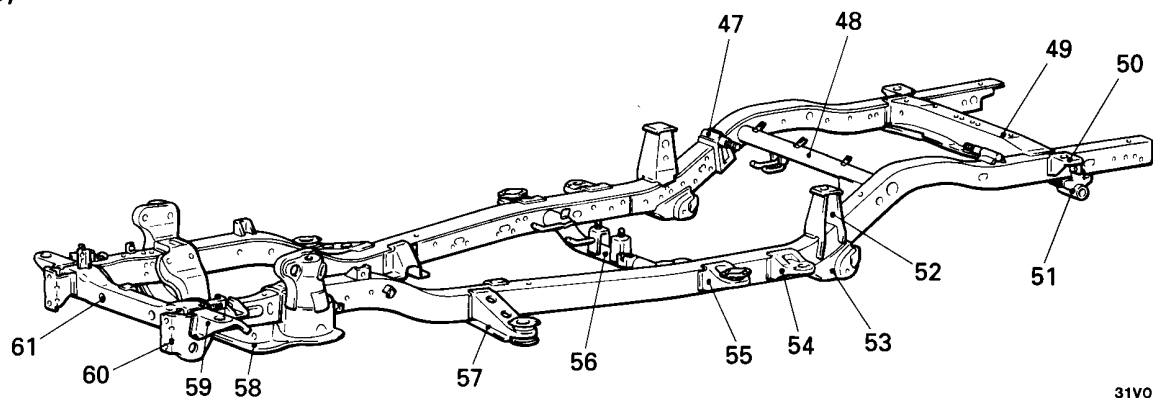

(2WD)

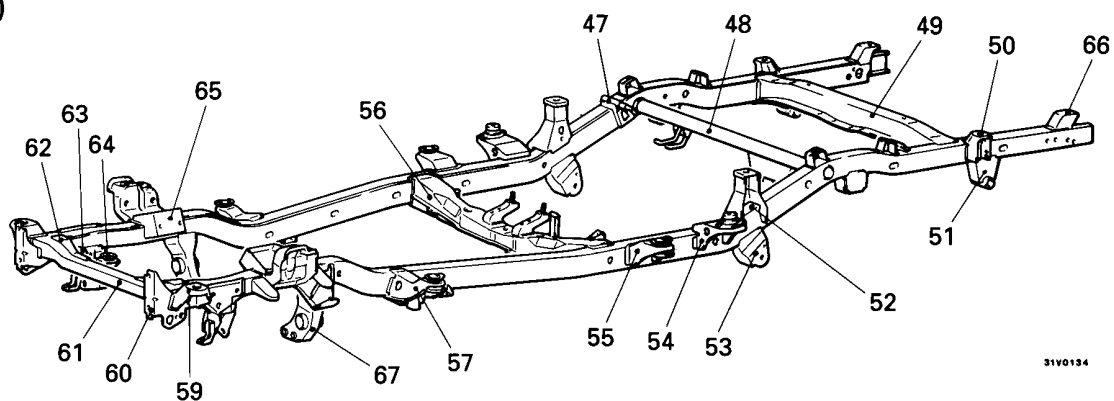

(4WD)



 : High-tensile steel panels.  
 : Anticorrosion steel panels.

1. Front end crossmember
2. Headlamp support panel
3. Front end upper bar
4. Fender shield
5. Hood panel, inner
6. Hood panel, outer
7. Dash panel
8. Cowl top panel
9. Front deck crossmember
10. Front roof rail
11. Roof panel
12. Rear roof rail
13. Front upper frame extension, outer
14. Front pillar, outer
15. Rear panel
16. Center pillar outer reinforcement
17. Quarter panel, inner, upper
18. Quarter panel, outer
19. Rear pillar inner reinforcement
20. Rear pillar, inner, lower
21. Center pillar, inner, lower
22. Side sill extension, outer
23. Front gate
24. Side gate panel, front
25. Rear gate inner panel
26. Rear gate outer panel
27. Rear combination lamp housing
28. Side panel, outer
29. Rear skirt
30. Front skirt
31. Fuel filler door
32. Rear end sill
33. Rear body floor
34. Front door outer panel
35. Front side door beam
36. Front door inner panel
37. No. 4 body mounting crossmember
38. Rear floor pan
39. Luggage box front panel
40. Backbone reinforcement
41. Front floor pan
42. Front floor crossmember
43. Front floor side sill, outer
44. Front floor side sill, inner
45. Front side sill brace
46. Front fender
47. Absorber bracket
48. No. 4 crossmember
49. No. 5 crossmember
50. No. 2 rear body mounting bracket
51. Shackle bracket
52. No. 1 rear body mounting bracket
53. Front eye bracket
54. No. 4 cab bracket
55. No. 3 cab bracket
56. No. 3 crossmember
57. No. 2 cab bracket
58. Engine mounting crossmember
59. No. 1 cab bracket
60. Bumper bracket
61. No. 1 crossmember
62. Crossmember reinforcement
63. Stabilizer bracket
64. Gear box inner bracket
65. Engine mounting bracket
66. No. 3 rear body mounting bracket
67. Lower arm support bracket

&lt;Double cab&gt;

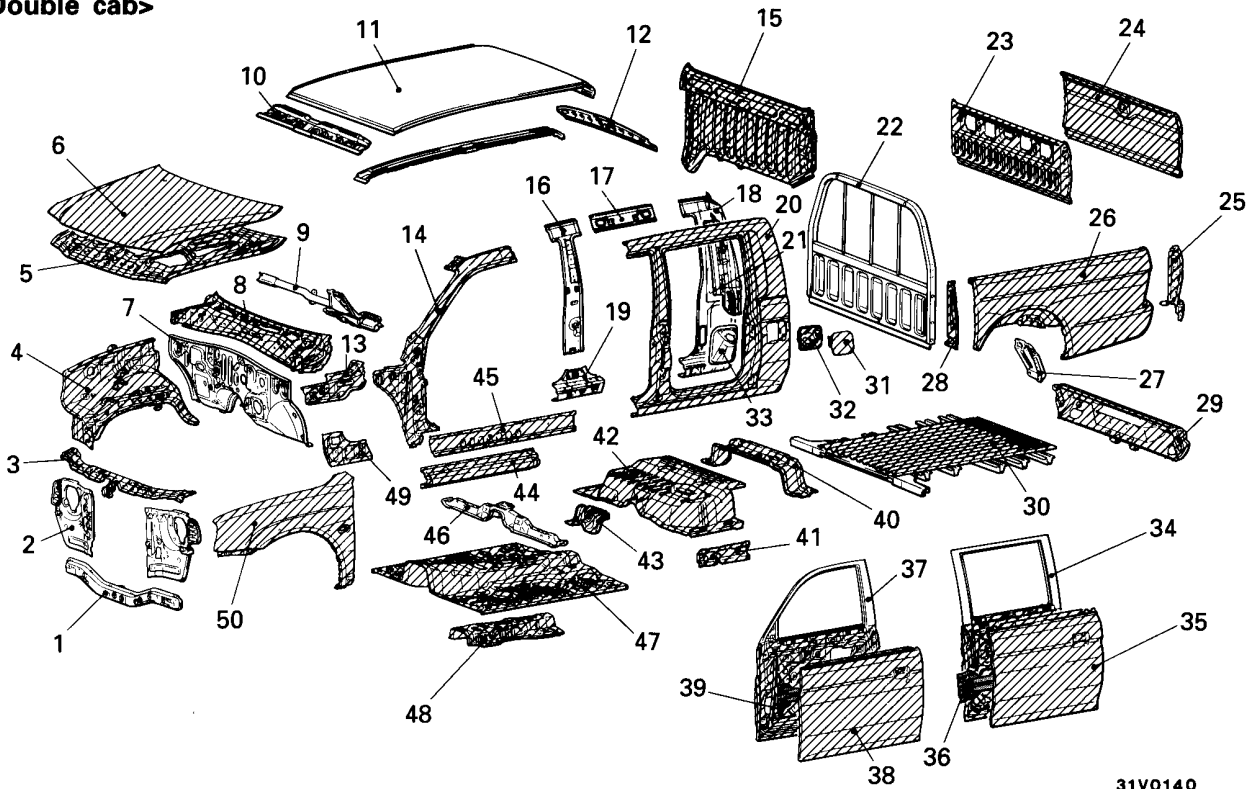

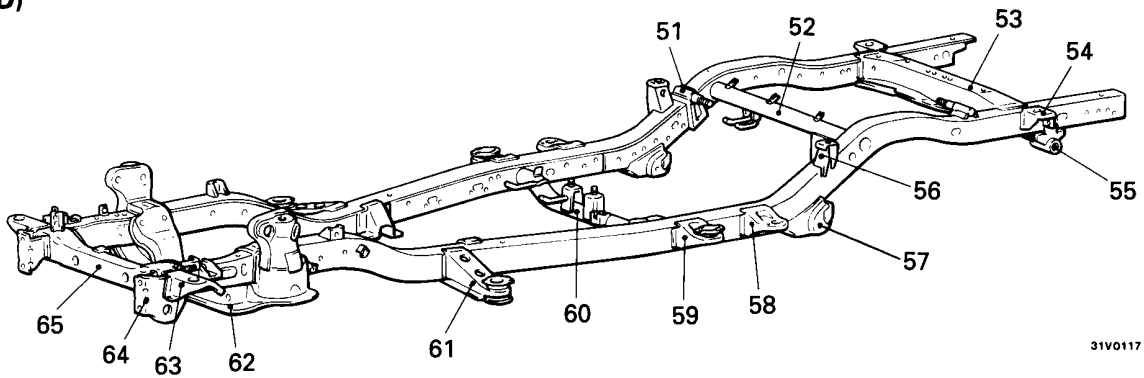

(2WD)

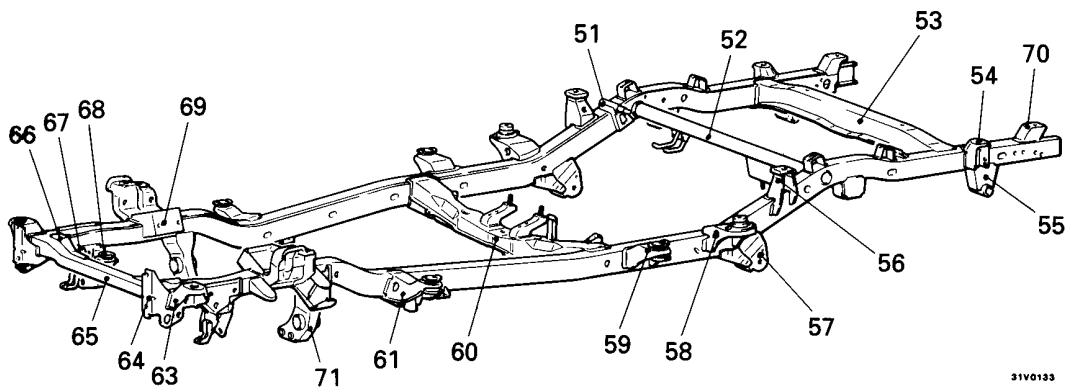

(4WD)



 : High-tensile steel panels.  
 : Anticorrosion steel panels.

- 
- |  |                                      |
|--|--------------------------------------|
| 1. Front end crossmember               | 37. Front door inner panel           |
| 2. Headlamp support panel              | 38. Front door outer panel           |
| 3. Front end upper bar                 | 39. Front side door beam             |
| 4. Fender shield                       | 40. No. 4 body mounting crossmember  |
| 5. Hood panel, inner                   | 41. Rear floor side sill, inner      |
| 6. Hood panel, outer                   | 42. Rear floor pan                   |
| 7. Dash panel                          | 43. Backbone reinforcement extension |
| 8. Cowl top panel                      | 44. Front floor side sill, outer     |
| 9. Front deck crossmember              | 45. Front floor side sill, inner     |
| 10. Front roof rail                    | 46. Front floor crossmember          |
| 11. Roof panel                         | 47. Front floor pan                  |
| 12. Rear roof rail                     | 48. Backbone reinforcement           |
| 13. Front upper frame extension, outer | 49. Front side sill brace            |
| 14. Front pillar, outer                | 50. Front fender                     |
| 15. Rear panel                         | 51. Absorber bracket                 |
| 16. Center pillar, inner               | 52. No. 4 crossmember                |
| 17. Side roof rail, inner              | 53. No. 5 crossmember                |
| 18. Rear pillar, inner                 | 54. No. 2 rear body mounting bracket |
| 19. Center pillar, inner, lower        | 55. Shackle bracket                  |
| 20. Side panel, outer, rear            | 56. No. 1 rear body mounting bracket |
| 21. Rear pillar seatbelt reinforcement | 57. Front eye bracket                |
| 22. Front gate                         | 58. No. 4 cab bracket                |
| 23. Rear gate inner panel              | 59. No. 3 cab bracket                |
| 24. Rear gate outer panel              | 60. No. 3 crossmember                |
| 25. Rear combination lamp housing      | 61. No. 2 cab bracket                |
| 26. Side panel, outer                  | 62. Engine mounting crossmember      |
| 27. Rear skirt                         | 63. No. 1 cab bracket                |
| 28. Side gate panel, front             | 64. Bumper bracket                   |
| 29. Rear end sill                      | 65. No. 1 crossmember                |
| 30. Rear body floor                    | 66. Crossmember reinforcement        |
| 31. Fuel filler door                   | 67. Stabilizer bracket               |
| 32. Fuel filler neck bracket           | 68. Gear box inner bracket           |
| 33. Fuel filler neck bracket, inner    | 69. Engine mounting bracket          |
| 34. Rear door inner panel              | 70. No. 3 rear body mounting bracket |
| 35. Rear door outer panel              | 71. Lower arm support bracket        |
| 36. Rear side door beam                |                                      |

# BODY CONSTRUCTION CHARACTERISTICS

## BODY MAIN CROSS-SECTIONAL VIEWS

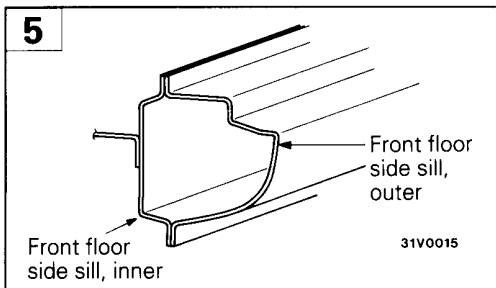
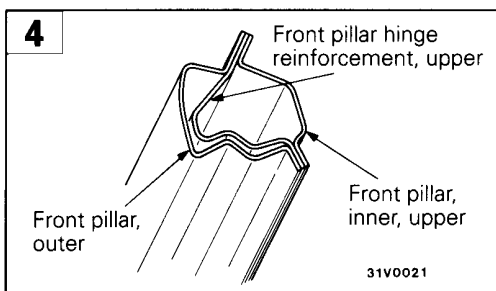
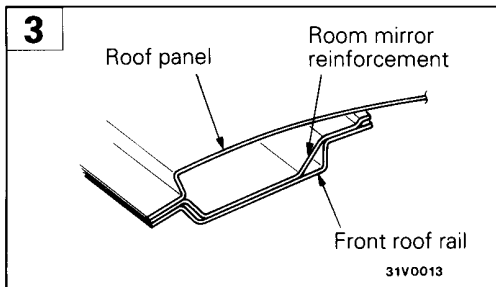
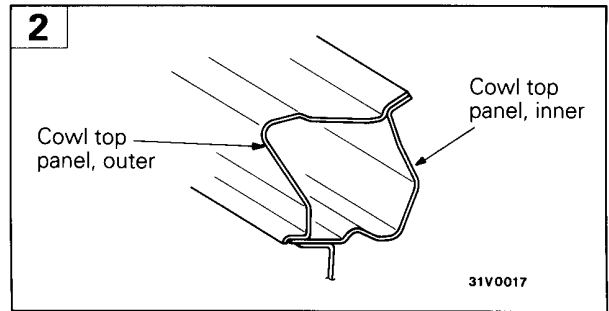
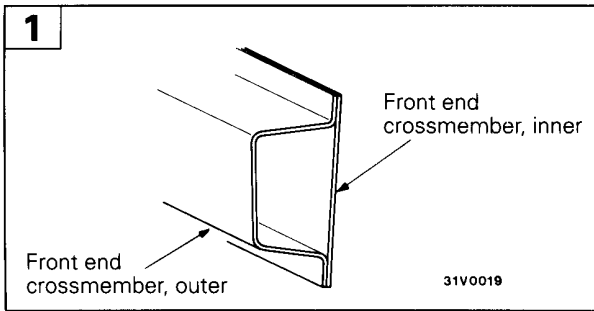

<Single cab>

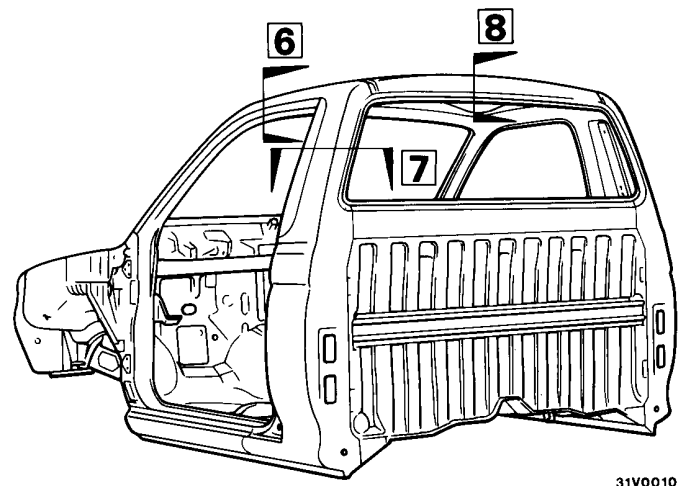
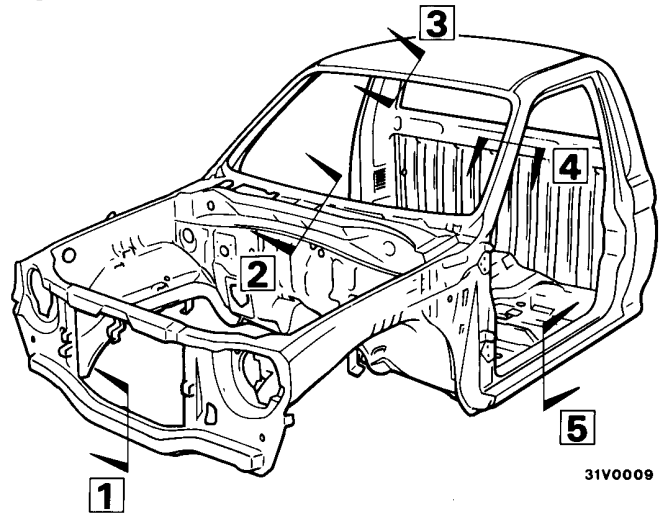



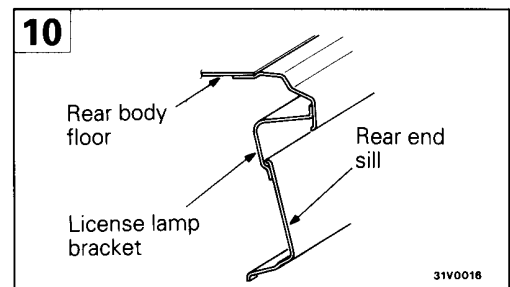
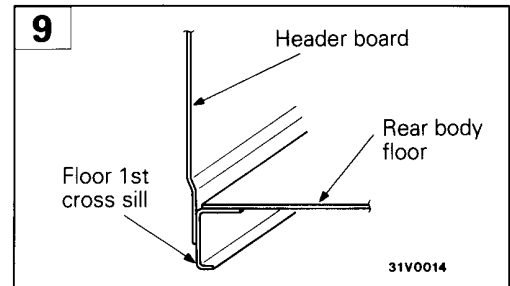
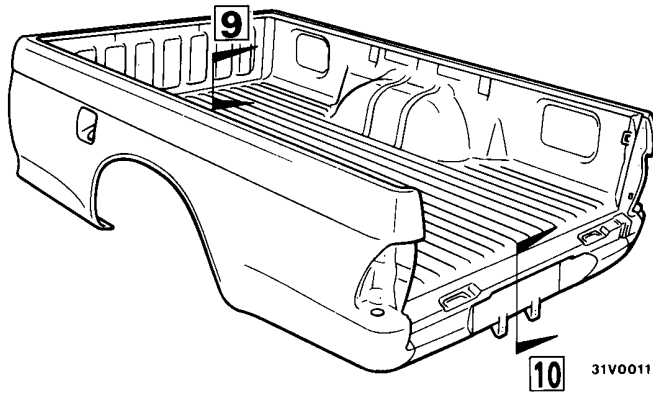
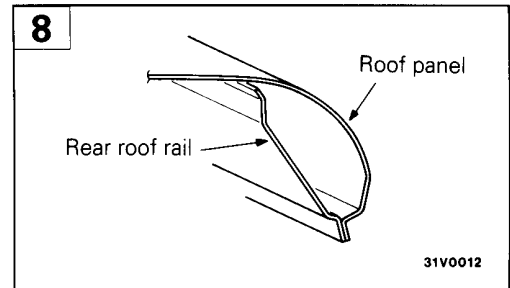
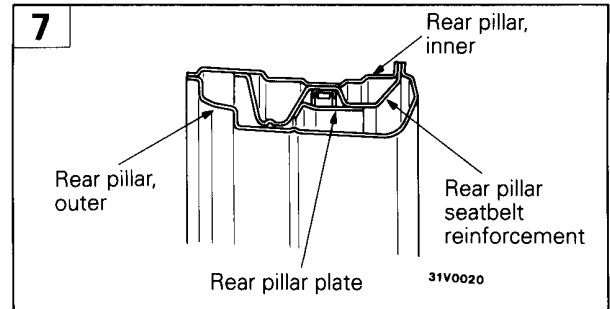
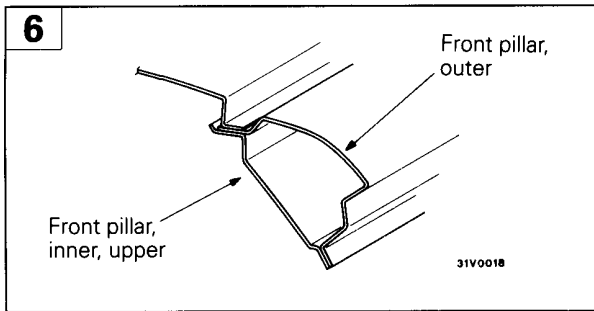

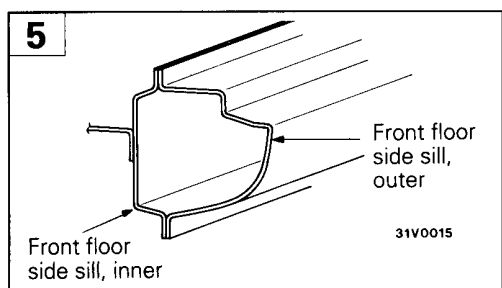
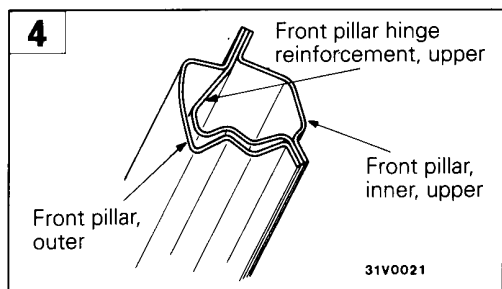
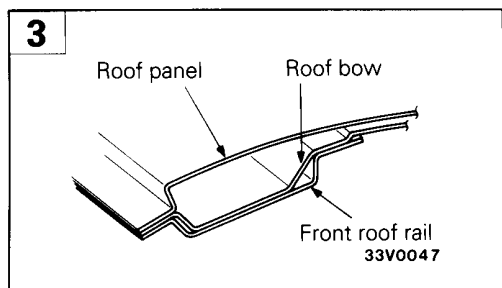
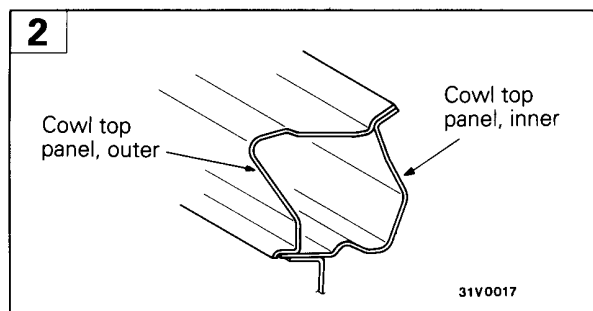
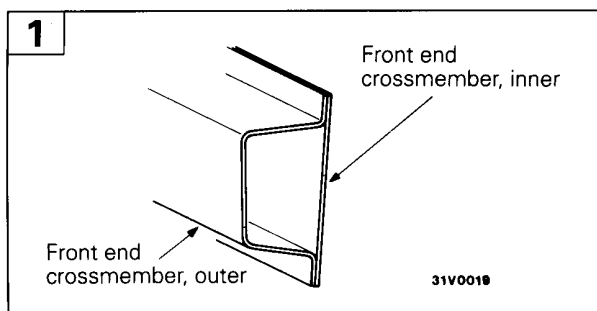

&lt;Club cab&gt;

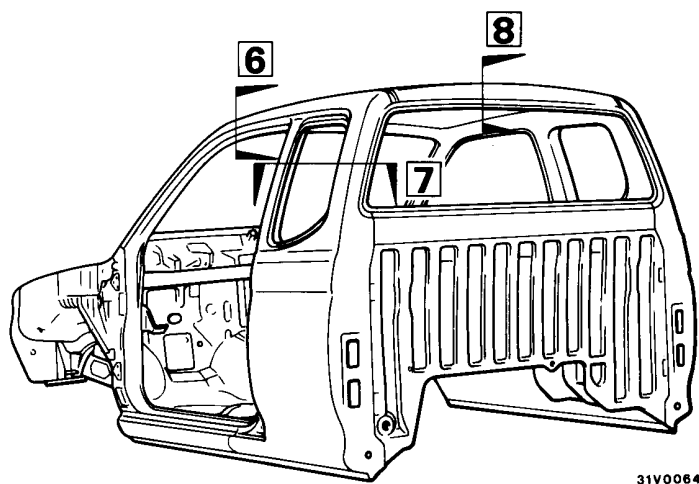
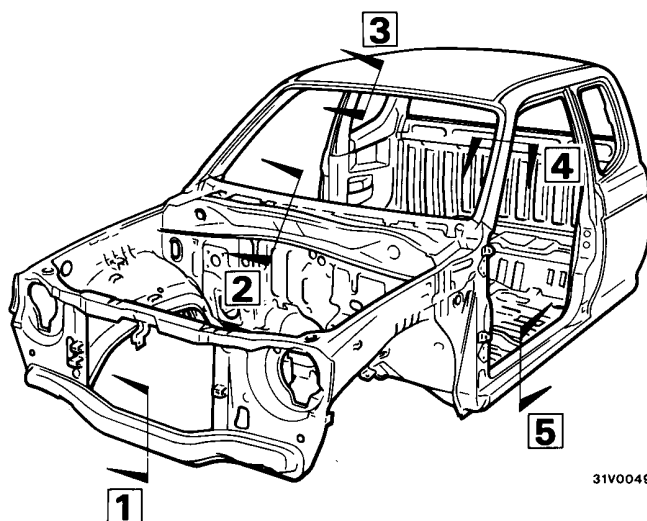

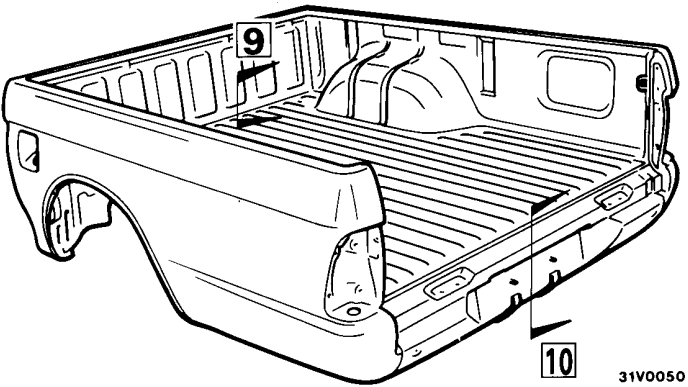
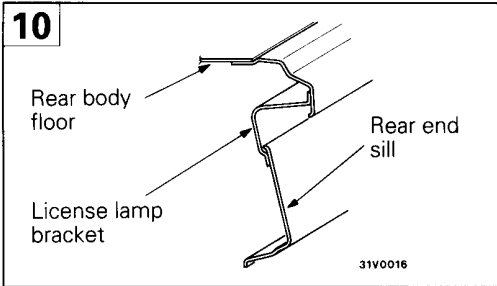
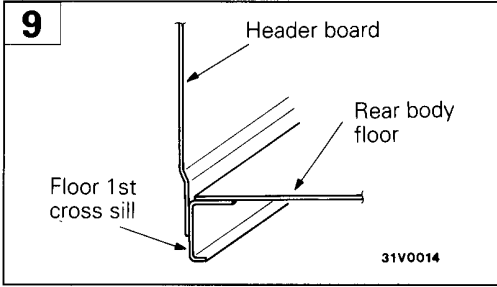
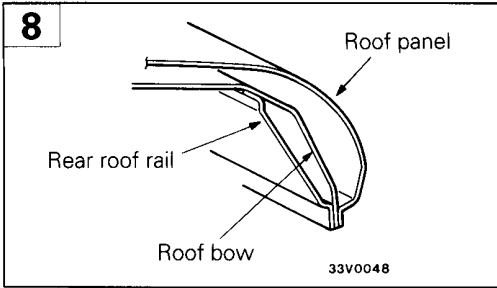
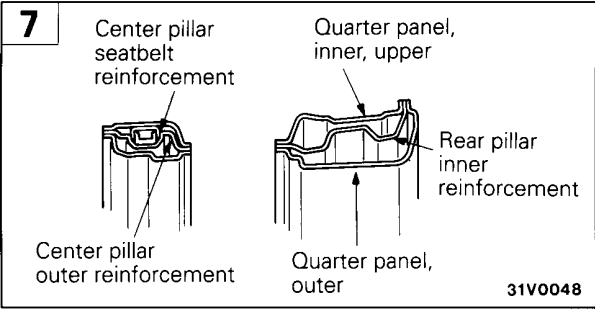
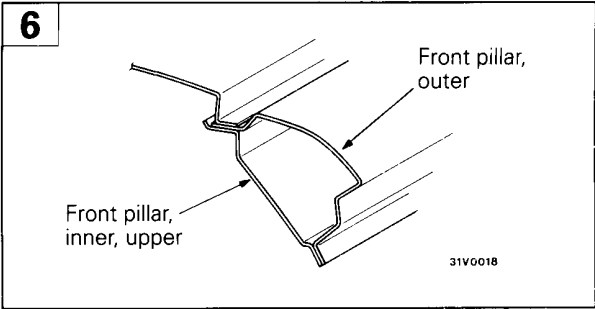

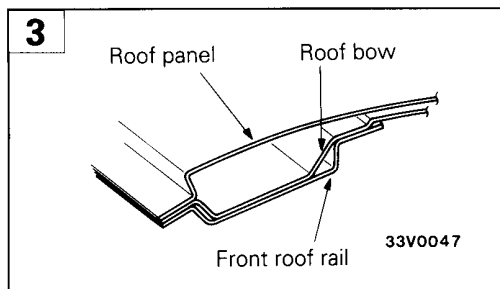
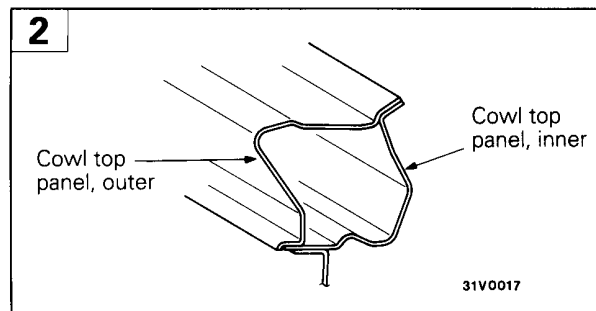
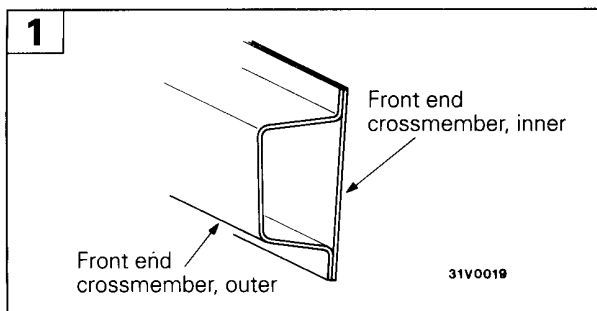

<Double cab>

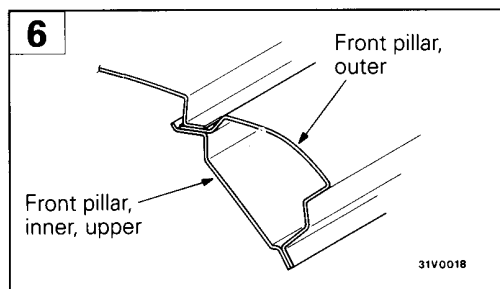
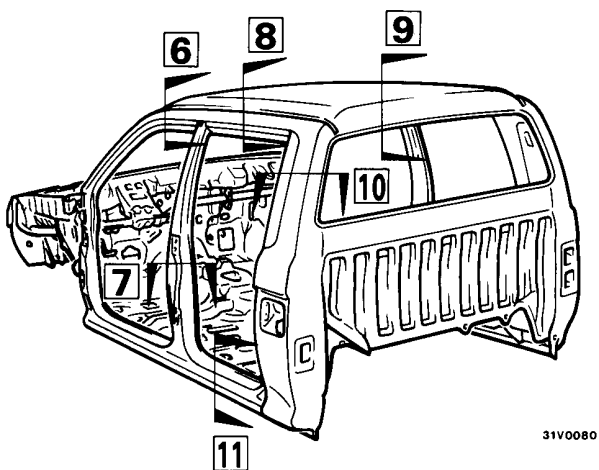
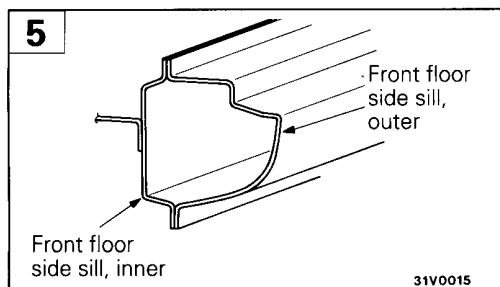
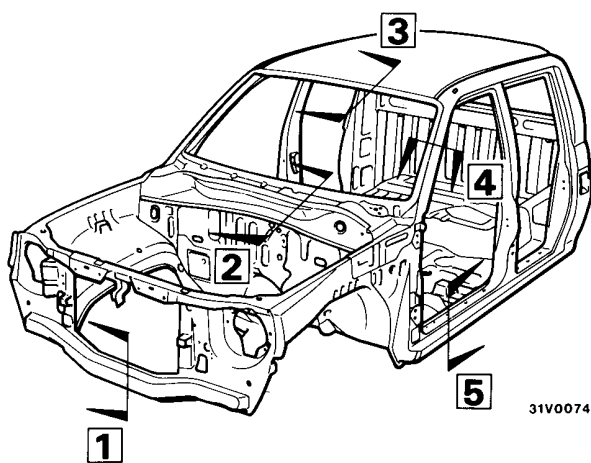
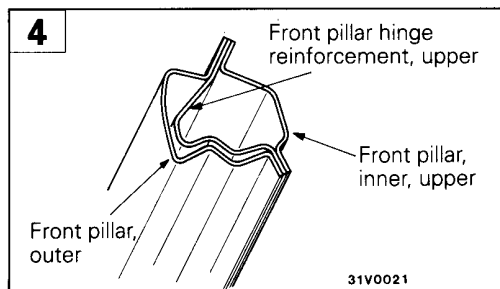

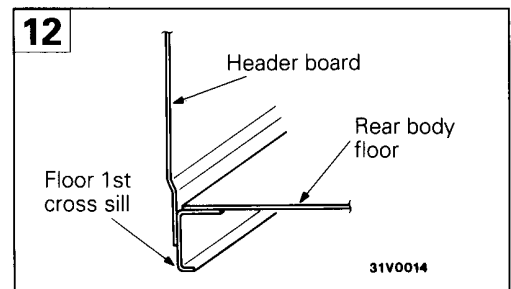
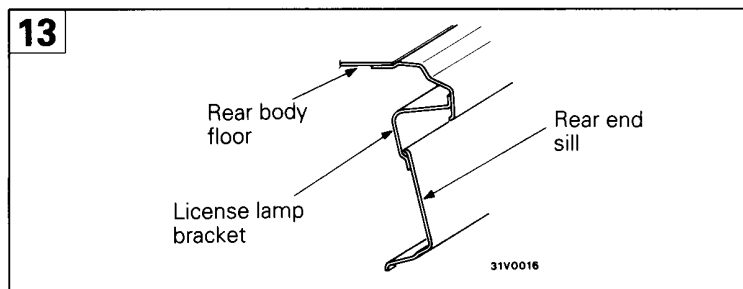
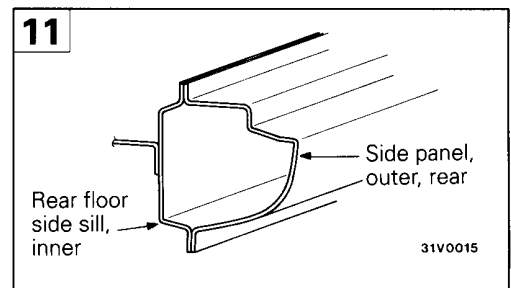
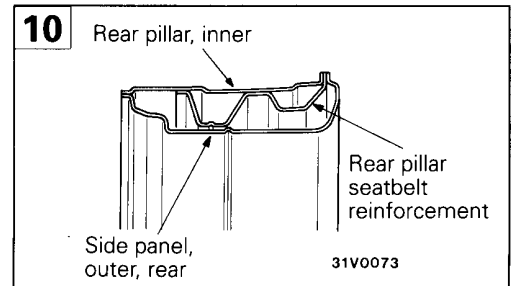
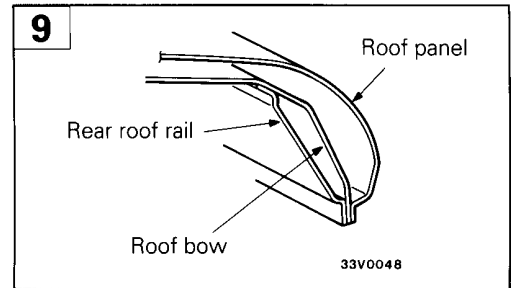
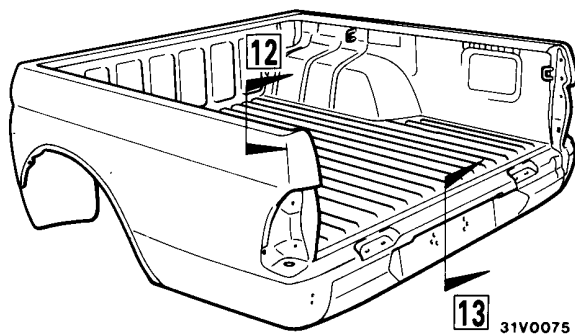
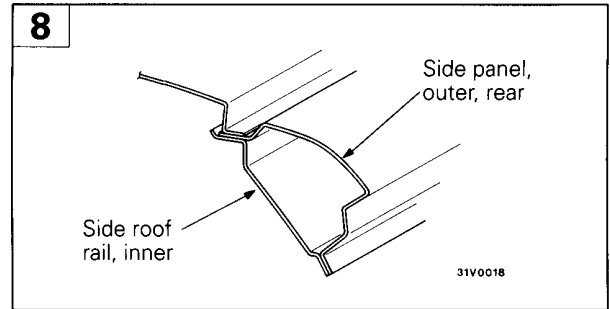
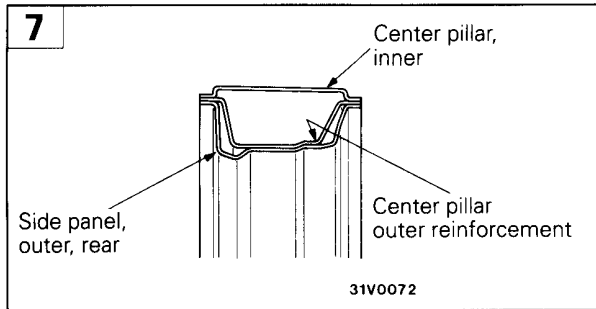

**MAINTENANCE, SERVICEABILITY****SIDE STRUCTURE**

The door opening section is provided with panel positioning notches to improve workability when replacing panels.

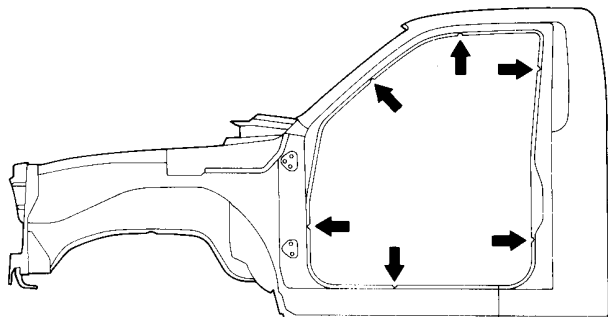
**<Single cab>**

32V0045

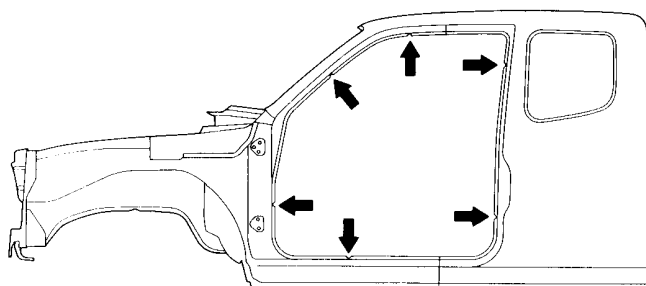
**<Club cab>**

32V0069

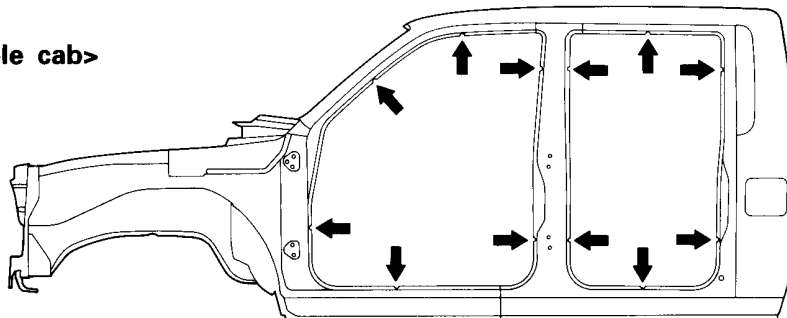
**<Double cab>**

31V0068

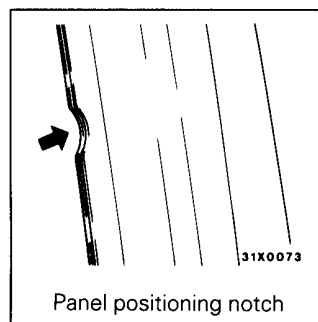

Panel positioning notch

## FRONT BODY

### HEADLAMP SUPPORT

The headlamp support is of an independent construction which follows that of former models.

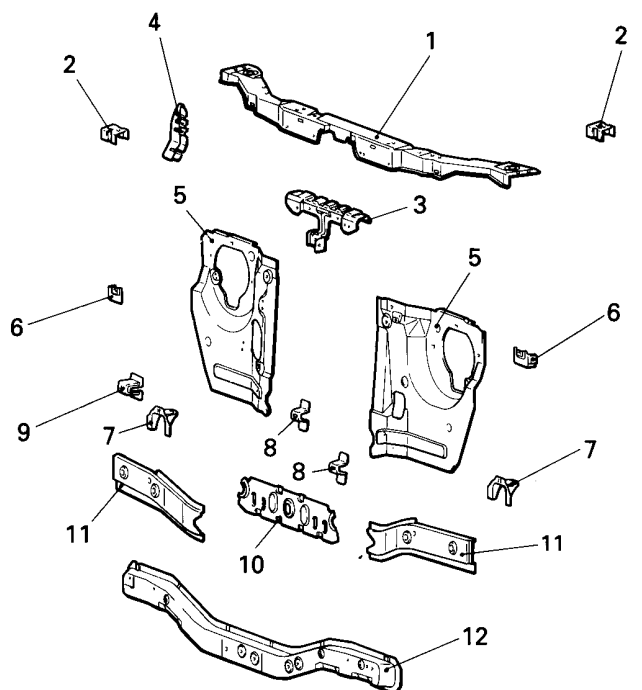

31V0078

- |                            |  |
|----------------------------|--|
| 1. Front end upper bar     | 8. Grille side bracket                   |
| 2. Radiator bracket, upper | 9. Oil cooler bracket                    |
| 3. Hood lock reinforcement | 10. Front end crossmember, inner, center |
| 4. Water proof plate       | 11. Front end inner crossmember          |
| 5. Headlamp support panel  | 12. Front end outer crossmember          |
| 6. Fender bracket          |  |
| 7. Radiator bracket, lower |  |

### FENDER SHIELD

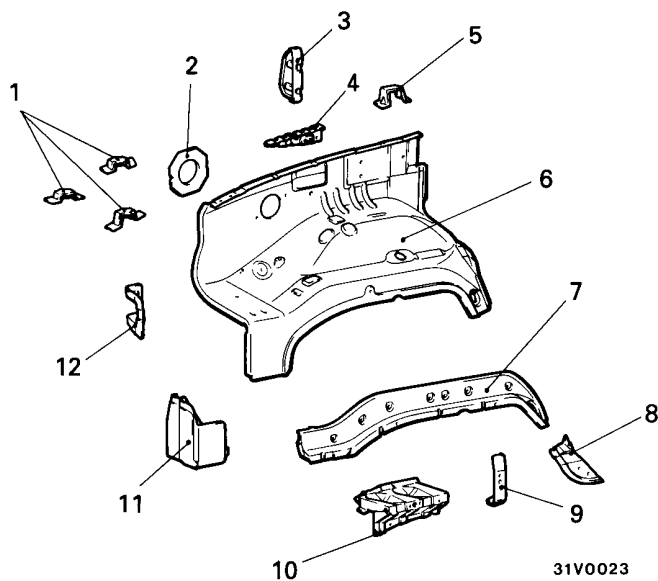

31V0023

- |  |
|--|
| 1. Air cleaner bracket (only R.H.)         |
| 2. Fender shield reinforcement (only R.H.) |
| 3. Baffle plate (only R.H.)                |
| 4. Fender shield reinforcement, upper      |
| 5. Oil reservoir bracket (only R.H.)       |
| 6. Fender shield                           |
| 7. Fender shield reinforcement, lower      |
| 8. Fender shield extension                 |
| 9. Brake hose bracket (2WD)                |
| 10. Battery tray (only L.H.)               |
| 11. No. 1 mounting bracket                 |
| 12. Fender shield gusset                   |

## FRONT DECK

1. Steering column support bracket, upper
2. Steering column support bracket, lower
3. Clutch pedal bracket
4. Cowl top panel, inner
5. Front upper frame extension, inner
6. Air intake duct
7. Front upper frame extension
8. Cowl top outer gusset
9. Cowl top panel, outer
10. Front deck crossmember

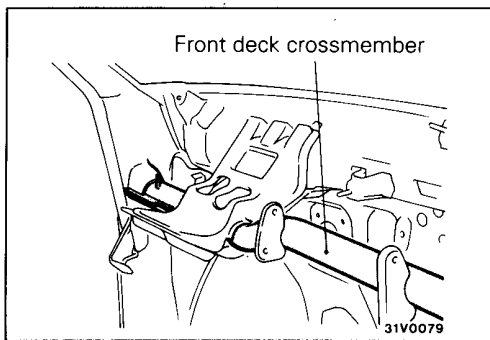
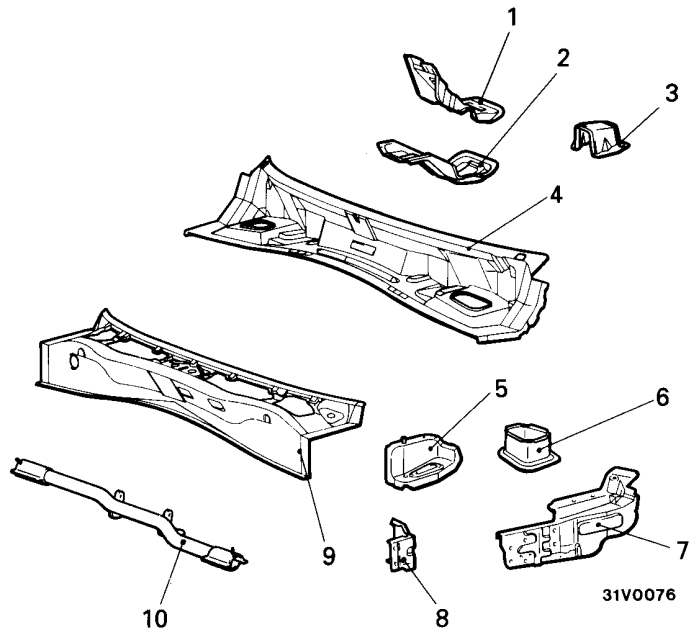

The front deck crossmember has been enlarged to increase the rigidity of the body. In addition, cowl top panels have been separated from the front deck crossmember to help maintain enough space in the passenger compartment for the passengers during a front-on collision by preventing backward movement of the steering wheel.

## DASH PANEL

1. Dash panel
2. Junction box bracket
3. Dash panel reinforcement
4. Fuel filter reinforcement

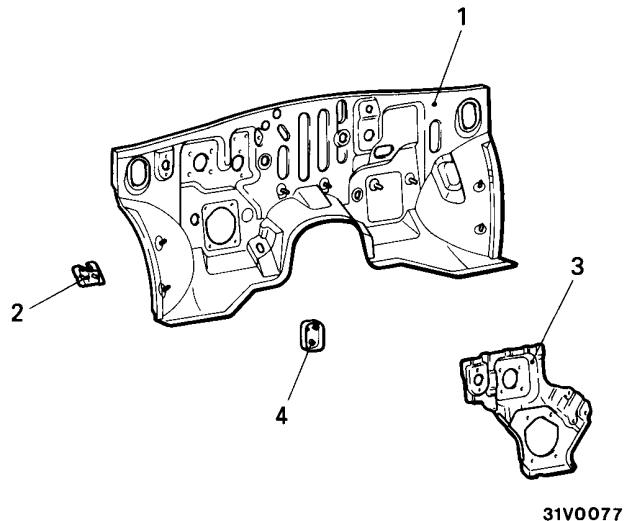



# SIDE BODY

<Single cab>

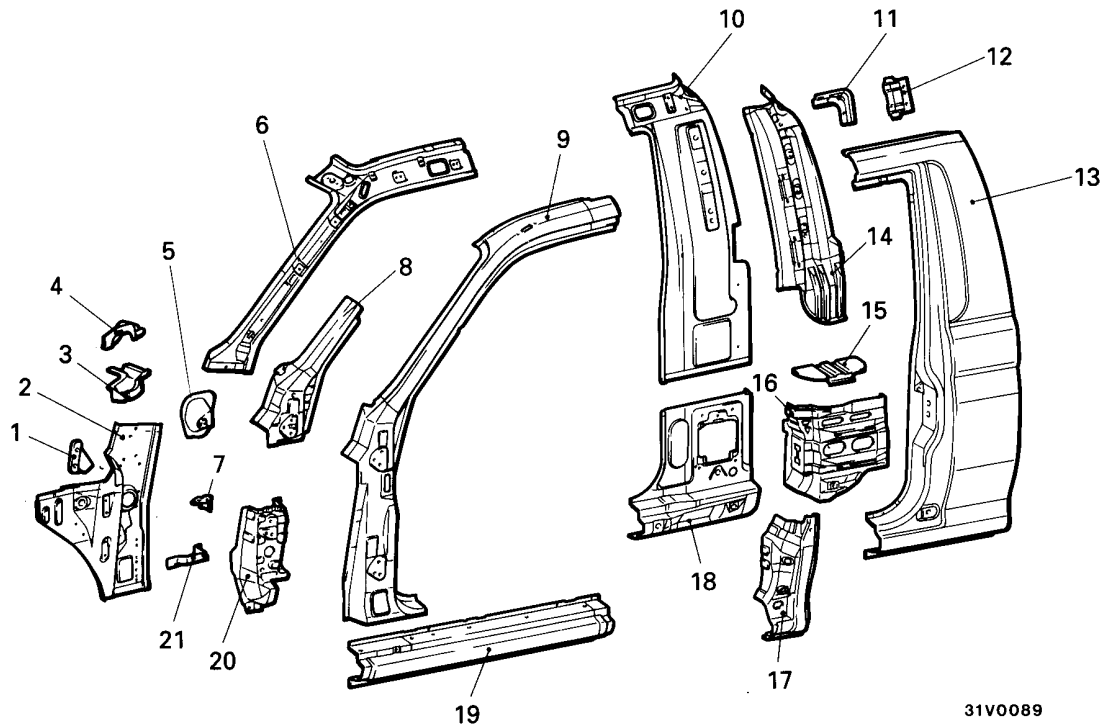

31V0089

- |  |   |
|--|---|
| 1. Instrument panel pillar side bracket    | 12. Rear pillar plate                       |
| 2. Front pillar, inner, lower              | 13. Rear pillar, outer                      |
| 3. Crossmember bracket, lower              | 14. Rear pillar seatbelt reinforcement      |
| 4. Crossmember bracket, upper              | 15. Baffle plate                            |
| 5. Front pillar bulkhead deck crossmember  | 16. Front door striker reinforcement        |
| 6. Front pillar, inner, upper              | 17. Rear pillar outer reinforcement, lower  |
| 7. Door check bracket                      | 18. Rear pillar, inner, lower               |
| 8. Front pillar hinge reinforcement, upper | 19. Front floor side sill, outer            |
| 9. Front pillar, outer                     | 20. Front pillar hinge reinforcement, lower |
| 10. Rear pillar, inner                     | 21. Front door check reinforcement          |
| 11. Rear pillar outer extension            |   |

&lt;Club cab&gt;

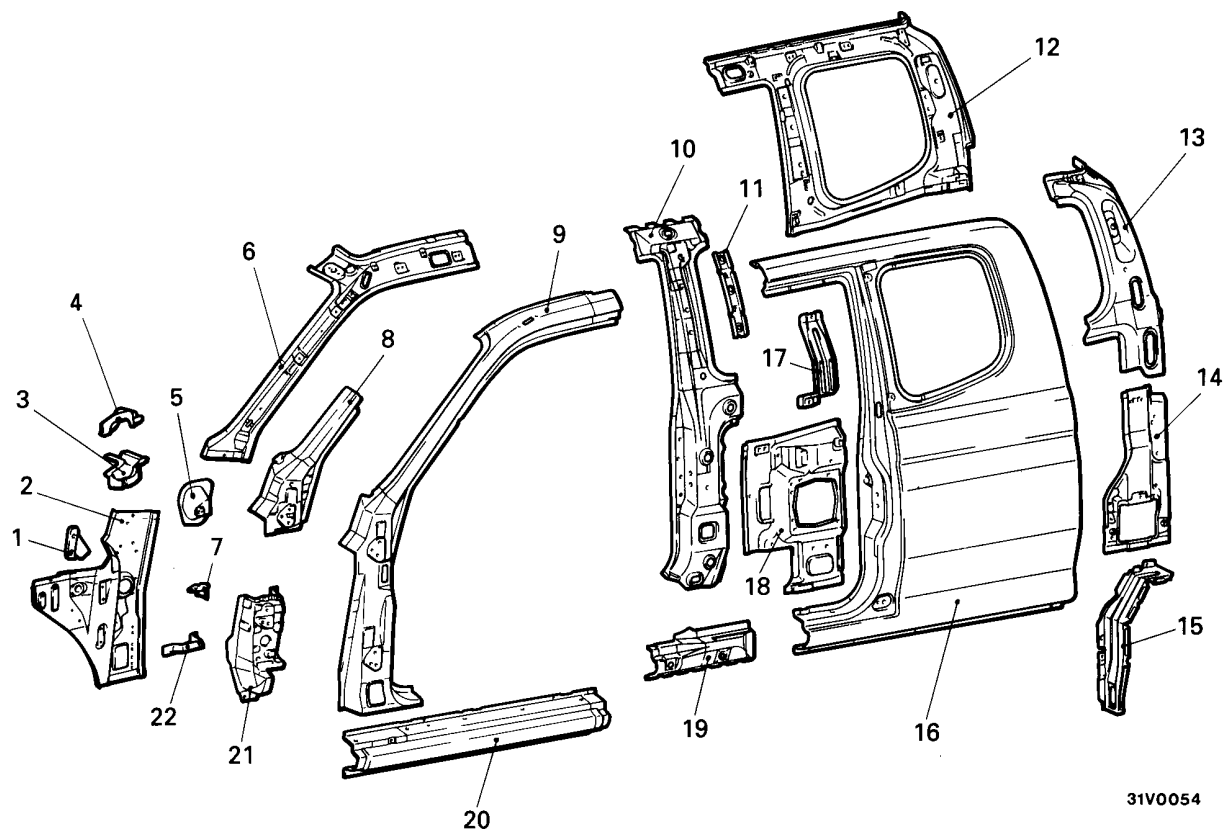

31V0054

1. Instrument panel pillar side bracket
2. Front pillar, inner, lower
3. Crossmember bracket, lower
4. Crossmember bracket, upper
5. Front pillar bulkhead deck crossmember
6. Front pillar, inner, upper
7. Door check bracket
8. Front pillar hinge reinforcement, upper
9. Front pillar, outer
10. Center pillar outer reinforcement
11. Center pillar seatbelt reinforcement

12. Quarter panel, inner, upper
13. Rear pillar inner reinforcement
14. Rear pillar, inner, lower
15. Silencer panel, rear
16. Quarter panel, outer
17. Quarter outer reinforcement, center
18. Center pillar, inner, lower
19. Side sill extension, outer
20. Front floor side sill, outer
21. Front pillar hinge reinforcement, lower
22. Front door check reinforcement

<Double cab>

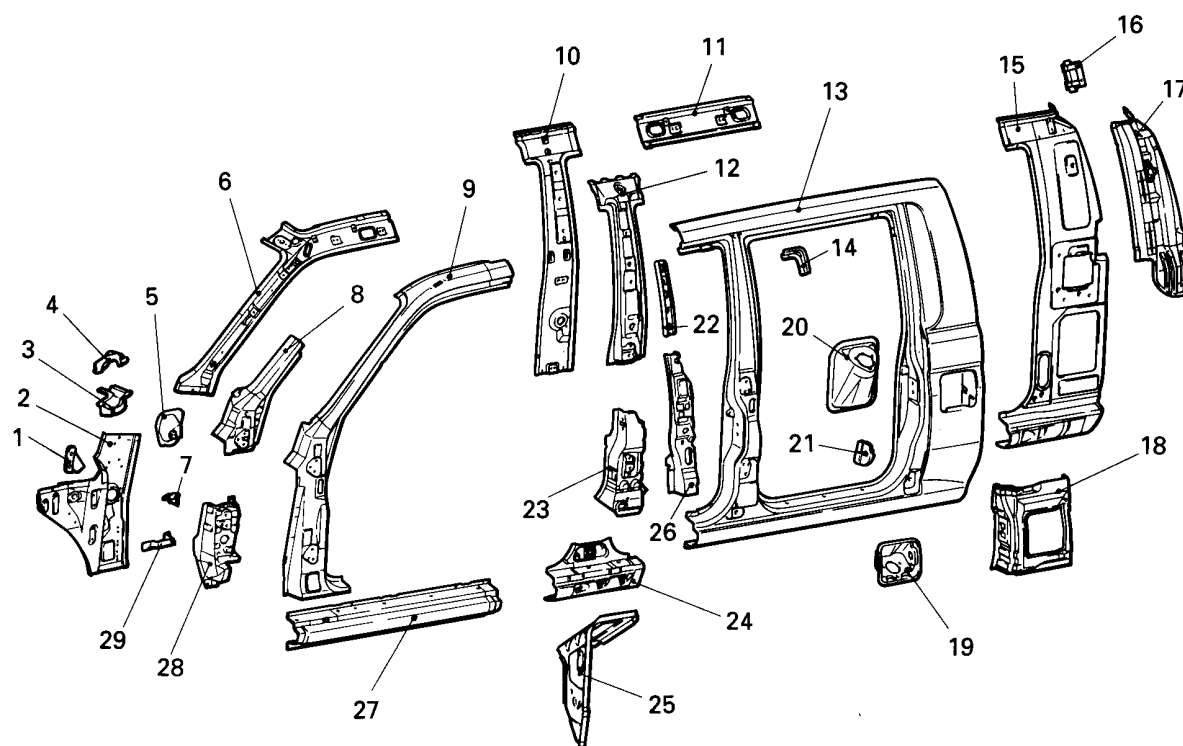

31V0091

- |  |   |
|--|---|
| 1. Instrument panel pillar side bracket    | 16. Rear pillar plate                         |
| 2. Front pillar, inner, lower              | 17. Rear pillar seatbelt reinforcement        |
| 3. Crossmember bracket, lower              | 18. Rear door striker reinforcement           |
| 4. Crossmember bracket, upper              | 19. Fuel filler neck bracket                  |
| 5. Front pillar bulkhead deck crossmember  | 20. Fuel filler neck bracket, inner           |
| 6. Front pillar, inner, upper              | 21. Filler neck cover extension               |
| 7. Door check bracket                      | 22. Center pillar seatbelt reinforcement      |
| 8. Front pillar hinge reinforcement, upper | 23. Center pillar hinge reinforcement, lower  |
| 9. Front pillar, outer                     | 24. Center pillar, inner, lower               |
| 10. Center pillar, inner                   | 25. Fuel filler neck cover                    |
| 11. Side roof rail, inner                  | 26. Center pillar reinforcement, center (2WD) |
| 12. Center pillar outer reinforcement      | 27. Front floor side sill, outer              |
| 13. Side panel, outer, rear                | 28. Front pillar hinge reinforcement, lower   |
| 14. Rear pillar outer extension            | 29. Front door check reinforcement            |
| 15. Rear pillar, inner                     |   |

**SIDE STRUCTURE REINFORCEMENTS**

Large reinforcements have been added to the pillars of the side structure to increase the rigidity of the body and the rigidity of the seatbelt installation part, thus improving passenger's safety.

<Single cab>

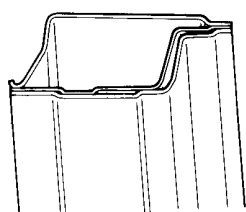
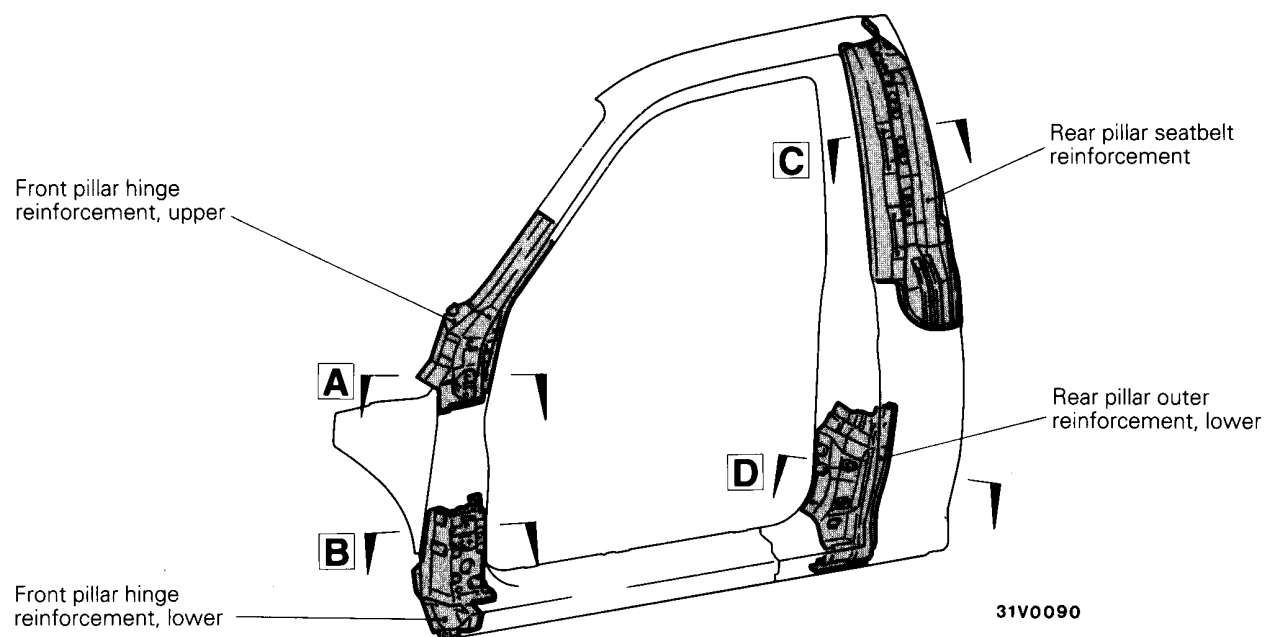

31V0027

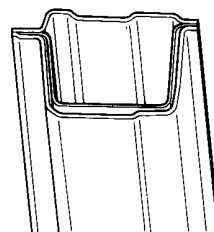
**A**

31V0026

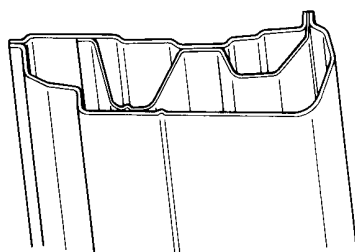
**B**

31V0028

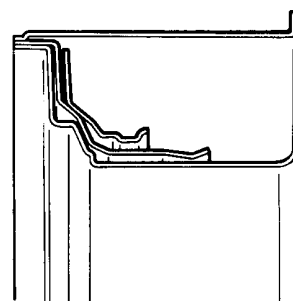
**C**

31V0086

**D**

<Club cab>

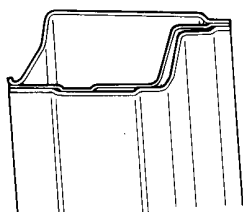
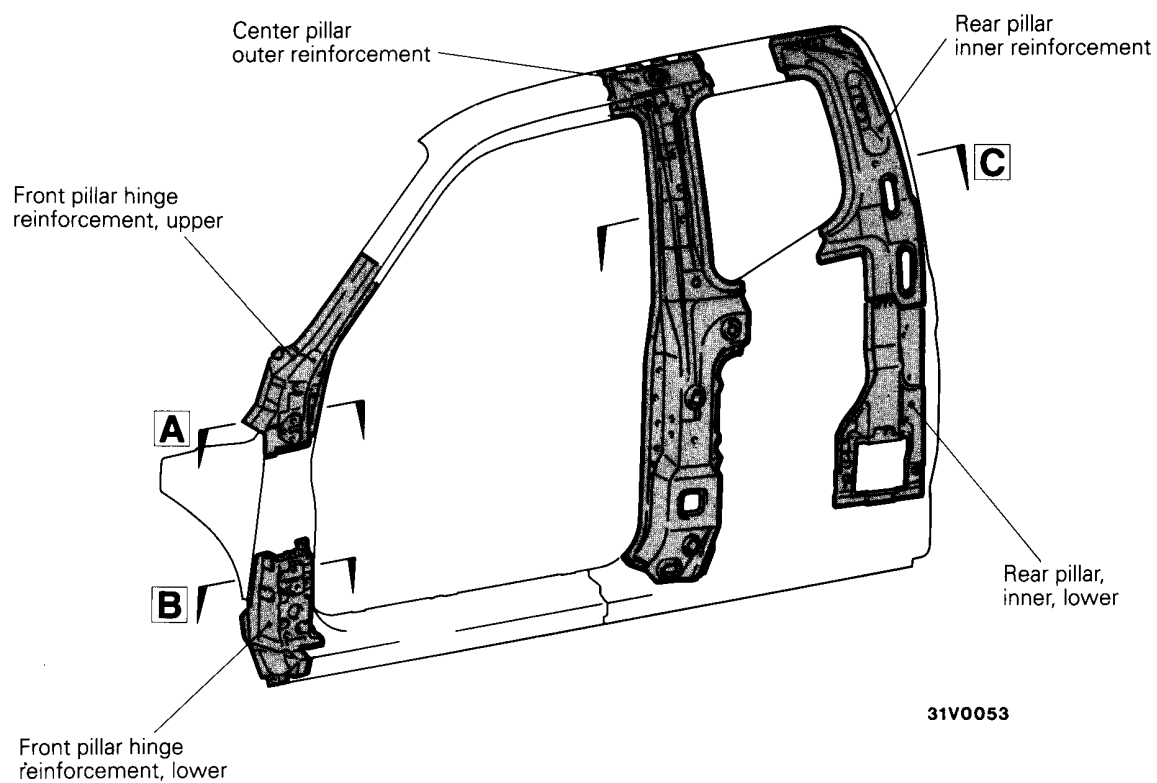

31V0027

**A**



31V0026

**B**

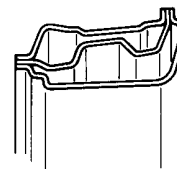

31V0048

**C**

<Double cab>

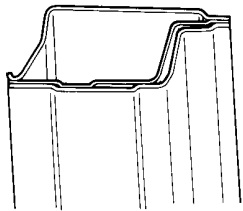
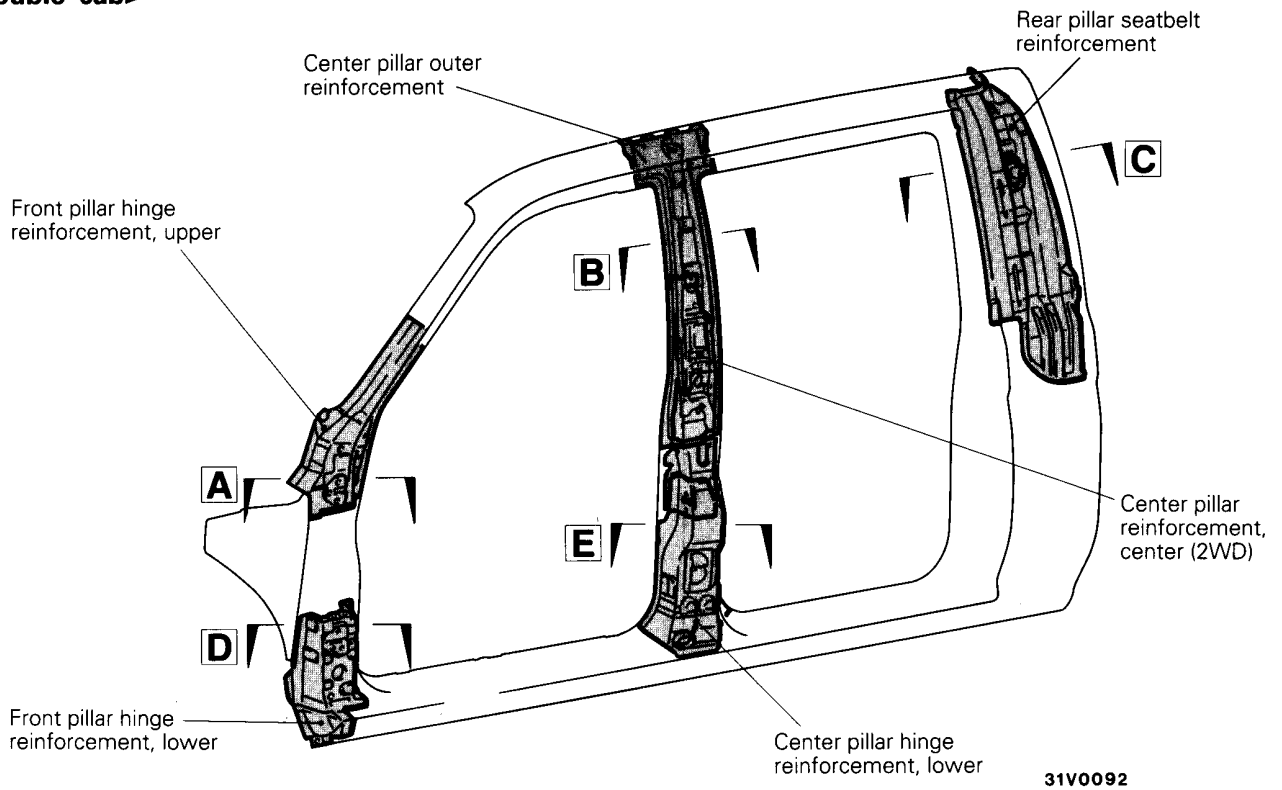

31V0027

A

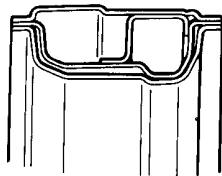

31V0087

B

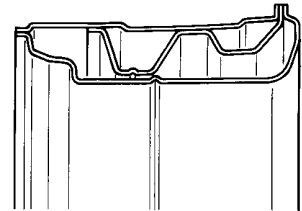

31V0073

C

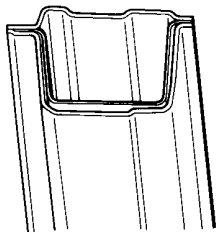

31V0026

D

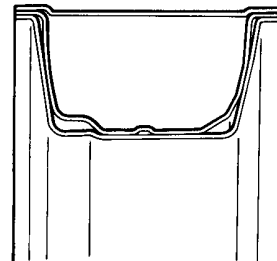

31V0088

E

# UNDER BODY

<Single cab>

(2WD)

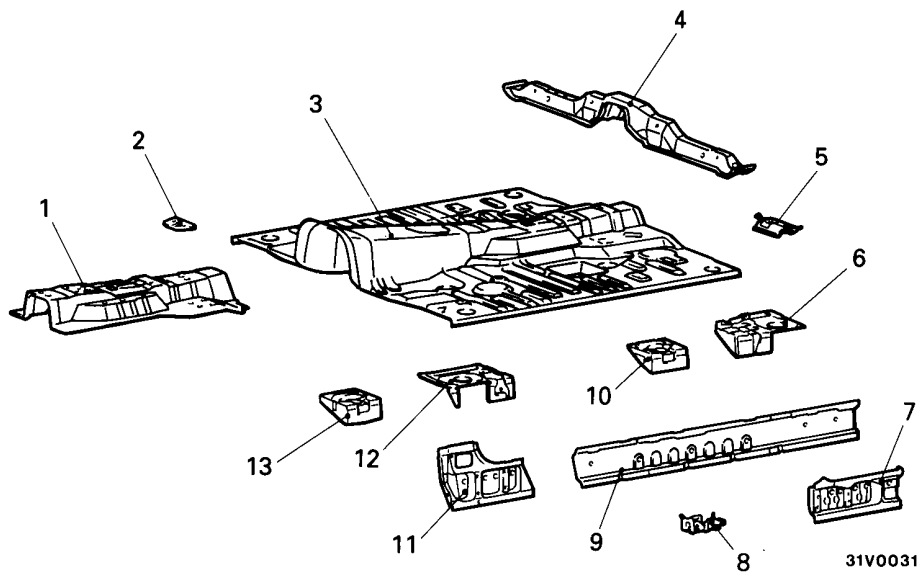

(4WD)

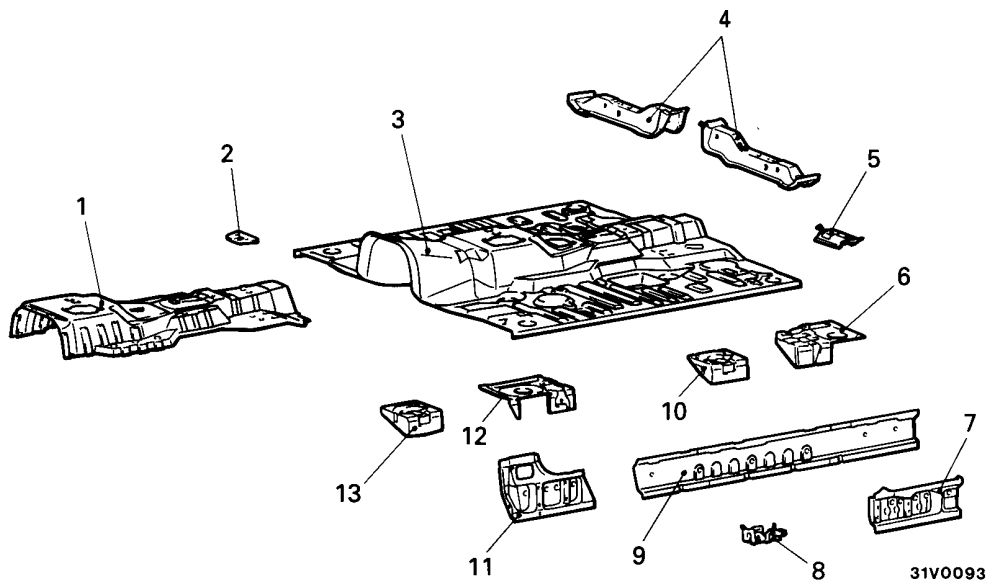

1. Backbone reinforcement
2. Front floor seatbelt reinforcement
3. Front floor pan
4. Front floor crossmember
5. Seat bracket
6. No. 3 body mounting reinforcement
7. Side sill reinforcement, rear

8. Jack bracket
9. Front floor side sill, inner
10. No. 3 body mounting bracket
11. Front side sill brace
12. No. 2 body mounting reinforcement
13. No. 2 body mounting bracket

&lt;Club cab&gt;

(2WD)

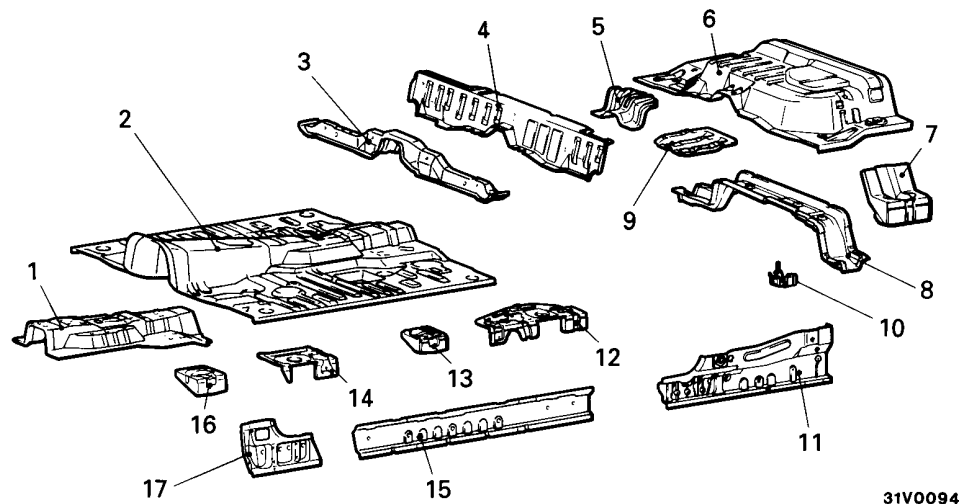

31V0094

(4WD)

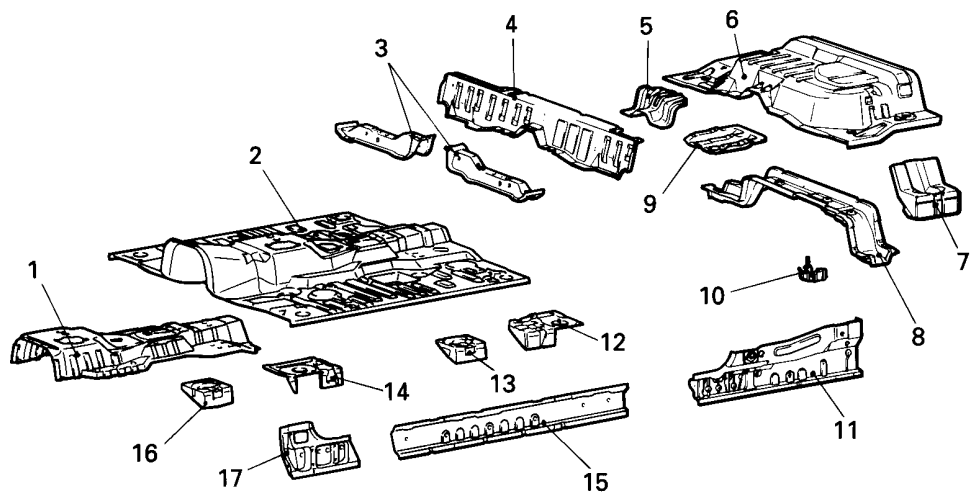

31V0095

- |   |                                       |
|---|---------------------------------------|
| 1. Backbone reinforcement                 | 10. Jack bracket                      |
| 2. Front floor pan                        | 11. Side sill reinforcement, rear     |
| 3. Front floor crossmember                | 12. No. 3 body mounting reinforcement |
| 4. Luggage box front panel                | 13. No. 3 body mounting bracket       |
| 5. Backbone reinforcement extension       | 14. No. 2 body mounting reinforcement |
| 6. Rear floor pan                         | 15. Front floor side sill, inner      |
| 7. No. 4 body mounting bracket            | 16. No. 2 body mounting bracket       |
| 8. No. 4 body mounting crossmember        | 17. Front side brace                  |
| 9. Backbone reinforcement extension, rear |                                       |



<Double cab>

(2WD-M/T)

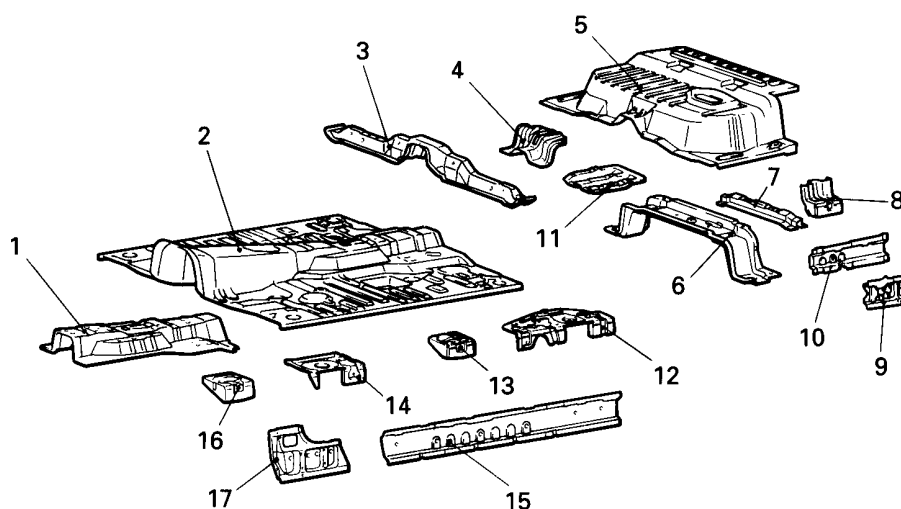

31V0096

(2WD-A/T, 4WD)

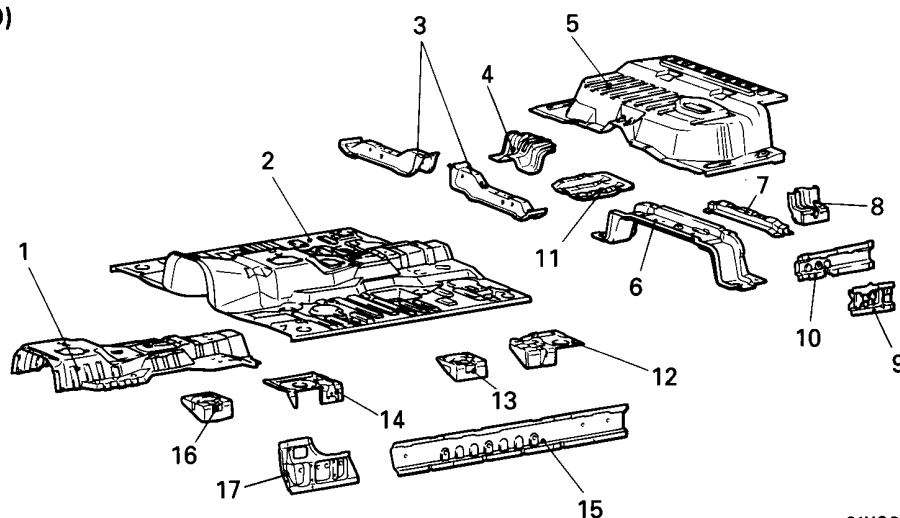

31V0097

- |                                      |  |
|--------------------------------------|--|
| 1. Backbone reinforcement            | 10. Rear floor side sill, inner            |
| 2. Front floor pan                   | 11. Backbone reinforcement extension, rear |
| 3. Front floor crossmember           | 12. No. 3 body mounting reinforcement      |
| 4. Backbone reinforcement extension  | 13. No. 3 body mounting bracket            |
| 5. Rear floor pan                    | 14. No. 2 body mounting reinforcement      |
| 6. No. 4 body mounting crossmember   | 15. Front floor side sill, inner           |
| 7. No. 4 body mounting reinforcement | 16. No. 2 body mounting bracket            |
| 8. No. 4 body mounting bracket       | 17. Front side brace                       |
| 9. Side sill reinforcement, rear     |  |

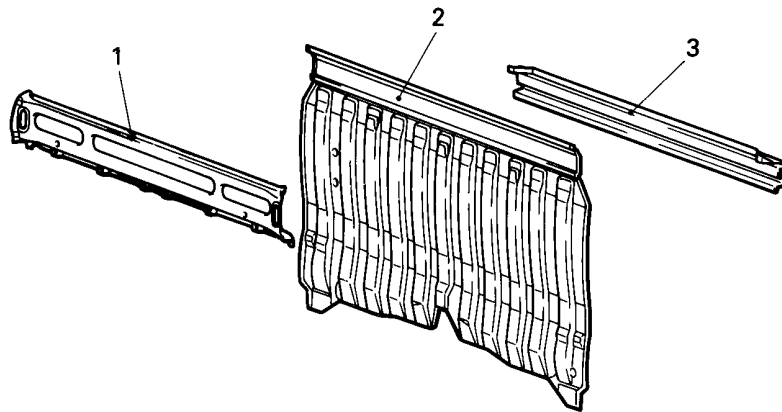
**REAR BODY****<Single cab>**

31V0032

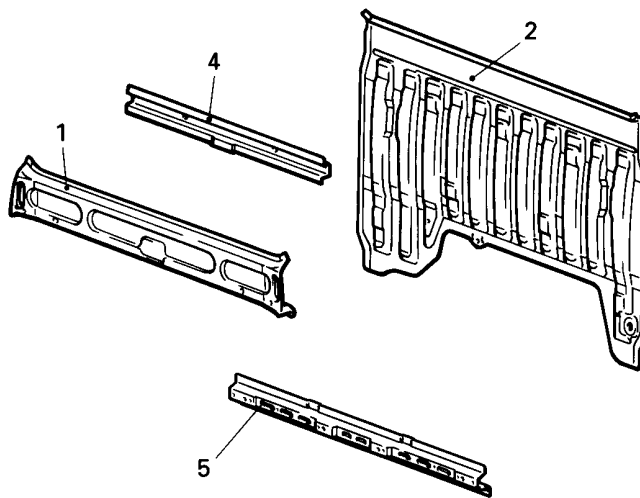
**<Club cab>**

31V0099

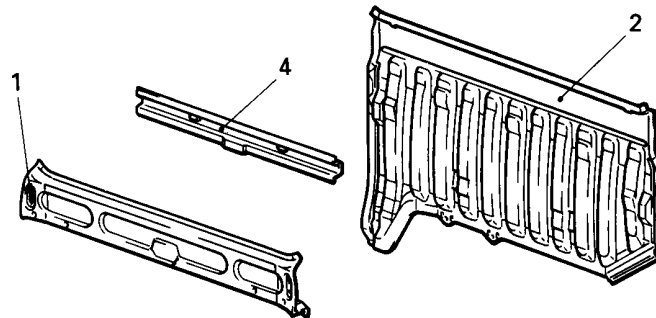
**<Double cab>**

31V0100

1. Rear panel reinforcement
2. Rear panel
3. Rear panel reinforcement, lower
4. Rear panel reinforcement, upper
5. Rear seatback reinforcement

## ROOF

### <Single cab>

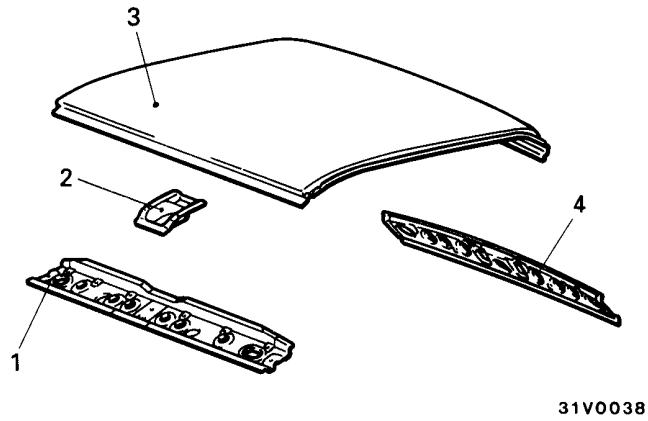

### <Club cab>

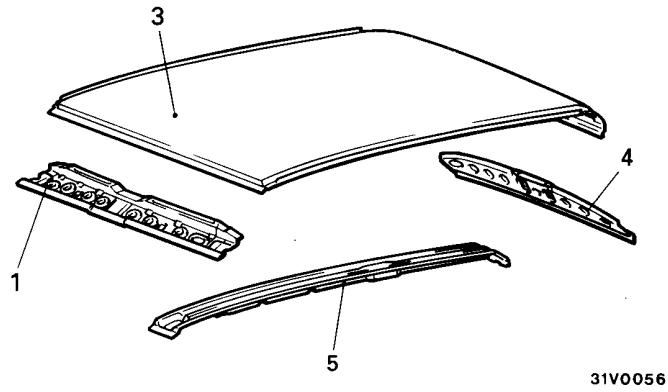

### <Double cab>

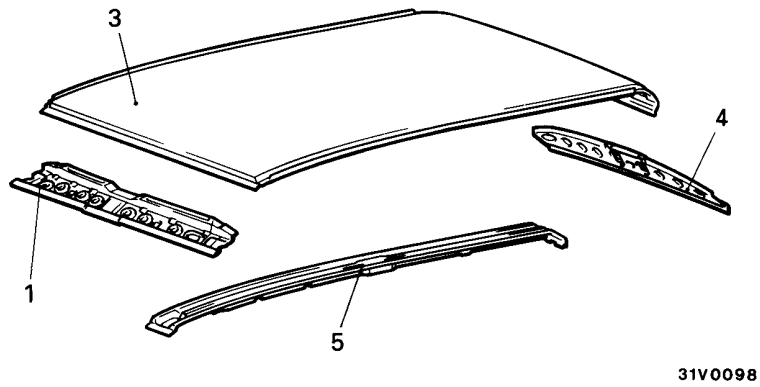

1. Front roof rail
2. Room mirror reinforcement
3. Roof panel
4. Rear roof rail
5. Roof bow

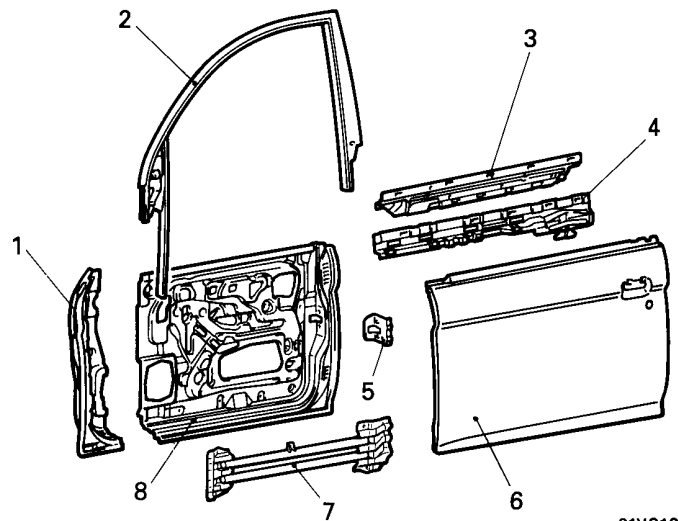
**DOOR****Front door**

31V0101

1. Front door hinge panel
2. Front door window sash
3. Front door beltline inner reinforcement
4. Front door beltline outer reinforcement
5. Front door latch reinforcement
6. Front door outer panel
7. Front side door beam
8. Front door inner panel

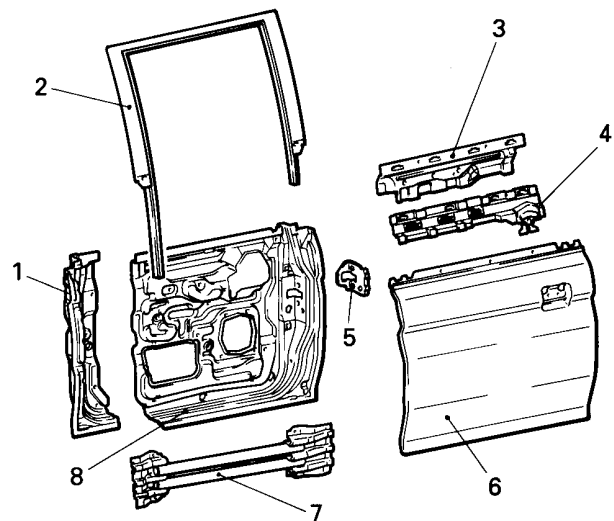
**Rear door**

31V0102

1. Rear door hinge panel
2. Rear door window sash
3. Rear door beltline inner reinforcement
4. Rear door beltline outer reinforcement
5. Rear door latch reinforcement
6. Rear door outer panel
7. Rear side door beam
8. Rear door inner panel

# CARRIER

<Single cab>

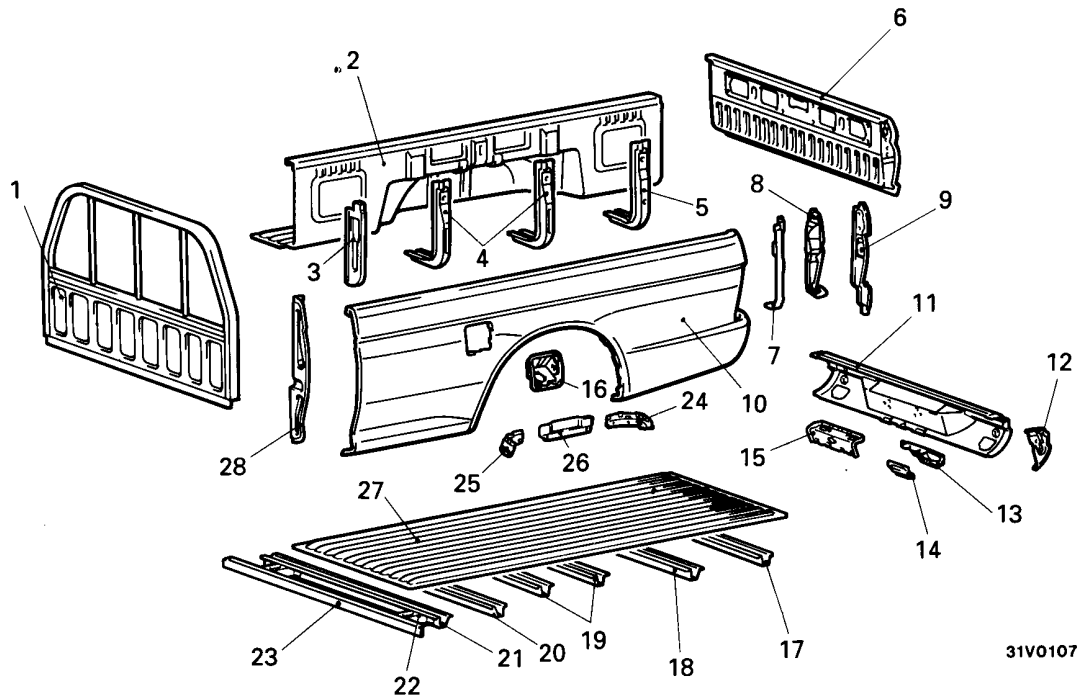

31V0107

- |                                     |                               |
|-------------------------------------|-------------------------------|
| 1. Front gate                       | 15. License lamp bracket      |
| 2. Side panel, inner                | 16. Fuel filler neck bracket  |
| 3. Side panel inner front extension | 17. Floor 5th cross sill      |
| 4. Side gate post, front            | 18. Floor 4th cross sill      |
| 5. Side gate post, rear             | 19. Center cross sill         |
| 6. Rear gate                        | 20. Floor 3rd cross sill      |
| 7. Side panel inner rear extension  | 21. Floor 2nd cross sill      |
| 8. Rear combination lamp housing    | 22. Rear body bracket         |
| 9. Side gate rear reinforcement     | 23. Floor 1st cross sill      |
| 10. Side panel, outer               | 24. Shield rubber bracket (B) |
| 11. Rear end sill                   | 25. Shield rubber bracket (A) |
| 12. Rear end outer bulkhead         | 26. Shield rubber bracket (C) |
| 13. Hinge reinforcement             | 27. Floor panel               |
| 14. Hinge bracket                   | 28. Side gate panel, front    |

&lt;Club cab&gt;

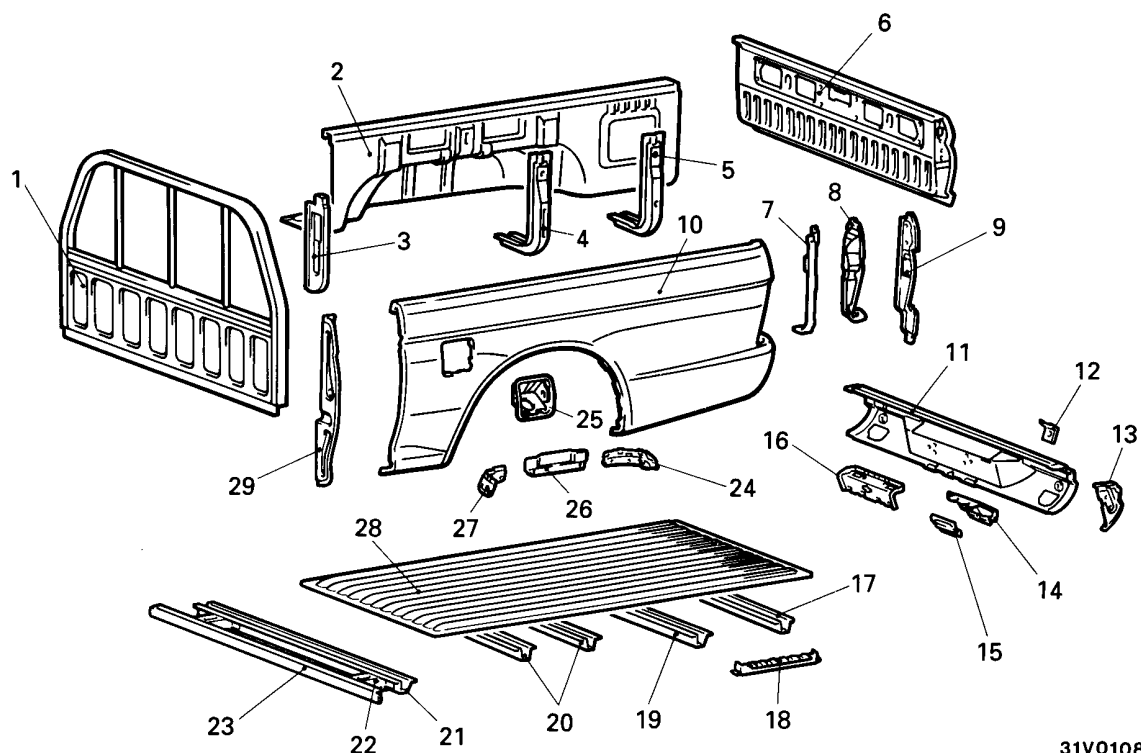

31V0108

- |                                     |                                    |
|-------------------------------------|------------------------------------|
| 1. Front gate                       | 16. License lamp bracket           |
| 2. Side panel, inner                | 17. Floor 4th cross sill           |
| 3. Side panel inner front extension | 18. Cross sill reinforcement, rear |
| 4. Side gate post, front            | 19. Floor 3rd cross sill           |
| 5. Side gate post, rear             | 20. Center cross sill              |
| 6. Rear gate                        | 21. Floor 2nd cross sill           |
| 7. Side panel inner rear extension  | 22. Rear body bracket              |
| 8. Rear combination lamp housing    | 23. Floor 1st cross sill           |
| 9. Side gate rear reinforcement     | 24. Shield rubber bracket (B)      |
| 10. Side panel, outer               | 25. Fuel filler neck bracket       |
| 11. Rear end sill                   | 26. Shield rubber bracket (C)      |
| 12. Stopper reinforcement           | 27. Shield rubber bracket (A)      |
| 13. Rear end outer bulkhead         | 28. Floor panel                    |
| 14. Hinge reinforcement             | 29. Side gate panel, front         |
| 15. Hinge bracket                   |                                    |

<Double cab>

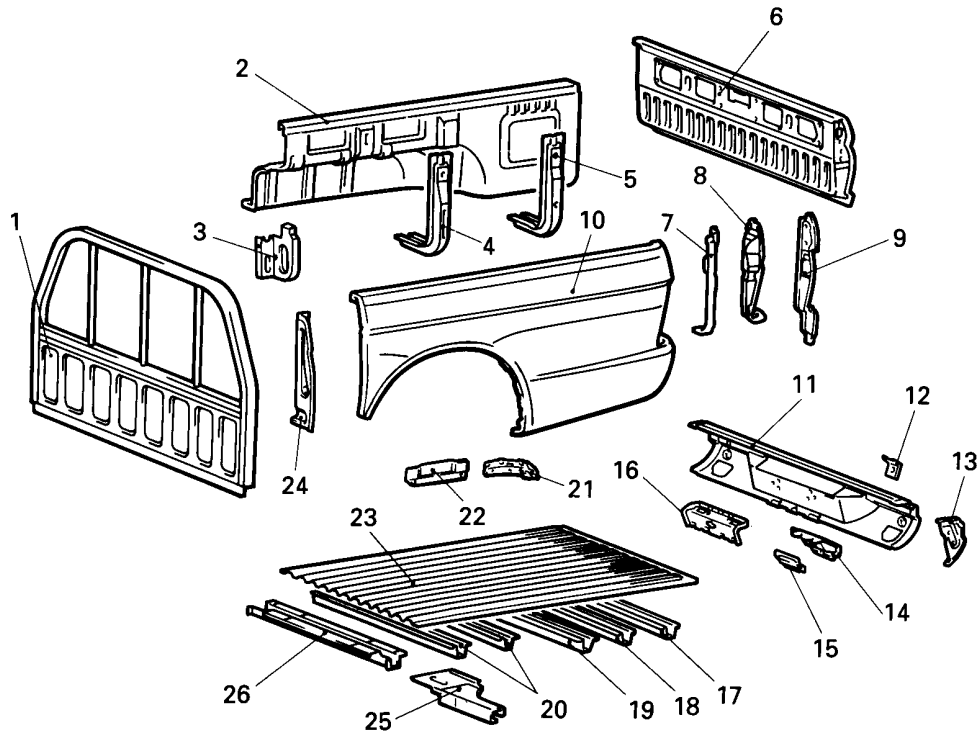

31V0109

1. Front gate
2. Side panel, inner
3. Side panel inner front extension
4. Side gate post, front
5. Side gate post, rear
6. Rear gate
7. Side panel inner rear extension
8. Rear combination lamp housing
9. Side gate rear reinforcement
10. Side panel, outer
11. Rear end sill
12. Stopper reinforcement
13. Rear end outer bulkhead

14. Hinge reinforcement
15. Hinge bracket
16. License lamp bracket
17. Floor 4th cross sill
18. Floor 3rd cross sill
19. Floor 2nd cross sill
20. Center cross sill
21. Shield rubber bracket (B)
22. Shield rubber bracket (C)
23. Floor panel
24. Side gate panel, front
25. Floor 1st cross sill, side
26. Floor 1st cross sill, center

## SILENCER APPLICATION LOCATIONS

In order to reduce vibration and screen out heat from the exhaust gas, silencers (melting sheets) are applied to the top of the floor and to the passenger compartment side of the dash panel ,etc.

### <Single cab>

(L.H. drive vehicles)

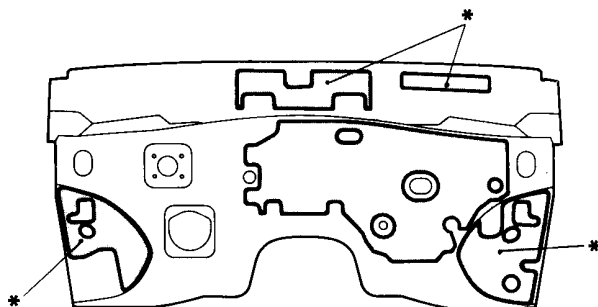

31V0104

(R.H. drive vehicles)

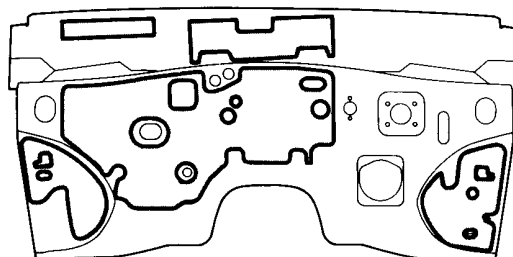

31V0055

Passenger compartment  
side of the dash panel

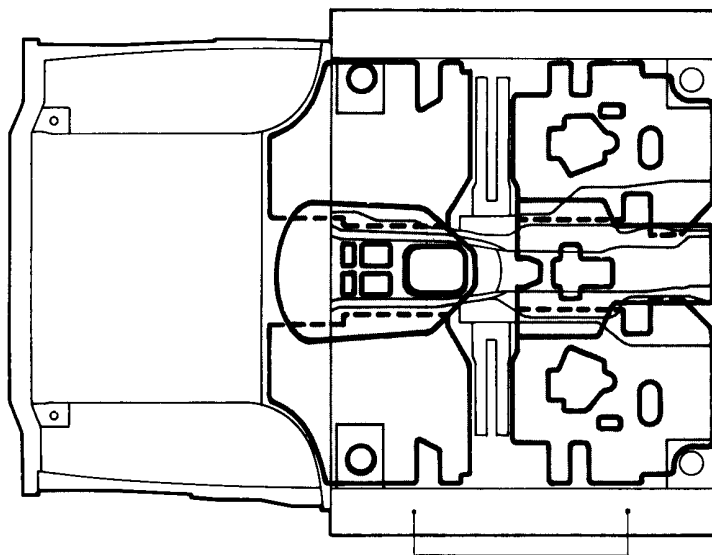

Top of floor pan 31V0040

□ : 1.6 mm thick

#### NOTE

\*: Except petrol-powered vehicles

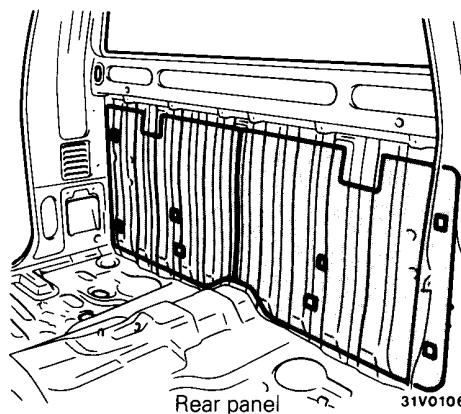

Rear panel

31V0106



<Club cab>

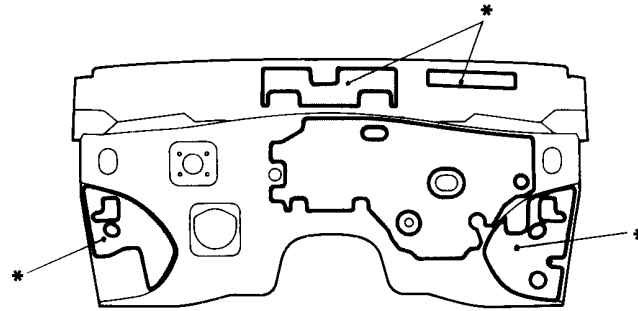

31V0104

Passenger compartment  
side of the dash panel

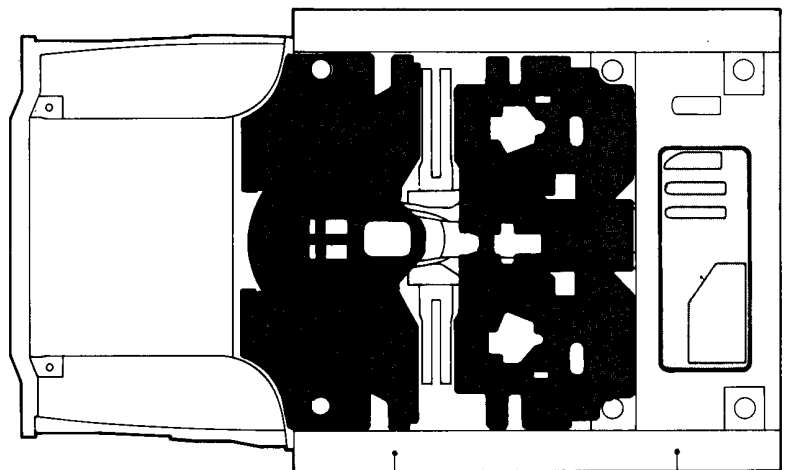

31V0062

Top of floor pan

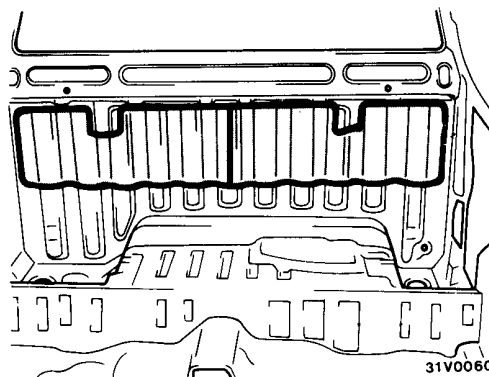

31V0060

Rear panel

- : 1.6 mm thick
- : 3.2 mm (two layers of 1.6 mm) thick silencer

NOTE

\*: Except petrol-powered vehicles

&lt;Double cab&gt;

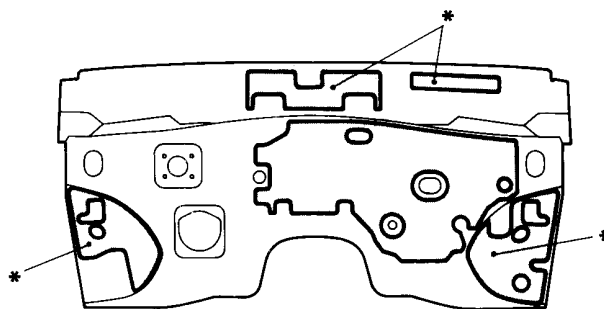

31V0104

Passenger compartment  
side of the dash panel

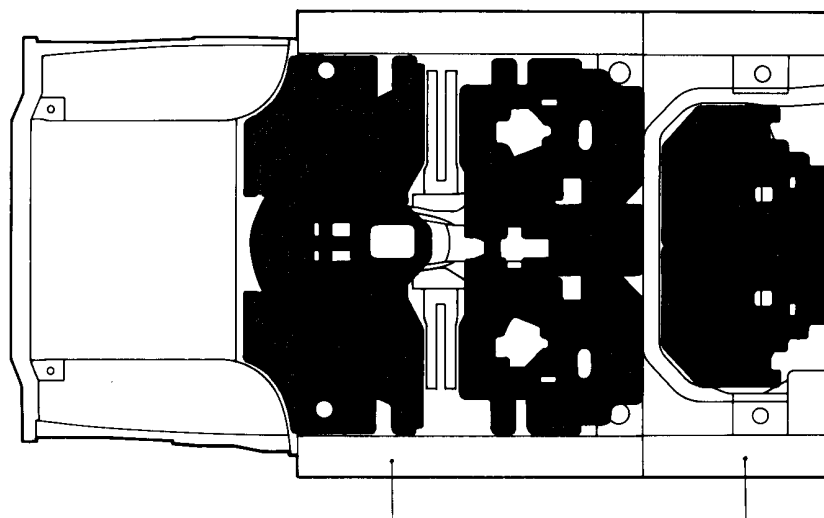

Top of floor pan

31V0105

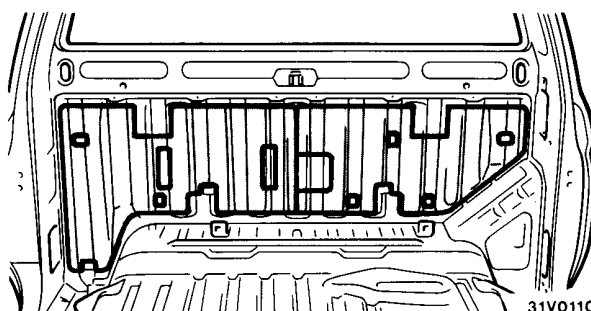

31V0110

Rear panel

- : 1.6 mm thick  
 : 3.2 mm (two layers of 1.6 mm) thick silencer

## NOTE

\*: Except petrol-powered vehicles