

GROUP 1

BODY
CONSTRUCTION

CONTENTS

BODY COMPONENTS.....	1-2	ROOF	1-15
		UNDER BODY.....	1-16
BODY MAIN CROSS-SECTIONAL VIEWS		DOOR	1-19
.....	1-4		
MAINTENANCE, SERVICEABILITY .	1-6	SILENCER APPLICATION LOCATIONS	
		1-20
BODY CONSTRUCTION CHARACTERISTICS		LOCATIONS USING URETHANE FOAM AND	
.....	1-7	FOAM MATERIAL	1-21
FRONT BODY.....	1-7		
SIDE BODY.....	1-12	STIFFENER AND DAMP SHEET	
REAR BODY.....	1-14	APPLICATION LOCATIONS	1-22

BODY COMPONENTS

M4010001000221

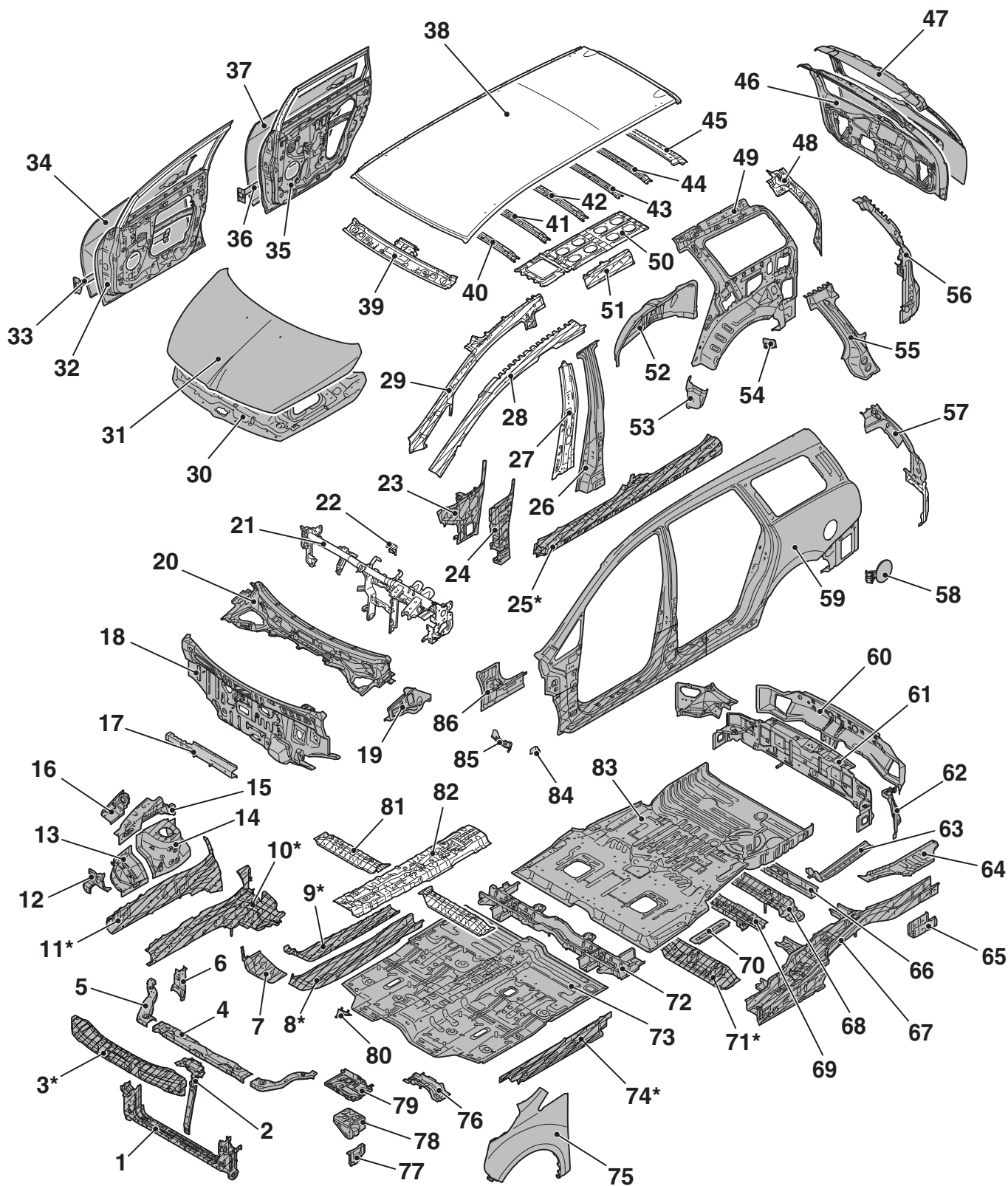

■ : Anti-corrosion steel panels

▨ : High-tensile steel panels (*: Indicates 590MPa-high-tensile steel panels.)

AB301830AB

- | | |
|--------------------------|---------------------------------|
| 1. Front end crossmember | 4. Front end upper bar |
| 2. Hood lock stay | 5. Front upper bar side |
| 3. Front end beam | 6. Headlamp support brace upper |

- | | |
|--|--|
| 7. Dash panel extension | 66. Rear floor crossmember D |
| 8. Front floor sidemember | 67. Rear floor sidemember |
| 9. Front floor sidemember reinforcement | 68. Rear floor crossmember C |
| 10. Front sidemember inner | 69. Rear floor crossmember B |
| 11. Front sidemember outer | 70. Front stringer |
| 12. Headlamp bracket | 71. Rear floor crossmember A |
| 13. Front fender shield | 72. Front floor crossmember rear |
| 14. Spring house panel | 73. Front floor pan |
| 15. Front upper frame inner | 74. Front floor side sill |
| 16. Front upper frame outer | 75. Front fender |
| 17. Dash panel crossmember upper | 76. Front floor crossmember front centre |
| 18. Dash panel | 77. Buttery tray stay |
| 19. Upper frame extension | 78. Buttery bracket |
| 20. Front deck | 79. Buttery tray |
| 21. Deck crossmember | 80. Foot rest bracket |
| 22. Guide bracket | 81. Front floor crossmember front |
| 23. Front pillar inner lower | 82. Back bone reinforcement |
| 24. Front pillar reinforcement outer lower | 83. Rear floor pan |
| 25. Side sill reinforcement | 84. Front fender bracket |
| 26. Centre pillar reinforcement outer | 85. Front fender bracket lower |
| 27. Centre pillar inner | 86. Front floor side sill inner front |
| 28. Front pillar reinforcement outer upper | |
| 29. Front pillar inner upper | |
| 30. Hood inner panel | |
| 31. Hood outer panel | |
| 32. Front door panel inner | |
| 33. Front door side door beam | |
| 34. Front door panel outer | |
| 35. Rear door panel inner | |
| 36. Rear door side door beam | |
| 37. Rear door panel outer | |
| 38. Roof panel | |
| 39. Front roof rail | |
| 40. Roof bow A | |
| 41. Roof bow B | |
| 42. Roof bow C | |
| 43. Roof bow D | |
| 44. Roof bow E | |
| 45. Rear roof rail | |
| 46. Tailgate panel inner | |
| 47. Tailgate panel outer | |
| 48. Quarter extension inner | |
| 49. Quarter inner panel | |
| 50. Roof reinforcement centre | |
| 51. Roof side rail inner | |
| 52. Rear wheel house inner panel | |
| 53. Shield plate front | |
| 54. Shield plate rear | |
| 55. Rear pillar reinforcement outer | |
| 56. Gate pillar reinforcement | |
| 57. Quarter extension outer | |
| 58. Fuel filler door panel | |
| 59. Side outer panel | |
| 60. Rear end outer panel | |
| 61. Rear end inner panel | |
| 62. Quarter inner extension lower | |
| 63. Seat pan reinforcement | |
| 64. Rear floor side pan | |
| 65. Rear floor side member rear extension | |

BODY MAIN CROSS-SECTIONAL VIEWS

M4010002000246

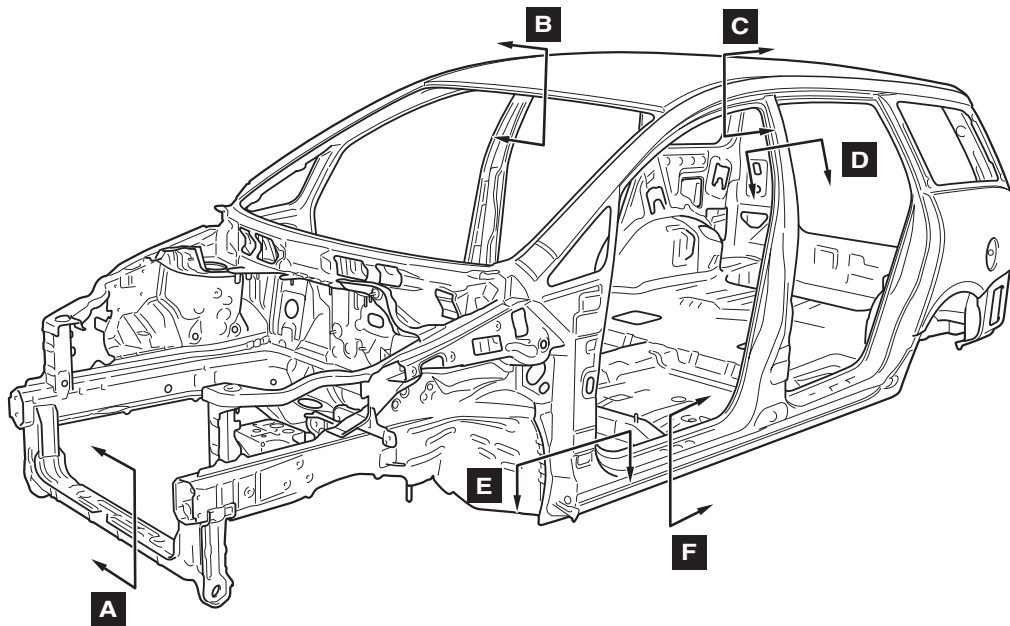

AB300191AD

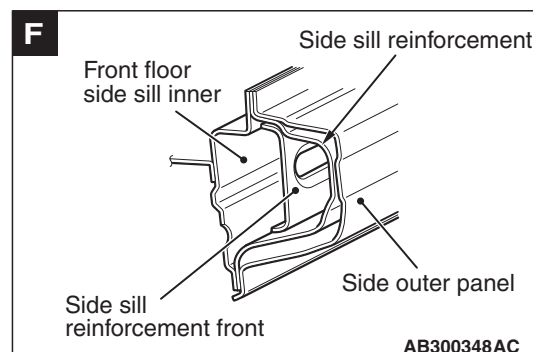
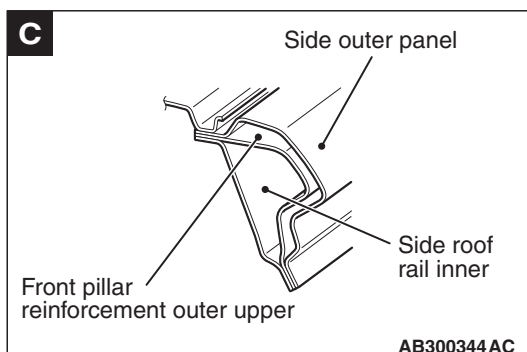
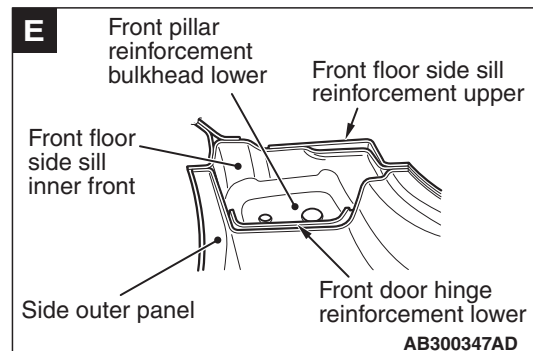
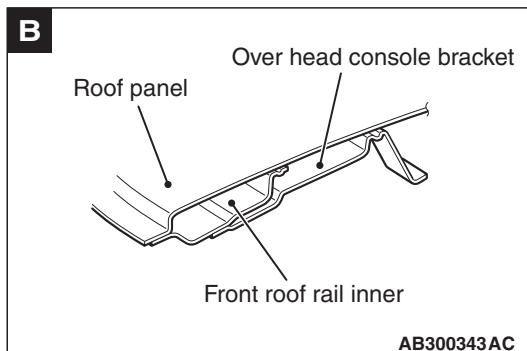
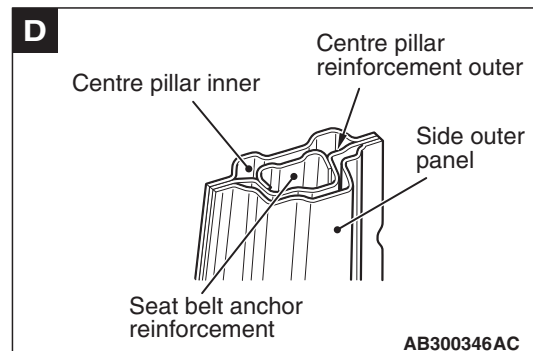
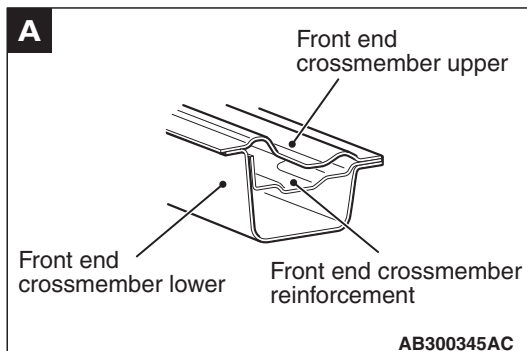

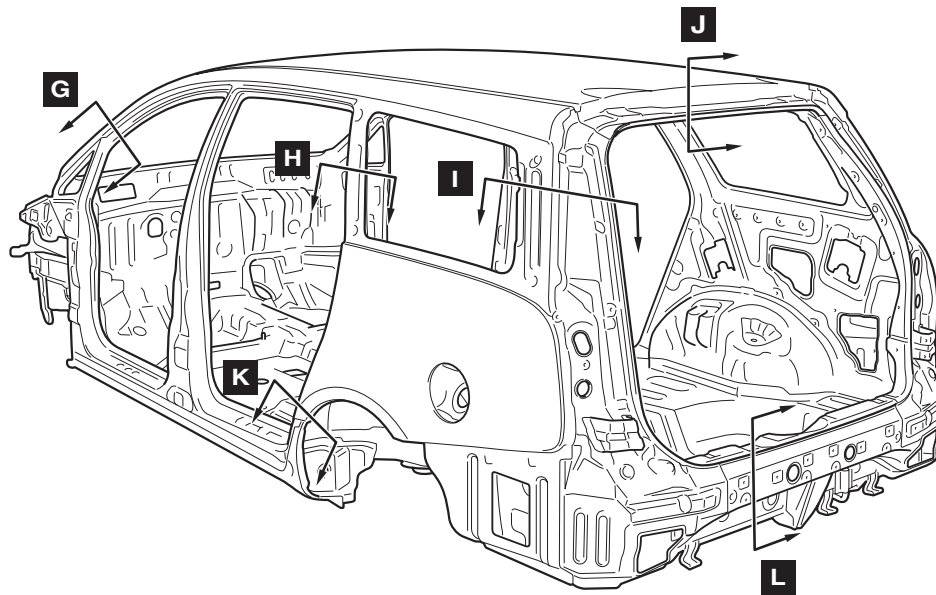

AB300192AD

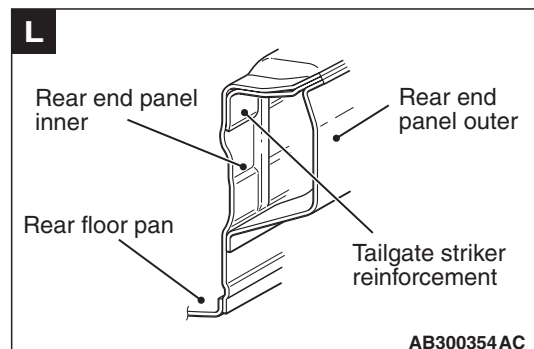
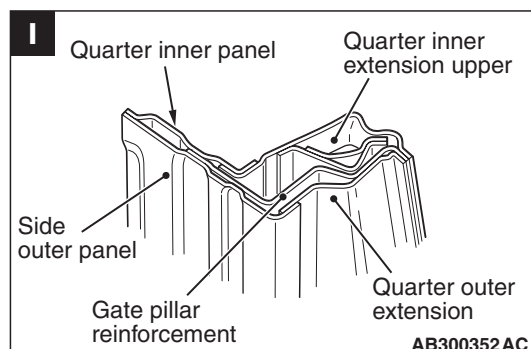
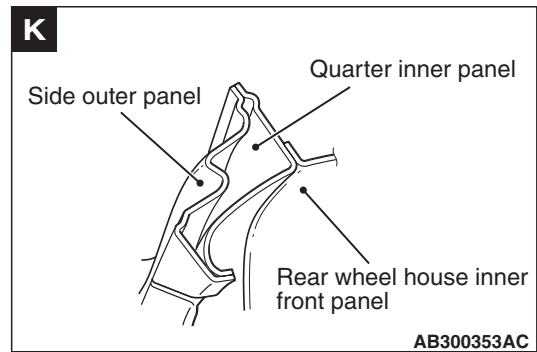
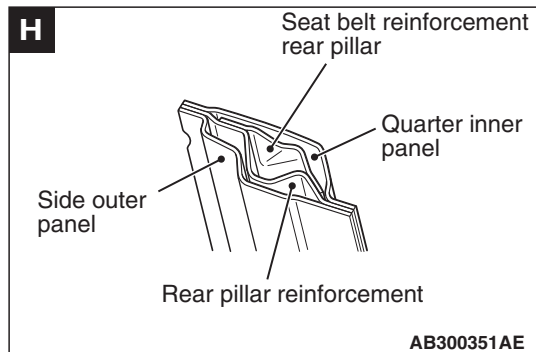
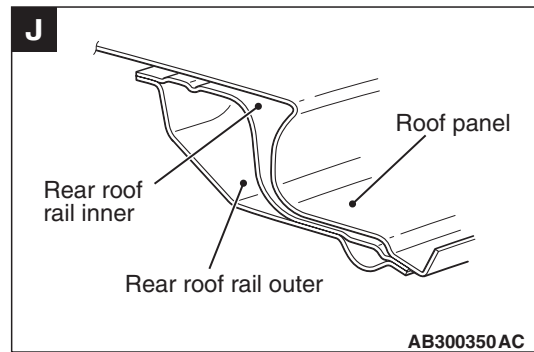
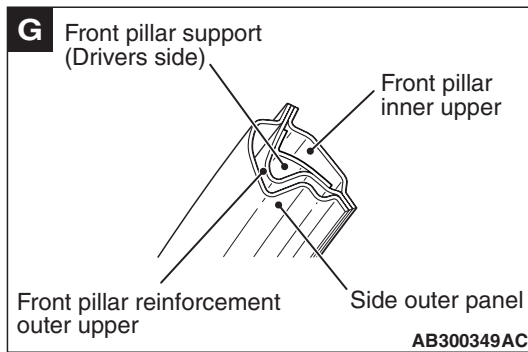

MAINTENANCE, SERVICEABILITY

M4010003000238

SIDE STRUCTURE

A panel positioning notch has been added on the door opening to improve assembling workability when replacing the panel.

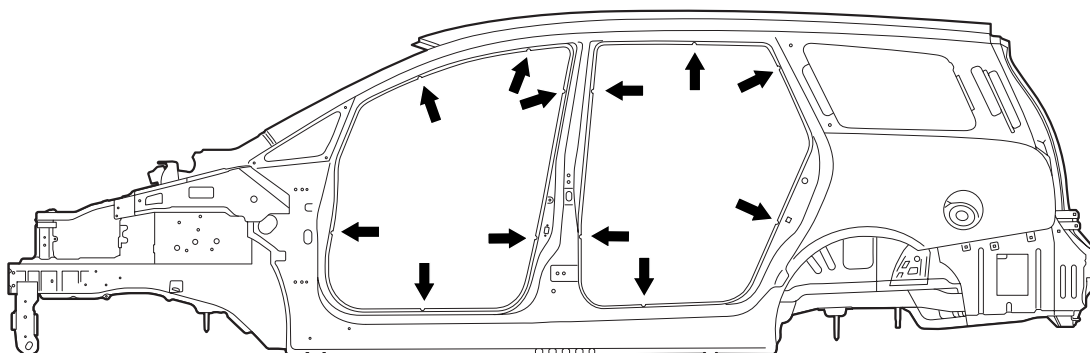
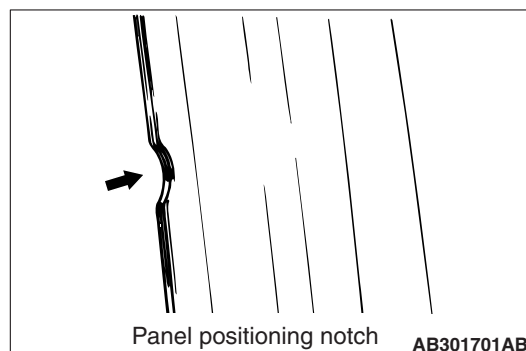

AB301702AB

SIDE OUTER PANEL

The extra parts are supplied in 4 different cut forms as a result of employing the integrated side-frame side outer panel.

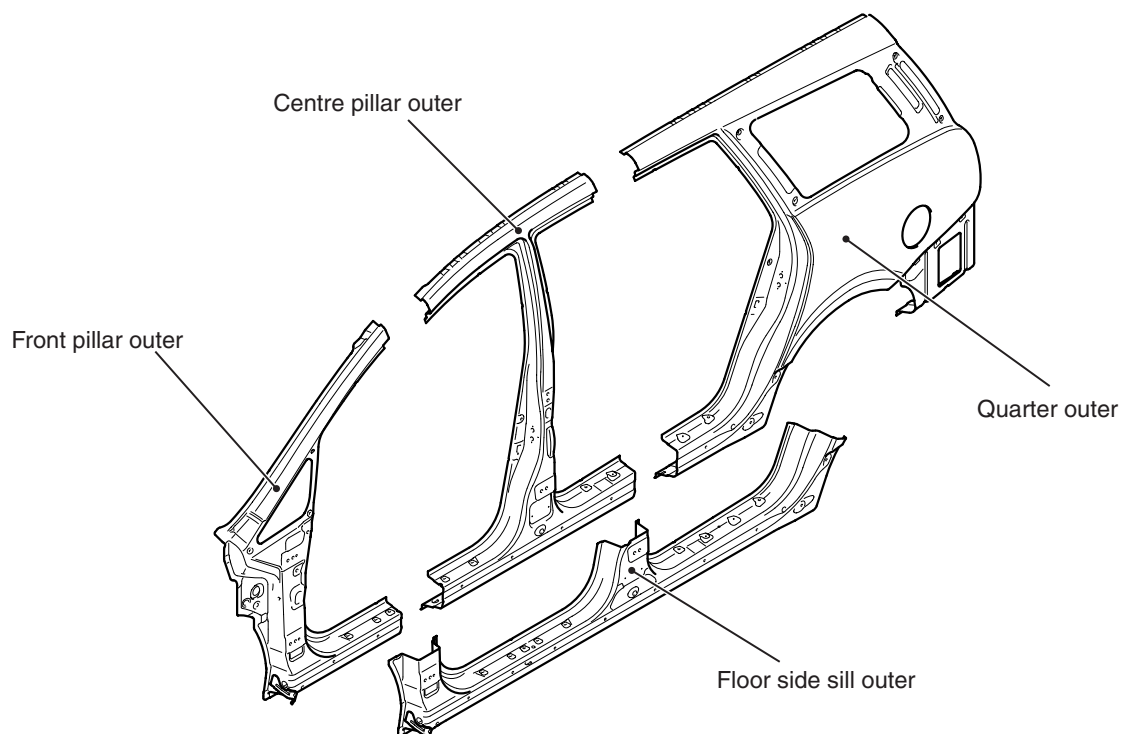

AB301703AB

BODY CONSTRUCTION CHARACTERISTICS

FRONT BODY

M4010010000263

HEADLAMP SUPPORT

- A front end beam with a large cross section has been adopted to improve safety upon impact.

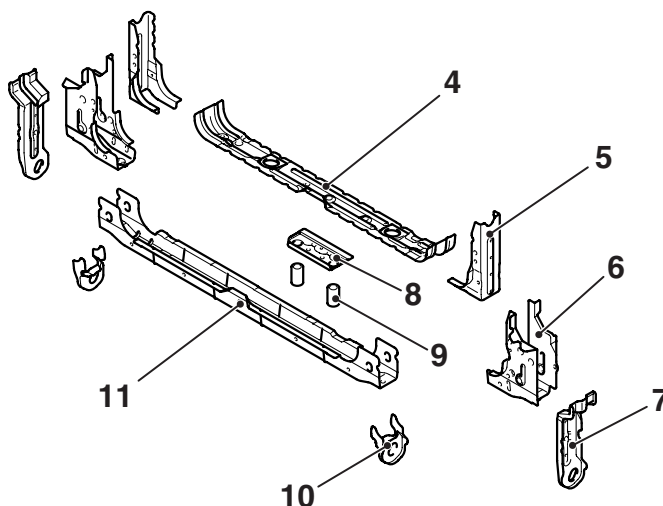
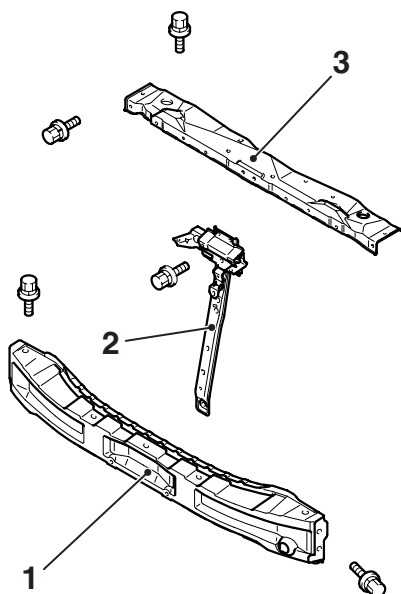

AB301705AB

1. Front end beam
2. Hood lock stay
3. Front end upper bar
4. Front end crossmember upper
5. Headlamp support brace lower
6. Front end crossmember brace
7. Shipping bracket
8. Front end crossmember reinforcement
9. Front No2 crossmember pipe
10. Shipping reinforcement
11. Front end crossmember lower

FENDER SHIELD

- The front frame structure is supported in three directions by the front floor side members with a large section, dash braces and dash upper crossmember (dash panel area) to improve body rigidity.
- An uneven thickness steel sheet* in which the sheet thickness is thicker in the forward part of the vehicle was employed for the front side member reinforcement to ensure safety upon impact and improve body rigidity.

NOTE: *: A steel sheet of varying thickness that is welded into one steel sheet.

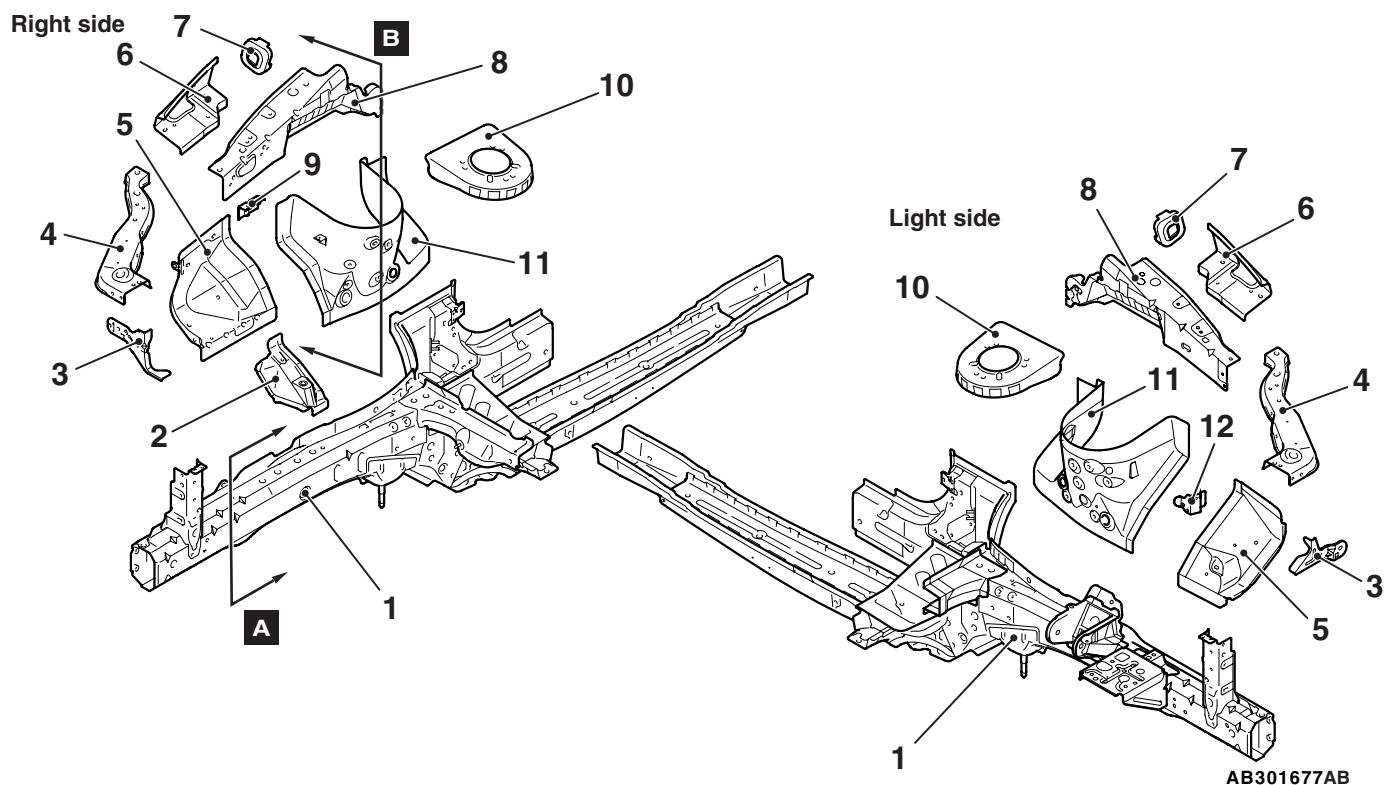

1. Front sidemember
2. Engine mount reinforcement (Right side)
3. Headlamp bracket
4. Front end upper bar side
5. Front fender shield
6. Front upper frame outer
7. Upper frame bulkhead front
8. Front upper frame inner
9. Power steering reservoir tank bracket (Right side)
10. Spring house bracket
11. Spring house panel
12. Relay box bracket (Left side)

The front part of the front side member has octagonal section that efficiently absorbs energy upon impact.

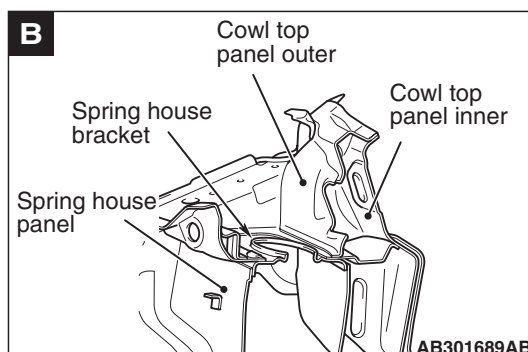
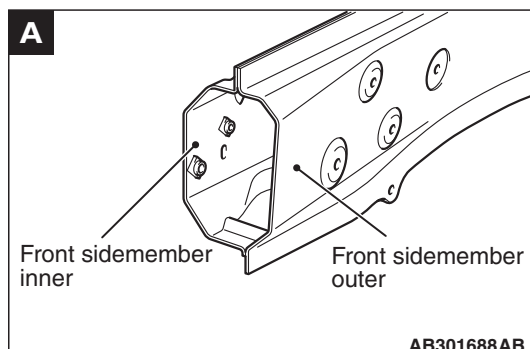

The coupling between the cowl tops with a large cross section and the spring house brackets has been strengthened to heighten body rigidity of the suspension assembling support area and improve driving stability.

FRONT SIDEMEMBER REINFORCEMENT

Right side

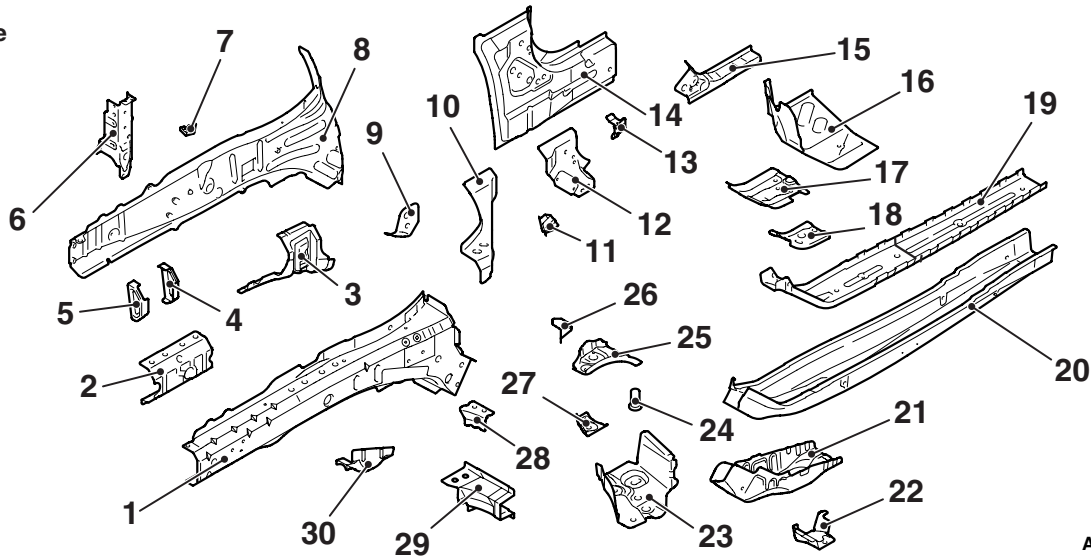

AB302050AB

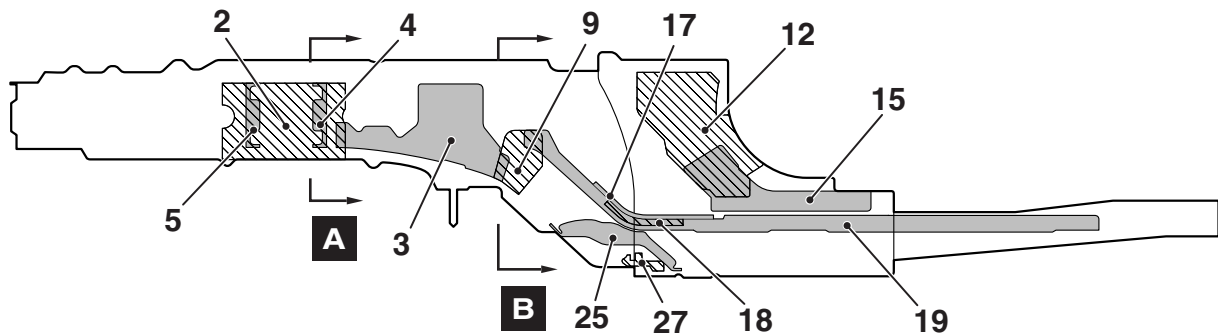

AB300245AC

- | | |
|---|--|
| 1. Front sidemember inner | 22. Dash crossmember extension lower |
| 2. Front sidemember inner reinforcement front | 23. Front sidemember brace lower |
| 3. Pipe support front | 24. Pipe nut |
| 4. Engine mounting bulkhead rear | 25. Pipe support rear |
| 5. Engine mounting bulkhead front | 26. Accel pedal bracket (R.H. drive vehicles) |
| 6. Headlamp support brace upper | 27. Stay reinforcement |
| 7. Brake hose bracket | 28. Dash crossmember upper reinforcement extension (R.H. drive vehicles) |
| 8. Front sidemember outer | 29. Dash crossmember extension upper |
| 9. Kick up reinforcement | 30. Suspension crossmember bracket front |
| 10. Dash brace | |
| 11. Accel stopper bracket (R.H. drive vehicles) | |
| 12. Front floor side sill inner reinforcement upper | |
| 13. Hood opener bracket (R.H. drive vehicles) | |
| 14. Front floor side sill inner front | |
| 15. Front floor side sill inner reinforcement lower | |
| 16. Dash panel extension | |
| 17. Front floor sidemember reinforcement upper | |
| 18. Front floor sidemember reinforcement middle (R.H. drive vehicles) | |
| 19. Front floor sidemember reinforcement | |
| 20. Front floor sidemember | |
| 21. Suspension crossmember bracket rear | |

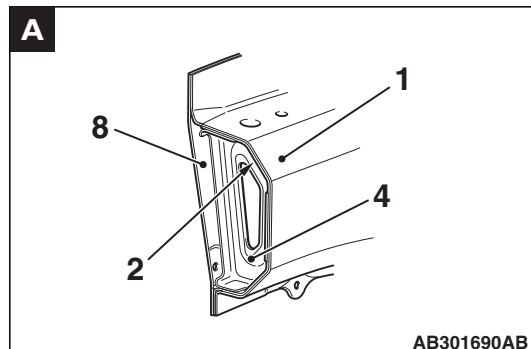

AB301690AB

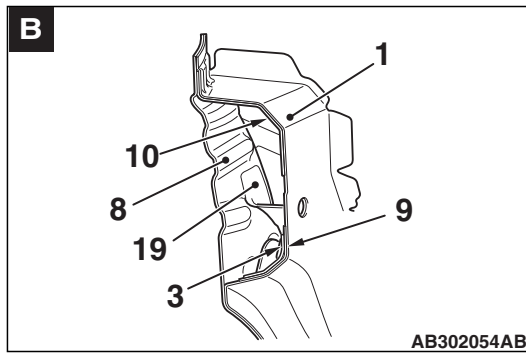

Light side

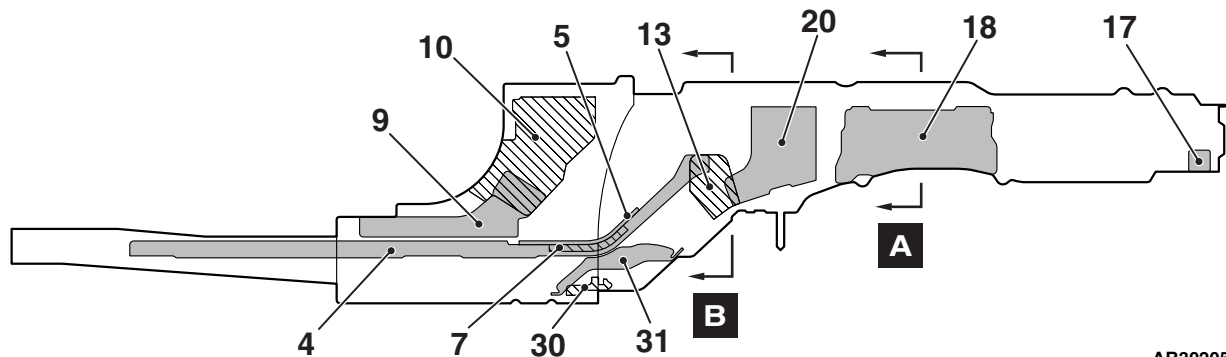
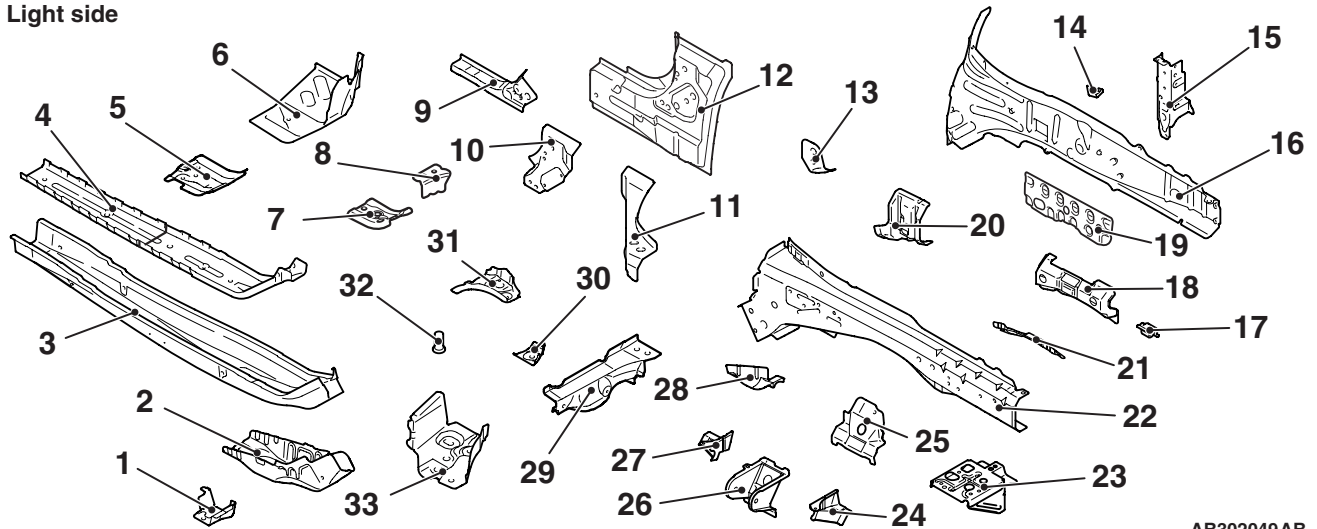

- | | |
|---|--|
| 1. Dash crossmember extension lower | 16. Front sidemember outer |
| 2. Suspension crossmember bracket rear | 17. Towing reinforcement |
| 3. Front floor sidemember | 18. Transmission mounting reinforcement |
| 4. Front floor sidemember reinforcement | 19. Front sidemember outer reinforcement (L.H. drive vehicles) |
| 5. Front floor sidemember reinforcement upper | 20. Pipe support front |
| 6. Dash panel extension | 21. Front sidemember inner reinforcement (L.H. drive vehicles) |
| 7. Front floor sidemember reinforcement middle (L.H. drive vehicles) | 22. Front sidemember inner |
| 8. Dash crossmember upper reinforcement extension (L.H. drive vehicles) | 23. Battery bracket |
| 9. Front floor side sill inner reinforcement lower | 24. Transmission mounting stay front |
| 10. Front floor side sill inner reinforcement upper | 25. Transmission mounting gusset |
| 11. Dash brace | 26. Transmission mounting bracket |
| 12. Front floor side sill inner front | 27. Transmission mounting stay rear |
| 13. Kick up reinforcement | 28. Suspension crossmember bracket front |
| 14. Brake house bracket | 29. Dash crossmember extension upper |
| 15. Headlamp support brace upper | 30. Stay reinforcement |

- 31. Pipe support rear
- 32. Pipe nut
- 33. Front sidemember brace lower

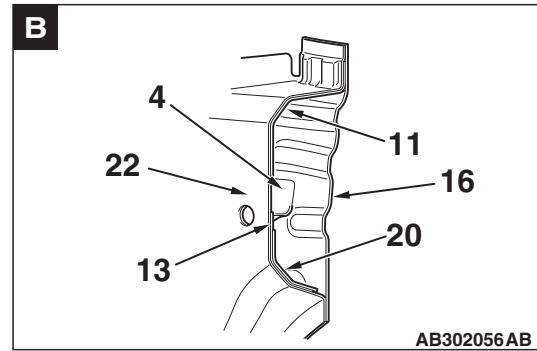
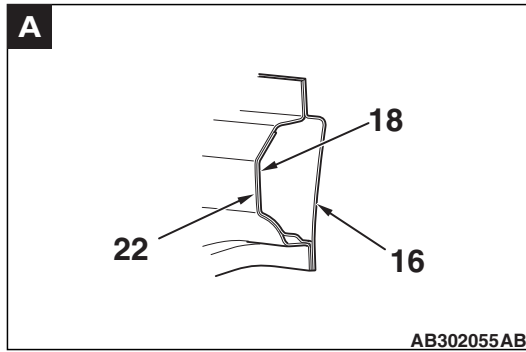

FRONT DECK

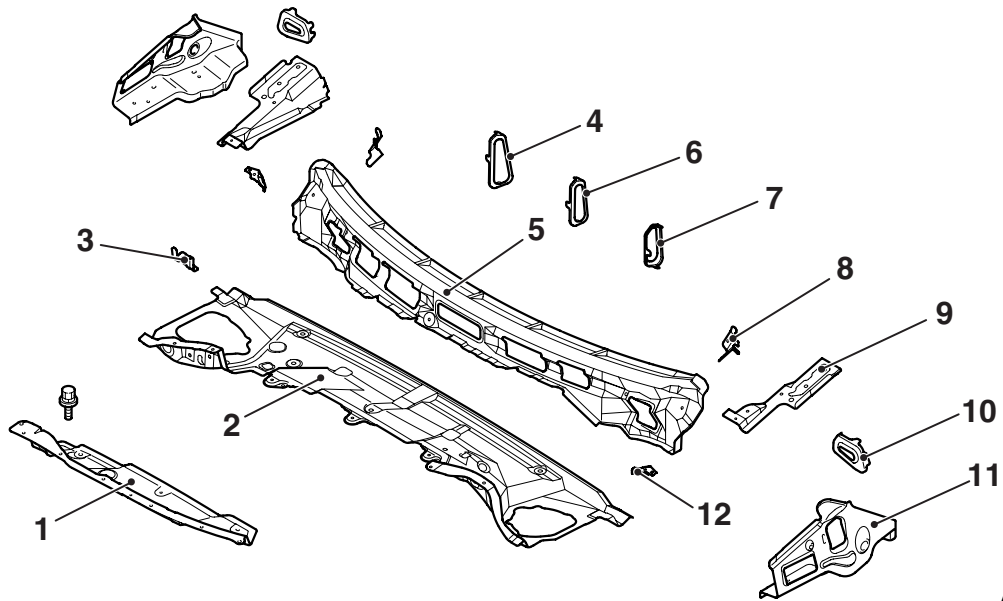

- | | |
|-------------------------|---------------------------------------|
| 1. Cowl top panel front | 7. Cowl top bulkhead C |
| 2. Cowl top panel inner | 8. Cowl top gusset side |
| 3. Wiper bracket A | 9. Front upper frame extension inner |
| 4. Cowl top bulkhead A | 10. Upper frame bulkhead rear |
| 5. Cowl top panel outer | 11. Front upper frame extension outer |
| 6. Cowl top bulkhead B | 12. Fender bracket |

DASH PANEL

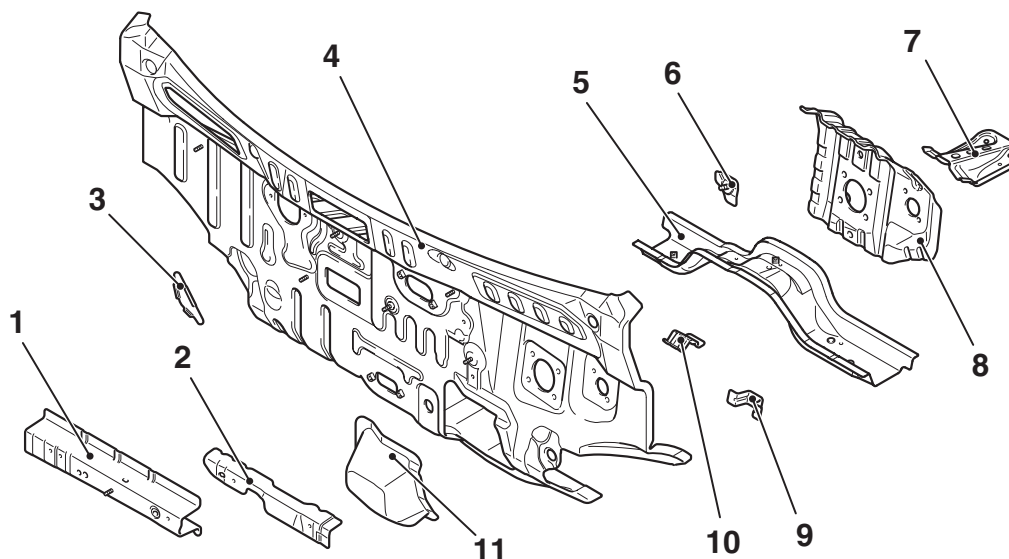

1. Dash crossmember upper
2. Dash crossmember reinforcement upper
3. Dash panel plate (RH drive vehicles, A/T lever type)
4. Dash panel
5. Dash crossmember lower
6. Accel pedal upper bracket (LH drive vehicles)
7. Clutch pedal support bracket (Vehicle for M/T)
8. Dash panel reinforcement
9. Clutch pedal stopper bracket (RH drive vehicles, M/T)
10. Accel pedal bracket (LH drive vehicles)
11. Steering shaft bracket

AB301685AB

M4010011000233

SIDE BODY

SIDE STRUCTURE

- An uneven thickness steel sheet* in which the sheet thickness is thicker in the order of the upper section, rear section, and lower section was employed for the side outer panel to ensure safety upon side impact.
- The rear wheel houses each consist of a front and a rear panel, and thick steel plates are used for the rear wheel house panels where the rear suspensions are installed, in order to heighten the body rigidity and improve driving stability.

NOTE: *: A steel sheet of varying thickness that is welded into one steel sheet.

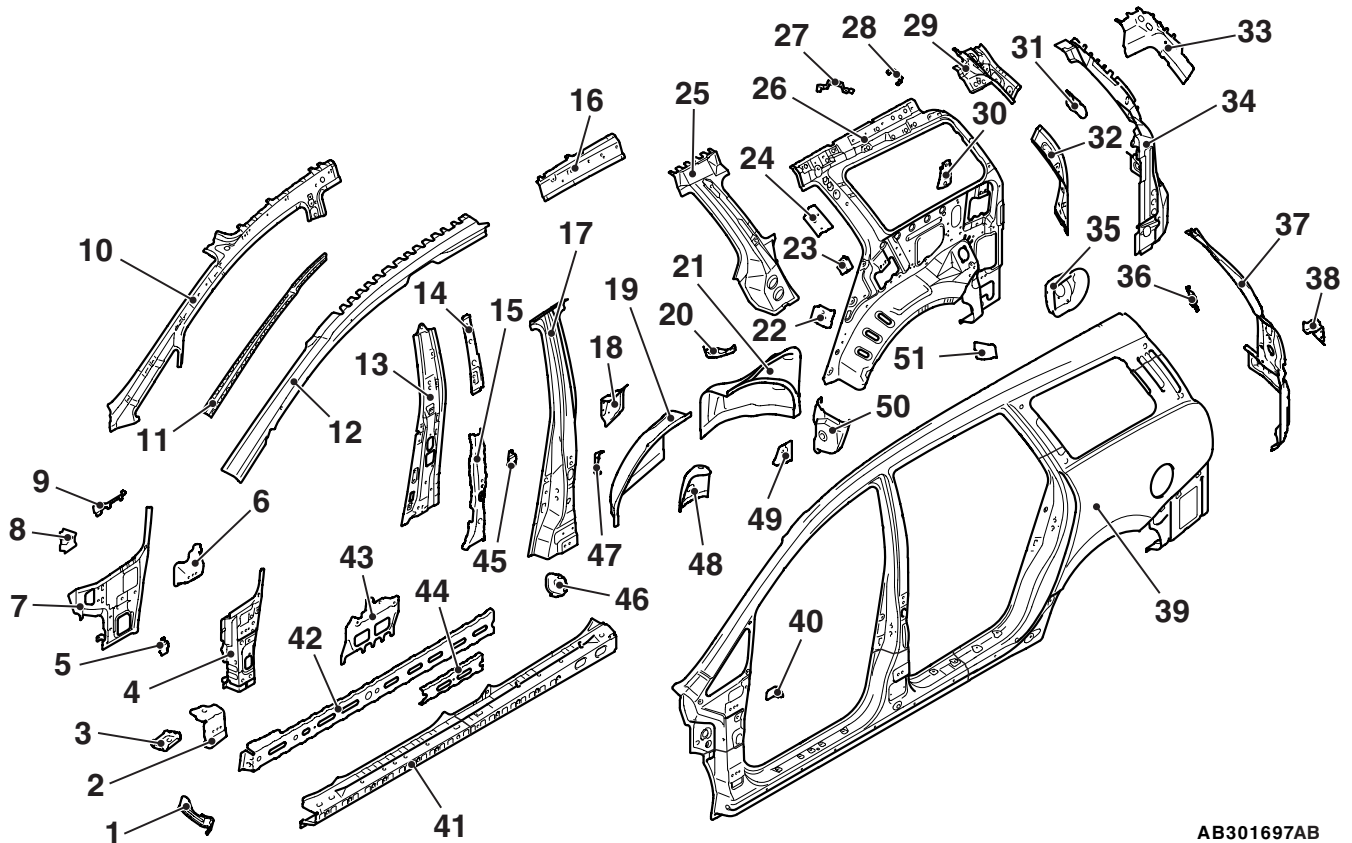

AB301697AB

- | | |
|---|--|
| 1. Front fender lower bracket | 31. Seat belt reinforcement upper |
| 2. Front door hinges reinforcement lower | 32. Quarter inner extension |
| 3. Front pillar reinforcement bulkhead lower | 33. Gate pillar upper reinforcement |
| 4. Front pillar reinforcement outer lower | 34. Gate pillar reinforcement |
| 5. Front door checker bulkhead | 35. Fuel filler neck bracket (Left side) |
| 6. Front door hinges reinforcement upper | 36. Gas spring reinforcement |
| 7. Front pillar inner lower | 37. Quarter outer extension |
| 8. Deck crossmember bracket | 38. Tailgate dumper reinforcement side |
| 9. Instrument panel side bracket | 39. Side outer panel |
| 10. Front pillar inner upper | 40. Fender bracket |
| 11. Front pillar support (Driver's side) | 41. Side sill reinforcement |
| 12. Front pillar reinforcement outer upper (Passenger's side) | 42. Side sill reinforcement front |
| 13. Centre pillar inner | 43. Seat belt front anchor reinforcement |
| 14. Seat belt anchor reinforcement | 44. Side sill reinforcement centre |
| 15. Rear door hinges reinforcement upper | 45. Rear door check bulkhead |
| 16. Side roof rail inner | 46. Side sill bulkhead rear |
| 17. Centre pillar reinforcement outer | 47. Harness bracket |
| 18. Third seat anchor reinforcement | 48. Shock absorber support |
| 19. Rear wheel house inner front panel | 49. Rear seat belt reinforcement wheel house |
| 20. Shock absorber reinforcement | 50. Shield plate front |
| 21. Rear wheel house inner rear panel | 51. Shield plate rear |
| 22. Rear door striker reinforcement | |
| 23. Seat belt reinforcement lower second | |
| 24. Seat belt reinforcement rear pillar | |
| 25. Rear pillar reinforcement outer | |
| 26. Quarter inner panel | |
| 27. Radio tuner amplifier bracket (Right side) | |
| 28. TV tuner amplifier bracket (Left side) | |
| 29. Quarter inner extension upper | |
| 30. Seat belt reinforcement lower third | |

SIDE STRUCTURE REINFORCEMENT

An uneven thickness steel sheet* in which the sheet thickness is thicker in the forward part of the vehicle was employed for the side sill reinforcement to ensure safety upon side impact.

*NOTE: *: A steel sheet of varying thickness that is welded into one steel sheet.*

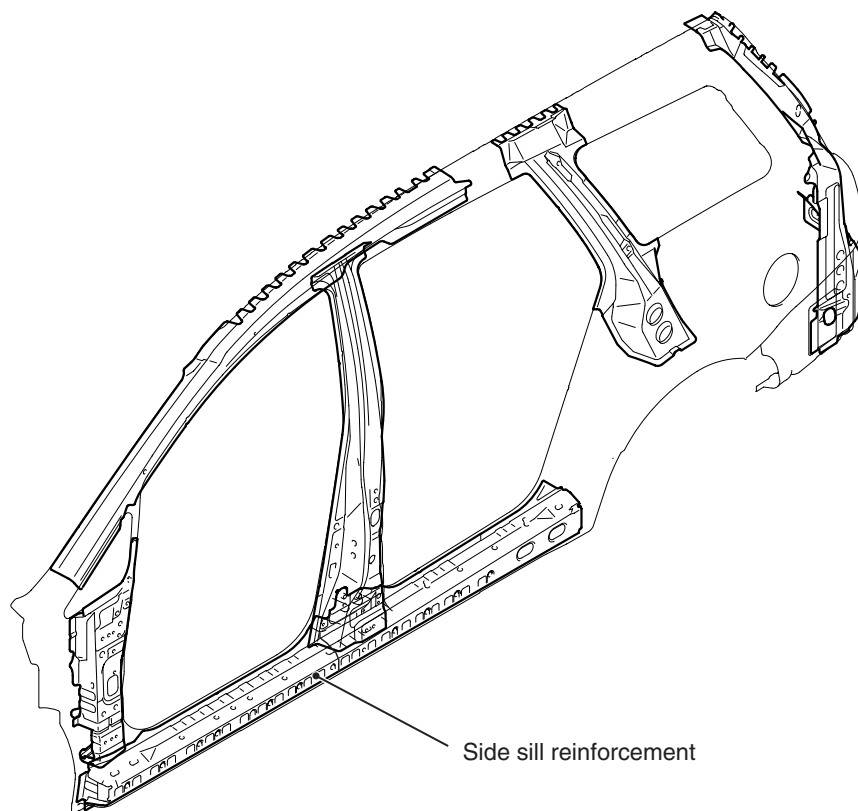

AB301707AB

REAR BODY

M4010012000203

REAR END CROSSMEMBER

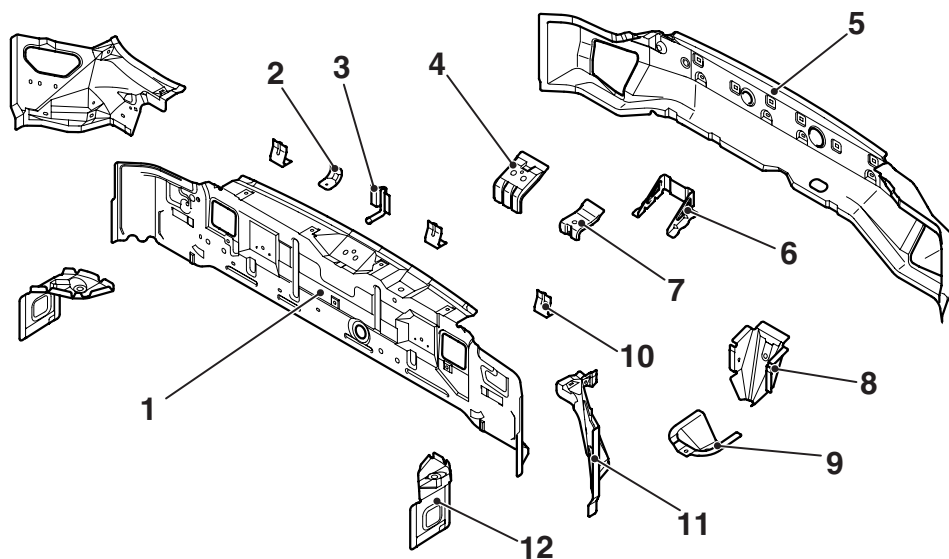

AB301708AB

- | | |
|--------------------------------------|-----------------------------------|
| 1. Rear end panel inner | 8. Jack rear bracket A |
| 2. Heat protector bracket | 9. Jack rear bracket B |
| 3. Muffler hanger bracket rear | 10. Bumper bracket |
| 4. Tailgate striker reinforcement | 11. Rear floor side brace |
| 5. Rear end panel outer | 12. Quarter inner extension lower |
| 6. Jack rear bulkhead | |
| 7. Spare tyre reinforcement rear end | |

ROOF

M4010013000217

Except for sun roof

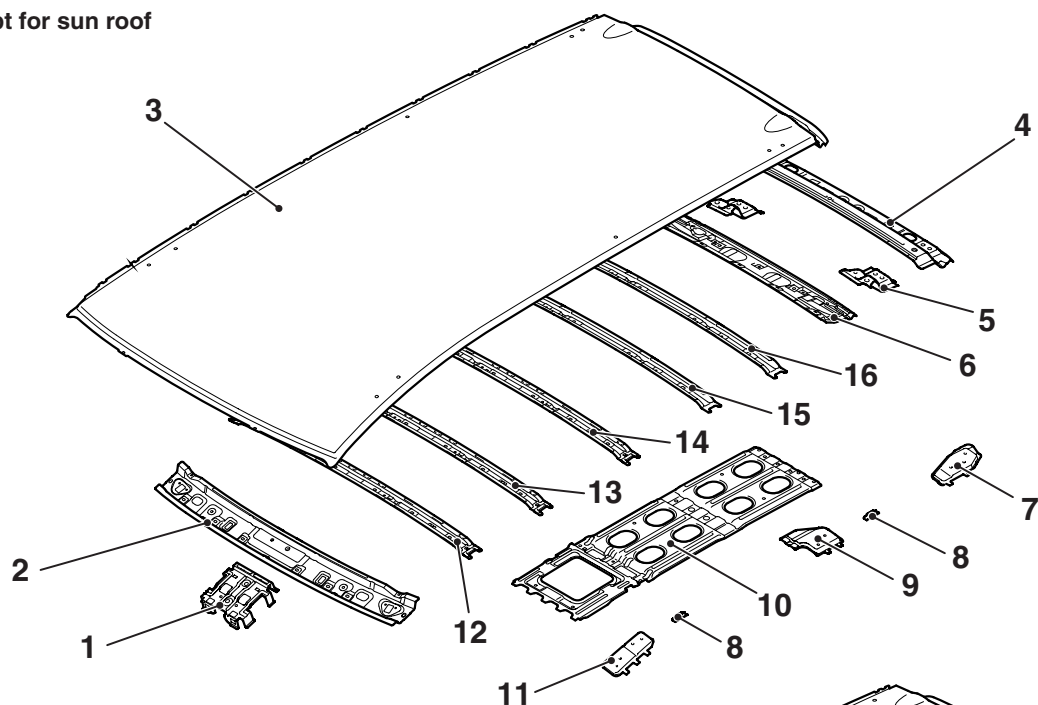

Vehicles with sun roof

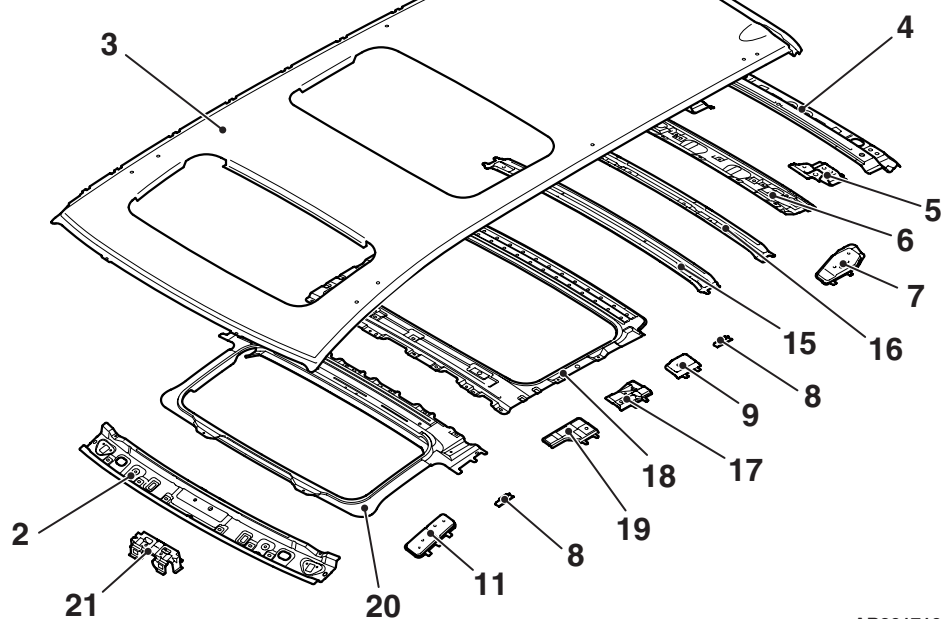

AB301710AB

- | | |
|---|---|
| 1. Overhead console bracket | 11. Roof rack reinforcement front (Vehicles with roof rail) |
| 2. Front roof rail inner | 12. Roof bow A |
| 3. Roof panel | 13. Roof bow B |
| 4. Rear roof rail outer | 14. Roof bow centre |
| 5. Tailgate hinge reinforcement | 15. Roof bow D |
| 6. Rear roof rail inner | 16. Roof bow E |
| 7. Roof rack reinforcement rear (Vehicles with roof rail) | 17. Set bracket rear |
| 8. Roof carrier bracket | 18. Roof reinforcement rear |
| 9. Roof rack reinforcement centre (Vehicles with roof rail) | 19. Set bracket front |
| 10. Roof centre reinforcement | 20. Roof reinforcement front |
| | 21. Room lamp bracket |

UNDER BODY**FRONT FLOOR**

M4010014000265

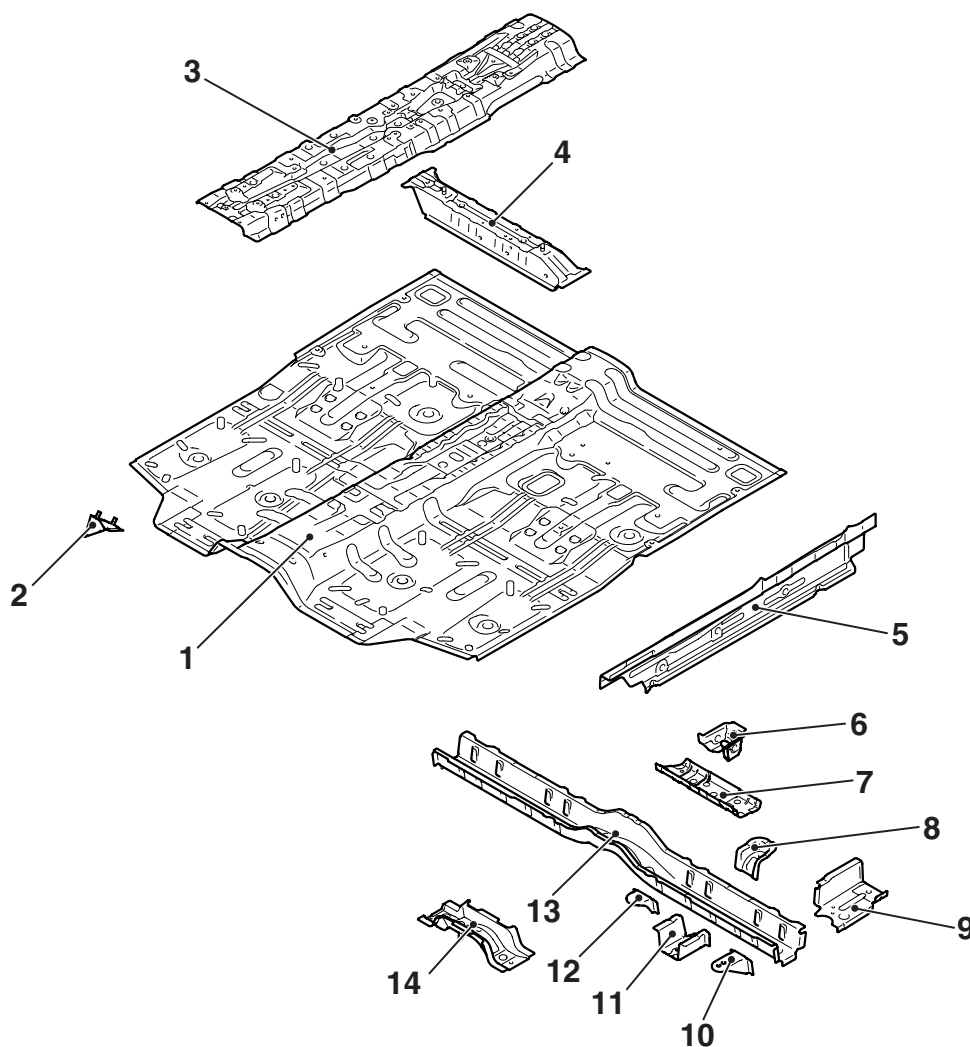

AB301673AB

1. Front floor pan
2. Foot rest bracket (R.H. drive vehicles)
3. Backbone reinforcement
4. Front floor crossmember front
5. Front floor side sill inner
6. Front floor crossmember rear bulkhead
7. Front floor crossmember rear reinforcement
8. Fuel tank support bracket front
9. Front floor sidemember extension rear
10. Front seat reinforcement rear side
11. Front floor sidemember extension front
12. Front seat anchor reinforcement centre

13. Front floor crossmember rear
14. Front floor crossmember front centre

REAR FLOOR

- An uneven thickness steel sheet* in which the sheet thickness is thicker in the forward part of the vehicle was employed for the rear floor side member to ensure safety upon impact.

*NOTE: *: A steel sheet of varying thickness that is welded into one steel sheet.*

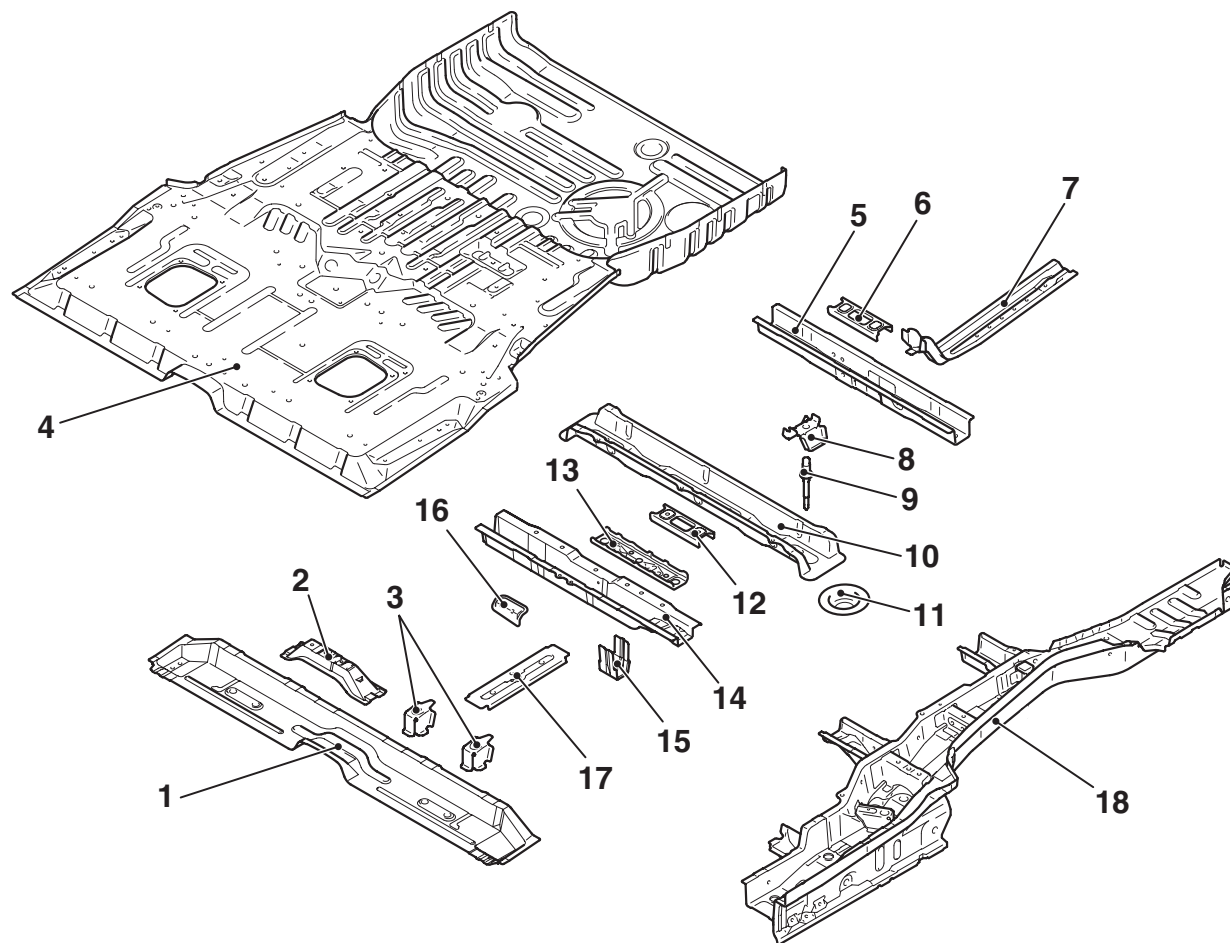

AB301667AB

- | | |
|---|---|
| 1. Rear floor crossmember A | 12. Seat anchor reinforcement B |
| 2. Seat anchor reinforcement front centre A | 13. Rear floor crossmember centre reinforcement B (Seven-passenger model) |
| 3. Seat anchor front reinforcement | 14. Rear floor crossmember B |
| 4. Rear floor pan | 15. Fuel tank support bracket rear |
| 5. Rear floor crossmember D | 16. Flange reinforcement (Seven-passenger model) |
| 6. Seat anchor reinforcement D | 17. Front stringer |
| 7. Seat pan reinforcement | 18. Rear floor sidemember |
| 8. Rear suspension crossmember bulkhead | |
| 9. Mounting bolt | |
| 10. Rear floor crossmember C | |
| 11. Spring sheet | |

REAR FLOOR SIDEMEMBER REINFORCEMENT

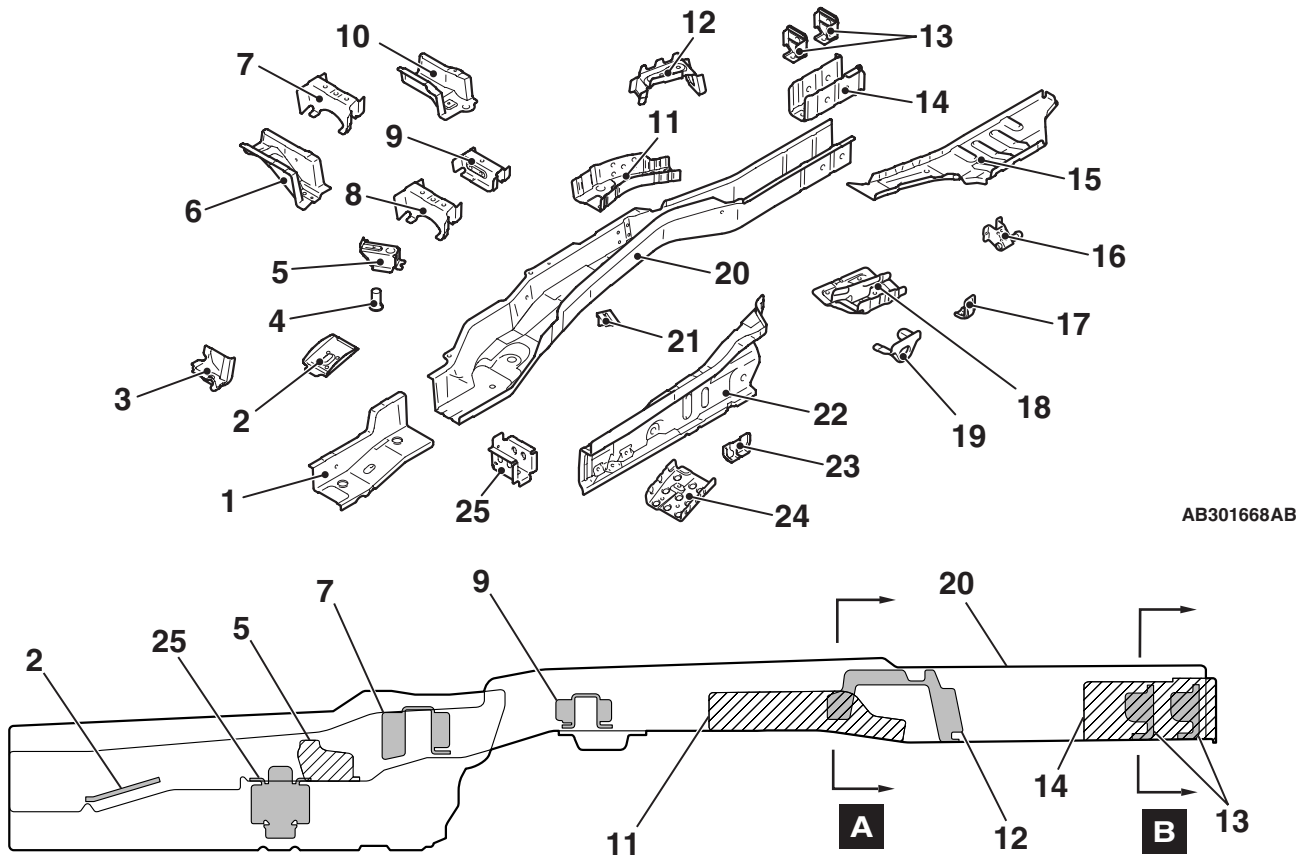

AB301675AB

1. Rear floor sidemember extension front
2. Tie down hook plate
3. Fuel tank support bracket
4. Pipe nut
5. Pipe support front
6. Rear floor crossmember extension B
7. Seat anchor rear reinforcement (Seven-passenger model right side)
8. Seat anchor rear reinforcement (Except for seven passenger model right side)
9. Rear floor sidemember front bulkhead
10. Rear floor crossmember extension D
11. Rear floor sidemember reinforcement
12. Third seat anchor reinforcement
13. Rear floor sidemember rear bulkhead (Left side)
14. Rear floor sidemember extension rear
15. Rear floor side pan
16. Muffler hanger bracket rear (Right side)
17. Heat protector bracket (Right side)
18. Spare tyre support (Left side)
19. Shipping bracket (Right side)
20. Rear floor sidemember
21. Brake hose bracket
22. Rear floor side sill inner
23. Jack up side reinforcement

24. Sidemember front bulkhead
25. Rear suspension crossmember stopper bracket

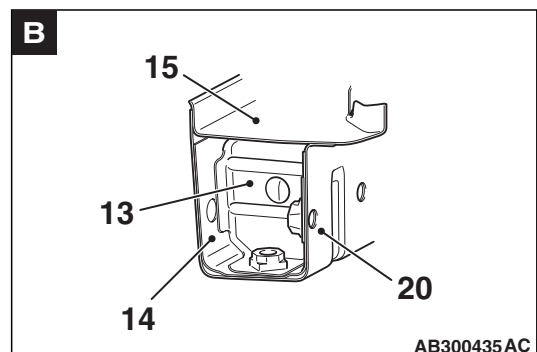
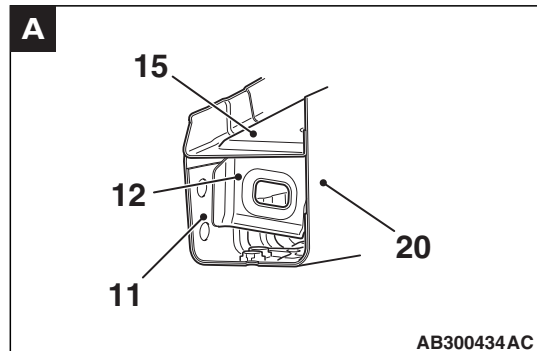

DOOR

M4010015000213

- An uneven thickness steel sheet* in which the sheet thickness is thicker in the forward part of the vehicle was employed for the inner panel to improve rigidity.
- The front and rear side door beam was located in the bumper position of the vehicle to improve cabin protection upon side impact.

- A belt line inner reinforcement has been adopted to improve cabin protection upon impact.
- The bottom section of the door sash pillar was enlarged and the couplings between the hinge, latch and door sash were strengthened to improve sash rigidity.

*NOTE: *: A steel sheet of varying thickness that is welded into one steel sheet.*

Front door

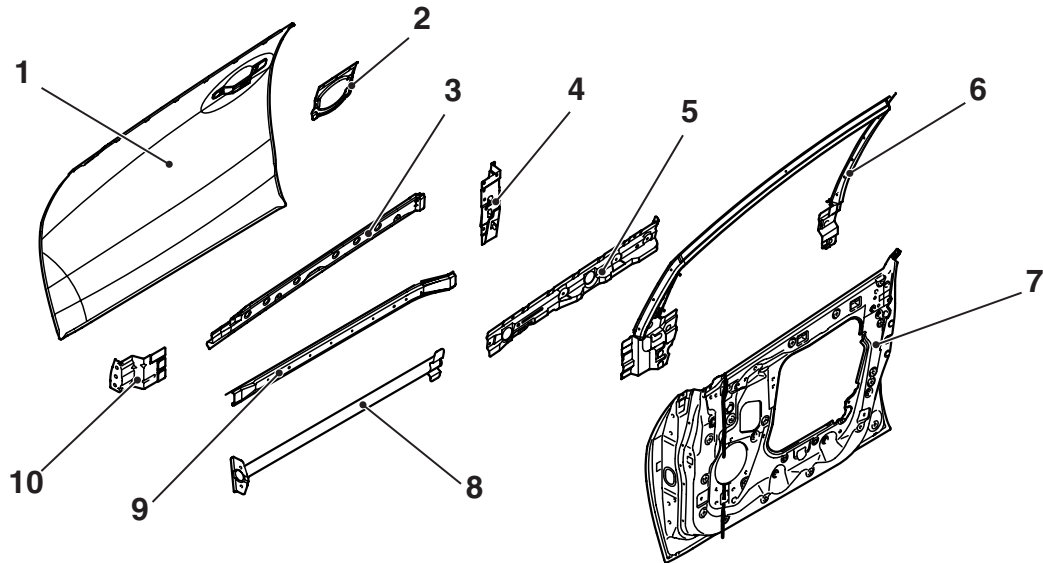

AB301700AB

Rear door

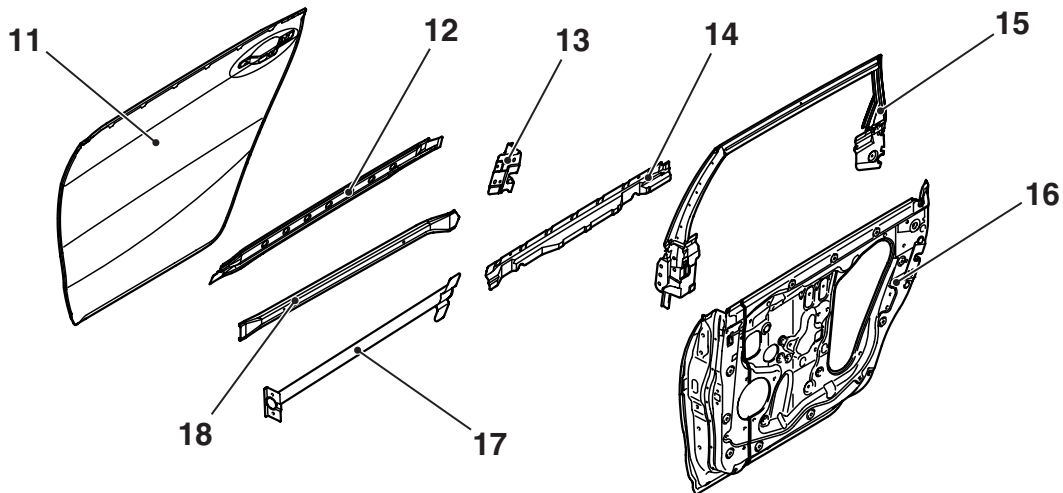

AB301699AB

- | | |
|---|---|
| 1. Front door outer panel | 10. Front door hinge upper reinforcement |
| 2. Front door outside handle reinforcement | 11. Rear door outer panel |
| 3. Front door belt line outer reinforcement | 12. Rear door belt line outer reinforcement |
| 4. Front door latch reinforcement | 13. Rear door latch reinforcement |
| 5. Front door belt line inner reinforcement | 14. Rear door belt line inner reinforcement |
| 6. Front door window sash | 15. Rear door window sash |
| 7. Front door inner panel | 16. Rear door inner panel |
| 8. Front side door beam | 17. Rear side door beam |
| 9. Front door outer stiffener | 18. Rear door outer stiffener |

SILENCER APPLICATION LOCATIONS

M4010005000278

Sound insulation was improved by using a spray-type anti-vibration agent on the cabin side of the dash panel, rear wheel house and rear floor.

Use a melting sheet for repair.

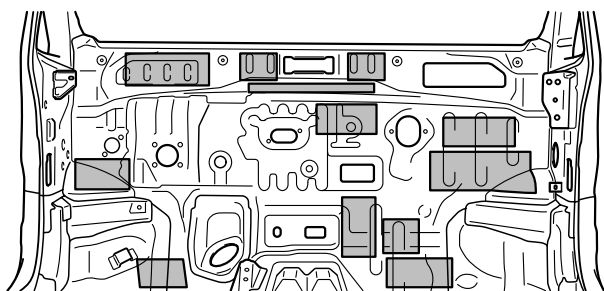

Dash panel

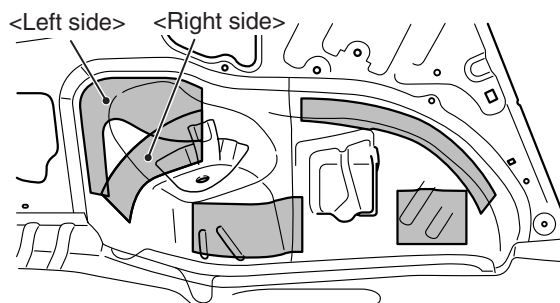

Rear wheel house inner

AB301712AB

Six-passenger model

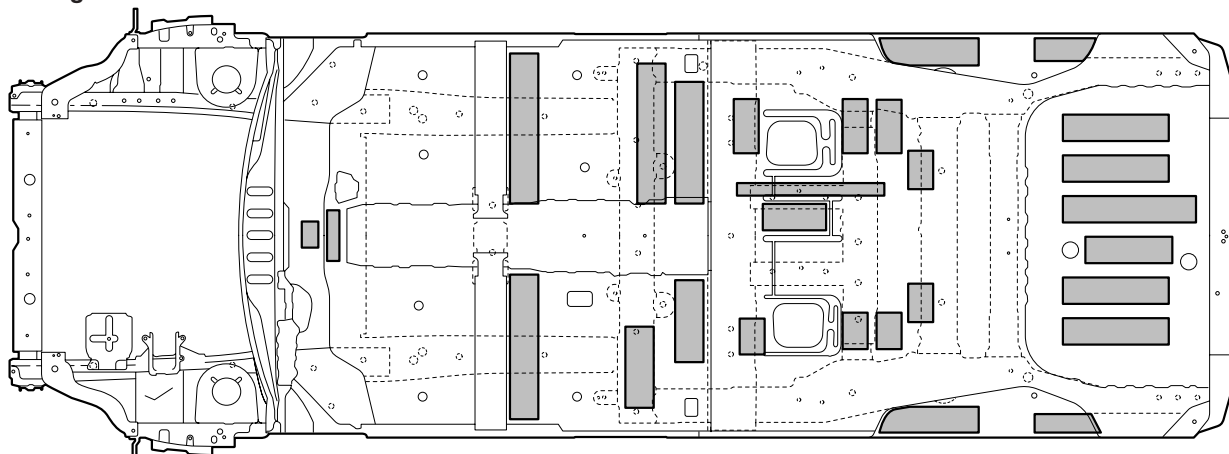

■ : 3.2 mm thick melting sheet and RSS (Place two 1.6 mm melting sheet one on top of another.)

AB301714AB

Seven-passenger model

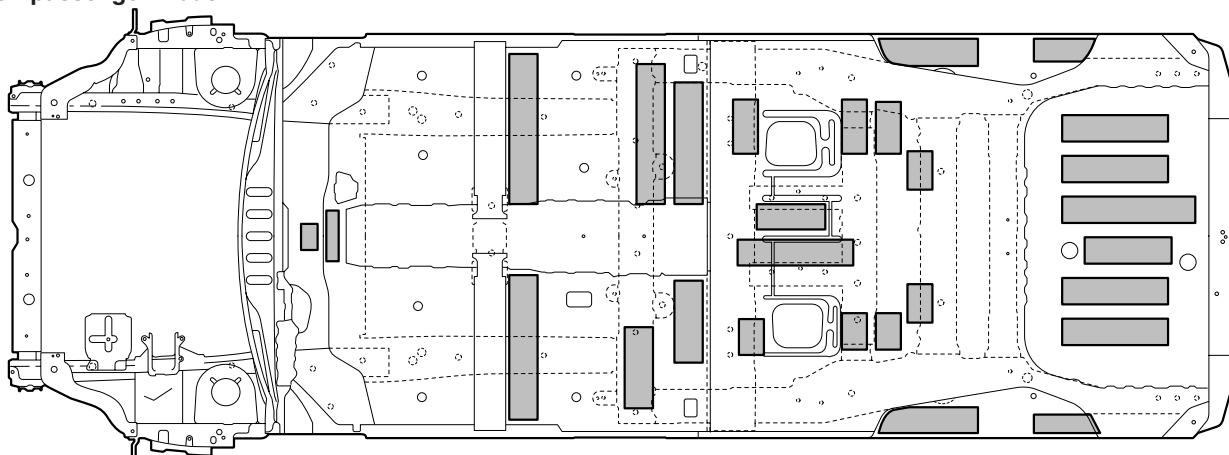

AB301713AB

NOTE: () indicates the number of melting sheets that are used for repair.

LOCATIONS USING URETHANE FOAM AND FOAM MATERIAL

M4010007000177

- Introduction of noise was prevented by adding acoustic foam materials inside the front pillar, centre pillar, side roof rail and wheel house arch.
- Introduction of noise was prevented by inserting urethane foam inside the front pillar, centre pillar and front fender.

⚠ CAUTION

The foam materials may burn when heated. Always observe the following instructions.

- Never use a gas burner or burn the areas using foam materials.
- When cutting the parts using foam materials, ensure to use tools (air saw, etc.) that do not generate fire.
- If there is residual foam materials remaining on the cut section (body side) then weld after removing the foam materials from periphery of the welding area.

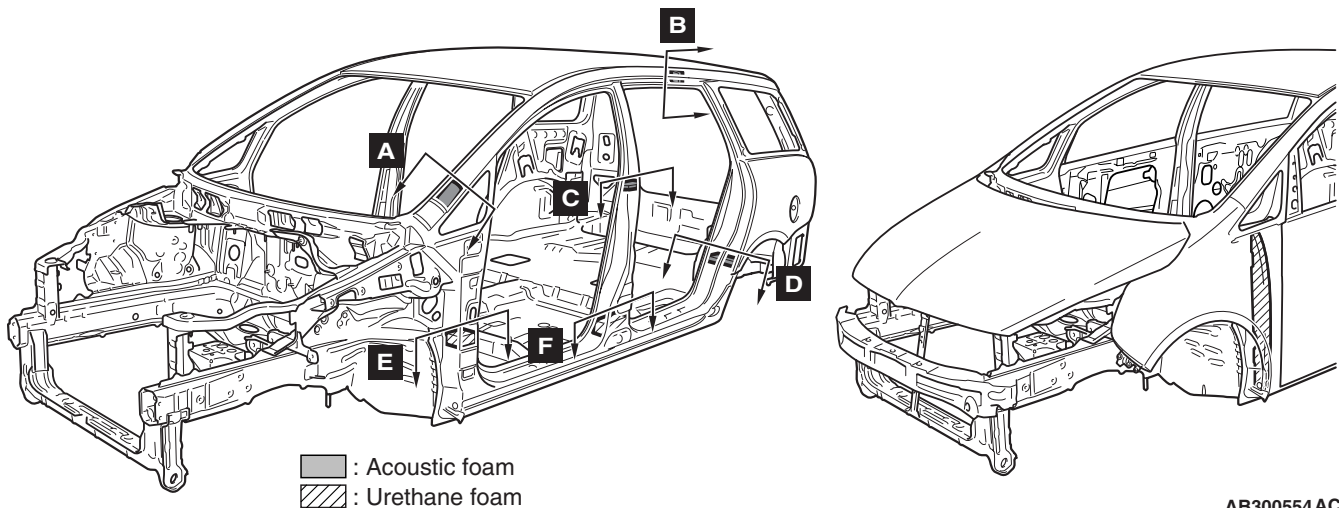

AB300554AC

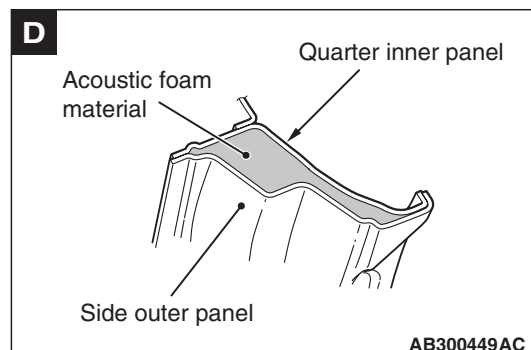
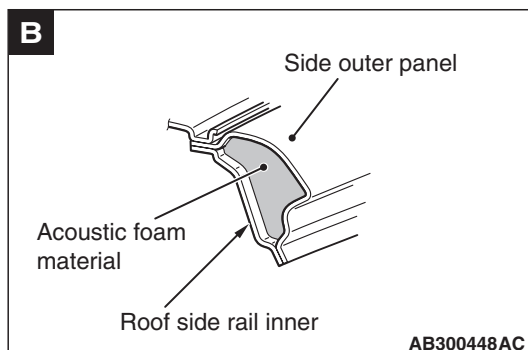
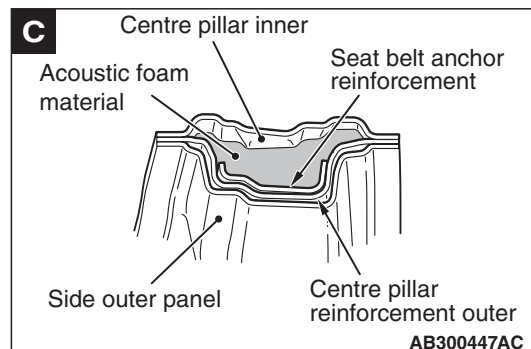
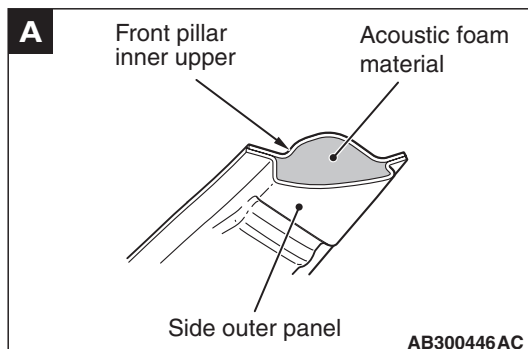

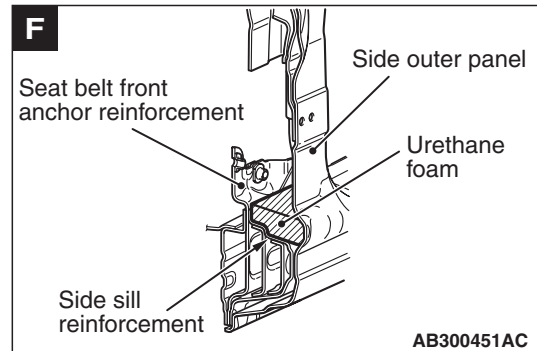
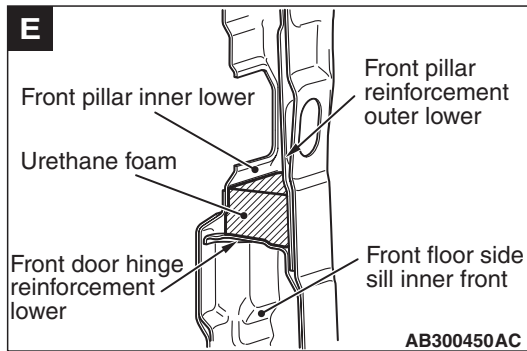

STIFFENER AND DAMP SHEET APPLICATION LOCATIONS

Sound insulation was improved with anti-vibration effects and heightening surface rigidity with a stiffener on the inner side of the side outer panel and the tailgate outer panel, as well as a damping sheet adhered to the inner side of the front door and the rear door outer panel.

M4010008000192

NOTE: The main contents of a stiffener are epoxy resin. It comes in a sheet form and contains a mixture of glass fibre and filler, and cures (stiffens) when heated. It is used to improve the rigidity of the outer plate.

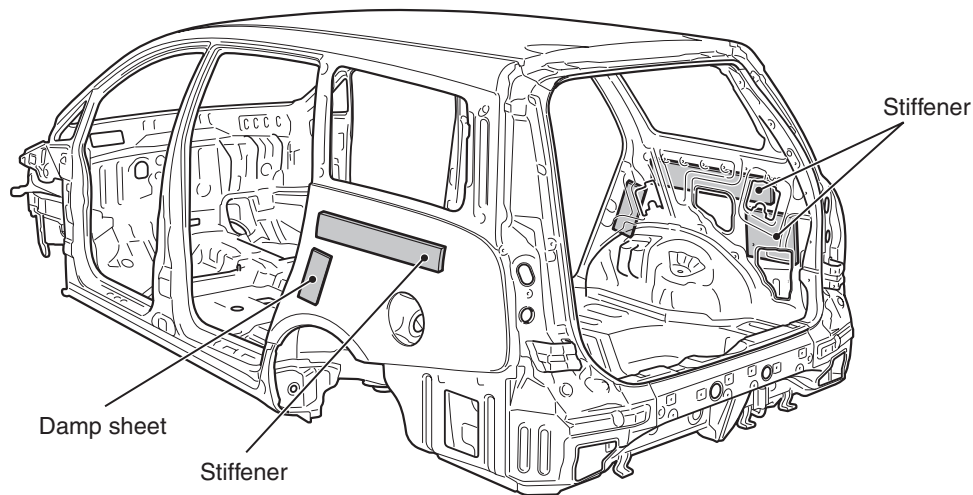

Front door

Tailgate

