

GROUP 80

CONFIGURATION
DIAGRAMS

CONTENTS

ENGINE COMPARTMENT <VEHICLES FOR RUSSIA>	80-2	FLOOR AND ROOF <VEHICLES FOR RUSSIA>.....	80-7
DASH PANEL <VEHICLES FOR RUSSIA>	80-3	LUGGAGE COMPARTMENT <VEHICLES FOR RUSSIA>.....	80-8

ENGINE COMPARTMENT <VEHICLES FOR RUSSIA>

M1801000303131

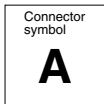

CONNECTOR COLOR CODE
B: BLACK
BR: BROWN
G: GREEN
GR: GRAY
L: BLUE
NONE: MILK WHITE
O: ORANGE
R: RED
V: VIOLET
Y: YELLOW

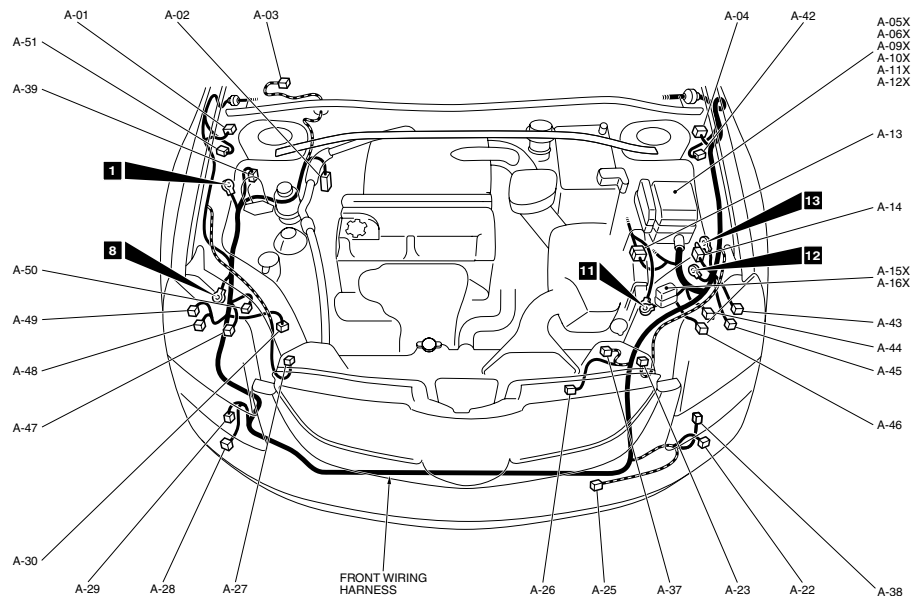

AC600391AC

A-01	(2-B)	WHEEL SPEED SENSOR (FRONT: RH)	A-25	(2-BR)	AMBIENT TEMPERATURE SENSOR
A-02	(28-GR)	ABS-ECU	A-26	(2-GR)	RADIATOR FAN MOTOR
A-03	(5-B)	WINDSHIELD WIPER MOTOR	A-27	(2-Y)	FRONT IMPACT SENSOR (RH)
A-04	(2-B)	WHEEL SPEED SENSOR (FRONT: LH)	A-28	(2-B)	FRONT FOG LIGHT (RH)
A-05X	(4)	FRONT FOG LIGHT RELAY	A-29	(2)	WINDSHIELD WASHER MOTOR
A-06X	(4)	HORN RELAY	A-30	(2-B)	A/C PRESSURE SENSOR
A-09X	(4)	REAR FOG LIGHT RELAY	A-37	(2-B)	CONDENSER FAN MOTOR
A-10X	(4)	FAN CONTROL RELAY	A-38	(1-B)	HORN (LOW)
A-11X	(11)	FRONT-ECU	A-39	(1-B)	HORN (HIGH)
A-12X	(11)	FRONT-ECU	A-42	(2-GR)	SIDE TURN-SIGNAL LIGHT (LH)
A-13	(17-GR)	FRONT WIRING HARNESS AND CONTROL WIRING HARNESS COMBINATION	A-43	(2-B)	FRONT TURN-SIGNAL LIGHT (LH)
A-14	(6-GR)	GROUNDING CONNECTOR	A-44	(3-GR)	HEADLIGHT LEVELING UNIT (LH)
A-15X	(4)	CONDENSER FAN RELAY	A-45	(2)	POSITION LIGHT (LH)
A-16X	(5)	RADIATOR FAN RELAY	A-46	(3-B)	HEADLIGHT (LH)
A-22	(2-B)	FRONT FOG LIGHT (LH)	A-47	(3-B)	HEADLIGHT (RH)
A-23	(2-Y)	FRONT IMPACT SENSOR (LH)	A-48	(2)	POSITION LIGHT (RH)
			A-49	(2-B)	FRONT TURN-SIGNAL LIGHT (RH)
			A-50	(3-GR)	HEADLIGHT LEVELING UNIT (RH)
			A-51	(2-GR)	SIDE TURN-SIGNAL LIGHT (RH)

M1801000602106

DASH PANEL <VEHICLES FOR RUSSIA>

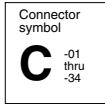

CONNECTOR COLOR CODE
B: BLACK
BR: BROWN
G: GREEN
GR: GRAY
L: BLUE
NONE: MILK WHITE
O: ORANGE
R: RED
V: VIOLET
Y: YELLOW

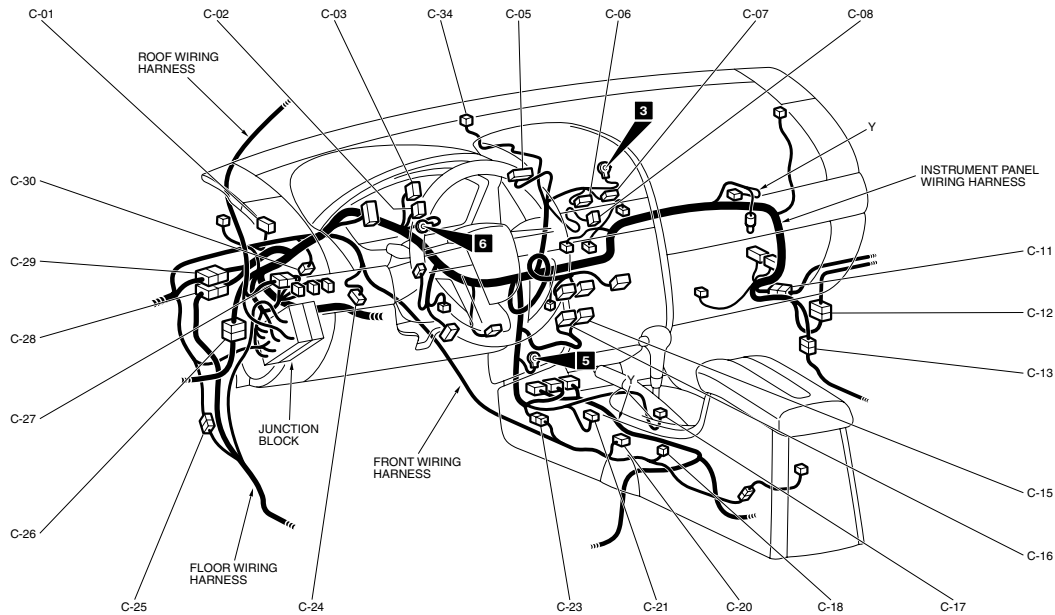

AC600392AB

C-01 (33)	J/C (1)	C-21 (9)	HEATED SEAT SWITCH
C-02 (22)	J/C (3)	C-23 (8)	INSTRUMENT PANEL WIRING HARNESS AND FRONT WIRING HARNESS COMBINATION
C-03 (33)	J/C (2)		
C-05 (20-B)	MULTI CENTER DISPLAY UNIT	C-24 (6-B)	ACCELERATOR PEDAL POSITION SENSOR
C-06 (3)	AIR BAG OFF INDICATOR LIGHT (PASSENGER'S SIDE)	C-25 (16)	FRONT WIRING HARNESS AND FLOOR WIRING HARNESS COMBINATION
C-07 (4)	SEAT BELT WARNING LIGHT (PASSENGER'S SIDE)	C-26 (32)	INSTRUMENT PANEL WIRING HARNESS AND FRONT DOOR WIRING HARNESS (LH) COMBINATION
C-08 (4)	HAZARD WARNING LIGHT SWITCH	C-27 (4)	INSTRUMENT PANEL WIRING HARNESS AND ROOF WIRING HARNESS COMBINATION
C-11 (2)	INSTRUMENT PANEL WIRING HARNESS AND FRONT WIRING HARNESS COMBINATION	C-28 (43)	INSTRUMENT PANEL WIRING HARNESS AND FLOOR WIRING HARNESS COMBINATION
C-12 (19)	INSTRUMENT PANEL WIRING HARNESS AND FRONT DOOR WIRING HARNESS (RH) COMBINATION	C-29 (38)	INSTRUMENT PANEL WIRING HARNESS AND FRONT WIRING HARNESS COMBINATION
C-13 (8)	INSTRUMENT PANEL WIRING HARNESS AND FLOOR WIRING HARNESS COMBINATION	C-30 (4)	STOPLIGHT SWITCH
C-15 (20-B)	A/C-ECU	C-34 (2)	PHOTO SENSOR
C-16 (16-B)	A/C-ECU		
C-17 (2)	ACCESSORY SOCKET (1)		
C-18 (1-B)	PARKING BRAKE SWITCH		
C-20 (8)	SHIFT SWITCH ASSEMBLY		

DASH PANEL <VEHICLES FOR RUSSIA> (CONTINUED)

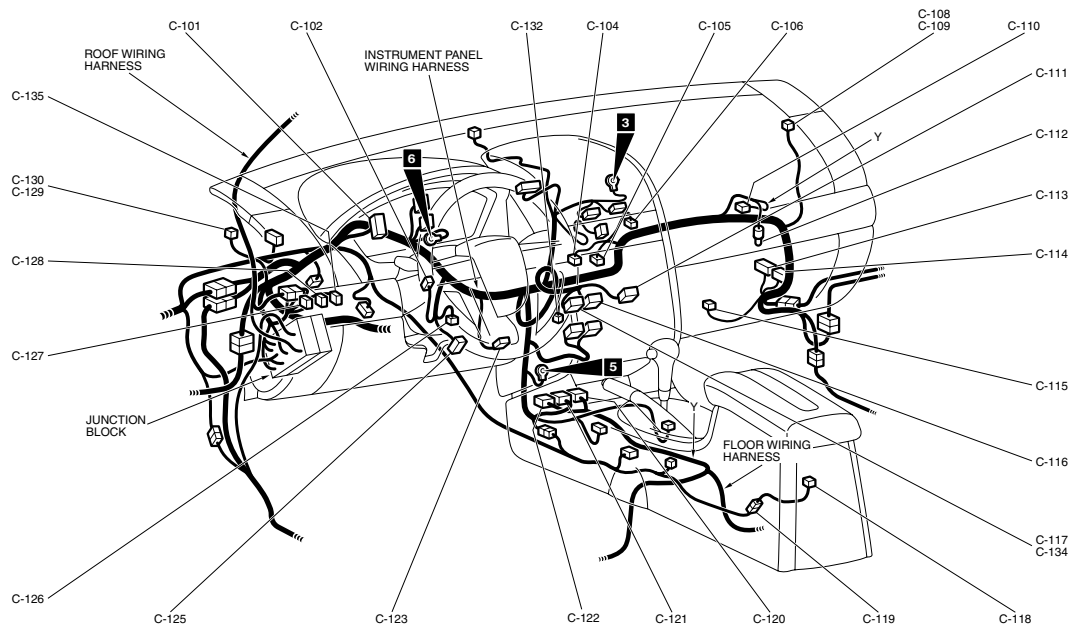
Connector
symbolC
-101
thru
-135CONNECTOR COLOR
CODE
B: BLACK
BR: BROWN
G: GREEN
GR: GRAY
L: BLUE
NONE: MILK WHITE
O: ORANGE
R: RED
V: VIOLET
Y: YELLOW

C-101 (22)	COMBINATION METER	C-118 (2)	ACCESSORY SOCKET (2)
C-102 (7)	MODE SELECTION DAMPER CONTROL MOTOR AND POTENTIOMETER	C-119 (2)	FRONT WIRING HARNESS AND FLOOR CONSOLE SUB WIRING HARNESS COMBINATION
C-104 (4)	POWER TRANSISTOR	C-120 (20-Y)	SRS-ECU
C-105 (7)	AIR MIXING DAMPER CONTROL MOTOR AND POTENTIOMETER	C-121 (28-Y)	SRS-ECU
C-106 (5)	OUTSIDE/INSIDE AIR SELECTION DAMPER CONTROL MOTOR	C-122 (20-Y)	SRS-ECU
C-108 (2-B)	TWEETER (RH) <WITHOUT AUDIO AMPLIFIER>	C-123 (2)	INTERIOR TEMPERATURE SENSOR
C-109 (2)	TWEETER (RH) <WITH AUDIO AMPLIFIER>	C-125 (16-B)	DATA LINK CONNECTOR
C-110 (4-Y)	AIR BAG MODULE (SQUIB) (PASSENGER'S SIDE)	C-126 (2)	AIR THERMO SENSOR
C-111 (14)	RADIO AND CD PLAYER OR RADIO, CD PLAYER AND CD CHANGER	C-127 (6-L)	RHEOSTAT
C-112 (2)	GLOVE BOX LIGHT	C-128 (6)	FOG LIGHT SWITCH
C-113 (18)	AUDIO AMPLIFIER	C-129 (2-B)	TWEETER (LH) <WITHOUT AUDIO AMPLIFIER>
C-114 (14)	AUDIO AMPLIFIER	C-130 (2)	TWEETER (LH) <WITH AUDIO AMPLIFIER>
C-115 (2)	BLOWER MOTOR	C-132 (1)	GLASS ANTENNA
C-116 (14)	RADIO, CD PLAYER AND CD CHANGER	C-134 (22)	RADIO, CD PLAYER AND CD CHANGER <WITHOUT AUDIO AMPLIFIER>
C-117 (10)	RADIO, CD PLAYER AND CD CHANGER <WITHOUT AUDIO AMPLIFIER>	C-135 (6-GR)	HEADLIGHT LEVELING SWITCH

DASH PANEL <VEHICLES FOR RUSSIA> (CONTINUED)

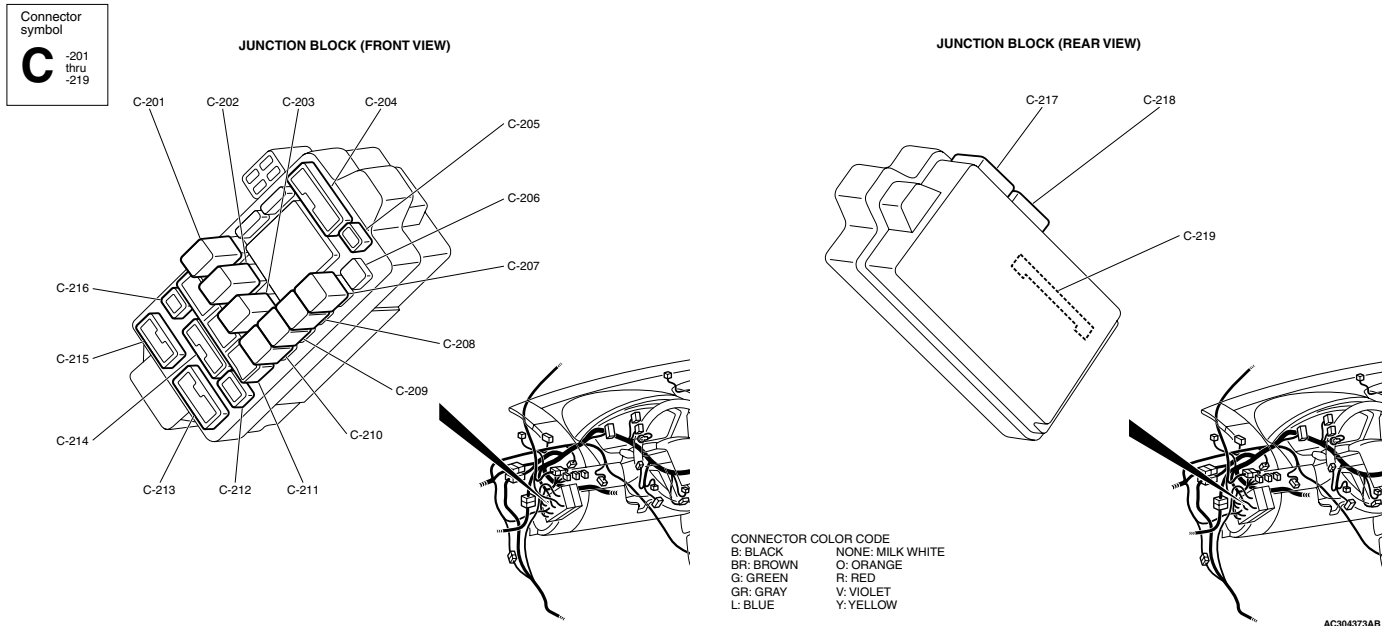

C-201 (5) REAR WINDOW DEFOGGER RELAY
C-202 (5) BLOWER RELAY
C-203 (5) POWER WINDOW RELAY
C-204 (15) FLOOR WIRING HARNESS AND
JUNCTION BLOCK COMBINATION
C-205 (3) ROOF WIRING HARNESS AND
JUNCTION BLOCK COMBINATION
C-206 (4) NO CONNECTION
C-207 (4) HEATED SEAT RELAY
C-208 (4) FUEL PUMP RELAY (2)
C-209 (4) ACCESSORY SOCKET RELAY
C-210 (4) FUEL PUMP RELAY (1)
C-211 (28) INSTRUMENT PANEL WIRING
HARNESS AND JUNCTION BLOCK
COMBINATION

C-212 (2) FRONT WIRING HARNESS AND
JUNCTION BLOCK COMBINATION
C-213 (13) INSTRUMENT PANEL WIRING
HARNESS AND JUNCTION BLOCK
COMBINATION
C-214 (14) FRONT WIRING HARNESS AND
JUNCTION BLOCK COMBINATION
C-215 (6) INSTRUMENT PANEL WIRING
HARNESS AND JUNCTION BLOCK
COMBINATION
C-216 (1-B) INSTRUMENT PANEL WIRING
HARNESS AND JUNCTION BLOCK
COMBINATION
C-217 (24) ETACS-ECU
C-218 (24-GR) ETACS-ECU
C-219 (20) ETACS-ECU

DASH PANEL <VEHICLES FOR RUSSIA> (CONTINUED)

Connector
symbol**C**
-301
thru
-311

STEERING COLUMN

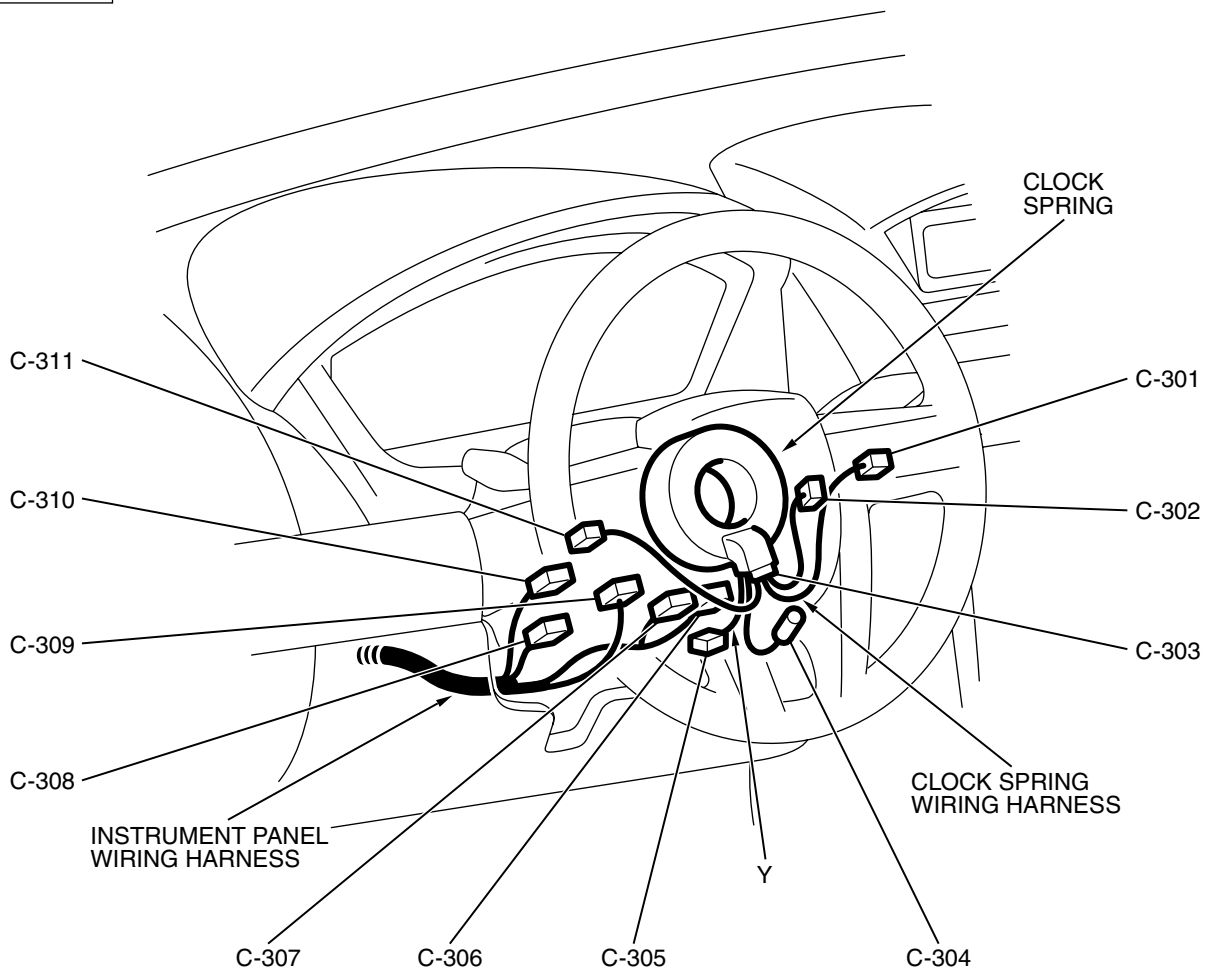

AC304363AB

C-301 (2-B)	REMOTE CONTROLLED RADIO SWITCH (RH)	C-306 (6)	CLOCK SPRING
C-302 (3-Y)	AUTO-CRUISE CONTROL SWITCH	C-307 (4-Y)	CLOCK SPRING
C-303 (5-GR)	CLOCK SPRING AND CLOCK SPRING WIRING HARNESS COMBINATION	C-308 (6)	IGNITION SWITCH
C-304 (1)	HORN SWITCH	C-309 (10)	COLUMN SWITCH
C-305 (4-Y)	AIR BAG MODULE (SQUIB) (DRIVER'S SIDE)	C-310 (7)	KEY REMINDER SWITCH
		C-311 (2-B)	REMOTE CONTROLLED RADIO SWITCH (LH)

FLOOR AND ROOF <VEHICLES FOR RUSSIA>

M1801000902185

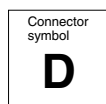

CONNECTOR COLOR
CODE
B: BLACK
BR: BROWN
G: GREEN
GR: GRAY
L: BLUE
NONE: MILK WHITE
O: ORANGE
R: RED
V: VIOLET
Y: YELLOW

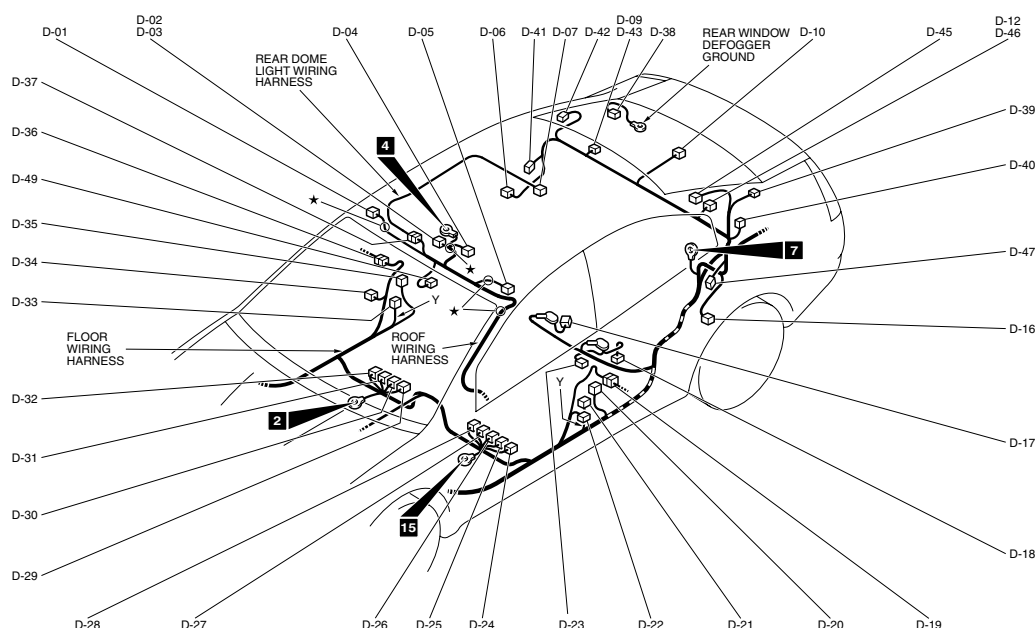

AC600393AB

D-01	(2)	VANITY MIRROR LIGHT (RH)	D-28	(5-B)	SEAT BELT BUCKLE SWITCH (DRIVER'S SIDE)
D-02	(4)	MAP LIGHT ASSEMBLY <WITHOUT SUNROOF>	D-29	(3)	SEAT BELT BUCKLE SWITCH (PASSENGER'S SIDE)
D-03	(7)	OVERHEAD CONSOLE ASSEMBLY <WITH SUNROOF>	D-30	(3-GR)	OCCUPANT CLASSIFICATION-ECU
D-04	(10)	SUNROOF ASSEMBLY	D-31	(3-B)	HEATED SEAT ASSEMBLY (RH)
D-05	(2)	VANITY MIRROR LIGHT (LH)	D-32	(2-R)	SIDE AIR BAG MODULE (SQUIB) (RH)
D-06	(3)	REAR DOOR SWITCH (RH)	D-33	(2-B)	SEAT BELT PRETENSIONER (RH)
D-07	(3)	REAR DOME LIGHT	D-34	(3)	FRONT DOOR SWITCH (RH)
D-09	(2)	REAR SPEAKER (RH) <WITHOUT AUDIO AMPLIFIER>	D-35	(2)	SIDE IMPACT SENSOR (FRONT: RH)
D-10	(2)	TRUNK LIGHT	D-36	(10)	FLOOR WIRING HARNESS AND REAR DOOR WIRING HARNESS (RH) COMBINATION
D-12	(2)	REAR SPEAKER (LH) <WITHOUT AUDIO AMPLIFIER>	D-37	(3)	ROOF WIRING HARNESS AND REAR DOME LIGHT WIRING HARNESS COMBINATION
D-16	(3)	REAR DOOR SWITCH (LH)	D-38	(1)	REAR WINDOW DEFOGGER (-)
D-17	(2-B)	FUEL LEVEL SENSOR (SUB)	D-39	(1)	REAR WINDOW DEFOGGER (+)
D-18	(5-GR)	FUEL PUMP MODULE	D-40	(1-B)	CAPACITOR
D-19	(10)	FLOOR WIRING HARNESS AND REAR DOOR WIRING HARNESS (LH) COMBINATION	D-41	(2-Y)	SIDE IMPACT SENSOR (REAR: RH)
D-20	(2)	SIDE IMPACT SENSOR (FRONT: LH)	D-42	(2-B)	CURTAIN AIR BAG MODULE (SQUIB) (RH)
D-21	(2-B)	SEAT BELT PRETENSIONER (LH)	D-43	(4)	REAR SPEAKER (RH) <WITH AUDIO AMPLIFIER>
D-22	(3)	FRONT DOOR SWITCH (LH)	D-45	(2-B)	CURTAIN AIR BAG MODULE (SQUIB) (LH)
D-23	(3-B)	FUEL TANK DIFFERENTIAL PRESSURE SENSOR	D-46	(4)	REAR SPEAKER (RH) <WITH AUDIO AMPLIFIER>
D-24	(2-R)	SIDE AIR BAG MODULE (SQUIB) (LH)	D-47	(2-Y)	SIDE IMPACT SENSOR (REAR: LH)
D-25	(2-B)	POWER SEAT ASSEMBLY	D-49	(7-B)	AUTOMATIC ANTI-DAZZLING MIRROR
D-26	(3-B)	HEATED SEAT ASSEMBLY (LH)			
D-27	(2-GR)	SEAT SLIDE SENSOR			

LUGGAGE COMPARTMENT <VEHICLES FOR RUSSIA>

M1801001500753

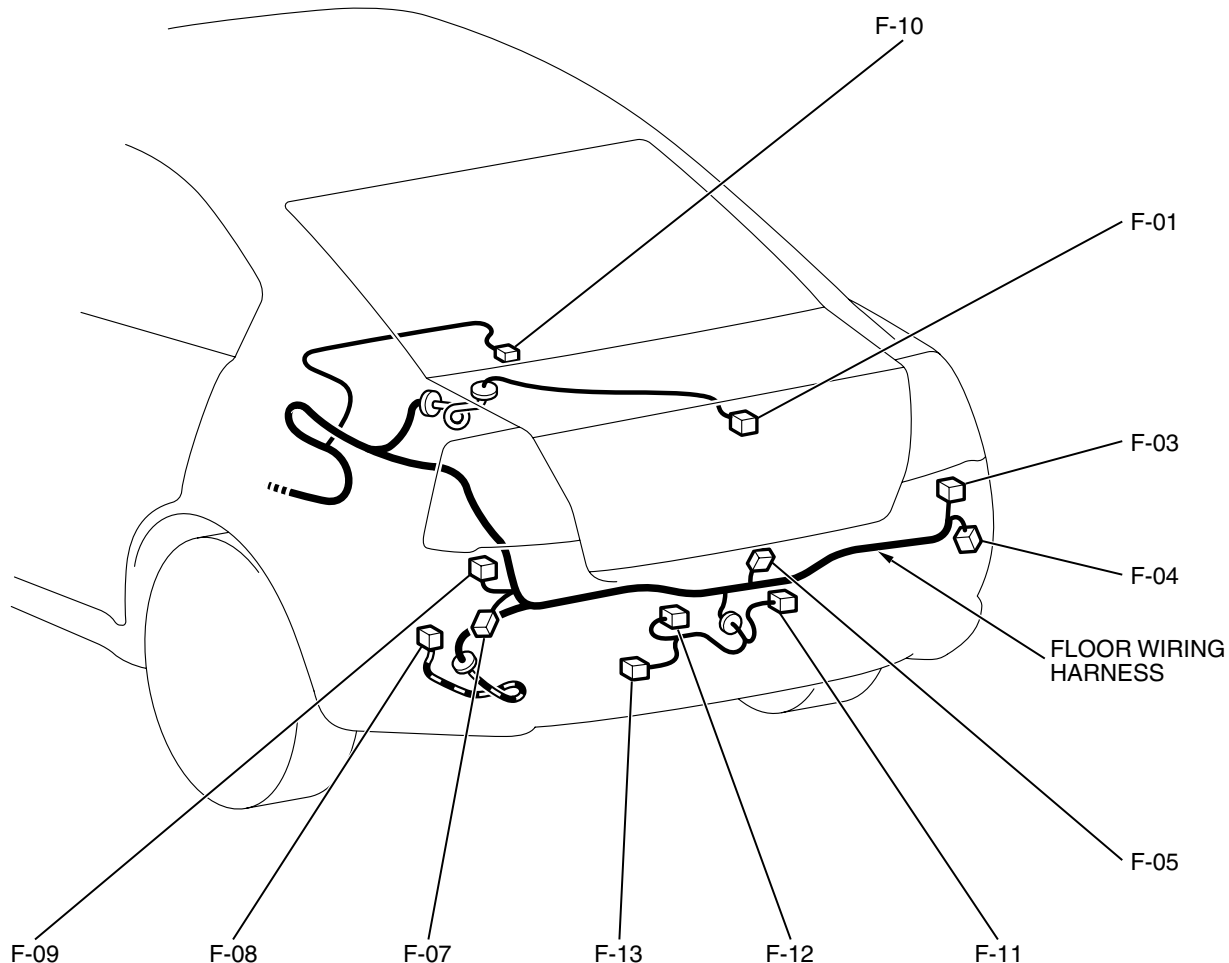
Connector
symbol**F**

AC600394AB

F-01 (2-GR) HIGH-MOUNTED STOPLIGHT
 F-03 (6) REAR COMBINATION LIGHT (RH)
 F-04 (2) WHEEL SPEED SENSOR (REAR:
 RH)
 F-05 (2) TRUNK LID LATCH ASSEMBLY
 F-07 (2) WHEEL SPEED SENSOR (REAR:
 LH)

F-08 (2-B) EVAPORATIVE EMISSION
 VENTILATION SOLENOID
 F-09 (6) REAR COMBINATION LIGHT (LH)
 F-10 (8-B) NAVIGATION UNIT <WITH MMCS>
 F-11 (2-B) LICENSE PLATE LIGHT (RH)
 F-12 (2-B) LICENSE PLATE LIGHT (LH)
 F-13 (2-B) REAR FOG LIGHT