

GROUP 14

ENGINE COOLING

GENERAL

OUTLINE OF CHANGES

The following maintenance service procedures have been established to correspond to the addition of vehicles with 4G9-GDI engine. Maintenance service procedures not listed below are the same as before.

WATER HOSE AND WATER PIPE**REMOVAL AND INSTALLATION****Pre-removal and Post-installation Operation**

- Engine Coolant Draining and Supplying
- Air Cleaner and Air Intake Hose Assembly Removal and Installation

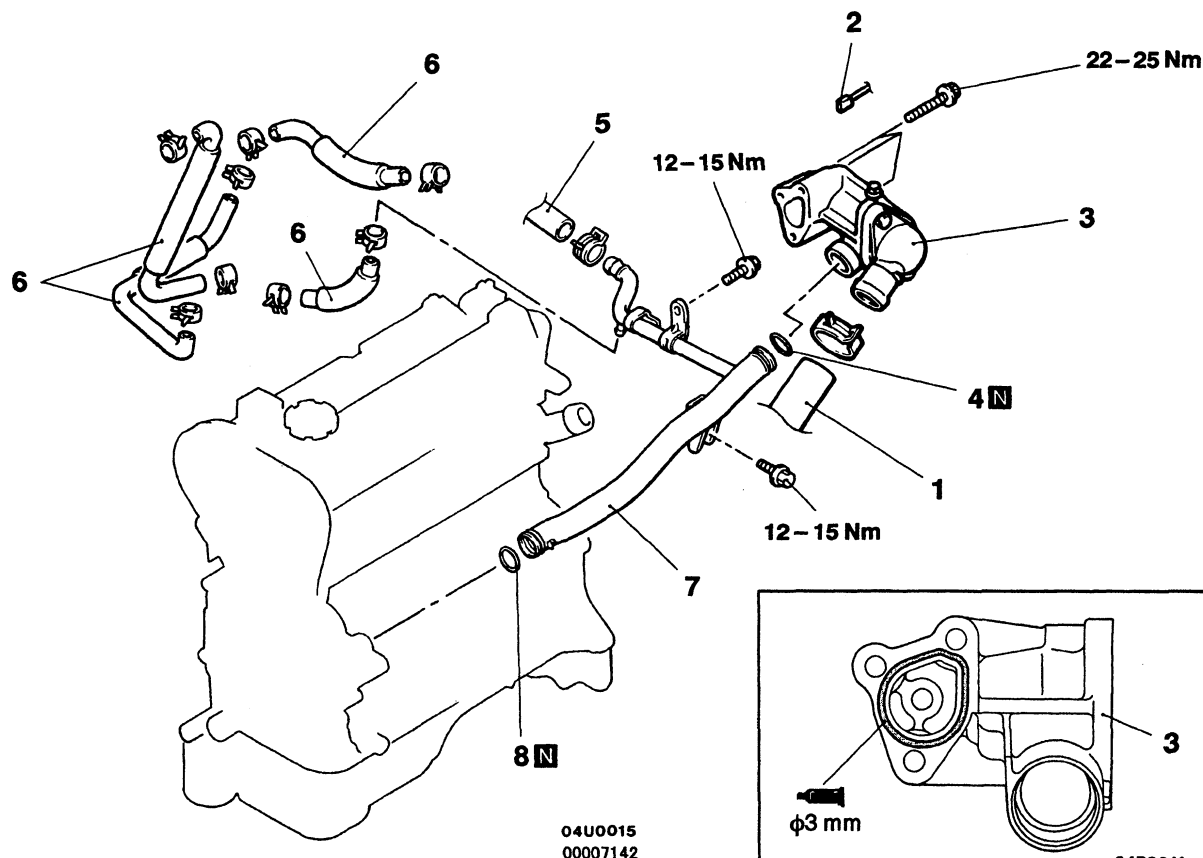

Sealant
Mitsubishi Genuine Part No.
MD970389 or equivalent

Removal steps

- ◀A▶ ▶C▶ 1. Radiator lower hose connection
2. Engine coolant temperature gauge unit connector
- ▶B▶ ▶A▶ 3. Thermostat case assembly
4. O-ring
5. Heater hose connection
- Intake manifold (Refer to GROUP 15.)

- ▶A▶ 6. Water hose
7. Water inlet pipe assembly
8. O-ring

NOTE

Removal and installation service points are the same as before.